

**Amended Acknowledgment and
Amended Notice of Acknowledgment
of Acceptance of R.S. 2477
Right-of-Way Grant**

Ent 235853 Bk 410 Pg 771
Date: 15-FEB-2008 9:48AM
Fee: None
Filed By: CP
BRUCE BROWN, Recorder
BEAVER COUNTY CORPORATION
For: GOVERNOR OF THE STATE OF UTAH

THE STATE OF UTAH

TO ALL WHOM THESE PRESENTS SHALL COME, Greeting:

Know ye, This is an Amended Acknowledgment and Amended Notice of Acknowledgment made under Utah Code Sections 72-5-309 through 310 inclusive, that the grant of the United States of America of “the right of way for the construction of highways over public lands, not reserved for public uses” under United States Revised Statutes 2477 (43 U.S.C. Section 932 (repealed October 21, 1976, with proviso recognizing the validity of rights-of-way already established)) was accepted for and on behalf of the State of Utah and its political subdivision Beaver County as it pertains to the highway located in Beaver County known as BEAVER LAKE MOUNTAIN ROAD; County Road Number: B-47; State Geographic Information Database (SGID) Road Identification Number: RD010132. Total road length is 1.98 miles more or less.

This Amended Acknowledgment and Amended Notice of Acknowledgment supersedes the information contained in the Acknowledgment recorded at Ent 232934, Bk 409, Beg Pg 285.

The reason for this Amended Acknowledgment and Amended Notice of Acknowledgment includes, but is not limited to, the fact that the road was constructed, mechanically, or by continuous use as a public highway for a period of at least ten years, over public lands not reserved for public uses, prior to the earlier of (a) the October 21, 1976 repeal of R.S. 2477 or (b) the date the servient estate was reserved for public uses.

This Amended Acknowledgment and Amended Notice of Acknowledgment applies only to the segments of the road that traverse land owned by the Bureau of Land Management, United States Department of the Interior, and does not apply to segments of the road that traverse land owned by any other person or entity. The State of Utah and its political subdivisions reserve the right to make further acknowledgments and notices of acknowledgment with regard to road segments that traverse land owned by other entities, including the United States of America, through one or more of its agencies.

A printed copy of a map showing the location of the road in said county is appended hereto as “Attachment 1,” a printed copy of representative photos of the road is appended hereto as “Attachment 2,” a printed copy of a description of the beginning and ending points of the entire road together with a list of Townships, Ranges and Sections that may be traversed by the road in said county is appended hereto as “Attachment 3,” and a printed copy of the Road Centerline Description Cover Page(s) is appended hereto as “Attachment 4.” The Appendices listed in “Attachment 4” that contain the actual road centerline descriptions are incorporated herein by reference.

A printed copy of this Amended Acknowledgment and Amended Notice of Acknowledgment, together with its Attachments and Appendices, may be viewed and/or obtained at the office of the Utah State Archives.

An electronic copy of this Amended Acknowledgment and Amended Notice of Acknowledgment, together with its Attachments and Appendices, may be viewed and/or downloaded as read-only PDF (Portable Document Format) files via the Internet at <http://recorded2477roads.utah.gov>.

The owner of the servient estate in the land underlying the road-segments subject to this Amended Acknowledgment and Amended Notice is believed to be the United States of America through one or more of its agencies. Any of such agencies or any other person with a servient ownership claim or a competing dominant estate right-of-way ownership claim, may file a petition in the State District Court for Salt Lake County for a decision regarding the correctness of this Amended Acknowledgment. A claimant shall file a petition within sixty (60) days after receipt of this Notice.

In Witness Whereof, I, John Harja, the official designee of the Governor of the State of Utah, in conformity to the laws of the State (Utah Code Sections 72-5-308 through 310 inclusive), have caused this Amended Acknowledgment and Amended Notice of Acknowledgment to be made.

Signed by my hand in Salt Lake City, Utah, the 15th day of January, 2008.

By the Governor's Designee



John Harja

CERTIFICATION

State of Utah)
 : ss
County of Salt Lake)

I hereby certify that the signer of the foregoing document, John Harja, is personally known by me, has made a voluntary signature and taken an oath stating that he is the official designee of the Governor of the State of Utah and is authorized to sign this document on the Governor's behalf pursuant to Utah Code Section 72-5-309. He further vouched that, based upon information and belief, the facts alleged therein are true.

Dated this 15 day of Jan, 2008.



Notary Public

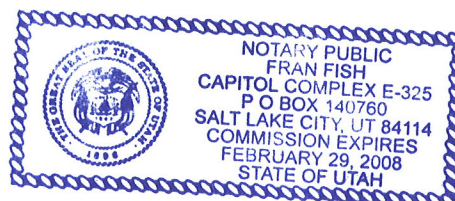

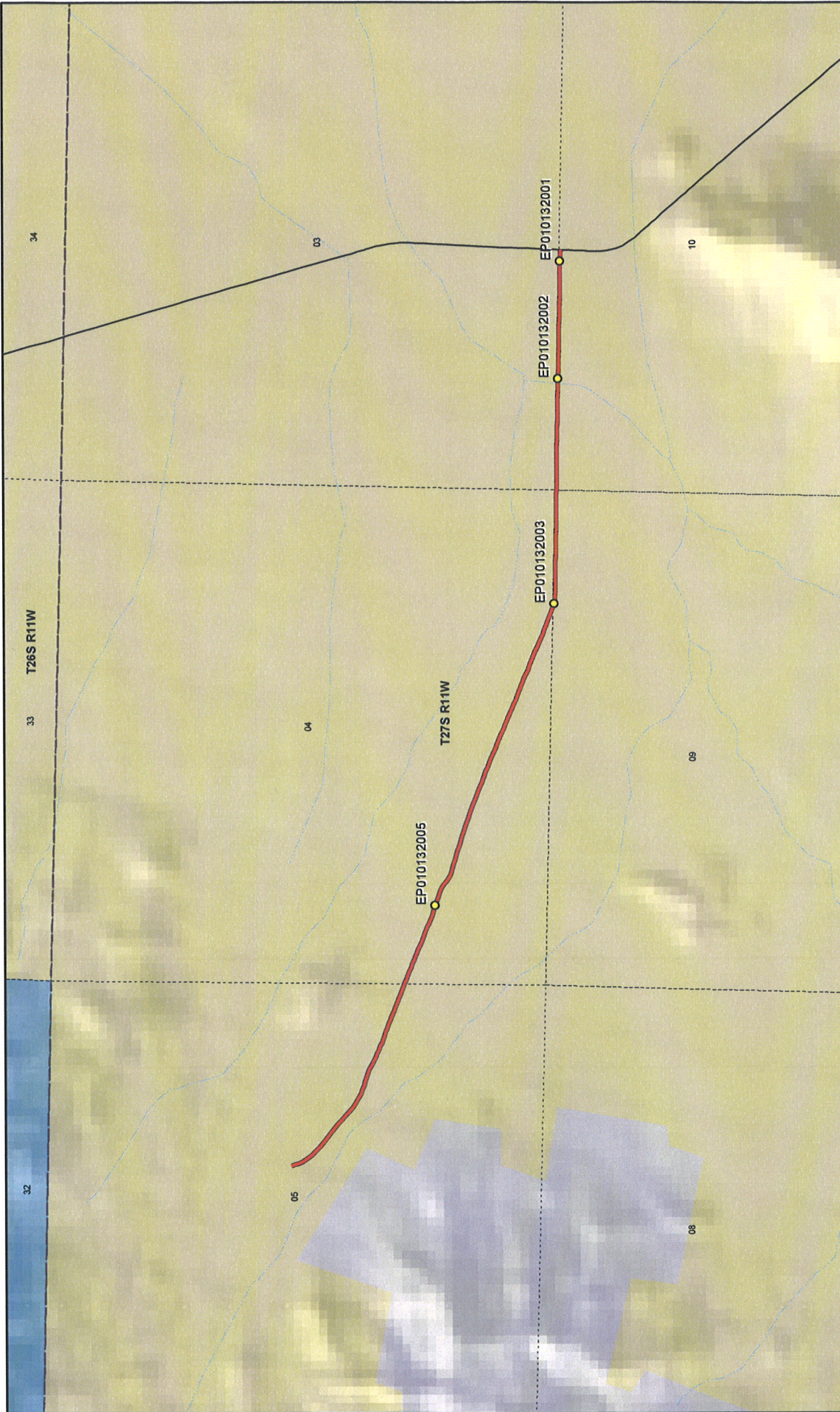

BEAVER LAKE MOUNTAIN ROAD - Beaver County
SGID RD_ID RD010132

Land Ownership Categories

- BLM
- Private
- SITLA, State Trust Land
- USFS, National Forest
- State Parks and Recreation
- Tribal, Indian Reservation
- NPS, National Park
- Wilderness
- UDWR, Wildlife Reserve
- DOD, Military
- State Sovereign Land
- National Recreation Area
- USFWS, Natl. Wildlife Refuge

Transportation Network

- BEAVER LAKE MOUNTAIN ROAD
- Other Roads
- Title V, Issued Or Under Consideration By BLM Or County
- Photo Event Point
- Section = 1 Mile

Map prepared by the State of Utah
Automated Geographic Reference Center
Room 3130 State Office Building
Salt Lake City, UT 84114
Jan 08, 2008

Attachment 2



EP010132001



EP010132002

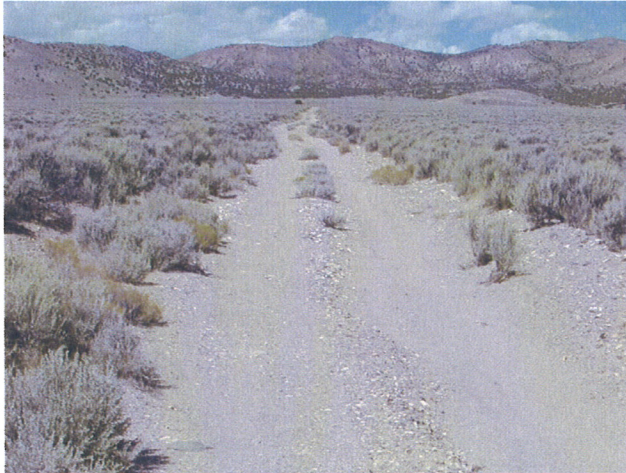

EP010132003



EP010132005

EP000000000

EP000000000

BEAVER LAKE MOUNTAIN ROAD - Beaver County
SGID RD_ID RD010132

Map prepared by the State of Utah
Automated Geographic Reference Center
Room 5130 State Office Building
Salt Lake City, Utah 84114
April 17, 2007



Attachment 3

Beginning & Ending Points and Township, Range, and Section References For:

Popular Name: BEAVER LAKE MOUNTAIN ROAD

County: Beaver

County Road Number: B-47

State Geographic Information Database (SGID) Road Identification Number: RD010132.

Total Road Length: 1.98 miles more or less.

Beginning at a point on the road centerline located at 38 degrees 29 minutes 33.23 seconds North Latitude and -113 degrees 06 minutes 32.45 seconds West Longitude, which can be converted to mapping accuracy State Plane Utah South Zone NAD 83 feet coordinates of X = 1,179,885.3 feet and Y = 10,511,334.5 feet based on the US Survey Foot conversion.

Ending at a point on the road centerline located at 38 degrees 29 minutes 6.7 seconds North Latitude and -113 degrees 04 minutes 29.36 seconds West Longitude, which can be converted to mapping accuracy State Plane Utah South Zone NAD 83 feet coordinates of X = 1,189,626.0 feet and Y = 10,508,484.4 feet based on the US Survey Foot conversion.

This road may traverse:

Township 27 South Range 11 West, Section(s) 4,5,9,10, Salt Lake Base & Meridian
See Attachment 1 above for a cartographic depiction of the course of this road.

**Attachment 4
Road Centerline Description Cover Page(s)**

Popular Name: BEAVER LAKE MOUNTAIN ROAD

County: Beaver

County Road Number: B-47

State Geographic Information Database (SGID) Road Identification Number: RD010132.

Total Road Length: 1.98 miles more or less.

Centerline Descriptions Of Road-Segments That Cross Over Federally Owned Land, Derived From Global Positioning System Data And Cross-checked against USGS Digital Orthophoto Quadrangles Compiled By The Utah Automated Geographic Reference Center And Entered Into The State Geographic Information Database (SGID).

Road-Segments Listed by SGID Road Identification Number (RD_ID)	Road-Segment Numbers	Believed Ownership Of Servient Estate	Approximate Segment Length	See Attached Appendix
RD010132	001	BLM	1.98 Miles	A
		Total Road Length	1.98	_____

* Indicates that a Title V permit will be requested, is in process, or has been issued.

† Indicates that road-segments crossing Forest Service land are under consideration by the state and county as of the date of this Amended Acknowledgment and Amended Notice of Acknowledgment.

Appendix A to Attachment 4

Popular Name: BEAVER LAKE MOUNTAIN ROAD

County: Beaver

County Road Number: B-47

State Geographic Information Database (SGID) Road Identification Number: RD010132.

Road-Segment Number: 001

Road-Segment Length: 1.98 miles more or less.

Believed owner of the land underlying this road-segment is: Bureau of Land Management.

The following description is based upon the geographic coordinate system using the NAD83 Datum. The source is GPS mapping grade data as indicated in the metadata and/or the transportation data model of the State of Utah Geographic Information Database (SGID).

The road-segment itself is the monument that is identified by its physical presence on the land. The location of said physical presence is closely approximated by mapping grade Global Positioning System (GPS) data. Said data are checked against the corresponding gray-scale 1-meter Digital Orthophoto Quadrangles published by the United States Geological Survey (USGS) to verify a reasonable degree of accuracy. In circumstances where accurate satellite signal acquisition is not possible, such as deep, narrow canyons or under a canopy of dense foliage, or where very sharp curves in the road make accuracy questionable, such portions of the road were digitized from the corresponding gray-scale 1-meter Digital Orthophoto Quadrangles published by the United States Geological Survey (USGS).

This road-segment may traverse:

Township 27 South Range 11 West, Section(s) 4,5,9,10, Salt Lake Base & Meridian

The following description closely approximates the location of the centerline of the physical monument (BEAVER LAKE MOUNTAIN ROAD)-- Segment 001 based on mapping grade Global Positioning System (GPS) data as defined above:

Beginning at a point on the road center line located at 38 degrees 29 minutes 33.23 seconds North Latitude and -113 degrees 06 minutes 32.45 seconds West Longitude, which can be converted to mapping accuracy State Plane Utah South Zone NAD 83 feet coordinates of X = 1,179,885.3 feet and Y = 10,511,334.5 feet; thence the following courses along the said road center line:

thence South 27 Degrees 51 Minutes 33 Seconds East	34.8 feet
thence South 12 Degrees 57 Minutes 10 Seconds East	42 feet
thence South 20 Degrees 58 Minutes 27 Seconds East	24.2 feet
thence South 26 Degrees 32 Minutes 57 Seconds East	24.5 feet
thence South 34 Degrees 22 Minutes 49 Seconds East	57.4 feet
thence South 40 Degrees 23 Minutes 34 Seconds East	64.7 feet
thence South 44 Degrees 02 Minutes 06 Seconds East	61.7 feet
thence South 46 Degrees 50 Minutes 25 Seconds East	61.5 feet
thence South 49 Degrees 24 Minutes 46 Seconds East	58.6 feet
thence South 51 Degrees 08 Minutes 02 Seconds East	55 feet
thence South 52 Degrees 14 Minutes 18 Seconds East	46.3 feet

thence South 52 Degrees 47 Minutes 32 Seconds East 33.9 feet
 thence South 52 Degrees 36 Minutes 58 Seconds East 40.2 feet
 thence South 50 Degrees 27 Minutes 19 Seconds East 72.7 feet
 thence South 49 Degrees 10 Minutes 05 Seconds East 65.8 feet
 thence South 46 Degrees 59 Minutes 27 Seconds East 55.9 feet
 thence South 48 Degrees 06 Minutes 05 Seconds East 52.7 feet
 thence South 50 Degrees 08 Minutes 52 Seconds East 58 feet
 thence South 54 Degrees 40 Minutes 57 Seconds East 61.4 feet
 thence South 60 Degrees 18 Minutes 09 Seconds East 58.4 feet
 thence South 61 Degrees 53 Minutes 53 Seconds East 49.6 feet
 thence South 65 Degrees 31 Minutes 17 Seconds East 43 feet
 thence South 69 Degrees 53 Minutes 39 Seconds East 35.7 feet
 thence South 73 Degrees 45 Minutes 11 Seconds East 28.8 feet
 thence South 73 Degrees 41 Minutes 17 Seconds East 29.8 feet
 thence South 75 Degrees 01 Minutes 34 Seconds East 36.1 feet
 thence South 71 Degrees 35 Minutes 08 Seconds East 38.8 feet
 thence South 68 Degrees 47 Minutes 10 Seconds East 40.2 feet
 thence South 66 Degrees 15 Minutes 05 Seconds East 33.8 feet
 thence South 61 Degrees 52 Minutes 12 Seconds East 48.9 feet
 thence South 61 Degrees 16 Minutes 21 Seconds East 47.3 feet
 thence South 63 Degrees 00 Minutes 11 Seconds East 44.3 feet
 thence South 65 Degrees 07 Minutes 33 Seconds East 43.1 feet
 thence South 67 Degrees 28 Minutes 20 Seconds East 43.1 feet
 thence South 69 Degrees 13 Minutes 20 Seconds East 40.1 feet
 thence South 67 Degrees 53 Minutes 38 Seconds East 38.7 feet
 thence South 71 Degrees 05 Minutes 06 Seconds East 36.8 feet
 thence South 69 Degrees 10 Minutes 51 Seconds East 37.3 feet
 thence South 68 Degrees 11 Minutes 29 Seconds East 41.8 feet
 thence South 69 Degrees 11 Minutes 34 Seconds East 41.9 feet
 thence South 69 Degrees 19 Minutes 25 Seconds East 39.4 feet
 thence South 68 Degrees 53 Minutes 45 Seconds East 37.7 feet
 thence South 68 Degrees 37 Minutes 35 Seconds East 34.6 feet
 thence South 70 Degrees 25 Minutes 24 Seconds East 20.2 feet
 thence South 68 Degrees 31 Minutes 32 Seconds East 24.7 feet
 thence South 67 Degrees 42 Minutes 25 Seconds East 25.6 feet
 thence South 67 Degrees 42 Minutes 25 Seconds East 25.6 feet
 thence South 69 Degrees 04 Minutes 35 Seconds East 19 feet
 thence South 67 Degrees 39 Minutes 45 Seconds East 32.4 feet
 thence South 69 Degrees 49 Minutes 47 Seconds East 37.5 feet
 thence South 68 Degrees 43 Minutes 17 Seconds East 35.6 feet
 thence South 67 Degrees 47 Minutes 37 Seconds East 33.4 feet
 thence South 67 Degrees 56 Minutes 48 Seconds East 12.1 feet
 thence South 69 Degrees 00 Minutes 32 Seconds East 72.2 feet
 thence South 68 Degrees 25 Minutes 43 Seconds East 36.1 feet
 thence South 67 Degrees 04 Minutes 03 Seconds East 29.1 feet
 thence South 67 Degrees 04 Minutes 07 Seconds East 11.6 feet
 thence South 69 Degrees 49 Minutes 32 Seconds East 40.3 feet
 thence South 67 Degrees 07 Minutes 42 Seconds East 42.5 feet
 thence South 68 Degrees 26 Minutes 52 Seconds East 44.9 feet

thence South 68 Degrees 13 Minutes 44 Seconds East 47.1 feet
 thence South 69 Degrees 49 Minutes 19 Seconds East 43.1 feet
 thence South 68 Degrees 16 Minutes 14 Seconds East 41.1 feet
 thence South 68 Degrees 12 Minutes 18 Seconds East 43.6 feet
 thence South 67 Degrees 00 Minutes 33 Seconds East 41.4 feet
 thence South 66 Degrees 27 Minutes 31 Seconds East 40.5 feet
 thence South 66 Degrees 24 Minutes 26 Seconds East 44.5 feet
 thence South 67 Degrees 07 Minutes 42 Seconds East 42.5 feet
 thence South 70 Degrees 56 Minutes 33 Seconds East 37.6 feet
 thence South 68 Degrees 04 Minutes 40 Seconds East 39 feet
 thence South 68 Degrees 02 Minutes 00 Seconds East 35.5 feet
 thence South 68 Degrees 02 Minutes 00 Seconds East 35.5 feet
 thence South 67 Degrees 03 Minutes 14 Seconds East 33.2 feet
 thence South 62 Degrees 42 Minutes 21 Seconds East 31.8 feet
 thence South 67 Degrees 27 Minutes 12 Seconds East 22.8 feet
 thence South 69 Degrees 11 Minutes 13 Seconds East 26.4 feet
 thence South 70 Degrees 30 Minutes 35 Seconds East 38.7 feet
 thence South 73 Degrees 03 Minutes 18 Seconds East 40.9 feet
 thence South 72 Degrees 12 Minutes 50 Seconds East 36.9 feet
 thence South 70 Degrees 43 Minutes 22 Seconds East 25.4 feet
 thence South 73 Degrees 30 Minutes 20 Seconds East 14.7 feet
 thence South 70 Degrees 12 Minutes 26 Seconds East 35.3 feet
 thence South 69 Degrees 51 Minutes 53 Seconds East 46.9 feet
 thence South 71 Degrees 10 Minutes 00 Seconds East 41 feet
 thence South 70 Degrees 08 Minutes 28 Seconds East 23.8 feet
 thence South 65 Degrees 01 Minutes 08 Seconds East 46.8 feet
 thence South 57 Degrees 32 Minutes 33 Seconds East 46 feet
 thence South 52 Degrees 56 Minutes 30 Seconds East 43.8 feet
 thence South 56 Degrees 52 Minutes 02 Seconds East 45.2 feet
 thence South 66 Degrees 07 Minutes 03 Seconds East 46.4 feet
 thence South 72 Degrees 16 Minutes 29 Seconds East 46.6 feet
 thence South 73 Degrees 23 Minutes 58 Seconds East 55.2 feet
 thence South 73 Degrees 13 Minutes 27 Seconds East 53.5 feet
 thence South 73 Degrees 49 Minutes 21 Seconds East 55.4 feet
 thence South 71 Degrees 59 Minutes 44 Seconds East 57.4 feet
 thence South 74 Degrees 05 Minutes 40 Seconds East 54 feet
 thence South 74 Degrees 10 Minutes 57 Seconds East 51.9 feet
 thence South 71 Degrees 14 Minutes 53 Seconds East 46.2 feet
 thence South 72 Degrees 03 Minutes 50 Seconds East 34.5 feet
 thence South 71 Degrees 26 Minutes 52 Seconds East 66.9 feet
 thence South 70 Degrees 47 Minutes 25 Seconds East 86.3 feet
 thence South 70 Degrees 21 Minutes 48 Seconds East 81.7 feet
 thence South 70 Degrees 53 Minutes 12 Seconds East 76.9 feet
 thence South 70 Degrees 01 Minutes 12 Seconds East 79.4 feet
 thence South 68 Degrees 54 Minutes 16 Seconds East 73.7 feet
 thence South 68 Degrees 08 Minutes 24 Seconds East 63.4 feet
 thence South 66 Degrees 31 Minutes 55 Seconds East 45.5 feet
 thence South 70 Degrees 20 Minutes 37 Seconds East 34.6 feet
 thence South 68 Degrees 49 Minutes 31 Seconds East 23.3 feet

thence South 71 Degrees 04 Minutes 38 Seconds East 21.9 feet
 thence South 69 Degrees 07 Minutes 26 Seconds East 40.8 feet
 thence South 68 Degrees 31 Minutes 31 Seconds East 42.4 feet
 thence South 68 Degrees 51 Minutes 00 Seconds East 43 feet
 thence South 68 Degrees 03 Minutes 37 Seconds East 45 feet
 thence South 67 Degrees 20 Minutes 17 Seconds East 47 feet
 thence South 66 Degrees 26 Minutes 25 Seconds East 50.2 feet
 thence South 66 Degrees 47 Minutes 40 Seconds East 44.4 feet
 thence South 68 Degrees 08 Minutes 34 Seconds East 36.5 feet
 thence South 67 Degrees 47 Minutes 37 Seconds East 33.4 feet
 thence South 66 Degrees 28 Minutes 00 Seconds East 37.3 feet
 thence South 67 Degrees 55 Minutes 01 Seconds East 34.4 feet
 thence South 69 Degrees 57 Minutes 55 Seconds East 33.9 feet
 thence South 64 Degrees 40 Minutes 03 Seconds East 37.1 feet
 thence South 69 Degrees 19 Minutes 25 Seconds East 39.4 feet
 thence South 70 Degrees 13 Minutes 24 Seconds East 53.5 feet
 thence South 67 Degrees 23 Minutes 41 Seconds East 46.3 feet
 thence South 68 Degrees 17 Minutes 26 Seconds East 29.7 feet
 thence South 67 Degrees 00 Minutes 32 Seconds East 20.7 feet
 thence South 66 Degrees 04 Minutes 51 Seconds East 47.1 feet
 thence South 67 Degrees 53 Minutes 02 Seconds East 49 feet
 thence South 66 Degrees 02 Minutes 09 Seconds East 40.7 feet
 thence South 66 Degrees 56 Minutes 29 Seconds East 39.7 feet
 thence South 68 Degrees 58 Minutes 33 Seconds East 38.7 feet
 thence South 68 Degrees 20 Minutes 39 Seconds East 38.6 feet
 thence South 67 Degrees 42 Minutes 25 Seconds East 21.3 feet
 thence South 71 Degrees 25 Minutes 20 Seconds East 25.3 feet
 thence South 71 Degrees 16 Minutes 08 Seconds East 19.1 feet
 thence South 68 Degrees 45 Minutes 19 Seconds East 15.2 feet
 thence South 67 Degrees 20 Minutes 17 Seconds East 11.8 feet
 thence South 68 Degrees 36 Minutes 33 Seconds East 41.7 feet
 thence South 67 Degrees 54 Minutes 38 Seconds East 56.8 feet
 thence South 65 Degrees 15 Minutes 33 Seconds East 44.9 feet
 thence South 70 Degrees 35 Minutes 15 Seconds East 59.3 feet
 thence South 68 Degrees 23 Minutes 06 Seconds East 74.6 feet
 thence South 66 Degrees 47 Minutes 27 Seconds East 80.5 feet
 thence South 67 Degrees 43 Minutes 56 Seconds East 57.2 feet
 thence South 66 Degrees 59 Minutes 10 Seconds East 52.2 feet
 thence South 67 Degrees 27 Minutes 11 Seconds East 45.6 feet
 thence South 67 Degrees 10 Minutes 51 Seconds East 46.7 feet
 thence South 68 Degrees 52 Minutes 44 Seconds East 49.3 feet
 thence South 70 Degrees 45 Minutes 13 Seconds East 47 feet
 thence South 70 Degrees 12 Minutes 51 Seconds East 49.6 feet
 thence South 68 Degrees 39 Minutes 07 Seconds East 55.1 feet
 thence South 68 Degrees 31 Minutes 31 Seconds East 51.2 feet
 thence South 69 Degrees 44 Minutes 04 Seconds East 46.5 feet
 thence South 69 Degrees 44 Minutes 02 Seconds East 14.1 feet
 thence South 68 Degrees 50 Minutes 28 Seconds East 33.1 feet
 thence South 80 Degrees 51 Minutes 52 Seconds East 25.9 feet

thence South 86 Degrees 10 Minutes 01 Seconds East 54.3 feet
 thence South 88 Degrees 26 Minutes 56 Seconds East 60.1 feet
 thence South 88 Degrees 36 Minutes 30 Seconds East 65.6 feet
 thence South 89 Degrees 30 Minutes 43 Seconds East 69.2 feet
 thence North 89 Degrees 40 Minutes 23 Seconds East 78.4 feet
 thence South 89 Degrees 12 Minutes 28 Seconds East 84 feet
 thence South 88 Degrees 01 Minutes 37 Seconds East 81.8 feet
 thence North 89 Degrees 25 Minutes 10 Seconds East 74.1 feet
 thence South 89 Degrees 46 Minutes 04 Seconds East 67.3 feet
 thence South 88 Degrees 15 Minutes 37 Seconds East 63.7 feet
 thence South 88 Degrees 15 Minutes 24 Seconds East 54.5 feet
 thence North 89 Degrees 04 Minutes 01 Seconds East 62 feet
 thence South 89 Degrees 16 Minutes 32 Seconds East 71.5 feet
 thence North 89 Degrees 40 Minutes 23 Seconds East 63.6 feet
 thence South 89 Degrees 42 Minutes 26 Seconds East 60.7 feet
 thence South 87 Degrees 51 Minutes 50 Seconds East 61.1 feet
 thence South 89 Degrees 05 Minutes 17 Seconds East 60.7 feet
 thence South 89 Degrees 33 Minutes 10 Seconds East 43.2 feet
 thence South 89 Degrees 32 Minutes 59 Seconds East 5.3 feet
 thence South 88 Degrees 39 Minutes 30 Seconds East 33.8 feet
 thence South 89 Degrees 20 Minutes 50 Seconds East 76.8 feet
 thence North 89 Degrees 13 Minutes 32 Seconds East 84 feet
 thence South 88 Degrees 45 Minutes 52 Seconds East 72.2 feet
 thence North 89 Degrees 21 Minutes 30 Seconds East 59.7 feet
 thence North 87 Degrees 13 Minutes 24 Seconds East 61.4 feet
 thence South 86 Degrees 48 Minutes 46 Seconds East 74.9 feet
 thence South 86 Degrees 05 Minutes 58 Seconds East 75.7 feet
 thence South 89 Degrees 30 Minutes 15 Seconds East 68.6 feet
 thence South 89 Degrees 59 Minutes 43 Seconds East 56.8 feet
 thence South 89 Degrees 16 Minutes 49 Seconds East 71.9 feet
 thence North 89 Degrees 55 Minutes 20 Seconds East 75.5 feet
 thence South 89 Degrees 23 Minutes 15 Seconds East 80.1 feet
 thence South 89 Degrees 12 Minutes 28 Seconds East 84 feet
 thence South 88 Degrees 57 Minutes 26 Seconds East 82.4 feet
 thence South 88 Degrees 59 Minutes 12 Seconds East 56.1 feet
 thence South 87 Degrees 32 Minutes 02 Seconds East 40.4 feet
 thence South 86 Degrees 22 Minutes 53 Seconds East 28.6 feet
 thence South 88 Degrees 05 Minutes 34 Seconds East 92.6 feet
 thence South 88 Degrees 36 Minutes 35 Seconds East 120.5 feet
 thence South 89 Degrees 09 Minutes 39 Seconds East 112.9 feet
 thence South 88 Degrees 55 Minutes 46 Seconds East 107.6 feet
 thence South 89 Degrees 38 Minutes 33 Seconds East 109.9 feet
 thence South 89 Degrees 29 Minutes 11 Seconds East 111.9 feet
 thence South 88 Degrees 49 Minutes 25 Seconds East 112.6 feet
 thence South 88 Degrees 35 Minutes 27 Seconds East 108.3 feet
 thence South 89 Degrees 34 Minutes 39 Seconds East 100.4 feet
 thence South 89 Degrees 28 Minutes 06 Seconds East 87.6 feet
 thence North 89 Degrees 55 Minutes 48 Seconds East 73.2 feet
 thence South 89 Degrees 10 Minutes 09 Seconds East 65 feet

thence South 89 Degrees 31 Minutes 11 Seconds East 46.6 feet
thence South 88 Degrees 21 Minutes 54 Seconds East 47.9 feet
thence South 85 Degrees 57 Minutes 21 Seconds East 51.7 feet
thence South 85 Degrees 23 Minutes 58 Seconds East 19.1 feet more or less to **the ending**
point at: 38 degrees 29 minutes 6.7 seconds North Latitude and -113 degrees 04 minutes 29.36 seconds West
Longitude, which can be converted to mapping accuracy State Plane Utah South Zone NAD 83 feet
coordinates of X = 1,189,626.0 feet and Y = 10,508,484.4 feet.