

**Acknowledgment and
Notice of Acknowledgment
of Acceptance of R.S. 2477
Right-of-Way Grant**

Ent 235881 Bk 419 Pg 51
Date: 15-FEB-2008 10:29AM
Fee: None
Filed By: CP
BRUCE BROWN, Recorder
BEAVER COUNTY CORPORATION
For: GOVERNOR OF THE STATE OF UTAH

THE STATE OF UTAH

TO ALL WHOM THESE PRESENTS SHALL COME, Greeting:

Know ye, This is an Acknowledgment and Notice of Acknowledgment made under Utah Code Sections 72-5-309 through 310 inclusive, that the grant of the United States of America of “the right of way for the construction of highways over public lands, not reserved for public uses” under United States Revised Statutes 2477 (43 U.S.C. Section 932 (repealed October 21, 1976, with proviso recognizing the validity of rights-of-way already established)) was accepted for and on behalf of the State of Utah and its political subdivision Beaver County as it pertains to the highway located in Beaver County known as SHAG HOLLOW; County Road Number: B-82; State Geographic Information Database (SGID) Road Identification Number: RD010163. Total road length is 0.53 miles more or less.

The reason for this Acknowledgment and Notice of Acknowledgment includes, but is not limited to, the fact that the road was constructed, mechanically, or by continuous use as a public highway for a period of at least ten years, over public lands not reserved for public uses, prior to the earlier of (a) the October 21, 1976 repeal of R.S. 2477 or (b) the date the servient estate was reserved for public uses.

This Acknowledgment and Notice of Acknowledgment applies only to the segments of the road that traverse land owned by the Bureau of Land Management, United States Department of the Interior, and does not apply to segments of the road that traverse land owned by any other person or entity. The State of Utah and its political subdivisions reserve the right to make further acknowledgments and notices of acknowledgment with regard to road segments that traverse land owned by other entities, including the United States of America, through one or more of its agencies.

A printed copy of a map showing the location of the road in said county is appended hereto as “Attachment 1,” a printed copy of representative photos of the road is appended hereto as “Attachment 2,” a printed copy of a description of the beginning and ending points of the entire road together with a list of Townships, Ranges and Sections that may be traversed by the road in said county is appended hereto as “Attachment 3,” and a printed copy of the Road Centerline Description Cover Page(s) is appended hereto as “Attachment 4.” The Appendices listed in “Attachment 4” that contain the actual road centerline descriptions are incorporated herein by reference.

A printed copy of this Acknowledgment and Notice of Acknowledgment, together with its Attachments and Appendices, may be viewed and/or obtained at the office of the Utah State Archives.

An electronic copy of this Acknowledgment and Notice of Acknowledgment, together with its Attachments and Appendices, may be viewed and/or downloaded as read-only PDF (Portable Document Format) files via the

Internet at <http://recorded2477roads.utah.gov>.

The owner of the servient estate in the land underlying the road-segments subject to this Acknowledgment and Notice is believed to be the United States of America through one or more of its agencies. Any of such agencies or any other person with a servient ownership claim or a competing dominant estate right-of-way ownership claim, may file a petition in the State District Court for Salt Lake County for a decision regarding the correctness of this Acknowledgment. A claimant shall file a petition within sixty (60) days after receipt of this Notice.

In Witness Whereof, I, John Harja, the official designee of the Governor of the State of Utah, in conformity to the laws of the State (Utah Code Sections 72-5-308 through 310 inclusive), have caused this Acknowledgment and Notice of Acknowledgment to be made.

Signed by my hand in Salt Lake City, Utah, the 11th day of FEBRUARY, 2008.

By the Governor's Designee



John Harja

CERTIFICATION

State of Utah)
 : ss
County of Salt Lake)

I hereby certify that the signer of the foregoing document, John Harja, is personally known by me, has made a voluntary signature and taken an oath stating that he is the official designee of the Governor of the State of Utah and is authorized to sign this document on the Governor's behalf pursuant to Utah Code Section 72-5-309. He further vouched that, based upon information and belief, the facts alleged therein are true.

Dated this 11th day of February, 2008.

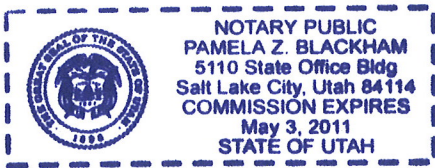



Notary Public

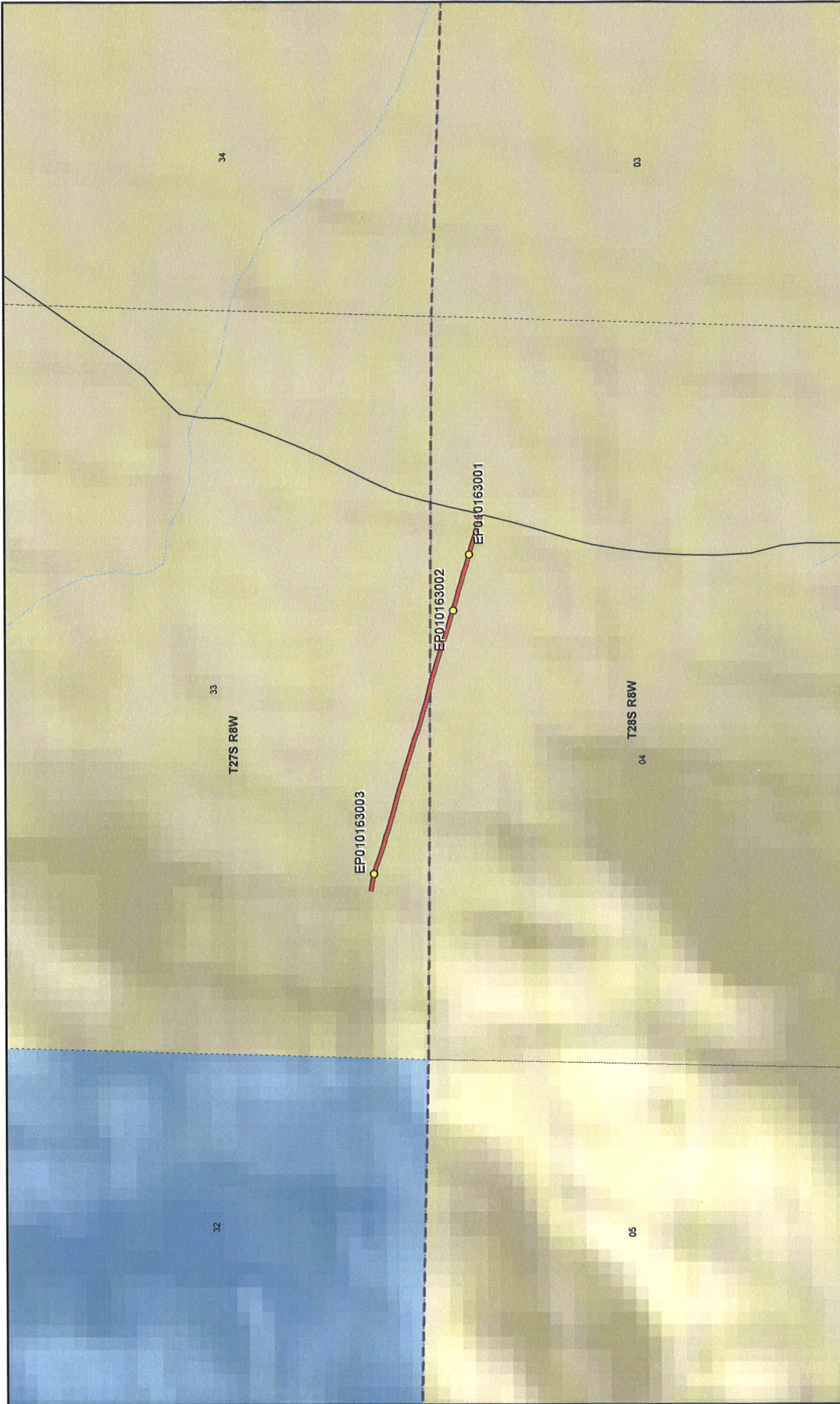



1:11,505
1 inch equals 0.2 miles

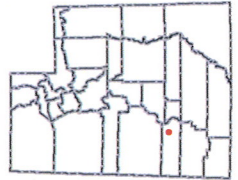

SHAG HOLLOW - Beaver County SGID RD_ID RD010163

Land Ownership Categories <ul style="list-style-type: none"> BLM Private SITLA, State Trust Land USFS, National Forest State Parks and Recreation Tribal, Indian Reservation NPS, National Park 	Transportation Network <ul style="list-style-type: none"> SHAG HOLLOW Other Roads Title V, Issued Or Under Consideration By BLM Or County Photo Event Point
--	---

Section = 1 Mile

Map prepared by the State of Utah
Automated Geographic Reference Center
Room 5130 State Office Building
Salt Lake City, Utah 84114
Jan 09, 2008



Attachment 2



EP010163001



EP010163002



EP010163003

EP000000000

EP000000000

EP000000000

SHAG HOLLOW - Beaver County
SGID RD_ID RD010163

Map prepared by the State of Utah
Automated Geographic Reference Center
Room 5130 State Office Building
Salt Lake City, Utah 84114
April 17, 2007



Attachment 3

Beginning & Ending Points and Township, Range, and Section References For:

Popular Name: SHAG HOLLOW

County: Beaver

County Road Number: B-82

State Geographic Information Database (SGID) Road Identification Number: RD010163.

Total Road Length: 0.53 miles more or less.

Beginning at a point on the road centerline located at 38 degrees 24 minutes 43.28 seconds North Latitude and -112 degrees 45 minutes 50.76 seconds West Longitude, which can be converted to mapping accuracy State Plane Utah South Zone NAD 83 feet coordinates of X = 1,278,203.4 feet and Y = 10,480,488.4 feet based on the US Survey Foot conversion.

Ending at a point on the road centerline located at 38 degrees 24 minutes 35.94 seconds North Latitude and -112 degrees 45 minutes 016.6 seconds West Longitude, which can be converted to mapping accuracy State Plane Utah South Zone NAD 83 feet coordinates of X = 1,280,912.2 feet and Y = 10,479,708.9 feet based on the US Survey Foot conversion.

This road may traverse:

Township 27 South Range 8 West, Section(s) 33, Salt Lake Base & Meridian
Township 28 South Range 8 West, Section(s) 4, Salt Lake Base & Meridian
See Attachment 1 above for a cartographic depiction of the course of this road.

Attachment 4
Road Centerline Description Cover Page(s)

Popular Name: SHAG HOLLOW

County: Beaver

County Road Number: B-82

State Geographic Information Database (SGID) Road Identification Number: RD010163.

Total Road Length: 0.53 miles more or less.

Centerline Descriptions Of Road-Segments That Cross Over Federally Owned Land, Derived From Global Positioning System Data And Cross-checked against USGS Digital Orthophoto Quadrangles Compiled By The Utah Automated Geographic Reference Center And Entered Into The State Geographic Information Database (SGID).

Road-Segments Listed by SGID Road Identification Number (RD_ID)	Road-Segment Numbers	Believed Ownership Of Servient Estate	Approximate Segment Length	See Attached Appendix
RD010163	001	BLM	0.53 Miles	A
		Total Road Length	0.53	_____

* Indicates that a Title V permit will be requested, is in process, or has been issued.

† Indicates that road-segments crossing Forest Service land are under consideration by the state and county as of the date of this Acknowledgment and Notice of Acknowledgment.

Appendix A to Attachment 4

Popular Name: SHAG HOLLOW

County: Beaver

County Road Number: B-82

State Geographic Information Database (SGID) Road Identification Number: RD010163.

Road-Segment Number: 001

Road-Segment Length: 0.53 miles more or less.

Believed owner of the land underlying this road-segment is: Bureau of Land Management.

The following description is based upon the geographic coordinate system using the NAD83 Datum. The source is GPS mapping grade data as indicated in the metadata and/or the transportation data model of the State of Utah Geographic Information Database (SGID).

The road-segment itself is the monument that is identified by its physical presence on the land. The location of said physical presence is closely approximated by mapping grade Global Positioning System (GPS) data. Said data are checked against the corresponding gray-scale 1-meter Digital Orthophoto Quadrangles published by the United States Geological Survey (USGS) to verify a reasonable degree of accuracy. In circumstances where accurate satellite signal acquisition is not possible, such as deep, narrow canyons or under a canopy of dense foliage, or where very sharp curves in the road make accuracy questionable, such portions of the road were digitized from the corresponding gray-scale 1-meter Digital Orthophoto Quadrangles published by the United States Geological Survey (USGS).

This road-segment may traverse:

Township 27 South Range 8 West, Section(s) 33, Salt Lake Base & Meridian

Township 28 South Range 8 West, Section(s) 4, Salt Lake Base & Meridian

The following description closely approximates the location of the centerline of the physical monument (SHAG HOLLOW)-- Segment 001 based on mapping grade Global Positioning System (GPS) data as defined above:

Beginning at a point on the road center line located at 38 degrees 24 minutes 43.28 seconds North Latitude and -112 degrees 45 minutes 50.76 seconds West Longitude, which can be converted to mapping accuracy State Plane Utah South Zone NAD 83 feet coordinates of X = 1,278,203.4 feet and Y = 10,480,488.4 feet; thence the following courses along the said road center line:

thence South 81 Degrees 52 Minutes 42 Seconds East 42.5 feet
thence South 78 Degrees 52 Minutes 20 Seconds East 52.9 feet
thence South 75 Degrees 09 Minutes 37 Seconds East 52.7 feet
thence South 75 Degrees 11 Minutes 09 Seconds East 41.5 feet
thence South 70 Degrees 49 Minutes 43 Seconds East 39.3 feet
thence South 70 Degrees 02 Minutes 46 Seconds East 54.9 feet
thence South 72 Degrees 04 Minutes 33 Seconds East 62.9 feet
thence South 73 Degrees 14 Minutes 29 Seconds East 61.4 feet
thence South 72 Degrees 17 Minutes 14 Seconds East 59.4 feet
thence South 74 Degrees 25 Minutes 13 Seconds East 58.7 feet
thence South 75 Degrees 24 Minutes 41 Seconds East 57.4 feet

thence South 75 Degrees 59 Minutes 56 Seconds East 47.7 feet
 thence South 75 Degrees 57 Minutes 25 Seconds East 55.5 feet
 thence South 74 Degrees 41 Minutes 58 Seconds East 71.9 feet
 thence South 72 Degrees 44 Minutes 30 Seconds East 69.5 feet
 thence South 73 Degrees 42 Minutes 18 Seconds East 65.4 feet
 thence South 73 Degrees 01 Minutes 16 Seconds East 62.9 feet
 thence South 73 Degrees 47 Minutes 12 Seconds East 65.7 feet
 thence South 73 Degrees 45 Minutes 26 Seconds East 66.8 feet
 thence South 71 Degrees 36 Minutes 02 Seconds East 62.4 feet
 thence South 71 Degrees 41 Minutes 49 Seconds East 62.7 feet
 thence South 72 Degrees 41 Minutes 46 Seconds East 66.1 feet
 thence South 73 Degrees 29 Minutes 39 Seconds East 70.3 feet
 thence South 74 Degrees 29 Minutes 21 Seconds East 68.6 feet
 thence South 75 Degrees 19 Minutes 54 Seconds East 62.2 feet
 thence South 76 Degrees 33 Minutes 13 Seconds East 51 feet
 thence South 75 Degrees 34 Minutes 41 Seconds East 6.4 feet
 thence South 74 Degrees 53 Minutes 58 Seconds East 59.2 feet
 thence South 74 Degrees 25 Minutes 13 Seconds East 58.7 feet
 thence South 74 Degrees 19 Minutes 48 Seconds East 56 feet
 thence South 73 Degrees 06 Minutes 54 Seconds East 53.2 feet
 thence South 73 Degrees 07 Minutes 55 Seconds East 47.7 feet
 thence South 72 Degrees 27 Minutes 24 Seconds East 41.7 feet
 thence South 72 Degrees 53 Minutes 02 Seconds East 53.7 feet
 thence South 74 Degrees 02 Minutes 22 Seconds East 69.1 feet
 thence South 72 Degrees 38 Minutes 54 Seconds East 70.3 feet
 thence South 72 Degrees 38 Minutes 54 Seconds East 70.3 feet
 thence South 74 Degrees 31 Minutes 45 Seconds East 67.5 feet
 thence South 74 Degrees 44 Minutes 07 Seconds East 64.7 feet
 thence South 74 Degrees 15 Minutes 10 Seconds East 62.8 feet
 thence South 73 Degrees 13 Minutes 08 Seconds East 62.5 feet
 thence South 73 Degrees 47 Minutes 45 Seconds East 62.3 feet
 thence South 74 Degrees 27 Minutes 44 Seconds East 60 feet
 thence South 74 Degrees 02 Minutes 52 Seconds East 55 feet
 thence South 74 Degrees 16 Minutes 21 Seconds East 49.8 feet
 thence South 71 Degrees 22 Minutes 30 Seconds East 46.5 feet
 thence South 72 Degrees 46 Minutes 33 Seconds East 46.8 feet
 thence South 72 Degrees 25 Minutes 01 Seconds East 67.2 feet
 thence South 78 Degrees 35 Minutes 18 Seconds East 43.6 feet
 thence South 78 Degrees 43 Minutes 46 Seconds East 13.1 feet more or less to **the ending**

point at: 38 degrees 24 minutes 35.94 seconds North Latitude and -112 degrees 45 minutes 016.6 seconds West Longitude, which can be converted to mapping accuracy State Plane Utah South Zone NAD 83 feet coordinates of X = 1,280,912.2 feet and Y = 10,479,708.9 feet.