

**Amended Acknowledgment and
Amended Notice of Acknowledgment
of Acceptance of R.S. 2477
Right-of-Way Grant**

Ent 235892 Bk 419 Pg 117
Date: 15-FEB-2008 10:47AM
Fee: None
Filed By: CP
BRUCE BROWN, Recorder
BEAVER COUNTY CORPORATION
For: GOVERNOR OF THE STATE OF UTAH

THE STATE OF UTAH

TO ALL WHOM THESE PRESENTS SHALL COME, Greeting:

Know ye, This is an Amended Acknowledgment and Amended Notice of Acknowledgment made under Utah Code Sections 72-5-309 through 310 inclusive, that the grant of the United States of America of “the right of way for the construction of highways over public lands, not reserved for public uses” under United States Revised Statutes 2477 (43 U.S.C. Section 932 (repealed October 21, 1976, with proviso recognizing the validity of rights-of-way already established)) was accepted for and on behalf of the State of Utah and its political subdivision Beaver County as it pertains to the highway located in Beaver County known as CORRAL CANYON WASH ROAD; County Road Number: B-95; State Geographic Information Database (SGID) Road Identification Number: RD010174. Total road length is 0.63 miles more or less.

This Amended Acknowledgment and Amended Notice of Acknowledgment supersedes the information contained in the Acknowledgment recorded at Ent 232949, Bk 409, Beg Pg 375.

The reason for this Amended Acknowledgment and Amended Notice of Acknowledgment includes, but is not limited to, the fact that the road was constructed, mechanically, or by continuous use as a public highway for a period of at least ten years, over public lands not reserved for public uses, prior to the earlier of (a) the October 21, 1976 repeal of R.S. 2477 or (b) the date the servient estate was reserved for public uses.

This Amended Acknowledgment and Amended Notice of Acknowledgment applies only to the segments of the road that traverse land owned by the Bureau of Land Management, United States Department of the Interior, and does not apply to segments of the road that traverse land owned by any other person or entity. The State of Utah and its political subdivisions reserve the right to make further acknowledgments and notices of acknowledgment with regard to road segments that traverse land owned by other entities, including the United States of America, through one or more of its agencies.

A printed copy of a map showing the location of the road in said county is appended hereto as “Attachment 1,” a printed copy of representative photos of the road is appended hereto as “Attachment 2,” a printed copy of a description of the beginning and ending points of the entire road together with a list of Townships, Ranges and Sections that may be traversed by the road in said county is appended hereto as “Attachment 3,” and a printed copy of the Road Centerline Description Cover Page(s) is appended hereto as “Attachment 4.” The Appendices listed in “Attachment 4” that contain the actual road centerline descriptions are incorporated herein by reference.

A printed copy of this Amended Acknowledgment and Amended Notice of Acknowledgment, together with its Attachments and Appendices, may be viewed and/or obtained at the office of the Utah State Archives.

An electronic copy of this Amended Acknowledgment and Amended Notice of Acknowledgment, together with its Attachments and Appendices, may be viewed and/or downloaded as read-only PDF (Portable Document Format) files via the Internet at <http://recorded2477roads.utah.gov>.

The owner of the servient estate in the land underlying the road-segments subject to this Amended Acknowledgment and Amended Notice is believed to be the United States of America through one or more of its agencies. Any of such agencies or any other person with a servient ownership claim or a competing dominant estate right-of-way ownership claim, may file a petition in the State District Court for Salt Lake County for a decision regarding the correctness of this Amended Acknowledgment. A claimant shall file a petition within sixty (60) days after receipt of this Notice.

In Witness Whereof, I, John Harja, the official designee of the Governor of the State of Utah, in conformity to the laws of the State (Utah Code Sections 72-5-308 through 310 inclusive), have caused this Amended Acknowledgment and Amended Notice of Acknowledgment to be made.

Signed by my hand in Salt Lake City, Utah, the 15th day of January, 2008.

By the Governor's Designee



John Harja

CERTIFICATION

State of Utah)
 : ss
County of Salt Lake)

I hereby certify that the signer of the foregoing document, John Harja, is personally known by me, has made a voluntary signature and taken an oath stating that he is the official designee of the Governor of the State of Utah and is authorized to sign this document on the Governor's behalf pursuant to Utah Code Section 72-5-309. He further vouched that, based upon information and belief, the facts alleged therein are true.

Dated this 15 day of Jan, 2008.



Notary Public

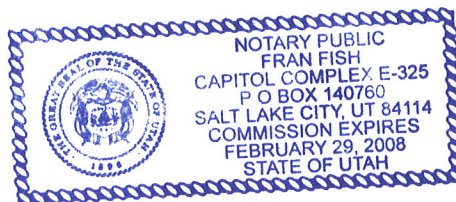

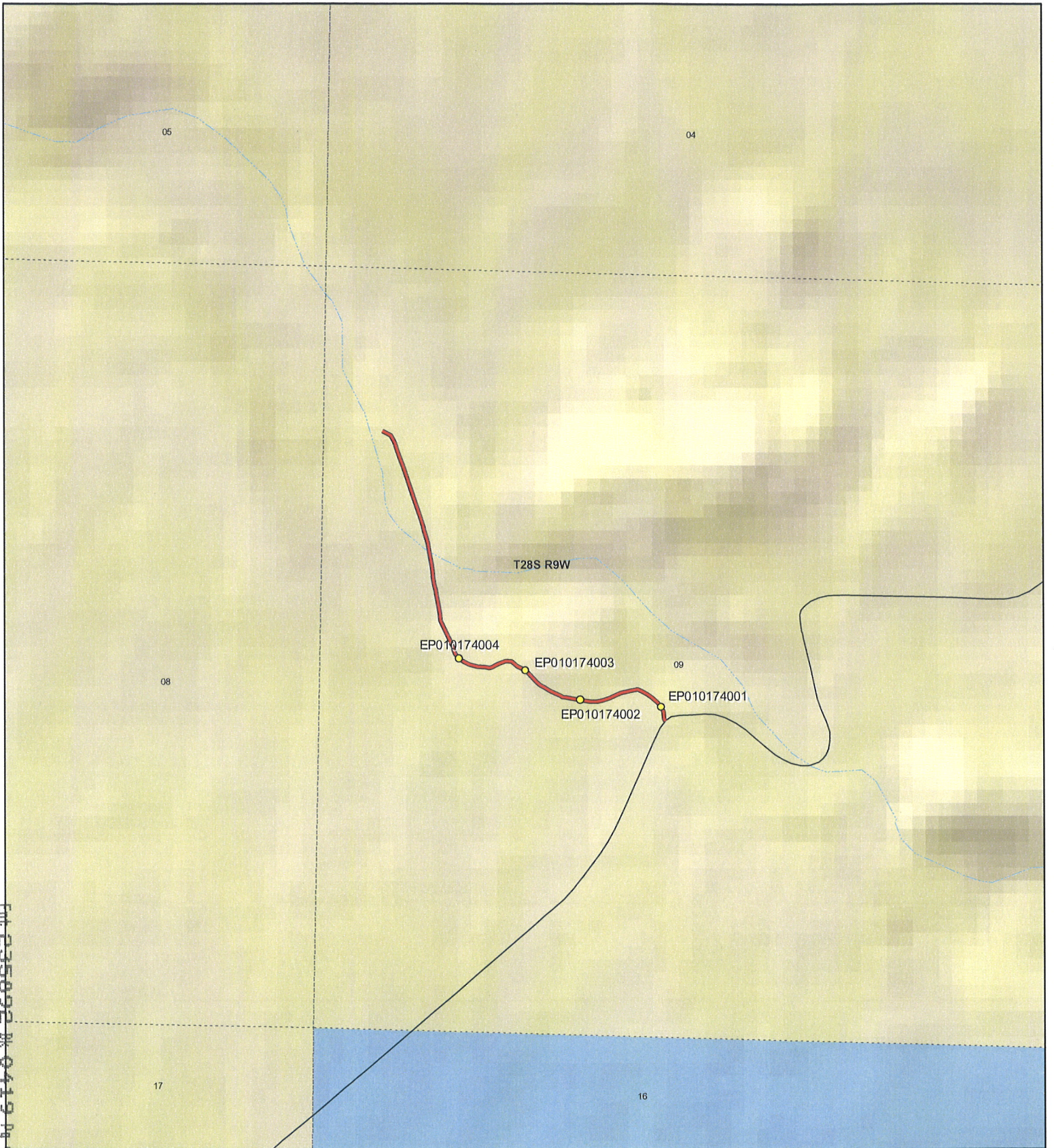

E:\235092\0419\0119



1:10,799

1 inch equals 0.2 miles

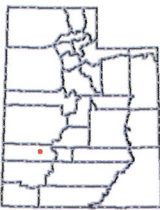

CORRAL CANYON WASH - Beaver County
SGID RD_ID RD010174

Land Ownership Categories

- | | |
|----------------------------|------------------------------|
| BLM | Wilderness |
| Private | UDWR Wildlife Reserve |
| SITLA, State Trust Land | DOD, Military |
| USFS, National Forest | State Sovereign Land |
| State Parks and Recreation | National Recreation Area |
| Tribal, Indian Reservation | USFWS, Natl. Wildlife Refuge |
| NPS, National Park | |

Transportation Network

- | |
|---------------------------------------------------------|
| CORRAL CANYON WASH |
| Title V: Issued Or Under Consideration By BLM Or County |
| Other Roads |
| Photo Event Point |
| Section = 1 Mile |

Map prepared by the State of Utah
 Automated Geographic Reference Center
 Room 5130 State Office Building
 Salt Lake City, Utah 84114
 May 16, 2007



Attachment 2



EP010174001



EP010174002



EP010174003



EP010174004

EP000000000

EP000000000

CORRAL CANYON WASH - Beaver County
SGID RD_ID RD010174

Map prepared by the State of Utah
Automated Geographic Reference Center
Room 5130 State Office Building
Salt Lake City, Utah 84114
April 17, 2007



Attachment 3

Beginning & Ending Points and Township, Range, and Section References For:

Popular Name: CORRAL CANYON WASH ROAD

County: Beaver

County Road Number: B-95

State Geographic Information Database (SGID) Road Identification Number: RD010174.

Total Road Length: 0.63 miles more or less.

Beginning at a point on the road centerline located at 38 degrees 23 minutes 16.68 seconds North Latitude and -112 degrees 52 minutes 16.02 seconds West Longitude, which can be converted to mapping accuracy State Plane Utah South Zone NAD 83 feet coordinates of X = 1,247,412.7 feet and Y = 10,472,160.6 feet based on the US Survey Foot conversion.

Ending at a point on the road centerline located at 38 degrees 23 minutes 36.08 seconds North Latitude and -112 degrees 52 minutes 41.02 seconds West Longitude, which can be converted to mapping accuracy State Plane Utah South Zone NAD 83 feet coordinates of X = 1,245,451.2 feet and Y = 10,474,151.4 feet based on the US Survey Foot conversion.

This road may traverse:

Township 28 South Range 9 West, Section(s) 9, Salt Lake Base & Meridian
See Attachment 1 above for a cartographic depiction of the course of this road.

**Attachment 4
Road Centerline Description Cover Page(s)**

Popular Name: CORRAL CANYON WASH ROAD

County: Beaver

County Road Number: B-95

State Geographic Information Database (SGID) Road Identification Number: RD010174.

Total Road Length: 0.63 miles more or less.

Centerline Descriptions Of Road-Segments That Cross Over Federally Owned Land, Derived From Global Positioning System Data And Cross-checked against USGS Digital Orthophoto Quadrangles Compiled By The Utah Automated Geographic Reference Center And Entered Into The State Geographic Information Database (SGID).

Road-Segments Listed by SGID Road Identification Number (RD_ID)	Road-Segment Numbers	Believed Ownership Of Servient Estate	Approximate Segment Length	See Attached Appendix
RD010174	001	BLM	0.63 Miles	A
		Total Road Length	0.63	_____

* Indicates that a Title V permit will be requested, is in process, or has been issued.

† Indicates that road-segments crossing Forest Service land are under consideration by the state and county as of the date of this Amended Acknowledgment and Amended Notice of Acknowledgment.

Appendix A to Attachment 4

Popular Name: CORRAL CANYON WASH ROAD

County: Beaver

County Road Number: B-95

State Geographic Information Database (SGID) Road Identification Number: RD010174.

Road-Segment Number: 001

Road-Segment Length: 0.63 miles more or less.

Believed owner of the land underlying this road-segment is: Bureau of Land Management.

The following description is based upon the geographic coordinate system using the NAD83 Datum. The source is GPS mapping grade data as indicated in the metadata and/or the transportation data model of the State of Utah Geographic Information Database (SGID).

The road-segment itself is the monument that is identified by its physical presence on the land. The location of said physical presence is closely approximated by mapping grade Global Positioning System (GPS) data. Said data are checked against the corresponding gray-scale 1-meter Digital Orthophoto Quadrangles published by the United States Geological Survey (USGS) to verify a reasonable degree of accuracy. In circumstances where accurate satellite signal acquisition is not possible, such as deep, narrow canyons or under a canopy of dense foliage, or where very sharp curves in the road make accuracy questionable, such portions of the road were digitized from the corresponding gray-scale 1-meter Digital Orthophoto Quadrangles published by the United States Geological Survey (USGS).

This road-segment may traverse:

Township 28 South Range 9 West, Section(s) 9, Salt Lake Base & Meridian

The following description closely approximates the location of the centerline of the physical monument (CORRAL CANYON WASH ROAD)-- Segment 001 based on mapping grade Global Positioning System (GPS) data as defined above:

Beginning at a point on the road center line located at 38 degrees 23 minutes 16.68 seconds North Latitude and -112 degrees 52 minutes 16.02 seconds West Longitude, which can be converted to mapping accuracy State Plane Utah South Zone NAD 83 feet coordinates of X = 1,247,412.7 feet and Y = 10,472,160.6 feet; thence the following courses along the said road center line:

thence North 42 Degrees 27 Minutes 34 Seconds West 9.3 feet
thence North 12 Degrees 25 Minutes 00 Seconds West 14.1 feet
thence North 04 Degrees 53 Minutes 45 Seconds West 41.1 feet
thence North 22 Degrees 58 Minutes 53 Seconds West 36.6 feet
thence North 40 Degrees 35 Minutes 04 Seconds West 42.1 feet
thence North 50 Degrees 33 Minutes 34 Seconds West 55.9 feet
thence North 55 Degrees 37 Minutes 37 Seconds West 36.3 feet
thence North 58 Degrees 44 Minutes 52 Seconds West 37 feet
thence North 69 Degrees 28 Minutes 03 Seconds West 36.9 feet
thence South 81 Degrees 37 Minutes 43 Seconds West 32.8 feet
thence South 75 Degrees 45 Minutes 11 Seconds West 40.9 feet

thence South 76 Degrees 18 Minutes 23 Seconds West 41.1 feet
thence South 71 Degrees 41 Minutes 05 Seconds West 40.4 feet
thence South 62 Degrees 56 Minutes 26 Seconds West 48.9 feet
thence South 69 Degrees 31 Minutes 45 Seconds West 48.6 feet
thence South 79 Degrees 46 Minutes 25 Seconds West 42 feet
thence South 89 Degrees 40 Minutes 40 Seconds West 42 feet
thence North 82 Degrees 59 Minutes 44 Seconds West 46.3 feet
thence North 81 Degrees 09 Minutes 35 Seconds West 30.9 feet
thence North 81 Degrees 34 Minutes 33 Seconds West 56.1 feet
thence North 79 Degrees 37 Minutes 47 Seconds West 47.7 feet
thence North 83 Degrees 44 Minutes 24 Seconds West 17.2 feet
thence North 56 Degrees 37 Minutes 55 Seconds West 15.4 feet
thence North 64 Degrees 54 Minutes 10 Seconds West 36.7 feet
thence North 63 Degrees 45 Minutes 25 Seconds West 47.7 feet
thence North 60 Degrees 31 Minutes 02 Seconds West 38.9 feet
thence North 59 Degrees 55 Minutes 44 Seconds West 39.6 feet
thence North 48 Degrees 53 Minutes 54 Seconds West 29.8 feet
thence North 43 Degrees 14 Minutes 41 Seconds West 44.8 feet
thence North 44 Degrees 30 Minutes 27 Seconds West 49 feet
thence North 49 Degrees 57 Minutes 27 Seconds West 17.2 feet
thence North 60 Degrees 08 Minutes 55 Seconds West 16.3 feet
thence North 61 Degrees 56 Minutes 19 Seconds West 46.2 feet
thence North 52 Degrees 36 Minutes 51 Seconds West 49.4 feet
thence North 84 Degrees 27 Minutes 58 Seconds West 38.6 feet
thence South 72 Degrees 02 Minutes 59 Seconds West 36.8 feet
thence South 66 Degrees 55 Minutes 36 Seconds West 22.1 feet
thence South 60 Degrees 19 Minutes 12 Seconds West 18.1 feet
thence South 58 Degrees 50 Minutes 23 Seconds West 25.6 feet
thence South 77 Degrees 34 Minutes 59 Seconds West 23.5 feet
thence North 80 Degrees 08 Minutes 48 Seconds West 26 feet
thence North 85 Degrees 42 Minutes 21 Seconds West 53 feet
thence North 76 Degrees 21 Minutes 43 Seconds West 59.8 feet
thence North 64 Degrees 10 Minutes 31 Seconds West 40.2 feet
thence North 54 Degrees 08 Minutes 54 Seconds West 37.8 feet
thence North 46 Degrees 06 Minutes 25 Seconds West 16.9 feet
thence North 36 Degrees 38 Minutes 09 Seconds West 33.8 feet
thence North 20 Degrees 43 Minutes 55 Seconds West 45.2 feet
thence North 21 Degrees 12 Minutes 28 Seconds West 53.4 feet
thence North 28 Degrees 19 Minutes 52 Seconds West 69.9 feet
thence North 24 Degrees 06 Minutes 29 Seconds West 75.7 feet
thence North 08 Degrees 07 Minutes 52 Seconds West 58 feet
thence North 08 Degrees 56 Minutes 16 Seconds West 54.8 feet
thence North 11 Degrees 44 Minutes 57 Seconds West 62.9 feet
thence North 09 Degrees 37 Minutes 55 Seconds West 40.6 feet
thence North 12 Degrees 33 Minutes 52 Seconds West 35.6 feet
thence North 10 Degrees 45 Minutes 34 Seconds West 50.7 feet
thence North 05 Degrees 54 Minutes 17 Seconds West 43.8 feet
thence North 07 Degrees 17 Minutes 42 Seconds West 45.9 feet
thence North 08 Degrees 39 Minutes 58 Seconds West 49.7 feet

thence North 10 Degrees 29 Minutes 51 Seconds West 52 feet
thence North 10 Degrees 31 Minutes 59 Seconds West 53.7 feet
thence North 16 Degrees 10 Minutes 11 Seconds West 52.9 feet
thence North 17 Degrees 21 Minutes 36 Seconds West 42.6 feet
thence North 16 Degrees 07 Minutes 29 Seconds West 18.1 feet
thence North 20 Degrees 36 Minutes 17 Seconds West 16.1 feet
thence North 17 Degrees 33 Minutes 49 Seconds West 49.8 feet
thence North 18 Degrees 00 Minutes 07 Seconds West 55.1 feet
thence North 20 Degrees 28 Minutes 47 Seconds West 55.2 feet
thence North 19 Degrees 30 Minutes 04 Seconds West 55.9 feet
thence North 16 Degrees 26 Minutes 59 Seconds West 56.7 feet
thence North 18 Degrees 45 Minutes 26 Seconds West 57.1 feet
thence North 19 Degrees 54 Minutes 33 Seconds West 56.8 feet
thence North 19 Degrees 18 Minutes 10 Seconds West 54.5 feet
thence North 19 Degrees 25 Minutes 43 Seconds West 53.1 feet
thence North 21 Degrees 30 Minutes 58 Seconds West 51.7 feet
thence North 19 Degrees 19 Minutes 28 Seconds West 52.4 feet
thence North 27 Degrees 10 Minutes 49 Seconds West 57.4 feet
thence North 62 Degrees 08 Minutes 37 Seconds West 31.3 feet
thence North 65 Degrees 03 Minutes 33 Seconds West 32.3 feet more or less to **the ending**

point at: 38 degrees 23 minutes 36.08 seconds North Latitude and -112 degrees 52 minutes 41.02 seconds West Longitude, which can be converted to mapping accuracy State Plane Utah South Zone NAD 83 feet coordinates of X = 1,245,451.2 feet and Y = 10,474,151.4 feet.