

**Acknowledgment and  
Notice of Acknowledgment  
of Acceptance of R.S. 2477  
Right-of-Way Grant**

Ent 232898 Bk 409 Pg 61  
Date: 27-JUN-2007 3:07PM  
Fee: None  
Filed By: CP  
BRUCE BROWN, Recorder  
BEAVER COUNTY CORPORATION  
For: STATE OF UTAH

**THE STATE OF UTAH**

**TO ALL WHOM THESE PRESENTS SHALL COME, Greeting:**

**Know ye,** This is an Acknowledgment and Notice of Acknowledgment made under Utah Code § 72-5-309 through 310 inclusive that the grant of the United States of America of “the right of way for the construction of highways over public lands, not reserved for public uses” under United States Revised Statutes 2477 (43 U.S.C. § 932 (repealed October 21, 1976, with proviso recognizing the validity of rights-of-way already established)) was accepted for and on behalf of the State of Utah and its political subdivision Beaver County as it pertains to the highway located in Beaver County known as TOPACHE PEAK ROAD; County Road Number: B-110; State Geographic Information Database (SGID) Road Identification Number: RD010017. Total road length is 2.61 miles more or less.

The reasons for this acknowledgment are as follows (indicated by an “X” in one or more blocks and any supplemental comment):

- The road was laid out or erected for public use over public lands not reserved for public uses prior to the earlier of (a) the October 21, 1976 repeal of R.S. 2477 or (b) the date the servient estate was reserved for public uses;
- By reason of its continuous use as a public highway over public lands not reserved for public uses for a period of at least ten years prior to the earlier of (a) the October 21, 1976 repeal of R.S. 2477 or (b) the date the servient estate was reserved for public uses;
- Other (explain).

A printed copy of a map showing the location of the road in said county is appended hereto as “Attachment 1.” A printed copy of photos of the road is appended hereto as “Attachment 2.” A printed copy of a description of the beginning and ending points of the entire road together with a list of Townships, Ranges and Sections that may be traversed by the road in said county is appended hereto as “Attachment 3.” A printed copy of the Road Centerline Description Cover Page(s) is appended hereto as “Attachment 4.” The Appendices referenced in “Attachment 4” that contain the actual road centerline descriptions are incorporated herein by reference.

A printed copy of this Acknowledgment and Notice of Acknowledgment, together with its Attachments and Appendices, may be viewed and/or obtained at the office of the Utah State Archives.

An electronic copy of this Acknowledgment and Notice of Acknowledgment, together with its Attachments and Appendices referenced in the Attachments, may be viewed and/or downloaded as read-only PDF (Portable

Document Format) files via the Internet at <http://recorded2477roads.utah.gov>.

The owner of the servient estate in the land underlying the road-segments subject to this Acknowledgment and Notice is believed to be the United States of America through one or more of its agencies. Any of such agencies or any other person with a servient ownership claim or a competing dominant estate right-of-way ownership claim, may file a petition in the State District Court for Salt Lake County for a decision regarding the correctness of this Acknowledgment. A claimant shall file a petition within sixty (60) days after receipt of this Notice.

**In Witness Whereof**, I, Lynn H. Stevens, the official designee of the Governor of the State of Utah, in conformity to the laws of the State (Utah Code Sections 72-5-308 through 310), have caused this Acknowledgment and Notice of Acknowledgment to be made and the Seal of the State of Utah to be hereunto affixed.

Signed and sealed under my hand in Salt Lake City, Utah, the 1 day of June, 2007.

By the Governor's Designee

  
\_\_\_\_\_  
Lynn H. Stevens

**CERTIFICATION**

State of Utah                    )  
  ) SS.  
County of Salt Lake         )

I, Pamela Z. Blackham, certify that the signer of this Acknowledgment and Notice of Acknowledgment of Acceptance of R.S. 2477 Right-of-way Grant, Lynn H. Stevens, is personally known by me, and he has made a voluntary signature and taken an oath or affirmation stating that he is the official designee of the Governor of the State of Utah and is authorized to sign this document on the Governor's behalf pursuant to Utah Code Section 72-5-309. He further vouched that, based upon information and belief, the facts alleged therein are true.

Dated this 1 day of June, 2007.

  
\_\_\_\_\_  
Pamela Z. Blackham, Notary Public  
Residing at Salt Lake City, Utah

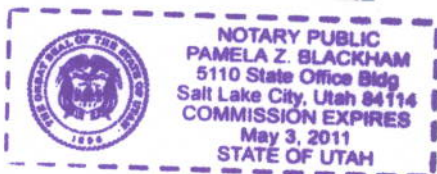

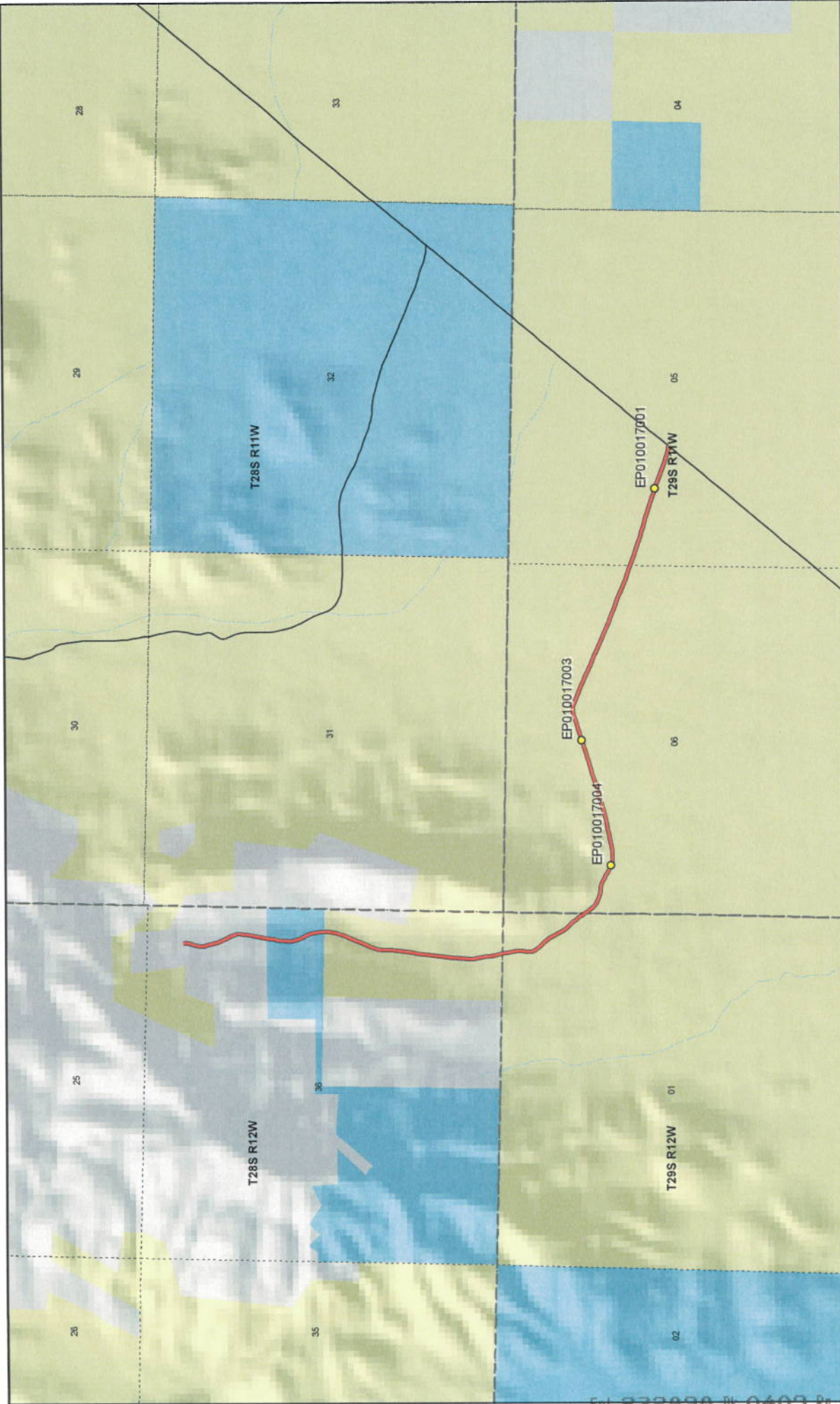



1:23,914  
1 inch equals 0.4 miles



### TOPACHE PEAK ROAD - Beaver County SGID RD\_ID RD010017

<b>Land Ownership Categories</b> <ul style="list-style-type: none"> <li>BLM</li> <li>Private</li> <li>SITLA, State Trust Land</li> <li>USFS, National Forest</li> <li>State Parks and Recreation</li> <li>Tribal, Indian Reservation</li> <li>NPS, National Park</li> </ul>	<b>Wilderness</b> <ul style="list-style-type: none"> <li>UDWR Wildlife Reserve</li> <li>DOD, Military</li> <li>State Sovereign Land</li> <li>National Recreation Area</li> <li>USFWS, Natl. Wildlife Refuge</li> </ul>	<b>Transportation Network</b> <ul style="list-style-type: none"> <li>TOPACHE PEAK ROAD</li> <li>Other Roads</li> <li>Title V, Issued Or Under Consideration By BLM Or County</li> <li>Photo Event Point</li> </ul>
--	---	---

Section = 1 Mile

Map prepared by the State of Utah  
Automated Geographic Reference Center  
Room 9130 State Office Building  
Salt Lake City, Utah 84114  
May 14, 2007



Ent 232898 Bk 0409 Pg 0063

Attachment 2



EP010017001



EP010017003



EP010017004

EP000000000

EP000000000

EP000000000

**TOPACHE PEAK ROAD - Beaver County**  
**SGID RD\_ID RD010017**

Map prepared by the State of Utah  
Automated Geographic Reference Center  
Room 5130 State Office Building  
Salt Lake City, Utah 84114  
April 17, 2007



### Attachment 3

#### Beginning & Ending Points and Township, Range, and Section References For:

**Popular Name: TOPACHE PEAK ROAD**

**County: Beaver**

**County Road Number: B-110**

**State Geographic Information Database (SGID) Road Identification Number: RD010017.**

**Total Road Length: 2.61 miles more or less.**

**Beginning at a point** on the road centerline located at 38 degrees 20 minutes 13.86 seconds North Latitude and -113 degrees 08 minutes 029.6 seconds West Longitude, which can be converted to mapping accuracy State Plane Utah South Zone NAD 83 feet coordinates of X = 1,169,579.1 feet and Y = 10,454,917.3 feet based on the US Survey Foot conversion.

**Ending at a point** on the road centerline located at 38 degrees 19 minutes 03.46 seconds North Latitude and -113 degrees 06 minutes 54.58 seconds West Longitude, which can be converted to mapping accuracy State Plane Utah South Zone NAD 83 feet coordinates of X = 1,177,026.0 feet and Y = 10,447,664.7 feet based on the US Survey Foot conversion.

This road may traverse:

Township 28 South Range 12 West, Section(s) 36, Salt Lake Base & Meridian  
Township 29 South Range 11 West, Section(s) 5,6, Salt Lake Base & Meridian  
Township 29 South Range 12 West, Section(s) 1, Salt Lake Base & Meridian  
See Attachment 1 above for a cartographic depiction of the course of this road.

**Attachment 4  
Road Centerline Description Cover Page(s)**

**Popular Name: TOPACHE PEAK ROAD**

**County: Beaver**

**County Road Number: B-110**

**State Geographic Information Database (SGID) Road Identification Number: RD010017.**

**Total Road Length: 2.61 miles more or less.**

**Centerline Descriptions Of Road-Segments That Cross Over Federally Owned Land, Derived From Global Positioning System Data And Cross-checked against USGS Digital Orthophoto Quadrangles Compiled By The Utah Automated Geographic Reference Center And Entered Into The State Geographic Information Database (SGID).**

<b>Road-Segments Listed by SGID Road Identification Number (RD ID)</b>	<b>Road-Segment Numbers</b>	<b>Believed Ownership Of Servient Estate</b>	<b>Approximate Segment Length</b>	<b>See Attached Appendix</b>
<b>RD010017</b>	<b>001</b>	<b>PVT</b>	<b>0.24 Miles</b>	<b>(not shown)</b>
<b>RD010017</b>	<b>002</b>	<b>ST</b>	<b>0.17 Miles</b>	<b>(not shown)</b>
<b>RD010017</b>	<b>003</b>	<b>BLM</b>	<b>2.2 Miles</b>	<b>A</b>
		<b>Total Road Length</b>	<b>2.61</b>	<b>_____</b>

\* Indicates that a Title V permit will be requested, is in process, or has been issued.

† Indicates that road-segments crossing Forest Service land are under consideration by the state and county as of the date of this Acknowledgment and Notice of Acknowledgment.