

**Acknowledgment and
Notice of Acknowledgment
of Acceptance of R.S. 2477
Right-of-Way Grant**

Ent 232852 Bk 408 Pg 660
Date: 27-JUN-2007 2:17PM
Fee: None
Filed By: CP
BRUCE BROWN, Recorder
BEAVER COUNTY CORPORATION
For: STATE OF UTAH

THE STATE OF UTAH

TO ALL WHOM THESE PRESENTS SHALL COME, Greeting:

Know ye, This is an Acknowledgment and Notice of Acknowledgment made under Utah Code § 72-5-309 through 310 inclusive that the grant of the United States of America of “the right of way for the construction of highways over public lands, not reserved for public uses” under United States Revised Statutes 2477 (43 U.S.C. § 932 (repealed October 21, 1976, with proviso recognizing the validity of rights-of-way already established)) was accepted for and on behalf of the State of Utah and its political subdivision Beaver County as it pertains to the highway located in Beaver County known as NORTH WAH WAH ROAD; County Road Number: B-13; State Geographic Information Database (SGID) Road Identification Number: RD010030. Total road length is 11.52 miles more or less.

The reasons for this acknowledgment are as follows (indicated by an “X” in one or more blocks and any supplemental comment):

- The road was laid out or erected for public use over public lands not reserved for public uses prior to the earlier of (a) the October 21, 1976 repeal of R.S. 2477 or (b) the date the servient estate was reserved for public uses;
- By reason of its continuous use as a public highway over public lands not reserved for public uses for a period of at least ten years prior to the earlier of (a) the October 21, 1976 repeal of R.S. 2477 or (b) the date the servient estate was reserved for public uses;
- Other (explain).

A printed copy of a map showing the location of the road in said county is appended hereto as “Attachment 1.” A printed copy of photos of the road is appended hereto as “Attachment 2.” A printed copy of a description of the beginning and ending points of the entire road together with a list of Townships, Ranges and Sections that may be traversed by the road in said county is appended hereto as “Attachment 3.” A printed copy of the Road Centerline Description Cover Page(s) is appended hereto as “Attachment 4.” The Appendices referenced in “Attachment 4” that contain the actual road centerline descriptions are incorporated herein by reference.

A printed copy of this Acknowledgment and Notice of Acknowledgment, together with its Attachments and Appendices, may be viewed and/or obtained at the office of the Utah State Archives.

An electronic copy of this Acknowledgment and Notice of Acknowledgment, together with its Attachments and Appendices referenced in the Attachments, may be viewed and/or downloaded as read-only PDF (Portable

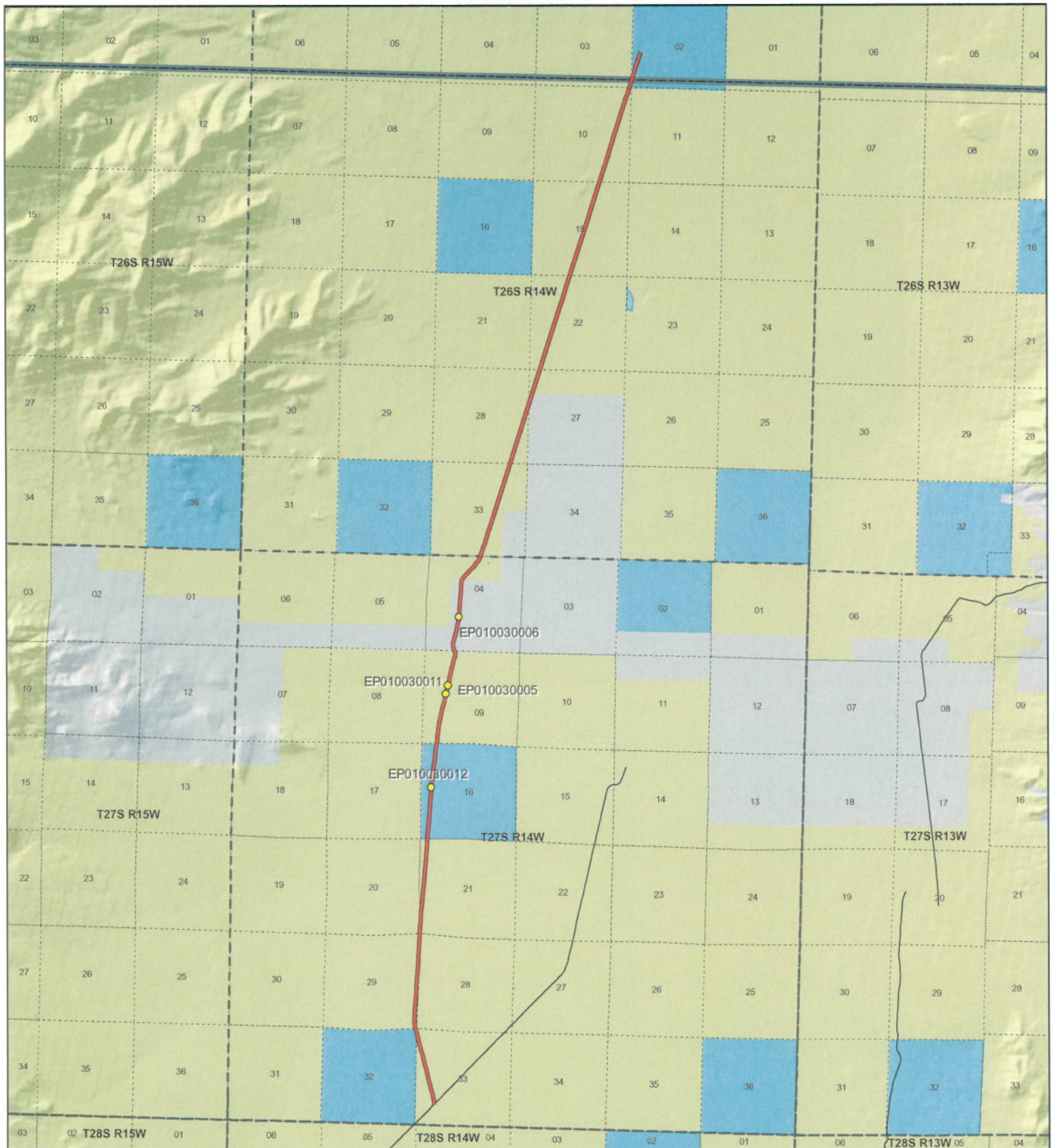

NORTH WAH WAH ROAD - Beaver County
SGID RD_ID RD010030

Land Ownership Categories

- BLM
- Private
- SITLA, State Trust Land
- USFS, National Forest
- State Parks and Recreation
- Tribal, Indian Reservation
- NPS, National Park
- Wilderness
- UDWR Wildlife Reserve
- DOD, Military
- State Sovereign Land
- National Recreation Area
- USFWS, Natl. Wildlife Refuge

Transportation Network

- NORTH WAH WAH ROAD
- Title V: Issued Or Under Consideration By BLM Or County
- Other Roads
- Photo Event Point
- Section = 1 Mile

Map prepared by the State of Utah
 Automated Geographic Reference Center
 Room 5130 State Office Building
 Salt Lake City, Utah 84114
 May 15, 2007



1:87,343
 1 inch equals 1.4 miles





EP010030005



EP010030006



EP010030011



EP010030012

EP000000000

EP000000000

NORTH WAH WAH ROAD - Beaver County
SGID RD_ID RD010030

Map prepared by the State of Utah
Automated Geographic Reference Center
Room 5130 State Office Building
Salt Lake City, Utah 84114
April 17, 2007



Attachment 3

Beginning & Ending Points and Township, Range, and Section References For:

Popular Name: NORTH WAH WAH ROAD

County: Beaver

County Road Number: B-13

State Geographic Information Database (SGID) Road Identification Number: RD010030.

Total Road Length: 11.52 miles more or less.

Beginning at a point on the road centerline located at 38 degrees 24 minutes 54.41 seconds North Latitude and -113 degrees 25 minutes 59.62 seconds West Longitude, which can be converted to mapping accuracy State Plane Utah South Zone NAD 83 feet coordinates of X = 1,086,518.3 feet and Y = 10,484,891.4 feet based on the US Survey Foot conversion.

Ending at a point on the road centerline located at 38 degrees 34 minutes 37.18 seconds North Latitude and -113 degrees 23 minutes 52.27 seconds West Longitude, which can be converted to mapping accuracy State Plane Utah South Zone NAD 83 feet coordinates of X = 1,097,848.9 feet and Y = 10,543,629.2 feet based on the US Survey Foot conversion.

This road may traverse:

Township 26 South Range 14 West, Section(s) 2,3,10,15,22,27,28,33, Salt Lake Base & Meridian
Township 27 South Range 14 West, Section(s) 4,9,16,21,28,29,33, Salt Lake Base & Meridian
See Attachment 1 above for a cartographic depiction of the course of this road.

Attachment 4
Road Centerline Description Cover Page(s)

Popular Name: NORTH WAH WAH ROAD

County: Beaver

County Road Number: B-13

State Geographic Information Database (SGID) Road Identification Number: RD010030.

Total Road Length: 11.52 miles more or less.

Centerline Descriptions Of Road-Segments That Cross Over Federally Owned Land, Derived From Global Positioning System Data And Cross-checked against USGS Digital Orthophoto Quadrangles Compiled By The Utah Automated Geographic Reference Center And Entered Into The State Geographic Information Database (SGID).

Road-Segments Listed by SGID Road Identification Number (RD ID)	Road-Segment Numbers	Believed Ownership Of Servient Estate	Approximate Segment Length	See Attached Appendix
RD010030	001	BLM	0.78 Miles	A
RD010030	002	ST	0.04 Miles	(not shown)
RD010030	003	BLM	2.01 Miles	B
RD010030	004	ST	1.02 Miles	(not shown)
RD010030	005	BLM	1.01 Miles	C
RD010030	006	PVT	0.76 Miles	(not shown)
RD010030	007	BLM	2 Miles	D
RD010030	008	PVT	0.12 Miles	(not shown)
RD010030	009		0 Miles	(not shown)
RD010030	010	BLM	3.46 Miles	E
		Total Road Length	11.52	_____

* Indicates that a Title V permit will be requested, is in process, or has been issued.

† Indicates that road-segments crossing Forest Service land are under consideration by the state and county as of the date of this Acknowledgment and Notice of Acknowledgment.