

**Acknowledgment and  
Notice of Acknowledgment  
of Acceptance of R.S. 2477  
Right-of-Way Grant**

Ent 232956 Bk 409 Pg 417  
Date: 28-JUN-2007 9:53AM  
Fee: None  
Filed By: CP  
BRUCE BROWN, Recorder  
BEAVER COUNTY CORPORATION  
or: STATE OF UTAH

**THE STATE OF UTAH**

**TO ALL WHOM THESE PRESENTS SHALL COME, Greeting:**

**Know ye,** This is an Acknowledgment and Notice of Acknowledgment made under Utah Code § 72-5-309 through 310 inclusive that the grant of the United States of America of “the right of way for the construction of highways over public lands, not reserved for public uses” under United States Revised Statutes 2477 (43 U.S.C. § 932 (repealed October 21, 1976, with proviso recognizing the validity of rights-of-way already established)) was accepted for and on behalf of the State of Utah and its political subdivision Beaver County as it pertains to the highway located in Beaver County known as DESERT RESEARCH ROAD; County Road Number: B-151; State Geographic Information Database (SGID) Road Identification Number: RD010053. Total road length is 1.51 miles more or less.

The reasons for this acknowledgment are as follows (indicated by an “X” in one or more blocks and any supplemental comment):

- The road was laid out or erected for public use over public lands not reserved for public uses prior to the earlier of (a) the October 21, 1976 repeal of R.S. 2477 or (b) the date the servient estate was reserved for public uses;
- By reason of its continuous use as a public highway over public lands not reserved for public uses for a period of at least ten years prior to the earlier of (a) the October 21, 1976 repeal of R.S. 2477 or (b) the date the servient estate was reserved for public uses;
- Other (explain).

A printed copy of a map showing the location of the road in said county is appended hereto as “Attachment 1.” A printed copy of photos of the road is appended hereto as “Attachment 2.” A printed copy of a description of the beginning and ending points of the entire road together with a list of Townships, Ranges and Sections that may be traversed by the road in said county is appended hereto as “Attachment 3.” A printed copy of the Road Centerline Description Cover Page(s) is appended hereto as “Attachment 4.” The Appendices referenced in “Attachment 4” that contain the actual road centerline descriptions are incorporated herein by reference.

A printed copy of this Acknowledgment and Notice of Acknowledgment, together with its Attachments and Appendices, may be viewed and/or obtained at the office of the Utah State Archives.

An electronic copy of this Acknowledgment and Notice of Acknowledgment, together with its Attachments and Appendices referenced in the Attachments, may be viewed and/or downloaded as read-only PDF (Portable

Document Format) files via the Internet at <http://recorded2477roads.utah.gov>.

The owner of the servient estate in the land underlying the road-segments subject to this Acknowledgment and Notice is believed to be the United States of America through one or more of its agencies. Any of such agencies or any other person with a servient ownership claim or a competing dominant estate right-of-way ownership claim, may file a petition in the State District Court for Salt Lake County for a decision regarding the correctness of this Acknowledgment. A claimant shall file a petition within sixty (60) days after receipt of this Notice.

**In Witness Whereof**, I, Lynn H. Stevens, the official designee of the Governor of the State of Utah, in conformity to the laws of the State (Utah Code Sections 72-5-308 through 310), have caused this Acknowledgment and Notice of Acknowledgment to be made and the Seal of the State of Utah to be hereunto affixed.

Signed and sealed under my hand in Salt Lake City, Utah, the 1 day of June, 2007.

By the Governor's Designee

*Lynn H. Stevens*

Lynn H. Stevens

**CERTIFICATION**

State of Utah                     )  
  ) SS.  
County of Salt Lake            )

I, Pamela Z. Blackham, certify that the signer of this Acknowledgment and Notice of Acknowledgment of Acceptance of R.S. 2477 Right-of-way Grant, Lynn H. Stevens, is personally known by me, and he has made a voluntary signature and taken an oath or affirmation stating that he is the official designee of the Governor of the State of Utah and is authorized to sign this document on the Governor's behalf pursuant to Utah Code Section 72-5-309. He further vouched that, based upon information and belief, the facts alleged therein are true.

Dated this 1 day of June, 2007.

*Pamela Z. Blackham*

Pamela Z. Blackham, Notary Public  
Residing at Salt Lake City, Utah

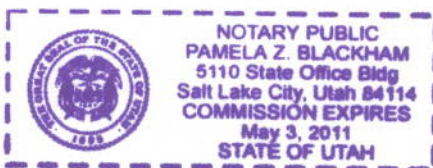

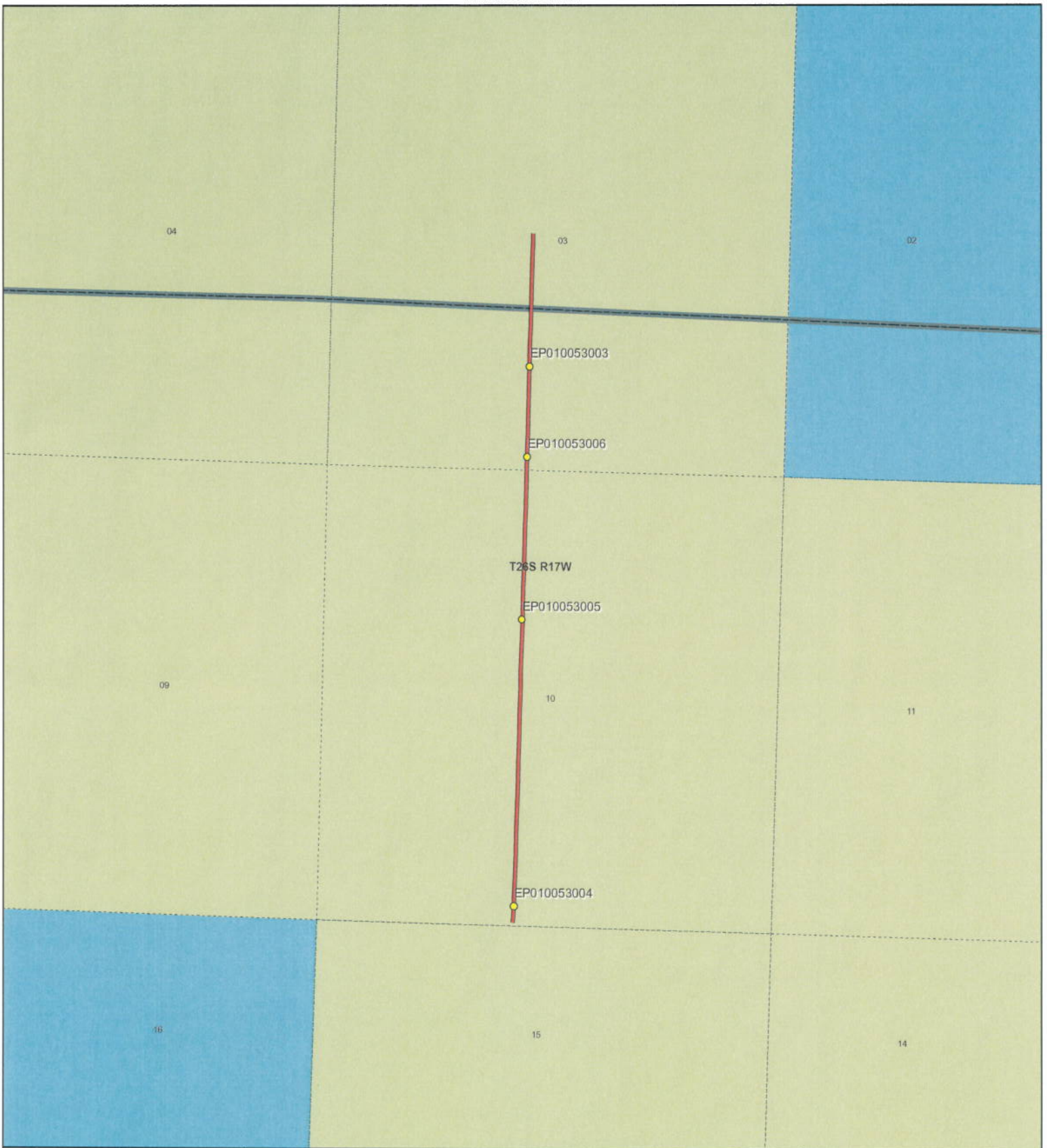

<p>1:18,078 1 inch equals 0.3 miles</p>		<p align="center"><b>DESERT RESEARCH ROAD- Beaver County</b> <b>SGID RD_ID RD010053</b></p> <table border="0"> <tr> <td colspan="2"><b>Land Ownership Categories</b></td> <td colspan="2"><b>Transportation Network</b></td> </tr> <tr> <td> BLM</td> <td> Wilderness</td> <td> DESERT RESEARCH ROAD</td> <td> Title V: Issued Or Under Consideration By BLM Or County</td> </tr> <tr> <td> Private</td> <td> UDWR Wildlife Reserve</td> <td> Other Roads</td> <td> Photo Event Point</td> </tr> <tr> <td> SITLA, State Trust Land</td> <td> DOD, Military</td> <td> Section = 1 Mile</td> <td></td> </tr> <tr> <td> USFS, National Forest</td> <td> State Sovereign Land</td> <td></td> <td></td> </tr> <tr> <td> State Parks and Recreation</td> <td> National Recreation Area</td> <td></td> <td></td> </tr> <tr> <td> Tribal, Indian Reservation</td> <td> USFWS, Natl. Wildlife Refuge</td> <td></td> <td></td> </tr> <tr> <td> NPS, National Park</td> <td></td> <td></td> <td></td> </tr> </table>	<b>Land Ownership Categories</b>		<b>Transportation Network</b>		BLM	Wilderness	DESERT RESEARCH ROAD	Title V: Issued Or Under Consideration By BLM Or County	Private	UDWR Wildlife Reserve	Other Roads	Photo Event Point	SITLA, State Trust Land	DOD, Military	Section = 1 Mile		USFS, National Forest	State Sovereign Land			State Parks and Recreation	National Recreation Area			Tribal, Indian Reservation	USFWS, Natl. Wildlife Refuge			NPS, National Park				<p>Map prepared by the State of Utah Automated Geographic Reference Center Room 5130 State Office Building Salt Lake City, Utah 84114 May 16, 2007</p>
<b>Land Ownership Categories</b>		<b>Transportation Network</b>																																	
BLM	Wilderness	DESERT RESEARCH ROAD	Title V: Issued Or Under Consideration By BLM Or County																																
Private	UDWR Wildlife Reserve	Other Roads	Photo Event Point																																
SITLA, State Trust Land	DOD, Military	Section = 1 Mile																																	
USFS, National Forest	State Sovereign Land																																		
State Parks and Recreation	National Recreation Area																																		
Tribal, Indian Reservation	USFWS, Natl. Wildlife Refuge																																		
NPS, National Park																																			



EP010053003



EP010053004



EP010053005



EP010053006

EP000000000

EP000000000

**DESERT RESEARCH ROAD - Beaver County**  
**SGID RD\_ID RD010053**

Map prepared by the State of Utah  
Automated Geographic Reference Center  
Room 5130 State Office Building  
Salt Lake City, Utah 84114  
April 17, 2007



## Attachment 3

### Beginning & Ending Points and Township, Range, and Section References For:

**Popular Name: DESERT RESEARCH ROAD**

**County: Beaver**

**County Road Number: B-151**

**State Geographic Information Database (SGID) Road Identification Number: RD010053.**

**Total Road Length: 1.51 miles more or less.**

**Beginning at a point** on the road centerline located at 38 degrees 33 minutes 16.29 seconds North Latitude and -113 degrees 44 minutes 30.91 seconds West Longitude, which can be converted to mapping accuracy State Plane Utah South Zone NAD 83 feet coordinates of X = 999,306.8 feet and Y = 10,537,624.8 feet based on the US Survey Foot conversion.

**Ending at a point** on the road centerline located at 38 degrees 34 minutes 35.21 seconds North Latitude and -113 degrees 44 minutes 30.72 seconds West Longitude, which can be converted to mapping accuracy State Plane Utah South Zone NAD 83 feet coordinates of X = 999,512.8 feet and Y = 10,545,606.4 feet based on the US Survey Foot conversion.

This road may traverse:

Township 26 South Range 17 West, Section(s) 3,10, Salt Lake Base & Meridian  
See Attachment 1 above for a cartographic depiction of the course of this road.

**Attachment 4  
Road Centerline Description Cover Page(s)**

**Popular Name: DESERT RESEARCH ROAD**

**County: Beaver**

**County Road Number: B-151**

**State Geographic Information Database (SGID) Road Identification Number: RD010053.**

**Total Road Length: 1.51 miles more or less.**

**Centerline Descriptions Of Road-Segments That Cross Over Federally Owned Land, Derived From Global Positioning System Data And Cross-checked against USGS Digital Orthophoto Quadrangles Compiled By The Utah Automated Geographic Reference Center And Entered Into The State Geographic Information Database (SGID).**

<b>Road-Segments Listed by SGID Road Identification Number (RD ID)</b>	<b>Road-Segment Numbers</b>	<b>Believed Ownership Of Servient Estate</b>	<b>Approximate Segment Length</b>	<b>See Attached Appendix</b>
<b>RD010053</b>	<b>001</b>	<b>BLM</b>	<b>1.51 Miles</b>	<b>A</b>
		<b>Total Road Length</b>	<b>1.51</b>	<b>_____</b>

\* Indicates that a Title V permit will be requested, is in process, or has been issued.

† Indicates that road-segments crossing Forest Service land are under consideration by the state and county as of the date of this Acknowledgment and Notice of Acknowledgment.