

**Acknowledgment and
Notice of Acknowledgment
of Acceptance of R.S. 2477
Right-of-Way Grant**

Ent 232890 Bk 409 Pg 13
Date: 27-JUN-2007 2:59PM
Fee: None
Filed By: CP
BRUCE BROWN, Recorder
BEAVER COUNTY CORPORATION
For: STATE OF UTAH

THE STATE OF UTAH

TO ALL WHOM THESE PRESENTS SHALL COME, Greeting:

Know ye, This is an Acknowledgment and Notice of Acknowledgment made under Utah Code § 72-5-309 through 310 inclusive that the grant of the United States of America of “the right of way for the construction of highways over public lands, not reserved for public uses” under United States Revised Statutes 2477 (43 U.S.C. § 932 (repealed October 21, 1976, with proviso recognizing the validity of rights-of-way already established)) was accepted for and on behalf of the State of Utah and its political subdivision Beaver County as it pertains to the highway located in Beaver County known as SOUTH SIDE ROAD; County Road Number: B-19; State Geographic Information Database (SGID) Road Identification Number: RD010071. Total road length is 18.56 miles more or less.

The reasons for this acknowledgment are as follows (indicated by an “X” in one or more blocks and any supplemental comment):

- The road was laid out or erected for public use over public lands not reserved for public uses prior to the earlier of (a) the October 21, 1976 repeal of R.S. 2477 or (b) the date the servient estate was reserved for public uses;
- By reason of its continuous use as a public highway over public lands not reserved for public uses for a period of at least ten years prior to the earlier of (a) the October 21, 1976 repeal of R.S. 2477 or (b) the date the servient estate was reserved for public uses;
- Other (explain).

A printed copy of a map showing the location of the road in said county is appended hereto as “Attachment 1.” A printed copy of photos of the road is appended hereto as “Attachment 2.” A printed copy of a description of the beginning and ending points of the entire road together with a list of Townships, Ranges and Sections that may be traversed by the road in said county is appended hereto as “Attachment 3.” A printed copy of the Road Centerline Description Cover Page(s) is appended hereto as “Attachment 4.” The Appendices referenced in “Attachment 4” that contain the actual road centerline descriptions are incorporated herein by reference.

A printed copy of this Acknowledgment and Notice of Acknowledgment, together with its Attachments and Appendices, may be viewed and/or obtained at the office of the Utah State Archives.

An electronic copy of this Acknowledgment and Notice of Acknowledgment, together with its Attachments and Appendices referenced in the Attachments, may be viewed and/or downloaded as read-only PDF (Portable

Document Format) files via the Internet at <http://recorded2477roads.utah.gov>.

The owner of the servient estate in the land underlying the road-segments subject to this Acknowledgment and Notice is believed to be the United States of America through one or more of its agencies. Any of such agencies or any other person with a servient ownership claim or a competing dominant estate right-of-way ownership claim, may file a petition in the State District Court for Salt Lake County for a decision regarding the correctness of this Acknowledgment. A claimant shall file a petition within sixty (60) days after receipt of this Notice.

In Witness Whereof, I, Lynn H. Stevens, the official designee of the Governor of the State of Utah, in conformity to the laws of the State (Utah Code Sections 72-5-308 through 310), have caused this Acknowledgment and Notice of Acknowledgment to be made and the Seal of the State of Utah to be hereunto affixed.

Signed and sealed under my hand in Salt Lake City, Utah, the 1 day of June, 2007.

By the Governor's Designee



Lynn H. Stevens

CERTIFICATION

State of Utah)
) SS.
County of Salt Lake)

I, Pamela Z. Blackham, certify that the signer of this Acknowledgment and Notice of Acknowledgment of Acceptance of R.S. 2477 Right-of-way Grant, Lynn H. Stevens, is personally known by me, and he has made a voluntary signature and taken an oath or affirmation stating that he is the official designee of the Governor of the State of Utah and is authorized to sign this document on the Governor's behalf pursuant to Utah Code Section 72-5-309. He further vouched that, based upon information and belief, the facts alleged therein are true.

Dated this 1 day of June, 2007.

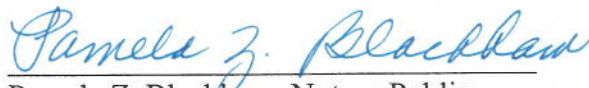

Pamela Z. Blackham, Notary Public
Residing at Salt Lake City, Utah

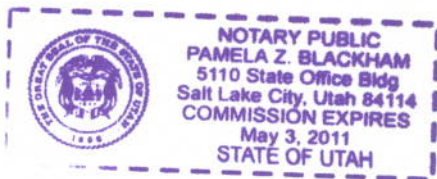

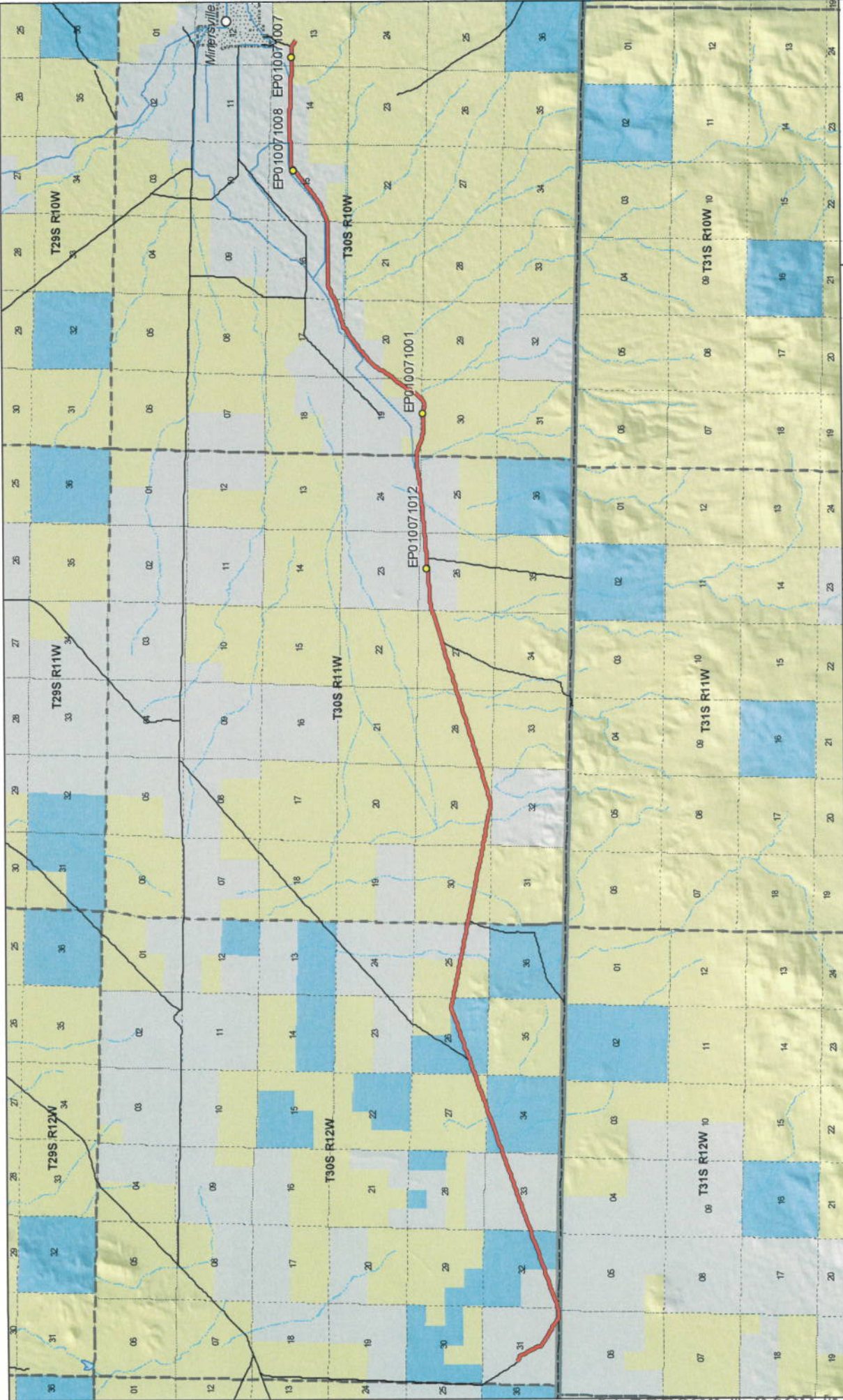

1:109,975
1 inch equals 1.7 miles

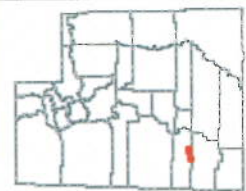

- Land Ownership Categories**
- BLM
 - Private
 - SITLA, State Trust Land
 - USFS, National Forest
 - State Parks and Recreation
 - Tribal, Indian Reservation
 - NPS, National Park
 - Wilderness
 - UDWR Wildlife Reserve
 - DOD, Military
 - State Sovereign Land
 - National Recreation Area
 - USFWS, Natl. Wildlife Refuge

- Transportation Network**
- SOUTH SIDE ROAD
 - Other Roads
 - Title V: Issued Or Under Consideration By BLM Or County
 - Photo Event Point
 - Section = 1 Mile

**SOUTH SIDE ROAD - Beaver County
SGID RD_ID RD010071**

Map prepared by the State of Utah
Automated Geographic Reference Center
Room 5100 State Office Building
Salt Lake City, Utah 84114
May 14, 2007



Ent 232890 BK 0409 Pg 0015

Attachment 2



EP010071001



EP010071007



EP010071008



EP010071012

EP000000000

EP000000000

SOUTH SIDE ROAD - Beaver County
SGID RD_ID RD010071

Map prepared by the State of Utah
Automated Geographic Reference Center
Room 5130 State Office Building
Salt Lake City, Utah 84114
April 17, 2007



Attachment 3

Beginning & Ending Points and Township, Range, and Section References For:

Popular Name: SOUTH SIDE ROAD

County: Beaver

County Road Number: B-19

State Geographic Information Database (SGID) Road Identification Number: RD010071.

Total Road Length: 18.56 miles more or less.

Beginning at a point on the road centerline located at 38 degrees 09 minutes 23.67 seconds North Latitude and -113 degrees 14 minutes 43.98 seconds West Longitude, which can be converted to mapping accuracy State Plane Utah South Zone NAD 83 feet coordinates of X = 1,138,527.0 feet and Y = 10,389,696.2 feet based on the US Survey Foot conversion.

Ending at a point on the road centerline located at 38 degrees 12 minutes 07.77 seconds North Latitude and -112 degrees 55 minutes 49.02 seconds West Longitude, which can be converted to mapping accuracy State Plane Utah South Zone NAD 83 feet coordinates of X = 1,229,420.2 feet and Y = 10,404,754.9 feet based on the US Survey Foot conversion.

This road may traverse:

Township 30 South Range 10 West, Section(s) 13,14,15,16,17,19,20,30, Salt Lake Base & Meridian

Township 30 South Range 11 West, Section(s) 24,25,26,27,28,29,30, Salt Lake Base & Meridian

Township 30 South Range 12 West, Section(s) 25,26,27,31,32,33,34, Salt Lake Base & Meridian

Township 31 South Range 12 West, Section(s) 6, Salt Lake Base & Meridian

See Attachment 1 above for a cartographic depiction of the course of this road.

Attachment 4
Road Centerline Description Cover Page(s)

Popular Name: SOUTH SIDE ROAD

County: Beaver

County Road Number: B-19

State Geographic Information Database (SGID) Road Identification Number: RD010071.

Total Road Length: 18.56 miles more or less.

Centerline Descriptions Of Road-Segments That Cross Over Federally Owned Land, Derived From Global Positioning System Data And Cross-checked against USGS Digital Orthophoto Quadrangles Compiled By The Utah Automated Geographic Reference Center And Entered Into The State Geographic Information Database (SGID).

Road-Segments Listed by SGID Road Identification Number (RD_ID)	Road-Segment Numbers	Believed Ownership Of Servient Estate	Approximate Segment Length	See Attached Appendix
RD010071	001	PVT	1.47 Miles	(not shown)
RD010071	002	ST	0.53 Miles	(not shown)
RD010071	003	PVT	1.08 Miles	(not shown)
RD010071	004	ST	0.62 Miles	(not shown)
RD010071	005	BLM	0.46 Miles	A
RD010071	006	ST	1.06 Miles	(not shown)
RD010071	007	BLM	0.51 Miles	B
RD010071	008	PVT	0.48 Miles	(not shown)
RD010071	009	BLM	4.22 Miles	C
RD010071	010	PVT	2.04 Miles	(not shown)
RD010071	011	BLM	0.77 Miles	D
RD010071	012	PVT	0.01 Miles	(not shown)
RD010071	013	BLM	0.6 Miles	E
RD010071	014	PVT	2.19 Miles	(not shown)
RD010071	015	BLM	0.03 Miles	F
RD010071	016	PVT	1.9 Miles	(not shown)
RD010071	017	BLM	0.6 Miles	G
		Total Road Length	18.56	_____

* Indicates that a Title V permit will be requested, is in process, or has been issued.

† Indicates that road-segments crossing Forest Service land are under consideration by the state and county as of the date of this Acknowledgment and Notice of Acknowledgment.