

**Acknowledgment and  
Notice of Acknowledgment  
of Acceptance of R.S. 2477  
Right-of-Way Grant**

Ent 232889 Bk 409 Pg 7  
Date: 27-JUN-2007 2:58PM  
Fee: None  
Filed By: CP  
BRUCE BROWN, Recorder  
BEAVER COUNTY CORPORATION  
For: STATE OF UTAH

**THE STATE OF UTAH**

**TO ALL WHOM THESE PRESENTS SHALL COME, Greeting:**

**Know ye,** This is an Acknowledgment and Notice of Acknowledgment made under Utah Code § 72-5-309 through 310 inclusive that the grant of the United States of America of “the right of way for the construction of highways over public lands, not reserved for public uses” under United States Revised Statutes 2477 (43 U.S.C. § 932 (repealed October 21, 1976, with proviso recognizing the validity of rights-of-way already established)) was accepted for and on behalf of the State of Utah and its political subdivision Beaver County as it pertains to the highway located in Beaver County known as SOUTH LAKE ACCESS II; County Road Number: B-88; State Geographic Information Database (SGID) Road Identification Number: RD010168. Total road length is 0.33 miles more or less.

The reasons for this acknowledgment are as follows (indicated by an “X” in one or more blocks and any supplemental comment):

- The road was laid out or erected for public use over public lands not reserved for public uses prior to the earlier of (a) the October 21, 1976 repeal of R.S. 2477 or (b) the date the servient estate was reserved for public uses;
- By reason of its continuous use as a public highway over public lands not reserved for public uses for a period of at least ten years prior to the earlier of (a) the October 21, 1976 repeal of R.S. 2477 or (b) the date the servient estate was reserved for public uses;
- Other (explain).

A printed copy of a map showing the location of the road in said county is appended hereto as “Attachment 1.” A printed copy of photos of the road is appended hereto as “Attachment 2.” A printed copy of a description of the beginning and ending points of the entire road together with a list of Townships, Ranges and Sections that may be traversed by the road in said county is appended hereto as “Attachment 3.” A printed copy of the Road Centerline Description Cover Page(s) is appended hereto as “Attachment 4.” The Appendices referenced in “Attachment 4” that contain the actual road centerline descriptions are incorporated herein by reference.

A printed copy of this Acknowledgment and Notice of Acknowledgment, together with its Attachments and Appendices, may be viewed and/or obtained at the office of the Utah State Archives.

An electronic copy of this Acknowledgment and Notice of Acknowledgment, together with its Attachments and Appendices referenced in the Attachments, may be viewed and/or downloaded as read-only PDF (Portable

Document Format) files via the Internet at <http://recorded2477roads.utah.gov>.

The owner of the servient estate in the land underlying the road-segments subject to this Acknowledgment and Notice is believed to be the United States of America through one or more of its agencies. Any of such agencies or any other person with a servient ownership claim or a competing dominant estate right-of-way ownership claim, may file a petition in the State District Court for Salt Lake County for a decision regarding the correctness of this Acknowledgment. A claimant shall file a petition within sixty (60) days after receipt of this Notice.

**In Witness Whereof**, I, Lynn H. Stevens, the official designee of the Governor of the State of Utah, in conformity to the laws of the State (Utah Code Sections 72-5-308 through 310), have caused this Acknowledgment and Notice of Acknowledgment to be made and the Seal of the State of Utah to be hereunto affixed.

Signed and sealed under my hand in Salt Lake City, Utah, the 1 day of June, 2007.

By the Governor's Designee  
  
\_\_\_\_\_  
Lynn H. Stevens

**CERTIFICATION**

State of Utah )  
                              ) SS.  
County of Salt Lake )

I, Pamela Z. Blackham, certify that the signer of this Acknowledgment and Notice of Acknowledgment of Acceptance of R.S. 2477 Right-of-way Grant, Lynn H. Stevens, is personally known by me, and he has made a voluntary signature and taken an oath or affirmation stating that he is the official designee of the Governor of the State of Utah and is authorized to sign this document on the Governor's behalf pursuant to Utah Code Section 72-5-309. He further vouched that, based upon information and belief, the facts alleged therein are true.

Dated this 1 day of June, 2007.

  
\_\_\_\_\_  
Pamela Z. Blackham, Notary Public  
Residing at Salt Lake City, Utah



Attachment 1

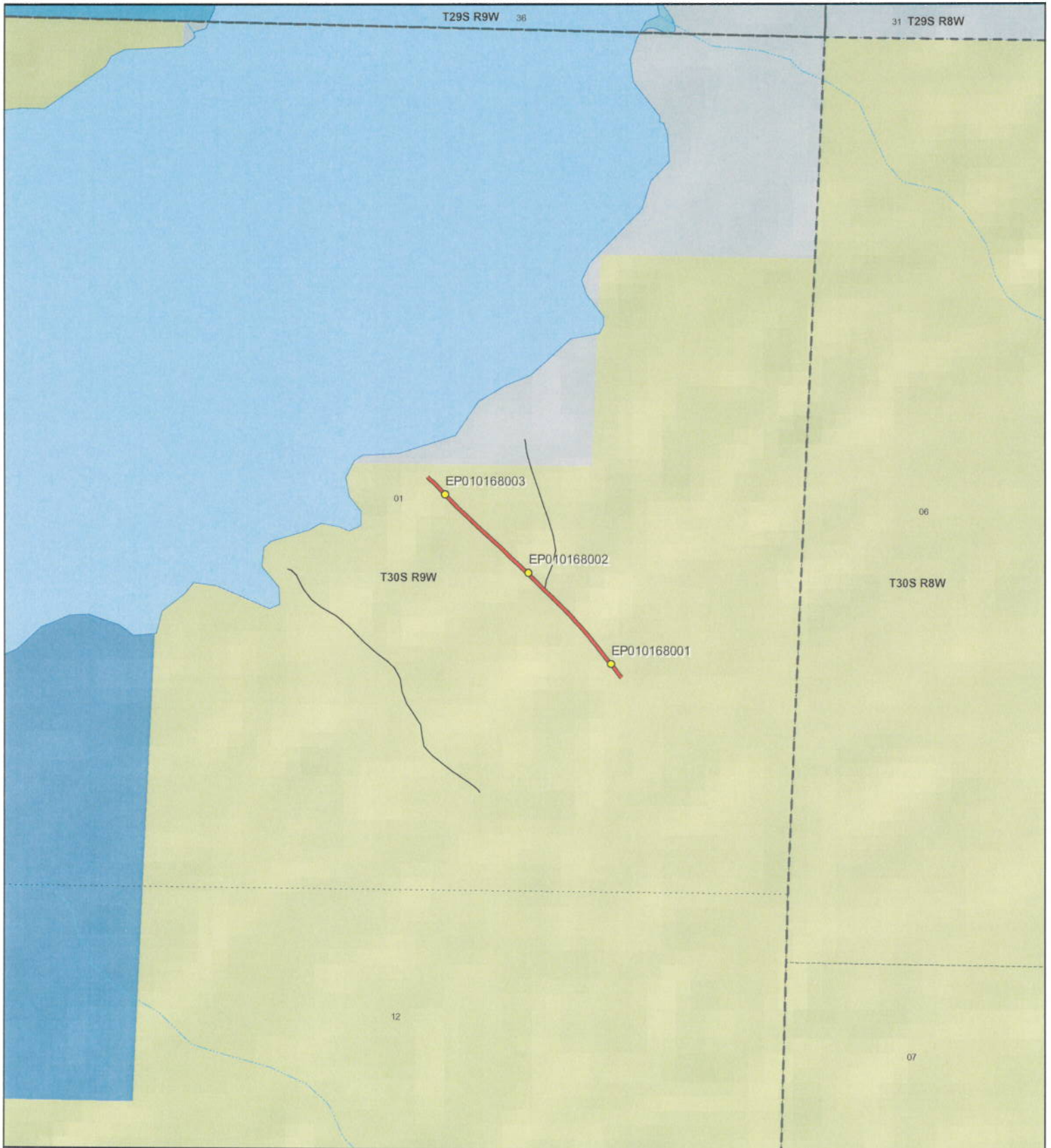

<p>1:9,678 1 inch equals 0.2 miles</p>		<p align="center"><b>SOUTH LAKE ACCESS II - Beaver County</b> <b>SGID RD_ID RD010168</b></p> <table border="0"> <tr> <td colspan="2"><b>Land Ownership Categories</b></td> <td><b>Transportation Network</b></td> </tr> <tr> <td> BLM</td> <td> Wilderness</td> <td> SOUTH LAKE ACCESS II</td> </tr> <tr> <td> Private</td> <td> UDWR Wildlife Reserve</td> <td> Title V: Issued Or Under Consideration By BLM Or County</td> </tr> <tr> <td> SITLA, State Trust Land</td> <td> DOD, Military</td> <td> Other Roads</td> </tr> <tr> <td> USFS, National Forest</td> <td> State Sovereign Land</td> <td> Photo Event Point</td> </tr> <tr> <td> State Parks and Recreation</td> <td> National Recreation Area</td> <td> Section = 1 Mile</td> </tr> <tr> <td> Tribal, Indian Reservation</td> <td> USFWS, Natl. Wildlife Refuge</td> <td></td> </tr> <tr> <td> NPS, National Park</td> <td></td> <td></td> </tr> </table>	<b>Land Ownership Categories</b>		<b>Transportation Network</b>	BLM	Wilderness	SOUTH LAKE ACCESS II	Private	UDWR Wildlife Reserve	Title V: Issued Or Under Consideration By BLM Or County	SITLA, State Trust Land	DOD, Military	Other Roads	USFS, National Forest	State Sovereign Land	Photo Event Point	State Parks and Recreation	National Recreation Area	Section = 1 Mile	Tribal, Indian Reservation	USFWS, Natl. Wildlife Refuge		NPS, National Park			<p>Map prepared by the State of Utah Automated Geographic Reference Center Room 5130 State Office Building Salt Lake City, Utah 84114 May 16, 2007</p>
<b>Land Ownership Categories</b>		<b>Transportation Network</b>																									
BLM	Wilderness	SOUTH LAKE ACCESS II																									
Private	UDWR Wildlife Reserve	Title V: Issued Or Under Consideration By BLM Or County																									
SITLA, State Trust Land	DOD, Military	Other Roads																									
USFS, National Forest	State Sovereign Land	Photo Event Point																									
State Parks and Recreation	National Recreation Area	Section = 1 Mile																									
Tribal, Indian Reservation	USFWS, Natl. Wildlife Refuge																										
NPS, National Park																											

Attachment 2



EP010168001



EP010168002



EP010168003

EP000000000

EP000000000

EP000000000

**SOUTH LAKE ACCESS II - Beaver County**  
**SGID RD\_ID RD010168**

Map prepared by the State of Utah  
Automated Geographic Reference Center  
Room 5130 State Office Building  
Salt Lake City, Utah 84114  
April 17, 2007



### Attachment 3

#### Beginning & Ending Points and Township, Range, and Section References For:

**Popular Name: SOUTH LAKE ACCESS II**

**County: Beaver**

**County Road Number: B-88**

**State Geographic Information Database (SGID) Road Identification Number: RD010168.**

**Total Road Length: 0.33 miles more or less.**

**Beginning at a point** on the road centerline located at 38 degrees 13 minutes 28.74 seconds North Latitude and -112 degrees 48 minutes 38.18 seconds West Longitude, which can be converted to mapping accuracy State Plane Utah South Zone NAD 83 feet coordinates of X = 1,263,922.7 feet and Y = 10,412,440.7 feet based on the US Survey Foot conversion.

**Ending at a point** on the road centerline located at 38 degrees 13 minutes 40.76 seconds North Latitude and -112 degrees 48 minutes 53.55 seconds West Longitude, which can be converted to mapping accuracy State Plane Utah South Zone NAD 83 feet coordinates of X = 1,262,713.3 feet and Y = 10,413,674.6 feet based on the US Survey Foot conversion.

This road may traverse:

Township 30 South Range 9 West, Section(s) 1, Salt Lake Base & Meridian  
See Attachment 1 above for a cartographic depiction of the course of this road.

**Attachment 4  
Road Centerline Description Cover Page(s)**

**Popular Name: SOUTH LAKE ACCESS II**

**County: Beaver**

**County Road Number: B-88**

**State Geographic Information Database (SGID) Road Identification Number: RD010168.**

**Total Road Length: 0.33 miles more or less.**

**Centerline Descriptions Of Road-Segments That Cross Over Federally Owned Land, Derived From Global Positioning System Data And Cross-checked against USGS Digital Orthophoto Quadrangles Compiled By The Utah Automated Geographic Reference Center And Entered Into The State Geographic Information Database (SGID).**

<b>Road-Segments Listed by SGID Road Identification Number (RD ID)</b>	<b>Road-Segment Numbers</b>	<b>Believed Ownership Of Servient Estate</b>	<b>Approximate Segment Length</b>	<b>See Attached Appendix</b>
<b>RD010168</b>	<b>001</b>	<b>BLM</b>	<b>0.33 Miles</b>	<b>A</b>
		<b>Total Road Length</b>	<b>0.33</b>	<b>_____</b>

\* Indicates that a Title V permit will be requested, is in process, or has been issued.

† Indicates that road-segments crossing Forest Service land are under consideration by the state and county as of the date of this Acknowledgment and Notice of Acknowledgment.