

Exhibit A

AFFIDAVIT OF ROBERT MERRYWEATHER
COPPERKING MINE ROAD
BEAVER COUNTY, UTAH
ROAD NUMBER B-113

State of Utah)
 : ss.
County of Beaver)

ROBERT MERRYWEATHER, being first duly sworn, deposes and states as follows:

1. I am an adult competent to testify about the matters set forth below based upon my personal knowledge. I currently reside in Milford, Beaver County, Utah. I have lived in Beaver County most of my life. I was employed with the Beaver County Road Department from approximately 1970 to 2000.

2. I have traveled and am familiar with a road in Beaver County known as Copperking Mine Road. I am also familiar with the land the road traverses. When I first used and observed the road in 1950, it followed the same route as in 2000 when I last observed it. Attached is a Beaver County map showing Copperking Mine Road. To the best of my knowledge and based upon my use of and familiarity with this road and the land it traverses, the location and route of the road are correctly illustrated on the attached map.

3. I am informed that the County also identifies this road according to the road number listed above.

4. I have observed that the road has been open to the public for all to use, to come and go as they pleased, since at least as early as 1950 and continuing through 1976 to 2000. Throughout this time period I have observed travel on the road by means of pickup trucks, ATVs and automobiles. Throughout this time period, the road has been used weekly, weather permitting.

5. Throughout the time period from 1950 to 2000, I have used the road myself for

recreation and county road maintenance.

6. Throughout the time period described in the previous paragraph, I have observed other vehicles from the general public using the road at various times for the uses described in the previous paragraph, plus mining and prospecting for minerals.

7. It is also the reputation in the community that this road has been open to the public for all to use, to come and go as they pleased, since at least as early as the early 1900s and continuing through 1976 to the present, for the uses described in the previous paragraphs.

8. Prior to 1976, I performed maintenance and construction activities on the road.

DATED this 1 day of February, 2007.

Robert Merryweather
ROBERT MERRYWEATHER

SUBSCRIBED AND SWORN to before me this 1st day of February, 2007.

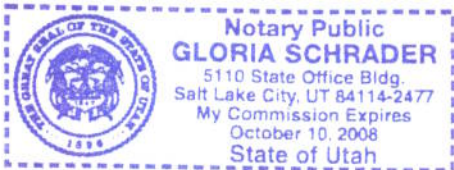

Gloria Schrader
NOTARY PUBLIC

BEAVER COUNTY "B" ROADS

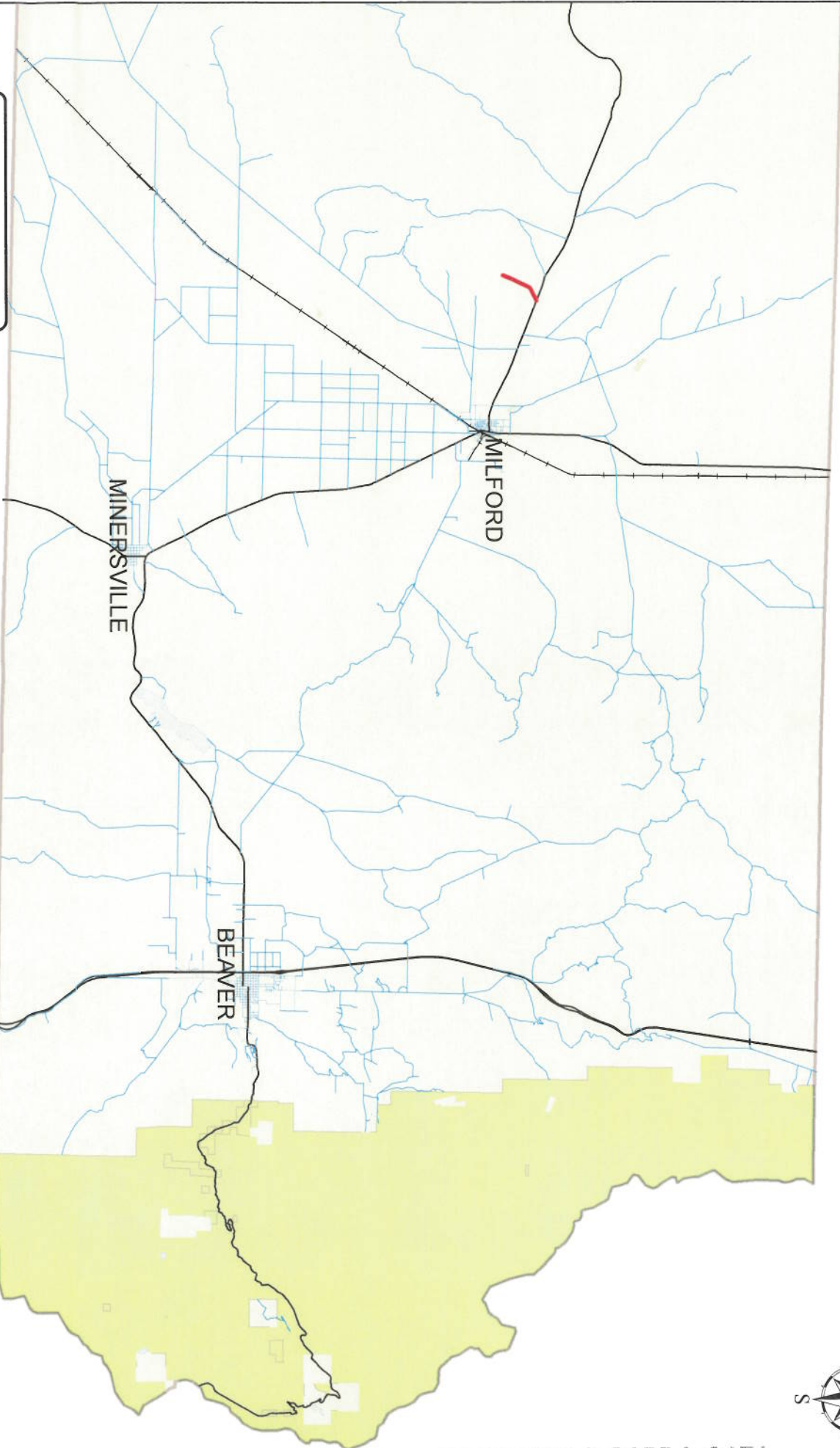

Legend

- Copperking Mine
- County B Roads
- State Highways
- UPRR

**COPPERKING MINE ROAD
B-113**



AFFIDAVIT OF RULON J. HARDY
COPPERKING MINE ROAD
BEAVER COUNTY, UTAH
ROAD NUMBER B-113

State of Utah)
 : ss.
County of Beaver)

RULON J. HARDY, being first duly sworn, deposes and states as follows:

1. I am an adult competent to testify about the matters set forth below based upon my personal knowledge. I currently reside in Milford, Beaver County, Utah. I have lived in Beaver County most of my life.

2. I have traveled and am familiar with a road in Beaver County known as Copperking Mine Road. I am also familiar with the land the road traverses. When I first used and observed the road in 1953, it followed the same route as in 2004 when I last observed it. Attached is a Beaver County map showing Cooperking Mine Road. To the best of my knowledge and based upon my use of and familiarity with this road and the land it traverses, the location and route of the road are correctly illustrated on the attached map.

3. I am informed that the County also identifies this road according to the road number listed above.

4. I have observed that the road has been open to the public for all to use, to come and go as they pleased, since at least as early as 1953 and continuing through 1976 to 2004. Throughout this time period I have observed travel on the road by means of trucks, ATVs and jeeps. Throughout the time period from 1953 to 2004 the road was used weekly, weather permitting.

5. Throughout the time period from 1953 to 2004, I have used the road myself for recreation.

6. Throughout the time period described in the previous paragraph, I have observed other vehicles from the general public using the road at various times for the uses described in the previous paragraph, plus hunting, trapping, prospecting for minerals and livestock operations.

7. It is also the reputation in the community that this road has been open to the public for all to use, to come and go as they pleased, since at least as early as the early 1900s and continuing through 1976 to the present, for the uses described in the previous paragraphs.

8. Prior to 1976, I observed the graded surface of the road.

DATED this 1 day of February, 2007.



RULON J. HARDY

SUBSCRIBED AND SWORN to before me this 1st day of February, 2007.

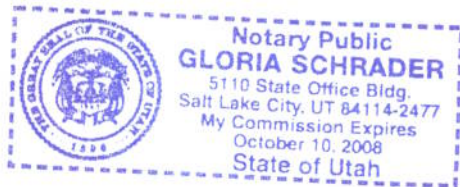



NOTARY PUBLIC

BEAVER COUNTY "B" ROADS

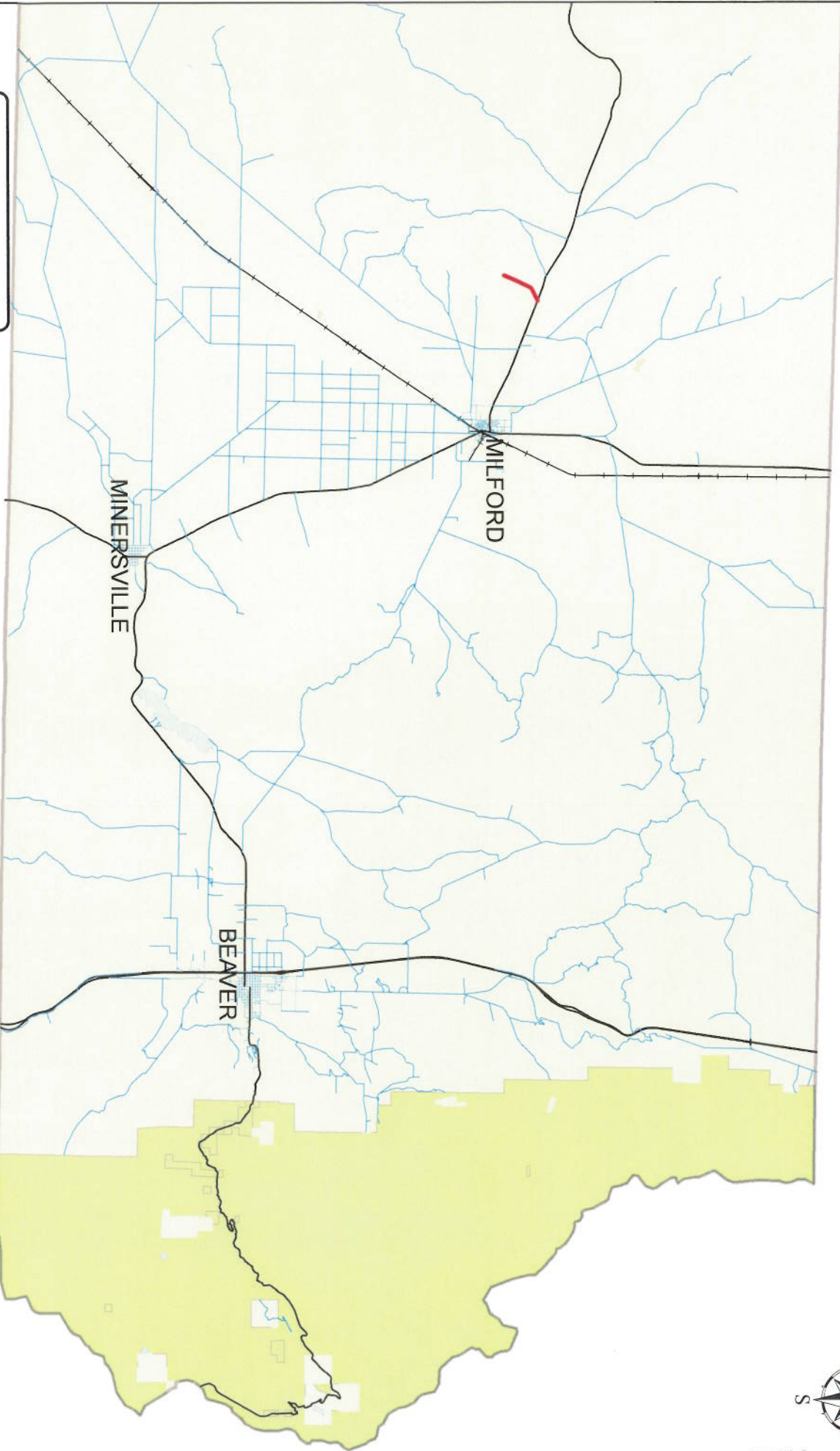

Legend

- Copperking Mine
- County B Roads
- State Highways
- UPRR

COPPERKING MINE ROAD B-113



Exhibit B

Beginning & Ending Points and Township, Range, and Section References For:

Popular Name: COPPERKING MINE ROAD

County: Beaver

County Road Number: B-113

State Geographic Information Database (SGID) Road Identification Number: RD010020.

Total Road Length: 1.58 miles more or less.

Beginning at a point on the road centerline located at 38 degrees 24 minutes 09.77 seconds North Latitude and -113 degrees 06 minutes 052.4 seconds West Longitude, which can be converted to mapping accuracy State Plane Utah South Zone NAD 83 feet coordinates of X = 1,177,735.0 feet and Y = 10,478,644.3 feet based on the US Survey Foot conversion.

Ending at a point on the road centerline located at 38 degrees 25 minutes 13.65 seconds North Latitude and -113 degrees 05 minutes 54.45 seconds West Longitude, which can be converted to mapping accuracy State Plane Utah South Zone NAD 83 feet coordinates of X = 1,182,458.0 feet and Y = 10,485,026.4 feet based on the US Survey Foot conversion.

This road may traverse:

Township 27 South Range 11 West, Section(s) 32,33, Salt Lake Base & Meridian

Township 28 South Range 11 West, Section(s) 5, Salt Lake Base & Meridian