

Supplement to Amended Acknowledgment and Amended Notice of Acknowledgment of Acceptance of R.S. 2477 Right-of-Way Grant

THE STATE OF UTAH

TO ALL WHOM THESE PRESENTS SHALL COME, Greeting:

This Supplement to Amended Acknowledgment and Amended Notice of Acknowledgment and the affidavits attached hereto as Exhibit A supplement and support the Amended Acknowledgment and Amended Notice of Acknowledgment, previously made under Utah Code Sections 72-5-309 through 310 inclusive, as it pertains to the highway located in Beaver County known as NEWHOUSE ROAD; County Road Number: B-18; State Geographic Information Database (SGID) Road Identification Number: RD010069.

This document supplements and supports the information contained in the document first recorded at **Ent 232842, Bk 408, Beg Pg 600**, as modified by the Amended Acknowledgment and Amended Notice of Acknowledgment recorded on **February 14, 2008** at **Ent 235768, Bk 418, Beg Pg 380** . A legal description is attached hereto as Exhibit B.

In Witness Whereof, I, John Harja, the official designee of the Governor of the State of Utah, in conformity to the laws of the State (Utah Code Sections 72-5-308 through 310 inclusive), have caused this Supplement to Amended Acknowledgment and Amended Notice of Acknowledgment to be made.

Signed by my hand in Salt Lake City, Utah, the 27th day of June, 2008.

By the Governor's Designee

John Harja

Ent 236976 Bk 423 Pg 674
Date: 02-JUL-2008 12:28PM
Fee: None
Filed By: CP
BRUCE BROWN, Recorder
BEAVER COUNTY CORPORATION
For: STATE OF UTAH

CERTIFICATION

State of Utah)
: ss
County of Salt Lake)

I hereby certify that the signer of the foregoing document, John Harja, is personally known by me, has made a voluntary signature and taken an oath stating that he is the official designee of the Governor of the State of Utah and is authorized to sign this document on the Governor's behalf pursuant to Utah Code Section 72-5-309. He further vouched that, based upon information and belief, the facts alleged therein are true.

Dated this 27th day of June, 2008.



Notary Public

Exhibit A

AFFIDAVIT OF KENT MARSHALL

NEWHOUSE ROAD

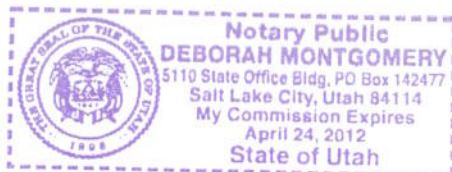
BEAVER COUNTY, UTAH

ROAD NUMBER B-18

State of Utah)
 : ss.
County of Beaver)

KENT MARSHALL, being first duly sworn, deposes and states as follows:

1. I am an adult competent to testify about the matters set forth below based upon my personal knowledge. I currently reside in Minersville, Beaver County, Utah. I have lived in Beaver County my entire life.

2. I have traveled and am familiar with a road in Beaver County known as Newhouse Road. I am also familiar with the land the road traverses. When I first used and observed the road in the late 1950s, it followed the same route as in the 2000 when I last observed it. Attached is a Beaver County map showing Newhouse Road. To the best of my knowledge and based upon my use of and familiarity with this road and the land it traverses, the location and route of the road are correctly illustrated on the attached map.

3. I am informed that the County also identifies this road according to the road number listed above.

4. I have observed that the road has been open to the public for all to use, to come and go as they pleased, since at least as early as the late 1950s and continuing through 1976 to the late 2000. Throughout this time period I have observed travel on the road by means of pickup trucks. Throughout the time period from the late 1950s to 2000 the road was used daily.

5. Throughout the time period from the late 1950s to 2000, I have used the road myself for hunting, recreation and travel in and through the area.

6. Throughout the time period described in the previous paragraph, I have observed

other vehicles from the general public using the road at various times for the uses described in the previous paragraph plus livestock operations, mining and trapping. It is also the reputation in the community that this road has been open to the public for all to use, to come and go as they pleased, since at least as early as the early 1900s and continuing through 1976 to the present, for the uses described in the previous paragraphs.

7. Prior to 1976, I observed the graded surface of the road.

DATED this 2 day of February, 2007.

KENT MARSHALL

SUBSCRIBED AND SWORN to before me this 2nd day of February, 2007.

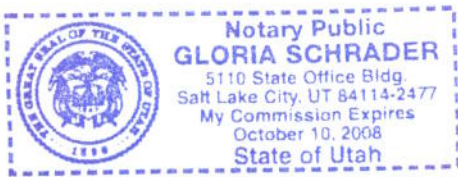



NOTARY PUBLIC

BEAVER COUNTY "B" ROADS

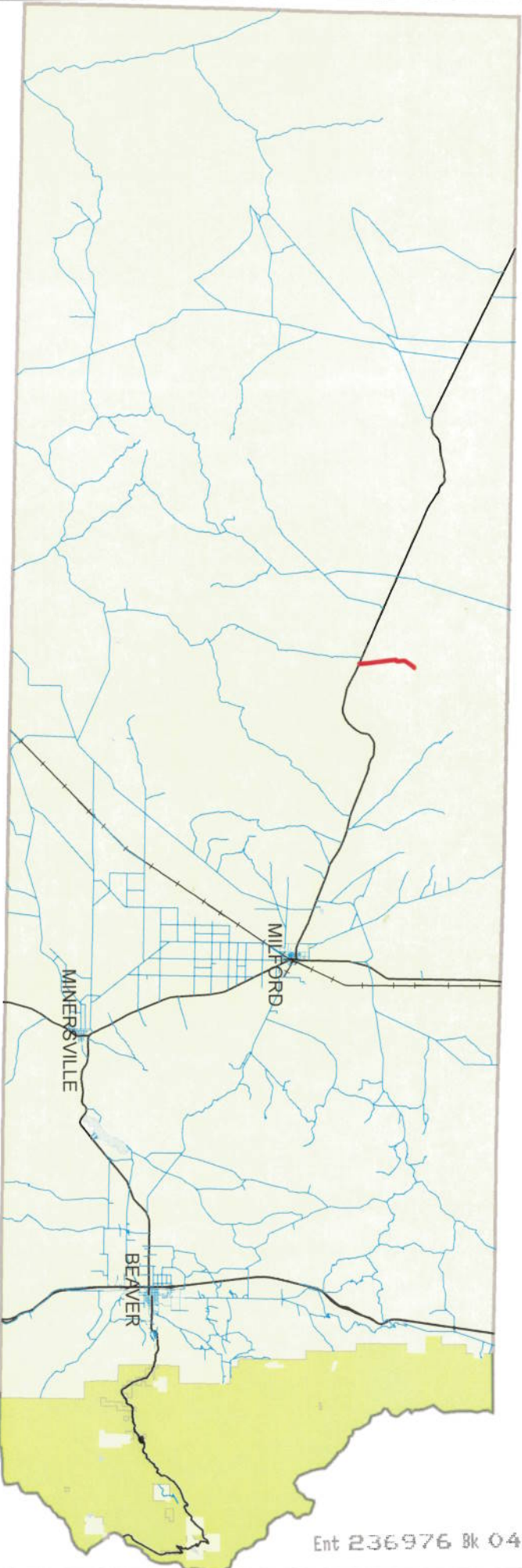

Ent 236976 Bk 0423 Pg 0678



NEWHOUSE ROAD B-18

Legend

- Newhouse Road (Red wavy line)
- County B Roads (Blue wavy line)
- State Highways (Black wavy line)
- UPRR (Black line with cross-ticks)

AFFIDAVIT OF ROBERT MERRYWEATHER

NEWHOUSE ROAD

BEAVER COUNTY, UTAH

ROAD NUMBER B-18

State of Utah)
 : ss.
County of Beaver)

ROBERT MERRYWEATHER, being first duly sworn, deposes and states as follows:

1. I am an adult competent to testify about the matters set forth below based upon my personal knowledge. I currently reside in Milford, Beaver County, Utah. I have lived in Beaver County most of my life. I was employed with the Beaver County Road Department from approximately 1970 to 2000.

2. I have traveled and am familiar with a road in Beaver County known as Newhouse Road. I am also familiar with the land the road traverses. When I first used and observed the road in 1950, it followed the same route as in 2006 when I last observed it. Attached is a Beaver County map showing Newhouse Road. To the best of my knowledge and based upon my use of and familiarity with this road and the land it traverses, the location and route of the road are correctly illustrated on the attached map.

3. I am informed that the County also identifies this road according to the road number listed above.

4. I have observed that the road has been open to the public for all to use, to come and go as they pleased, since at least as early as 1950 and continuing through 1976 to 2006. Throughout this time period I have observed travel on the road by means of pickup trucks, ATVs and automobiles. Throughout this time period, the road has been used daily, weather permitting.

5. Throughout the time period from 1950 to 2006, I have used the road myself for hunting, recreation and county road maintenance.

6. Throughout the time period described in the previous paragraph, I have observed other vehicles from the general public using the road at various times for the uses described in the previous paragraph, plus mining, prospecting for minerals, government access and wood gathering.

7. It is also the reputation in the community that this road has been open to the public for all to use, to come and go as they pleased, since at least as early as the early 1900s and continuing through 1976 to the present, for the uses described in the previous paragraphs.

8. Prior to 1976, I performed maintenance and construction activities on the road.

DATED this 1 day of February, 2007.

ROBERT MERRYWEATHER

SUBSCRIBED AND SWORN to before me this 1st day of February, 2007.

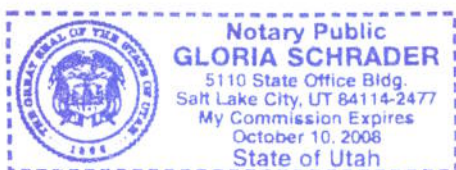



NOTARY PUBLIC



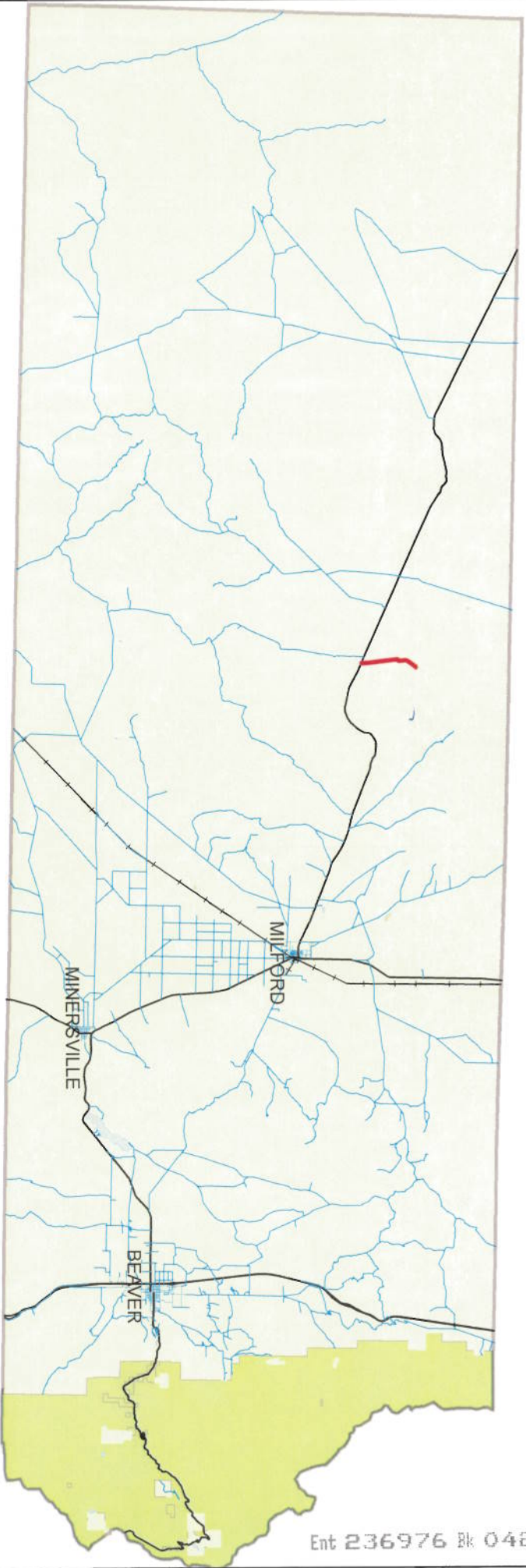

BEAVER COUNTY "B" ROADS



Ent 236976 Bk 0423 Pg 0681



Legend

-  Newhouse Road
-  County B Roads
-  State Highways
-  UPRR

NEWHOUSE ROAD B-18

Exhibit B

Beginning & Ending Points and Township, Range, and Section References For:

Popular Name: NEWHOUSE ROAD

County: Beaver

County Road Number: B-18

State Geographic Information Database (SGID) Road Identification Number: RD010069.

Total Road Length: 4.73 miles more or less.

Beginning at a point on the road centerline located at 38 degrees 26 minutes 50.55 seconds North Latitude and -113 degrees 20 minutes 09.51 seconds West Longitude, which can be converted to mapping accuracy State Plane Utah South Zone NAD 83 feet coordinates of X = 1,114,609.8 feet and Y = 10,496,076.7 feet based on the US Survey Foot conversion.

Ending at a point on the road centerline located at 38 degrees 29 minutes 53.79 seconds North Latitude and -113 degrees 18 minutes 40.51 seconds West Longitude, which can be converted to mapping accuracy State Plane Utah South Zone NAD 83 feet coordinates of X = 1,122,048.3 feet and Y = 10,514,472.8 feet based on the US Survey Foot conversion.

This road may traverse:

Township 26 South Range 13 West, Section(s) 33, Salt Lake Base & Meridian

Township 27 South Range 13 West, Section(s) 4,5,8,17,20, Salt Lake Base & Meridian