

Exhibit A

AFFIDAVIT OF SPENCER L. STEPHENS

ADAMSVILLE LOOP ROAD

BEAVER COUNTY, UTAH

ROAD NUMBER B-196

State of Utah)
 : ss.
County of Beaver)

SPENCER L. STEPHENS, being first duly sworn, deposes and states as follows:

1. I am an adult competent to testify about the matters set forth below based upon my personal knowledge. I currently reside in Adamsville, Beaver County, Utah. I have lived in Beaver County since 1950.

2. I have traveled and am familiar with a road in Beaver County known as Adamsville Loop Road. I am also familiar with the land the road traverses. When I first used and observed the road in 1952, it followed the same route as in 2007 when I last observed it. Attached is a Beaver County map showing Adamsville Loop Road. To the best of my knowledge and based upon my use of and familiarity with this road and the land it traverses, the location and route of the road are correctly illustrated on the attached map.

3. I am informed that the County also identifies this road according to the road number listed above.

4. I have observed that the road has been open to the public for all to use, to come and go as they pleased, since at least as early as 1952 and continuing through 1976 to 2007 present. Throughout this time period I have observed travel on the road by means of pickup trucks and automobiles. Throughout this time period, the road has been used daily.

5. Throughout the time period from 1952 to 2007, I have used the road myself for residential access and travel in and through the area.

6. Throughout the time period described in the previous paragraph, I have observed

other vehicles from the general public using the road at various times for the uses described in the previous paragraph plus livestock operations.

7. It is also the reputation in the community that this road has been open to the public for all to use, to come and go as they pleased, since at least as early as the early 1900s and continuing through 1976 to the present, for the uses described in the previous paragraphs.

8. Prior to 1976, I observed county road equipment performing maintenance and construction activities on the road.

DATED this 30 day of January, 2007.

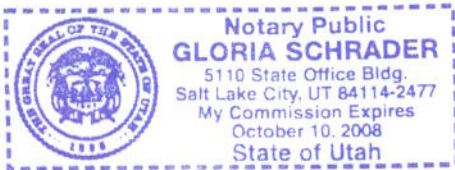

SPENCER L. STEPHENS

SUBSCRIBED AND SWORN to before me this 30th day of January, 2007.

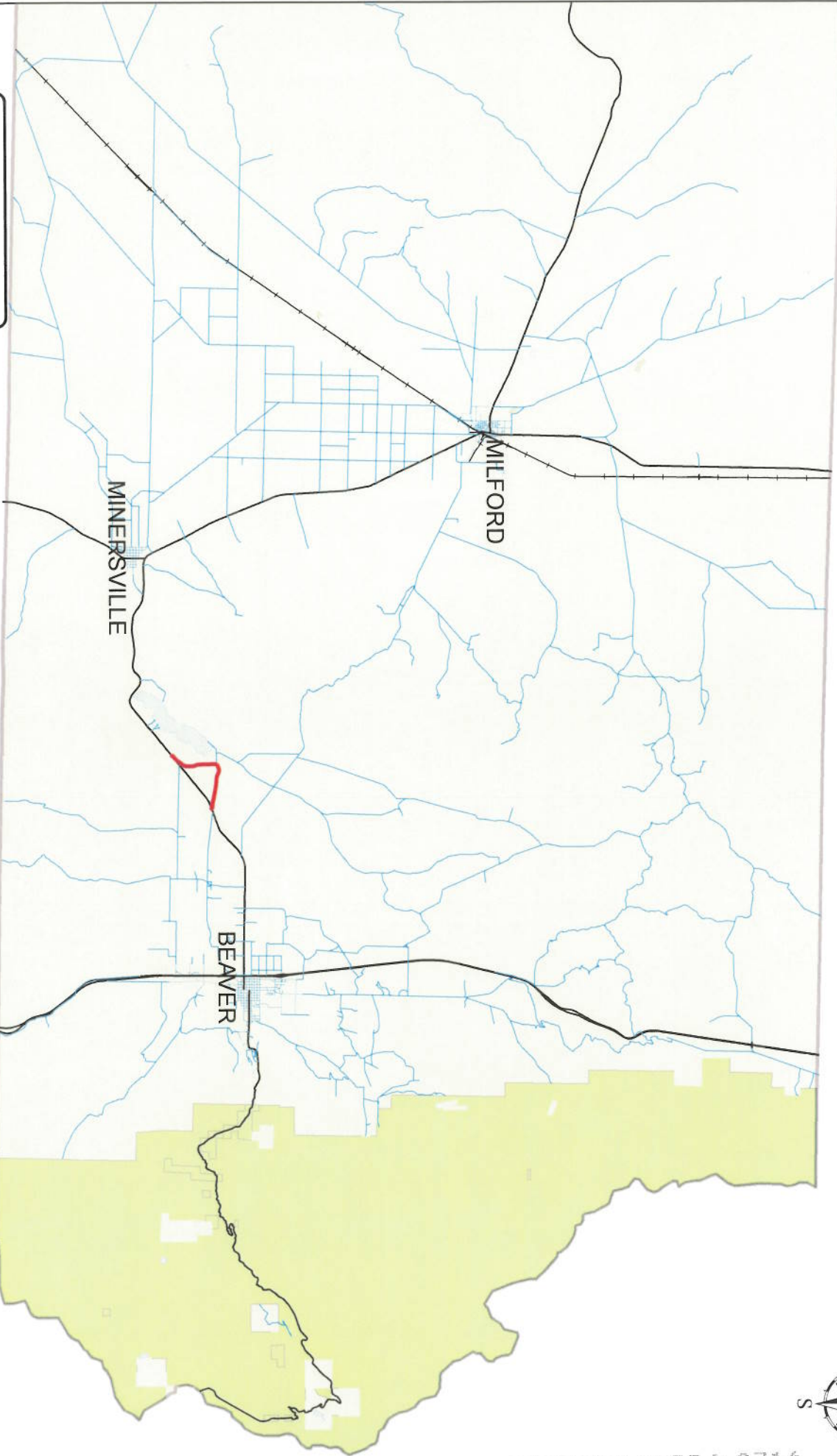

NOTARY PUBLIC

BEAVER COUNTY "B" ROADS



ADAMSVILLE LOOP
B-196

Legend

- Adamsville Loop
- County B Roads
- State Highways
- UPRR

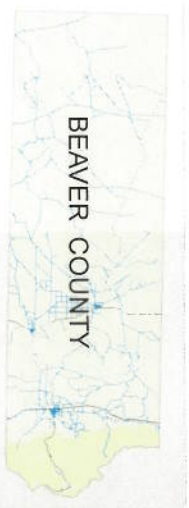

AFFIDAVIT OF CRAIG DAVIS
ADAMSVILLE LOOP ROAD
BEAVER COUNTY, UTAH
ROAD NUMBER B-196

State of Utah)
 : ss.
County of Beaver)

CRAIG DAVIS, being first duly sworn, deposes and states as follows:

1. I am an adult competent to testify about the matters set forth below based upon my personal knowledge. I currently reside in Beaver, Beaver County, Utah. I have lived in Beaver County my entire life.

2. I have traveled and am familiar with a road in Beaver County known as Adamsville Loop Road. I am also familiar with the land the road traverses. When I first used and observed the road in 1966, it followed the same route as in 2006 when I last observed it. Attached is a Beaver County map showing Adamsville Loop Road. To the best of my knowledge and based upon my use of and familiarity with this road and the land it traverses, the location and route of the road are correctly illustrated on the attached map.

3. I am informed that the County also identifies this road according to the road number listed above.

4. I have observed that the road has been open to the public for all to use, to come and go as they pleased, since at least as early as 1966 and continuing through 1976 to the present. Throughout this time period I have observed travel on the road by means of cars, pickup trucks and jeeps. Throughout this time period, the road has been used daily.

5. Throughout the time period from 1966 to 2006, I have used the road myself for fishing, recreation and traveling in and through the area.

6. Throughout the time period described in the previous paragraph, I have observed

other vehicles from the general public using the road at various times for the uses described in the previous paragraph, plus rock hounding, residential access, livestock operations and government access.

7. It is also the reputation in the community that this road has been open to the public for all to use, to come and go as they pleased, since at least as early as the early 1900s and continuing through 1976 to the present, for the uses described in the previous paragraphs.

8. Prior to 1976, I observed county road equipment performing maintenance and construction activities on the road. The road is presently oiled.

DATED this 30 day of January, 2007.

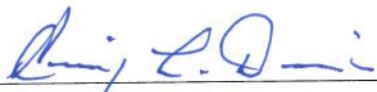

CRAIG DAVIS

SUBSCRIBED AND SWORN to before me this 30th day of January, 2007.

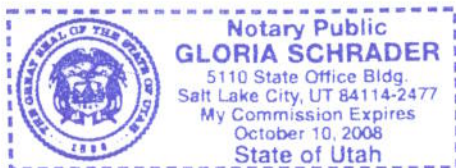



NOTARY PUBLIC

BEAVER COUNTY "B" ROADS

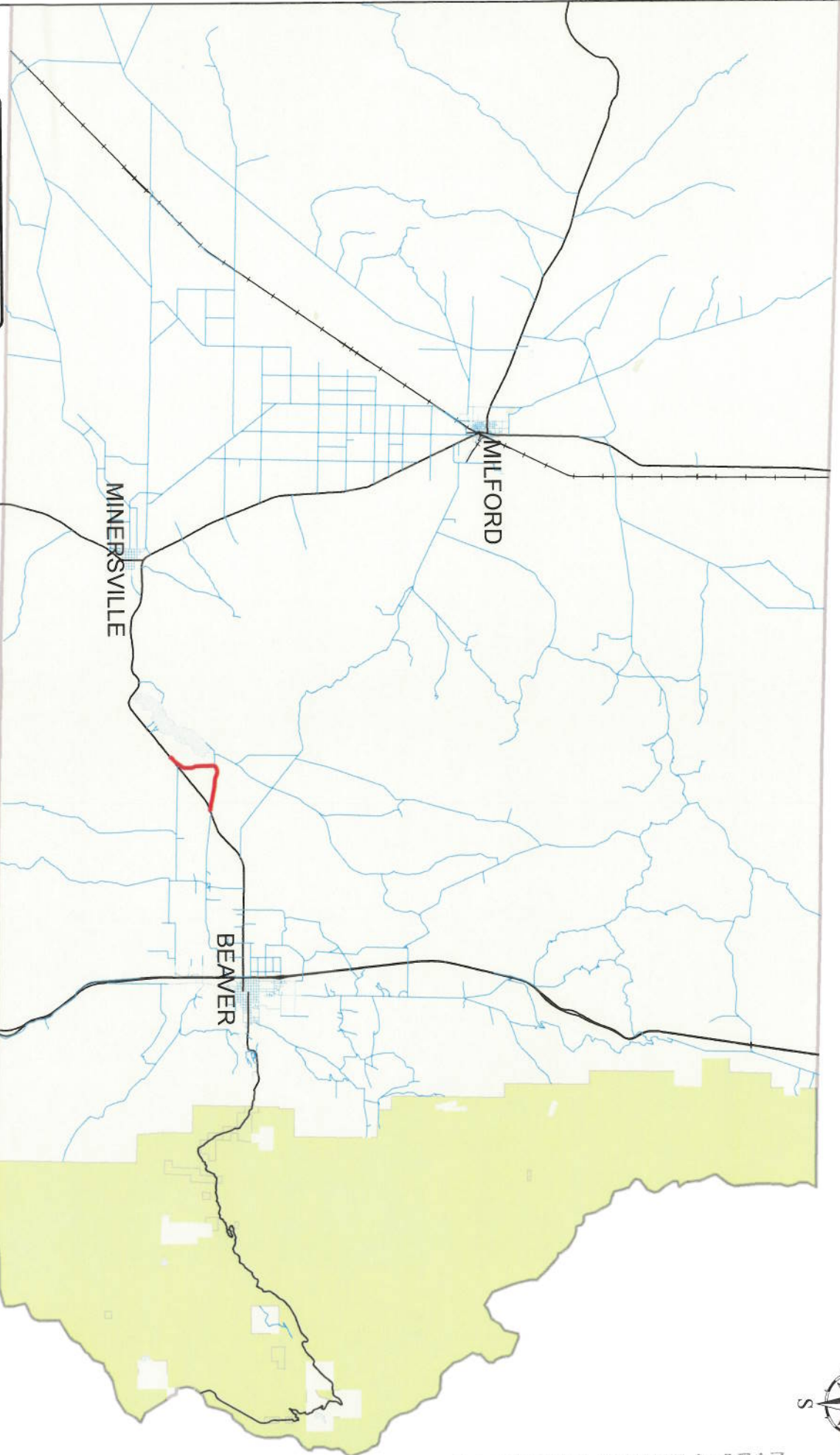

Legend

- Adamsville Loop
- County B Roads
- State Highways
- UPRR

ADAMSVILLE LOOP B-196

MAP VIEW AREA

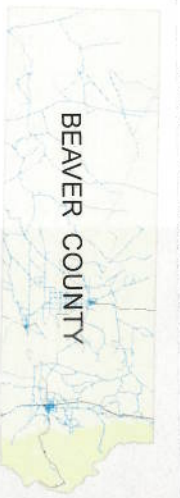

Exhibit B

Beginning & Ending Points and Township, Range, and Section References For:

Popular Name: ADAMSVILLE LOOP

County: Beaver

County Road Number: B-196

State Geographic Information Database (SGID) Road Identification Number: RD010073.

Total Road Length: 3.37 miles more or less.

Beginning at a point on the road centerline located at 38 degrees 14 minutes 7 seconds North Latitude and -112 degrees 47 minutes 39.88 seconds West Longitude, which can be converted to mapping accuracy State Plane Utah South Zone NAD 83 feet coordinates of X = 1,268,627.4 feet and Y = 10,416,246.0 feet based on the US Survey Foot conversion.

Ending at a point on the road centerline located at 38 degrees 15 minutes 21.71 seconds North Latitude and -112 degrees 45 minutes 37.01 seconds West Longitude, which can be converted to mapping accuracy State Plane Utah South Zone NAD 83 feet coordinates of X = 1,278,532.4 feet and Y = 10,423,669.2 feet based on the US Survey Foot conversion.

This road may traverse:

Township 29 South Range 8 West, Section(s) 28,29,30,31,32, Salt Lake Base & Meridian
Township 30 South Range 8 West, Section(s) 6, Salt Lake Base & Meridian