

**Supplement to Amended Acknowledgment and
Amended Notice of Acknowledgment
of Acceptance of R.S. 2477
Right-of-Way Grant**

THE STATE OF UTAH

TO ALL WHOM THESE PRESENTS SHALL COME, Greeting:

This Supplement to Amended Acknowledgment and Amended Notice of Acknowledgment and the affidavits attached hereto as Exhibit A supplement and support the Amended Acknowledgment and Amended Notice of Acknowledgment, previously made under Utah Code Sections 72-5-309 through 310 inclusive, as it pertains to the highway located in Beaver County known as PINE CREEK HIGHWAY 91; County Road Number: B-208; State Geographic Information Database (SGID) Road Identification Number: RD010082.

This document supplements and supports the information contained in the document first recorded at **Ent 232859, Bk 408, Beg Pg 702**, as modified by the Amended Acknowledgment and Amended Notice of Acknowledgment recorded on **February 15, 2008 at Ent 235806, Bk 418, Beg Pg 489**. A legal description is attached hereto as Exhibit B.

In Witness Whereof, I, John Harja, the official designee of the Governor of the State of Utah, in conformity to the laws of the State (Utah Code Sections 72-5-308 through 310 inclusive), have caused this Supplement to Amended Acknowledgment and Amended Notice of Acknowledgment to be made.

Signed by my hand in Salt Lake City, Utah, the 27th day of June, 2008.

By the Governor's Designee

John Harja

John Harja

Ent 237009 Bk 424 Pg 91
Date: 02 JUL 2008 1:30PM
Fee: None
Filed By: CP
BRUCE BROWN, Recorder
BEAVER COUNTY CORPORATION
For: STATE OF UTAH

CERTIFICATION

State of Utah)
 : ss
County of Salt Lake)

I hereby certify that the signer of the foregoing document, John Harja, is personally known by me, has made a voluntary signature and taken an oath stating that he is the official designee of the Governor of the State of Utah and is authorized to sign this document on the Governor's behalf pursuant to Utah Code Section 72-5-309. He further vouched that, based upon information and belief, the facts alleged therein are true.

Dated this 27 day of June, 2008.

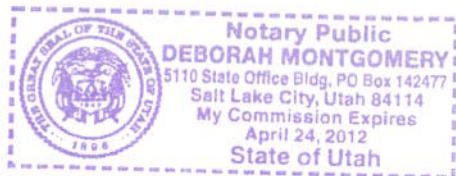

Deborah Montgomery
Notary Public

Exhibit A

AFFIDAVIT OF HOWARD W. BRADSHAW

PINE CREEK HIGHWAY

BEAVER COUNTY, UTAH

ROAD NUMBER B-208

State of Utah)
 : ss.
County of Beaver)

HOWARD W. BRADSHAW, being first duly sworn, deposes and states as follows:

1. I am an adult competent to testify about the matters set forth below based upon my personal knowledge. I currently reside in Beaver, Beaver County, Utah. I have lived in Beaver County my entire life.

2. I have traveled and am familiar with a road in Beaver County known as Pine Creek Highway. I am also familiar with the land the road traverses. When I first used and observed the road in 1941, it followed the same route as in 2005 when I last observed it. Attached is a Beaver County map showing Pine Creek Highway. To the best of my knowledge and based upon my use of and familiarity with this road and the land it traverses, the location and route of the road are correctly illustrated on the attached map.

3. I am informed that the County also identifies this road according to the road number listed above.

4. I have observed that the road has been open to the public for all to use, to come and go as they pleased, since at least as early as 1941 and continuing through 1976 to 2005. Throughout this time period I have observed travel on the road by means of ATVs, pickup trucks, jeeps and cars. Throughout the time period from 1941 to 2005 the road was used daily, weather permitting.

5. Throughout the time period from 1941 to 2005, I have used the road myself for hunting and livestock operations.

6. Throughout the time period described in the previous paragraph, I have observed other vehicles from the general public using the road at various times for the uses described in the previous paragraph, plus residential access and farming.

7. It is also the reputation in the community that this road has been open to the public for all to use, to come and go as they pleased, since at least as early as the early 1900s and continuing through 1976 to the present, for the uses described in the previous paragraphs.

8. Prior to 1976, I observed the graded surface of the road.

DATED this 31 day of January, 2007.

Howard W. Bradshaw
HOWARD W. BRADSHAW

SUBSCRIBED AND SWORN to before me this 31st day of January, 2007.

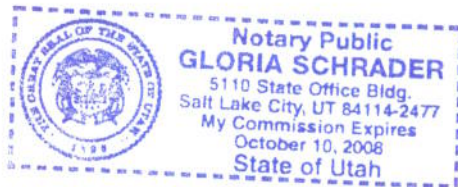

Gloria Schrader
NOTARY PUBLIC

BEAVER COUNTY "B" ROADS

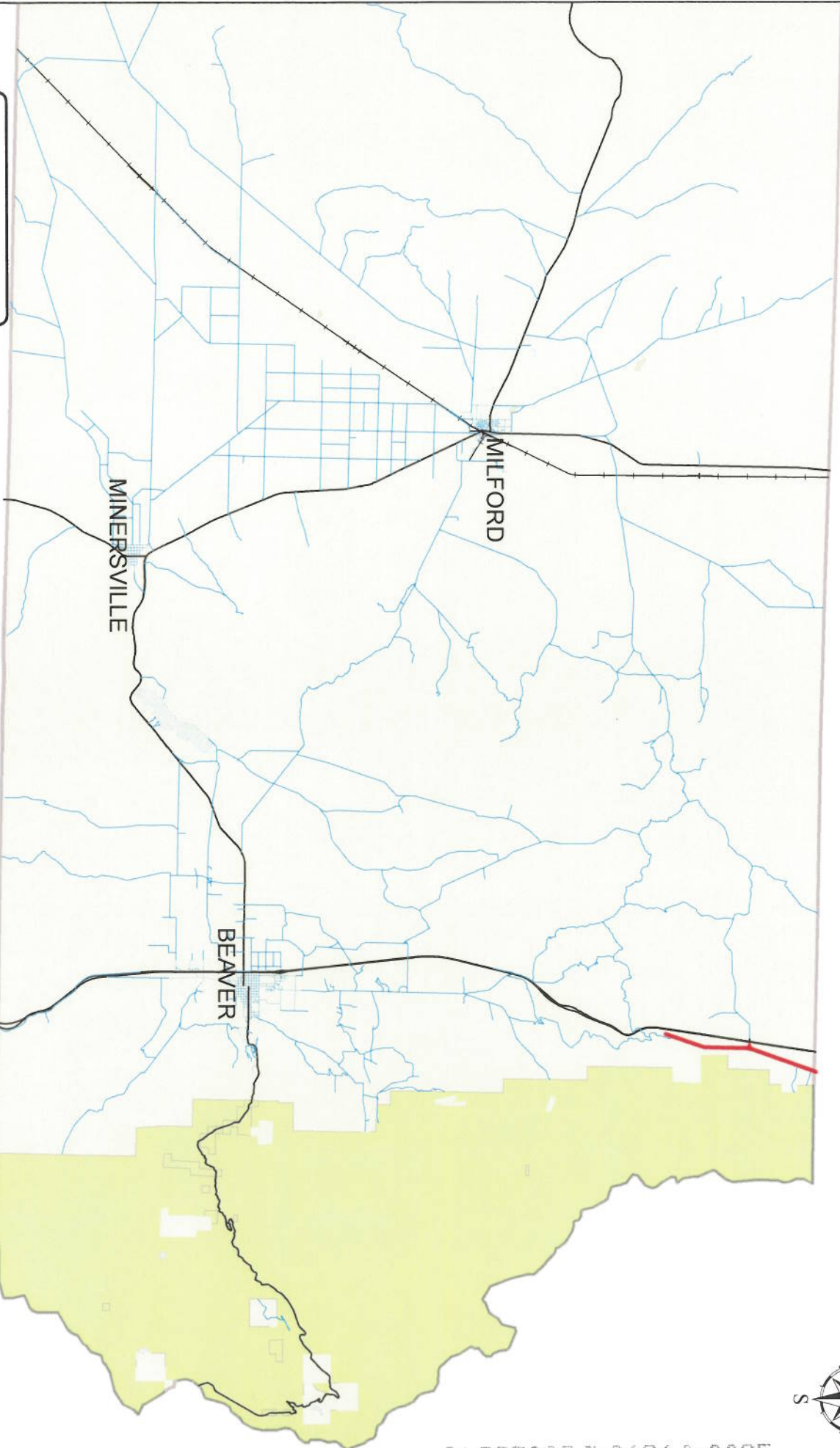

Legend

- Pine Creek Hwy
- County B Roads
- State Highways
- UPRR

**PINE CREEK HWY
B-208**

MAP VIEW AREA



AFFIDAVIT OF JOHN L. RILEY

PINE CREEK HIGHWAY

BEAVER COUNTY, UTAH

ROAD NUMBER B-208

State of Utah)
 : ss.
County of Beaver)

JOHN L. RILEY, being first duly sworn, deposes and states as follows:

1. I am an adult competent to testify about the matters set forth below based upon my personal knowledge. I currently reside in Beaver, Beaver County, Utah. I have lived in Beaver County my entire life.

2. I have traveled and am familiar with a road in Beaver County known as Pine Creek Highway. I am also familiar with the land the road traverses. When I first used and observed the road in 1928, it followed the same route as in 2006 when I last observed it. Attached is a Beaver County map showing Pine Creek Highway. To the best of my knowledge and based upon my use of and familiarity with this road and the land it traverses, the location and route of the road are correctly illustrated on the attached map.

3. I am informed that the County also identifies this road according to the road number listed above.

4. I have observed that the road has been open to the public for all to use, to come and go as they pleased, since at least as early as 1928 and continuing through 1976 to the present. Throughout this time period I have observed travel on the road by means of semi trucks, ATVs, pickup trucks and cars. Throughout the time period from 1928 to 1976 the road was used daily and is presently used daily.

5. Throughout the time period from 1928 to 2006, I have used the road myself for recreation and hunting.

6. Throughout the time period described in the previous paragraph, I have observed other vehicles from the general public using the road at various times for the uses described in the previous paragraph, plus livestock operations, access to sulphur beds, residential access, farming, wood gathering.

7. It is also the reputation in the community that this road has been open to the public for all to use, to come and go as they pleased, since at least as early as 1928 and continuing through 1976 to the present, for the uses described in the previous paragraphs.

8. Prior to 1976, I observed the graded and oiled surface of the road.

DATED this 30 day of January, 2007.



JOHN L. RILEY

SUBSCRIBED AND SWORN to before me this 30th day of January, 2007.

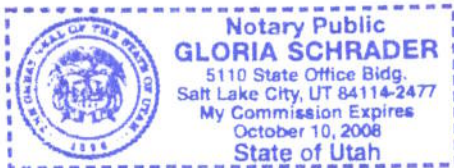



NOTARY PUBLIC

BEAVER COUNTY "B" ROADS

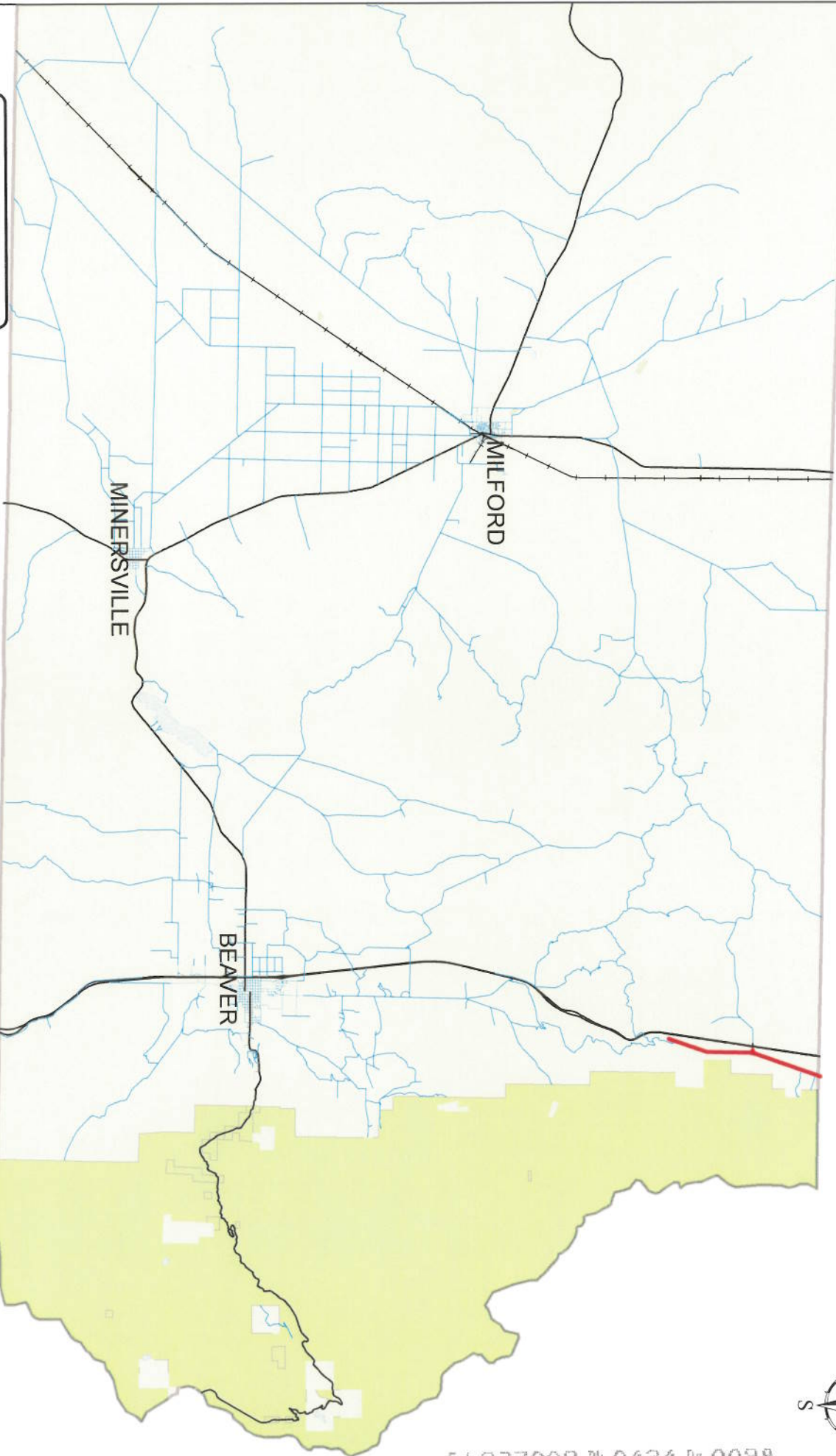

Legend

- Pine Creek Hwy
- County B Roads
- State Highways
- UPRR

PINE CREEK HWY B-208

MAP VIEW AREA

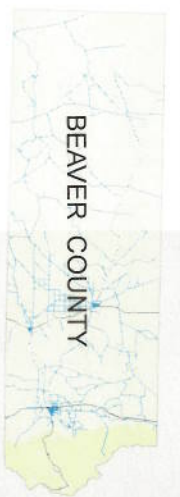

Exhibit B

Beginning & Ending Points and Township, Range, and Section References For:

Popular Name: PINE CREEK HIGHWAY 91

County: Beaver

County Road Number: B-208

State Geographic Information Database (SGID) Road Identification Number: RD010082.

Total Road Length: 5.89 miles more or less.

Beginning at a point on the road centerline located at 38 degrees 29 minutes 38.79 seconds North Latitude and -112 degrees 36 minutes 49.47 seconds West Longitude, which can be converted to mapping accuracy State Plane Utah South Zone NAD 83 feet coordinates of X = 1,321,640.5 feet and Y = 10,509,833.5 feet based on the US Survey Foot conversion.

Ending at a point on the road centerline located at 38 degrees 34 minutes 23.48 seconds North Latitude and -112 degrees 35 minutes 25.23 seconds West Longitude, which can be converted to mapping accuracy State Plane Utah South Zone NAD 83 feet coordinates of X = 1,328,673.7 feet and Y = 10,538,554.0 feet based on the US Survey Foot conversion.

This road may traverse:

Township 26 South Range 7 West, Section(s) 1,12,13,14,23,26,35, Salt Lake Base & Meridian
Township 27 South Range 7 West, Section(s) 2, Salt Lake Base & Meridian