

**Supplement to Amended Acknowledgment and  
Amended Notice of Acknowledgment  
of Acceptance of R.S. 2477  
Right-of-Way Grant**

**THE STATE OF UTAH**

**TO ALL WHOM THESE PRESENTS SHALL COME, Greeting:**

This Supplement to Amended Acknowledgment and Amended Notice of Acknowledgment and the affidavits attached hereto as Exhibit A supplement and support the Amended Acknowledgment and Amended Notice of Acknowledgment, previously made under Utah Code Sections 72-5-309 through 310 inclusive, as it pertains to the highway located in Beaver County known as BEAVER LAKE MOUNTAIN ROAD; County Road Number: B-47; State Geographic Information Database (SGID) Road Identification Number: RD010132.

This document supplements and supports the information contained in the document first recorded at **Ent 232934, Bk 409, Beg Pg 285**, as modified by the Amended Acknowledgment and Amended Notice of Acknowledgment recorded on **February 15, 2008** at **Ent 235853, Bk 418, Beg Pg 771**. A legal description is attached hereto as Exhibit B.

**In Witness Whereof**, I, John Harja, the official designee of the Governor of the State of Utah, in conformity to the laws of the State (Utah Code Sections 72-5-308 through 310 inclusive), have caused this Supplement to Amended Acknowledgment and Amended Notice of Acknowledgment to be made.

Signed by my hand in Salt Lake City, Utah, the 27<sup>th</sup> day of June, 2008.

By the Governor's Designee

  
John Harja

Ent 237056 Bk 424 Pg 515  
Date: 02-JUL-2008 2:54PM  
Fee: None  
Filed By: CP  
BRUCE BROWN, Recorder  
BEAVER COUNTY CORPORATION  
For: STATE OF UTAH

**CERTIFICATION**

State of Utah )  
: ss  
County of Salt Lake )

I hereby certify that the signer of the foregoing document, John Harja, is personally known by me, has made a voluntary signature and taken an oath stating that he is the official designee of the Governor of the State of Utah and is authorized to sign this document on the Governor's behalf pursuant to Utah Code Section 72-5-309. He further vouched that, based upon information and belief, the facts alleged therein are true.

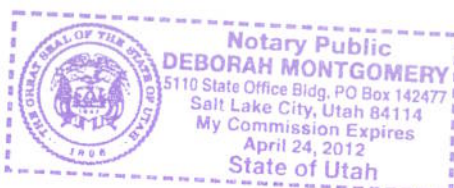

Dated this 27<sup>th</sup> day of June, 2008.

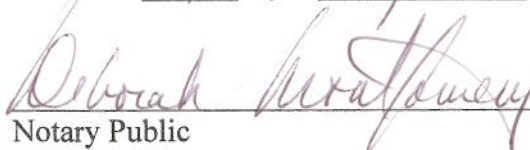
  
Notary Public

## **Exhibit A**

**AFFIDAVIT OF RULON J. HARDY**  
**BEAVER LAKE MOUNTAIN ROAD**  
**BEAVER COUNTY, UTAH**  
**ROAD NUMBER B-47**

State of Utah                    )  
  : ss.  
County of Beaver                )

RULON J. HARDY, being first duly sworn, deposes and states as follows:

1. I am an adult competent to testify about the matters set forth below based upon my personal knowledge. I currently reside in Milford, Beaver County, Utah. I have lived in Beaver County most of my life.

2. I have traveled and am familiar with a road in Beaver County known as Beaver Lake Mountain Road. I am also familiar with the land the road traverses. When I first used and observed the road in 1953, it followed the same route as in 2004 when I last observed it. Attached is a Beaver County map showing Beaver Lake Mountain Road. To the best of my knowledge and based upon my use of and familiarity with this road and the land it traverses, the location and route of the road are correctly illustrated on the attached map.

3. I am informed that the County also identifies this road according to the road number listed above.

4. I have observed that the road has been open to the public for all to use, to come and go as they pleased, since at least as early as 1953 and continuing through 1976 to 2004. Throughout this time period I have observed travel on the road by means of trucks, ATVs and jeeps. Throughout the time period from 1953 to 2004 the road was used daily and is presently used weekly, weather permitting.

5. Throughout the time period from 1953 to 2004, I have used the road myself for recreation and hunting.

6. Throughout the time period described in the previous paragraph, I have observed other vehicles from the general public using the road at various times for the uses described in the previous paragraph, plus mining, prospecting for minerals and livestock operations.

7. It is also the reputation in the community that this road has been open to the public for all to use, to come and go as they pleased, since at least as early as the 1940s and continuing through 1976 to the present, for the uses described in the previous paragraphs.

8. Prior to 1976, I observed the graded surface of the road.

DATED this 1 day of February, 2007.

Rulon J. Hardy  
RULON J. HARDY

SUBSCRIBED AND SWORN to before me this 1<sup>st</sup> day of February, 2007.

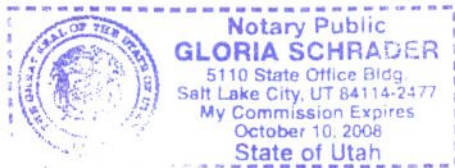

Gloria Schrader  
NOTARY PUBLIC



# BEAVER COUNTY "B" ROADS

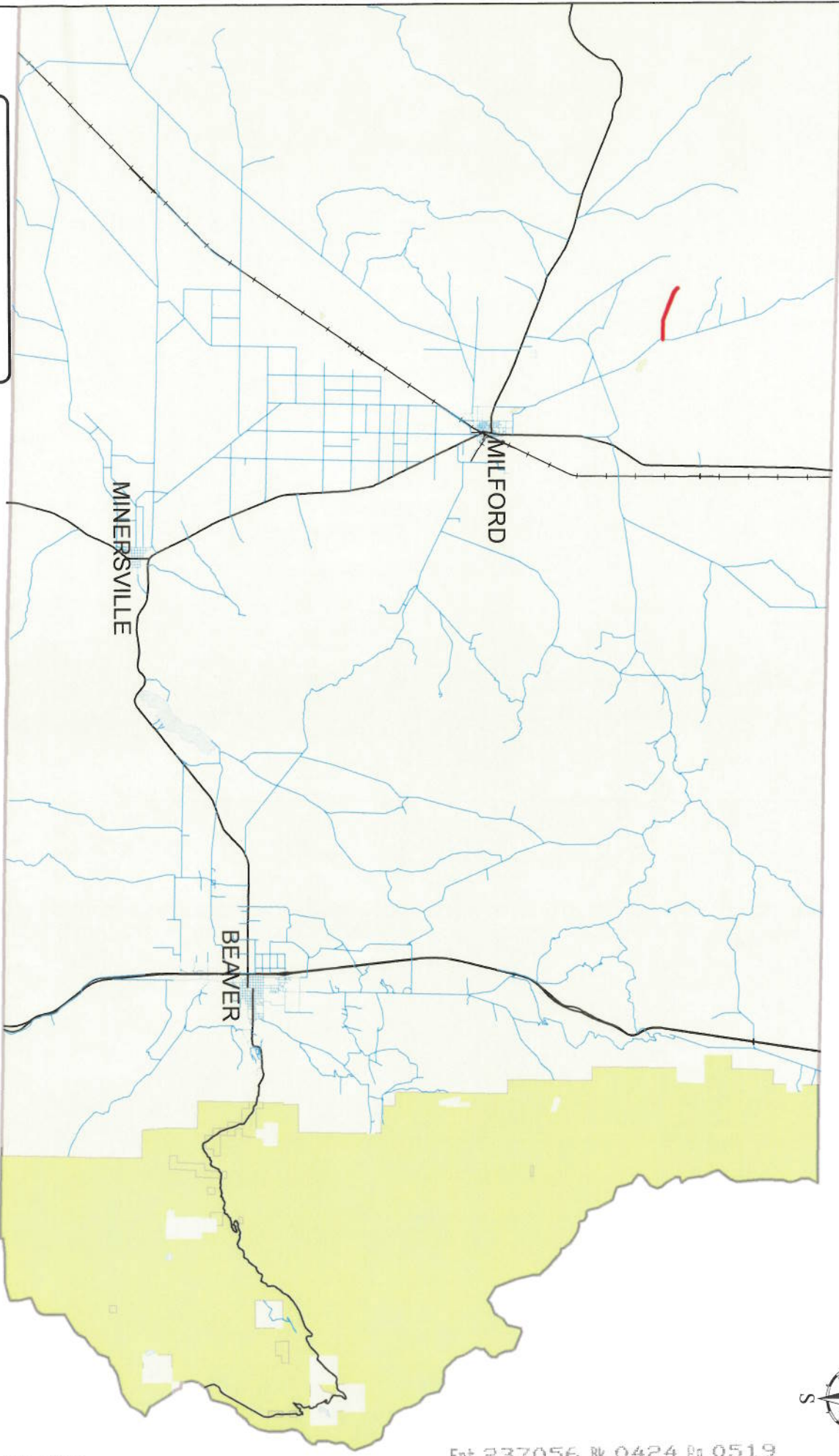

**Legend**

- Beaver Lake Mtn Road
- County B Roads
- State Highways
- UPRR

## BEAVER LAKE MOUNTAIN ROAD B-47



**AFFIDAVIT OF ROBERT MERRYWEATHER**

**BEAVER LAKE MOUNTAIN ROAD**

**BEAVER COUNTY, UTAH**

**ROAD NUMBER B-47**

State of Utah                    )  
  : ss.  
County of Beaver                )

ROBERT MERRYWEATHER, being first duly sworn, deposes and states as follows:

1. I am an adult competent to testify about the matters set forth below based upon my personal knowledge. I currently reside in Milford, Beaver County, Utah. I have lived in Beaver County most of my life. I was employed with the Beaver County Road Department from approximately 1970 to 2000.

2. I have traveled and am familiar with a road in Beaver County known as Beaver Lake Mountain Road. I am also familiar with the land the road traverses. When I first used and observed the road in 1950, it followed the same route as in 2006 when I last observed it. Attached is a Beaver County map showing Beaver Lake Mountain Road. To the best of my knowledge and based upon my use of and familiarity with this road and the land it traverses, the location and route of the road are correctly illustrated on the attached map.

3. I am informed that the County also identifies this road according to the road number listed above.

4. I have observed that the road has been open to the public for all to use, to come and go as they pleased, since at least as early as 1950 and continuing through 1976 to 2006. Throughout this time period I have observed travel on the road by means of pickup trucks, ATVs and automobiles. Throughout this time period, the road has been used daily, weather permitting.

5. Throughout the time period from 1950 to 2006, I have used the road myself for hunting, recreation and county road maintenance.

6. Throughout the time period described in the previous paragraph, I have observed other vehicles from the general public using the road at various times for the uses described in the previous paragraph, plus mining, gathering pine nuts and livestock operations.

7. It is also the reputation in the community that this road has been open to the public for all to use, to come and go as they pleased, since at least as early as the early 1900s and continuing through 1976 to the present, for the uses described in the previous paragraphs.

8. Prior to 1976, I performed maintenance and construction activities on the road.

DATED this 1 day of February, 2007.

  
ROBERT MERRYWEATHER

SUBSCRIBED AND SWORN to before me this 1st day of February, 2007.

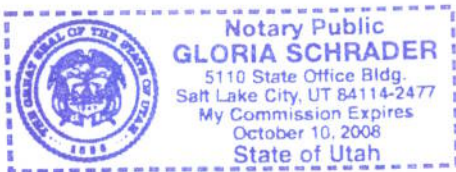





  
NOTARY PUBLIC

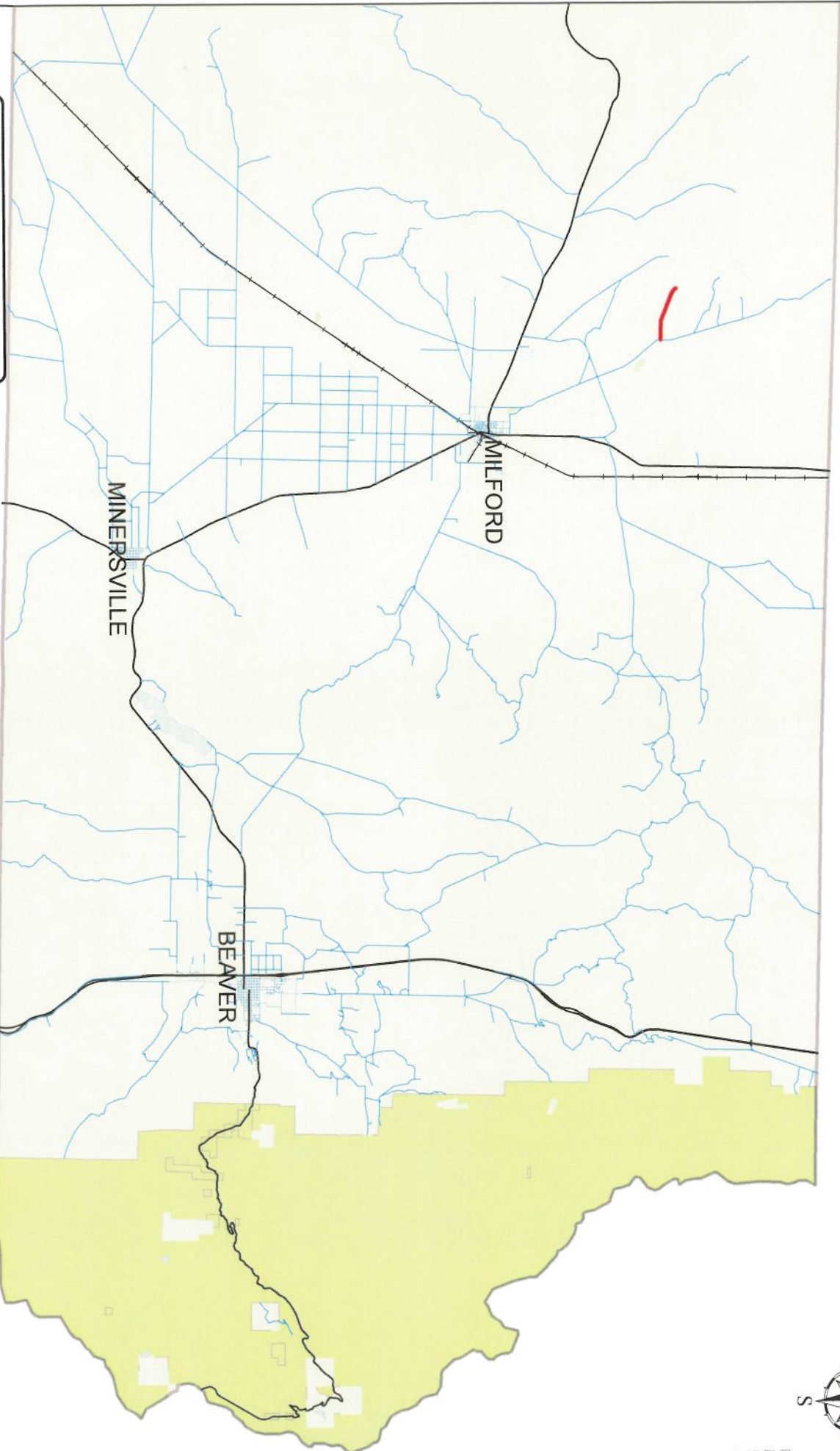
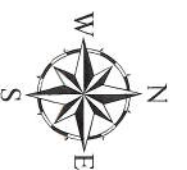

# BEAVER COUNTY "B" ROADS



## Legend

-  Beaver Lake Mtn Road
-  County B Roads
-  State Highways
-  UPRR

## BEAVER LAKE MOUNTAIN ROAD B-47

### MAP VIEW AREA





## Exhibit B

### Beginning & Ending Points and Township, Range, and Section References For:

**Popular Name: BEAVER LAKE MOUNTAIN ROAD**

**County: Beaver**

**County Road Number: B-47**

**State Geographic Information Database (SGID) Road Identification Number: RD010132.**

**Total Road Length: 1.98 miles more or less.**

**Beginning at a point** on the road centerline located at 38 degrees 29 minutes 33.23 seconds North Latitude and -113 degrees 06 minutes 32.45 seconds West Longitude, which can be converted to mapping accuracy State Plane Utah South Zone NAD 83 feet coordinates of X = 1,179,885.3 feet and Y = 10,511,334.5 feet based on the US Survey Foot conversion.

**Ending at a point** on the road centerline located at 38 degrees 29 minutes 6.7 seconds North Latitude and -113 degrees 04 minutes 29.36 seconds West Longitude, which can be converted to mapping accuracy State Plane Utah South Zone NAD 83 feet coordinates of X = 1,189,626.0 feet and Y = 10,508,484.4 feet based on the US Survey Foot conversion.

This road may traverse:

Township 27 South Range 11 West, Section(s) 4,5,9,10, Salt Lake Base & Meridian