

**Supplement to Amended Acknowledgment and Amended Notice of Acknowledgment of Acceptance of R.S. 2477 Right-of-Way Grant**

**THE STATE OF UTAH**

**TO ALL WHOM THESE PRESENTS SHALL COME, Greeting:**

This Supplement to Amended Acknowledgment and Amended Notice of Acknowledgment and the affidavits attached hereto as Exhibit A supplement and support the Amended Acknowledgment and Amended Notice of Acknowledgment, previously made under Utah Code Sections 72-5-309 through 310 inclusive, as it pertains to the highway located in Beaver County known as LAST CHANCE BENCH ROAD; County Road Number: B-56; State Geographic Information Database (SGID) Road Identification Number: RD010141.

This document supplements and supports the information contained in the document first recorded at **Ent 232981, Bk 409, Beg Pg 567**, as modified by the Amended Acknowledgment and Amended Notice of Acknowledgment recorded on **February 15, 2008** at **Ent 235861, Bk 418, Beg Pg 819**. A legal description is attached hereto as Exhibit B.

**In Witness Whereof**, I, John Harja, the official designee of the Governor of the State of Utah, in conformity to the laws of the State (Utah Code Sections 72-5-308 through 310 inclusive), have caused this Supplement to Amended Acknowledgment and Amended Notice of Acknowledgment to be made.

Signed by my hand in Salt Lake City, Utah, the 27<sup>th</sup> day of June, 2008.

By the Governor's Designee

  
 John Harja  
Ent 237064 Bk 424 Pg 587  
 Date: 02-JUL-2008 3:08PM  
 Fee: None  
 Filed By: CP  
 BRUCE BROWN, Recorder  
 BEAVER COUNTY CORPORATION  
 For: STATE OF UTAH

**CERTIFICATION**

State of Utah )  
 : ss  
 County of Salt Lake )

I hereby certify that the signer of the foregoing document, John Harja, is personally known by me, has made a voluntary signature and taken an oath stating that he is the official designee of the Governor of the State of Utah and is authorized to sign this document on the Governor's behalf pursuant to Utah Code Section 72-5-309. He further vouched that, based upon information and belief, the facts alleged therein are true.

Dated this 27<sup>th</sup> day of June, 2008.

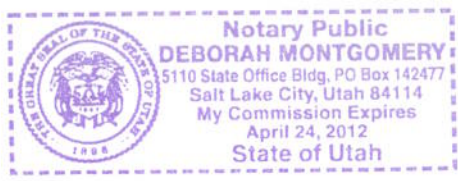

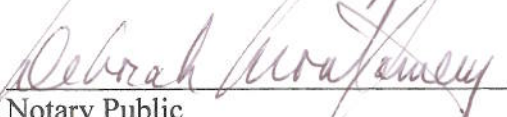
  
 Notary Public

## Exhibit A

**AFFIDAVIT OF GLENNA PUFFER**  
**LAST CHANCE BENCH ROAD**  
**BEAVER COUNTY, UTAH**  
**ROAD NUMBER B-56**

State of Utah                    )  
  : ss.  
County of Beaver                )

GLENNA PUFFER, being first duly sworn, deposes and states as follows:

1. I am an adult competent to testify about the matters set forth below based upon my personal knowledge. I currently reside in Beaver, Beaver County, Utah. I have lived in Beaver County my entire life.

2. I have traveled and am familiar with a road in Beaver County known as Last Chance Bench Road. I am also familiar with the land the road traverses. When I first used and observed the road in 1945, it followed the same route as in 2007 when I last observed it. Attached is a Beaver County map showing Last Chance Bench Road. To the best of my knowledge and based upon my use of and familiarity with this road and the land it traverses, the location and route of the road are correctly illustrated on the attached map.

3. I am informed that the County also identifies this road according to the road number listed above.

4. I have observed that the road has been open to the public for all to use, to come and go as they pleased, since at least as early as 1945 and continuing through 1976 to 2007. Throughout this time period I have observed travel on the road by means of pickup trucks, cars and ATVs. Throughout the time period from 1945 to 2007 the road has been used daily.

5. Throughout the time period from 1945 to 2007, I have used the road myself for farming, livestock operations and traveling in and through the area.

6. Throughout the time period described in the previous paragraph, I have observed

other vehicles from the general public using the road at various times for the uses described in the previous paragraph plus wood gathering, government access and accessing private property. It is also the reputation in the community that this road has been open to the public for all to use, to come and go as they pleased, since at least as early as the late 1800s and continuing through 1976 to the present, for the uses described in the previous paragraphs.

8. Prior to 1976, I observed graders performing maintenance and construction activities on the road.

DATED this 30 day of January, 2007.

Glenna Puffer  
GLENNA PUFFER

SUBSCRIBED AND SWORN to before me this 30<sup>th</sup> day of January, 2007.

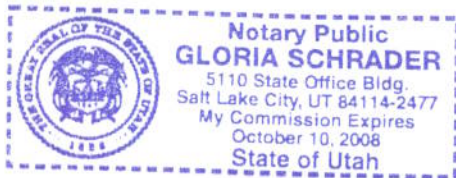

Gloria Schrader  
NOTARY PUBLIC

# BEAVER COUNTY "B" ROADS

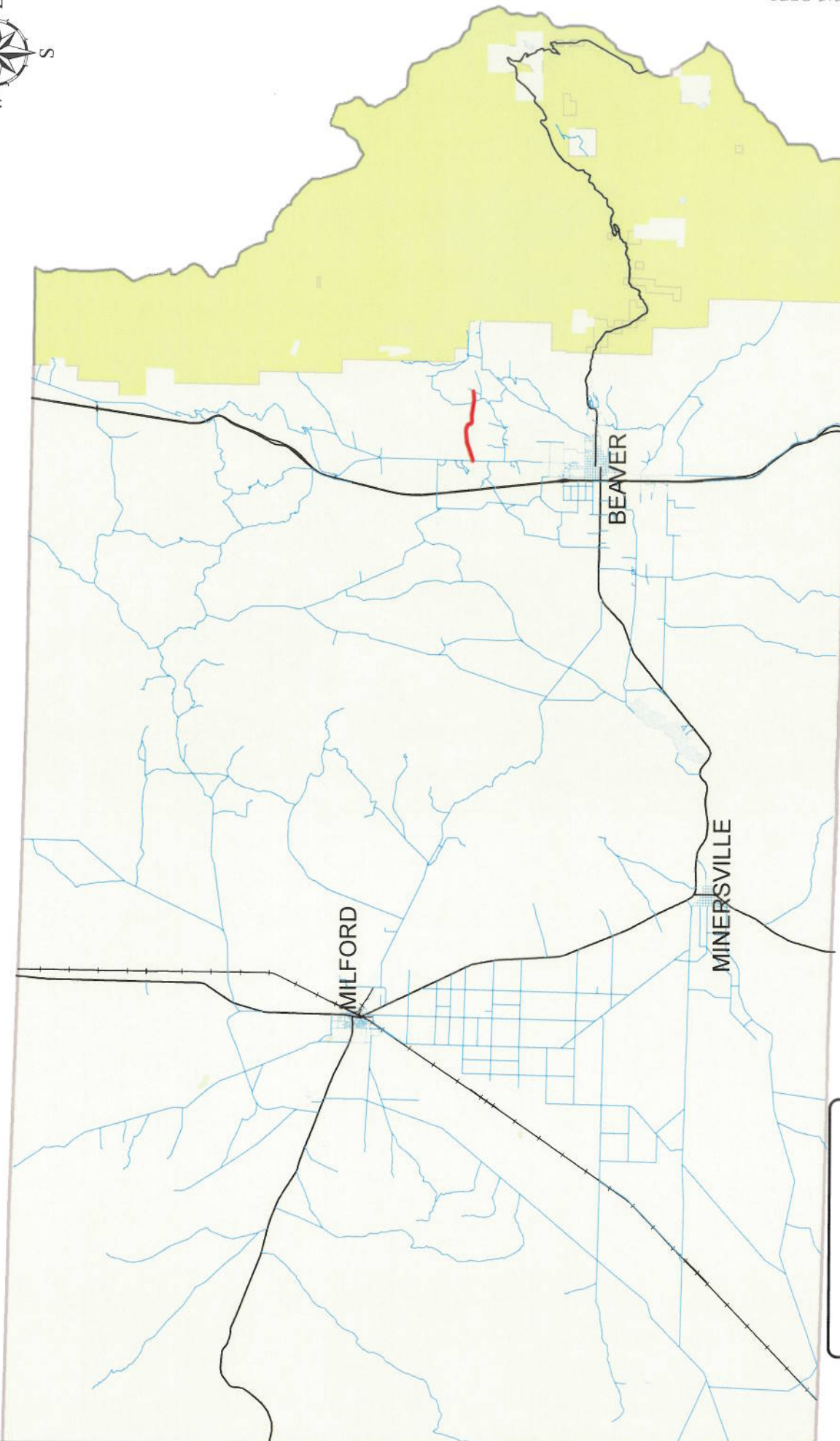

MAP VIEW AREA



## LAST CHANCE BENCH ROAD B-56

**Legend**

- Last Chance Bench (Red wavy line)
- County B Roads (Light blue lines)
- State Highways (Black line)
- UPRR (Black line with cross-ticks)

CREATED BY BEAVER CO GIS DEPT

**AFFIDAVIT OF WENDELL GREEN**  
**LAST CHANCE BENCH ROAD**  
**BEAVER COUNTY, UTAH**  
**ROAD NUMBER B-56**

State of Utah                    )  
  : ss.  
County of Beaver                )

WENDELL GREEN, being first duly sworn, deposes and states as follows:

1. I am an adult competent to testify about the matters set forth below based upon my personal knowledge. I currently reside in Beaver, Beaver County, Utah. I have lived in Beaver County my entire life.

2. I have traveled and am familiar with a road in Beaver County known as Last Chance Bench Road. I am also familiar with the land the road traverses. When I first used and observed the road in 1938, it followed the same route as in 2007 when I last observed it. Attached is a Beaver County map showing Last Chance Bench Road. To the best of my knowledge and based upon my use of and familiarity with this road and the land it traverses, the location and route of the road are correctly illustrated on the attached map.

3. I am informed that the County also identifies this road according to the road number listed above.

4. I have observed that the road has been open to the public for all to use, to come and go as they pleased, since at least as early as 1938 and continuing through 1976 to 2007. Throughout this time period I have observed travel on the road by means of pickup trucks, cars and ATVs. Throughout the time period from 1938 to 2007 the road has been used daily.

5. Throughout the time period from 1938 to 2007, I have used the road myself for livestock operations, hunting and accessing private property.

6. Throughout the time period described in the previous paragraph, I have observed

other vehicles from the general public using the road at various times for the uses described in the previous paragraph plus recreation, farming and wood gathering.

7. It is also the reputation in the community that this road has been open to the public for all to use, to come and go as they pleased, since at least as early as the early 1900s and continuing through 1976 to the present, for the uses described in the previous paragraphs.

8. Prior to 1976, I observed graders performing maintenance and construction activities on the road.

DATED this 30 day of January, 2007.

Wendell Green  
WENDELL GREEN

SUBSCRIBED AND SWORN to before me this 30<sup>th</sup> day of January, 2007.

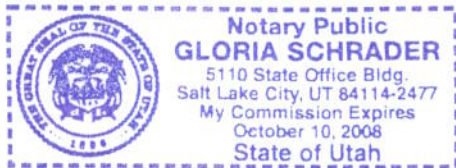

Gloria Schrader  
NOTARY PUBLIC

# BEAVER COUNTY "B" ROADS

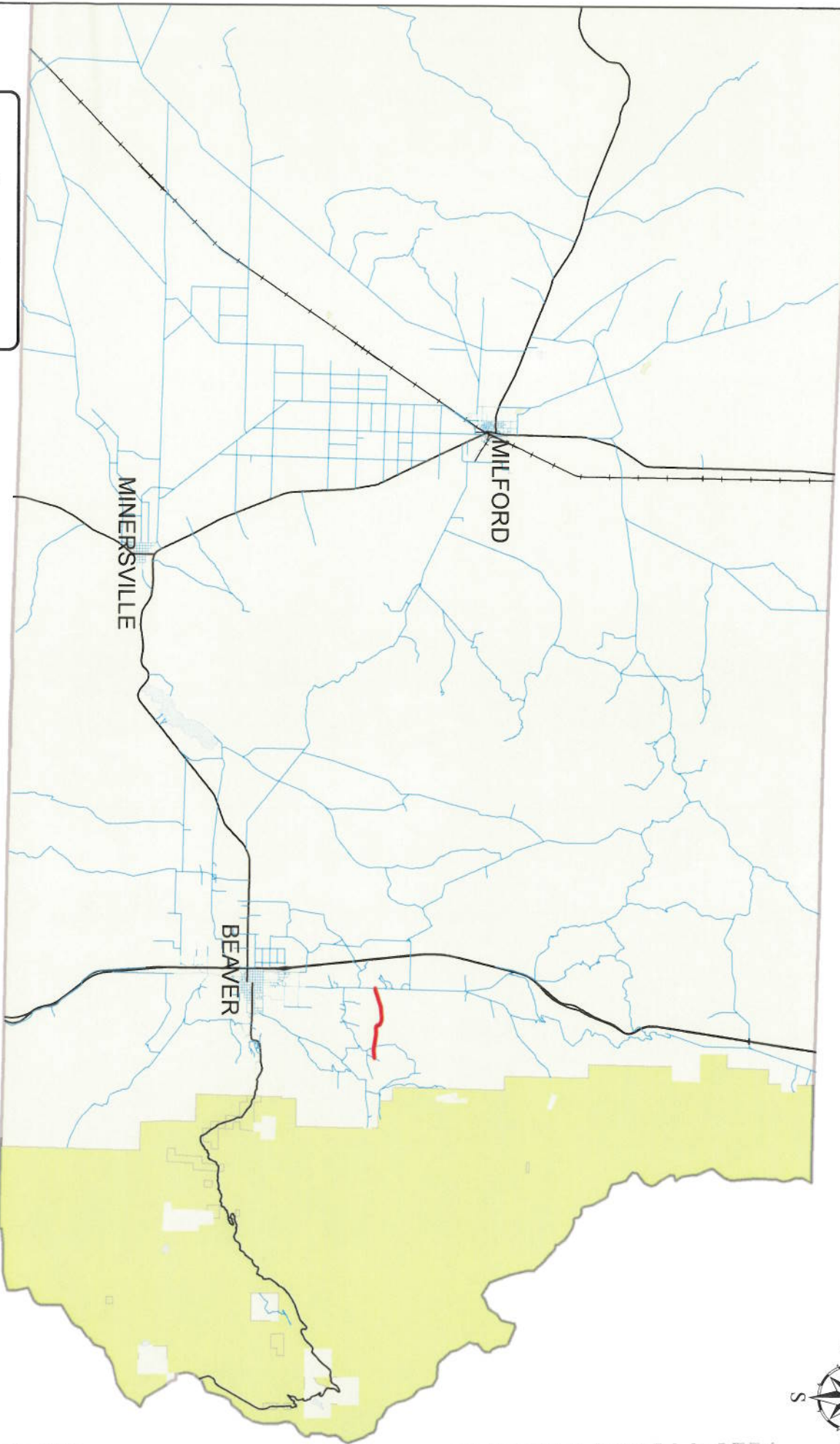

**Legend**

- Last Chance Bench
- County B Roads
- State Highways
- UPRR

## LAST CHANCE BENCH ROAD B-56

MAP VIEW AREA

BEAVER COUNTY



## Exhibit B

### Beginning & Ending Points and Township, Range, and Section References For:

**Popular Name:** LAST CHANCE BENCH ROAD

**County:** Beaver

**County Road Number:** B-56

**State Geographic Information Database (SGID) Road Identification Number:** RD010141.

**Total Road Length:** 2.67 miles more or less.

**Beginning at a point** on the road centerline located at 38 degrees 20 minutes 28.22 seconds North Latitude and -112 degrees 38 minutes 20.96 seconds West Longitude, which can be converted to mapping accuracy State Plane Utah South Zone NAD 83 feet coordinates of X = 1,313,688.4 feet and Y = 10,454,227.2 feet based on the US Survey Foot conversion.

**Ending at a point** on the road centerline located at 38 degrees 20 minutes 029.7 seconds North Latitude and -112 degrees 35 minutes 033.4 seconds West Longitude, which can be converted to mapping accuracy State Plane Utah South Zone NAD 83 feet coordinates of X = 1,327,039.8 feet and Y = 10,454,217.9 feet based on the US Survey Foot conversion.

This road may traverse:

Township 28 South Range 7 West, Section(s) 25,26,27,28, Salt Lake Base & Meridian