

Exhibit A

AFFIDAVIT OF GLENNA PUFFER

SHEEP ROCK ROAD

BEAVER COUNTY, UTAH

ROAD NUMBER B-61

State of Utah)
 : ss.
County of Beaver)

GLENNA PUFFER, being first duly sworn, deposes and states as follows:

1. I am an adult competent to testify about the matters set forth below based upon my personal knowledge. I currently reside in Beaver, Beaver County, Utah. I have lived in Beaver County my entire life.

2. I have traveled and am familiar with a road in Beaver County known as Sheep Rock Road. I am also familiar with the land the road traverses. When I first used and observed the road in 1945, it followed the same route as in 2007 when I last observed it. Attached is a Beaver County map showing Sheep Rock Road. To the best of my knowledge and based upon my use of and familiarity with this road and the land it traverses, the location and route of the road are correctly illustrated on the attached map.

3. I am informed that the County also identifies this road according to the road number listed above.

4. I have observed that the road has been open to the public for all to use, to come and go as they pleased, since at least as early as 1945 and continuing through 1976 to 2007. Throughout this time period I have observed travel on the road by means of pickup trucks, cars and ATVs. Throughout the time period from 1945 to 2007 the road has been used daily.

5. Throughout the time period from 1945 to 2007, I have used the road myself for livestock operations, wood gathering and traveling in and through the area.

6. Throughout the time period described in the previous paragraph, I have observed

other vehicles from the general public using the road at various times for the uses described in the previous paragraph plus mining, hunting, government access and accessing private property. It is also the reputation in the community that this road has been open to the public for all to use, to come and go as they pleased, since at least as early as the late 1800s and continuing through 1976 to the present, for the uses described in the previous paragraphs.

8. Prior to 1976, I observed graders performing maintenance and construction activities on the road.

DATED this 30 day of January, 2007.



GLENNA PUFFER

SUBSCRIBED AND SWORN to before me this 30th day of January, 2007.

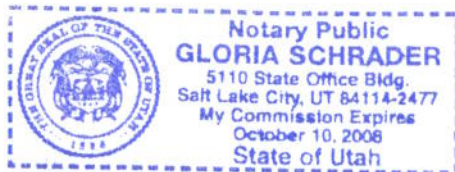



NOTARY PUBLIC

BEAVER COUNTY "B" ROADS

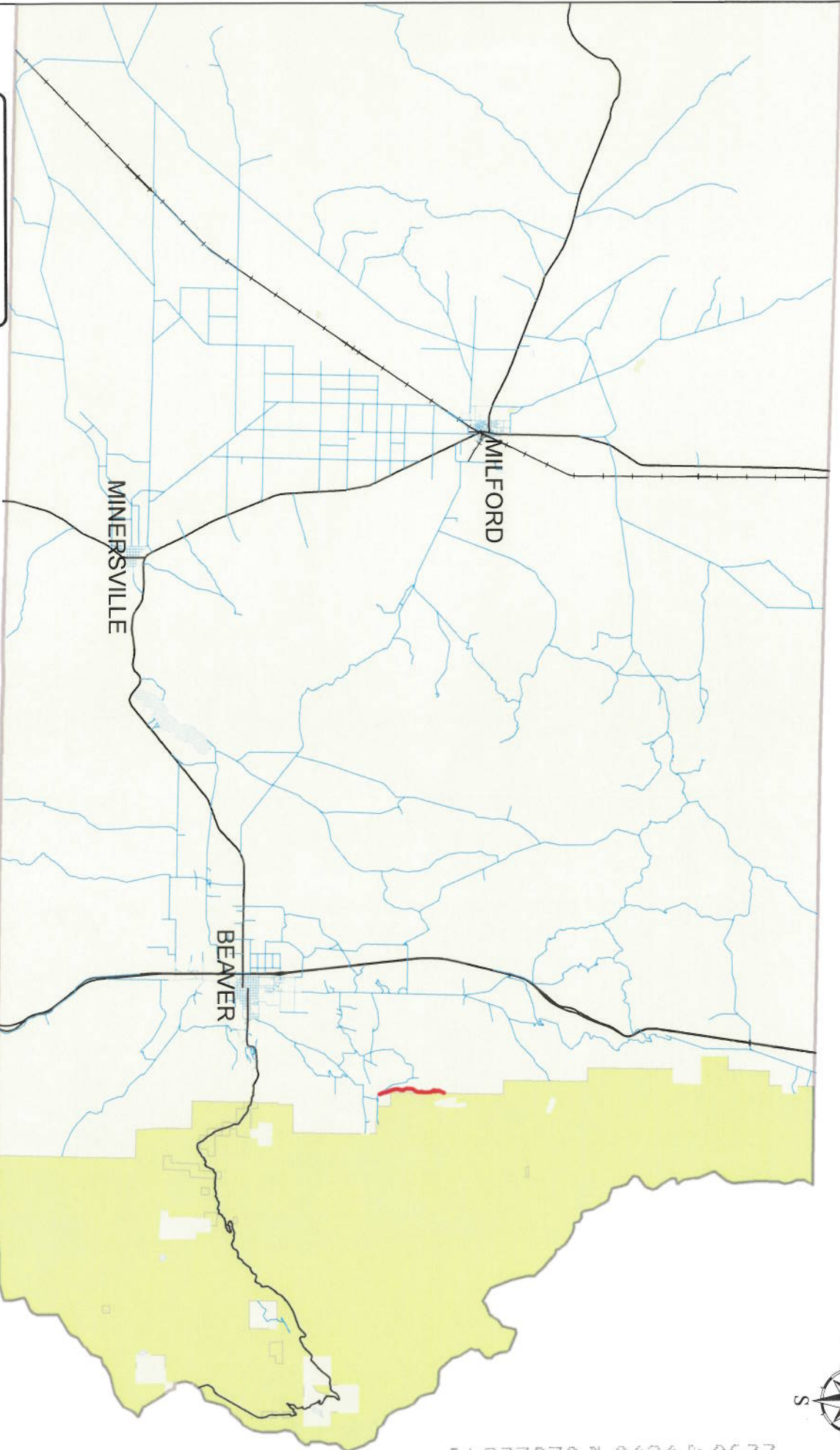

SHEEP ROCK ROAD B-61

MAP VIEW AREA



Legend

- Sheep Rock Rd (Red wavy line)
- County B Roads (Blue line)
- State Highways (Black line)
- UPRR (Black line with cross-ticks)

AFFIDAVIT OF WENDELL GREEN

SHEEP ROCK ROAD

BEAVER COUNTY, UTAH

ROAD NUMBER B-61

State of Utah)
 : ss.
County of Beaver)

WENDELL GREEN, being first duly sworn, deposes and states as follows:

1. I am an adult competent to testify about the matters set forth below based upon my personal knowledge. I currently reside in Beaver, Beaver County, Utah. I have lived in Beaver County my entire life.

2. I have traveled and am familiar with a road in Beaver County known as Sheep Rock Road. I am also familiar with the land the road traverses. When I first used and observed the road in 1938, it followed the same route as in 2007 when I last observed it. Attached is a Beaver County map showing Sheep Rock Road. To the best of my knowledge and based upon my use of and familiarity with this road and the land it traverses, the location and route of the road are correctly illustrated on the attached map.

3. I am informed that the County also identifies this road according to the road number listed above.

4. I have observed that the road has been open to the public for all to use, to come and go as they pleased, since at least as early as 1938 and continuing through 1976 to 2007. Throughout this time period I have observed travel on the road by means of pickup trucks, cars and ATVs. Throughout the time period from 1938 to 2007 the road has been used daily.

5. Throughout the time period from 1938 to 2007, I have used the road myself for livestock operations, hunting and access to forest service property.

6. Throughout the time period described in the previous paragraph, I have observed

other vehicles from the general public using the road at various times for the uses described in the previous paragraph plus recreation and wood gathering.

7. It is also the reputation in the community that this road has been open to the public for all to use, to come and go as they pleased, since at least as early as the early 1900s and continuing through 1976 to the present, for the uses described in the previous paragraphs.

8. Prior to 1976, I observed graders performing maintenance and construction activities on the road.

DATED this 30 day of January, 2007.

Wendell Green
WENDELL GREEN

SUBSCRIBED AND SWORN to before me this 30th day of January, 2007.

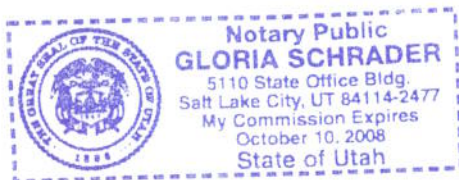

Gloria Schrader
NOTARY PUBLIC

BEAVER COUNTY "B" ROADS

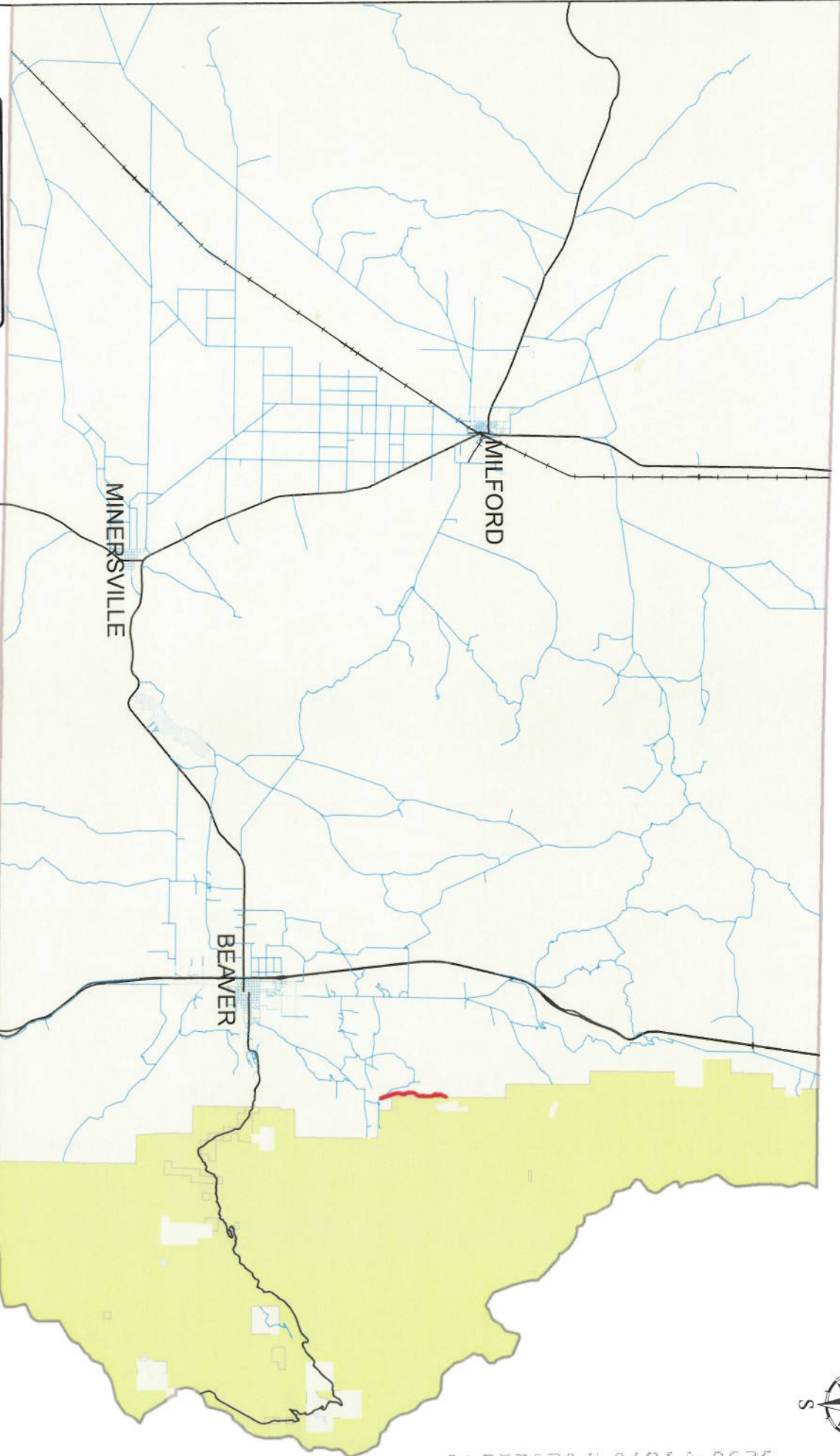

SHEEP ROCK ROAD B-61

Legend

- Sheep Rock Rd (Red wavy line)
- County B Roads (Light blue line)
- State Highways (Black line)
- UPRR (Black line with cross-ticks)

MAP VIEW AREA

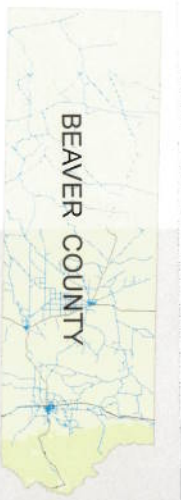

Exhibit B

Beginning & Ending Points and Township, Range, and Section References For:

Popular Name: SHEEP ROCK ROAD

County: Beaver

County Road Number: B-61

State Geographic Information Database (SGID) Road Identification Number: RD010148.

Total Road Length: 2.54 miles more or less.

Beginning at a point on the road centerline located at 38 degrees 20 minutes 45.15 seconds North Latitude and -112 degrees 34 minutes 19.54 seconds West Longitude, which can be converted to mapping accuracy State Plane Utah South Zone NAD 83 feet coordinates of X = 1,332,941.3 feet and Y = 10,455,712.9 feet based on the US Survey Foot conversion.

Ending at a point on the road centerline located at 38 degrees 22 minutes 46.06 seconds North Latitude and -112 degrees 34 minutes 24.32 seconds West Longitude, which can be converted to mapping accuracy State Plane Utah South Zone NAD 83 feet coordinates of X = 1,332,701.6 feet and Y = 10,467,947.4 feet based on the US Survey Foot conversion.

This road may traverse:

Township 28 South Range 6 West, Section(s) 18,19,30, Salt Lake Base & Meridian