

**Supplement to Amended Acknowledgment and
Amended Notice of Acknowledgment
of Acceptance of R.S. 2477
Right-of-Way Grant**

THE STATE OF UTAH

TO ALL WHOM THESE PRESENTS SHALL COME, Greeting:

This Supplement to Amended Acknowledgment and Amended Notice of Acknowledgment and the affidavits attached hereto as Exhibit A supplement and support the Amended Acknowledgment and Amended Notice of Acknowledgment, previously made under Utah Code Sections 72-5-309 through 310 inclusive, as it pertains to the highway located in Beaver County known as SOUTH FORK NORTH CREEK ROAD; County Road Number: B-62; State Geographic Information Database (SGID) Road Identification Number: RD010149.

This document supplements and supports the information contained in the document first recorded at **Ent 232887, Bk 408, Beg Pg 870**, as modified by the Amended Acknowledgment and Amended Notice of Acknowledgment recorded on **February 15, 2008** at **Ent 235867, Bk 418, Beg Pg 850**. A legal description is attached hereto as Exhibit B.

In Witness Whereof, I, John Harja, the official designee of the Governor of the State of Utah, in conformity to the laws of the State (Utah Code Sections 72-5-308 through 310 inclusive), have caused this Supplement to Amended Acknowledgment and Amended Notice of Acknowledgment to be made.

Signed by my hand in Salt Lake City, Utah, the 27th day of June, 2008.

By the Governor's Designee



John Harja

Ent 237071 Bk 424 Pg 638
Date: 02-JUL-2008 3:25PM
Fee: None
Filed By: RBB
BRUCE BROWN, Recorder
BEAVER COUNTY CORPORATION
For: STATE OF UTAH

CERTIFICATION

State of Utah)
: ss
County of Salt Lake)

I hereby certify that the signer of the foregoing document, John Harja, is personally known by me, has made a voluntary signature and taken an oath stating that he is the official designee of the Governor of the State of Utah and is authorized to sign this document on the Governor's behalf pursuant to Utah Code Section 72-5-309. He further vouched that, based upon information and belief, the facts alleged therein are true.

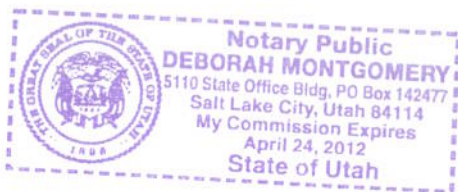

Dated this 27th day of June, 2008.

Notary Public

Exhibit A

AFFIDAVIT OF GLENNA PUFFER
SOUTH FORK NORTH CREEK ROAD
BEAVER COUNTY, UTAH
ROAD NUMBER B-62

State of Utah)
 : ss.
County of Beaver)

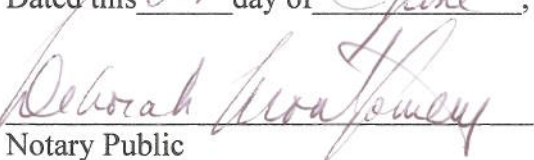
GLENNA PUFFER, being first duly sworn, deposes and states as follows:

1. I am an adult competent to testify about the matters set forth below based upon my personal knowledge. I currently reside in Beaver, Beaver County, Utah. I have lived in Beaver County my entire life.

2. I have traveled and am familiar with a road in Beaver County known as South Fork North Creek Road. I am also familiar with the land the road traverses. When I first used and observed the road in 1945, it followed the same route as in 2007 when I last observed it. Attached is a Beaver County map showing South Fork North Creek Road. To the best of my knowledge and based upon my use of and familiarity with this road and the land it traverses, the location and route of the road are correctly illustrated on the attached map.

3. I am informed that the County also identifies this road according to the road number listed above.

4. I have observed that the road has been open to the public for all to use, to come and go as they pleased, since at least as early as 1945 and continuing through 1976 to 2007. Throughout this time period I have observed travel on the road by means of pickup trucks, cars and ATVs. Throughout the time period from 1945 to 2007 the road has been used daily.

5. Throughout the time period from 1945 to 2007, I have used the road myself for livestock operations, wood gathering and traveling in and through the area.

6. Throughout the time period described in the previous paragraph, I have observed

other vehicles from the general public using the road at various times for the uses described in the previous paragraph plus mining, hunting, government access and accessing private property. It is also the reputation in the community that this road has been open to the public for all to use, to come and go as they pleased, since at least as early as the late 1800s and continuing through 1976 to the present, for the uses described in the previous paragraphs.

8. Prior to 1976, I observed graders performing maintenance and construction activities on the road.

DATED this 30 day of January, 2007.



GLENNA PUFFER

SUBSCRIBED AND SWORN to before me this 30th day of January, 2007.

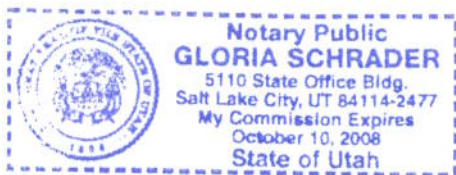



NOTARY PUBLIC

BEAVER COUNTY "B" ROADS

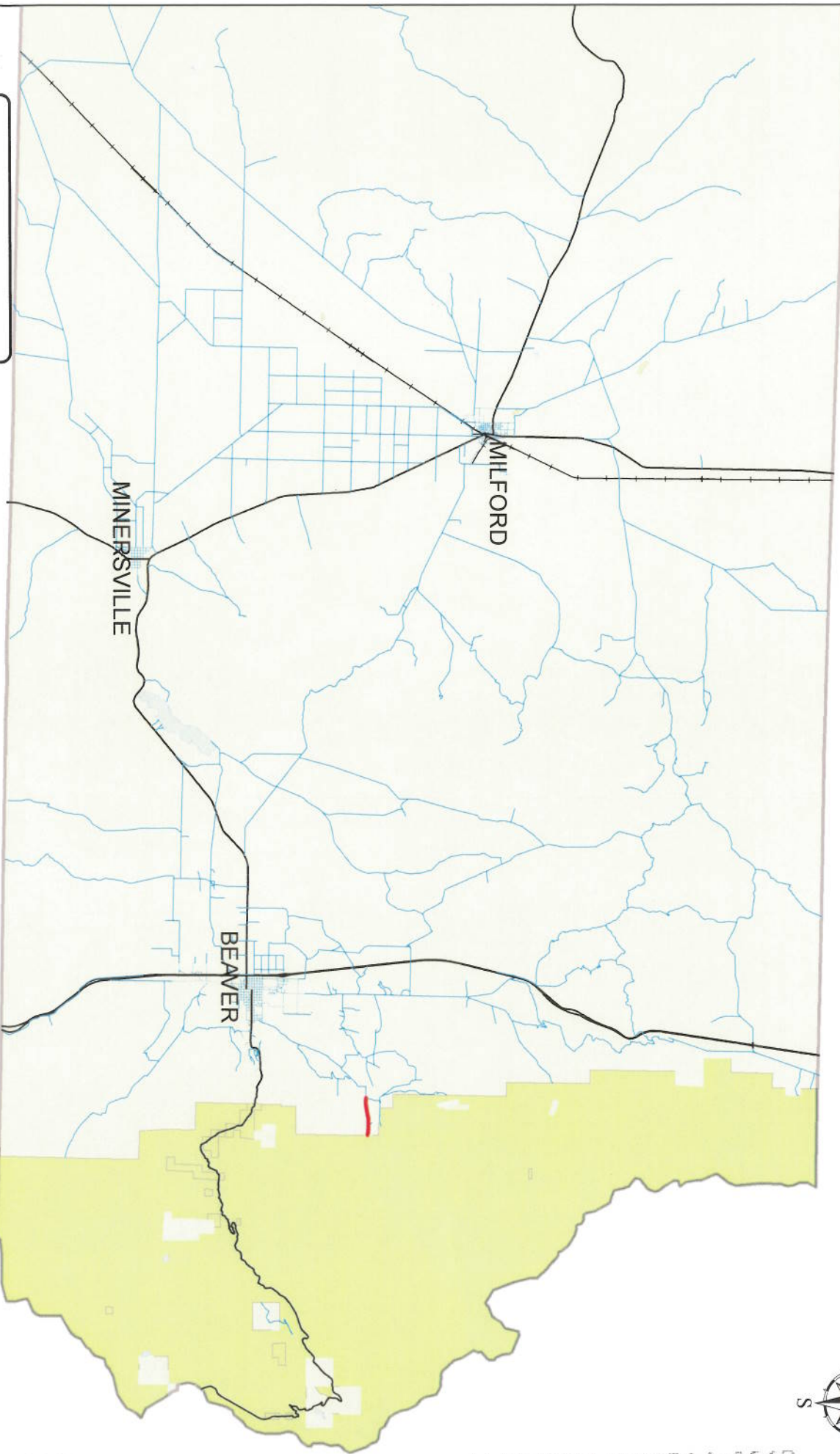

Legend

- So Fork North Creek
- County B Roads
- State Highways
- UPRR

SO. FORK NORTH CREEK B-62



AFFIDAVIT OF WENDELL GREEN
SOUTH FORK NORTH CREEK ROAD
BEAVER COUNTY, UTAH
ROAD NUMBER B-62

State of Utah)
 : ss.
County of Beaver)

WENDELL GREEN, being first duly sworn, deposes and states as follows:

1. I am an adult competent to testify about the matters set forth below based upon my personal knowledge. I currently reside in Beaver, Beaver County, Utah. I have lived in Beaver County my entire life.

2. I have traveled and am familiar with a road in Beaver County known as South Fork North Creek Road. I am also familiar with the land the road traverses. When I first used and observed the road in 1938, it followed the same route as in 2007 when I last observed it. Attached is a Beaver County map showing South Fork North Creek Road. To the best of my knowledge and based upon my use of and familiarity with this road and the land it traverses, the location and route of the road are correctly illustrated on the attached map.

3. I am informed that the County also identifies this road according to the road number listed above.

4. I have observed that the road has been open to the public for all to use, to come and go as they pleased, since at least as early as 1938 and continuing through 1976 to 2007. Throughout this time period I have observed travel on the road by means of pickup trucks, cars and ATVs. Throughout the time period from 1938 to 2007 the road has been used daily.

5. Throughout the time period from 1938 to 2007, I have used the road myself for livestock operations, hunting and access to forest service property.

6. Throughout the time period described in the previous paragraph, I have observed

other vehicles from the general public using the road at various times for the uses described in the previous paragraph plus recreation and wood gathering.

7. It is also the reputation in the community that this road has been open to the public for all to use, to come and go as they pleased, since at least as early as the early 1900s and continuing through 1976 to the present, for the uses described in the previous paragraphs.

8. Prior to 1976, I observed graders performing maintenance and construction activities on the road.

DATED this 30 day of January, 2007.

Wendell Green
WENDELL GREEN

SUBSCRIBED AND SWORN to before me this 30th day of January, 2007.

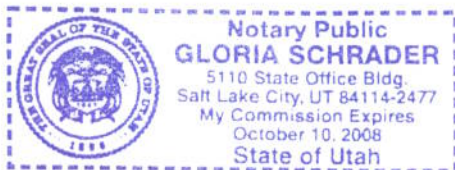

Gloria Schrader
NOTARY PUBLIC

BEAVER COUNTY "B" ROADS

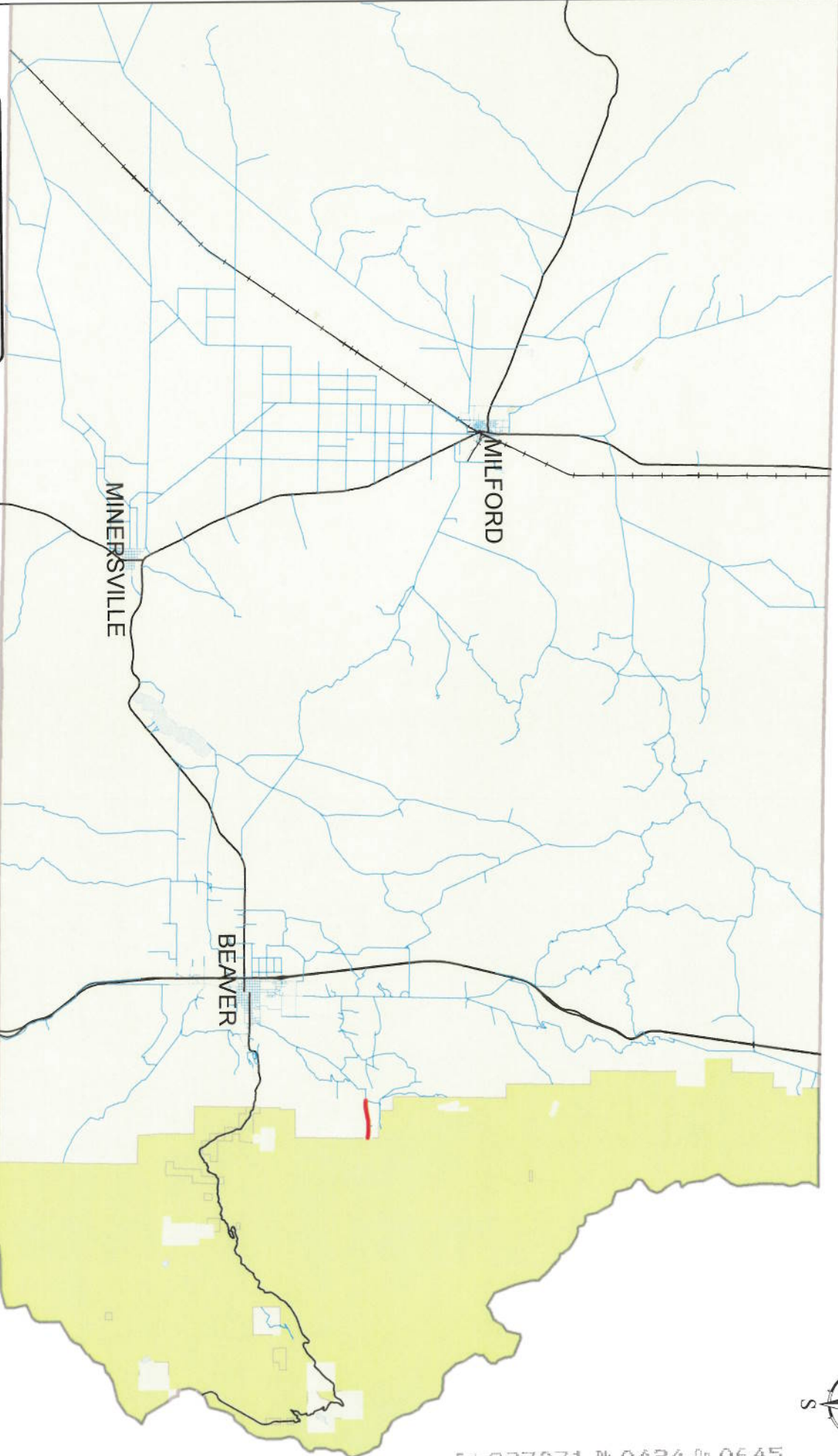

Legend

- So Fork North Creek
- County B Roads
- State Highways
- UPRR

SO. FORK NORTH CREEK B-62

MAP VIEW AREA



Exhibit B

Beginning & Ending Points and Township, Range, and Section References For:

Popular Name: SOUTH FORK NORTH CREEK ROAD

County: Beaver

County Road Number: B-62

State Geographic Information Database (SGID) Road Identification Number: RD010149.

Total Road Length: 1.35 miles more or less.

Beginning at a point on the road centerline located at 38 degrees 20 minutes 15.29 seconds North Latitude and -112 degrees 34 minutes 14.33 seconds West Longitude, which can be converted to mapping accuracy State Plane Utah South Zone NAD 83 feet coordinates of X = 1,333,322.0 feet and Y = 10,452,687.2 feet based on the US Survey Foot conversion.

Ending at a point on the road centerline located at 38 degrees 20 minutes 19.22 seconds North Latitude and -112 degrees 32 minutes 45.69 seconds West Longitude, which can be converted to mapping accuracy State Plane Utah South Zone NAD 83 feet coordinates of X = 1,340,388.8 feet and Y = 10,453,004.5 feet based on the US Survey Foot conversion.

This road may traverse:

Township 28 South Range 6 West, Section(s) 28,29,30, Salt Lake Base & Meridian