

Supplement to Amended Acknowledgment and Amended Notice of Acknowledgment of Acceptance of R.S. 2477 Right-of-Way Grant

THE STATE OF UTAH

TO ALL WHOM THESE PRESENTS SHALL COME, Greeting:

This Supplement to Amended Acknowledgment and Amended Notice of Acknowledgment and the affidavits attached hereto as Exhibit A supplement and support the Amended Acknowledgment and Amended Notice of Acknowledgment, previously made under Utah Code Sections 72-5-309 through 310 inclusive, as it pertains to the highway located in Beaver County known as SOUTH LAKE ACCESS II; County Road Number: B-88; State Geographic Information Database (SGID) Road Identification Number: RD010168.

This document supplements and supports the information contained in the document first recorded at **Ent 232889, Bk 409, Beg Pg 7**, as modified by the Amended Acknowledgment and Amended Notice of Acknowledgment recorded on **February 15, 2008** at **Ent 235886, Bk 419, Beg Pg 81**. A legal description is attached hereto as Exhibit B.

In Witness Whereof, I, John Harja, the official designee of the Governor of the State of Utah, in conformity to the laws of the State (Utah Code Sections 72-5-308 through 310 inclusive), have caused this Supplement to Amended Acknowledgment and Amended Notice of Acknowledgment to be made.

Signed by my hand in Salt Lake City, Utah, the 27th day of June, 2008.

By the Governor's Designee

John Harja

Ent 237085 Bk 424 Pg 764
Date: 02-JUL-2008 3:49PM
Fee: None
Filed By: RBB
BRUCE BROWN, Recorder
BEAVER COUNTY CORPORATION
For: STATE OF UTAH

CERTIFICATION

State of Utah)
 : ss
County of Salt Lake)

I hereby certify that the signer of the foregoing document, John Harja, is personally known by me, has made a voluntary signature and taken an oath stating that he is the official designee of the Governor of the State of Utah and is authorized to sign this document on the Governor's behalf pursuant to Utah Code Section 72-5-309. He further vouched that, based upon information and belief, the facts alleged therein are true.

Dated this 27th day of June, 2008.

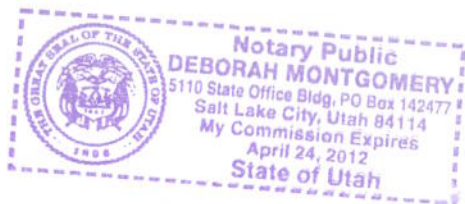



Notary Public

Exhibit A

AFFIDAVIT OF RONDO FARRER
SOUTH LAKE ACCESS II ROAD
BEAVER COUNTY, UTAH
ROAD NUMBER B-88

State of Utah)
 : ss.
County of Beaver)

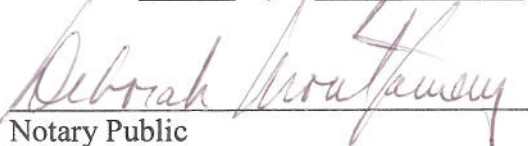
RONDO FARRER, being first duly sworn, deposes and states as follows:

1. I am an adult competent to testify about the matters set forth below based upon my personal knowledge. I currently reside in Beaver, Beaver County, Utah. I have lived in Beaver County my entire life.

2. I have traveled and am familiar with a road in Beaver County known as South Lake Access II Road. I am also familiar with the land the road traverses. When I first used and observed the road in 1940, it followed the same route as in 2006 when I last observed it. Attached is a Beaver County map showing South Lake Access II Road. To the best of my knowledge and based upon my use of and familiarity with this road and the land it traverses, the location and route of the road are correctly illustrated on the attached map.

3. I am informed that the County also identifies this road according to the road number listed above.

4. I have observed that the road has been open to the public for all to use, to come and go as they pleased, since at least as early as 1940 and continuing through 1976 to 2006. Throughout this time period I have observed travel on the road by means of ATVs, pickup trucks and horses. Throughout the time period from 1940 to 2006, the road was used daily, weather permitting.

5. Through out the time period from 1940 to 2006 I have used the road myself for hunting and fishing.

6. Throughout the time period described in the previous paragraph, I have observed other vehicles from the general public using the road at various times for the uses described in the previous paragraph, plus livestock operations.

7. It is also the reputation in the community that this road has been open to the public for all to use, to come and go as they pleased, since at least as early as the early 1900s and continuing through 1976 to the present, for the uses described in the previous paragraphs.

8. Prior to 1976, I observed the graded surface of the road.

DATED this 30th day of January, 2007.



RONDO FARRER

SUBSCRIBED AND SWORN to before me this 30th day of January, 2007.

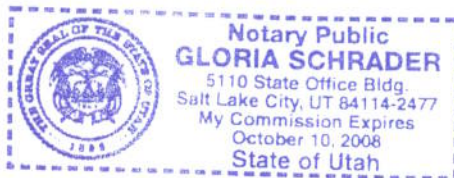



NOTARY PUBLIC

BEAVER COUNTY "B" ROADS



Legend

- South Lake Access II (Red line)
- County B Roads (Blue line)
- State Highways (Black line)
- UPRR (Black line with cross-ticks)

SOUTH LAKE ACCESS II ROAD

B-88

MAP VIEW AREA



AFFIDAVIT OF CRAIG DAVIS
SOUTH LAKE ACCESS II ROAD
BEAVER COUNTY, UTAH
ROAD NUMBER B-88

State of Utah)
 : ss.
County of Beaver)

CRAIG DAVIS, being first duly sworn, deposes and states as follows:

1. I am an adult competent to testify about the matters set forth below based upon my personal knowledge. I currently reside in Beaver, Beaver County, Utah. I have lived in Beaver County my entire life.

2. I have traveled and am familiar with a road in Beaver County known as South Lake Access II Road. I am also familiar with the land the road traverses. When I first used and observed the road in 1966, it followed the same route as in 2006 when I last observed it. Attached is a Beaver County map showing South Lake Access II Road. To the best of my knowledge and based upon my use of and familiarity with this road and the land it traverses, the location and route of the road are correctly illustrated on the attached map.

3. I am informed that the County also identifies this road according to the road number listed above.

4. I have observed that the road has been open to the public for all to use, to come and go as they pleased, since at least as early as 1966 and continuing through 1976 to the present. Throughout this time period I have observed travel on the road by means of cars, pickup trucks and jeeps. Throughout this time period, the road has been used daily, weather permitting.

5. Throughout the time period from 1966 to 2006, I have used the road myself for fishing, recreation and traveling in and through the area.

6. Throughout the time period described in the previous paragraph, I have observed

other vehicles from the general public using the road at various times for the uses described in the previous paragraph, plus rock hounding, livestock operations and government access.

7. It is also the reputation in the community that this road has been open to the public for all to use, to come and go as they pleased, since at least as early as the 1950s and continuing through 1976 to the present, for the uses described in the previous paragraphs.

8. Prior to 1976, I observed graders performing maintenance and construction activities on the road.

DATED this 30 day of January, 2007.

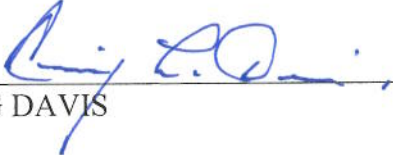

CRAIG DAVIS

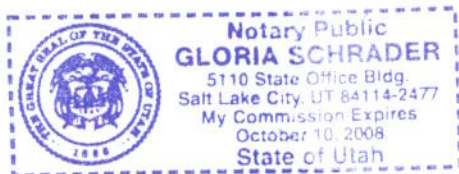
SUBSCRIBED AND SWORN to before me this 30th day of January, 2007.

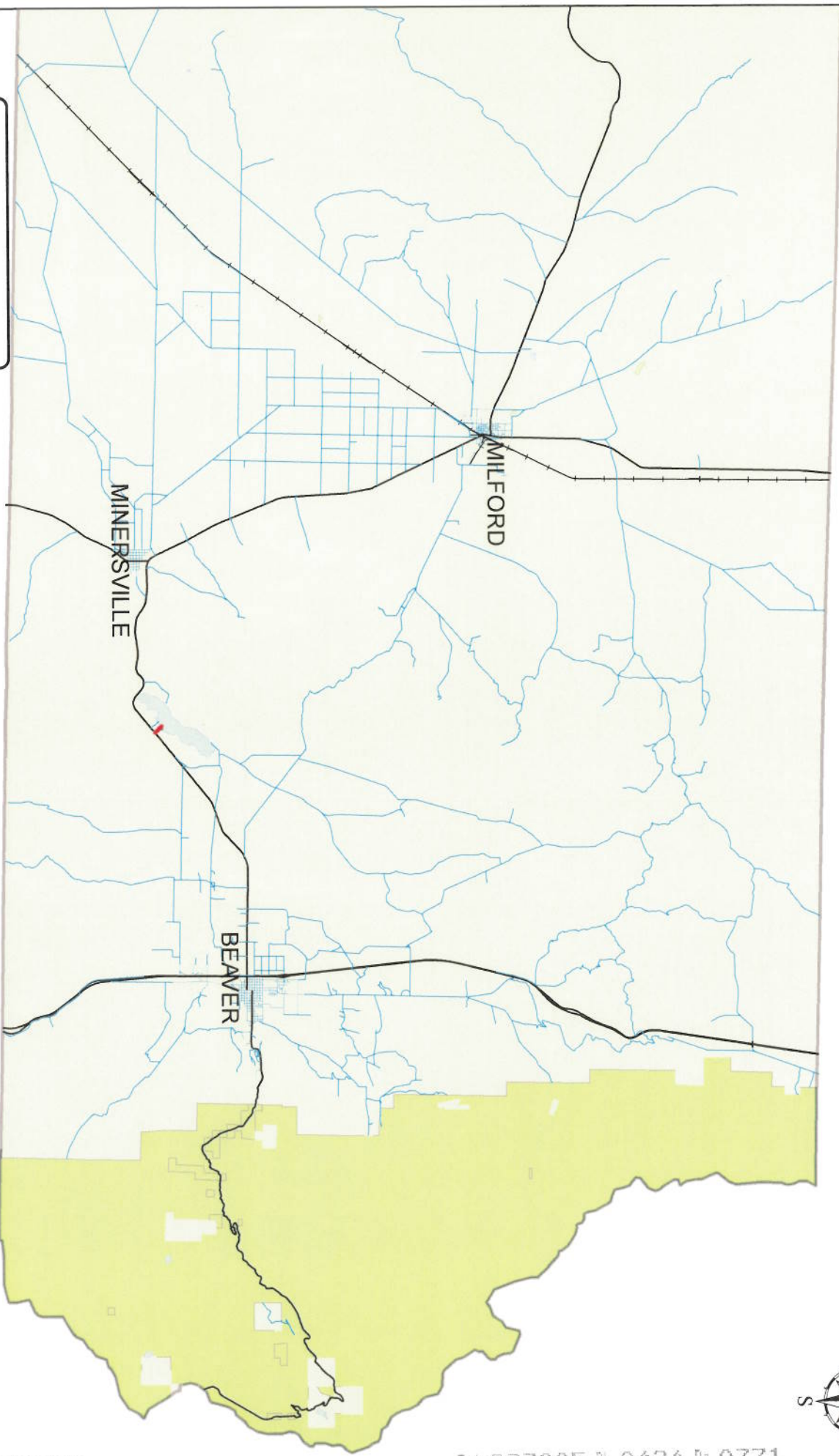

NOTARY PUBLIC

BEAVER COUNTY "B" ROADS



Legend

- South Lake Access II
- County B Roads
- State Highways
- UPRR

SOUTH LAKE ACCESS II ROAD B-88

MAP VIEW AREA

BEAVER COUNTY

Exhibit B

Beginning & Ending Points and Township, Range, and Section References For:

Popular Name: SOUTH LAKE ACCESS II

County: Beaver

County Road Number: B-88

State Geographic Information Database (SGID) Road Identification Number: RD010168.

Total Road Length: 0.33 miles more or less.

Beginning at a point on the road centerline located at 38 degrees 13 minutes 28.74 seconds North Latitude and -112 degrees 48 minutes 38.18 seconds West Longitude, which can be converted to mapping accuracy State Plane Utah South Zone NAD 83 feet coordinates of X = 1,263,922.7 feet and Y = 10,412,440.7 feet based on the US Survey Foot conversion.

Ending at a point on the road centerline located at 38 degrees 13 minutes 40.76 seconds North Latitude and -112 degrees 48 minutes 53.55 seconds West Longitude, which can be converted to mapping accuracy State Plane Utah South Zone NAD 83 feet coordinates of X = 1,262,713.3 feet and Y = 10,413,674.6 feet based on the US Survey Foot conversion.

This road may traverse:

Township 30 South Range 9 West, Section(s) 1, Salt Lake Base & Meridian