

**Amended Acknowledgment and
Amended Notice of Acknowledgment
of Acceptance of R.S. 2477
Right-of-Way Grant**

THE STATE OF UTAH

TO ALL WHOM THESE PRESENTS SHALL COME, Greeting:

Know ye, This is an Amended Acknowledgment and Amended Notice of Acknowledgment made under Utah Code Sections 72-5-309 through 310 inclusive, that the grant of the United States of America of “the right of way for the construction of highways over public lands, not reserved for public uses” under United States Revised Statutes 2477 (43 U.S.C. Section 932 (repealed October 21, 1976, with proviso recognizing the validity of rights-of-way already established)) was accepted for and on behalf of the State of Utah and its political subdivision Box Elder County as it pertains to the highway located in Box Elder County known as Cedar Hill Road; County Road Number: 101; State Geographic Information Database (SGID) Road Identification Number: RD020006. Total road length is 5.37 miles more or less.

This Amended Acknowledgment and Amended Notice of Acknowledgment supersedes the information contained in the Acknowledgment recorded at Ent 238484, Bk 988, Beg Pg 483.

The reason for this Amended Acknowledgment and Amended Notice of Acknowledgment includes, but is not limited to, the fact that the road was constructed, mechanically, or by continuous use as a public highway for a period of at least ten years, over public lands not reserved for public uses, prior to the earlier of (a) the October 21, 1976 repeal of R.S. 2477 or (b) the date the servient estate was reserved for public uses.

This Amended Acknowledgment and Amended Notice of Acknowledgment applies only to the segments of the road that traverse land owned by the Bureau of Land Management, United States Department of the Interior, and does not apply to segments of the road that traverse land owned by any other person or entity. The State of Utah and its political subdivisions reserve the right to make further acknowledgments and notices of acknowledgment with regard to road segments that traverse land owned by other entities, including the United States of America, through one or more of its agencies.

A printed copy of a map showing the location of the road in said county is appended hereto as “Attachment 1,” a printed copy of representative photos of the road is appended hereto as “Attachment 2,” a printed copy of a description of the beginning and ending points of the entire road together with a list of Townships, Ranges and Sections that may be traversed by the road in said county is appended hereto as “Attachment 3,” and a printed copy of the Road Centerline Description Cover Page(s) is appended hereto as “Attachment 4.” The Appendices listed in “Attachment 4” that contain the actual road centerline descriptions are incorporated herein by reference.

A printed copy of this Amended Acknowledgment and Amended Notice of Acknowledgment, together with its Attachments and Appendices, may be viewed and/or obtained at the office of the Utah State Archives.

An electronic copy of this Amended Acknowledgment and Amended Notice of Acknowledgment, together with its Attachments and Appendices, may be viewed and/or downloaded as read-only PDF (Portable Document Format) files via the Internet at <http://recorded2477roads.utah.gov>.

The owner of the servient estate in the land underlying the road-segments subject to this Amended Acknowledgment and Amended Notice is believed to be the United States of America through one or more of its agencies. Any of such agencies or any other person with a servient ownership claim or a competing dominant estate right-of-way ownership claim, may file a petition in the State District Court for Salt Lake County for a decision regarding the correctness of this Amended Acknowledgment. A claimant shall file a petition within sixty (60) days after receipt of this Notice.

In Witness Whereof, I, John Harja, the official designee of the Governor of the State of Utah, in conformity to the laws of the State (Utah Code Sections 72-5-308 through 310 inclusive), have caused this Amended Acknowledgment and Amend Notice of Acknowledgment to be made.

Signed by my hand in Salt Lake City, Utah, the 15th day of November, 2007.

By the Governor's Designee



John Harja

CERTIFICATION

State of Utah)
 : ss
County of Salt Lake)

I hereby certify that the signer of the foregoing document, John Harja, is personally known by me, has made a voluntary signature and taken an oath stating that he is the official designee of the Governor of the State of Utah and is authorized to sign this document on the Governor's behalf pursuant to Utah Code Section 72-5-309. He further vouched that, based upon information and belief, the facts alleged therein are true.

Dated this 15th day of November, 2007.



Pamela Z. Blackham
Notary Public

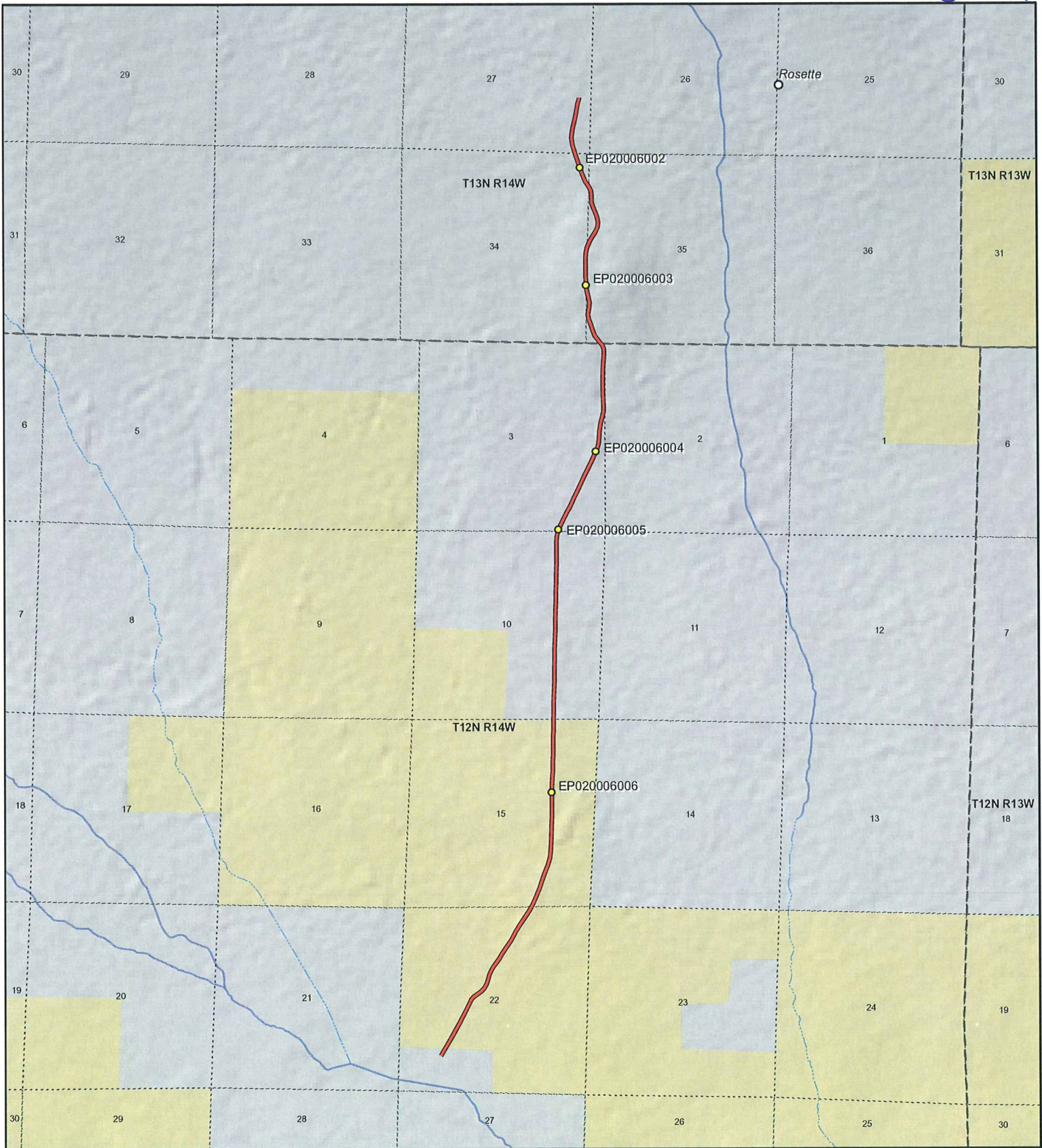

Cedar Hill Road - Box Elder County
SGID RD_ID RD020006

Land Ownership Categories		Transportation Network
BLM	Wilderness	Cedar Hill Road
Private	UDWR Wildlife Reserve	Title V: Issued Or Under Consideration By BLM Or County
SITLA, State Trust Land	DOD, Military	Other Roads
USFS, National Forest	State Sovereign Land	Photo Event Point
State Parks and Recreation	National Recreation Area	Section = 1 Mile
Tribal, Indian Reservation	USFWS, Natl. Wildlife Refuge	
NPS, National Park		

Map prepared by the State of Utah
Automated Geographic Reference Center
Room 5130 State Office Building
Salt Lake City, Utah 84114
Nov 09, 2006



EP020006002



EP020006003



EP020006004



EP020006005



EP020006006

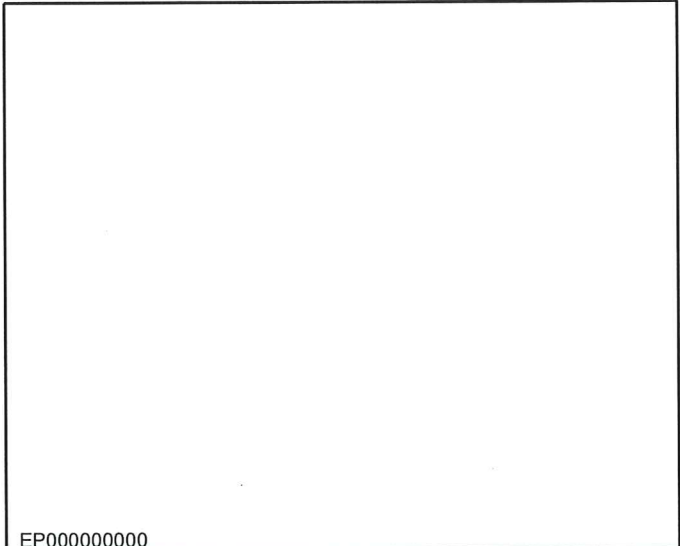

EP000000000

Cedar Hill Road - Box Elder County
SGID RD_ID RD020006

Map prepared by the State of Utah
Automated Geographic Reference Center
Room 5130 State Office Building
Salt Lake City, Utah 84114
November 9, 2006



Attachment 3

Beginning & Ending Points and Township, Range, and Section References For:

Popular Name: Cedar Hill Road

County: Box Elder

County Road Number: 101

State Geographic Information Database (SGID) Road Identification Number: RD020006.

Total Road Length: 5.37 miles more or less.

Beginning at a point on the road centerline located at 41 degrees 44 minutes 46.72 seconds North Latitude and -113 degrees 26 minutes 21.67 seconds West Longitude, which can be converted to mapping accuracy State Plane Utah North Zone NAD 83 feet coordinates of X = 1,111,221.0 feet and Y = 3,801,553.7 feet based on the US Survey Foot conversion.

Ending at a point on the road centerline located at 41 degrees 49 minutes 12.72 seconds North Latitude and -113 degrees 25 minutes 038.7 seconds West Longitude, which can be converted to mapping accuracy State Plane Utah North Zone NAD 83 feet coordinates of X = 1,115,075.0 feet and Y = 3,828,400.2 feet based on the US Survey Foot conversion.

This road may traverse:

Township 12 North Range 14 West, Section(s) 3,10,15,22, Salt Lake Base & Meridian
Township 13 North Range 14 West, Section(s) 27,34,35, Salt Lake Base & Meridian
See Attachment 1 above for a cartographic depiction of the course of this road.

Attachment 4
Road Centerline Description Cover Page(s)

Popular Name: Cedar Hill Road

County: Box Elder

County Road Number: 101

State Geographic Information Database (SGID) Road Identification Number: RD020006.

Total Road Length: 5.37 miles more or less.

Centerline Descriptions Of Road-Segments That Cross Over Federally Owned Land, Derived From Global Positioning System Data And Cross-checked against USGS Digital Orthophoto Quadrangles Compiled By The Utah Automated Geographic Reference Center And Entered Into The State Geographic Information Database (SGID).

Road-Segments Listed by SGID Road Identification Number (RD ID)	Road-Segment Numbers	Believed Ownership Of Servient Estate	Approximate Segment Length	See Attached Appendix
RD020006	001	PVT	0.05 Miles	(not shown)
RD020006	002	BLM	1.9 Miles	A
RD020006	003	PVT	3.42 Miles	(not shown)
		Total Road Length	5.37	_____

* Indicates that a Title V permit will be requested, is in process, or has been issued.

† Indicates that road-segments crossing Forest Service land are under consideration by the state and county as of the date of this Amended Acknowledgment and Amended Notice of Acknowledgment.

Appendix A to Attachment 4

Popular Name: Cedar Hill Road

County: Box Elder

County Road Number: 101

State Geographic Information Database (SGID) Road Identification Number: RD020006.

Road-Segment Number: 002

Road-Segment Length: 1.9 miles more or less.

Believed owner of the land underlying this road-segment is: Bureau of Land Management.

The following description is based upon the geographic coordinate system using the NAD83 Datum. The source is GPS mapping grade data as indicated in the metadata and/or the transportation data model of the State of Utah Geographic Information Database (SGID).

The road-segment itself is the monument that is identified by its physical presence on the land. The location of said physical presence is closely approximated by mapping grade Global Positioning System (GPS) data. Said data are checked against the corresponding gray-scale 1-meter Digital Orthophoto Quadrangles published by the United States Geological Survey (USGS) to verify a reasonable degree of accuracy. In circumstances where accurate satellite signal acquisition is not possible, such as deep, narrow canyons or under a canopy of dense foliage, or where very sharp curves in the road make accuracy questionable, such portions of the road were digitized from the corresponding gray-scale 1-meter Digital Orthophoto Quadrangles published by the United States Geological Survey (USGS).

This road-segment may traverse:

Township 12 North Range 14 West, Section(s) 15,22, Salt Lake Base & Meridian

The following description closely approximates the location of the centerline of the physical monument (Cedar Hill Road)-- Segment 002 based on mapping grade Global Positioning System (GPS) data as defined above:

Beginning at a point on the road center line located at 41 degrees 44 minutes 48.82 seconds North Latitude and -113 degrees 26 minutes 20.12 seconds West Longitude, which can be converted to mapping accuracy State Plane Utah North Zone NAD 83 feet coordinates of X = 1,111,343.2 feet and Y = 3,801,764.3 feet; thence the following courses along the said road center line:

thence North 30 Degrees 58 Minutes 20 Seconds East	100 feet
thence North 29 Degrees 49 Minutes 29 Seconds East	142.3 feet
thence North 29 Degrees 50 Minutes 43 Seconds East	146.1 feet
thence North 29 Degrees 08 Minutes 20 Seconds East	152.6 feet
thence North 28 Degrees 56 Minutes 42 Seconds East	154.2 feet
thence North 28 Degrees 40 Minutes 10 Seconds East	140.7 feet
thence North 27 Degrees 54 Minutes 13 Seconds East	124.8 feet
thence North 28 Degrees 29 Minutes 33 Seconds East	118.3 feet
thence North 27 Degrees 59 Minutes 12 Seconds East	118.9 feet
thence North 27 Degrees 16 Minutes 00 Seconds East	120.3 feet
thence North 27 Degrees 38 Minutes 00 Seconds East	118.9 feet
thence North 28 Degrees 34 Minutes 09 Seconds East	118.1 feet

thence North 37 Degrees 41 Minutes 03 Seconds East 116.6 feet
 thence North 56 Degrees 03 Minutes 06 Seconds East 118.6 feet
 thence North 52 Degrees 16 Minutes 10 Seconds East 124.3 feet
 thence North 42 Degrees 58 Minutes 08 Seconds East 126.2 feet
 thence North 29 Degrees 59 Minutes 04 Seconds East 127.3 feet
 thence North 18 Degrees 58 Minutes 43 Seconds East 126.9 feet
 thence North 16 Degrees 54 Minutes 00 Seconds East 125 feet
 thence North 21 Degrees 15 Minutes 38 Seconds East 125.6 feet
 thence North 29 Degrees 42 Minutes 05 Seconds East 123.2 feet
 thence North 35 Degrees 38 Minutes 21 Seconds East 131.8 feet
 thence North 36 Degrees 49 Minutes 55 Seconds East 158.5 feet
 thence North 29 Degrees 48 Minutes 29 Seconds East 199.2 feet
 thence North 32 Degrees 17 Minutes 14 Seconds East 222 feet
 thence North 33 Degrees 32 Minutes 12 Seconds East 243 feet
 thence North 29 Degrees 57 Minutes 16 Seconds East 243.2 feet
 thence North 31 Degrees 35 Minutes 54 Seconds East 230 feet
 thence North 32 Degrees 18 Minutes 52 Seconds East 228 feet
 thence North 32 Degrees 54 Minutes 16 Seconds East 225.6 feet
 thence North 29 Degrees 07 Minutes 24 Seconds East 135.9 feet
 thence North 29 Degrees 07 Minutes 24 Seconds East 101.5 feet
 thence North 23 Degrees 25 Minutes 02 Seconds East 240.2 feet
 thence North 21 Degrees 18 Minutes 22 Seconds East 234.7 feet
 thence North 19 Degrees 38 Minutes 12 Seconds East 230.4 feet
 thence North 19 Degrees 24 Minutes 16 Seconds East 221.3 feet
 thence North 21 Degrees 36 Minutes 46 Seconds East 221.1 feet
 thence North 17 Degrees 34 Minutes 29 Seconds East 243.1 feet
 thence North 03 Degrees 51 Minutes 24 Seconds East 273 feet
 thence North 01 Degrees 41 Minutes 39 Seconds East 285.6 feet
 thence North 01 Degrees 47 Minutes 20 Seconds East 290.5 feet
 thence North 00 Degrees 33 Minutes 35 Seconds East 290.4 feet
 thence North 00 Degrees 16 Minutes 46 Seconds West 280.5 feet
 thence North 00 Degrees 25 Minutes 00 Seconds West 267.4 feet
 thence North 00 Degrees 59 Minutes 33 Seconds East 252.7 feet
 thence North 02 Degrees 19 Minutes 43 Seconds East 246 feet
 thence North 02 Degrees 21 Minutes 27 Seconds East 243.4 feet
 thence North 02 Degrees 03 Minutes 21 Seconds East 234.8 feet
 thence North 01 Degrees 21 Minutes 01 Seconds East 221.5 feet
 thence North 00 Degrees 11 Minutes 25 Seconds East 210 feet
 thence North 00 Degrees 02 Minutes 32 Seconds West 185.4 feet
 thence North 00 Degrees 13 Minutes 19 Seconds West 150.9 feet
 thence North 00 Degrees 37 Minutes 27 Seconds East 96.8 feet
 thence North 00 Degrees 23 Minutes 33 Seconds East 101.7 feet
 thence North 01 Degrees 09 Minutes 38 Seconds East 187.1 feet
 thence North 01 Degrees 08 Minutes 03 Seconds East 46.4 feet more or less to **the ending**

point at: 41 degrees 46 minutes 20.56 seconds North Latitude and -113 degrees 25 minutes 42.69 seconds West Longitude, which can be converted to mapping accuracy State Plane Utah North Zone NAD 83 feet coordinates of X = 1,114,385.7 feet and Y = 3,810,985.2 feet.