

**Amended Acknowledgment and
Amended Notice of Acknowledgment
of Acceptance of R.S. 2477
Right-of-Way Grant**

Ent 255657 Bk 1030 Pg 899
Date 19-Nov-2007 9:24AM Fee \$0.00
LuAnn Adams - Filed By la
Box Elder Co., UT
For GOVERNOR FOR THE STATE OF UTAH

THE STATE OF UTAH

TO ALL WHOM THESE PRESENTS SHALL COME, Greeting:

Know ye, This is an Amended Acknowledgment and Amended Notice of Acknowledgment made under Utah Code Sections 72-5-309 through 310 inclusive, that the grant of the United States of America of “the right of way for the construction of highways over public lands, not reserved for public uses” under United States Revised Statutes 2477 (43 U.S.C. Section 932 (repealed October 21, 1976, with proviso recognizing the validity of rights-of-way already established)) was accepted for and on behalf of the State of Utah and its political subdivision Box Elder County as it pertains to the highway located in Box Elder County known as Government Well Road; County Road Number: 124; State Geographic Information Database (SGID) Road Identification Number: RD020032. Total road length is 5.6 miles more or less.

This Amended Acknowledgment and Amended Notice of Acknowledgment supersedes the information contained in the Acknowledgment recorded at Ent 238497, Bk 988, Beg Pg 561.

The reason for this Amended Acknowledgment and Amended Notice of Acknowledgment includes, but is not limited to, the fact that the road was constructed, mechanically, or by continuous use as a public highway for a period of at least ten years, over public lands not reserved for public uses, prior to the earlier of (a) the October 21, 1976 repeal of R.S. 2477 or (b) the date the servient estate was reserved for public uses.

This Amended Acknowledgment and Amended Notice of Acknowledgment applies only to the segments of the road that traverse land owned by the Bureau of Land Management, United States Department of the Interior, and does not apply to segments of the road that traverse land owned by any other person or entity. The State of Utah and its political subdivisions reserve the right to make further acknowledgments and notices of acknowledgment with regard to road segments that traverse land owned by other entities, including the United States of America, through one or more of its agencies.

A printed copy of a map showing the location of the road in said county is appended hereto as “Attachment 1,” a printed copy of representative photos of the road is appended hereto as “Attachment 2,” a printed copy of a description of the beginning and ending points of the entire road together with a list of Townships, Ranges and Sections that may be traversed by the road in said county is appended hereto as “Attachment 3,” and a printed copy of the Road Centerline Description Cover Page(s) is appended hereto as “Attachment 4.” The Appendices listed in “Attachment 4” that contain the actual road centerline descriptions are incorporated herein by reference.

A printed copy of this Amended Acknowledgment and Amended Notice of Acknowledgment, together with its Attachments and Appendices, may be viewed and/or obtained at the office of the Utah State Archives.

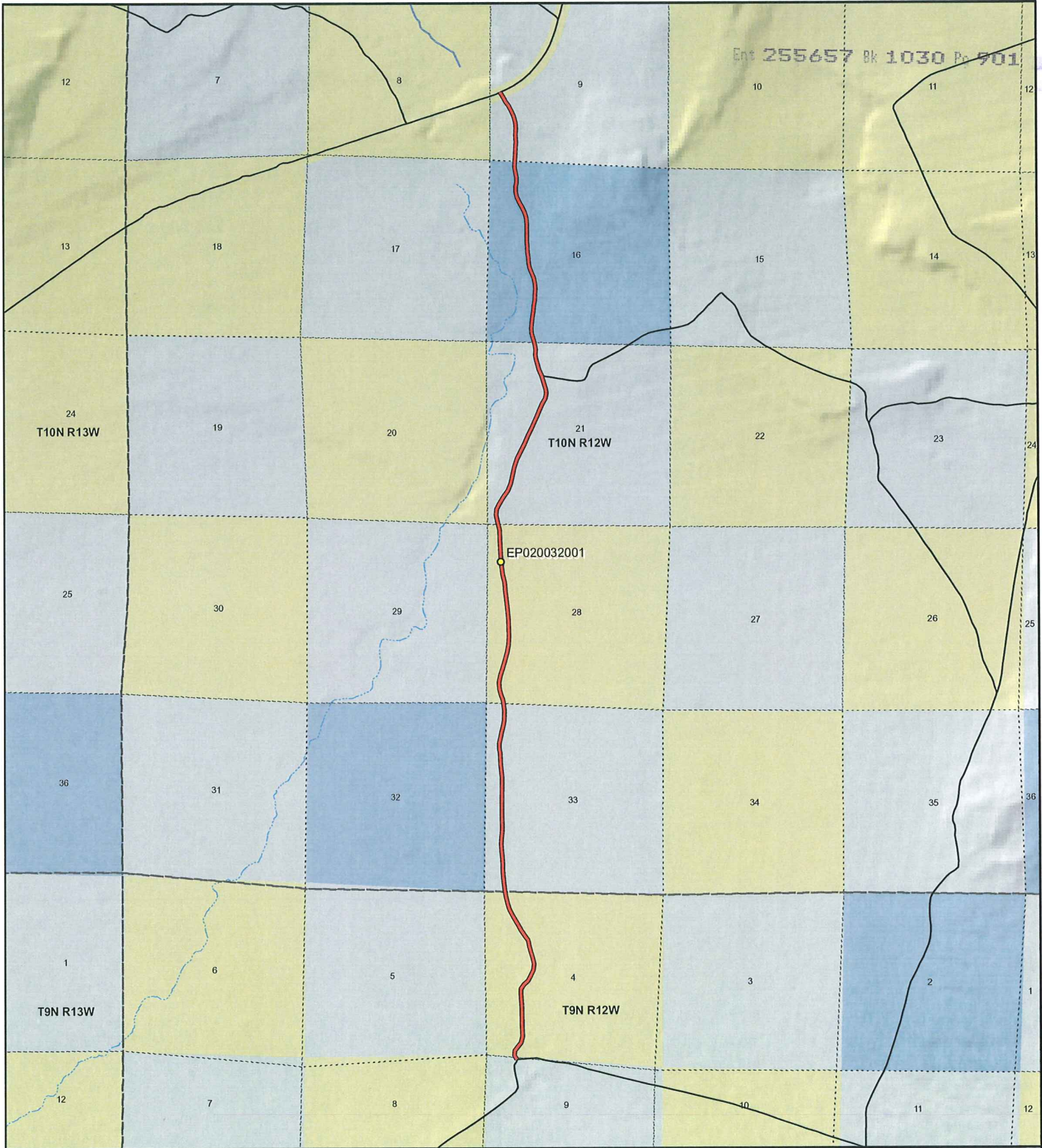

Ent 255657 Bk 1030 Pg 901



1:45,853

1 inch equals 0.7 miles

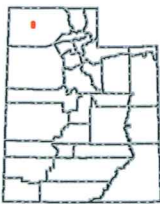

Government Well Road - Box Elder County
SGID RD_ID RD020032

Land Ownership Categories

- ◆ BLM
- ◆ Private
- ◆ SITLA, State Trust Land
- ◆ USFS, National Forest
- ◆ State Parks and Recreation
- ◆ Tribal, Indian Reservation
- ◆ NPS, National Park
- ◆ Wilderness
- ◆ UDWR Wildlife Reserve
- ◆ DOD, Military
- ◆ State Sovereign Land
- ◆ National Recreation Area
- ◆ USFWS, Natl. Wildlife Refuge

Transportation Network

- Government Well Road
- Title V: Issued Or Under Consideration By BLM Or County
- Other Roads
- Photo Event Point
- Section = 1 Mile

Map prepared by the State of Utah
 Automated Geographic Reference Center
 Room 5130 State Office Building
 Salt Lake City, Utah 84114
 Nov 09, 2006





EP020032001

EP000000000

EP000000000

EP000000000

EP000000000

EP000000000

Government Well Road - Box Elder County
SGID RD_ID RD020032

Map prepared by the State of Utah
Automated Geographic Reference Center
Room 5130 State Office Building
Salt Lake City, Utah 84114
November 9, 2006



Attachment 3

Beginning & Ending Points and Township, Range, and Section References For:

Popular Name: Government Well Road

County: Box Elder

County Road Number: 124

State Geographic Information Database (SGID) Road Identification Number: RD020032.

Total Road Length: 5.6 miles more or less.

Beginning at a point on the road centerline located at 41 degrees 31 minutes 39.08 seconds North Latitude and -113 degrees 13 minutes 34.01 seconds West Longitude, which can be converted to mapping accuracy State Plane Utah North Zone NAD 83 feet coordinates of X = 1,167,816.0 feet and Y = 3,720,619.9 feet based on the US Survey Foot conversion.

Ending at a point on the road centerline located at 41 degrees 36 minutes 19.59 seconds North Latitude and -113 degrees 13 minutes 48.45 seconds West Longitude, which can be converted to mapping accuracy State Plane Utah North Zone NAD 83 feet coordinates of X = 1,167,284.0 feet and Y = 3,749,028.4 feet based on the US Survey Foot conversion.

This road may traverse:

Township 10 North Range 12 West, Section(s) 9,16,21,28,33, Salt Lake Base & Meridian

Township 9 North Range 12 West, Section(s) 4,9, Salt Lake Base & Meridian

See Attachment 1 above for a cartographic depiction of the course of this road.

Attachment 4
Road Centerline Description Cover Page(s)

Popular Name: Government Well Road

County: Box Elder

County Road Number: 124

State Geographic Information Database (SGID) Road Identification Number: RD020032.

Total Road Length: 5.6 miles more or less.

Centerline Descriptions Of Road-Segments That Cross Over Federally Owned Land, Derived From Global Positioning System Data And Cross-checked against USGS Digital Orthophoto Quadrangles Compiled By The Utah Automated Geographic Reference Center And Entered Into The State Geographic Information Database (SGID).

Road-Segments Listed by SGID Road Identification Number (RD ID)	Road-Segment Numbers	Believed Ownership Of Servient Estate	Approximate Segment Length	See Attached Appendix
RD020032	001	PVT	0.02 Miles	(not shown)
RD020032	002	BLM	0.99 Miles	A
RD020032	003	PVT	1.05 Miles	(not shown)
RD020032	004	BLM	1.01 Miles	B
RD020032	005	PVT	1.09 Miles	(not shown)
RD020032	006	ST	1.03 Miles	(not shown)
RD020032	007	PVT	0.37 Miles	(not shown)
RD020032	008	BLM	0.04 Miles	C
		Total Road Length	5.6	_____

* Indicates that a Title V permit will be requested, is in process, or has been issued.

† Indicates that road-segments crossing Forest Service land are under consideration by the state and county as of the date of this Amended Acknowledgment and Amended Notice of Acknowledgment.

Appendix A to Attachment 4

Popular Name: Government Well Road

County: Box Elder

County Road Number: 124

State Geographic Information Database (SGID) Road Identification Number: RD020032.

Road-Segment Number: 002

Road-Segment Length: 0.99 miles more or less.

Believed owner of the land underlying this road-segment is: Bureau of Land Management.

The following description is based upon the geographic coordinate system using the NAD83 Datum. The source is GPS mapping grade data as indicated in the metadata and/or the transportation data model of the State of Utah Geographic Information Database (SGID).

The road-segment itself is the monument that is identified by its physical presence on the land. The location of said physical presence is closely approximated by mapping grade Global Positioning System (GPS) data. Said data are checked against the corresponding gray-scale 1-meter Digital Orthophoto Quadrangles published by the United States Geological Survey (USGS) to verify a reasonable degree of accuracy. In circumstances where accurate satellite signal acquisition is not possible, such as deep, narrow canyons or under a canopy of dense foliage, or where very sharp curves in the road make accuracy questionable, such portions of the road were digitized from the corresponding gray-scale 1-meter Digital Orthophoto Quadrangles published by the United States Geological Survey (USGS).

This road-segment may traverse:

Township 10 North Range 12 West, Section(s) 33, Salt Lake Base & Meridian

Township 9 North Range 12 West, Section(s) 4, Salt Lake Base & Meridian

The following description closely approximates the location of the centerline of the physical monument (Government Well Road)-- Segment 002 based on mapping grade Global Positioning System (GPS) data as defined above:

Beginning at a point on the road center line located at 41 degrees 31 minutes 39.93 seconds North Latitude and -113 degrees 13 minutes 34.76 seconds West Longitude, which can be converted to mapping accuracy State Plane Utah North Zone NAD 83 feet coordinates of X = 1,167,761.2 feet and Y = 3,720,707.3 feet; thence the following courses along the said road center line:

thence North 34 Degrees 15 Minutes 38 Seconds West 26.7 feet
thence North 04 Degrees 15 Minutes 08 Seconds East 135.3 feet
thence North 37 Degrees 33 Minutes 29 Seconds East 153.8 feet
thence North 37 Degrees 17 Minutes 45 Seconds East 157.4 feet
thence North 14 Degrees 31 Minutes 35 Seconds East 181.6 feet
thence North 02 Degrees 36 Minutes 57 Seconds West 288.9 feet
thence North 01 Degrees 56 Minutes 26 Seconds West 551.4 feet
thence North 02 Degrees 59 Minutes 53 Seconds West 417.1 feet
thence North 01 Degrees 20 Minutes 19 Seconds East 145.7 feet
thence North 32 Degrees 43 Minutes 21 Seconds East 149.1 feet

thence North 47 Degrees 16 Minutes 30 Seconds East 167.9 feet
thence North 31 Degrees 17 Minutes 00 Seconds East 171.4 feet
thence North 25 Degrees 15 Minutes 49 Seconds East 174.6 feet
thence North 05 Degrees 37 Minutes 07 Seconds East 189.7 feet
thence North 13 Degrees 58 Minutes 05 Seconds West 190.7 feet
thence North 18 Degrees 48 Minutes 17 Seconds West 188.5 feet
thence North 13 Degrees 19 Minutes 58 Seconds West 175.1 feet
thence North 09 Degrees 56 Minutes 05 Seconds West 161.4 feet
thence North 38 Degrees 34 Minutes 10 Seconds West 171.2 feet
thence North 34 Degrees 29 Minutes 22 Seconds West 192.3 feet
thence North 27 Degrees 53 Minutes 55 Seconds West 194.3 feet
thence North 31 Degrees 02 Minutes 27 Seconds West 185.1 feet
thence North 30 Degrees 12 Minutes 52 Seconds West 177.8 feet
thence North 27 Degrees 49 Minutes 56 Seconds West 172 feet
thence North 15 Degrees 34 Minutes 30 Seconds West 178.5 feet
thence North 14 Degrees 21 Minutes 00 Seconds West 184.3 feet
thence North 10 Degrees 44 Minutes 33 Seconds West 146.9 feet
thence North 10 Degrees 44 Minutes 30 Seconds West 12.6 feet more or less to **the ending**

point at: 41 degrees 32 minutes 27.71 seconds North Latitude and -113 degrees 13 minutes 40.03 seconds West Longitude, which can be converted to mapping accuracy State Plane Utah North Zone NAD 83 feet coordinates of X = 1,167,456.6 feet and Y = 3,725,550.0 feet.

Appendix B to Attachment 4

Popular Name: Government Well Road

County: Box Elder

County Road Number: 124

State Geographic Information Database (SGID) Road Identification Number: RD020032.

Road-Segment Number: 004

Road-Segment Length: 1.01 miles more or less.

Believed owner of the land underlying this road-segment is: Bureau of Land Management.

The following description is based upon the geographic coordinate system using the NAD83 Datum. The source is GPS mapping grade data as indicated in the metadata and/or the transportation data model of the State of Utah Geographic Information Database (SGID).

The road-segment itself is the monument that is identified by its physical presence on the land. The location of said physical presence is closely approximated by mapping grade Global Positioning System (GPS) data. Said data are checked against the corresponding gray-scale 1-meter Digital Orthophoto Quadrangles published by the United States Geological Survey (USGS) to verify a reasonable degree of accuracy. In circumstances where accurate satellite signal acquisition is not possible, such as deep, narrow canyons or under a canopy of dense foliage, or where very sharp curves in the road make accuracy questionable, such portions of the road were digitized from the corresponding gray-scale 1-meter Digital Orthophoto Quadrangles published by the United States Geological Survey (USGS).

This road-segment may traverse:

Township 10 North Range 12 West, Section(s) 28, Salt Lake Base & Meridian

The following description closely approximates the location of the centerline of the physical monument (Government Well Road)-- Segment 004 based on mapping grade Global Positioning System (GPS) data as defined above:

Beginning at a point on the road center line located at 41 degrees 33 minutes 22.25 seconds North Latitude and -113 degrees 13 minutes 42.19 seconds West Longitude, which can be converted to mapping accuracy State Plane Utah North Zone NAD 83 feet coordinates of X = 1,167,402.1 feet and Y = 3,731,072.3 feet; thence the following courses along the said road center line:

thence North 11 Degrees 38 Minutes 55 Seconds West 98.2 feet
thence North 18 Degrees 05 Minutes 01 Seconds West 163.6 feet
thence North 15 Degrees 20 Minutes 09 Seconds West 185.1 feet
thence North 03 Degrees 10 Minutes 37 Seconds West 192.2 feet
thence North 12 Degrees 21 Minutes 46 Seconds East 211.9 feet
thence North 16 Degrees 14 Minutes 29 Seconds East 227.6 feet
thence North 16 Degrees 26 Minutes 14 Seconds East 233 feet
thence North 14 Degrees 43 Minutes 13 Seconds East 236.1 feet
thence North 09 Degrees 43 Minutes 58 Seconds East 238.2 feet
thence North 03 Degrees 12 Minutes 25 Seconds East 233.4 feet
thence North 02 Degrees 20 Minutes 10 Seconds West 499 feet

thence North 02 Degrees 56 Minutes 08 Seconds West 282.4 feet
thence North 08 Degrees 11 Minutes 33 Seconds West 288.1 feet
thence North 07 Degrees 42 Minutes 58 Seconds West 268.3 feet
thence North 04 Degrees 39 Minutes 09 Seconds West 253 feet
thence North 11 Degrees 25 Minutes 48 Seconds West 252.4 feet
thence North 10 Degrees 09 Minutes 10 Seconds West 246.4 feet
thence North 04 Degrees 01 Minutes 41 Seconds West 249.8 feet
thence North 02 Degrees 28 Minutes 56 Seconds West 254.4 feet
thence North 04 Degrees 32 Minutes 59 Seconds West 268.1 feet
thence North 01 Degrees 45 Minutes 16 Seconds West 278.9 feet
thence North 13 Degrees 44 Minutes 45 Seconds West 176.1 feet more or less to **the ending**

point at: 41 degrees 34 minutes 14.19 seconds North Latitude and -113 degrees 13 minutes 45.78 seconds West Longitude, which can be converted to mapping accuracy State Plane Utah North Zone NAD 83 feet coordinates of X = 1,167,234.1 feet and Y = 3,736,333.8 feet.

Appendix C to Attachment 4

Popular Name: Government Well Road

County: Box Elder

County Road Number: 124

State Geographic Information Database (SGID) Road Identification Number: RD020032.

Road-Segment Number: 008

Road-Segment Length: 0.04 miles more or less.

Believed owner of the land underlying this road-segment is: Bureau of Land Management.

The following description is based upon the geographic coordinate system using the NAD83 Datum. The source is GPS mapping grade data as indicated in the metadata and/or the transportation data model of the State of Utah Geographic Information Database (SGID).

The road-segment itself is the monument that is identified by its physical presence on the land. The location of said physical presence is closely approximated by mapping grade Global Positioning System (GPS) data. Said data are checked against the corresponding gray-scale 1-meter Digital Orthophoto Quadrangles published by the United States Geological Survey (USGS) to verify a reasonable degree of accuracy. In circumstances where accurate satellite signal acquisition is not possible, such as deep, narrow canyons or under a canopy of dense foliage, or where very sharp curves in the road make accuracy questionable, such portions of the road were digitized from the corresponding gray-scale 1-meter Digital Orthophoto Quadrangles published by the United States Geological Survey (USGS).

This road-segment may traverse:

Township 10 North Range 12 West, Section(s) 9, Salt Lake Base & Meridian

The following description closely approximates the location of the centerline of the physical monument (Government Well Road)-- Segment 008 based on mapping grade Global Positioning System (GPS) data as defined above:

Beginning at a point on the road center line located at 41 degrees 36 minutes 17.86 seconds North Latitude and -113 degrees 13 minutes 46.94 seconds West Longitude, which can be converted to mapping accuracy State Plane Utah North Zone NAD 83 feet coordinates of X = 1,167,394.5 feet and Y = 3,748,850.4 feet; thence the following courses along the said road center line:

thence North 29 Degrees 49 Minutes 09 Seconds West 31.9 feet

thence North 32 Degrees 08 Minutes 21 Seconds West 115.8 feet

thence North 32 Degrees 44 Minutes 05 Seconds West 56.3 feet

thence North 28 Degrees 24 Minutes 46 Seconds West 5.6 feet more or less to **the ending point**

at: 41 degrees 36 minutes 19.59 seconds North Latitude and -113 degrees 13 minutes 48.45 seconds West Longitude, which can be converted to mapping accuracy State Plane Utah North Zone NAD 83 feet coordinates of X = 1,167,284.0 feet and Y = 3,749,028.4 feet.