

**Amended Acknowledgment and  
Amended Notice of Acknowledgment  
of Acceptance of R.S. 2477  
Right-of-Way Grant**

Ent 255658 Bk 1030 Pg 905  
Date 19-Nov-2007 9:25AM Fee \$0.00  
LuAnn Adams - Filed By la  
Box Elder Co., UT  
For GOVERNOR FOR THE STATE OF UTAH

**THE STATE OF UTAH**

**TO ALL WHOM THESE PRESENTS SHALL COME, Greeting:**

**Know ye,** This is an Amended Acknowledgment and Amended Notice of Acknowledgment made under Utah Code Sections 72-5-309 through 310 inclusive, that the grant of the United States of America of “the right of way for the construction of highways over public lands, not reserved for public uses” under United States Revised Statutes 2477 (43 U.S.C. Section 932 (repealed October 21, 1976, with proviso recognizing the validity of rights-of-way already established)) was accepted for and on behalf of the State of Utah and its political subdivision Box Elder County as it pertains to the highway located in Box Elder County known as Hogup Cabin Road; County Road Number: 125; State Geographic Information Database (SGID) Road Identification Number: RD020033. Total road length is 4.65 miles more or less.

This Amended Acknowledgment and Amended Notice of Acknowledgment supersedes the information contained in the Acknowledgment recorded at Ent 238498, Bk 988, Beg Pg 567.

The reason for this Amended Acknowledgment and Amended Notice of Acknowledgment includes, but is not limited to, the fact that the road was constructed, mechanically, or by continuous use as a public highway for a period of at least ten years, over public lands not reserved for public uses, prior to the earlier of (a) the October 21, 1976 repeal of R.S. 2477 or (b) the date the servient estate was reserved for public uses.

This Amended Acknowledgment and Amended Notice of Acknowledgment applies only to the segments of the road that traverse land owned by the Bureau of Land Management, United States Department of the Interior, and does not apply to segments of the road that traverse land owned by any other person or entity. The State of Utah and its political subdivisions reserve the right to make further acknowledgments and notices of acknowledgment with regard to road segments that traverse land owned by other entities, including the United States of America, through one or more of its agencies.

A printed copy of a map showing the location of the road in said county is appended hereto as “Attachment 1,” a printed copy of representative photos of the road is appended hereto as “Attachment 2,” a printed copy of a description of the beginning and ending points of the entire road together with a list of Townships, Ranges and Sections that may be traversed by the road in said county is appended hereto as “Attachment 3,” and a printed copy of the Road Centerline Description Cover Page(s) is appended hereto as “Attachment 4.” The Appendices listed in “Attachment 4” that contain the actual road centerline descriptions are incorporated herein by reference.

A printed copy of this Amended Acknowledgment and Amended Notice of Acknowledgment, together with its Attachments and Appendices, may be viewed and/or obtained at the office of the Utah State Archives.

An electronic copy of this Amended Acknowledgment and Amended Notice of Acknowledgment, together with its Attachments and Appendices, may be viewed and/or downloaded as read-only PDF (Portable Document Format) files via the Internet at <http://recorded2477roads.utah.gov>.

The owner of the servient estate in the land underlying the road-segments subject to this Amended Acknowledgment and Amended Notice is believed to be the United States of America through one or more of its agencies. Any of such agencies or any other person with a servient ownership claim or a competing dominant estate right-of-way ownership claim, may file a petition in the State District Court for Salt Lake County for a decision regarding the correctness of this Amended Acknowledgment. A claimant shall file a petition within sixty (60) days after receipt of this Notice.

**In Witness Whereof**, I, John Harja, the official designee of the Governor of the State of Utah, in conformity to the laws of the State (Utah Code Sections 72-5-308 through 310 inclusive), have caused this Amended Acknowledgment and Amend Notice of Acknowledgment to be made.

Signed by my hand in Salt Lake City, Utah, the 15<sup>th</sup> day of November, 2007.

By the Governor's Designee

  
\_\_\_\_\_  
John Harja

**CERTIFICATION**

State of Utah                    )  
  : ss  
County of Salt Lake         )

I hereby certify that the signer of the foregoing document, John Harja, is personally known by me, has made a voluntary signature and taken an oath stating that he is the official designee of the Governor of the State of Utah and is authorized to sign this document on the Governor's behalf pursuant to Utah Code Section 72-5-309. He further vouched that, based upon information and belief, the facts alleged therein are true.

Dated this 15<sup>th</sup> day of November, 2007.

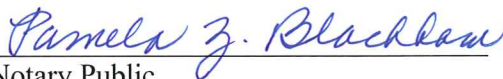

  
\_\_\_\_\_  
Notary Public

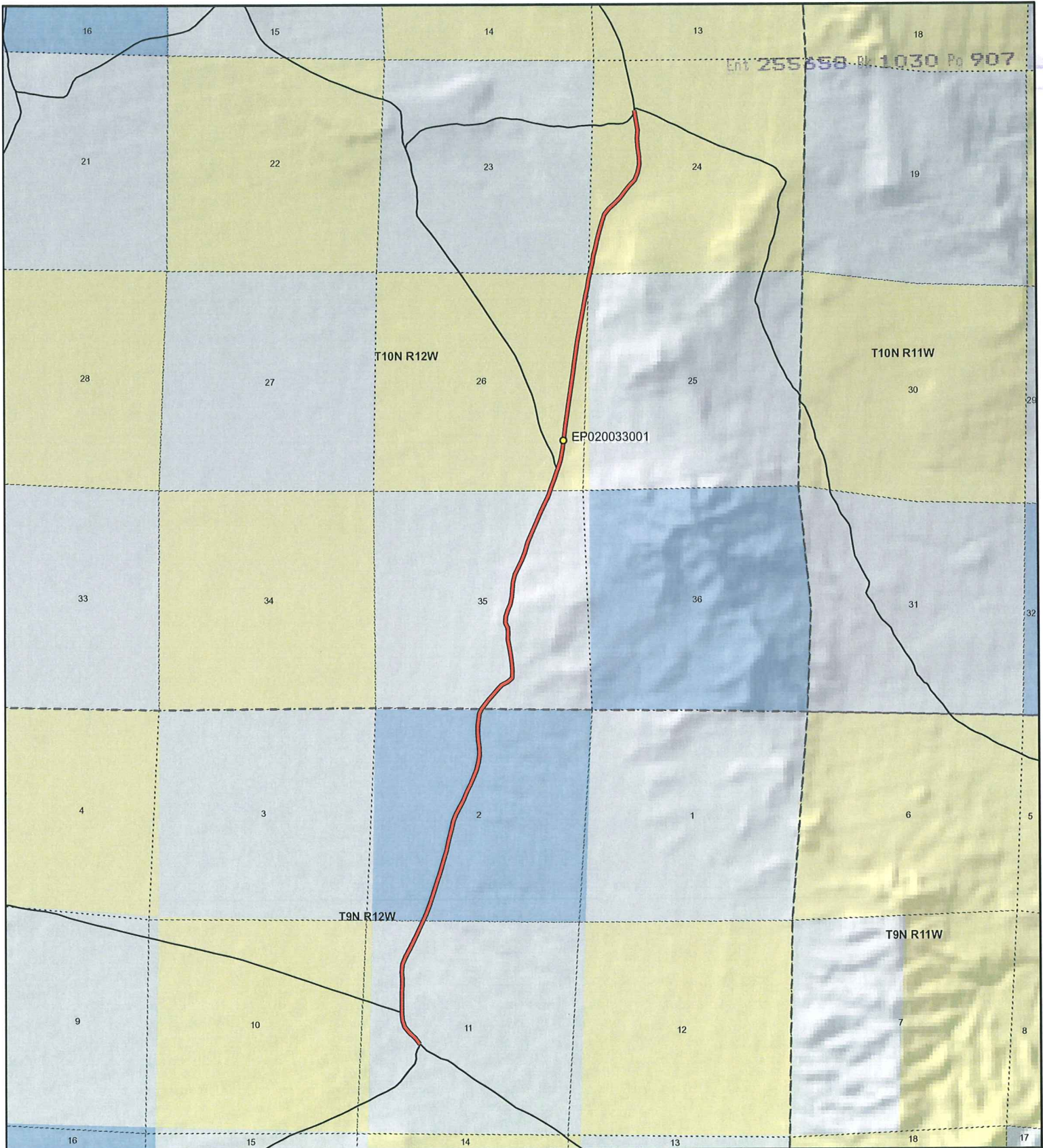

**Hogup Cabin Road - Box Elder County**  
**SGID RD\_ID RD020033**

**Land Ownership Categories**

- BLM
- Private
- SITLA, State Trust Land
- USFS, National Forest
- State Parks and Recreation
- Tribal, Indian Reservation
- NPS, National Park
- Wilderness
- UDWR Wildlife Reserve
- DOD, Military
- State Sovereign Land
- National Recreation Area
- USFWS, Natl. Wildlife Refuge

**Transportation Network**

- Hogup Cabin Road
- Title V: Issued Or Under Consideration By BLM Or County
- Other Roads
- Photo Event Point
- Section = 1 Mile



1:38,449

1 inch equals 0.6 miles

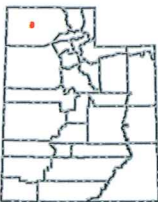

Map prepared by the State of Utah  
 Automated Geographic Reference Center  
 Room 5130 State Office Building  
 Salt Lake City, Utah 84114  
 Nov 10, 2006





EP020033001

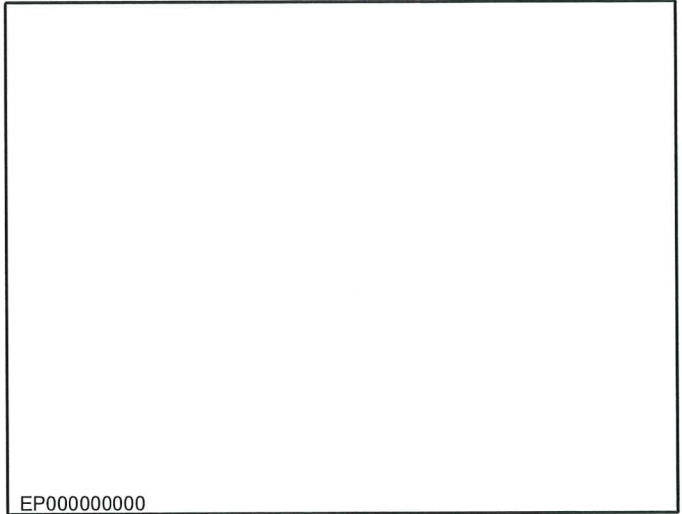

EP000000000

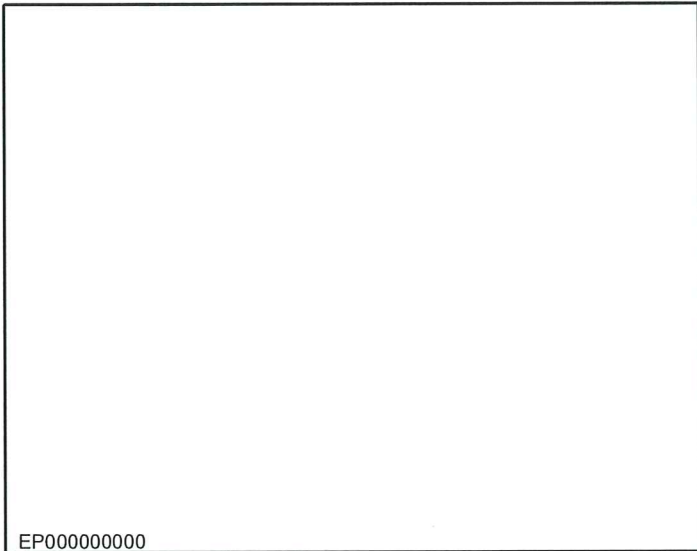

EP000000000

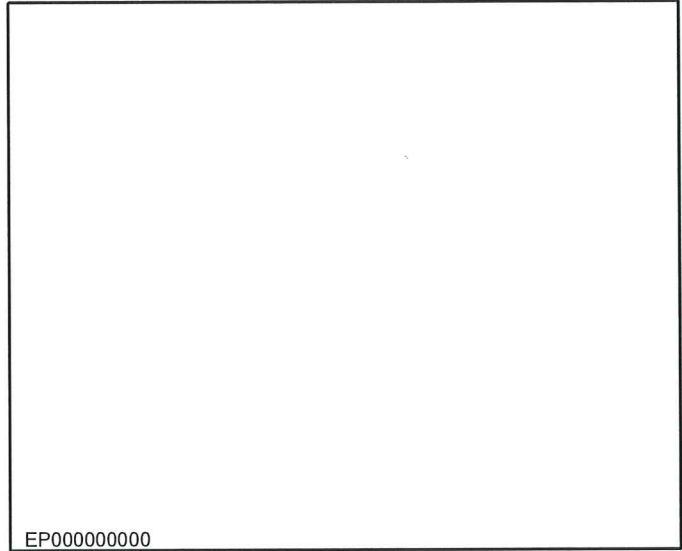

EP000000000

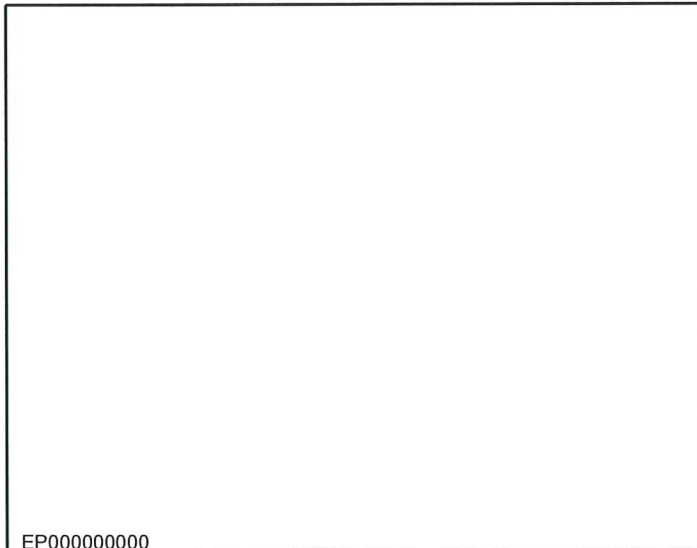

EP000000000

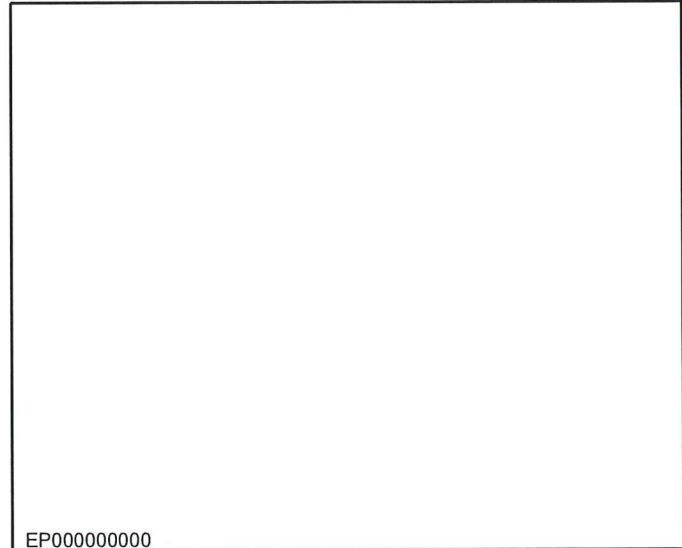

EP000000000

**Hogup Cabin Road - Box Elder County**  
**SGID RD\_ID RD020033**

Map prepared by the State of Utah  
Automated Geographic Reference Center  
Room 5130 State Office Building  
Salt Lake City, Utah 84114  
November 9, 2006



### Attachment 3

#### Beginning & Ending Points and Township, Range, and Section References For:

**Popular Name: Hogup Cabin Road**

**County: Box Elder**

**County Road Number: 125**

**State Geographic Information Database (SGID) Road Identification Number: RD020033.**

**Total Road Length: 4.65 miles more or less.**

**Beginning at a point** on the road centerline located at 41 degrees 31 minutes 08.12 seconds North Latitude and -113 degrees 11 minutes 11.38 seconds West Longitude, which can be converted to mapping accuracy State Plane Utah North Zone NAD 83 feet coordinates of X = 1,178,601.5 feet and Y = 3,717,273.5 feet based on the US Survey Foot conversion.

**Ending at a point** on the road centerline located at 41 degrees 34 minutes 56.41 seconds North Latitude and -113 degrees 10 minutes 07.17 seconds West Longitude, which can be converted to mapping accuracy State Plane Utah North Zone NAD 83 feet coordinates of X = 1,183,929.0 feet and Y = 3,740,281.9 feet based on the US Survey Foot conversion.

This road may traverse:

Township 10 North Range 12 West, Section(s) 24,25,26,35, Salt Lake Base & Meridian

Township 9 North Range 12 West, Section(s) 2,11, Salt Lake Base & Meridian

See Attachment 1 above for a cartographic depiction of the course of this road.

**Attachment 4**  
**Road Centerline Description Cover Page(s)**

**Popular Name: Hogup Cabin Road**

**County: Box Elder**

**County Road Number: 125**

**State Geographic Information Database (SGID) Road Identification Number: RD020033.**

**Total Road Length: 4.65 miles more or less.**

**Centerline Descriptions Of Road-Segments That Cross Over Federally Owned Land, Derived From Global Positioning System Data And Cross-checked against USGS Digital Orthophoto Quadrangles Compiled By The Utah Automated Geographic Reference Center And Entered Into The State Geographic Information Database (SGID).**

<b>Road-Segments Listed by SGID Road Identification Number (RD ID)</b>	<b>Road-Segment Numbers</b>	<b>Believed Ownership Of Servient Estate</b>	<b>Approximate Segment Length</b>	<b>See Attached Appendix</b>
<b>RD020033</b>	<b>001</b>	<b>PVT</b>	<b>0.63 Miles</b>	<b>(not shown)</b>
<b>RD020033</b>	<b>002</b>	<b>ST</b>	<b>1.04 Miles</b>	<b>(not shown)</b>
<b>RD020033</b>	<b>003</b>	<b>PVT</b>	<b>1.13 Miles</b>	<b>(not shown)</b>
<b>RD020033</b>	<b>004</b>	<b>BLM</b>	<b>0.99 Miles</b>	<b>A</b>
<b>RD020033</b>	<b>005</b>	<b>PVT</b>	<b>0.04 Miles</b>	<b>(not shown)</b>
<b>RD020033</b>	<b>006</b>	<b>BLM</b>	<b>0.83 Miles</b>	<b>B</b>
		<b>Total Road Length</b>	<b>4.65</b>	<b>—————</b>

\* Indicates that a Title V permit will be requested, is in process, or has been issued.

† Indicates that road-segments crossing Forest Service land are under consideration by the state and county as of the date of this Amended Acknowledgment and Amended Notice of Acknowledgment.

## Appendix A to Attachment 4

**Popular Name: Hogup Cabin Road**

**County: Box Elder**

**County Road Number: 125**

**State Geographic Information Database (SGID) Road Identification Number: RD020033.**

**Road-Segment Number: 004**

**Road-Segment Length: 0.99 miles more or less.**

**Believed owner of the land underlying this road-segment is: Bureau of Land Management.**

*The following description is based upon the geographic coordinate system using the NAD83 Datum. The source is GPS mapping grade data as indicated in the metadata and/or the transportation data model of the State of Utah Geographic Information Database (SGID).*

The road-segment itself is the monument that is identified by its physical presence on the land. The location of said physical presence is closely approximated by mapping grade Global Positioning System (GPS) data. Said data are checked against the corresponding gray-scale 1-meter Digital Orthophoto Quadrangles published by the United States Geological Survey (USGS) to verify a reasonable degree of accuracy. In circumstances where accurate satellite signal acquisition is not possible, such as deep, narrow canyons or under a canopy of dense foliage, or where very sharp curves in the road make accuracy questionable, such portions of the road were digitized from the corresponding gray-scale 1-meter Digital Orthophoto Quadrangles published by the United States Geological Survey (USGS).

This road-segment may traverse:

Township 10 North Range 12 West, Section(s) 26, Salt Lake Base & Meridian

The following description closely approximates the location of the centerline of the physical monument (Hogup Cabin Road)-- Segment 004 based on mapping grade Global Positioning System (GPS) data as defined above:

**Beginning at a point** on the road center line located at 41 degrees 33 minutes 23.63 seconds North Latitude and -113 degrees 10 minutes 32.66 seconds West Longitude, which can be converted to mapping accuracy State Plane Utah North Zone NAD 83 feet coordinates of X = 1,181,810.7 feet and Y = 3,730,929.5 feet; thence the following courses along the said road center line:

thence North 19 Degrees 15 Minutes 43 Seconds East	72.6 feet
thence North 19 Degrees 57 Minutes 56 Seconds East	209.9 feet
thence North 20 Degrees 24 Minutes 14 Seconds East	164.9 feet
thence North 16 Degrees 53 Minutes 43 Seconds East	84.2 feet
thence North 28 Degrees 16 Minutes 17 Seconds East	20.6 feet
thence North 17 Degrees 03 Minutes 57 Seconds East	242.4 feet
thence North 09 Degrees 57 Minutes 36 Seconds East	288.1 feet
thence North 07 Degrees 39 Minutes 13 Seconds East	290.2 feet
thence North 07 Degrees 34 Minutes 44 Seconds East	288.2 feet
thence North 08 Degrees 04 Minutes 32 Seconds East	280.2 feet
thence North 07 Degrees 50 Minutes 28 Seconds East	265.2 feet
thence North 08 Degrees 04 Minutes 46 Seconds East	248.7 feet

thence North 08 Degrees 01 Minutes 29 Seconds East 250.4 feet  
thence North 08 Degrees 27 Minutes 11 Seconds East 249 feet  
thence North 09 Degrees 00 Minutes 34 Seconds East 244.4 feet  
thence North 07 Degrees 03 Minutes 38 Seconds East 254.7 feet  
thence North 08 Degrees 46 Minutes 05 Seconds East 261.2 feet  
thence North 09 Degrees 49 Minutes 37 Seconds East 254.6 feet  
thence North 09 Degrees 55 Minutes 54 Seconds East 248.4 feet  
thence North 10 Degrees 53 Minutes 35 Seconds East 237.5 feet  
thence North 11 Degrees 03 Minutes 13 Seconds East 222.6 feet  
thence North 10 Degrees 31 Minutes 32 Seconds East 207.1 feet  
thence North 11 Degrees 03 Minutes 42 Seconds East 202.5 feet  
thence North 11 Degrees 24 Minutes 14 Seconds East 133.7 feet more or less to **the ending**

**point at:** 41 degrees 34 minutes 14.39 seconds North Latitude and -113 degrees 10 minutes 21.42 seconds West Longitude, which can be converted to mapping accuracy State Plane Utah North Zone NAD 83 feet coordinates of X = 1,182,764.1 feet and Y = 3,736,050.6 feet.



## Appendix B to Attachment 4

**Popular Name: Hogup Cabin Road**

**County: Box Elder**

**County Road Number: 125**

**State Geographic Information Database (SGID) Road Identification Number: RD020033.**

**Road-Segment Number: 006**

**Road-Segment Length: 0.83 miles more or less.**

**Believed owner of the land underlying this road-segment is: Bureau of Land Management.**

*The following description is based upon the geographic coordinate system using the NAD83 Datum. The source is GPS mapping grade data as indicated in the metadata and/or the transportation data model of the State of Utah Geographic Information Database (SGID).*

The road-segment itself is the monument that is identified by its physical presence on the land. The location of said physical presence is closely approximated by mapping grade Global Positioning System (GPS) data. Said data are checked against the corresponding gray-scale 1-meter Digital Orthophoto Quadrangles published by the United States Geological Survey (USGS) to verify a reasonable degree of accuracy. In circumstances where accurate satellite signal acquisition is not possible, such as deep, narrow canyons or under a canopy of dense foliage, or where very sharp curves in the road make accuracy questionable, such portions of the road were digitized from the corresponding gray-scale 1-meter Digital Orthophoto Quadrangles published by the United States Geological Survey (USGS).

This road-segment may traverse:

Township 10 North Range 12 West, Section(s) 24, Salt Lake Base & Meridian

The following description closely approximates the location of the centerline of the physical monument (Hogup Cabin Road)-- Segment 006 based on mapping grade Global Positioning System (GPS) data as defined above:

**Beginning at a point** on the road center line located at 41 degrees 34 minutes 16.41 seconds North Latitude and -113 degrees 10 minutes 20.91 seconds West Longitude, which can be converted to mapping accuracy State Plane Utah North Zone NAD 83 feet coordinates of X = 1,182,807.0 feet and Y = 3,736,253.5 feet; thence the following courses along the said road center line:

thence North 12 Degrees 17 Minutes 50 Seconds East	80.2 feet
thence North 12 Degrees 05 Minutes 12 Seconds East	198.2 feet
thence North 08 Degrees 29 Minutes 29 Seconds East	185.9 feet
thence North 15 Degrees 02 Minutes 13 Seconds East	190.5 feet
thence North 13 Degrees 58 Minutes 53 Seconds East	208.2 feet
thence North 14 Degrees 03 Minutes 30 Seconds East	226.9 feet
thence North 14 Degrees 24 Minutes 15 Seconds East	225.6 feet
thence North 18 Degrees 44 Minutes 03 Seconds East	204.8 feet
thence North 39 Degrees 21 Minutes 40 Seconds East	183.4 feet
thence North 49 Degrees 00 Minutes 14 Seconds East	183.8 feet
thence North 43 Degrees 46 Minutes 52 Seconds East	196.5 feet
thence North 37 Degrees 30 Minutes 39 Seconds East	199.4 feet

thence North 40 Degrees 43 Minutes 12 Seconds East 195.8 feet  
thence North 41 Degrees 18 Minutes 09 Seconds East 182.2 feet  
thence North 22 Degrees 37 Minutes 49 Seconds East 194.2 feet  
thence North 14 Degrees 01 Minutes 50 Seconds East 204.9 feet  
thence North 04 Degrees 22 Minutes 17 Seconds West 200.6 feet  
thence North 08 Degrees 07 Minutes 53 Seconds West 220.2 feet  
thence North 03 Degrees 42 Minutes 55 Seconds West 228.4 feet  
thence North 03 Degrees 19 Minutes 33 Seconds East 210.4 feet  
thence North 10 Degrees 11 Minutes 33 Seconds West 189.8 feet  
thence North 10 Degrees 58 Minutes 23 Seconds West 163.6 feet  
thence North 05 Degrees 27 Minutes 08 Seconds West 125.2 feet more or less to **the ending**

**point at:** 41 degrees 34 minutes 56.41 seconds North Latitude and -113 degrees 10 minutes 07.17 seconds West Longitude, which can be converted to mapping accuracy State Plane Utah North Zone NAD 83 feet coordinates of X = 1,183,929.0 feet and Y = 3,740,281.9 feet.