

**Amended Acknowledgment and  
Amended Notice of Acknowledgment  
of Acceptance of R.S. 2477  
Right-of-Way Grant**

**THE STATE OF UTAH**

**TO ALL WHOM THESE PRESENTS SHALL COME, Greeting:**

**Know ye,** This is an Amended Acknowledgment and Amended Notice of Acknowledgment made under Utah Code Sections 72-5-309 through 310 inclusive, that the grant of the United States of America of “the right of way for the construction of highways over public lands, not reserved for public uses” under United States Revised Statutes 2477 (43 U.S.C. Section 932 (repealed October 21, 1976, with proviso recognizing the validity of rights-of-way already established)) was accepted for and on behalf of the State of Utah and its political subdivision Box Elder County as it pertains to the highway located in Box Elder County known as North End Upper Hogup; County Road Number: 126; State Geographic Information Database (SGID) Road Identification Number: RD020034. Total road length is 5.5 miles more or less.

This Amended Acknowledgment and Amended Notice of Acknowledgment supersedes the information contained in the Acknowledgment recorded at Ent 238499, Bk 988, Beg Pg 573.

The reason for this Amended Acknowledgment and Amended Notice of Acknowledgment includes, but is not limited to, the fact that the road was constructed, mechanically, or by continuous use as a public highway for a period of at least ten years, over public lands not reserved for public uses, prior to the earlier of (a) the October 21, 1976 repeal of R.S. 2477 or (b) the date the servient estate was reserved for public uses.

This Amended Acknowledgment and Amended Notice of Acknowledgment applies only to the segments of the road that traverse land owned by the Bureau of Land Management, United States Department of the Interior, and does not apply to segments of the road that traverse land owned by any other person or entity. The State of Utah and its political subdivisions reserve the right to make further acknowledgments and notices of acknowledgment with regard to road segments that traverse land owned by other entities, including the United States of America, through one or more of its agencies.

A printed copy of a map showing the location of the road in said county is appended hereto as “Attachment 1,” a printed copy of representative photos of the road is appended hereto as “Attachment 2,” a printed copy of a description of the beginning and ending points of the entire road together with a list of Townships, Ranges and Sections that may be traversed by the road in said county is appended hereto as “Attachment 3,” and a printed copy of the Road Centerline Description Cover Page(s) is appended hereto as “Attachment 4.” The Appendices listed in “Attachment 4” that contain the actual road centerline descriptions are incorporated herein by reference.

A printed copy of this Amended Acknowledgment and Amended Notice of Acknowledgment, together with its Attachments and Appendices, may be viewed and/or obtained at the office of the Utah State Archives.

An electronic copy of this Amended Acknowledgment and Amended Notice of Acknowledgment, together with its Attachments and Appendices, may be viewed and/or downloaded as read-only PDF (Portable Document Format) files via the Internet at <http://recorded2477roads.utah.gov>.

The owner of the servient estate in the land underlying the road-segments subject to this Amended Acknowledgment and Amended Notice is believed to be the United States of America through one or more of its agencies. Any of such agencies or any other person with a servient ownership claim or a competing dominant estate right-of-way ownership claim, may file a petition in the State District Court for Salt Lake County for a decision regarding the correctness of this Amended Acknowledgment. A claimant shall file a petition within sixty (60) days after receipt of this Notice.

**In Witness Whereof**, I, John Harja, the official designee of the Governor of the State of Utah, in conformity to the laws of the State (Utah Code Sections 72-5-308 through 310 inclusive), have caused this Amended Acknowledgment and Amend Notice of Acknowledgment to be made.

Signed by my hand in Salt Lake City, Utah, the 15<sup>th</sup> day of November, 2007.

By the Governor's Designee

  
\_\_\_\_\_  
John Harja

**CERTIFICATION**

State of Utah                    )  
  : ss  
County of Salt Lake         )

I hereby certify that the signer of the foregoing document, John Harja, is personally known by me, has made a voluntary signature and taken an oath stating that he is the official designee of the Governor of the State of Utah and is authorized to sign this document on the Governor's behalf pursuant to Utah Code Section 72-5-309. He further vouched that, based upon information and belief, the facts alleged therein are true.

Dated this 15<sup>th</sup> day of November, 2007.



  
\_\_\_\_\_  
Notary Public

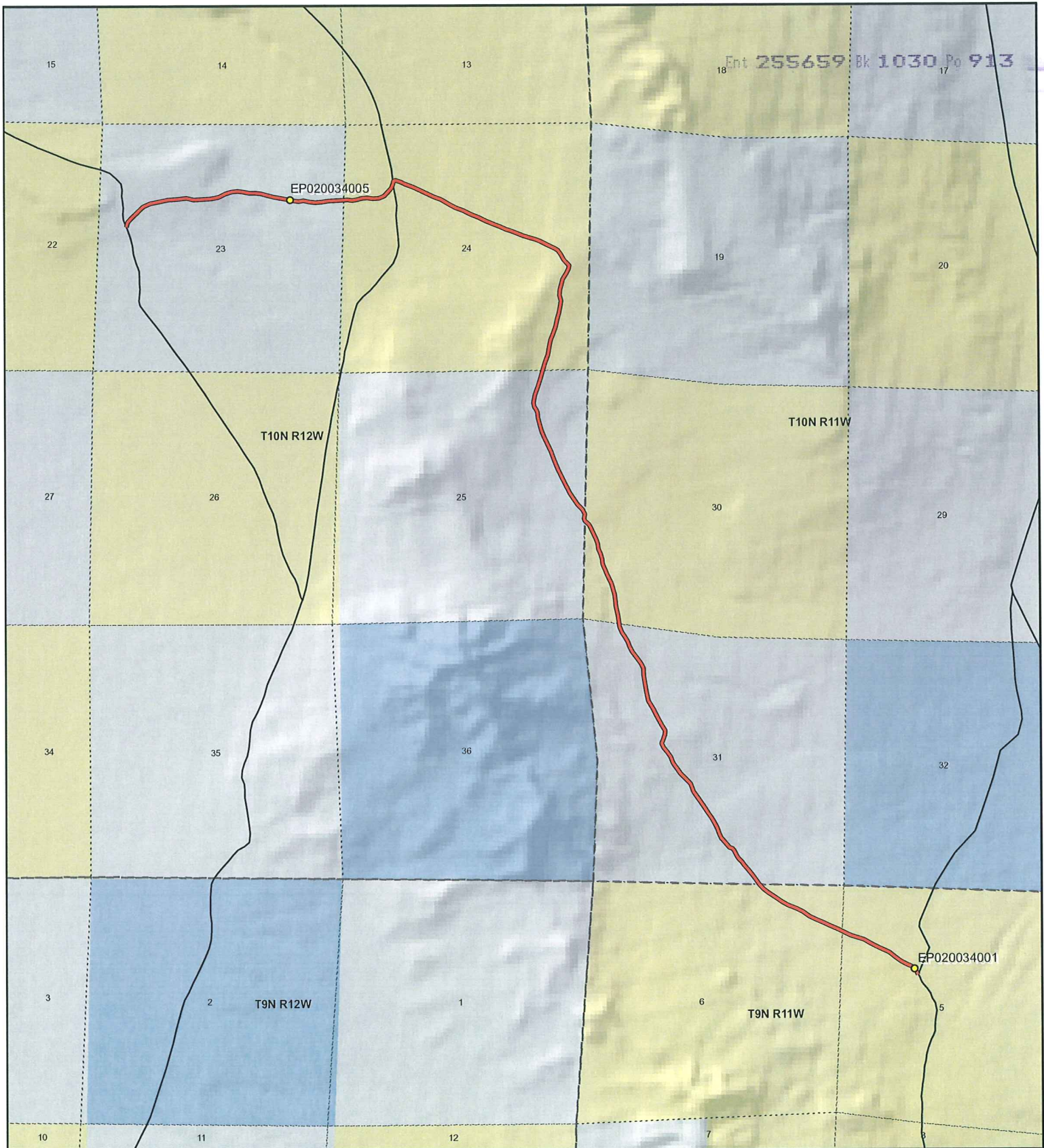

Ent 255659 Bk 1030 Po 913

**North End Upper Hogup - Box Elder County**  
**SGID RD\_ID RD020034**

<b>Land Ownership Categories</b>		<b>Transportation Network</b>	
BLM	Wilderness	North End Upper Hogup	Title V: Issued Or Under Consideration By BLM Or County
Private	UDWR Wildlife Reserve	Other Roads	Photo Event Point
SITLA, State Trust Land	DOD, Military	Section = 1 Mile	
USFS, National Forest	State Sovereign Land		
State Parks and Recreation	National Recreation Area		
Tribal, Indian Reservation	USFWS, Natl. Wildlife Refuge		
NPS, National Park			

Map prepared by the State of Utah  
Automated Geographic Reference Center  
Room 5130 State Office Building  
Salt Lake City, Utah 84114  
Nov 10, 2006

1:33,129  
1 inch equals 0.5 miles



EP020034001



EP020034005

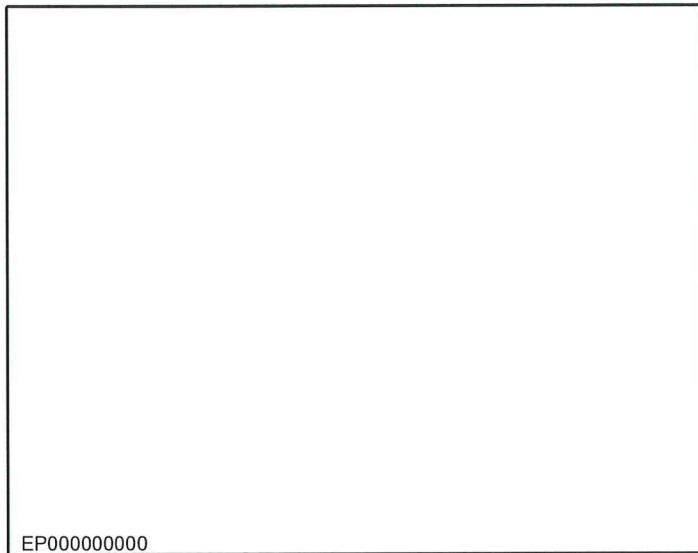

EP000000000

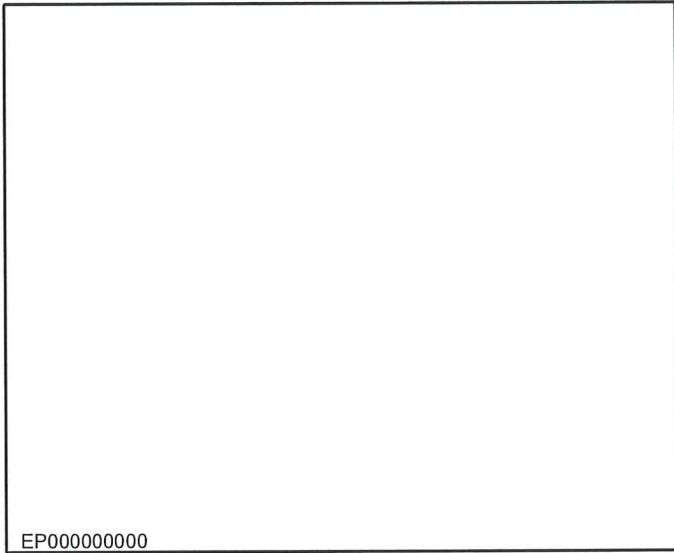

EP000000000

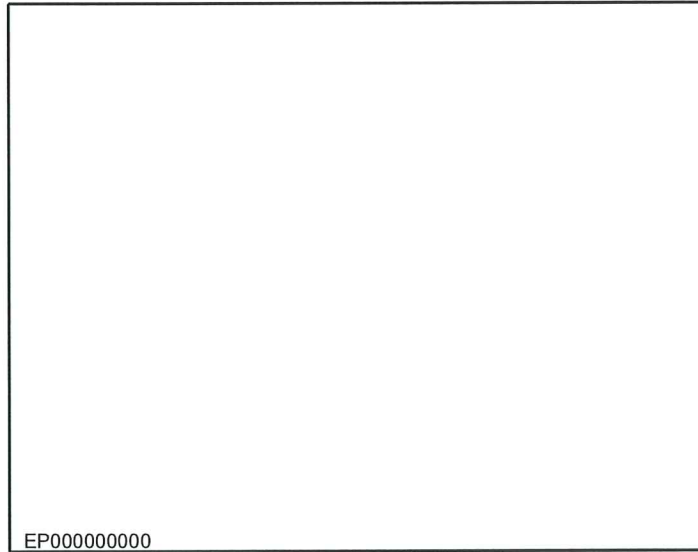

EP000000000

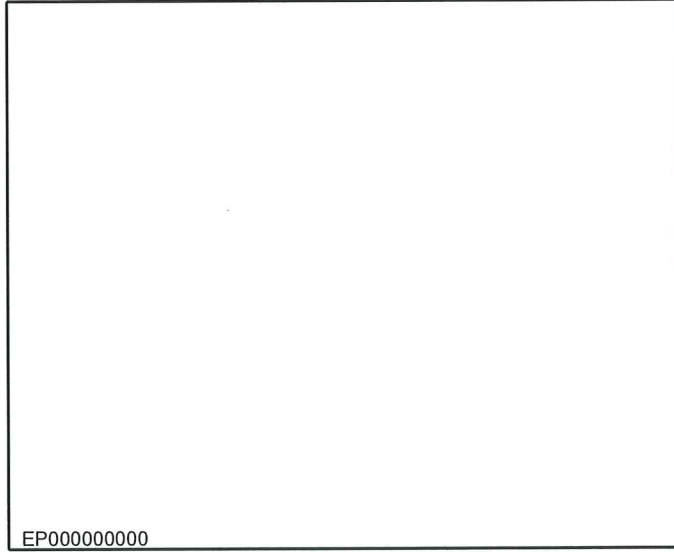

EP000000000

*North End Upper Hogup Road - Box Elder County*  
**SGID RD\_ID RD020034**

Map prepared by the State of Utah  
 Automated Geographic Reference Center  
 Room 5130 State Office Building  
 Salt Lake City, Utah 84114  
 November 9, 2006



### Attachment 3

#### Beginning & Ending Points and Township, Range, and Section References For:

**Popular Name:** North End Upper Hogup

**County:** Box Elder

**County Road Number:** 126

**State Geographic Information Database (SGID) Road Identification Number:** RD020034.

**Total Road Length:** 5.5 miles more or less.

**Beginning at a point** on the road centerline located at 41 degrees 32 minutes 13.01 seconds North Latitude and -113 degrees 07 minutes 35.32 seconds West Longitude, which can be converted to mapping accuracy State Plane Utah North Zone NAD 83 feet coordinates of X = 1,195,157.2 feet and Y = 3,723,527.6 feet based on the US Survey Foot conversion.

**Ending at a point** on the road centerline located at 41 degrees 34 minutes 46 seconds North Latitude and -113 degrees 11 minutes 21.94 seconds West Longitude, which can be converted to mapping accuracy State Plane Utah North Zone NAD 83 feet coordinates of X = 1,178,227.3 feet and Y = 3,739,337.7 feet based on the US Survey Foot conversion.

This road may traverse:

Township 10 North Range 11 West, Section(s) 30,31, Salt Lake Base & Meridian

Township 10 North Range 12 West, Section(s) 23,24,25, Salt Lake Base & Meridian

Township 9 North Range 11 West, Section(s) 5,6, Salt Lake Base & Meridian

See Attachment 1 above for a cartographic depiction of the course of this road.

**Attachment 4**  
**Road Centerline Description Cover Page(s)**

**Popular Name: North End Upper Hogup**

**County: Box Elder**

**County Road Number: 126**

**State Geographic Information Database (SGID) Road Identification Number: RD020034.**

**Total Road Length: 5.5 miles more or less.**

**Centerline Descriptions Of Road-Segments That Cross Over Federally Owned Land, Derived From Global Positioning System Data And Cross-checked against USGS Digital Orthophoto Quadrangles Compiled By The Utah Automated Geographic Reference Center And Entered Into The State Geographic Information Database (SGID).**

<b>Road-Segments Listed by SGID Road Identification Number (RD_ID)</b>	<b>Road-Segment Numbers</b>	<b>Believed Ownership Of Servient Estate</b>	<b>Approximate Segment Length</b>	<b>See Attached Appendix</b>
<b>RD020034</b>	<b>001</b>	<b>BLM</b>	<b>0.75 Miles</b>	<b>A</b>
<b>RD020034</b>	<b>002</b>	<b>PVT</b>	<b>1.23 Miles</b>	<b>(not shown)</b>
<b>RD020034</b>	<b>003</b>	<b>BLM</b>	<b>0.44 Miles</b>	<b>B</b>
<b>RD020034</b>	<b>004</b>	<b>PVT</b>	<b>0.67 Miles</b>	<b>(not shown)</b>
<b>RD020034</b>	<b>005</b>	<b>BLM</b>	<b>1.48 Miles</b>	<b>C</b>
<b>RD020034</b>	<b>006</b>	<b>PVT</b>	<b>.93 Miles</b>	<b>(not shown)</b>
		<b>Total Road Length</b>	<b>5.5</b>	<b>—————</b>

\* Indicates that a Title V permit will be requested, is in process, or has been issued.

† Indicates that road-segments crossing Forest Service land are under consideration by the state and county as of the date of this Amended Acknowledgment and Amended Notice of Acknowledgment.

## Appendix A to Attachment 4

**Popular Name: North End Upper Hogup**

**County: Box Elder**

**County Road Number: 126**

**State Geographic Information Database (SGID) Road Identification Number: RD020034.**

**Road-Segment Number: 001**

**Road-Segment Length: 0.75 miles more or less.**

**Believed owner of the land underlying this road-segment is: Bureau of Land Management.**

*The following description is based upon the geographic coordinate system using the NAD83 Datum. The source is GPS mapping grade data as indicated in the metadata and/or the transportation data model of the State of Utah Geographic Information Database (SGID).*

The road-segment itself is the monument that is identified by its physical presence on the land. The location of said physical presence is closely approximated by mapping grade Global Positioning System (GPS) data. Said data are checked against the corresponding gray-scale 1-meter Digital Orthophoto Quadrangles published by the United States Geological Survey (USGS) to verify a reasonable degree of accuracy. In circumstances where accurate satellite signal acquisition is not possible, such as deep, narrow canyons or under a canopy of dense foliage, or where very sharp curves in the road make accuracy questionable, such portions of the road were digitized from the corresponding gray-scale 1-meter Digital Orthophoto Quadrangles published by the United States Geological Survey (USGS).

This road-segment may traverse:

Township 9 North Range 11 West, Section(s) 5,6, Salt Lake Base & Meridian

The following description closely approximates the location of the centerline of the physical monument (North End Upper Hogup)-- Segment 001 based on mapping grade Global Positioning System (GPS) data as defined above:

**Beginning at a point** on the road center line located at 41 degrees 32 minutes 13.01 seconds North Latitude and -113 degrees 07 minutes 35.32 seconds West Longitude, which can be converted to mapping accuracy State Plane Utah North Zone NAD 83 feet coordinates of X = 1,195,157.2 feet and Y = 3,723,527.6 feet; thence the following courses along the said road center line:

thence North 30 Degrees 53 Minutes 55 Seconds West 80 feet  
thence North 43 Degrees 03 Minutes 52 Seconds West 122.8 feet  
thence North 64 Degrees 23 Minutes 44 Seconds West 135 feet  
thence North 61 Degrees 17 Minutes 00 Seconds West 145.2 feet  
thence North 54 Degrees 43 Minutes 47 Seconds West 155 feet  
thence North 53 Degrees 14 Minutes 15 Seconds West 146.8 feet  
thence North 63 Degrees 53 Minutes 13 Seconds West 147.3 feet  
thence North 66 Degrees 26 Minutes 59 Seconds West 153.9 feet  
thence North 62 Degrees 10 Minutes 43 Seconds West 152.9 feet  
thence North 58 Degrees 43 Minutes 21 Seconds West 153.3 feet  
thence North 74 Degrees 27 Minutes 06 Seconds West 305.6 feet

thence North 63 Degrees 51 Minutes 03 Seconds West 201.2 feet  
thence North 63 Degrees 51 Minutes 22 Seconds West 2.4 feet  
thence North 63 Degrees 51 Minutes 02 Seconds West 120.1 feet  
thence North 67 Degrees 37 Minutes 51 Seconds West 165.7 feet  
thence North 65 Degrees 30 Minutes 20 Seconds West 160.1 feet  
thence North 67 Degrees 28 Minutes 15 Seconds West 163.8 feet  
thence North 63 Degrees 55 Minutes 27 Seconds West 166.7 feet  
thence North 55 Degrees 46 Minutes 39 Seconds West 167.7 feet  
thence North 62 Degrees 54 Minutes 53 Seconds West 156.7 feet  
thence North 70 Degrees 49 Minutes 53 Seconds West 171.9 feet  
thence North 60 Degrees 51 Minutes 14 Seconds West 170 feet  
thence North 55 Degrees 56 Minutes 38 Seconds West 177.7 feet  
thence North 57 Degrees 52 Minutes 33 Seconds West 161.4 feet  
thence North 54 Degrees 15 Minutes 25 Seconds West 128.7 feet  
thence North 40 Degrees 19 Minutes 43 Seconds West 120.9 feet more or less to **the ending**

**point at:** 41 degrees 32 minutes 31.04 seconds North Latitude and -113 degrees 08 minutes 20.47 seconds West Longitude, which can be converted to mapping accuracy State Plane Utah North Zone NAD 83 feet coordinates of X = 1,191,758.7 feet and Y = 3,725,416.4 feet.



## Appendix B to Attachment 4

**Popular Name: North End Upper Hogup**

**County: Box Elder**

**County Road Number: 126**

**State Geographic Information Database (SGID) Road Identification Number: RD020034.**

**Road-Segment Number: 003**

**Road-Segment Length: 0.44 miles more or less.**

**Believed owner of the land underlying this road-segment is: Bureau of Land Management.**

*The following description is based upon the geographic coordinate system using the NAD83 Datum. The source is GPS mapping grade data as indicated in the metadata and/or the transportation data model of the State of Utah Geographic Information Database (SGID).*

The road-segment itself is the monument that is identified by its physical presence on the land. The location of said physical presence is closely approximated by mapping grade Global Positioning System (GPS) data. Said data are checked against the corresponding gray-scale 1-meter Digital Orthophoto Quadrangles published by the United States Geological Survey (USGS) to verify a reasonable degree of accuracy. In circumstances where accurate satellite signal acquisition is not possible, such as deep, narrow canyons or under a canopy of dense foliage, or where very sharp curves in the road make accuracy questionable, such portions of the road were digitized from the corresponding gray-scale 1-meter Digital Orthophoto Quadrangles published by the United States Geological Survey (USGS).

This road-segment may traverse:

Township 10 North Range 11 West, Section(s) 30, Salt Lake Base & Meridian

The following description closely approximates the location of the centerline of the physical monument (North End Upper Hogup)-- Segment 003 based on mapping grade Global Positioning System (GPS) data as defined above:

**Beginning at a point** on the road center line located at 41 degrees 33 minutes 25.16 seconds North Latitude and -113 degrees 09 minutes 01.31 seconds West Longitude, which can be converted to mapping accuracy State Plane Utah North Zone NAD 83 feet coordinates of X = 1,188,758.0 feet and Y = 3,730,952.1 feet; thence the following courses along the said road center line:

thence North 07 Degrees 10 Minutes 52 Seconds West 170.1 feet  
thence North 11 Degrees 07 Minutes 52 Seconds West 106.9 feet  
thence North 13 Degrees 18 Minutes 28 Seconds West 111.1 feet  
thence North 05 Degrees 24 Minutes 00 Seconds West 115.3 feet  
thence North 07 Degrees 46 Minutes 36 Seconds West 119.1 feet  
thence North 16 Degrees 18 Minutes 18 Seconds West 122.8 feet  
thence North 17 Degrees 49 Minutes 36 Seconds West 125.6 feet  
thence North 24 Degrees 05 Minutes 17 Seconds West 116.5 feet  
thence North 27 Degrees 48 Minutes 00 Seconds West 103.2 feet  
thence North 19 Degrees 21 Minutes 51 Seconds West 90.6 feet  
thence North 26 Degrees 10 Minutes 31 Seconds West 69.3 feet

thence North 25 Degrees 08 Minutes 46 Seconds West 81.3 feet  
thence North 04 Degrees 31 Minutes 08 Seconds West 99 feet  
thence North 18 Degrees 49 Minutes 38 Seconds West 110.7 feet  
thence North 22 Degrees 48 Minutes 28 Seconds West 115 feet  
thence North 10 Degrees 18 Minutes 25 Seconds West 109.9 feet  
thence North 17 Degrees 44 Minutes 10 Seconds West 103.1 feet  
thence North 26 Degrees 28 Minutes 57 Seconds West 199.5 feet  
thence North 23 Degrees 21 Minutes 01 Seconds West 92.3 feet  
thence North 33 Degrees 06 Minutes 36 Seconds West 62.4 feet  
thence North 49 Degrees 59 Minutes 36 Seconds West 111.5 feet more or less to **the ending**

**point at:** 41 degrees 33 minutes 046.5 seconds North Latitude and -113 degrees 09 minutes 11.61 seconds West Longitude, which can be converted to mapping accuracy State Plane Utah North Zone NAD 83 feet coordinates of X = 1,188,015.6 feet and Y = 3,733,126.1 feet.

## Appendix C to Attachment 4

**Popular Name: North End Upper Hogup**

**County: Box Elder**

**County Road Number: 126**

**State Geographic Information Database (SGID) Road Identification Number: RD020034.**

**Road-Segment Number: 005**

**Road-Segment Length: 1.48 miles more or less.**

**Believed owner of the land underlying this road-segment is: Bureau of Land Management.**

*The following description is based upon the geographic coordinate system using the NAD83 Datum. The source is GPS mapping grade data as indicated in the metadata and/or the transportation data model of the State of Utah Geographic Information Database (SGID).*

The road-segment itself is the monument that is identified by its physical presence on the land. The location of said physical presence is closely approximated by mapping grade Global Positioning System (GPS) data. Said data are checked against the corresponding gray-scale 1-meter Digital Orthophoto Quadrangles published by the United States Geological Survey (USGS) to verify a reasonable degree of accuracy. In circumstances where accurate satellite signal acquisition is not possible, such as deep, narrow canyons or under a canopy of dense foliage, or where very sharp curves in the road make accuracy questionable, such portions of the road were digitized from the corresponding gray-scale 1-meter Digital Orthophoto Quadrangles published by the United States Geological Survey (USGS).

This road-segment may traverse:

Township 10 North Range 12 West, Section(s) 23,24, Salt Lake Base & Meridian

The following description closely approximates the location of the centerline of the physical monument (North End Upper Hogup)-- Segment 005 based on mapping grade Global Positioning System (GPS) data as defined above:

**Beginning at a point** on the road center line located at 41 degrees 34 minutes 17.93 seconds North Latitude and -113 degrees 09 minutes 24.38 seconds West Longitude, which can be converted to mapping accuracy State Plane Utah North Zone NAD 83 feet coordinates of X = 1,187,105.7 feet and Y = 3,736,325.5 feet; thence the following courses along the said road center line:

thence North 16 Degrees 50 Minutes 12 Seconds East	162 feet
thence North 20 Degrees 58 Minutes 35 Seconds East	179.6 feet
thence North 09 Degrees 09 Minutes 39 Seconds East	163 feet
thence North 10 Degrees 37 Minutes 20 Seconds East	158.7 feet
thence North 23 Degrees 25 Minutes 59 Seconds East	150.6 feet
thence North 20 Degrees 27 Minutes 22 Seconds East	156.2 feet
thence North 10 Degrees 58 Minutes 14 Seconds East	157.2 feet
thence North 13 Degrees 51 Minutes 06 Seconds East	147.2 feet
thence North 11 Degrees 30 Minutes 02 Seconds East	139.1 feet
thence North 07 Degrees 57 Minutes 04 Seconds East	116 feet
thence North 13 Degrees 51 Minutes 58 Seconds West	116.4 feet

thence North 04 Degrees 07 Minutes 13 Seconds East 118.1 feet  
 thence North 12 Degrees 37 Minutes 54 Seconds East 119.9 feet  
 thence North 16 Degrees 40 Minutes 07 Seconds East 116.6 feet  
 thence North 30 Degrees 51 Minutes 28 Seconds East 138.1 feet  
 thence North 27 Degrees 52 Minutes 54 Seconds East 111.7 feet  
 thence North 14 Degrees 30 Minutes 33 Seconds East 73 feet  
 thence North 43 Degrees 21 Minutes 51 Seconds West 80.8 feet  
 thence North 46 Degrees 19 Minutes 28 Seconds West 94.4 feet  
 thence North 28 Degrees 24 Minutes 42 Seconds West 128.3 feet  
 thence North 37 Degrees 53 Minutes 10 Seconds West 105.5 feet  
 thence North 55 Degrees 29 Minutes 36 Seconds West 94.7 feet  
 thence North 65 Degrees 45 Minutes 16 Seconds West 110.4 feet  
 thence North 64 Degrees 35 Minutes 59 Seconds West 234.2 feet  
 thence North 69 Degrees 54 Minutes 01 Seconds West 112.7 feet  
 thence North 75 Degrees 19 Minutes 53 Seconds West 126.7 feet  
 thence North 73 Degrees 50 Minutes 22 Seconds West 144.4 feet  
 thence North 68 Degrees 01 Minutes 59 Seconds West 138.3 feet  
 thence North 69 Degrees 29 Minutes 30 Seconds West 120.8 feet  
 thence North 70 Degrees 46 Minutes 32 Seconds West 126.4 feet  
 thence North 67 Degrees 00 Minutes 37 Seconds West 132.6 feet  
 thence North 69 Degrees 59 Minutes 38 Seconds West 146.3 feet  
 thence North 66 Degrees 40 Minutes 26 Seconds West 179.8 feet  
 thence North 65 Degrees 18 Minutes 57 Seconds West 174.5 feet  
 thence North 67 Degrees 40 Minutes 37 Seconds West 170.3 feet  
 thence North 64 Degrees 07 Minutes 08 Seconds West 170.8 feet  
 thence North 67 Degrees 50 Minutes 34 Seconds West 175.8 feet  
 thence North 60 Degrees 30 Minutes 04 Seconds West 174.7 feet  
 thence North 62 Degrees 06 Minutes 38 Seconds West 176.9 feet  
 thence North 69 Degrees 20 Minutes 26 Seconds West 173.9 feet  
 thence North 62 Degrees 34 Minutes 51 Seconds West 162 feet  
 thence North 64 Degrees 11 Minutes 06 Seconds West 163.7 feet  
 thence North 66 Degrees 46 Minutes 14 Seconds West 160 feet  
 thence North 68 Degrees 21 Minutes 02 Seconds West 149 feet  
 thence North 67 Degrees 23 Minutes 50 Seconds West 134.7 feet  
 thence North 74 Degrees 48 Minutes 55 Seconds West 104.2 feet  
 thence South 77 Degrees 23 Minutes 44 Seconds West 38.6 feet  
 thence South 15 Degrees 36 Minutes 21 Seconds West 47.8 feet  
 thence South 46 Degrees 30 Minutes 29 Seconds West 7.2 feet  
 thence South 14 Degrees 46 Minutes 12 Seconds West 101.9 feet  
 thence South 38 Degrees 27 Minutes 06 Seconds West 111.5 feet  
 thence South 48 Degrees 03 Minutes 56 Seconds West 121.1 feet  
 thence South 64 Degrees 49 Minutes 52 Seconds West 121.1 feet  
 thence South 85 Degrees 53 Minutes 11 Seconds West 124.6 feet  
 thence North 84 Degrees 22 Minutes 37 Seconds West 126.3 feet  
 thence South 87 Degrees 14 Minutes 27 Seconds West 116.6 feet  
 thence South 75 Degrees 28 Minutes 22 Seconds West 120.5 feet  
 thence South 78 Degrees 44 Minutes 15 Seconds West 95.2 feet  
 thence North 81 Degrees 27 Minutes 31 Seconds West 106.3 feet  
 thence South 87 Degrees 19 Minutes 12 Seconds West 80.9 feet

thence South 87 Degrees 19 Minutes 22 Seconds West 3.7 feet more or less to **the ending point**  
**at:** 41 degrees 34 minutes 52.63 seconds North Latitude and -113 degrees 10 minutes 21.11 seconds West  
Longitude, which can be converted to mapping accuracy State Plane Utah North Zone NAD 83 feet  
coordinates of X = 1,182,862.7 feet and Y = 3,739,919.5 feet.