

Ent 255660 Bk 1030 Pg 917
Date 19-Nov-2007 9:27AM Fee \$0.00
LuAnn Adams - Filed By Ia
Box Elder Co., UT
For GOVERNOR FOR THE STATE OF UTAH

**Amended Acknowledgment and
Amended Notice of Acknowledgment
of Acceptance of R.S. 2477
Right-of-Way Grant**

THE STATE OF UTAH

TO ALL WHOM THESE PRESENTS SHALL COME, Greeting:

Know ye, This is an Amended Acknowledgment and Amended Notice of Acknowledgment made under Utah Code Sections 72-5-309 through 310 inclusive, that the grant of the United States of America of “the right of way for the construction of highways over public lands, not reserved for public uses” under United States Revised Statutes 2477 (43 U.S.C. Section 932 (repealed October 21, 1976, with proviso recognizing the validity of rights-of-way already established)) was accepted for and on behalf of the State of Utah and its political subdivision Box Elder County as it pertains to the highway located in Box Elder County known as Upper East Hogup Road; County Road Number: 127; State Geographic Information Database (SGID) Road Identification Number: RD020035. Total road length is 11.68 miles more or less.

This Amended Acknowledgment and Amended Notice of Acknowledgment supersedes the information contained in the Acknowledgment recorded at Ent 238500, Bk 988, Beg Pg 579.

The reason for this Amended Acknowledgment and Amended Notice of Acknowledgment includes, but is not limited to, the fact that the road was constructed, mechanically, or by continuous use as a public highway for a period of at least ten years, over public lands not reserved for public uses, prior to the earlier of (a) the October 21, 1976 repeal of R.S. 2477 or (b) the date the servient estate was reserved for public uses.

This Amended Acknowledgment and Amended Notice of Acknowledgment applies only to the segments of the road that traverse land owned by the Bureau of Land Management, United States Department of the Interior, and does not apply to segments of the road that traverse land owned by any other person or entity. The State of Utah and its political subdivisions reserve the right to make further acknowledgments and notices of acknowledgment with regard to road segments that traverse land owned by other entities, including the United States of America, through one or more of its agencies.

A printed copy of a map showing the location of the road in said county is appended hereto as “Attachment 1,” a printed copy of representative photos of the road is appended hereto as “Attachment 2,” a printed copy of a description of the beginning and ending points of the entire road together with a list of Townships, Ranges and Sections that may be traversed by the road in said county is appended hereto as “Attachment 3,” and a printed copy of the Road Centerline Description Cover Page(s) is appended hereto as “Attachment 4.” The Appendices listed in “Attachment 4” that contain the actual road centerline descriptions are incorporated herein by reference.

A printed copy of this Amended Acknowledgment and Amended Notice of Acknowledgment, together with its Attachments and Appendices, may be viewed and/or obtained at the office of the Utah State Archives.

An electronic copy of this Amended Acknowledgment and Amended Notice of Acknowledgment, together with its Attachments and Appendices, may be viewed and/or downloaded as read-only PDF (Portable Document Format) files via the Internet at <http://recorded2477roads.utah.gov>.

The owner of the servient estate in the land underlying the road-segments subject to this Amended Acknowledgment and Amended Notice is believed to be the United States of America through one or more of its agencies. Any of such agencies or any other person with a servient ownership claim or a competing dominant estate right-of-way ownership claim, may file a petition in the State District Court for Salt Lake County for a decision regarding the correctness of this Amended Acknowledgment. A claimant shall file a petition within sixty (60) days after receipt of this Notice.

In Witness Whereof, I, John Harja, the official designee of the Governor of the State of Utah, in conformity to the laws of the State (Utah Code Sections 72-5-308 through 310 inclusive), have caused this Amended Acknowledgment and Amend Notice of Acknowledgment to be made.

Signed by my hand in Salt Lake City, Utah, the 15th day of NOVEMBER, 2007.

By the Governor's Designee



John Harja

CERTIFICATION

State of Utah)
 : ss
County of Salt Lake)

I hereby certify that the signer of the foregoing document, John Harja, is personally known by me, has made a voluntary signature and taken an oath stating that he is the official designee of the Governor of the State of Utah and is authorized to sign this document on the Governor's behalf pursuant to Utah Code Section 72-5-309. He further vouched that, based upon information and belief, the facts alleged therein are true.

Dated this 15th day of November, 2007.



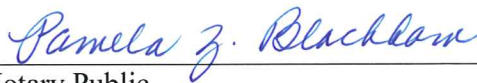

Notary Public

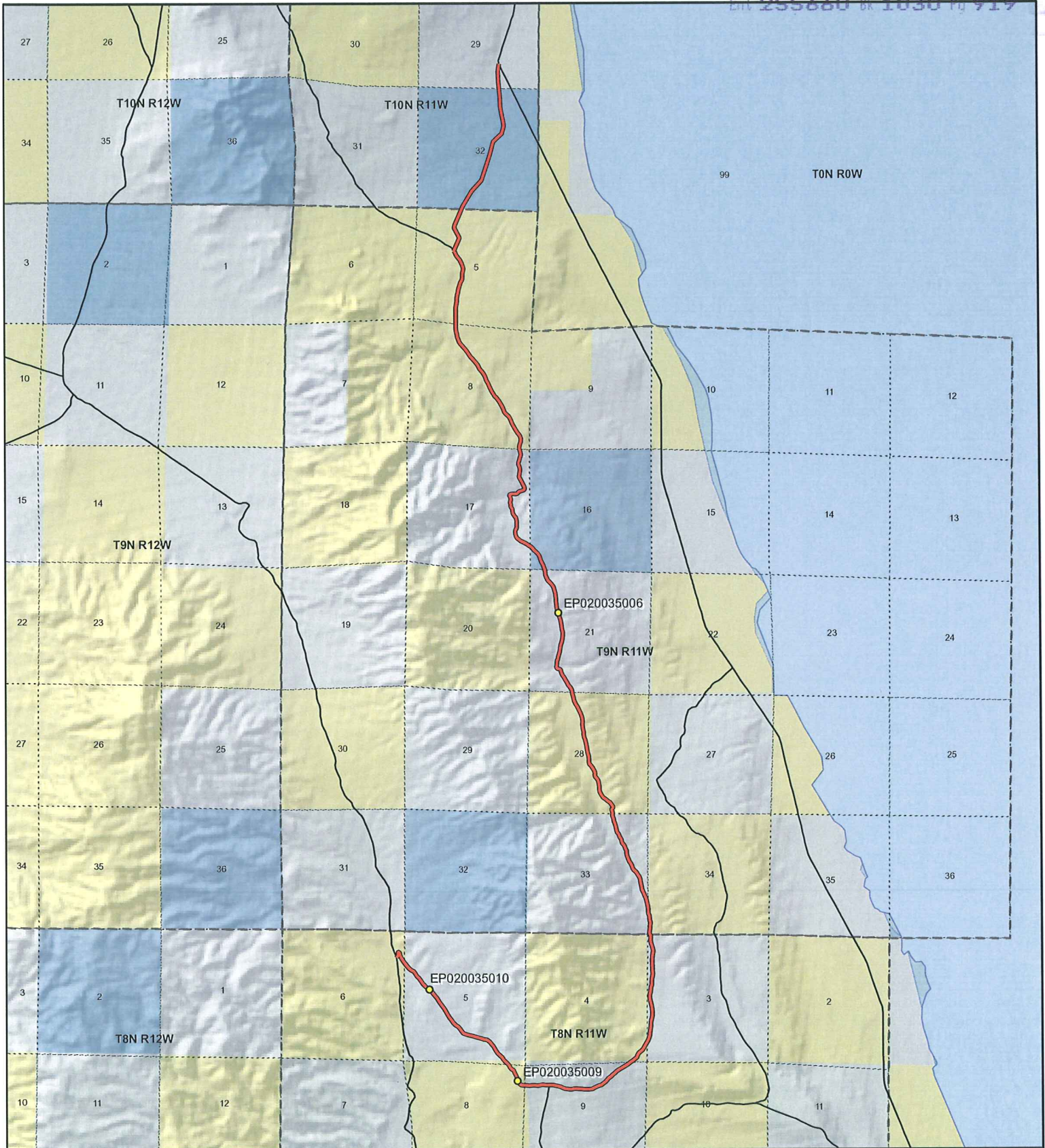

1:67,703
1 inch equals 1.1 miles

Upper East Hogup Road - Box Elder County SGID RD_ID RD020035

Land Ownership Categories		Transportation Network	
<ul style="list-style-type: none"> ◆ BLM ◆ Private ◆ SITLA, State Trust Land ◆ USFS, National Forest ◆ State Parks and Recreation ◆ Tribal, Indian Reservation ◆ NPS, National Park 	<ul style="list-style-type: none"> ◆ Wilderness ◆ UDWR Wildlife Reserve ◆ DOD, Military ◆ State Sovereign Land ◆ National Recreation Area ◆ USFWS, Natl. Wildlife Refuge 	<ul style="list-style-type: none"> — Upper East Hogup Road — Title V: Issued Or Under Consideration By BLM Or County — Other Roads ● Photo Event Point 	<ul style="list-style-type: none"> Section = 1 Mile

Map prepared by the State of Utah
Automated Geographic Reference Center
Room 5130 State Office Building
Salt Lake City, Utah 84114
Nov 10, 2006

Attachment 2

ENT 255660 BK 1030 Pg 920



EP020035006



EP020035009



EP020035010

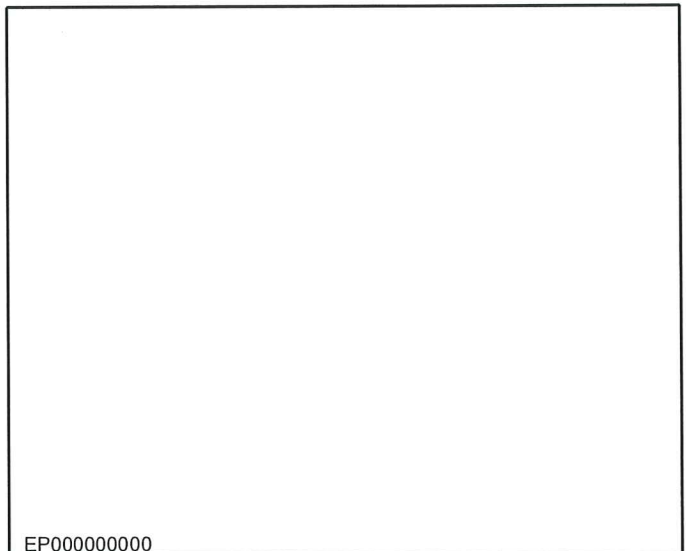

EP000000000

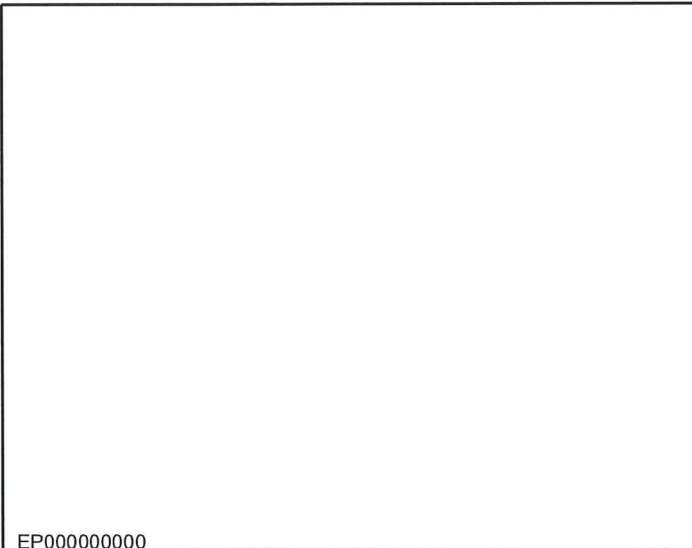

EP000000000

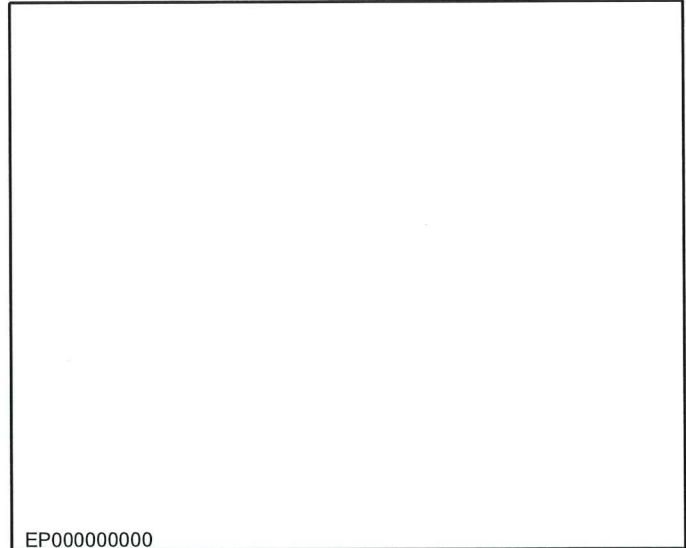

EP000000000

Upper East Hogup Road - Box Elder County
SGID RD_ID RD020035



Map prepared by the State of Utah
Automated Geographic Reference Center
Room 5130 State Office Building
Salt Lake City, Utah 84114
November 9, 2006



Attachment 3

Beginning & Ending Points and Township, Range, and Section References For:

Popular Name: Upper East Hogup Road

County: Box Elder

County Road Number: 127

State Geographic Information Database (SGID) Road Identification Number: RD020035.

Total Road Length: 11.68 miles more or less.

Beginning at a point on the road centerline located at 41 degrees 27 minutes 09.98 seconds North Latitude and -113 degrees 07 minutes 59.88 seconds West Longitude, which can be converted to mapping accuracy State Plane Utah North Zone NAD 83 feet coordinates of X = 1,192,713.6 feet and Y = 3,692,896.6 feet based on the US Survey Foot conversion.

Ending at a point on the road centerline located at 41 degrees 33 minutes 33.56 seconds North Latitude and -113 degrees 07 minutes 11.26 seconds West Longitude, which can be converted to mapping accuracy State Plane Utah North Zone NAD 83 feet coordinates of X = 1,197,138.5 feet and Y = 3,731,644.6 feet based on the US Survey Foot conversion.

This road may traverse:

Township 10 North Range 11 West, Section(s) 29,32, Salt Lake Base & Meridian

Township 8 North Range 11 West, Section(s) 3,4,5,6,8,9, Salt Lake Base & Meridian

Township 9 North Range 11 West, Section(s) 5,8,16,17,21,28,33,34, Salt Lake Base & Meridian

See Attachment 1 above for a cartographic depiction of the course of this road.

Attachment 4
Road Centerline Description Cover Page(s)

Popular Name: Upper East Hogup Road

County: Box Elder

County Road Number: 127

State Geographic Information Database (SGID) Road Identification Number: RD020035.

Total Road Length: 11.68 miles more or less.

Centerline Descriptions Of Road-Segments That Cross Over Federally Owned Land, Derived From Global Positioning System Data And Cross-checked against USGS Digital Orthophoto Quadrangles Compiled By The Utah Automated Geographic Reference Center And Entered Into The State Geographic Information Database (SGID).

Road-Segments Listed by SGID Road Identification Number (RD ID)	Road-Segment Numbers	Believed Ownership Of Servient Estate	Approximate Segment Length	See Attached Appendix
RD020035	001	BLM	0.16 Miles	A
RD020035	002	PVT	1.17 Miles	(not shown)
RD020035	003	BLM	0.29 Miles	B
RD020035	004	PVT	0.97 Miles	(not shown)
RD020035	005	BLM	0.18 Miles	C
RD020035	006	PVT	0.91 Miles	(not shown)
RD020035	007	BLM	0.27 Miles	D
RD020035	008	PVT	0.8 Miles	(not shown)
RD020035	009	BLM	1.1 Miles	E
RD020035	010	PVT	1.09 Miles	(not shown)
RD020035	011	ST	0.24 Miles	(not shown)
RD020035	012	PVT	0.99 Miles	(not shown)
RD020035	013	BLM	2.2 Miles	F
RD020035	014	ST	1.1 Miles	(not shown)
RD020035	015	PVT	.21 Miles	(not shown)
		Total Road Length	11.68	_____

* Indicates that a Title V permit will be requested, is in process, or has been issued.

† Indicates that road-segments crossing Forest Service land are under consideration by the state and county as of the date of this Amended Acknowledgment and Amended Notice of Acknowledgment.

Appendix A to Attachment 4

Popular Name: Upper East Hogup Road

County: Box Elder

County Road Number: 127

State Geographic Information Database (SGID) Road Identification Number: RD020035.

Road-Segment Number: 001

Road-Segment Length: 0.16 miles more or less.

Believed owner of the land underlying this road-segment is: Bureau of Land Management.

The following description is based upon the geographic coordinate system using the NAD83 Datum. The source is GPS mapping grade data as indicated in the metadata and/or the transportation data model of the State of Utah Geographic Information Database (SGID).

The road-segment itself is the monument that is identified by its physical presence on the land. The location of said physical presence is closely approximated by mapping grade Global Positioning System (GPS) data. Said data are checked against the corresponding gray-scale 1-meter Digital Orthophoto Quadrangles published by the United States Geological Survey (USGS) to verify a reasonable degree of accuracy. In circumstances where accurate satellite signal acquisition is not possible, such as deep, narrow canyons or under a canopy of dense foliage, or where very sharp curves in the road make accuracy questionable, such portions of the road were digitized from the corresponding gray-scale 1-meter Digital Orthophoto Quadrangles published by the United States Geological Survey (USGS).

This road-segment may traverse:

Township 8 North Range 11 West, Section(s) 5,6, Salt Lake Base & Meridian

The following description closely approximates the location of the centerline of the physical monument (Upper East Hogup Road)-- Segment 001 based on mapping grade Global Positioning System (GPS) data as defined above:

Beginning at a point on the road center line located at 41 degrees 27 minutes 09.98 seconds North Latitude and -113 degrees 07 minutes 59.88 seconds West Longitude, which can be converted to mapping accuracy State Plane Utah North Zone NAD 83 feet coordinates of X = 1,192,713.6 feet and Y = 3,692,896.6 feet; thence the following courses along the said road center line:

thence North 40 Degrees 42 Minutes 24 Seconds East	37 feet
thence North 19 Degrees 01 Minutes 23 Seconds East	64.3 feet
thence North 00 Degrees 54 Minutes 34 Seconds East	75.5 feet
thence North 00 Degrees 18 Minutes 03 Seconds East	59.1 feet
thence North 59 Degrees 32 Minutes 06 Seconds East	42.5 feet
thence South 42 Degrees 13 Minutes 14 Seconds East	68.3 feet
thence South 13 Degrees 59 Minutes 10 Seconds East	118.2 feet
thence South 27 Degrees 09 Minutes 17 Seconds East	132.3 feet
thence South 32 Degrees 28 Minutes 17 Seconds East	137.5 feet
thence South 33 Degrees 49 Minutes 18 Seconds East	82.1 feet
thence South 33 Degrees 49 Minutes 18 Seconds East	45.7 feet

thence South 38 Degrees 59 Minutes 39 Seconds East 5.4 feet more or less to **the ending point**
at: 41 degrees 27 minutes 07.43 seconds North Latitude and -113 degrees 07 minutes 55 seconds West
Longitude, which can be converted to mapping accuracy State Plane Utah North Zone NAD 83 feet
coordinates of X = 1,193,080.1 feet and Y = 3,692,632.1 feet.

Appendix B to Attachment 4

Popular Name: Upper East Hogup Road

County: Box Elder

County Road Number: 127

State Geographic Information Database (SGID) Road Identification Number: RD020035.

Road-Segment Number: 003

Road-Segment Length: 0.29 miles more or less.

Believed owner of the land underlying this road-segment is: Bureau of Land Management.

The following description is based upon the geographic coordinate system using the NAD83 Datum. The source is GPS mapping grade data as indicated in the metadata and/or the transportation data model of the State of Utah Geographic Information Database (SGID).

The road-segment itself is the monument that is identified by its physical presence on the land. The location of said physical presence is closely approximated by mapping grade Global Positioning System (GPS) data. Said data are checked against the corresponding gray-scale 1-meter Digital Orthophoto Quadrangles published by the United States Geological Survey (USGS) to verify a reasonable degree of accuracy. In circumstances where accurate satellite signal acquisition is not possible, such as deep, narrow canyons or under a canopy of dense foliage, or where very sharp curves in the road make accuracy questionable, such portions of the road were digitized from the corresponding gray-scale 1-meter Digital Orthophoto Quadrangles published by the United States Geological Survey (USGS).

This road-segment may traverse:

Township 8 North Range 11 West, Section(s) 5,8,9, Salt Lake Base & Meridian

The following description closely approximates the location of the centerline of the physical monument (Upper East Hogup Road)-- Segment 003 based on mapping grade Global Positioning System (GPS) data as defined above:

Beginning at a point on the road center line located at 41 degrees 26 minutes 027.1 seconds North Latitude and -113 degrees 06 minutes 57.36 seconds West Longitude, which can be converted to mapping accuracy State Plane Utah North Zone NAD 83 feet coordinates of X = 1,197,392.4 feet and Y = 3,688,468.8 feet; thence the following courses along the said road center line:

thence South 39 Degrees 45 Minutes 47 Seconds East	53.2 feet
thence South 47 Degrees 57 Minutes 55 Seconds East	131.4 feet
thence South 37 Degrees 52 Minutes 28 Seconds East	85.8 feet
thence South 37 Degrees 52 Minutes 30 Seconds East	32.2 feet
thence South 31 Degrees 09 Minutes 30 Seconds East	114.6 feet
thence South 49 Degrees 19 Minutes 34 Seconds East	110 feet
thence South 59 Degrees 01 Minutes 52 Seconds East	85.2 feet
thence South 22 Degrees 34 Minutes 27 Seconds East	79.7 feet
thence South 21 Degrees 57 Minutes 12 Seconds East	95.3 feet
thence South 36 Degrees 47 Minutes 56 Seconds East	120.3 feet
thence South 19 Degrees 58 Minutes 38 Seconds East	108.3 feet

thence South 15 Degrees 00 Minutes 29 Seconds East 121.7 feet

thence South 30 Degrees 07 Minutes 21 Seconds East 109.6 feet

thence South 53 Degrees 32 Minutes 28 Seconds East 99.1 feet

thence South 77 Degrees 54 Minutes 53 Seconds East 112.9 feet

thence South 87 Degrees 53 Minutes 42 Seconds East 35.2 feet

thence South 87 Degrees 53 Minutes 43 Seconds East 57.9 feet more or less to **the ending**

point at: 41 degrees 26 minutes 16.47 seconds North Latitude and -113 degrees 06 minutes 44.43 seconds West Longitude, which can be converted to mapping accuracy State Plane Utah North Zone NAD 83 feet coordinates of X = 1,198,357.3 feet and Y = 3,687,374.6 feet.

Appendix C to Attachment 4

Popular Name: Upper East Hogup Road

County: Box Elder

County Road Number: 127

State Geographic Information Database (SGID) Road Identification Number: RD020035.

Road-Segment Number: 005

Road-Segment Length: 0.18 miles more or less.

Believed owner of the land underlying this road-segment is: Bureau of Land Management.

The following description is based upon the geographic coordinate system using the NAD83 Datum. The source is GPS mapping grade data as indicated in the metadata and/or the transportation data model of the State of Utah Geographic Information Database (SGID).

The road-segment itself is the monument that is identified by its physical presence on the land. The location of said physical presence is closely approximated by mapping grade Global Positioning System (GPS) data. Said data are checked against the corresponding gray-scale 1-meter Digital Orthophoto Quadrangles published by the United States Geological Survey (USGS) to verify a reasonable degree of accuracy. In circumstances where accurate satellite signal acquisition is not possible, such as deep, narrow canyons or under a canopy of dense foliage, or where very sharp curves in the road make accuracy questionable, such portions of the road were digitized from the corresponding gray-scale 1-meter Digital Orthophoto Quadrangles published by the United States Geological Survey (USGS).

This road-segment may traverse:

Township 8 North Range 11 West, Section(s) 4, Salt Lake Base & Meridian

The following description closely approximates the location of the centerline of the physical monument (Upper East Hogup Road)-- Segment 005 based on mapping grade Global Positioning System (GPS) data as defined above:

Beginning at a point on the road center line located at 41 degrees 26 minutes 28.17 seconds North Latitude and -113 degrees 05 minutes 43.24 seconds West Longitude, which can be converted to mapping accuracy State Plane Utah North Zone NAD 83 feet coordinates of X = 1,203,038.6 feet and Y = 3,688,472.8 feet; thence the following courses along the said road center line:

thence North 47 Degrees 55 Minutes 33 Seconds East 36.1 feet
thence North 51 Degrees 59 Minutes 21 Seconds East 107.4 feet
thence North 55 Degrees 35 Minutes 35 Seconds East 82 feet
thence North 24 Degrees 32 Minutes 19 Seconds East 79.6 feet
thence North 23 Degrees 58 Minutes 28 Seconds East 104.4 feet
thence North 42 Degrees 18 Minutes 27 Seconds East 95.9 feet
thence North 51 Degrees 17 Minutes 23 Seconds East 82.4 feet
thence North 49 Degrees 33 Minutes 11 Seconds East 70.8 feet
thence North 32 Degrees 32 Minutes 37 Seconds East 70.7 feet
thence North 27 Degrees 42 Minutes 59 Seconds East 107.4 feet
thence North 28 Degrees 38 Minutes 04 Seconds East 119.2 feet more or less to **the ending**

point at: 41 degrees 26 minutes 35.51 seconds North Latitude and -113 degrees 05 minutes 35.77 seconds West Longitude, which can be converted to mapping accuracy State Plane Utah North Zone NAD 83 feet coordinates of X = 1,203,621.0 feet and Y = 3,689,204.9 feet.

Appendix D to Attachment 4

Popular Name: Upper East Hogup Road

County: Box Elder

County Road Number: 127

State Geographic Information Database (SGID) Road Identification Number: RD020035.

Road-Segment Number: 007

Road-Segment Length: 0.27 miles more or less.

Believed owner of the land underlying this road-segment is: Bureau of Land Management.

The following description is based upon the geographic coordinate system using the NAD83 Datum. The source is GPS mapping grade data as indicated in the metadata and/or the transportation data model of the State of Utah Geographic Information Database (SGID).

The road-segment itself is the monument that is identified by its physical presence on the land. The location of said physical presence is closely approximated by mapping grade Global Positioning System (GPS) data. Said data are checked against the corresponding gray-scale 1-meter Digital Orthophoto Quadrangles published by the United States Geological Survey (USGS) to verify a reasonable degree of accuracy. In circumstances where accurate satellite signal acquisition is not possible, such as deep, narrow canyons or under a canopy of dense foliage, or where very sharp curves in the road make accuracy questionable, such portions of the road were digitized from the corresponding gray-scale 1-meter Digital Orthophoto Quadrangles published by the United States Geological Survey (USGS).

This road-segment may traverse:

Township 9 North Range 11 West, Section(s) 33,34, Salt Lake Base & Meridian

The following description closely approximates the location of the centerline of the physical monument (Upper East Hogup Road)-- Segment 007 based on mapping grade Global Positioning System (GPS) data as defined above:

Beginning at a point on the road center line located at 41 degrees 27 minutes 21.96 seconds North Latitude and -113 degrees 05 minutes 34.72 seconds West Longitude, which can be converted to mapping accuracy State Plane Utah North Zone NAD 83 feet coordinates of X = 1,203,786.7 feet and Y = 3,693,903.8 feet; thence the following courses along the said road center line:

thence North 22 Degrees 30 Minutes 56 Seconds West 35.9 feet
thence North 22 Degrees 30 Minutes 58 Seconds West 46.6 feet
thence North 04 Degrees 39 Minutes 53 Seconds East 105.4 feet
thence North 04 Degrees 23 Minutes 24 Seconds East 123.4 feet
thence North 05 Degrees 17 Minutes 05 Seconds East 103.8 feet
thence North 07 Degrees 56 Minutes 24 Seconds East 91.2 feet
thence North 05 Degrees 33 Minutes 09 Seconds West 75.8 feet
thence North 12 Degrees 53 Minutes 14 Seconds West 89.1 feet
thence North 09 Degrees 17 Minutes 49 Seconds West 86.4 feet
thence North 03 Degrees 54 Minutes 01 Seconds West 100.3 feet
thence North 18 Degrees 54 Minutes 11 Seconds West 89.6 feet

thence North 14 Degrees 35 Minutes 28 Seconds West 103.9 feet

thence North 00 Degrees 15 Minutes 39 Seconds East 126 feet

thence North 04 Degrees 28 Minutes 49 Seconds West 113.5 feet

thence North 11 Degrees 25 Minutes 58 Seconds West 14.2 feet

thence North 11 Degrees 26 Minutes 01 Seconds West 72.7 feet

thence North 13 Degrees 59 Minutes 08 Seconds West 33.7 feet more or less to **the ending**

point at: 41 degrees 27 minutes 35.64 seconds North Latitude and -113 degrees 05 minutes 36.74 seconds West Longitude, which can be converted to mapping accuracy State Plane Utah North Zone NAD 83 feet coordinates of X = 1,203,658.5 feet and Y = 3,695,291.7 feet.

Appendix E to Attachment 4

Popular Name: Upper East Hogup Road

County: Box Elder

County Road Number: 127

State Geographic Information Database (SGID) Road Identification Number: RD020035.

Road-Segment Number: 009

Road-Segment Length: 1.1 miles more or less.

Believed owner of the land underlying this road-segment is: Bureau of Land Management.

The following description is based upon the geographic coordinate system using the NAD83 Datum. The source is GPS mapping grade data as indicated in the metadata and/or the transportation data model of the State of Utah Geographic Information Database (SGID).

The road-segment itself is the monument that is identified by its physical presence on the land. The location of said physical presence is closely approximated by mapping grade Global Positioning System (GPS) data. Said data are checked against the corresponding gray-scale 1-meter Digital Orthophoto Quadrangles published by the United States Geological Survey (USGS) to verify a reasonable degree of accuracy. In circumstances where accurate satellite signal acquisition is not possible, such as deep, narrow canyons or under a canopy of dense foliage, or where very sharp curves in the road make accuracy questionable, such portions of the road were digitized from the corresponding gray-scale 1-meter Digital Orthophoto Quadrangles published by the United States Geological Survey (USGS).

This road-segment may traverse:

Township 9 North Range 11 West, Section(s) 21,28, Salt Lake Base & Meridian

The following description closely approximates the location of the centerline of the physical monument (Upper East Hogup Road)-- Segment 009 based on mapping grade Global Positioning System (GPS) data as defined above:

Beginning at a point on the road center line located at 41 degrees 28 minutes 13.54 seconds North Latitude and -113 degrees 05 minutes 57.52 seconds West Longitude, which can be converted to mapping accuracy State Plane Utah North Zone NAD 83 feet coordinates of X = 1,202,147.4 feet and Y = 3,699,156.1 feet; thence the following courses along the said road center line:

thence North 07 Degrees 20 Minutes 31 Seconds East 4.3 feet
thence North 07 Degrees 20 Minutes 18 Seconds East 10.5 feet
thence North 10 Degrees 12 Minutes 39 Seconds West 89.9 feet
thence North 17 Degrees 15 Minutes 14 Seconds West 82.3 feet
thence North 30 Degrees 22 Minutes 45 Seconds East 64.9 feet
thence North 27 Degrees 27 Minutes 55 Seconds East 20.4 feet
thence North 26 Degrees 44 Minutes 09 Seconds East 33.2 feet
thence North 19 Degrees 52 Minutes 21 Seconds West 54 feet
thence North 31 Degrees 43 Minutes 09 Seconds West 76.9 feet
thence North 36 Degrees 13 Minutes 22 Seconds West 68.8 feet
thence North 41 Degrees 37 Minutes 39 Seconds West 50.2 feet

thence North 47 Degrees 26 Minutes 15 Seconds West 50.6 feet
 thence North 60 Degrees 50 Minutes 35 Seconds West 83.3 feet
 thence North 49 Degrees 16 Minutes 05 Seconds West 104.9 feet
 thence North 50 Degrees 56 Minutes 39 Seconds West 116.3 feet
 thence North 41 Degrees 30 Minutes 22 Seconds West 111.1 feet
 thence North 30 Degrees 06 Minutes 13 Seconds West 102.4 feet
 thence North 24 Degrees 58 Minutes 51 Seconds West 100.7 feet
 thence North 12 Degrees 33 Minutes 40 Seconds West 100.7 feet
 thence North 02 Degrees 52 Minutes 51 Seconds West 103.4 feet
 thence North 06 Degrees 22 Minutes 48 Seconds West 112.2 feet
 thence North 07 Degrees 18 Minutes 49 Seconds West 110.7 feet
 thence North 24 Degrees 25 Minutes 09 Seconds West 94.9 feet
 thence North 35 Degrees 27 Minutes 30 Seconds West 94.7 feet
 thence North 44 Degrees 12 Minutes 19 Seconds West 70.5 feet
 thence North 09 Degrees 50 Minutes 30 Seconds West 71.5 feet
 thence North 13 Degrees 20 Minutes 06 Seconds East 62.5 feet
 thence North 16 Degrees 02 Minutes 09 Seconds West 126.1 feet
 thence North 32 Degrees 17 Minutes 14 Seconds West 146.9 feet
 thence North 38 Degrees 45 Minutes 00 Seconds West 119.3 feet
 thence North 39 Degrees 47 Minutes 57 Seconds West 91.4 feet
 thence North 19 Degrees 04 Minutes 10 Seconds West 79.7 feet
 thence North 01 Degrees 14 Minutes 35 Seconds West 124.4 feet
 thence North 03 Degrees 31 Minutes 24 Seconds West 141.6 feet
 thence North 12 Degrees 43 Minutes 01 Seconds West 137.7 feet
 thence North 15 Degrees 44 Minutes 54 Seconds West 125.9 feet
 thence North 08 Degrees 10 Minutes 28 Seconds West 127.5 feet
 thence North 10 Degrees 36 Minutes 54 Seconds West 128.7 feet
 thence North 11 Degrees 22 Minutes 24 Seconds West 121.7 feet
 thence North 11 Degrees 38 Minutes 46 Seconds West 105.4 feet
 thence North 24 Degrees 58 Minutes 24 Seconds West 104.7 feet
 thence North 07 Degrees 42 Minutes 36 Seconds West 112.5 feet
 thence North 04 Degrees 24 Minutes 37 Seconds West 115.4 feet
 thence North 13 Degrees 56 Minutes 03 Seconds West 114.4 feet
 thence North 12 Degrees 18 Minutes 09 Seconds West 112.3 feet
 thence North 06 Degrees 28 Minutes 58 Seconds West 107.2 feet
 thence North 11 Degrees 27 Minutes 06 Seconds East 115.6 feet
 thence North 09 Degrees 47 Minutes 55 Seconds West 129.7 feet
 thence North 14 Degrees 32 Minutes 35 Seconds West 133.7 feet
 thence North 19 Degrees 29 Minutes 55 Seconds West 138.9 feet
 thence North 29 Degrees 10 Minutes 32 Seconds West 144.2 feet
 thence North 26 Degrees 40 Minutes 26 Seconds West 147.9 feet
 thence North 32 Degrees 45 Minutes 32 Seconds West 148.1 feet
 thence North 23 Degrees 19 Minutes 05 Seconds West 147.9 feet
 thence North 17 Degrees 29 Minutes 30 Seconds West 157.9 feet
 thence North 11 Degrees 45 Minutes 27 Seconds West 165.7 feet
 thence North 12 Degrees 48 Minutes 29 Seconds West 64 feet

thence North 12 Degrees 48 Minutes 30 Seconds West 25.1 feet more or less to **the ending point at:** 41 degrees 29 minutes 05.49 seconds North Latitude and -113 degrees 06 minutes 22.17 seconds West Longitude, which can be converted to mapping accuracy State Plane Utah North Zone NAD 83 feet

coordinates of X = 1,200,368.4 feet and Y = 3,704,447.4 feet.

Appendix F to Attachment 4

Popular Name: Upper East Hogup Road

County: Box Elder

County Road Number: 127

State Geographic Information Database (SGID) Road Identification Number: RD020035.

Road-Segment Number: 013

Road-Segment Length: 2.2 miles more or less.

Believed owner of the land underlying this road-segment is: Bureau of Land Management.

The following description is based upon the geographic coordinate system using the NAD83 Datum. The source is GPS mapping grade data as indicated in the metadata and/or the transportation data model of the State of Utah Geographic Information Database (SGID).

The road-segment itself is the monument that is identified by its physical presence on the land. The location of said physical presence is closely approximated by mapping grade Global Positioning System (GPS) data. Said data are checked against the corresponding gray-scale 1-meter Digital Orthophoto Quadrangles published by the United States Geological Survey (USGS) to verify a reasonable degree of accuracy. In circumstances where accurate satellite signal acquisition is not possible, such as deep, narrow canyons or under a canopy of dense foliage, or where very sharp curves in the road make accuracy questionable, such portions of the road were digitized from the corresponding gray-scale 1-meter Digital Orthophoto Quadrangles published by the United States Geological Survey (USGS).

This road-segment may traverse:

Township 9 North Range 11 West, Section(s) 5,8,17, Salt Lake Base & Meridian

The following description closely approximates the location of the centerline of the physical monument (Upper East Hogup Road)-- Segment 013 based on mapping grade Global Positioning System (GPS) data as defined above:

Beginning at a point on the road center line located at 41 degrees 30 minutes 48.62 seconds North Latitude and -113 degrees 06 minutes 55.07 seconds West Longitude, which can be converted to mapping accuracy State Plane Utah North Zone NAD 83 feet coordinates of X = 1,198,058.6 feet and Y = 3,714,929.8 feet; thence the following courses along the said road center line:

thence North 17 Degrees 34 Minutes 09 Seconds West 16.5 feet
thence North 05 Degrees 09 Minutes 52 Seconds West 2.4 feet
thence North 05 Degrees 10 Minutes 04 Seconds West 114.4 feet
thence North 17 Degrees 37 Minutes 39 Seconds East 113.8 feet
thence North 17 Degrees 06 Minutes 35 Seconds East 120.4 feet
thence North 02 Degrees 27 Minutes 06 Seconds East 128.1 feet
thence North 20 Degrees 28 Minutes 25 Seconds West 125.8 feet
thence North 39 Degrees 22 Minutes 59 Seconds West 152.1 feet
thence North 32 Degrees 56 Minutes 19 Seconds West 177.2 feet
thence North 31 Degrees 41 Minutes 29 Seconds West 165.2 feet
thence North 28 Degrees 24 Minutes 35 Seconds West 133.9 feet

thence North 24 Degrees 12 Minutes 11 Seconds West 118.4 feet
thence North 23 Degrees 19 Minutes 34 Seconds West 117.6 feet
thence North 37 Degrees 35 Minutes 45 Seconds West 125.7 feet
thence North 47 Degrees 03 Minutes 41 Seconds West 138.8 feet
thence North 40 Degrees 20 Minutes 50 Seconds West 141.4 feet
thence North 19 Degrees 41 Minutes 23 Seconds West 142.6 feet
thence North 22 Degrees 20 Minutes 02 Seconds West 125.3 feet
thence North 29 Degrees 08 Minutes 28 Seconds West 116.4 feet
thence North 29 Degrees 29 Minutes 39 Seconds West 107.1 feet
thence North 38 Degrees 07 Minutes 53 Seconds West 101.7 feet
thence North 40 Degrees 18 Minutes 57 Seconds West 111.3 feet
thence North 43 Degrees 14 Minutes 04 Seconds West 107.5 feet
thence North 34 Degrees 42 Minutes 34 Seconds West 99.4 feet
thence North 32 Degrees 48 Minutes 31 Seconds West 106.9 feet
thence North 31 Degrees 26 Minutes 37 Seconds West 113 feet
thence North 21 Degrees 46 Minutes 03 Seconds West 141 feet
thence North 29 Degrees 07 Minutes 18 Seconds West 155.3 feet
thence North 28 Degrees 41 Minutes 09 Seconds West 160.3 feet
thence North 18 Degrees 30 Minutes 38 Seconds West 158.8 feet
thence North 29 Degrees 39 Minutes 12 Seconds West 146.7 feet
thence North 37 Degrees 27 Minutes 37 Seconds West 133.7 feet
thence North 35 Degrees 16 Minutes 36 Seconds West 146.1 feet
thence North 29 Degrees 14 Minutes 38 Seconds West 172.4 feet
thence North 38 Degrees 23 Minutes 45 Seconds West 170.8 feet
thence North 40 Degrees 12 Minutes 14 Seconds West 158.2 feet
thence North 43 Degrees 02 Minutes 49 Seconds West 145.1 feet
thence North 38 Degrees 23 Minutes 04 Seconds West 143.7 feet
thence North 35 Degrees 01 Minutes 00 Seconds West 147.6 feet
thence North 38 Degrees 41 Minutes 32 Seconds West 144.3 feet
thence North 42 Degrees 44 Minutes 39 Seconds West 133.3 feet
thence North 40 Degrees 30 Minutes 15 Seconds West 126.7 feet
thence North 36 Degrees 54 Minutes 23 Seconds West 112.3 feet
thence North 26 Degrees 29 Minutes 04 Seconds West 100.5 feet
thence North 21 Degrees 22 Minutes 30 Seconds West 114.2 feet
thence North 08 Degrees 01 Minutes 47 Seconds West 127.5 feet
thence North 15 Degrees 07 Minutes 35 Seconds West 127.2 feet
thence North 08 Degrees 48 Minutes 00 Seconds West 136 feet
thence North 01 Degrees 43 Minutes 56 Seconds East 136.2 feet
thence North 01 Degrees 21 Minutes 54 Seconds East 74.2 feet
thence North 01 Degrees 21 Minutes 56 Seconds East 39.3 feet
thence North 01 Degrees 21 Minutes 49 Seconds East 8 feet
thence North 00 Degrees 01 Minutes 55 Seconds West 123 feet
thence North 01 Degrees 07 Minutes 51 Seconds East 128 feet
thence North 00 Degrees 37 Minutes 14 Seconds West 132.9 feet
thence North 04 Degrees 17 Minutes 15 Seconds West 138.1 feet
thence North 03 Degrees 28 Minutes 34 Seconds East 138.1 feet
thence North 08 Degrees 12 Minutes 24 Seconds East 134.7 feet
thence North 08 Degrees 46 Minutes 29 Seconds East 132.6 feet
thence North 02 Degrees 58 Minutes 32 Seconds East 124.9 feet

thence North 05 Degrees 27 Minutes 01 Seconds East 120.4 feet
 thence North 14 Degrees 44 Minutes 31 Seconds East 122.3 feet
 thence North 06 Degrees 42 Minutes 46 Seconds East 125.6 feet
 thence North 12 Degrees 34 Minutes 42 Seconds East 126.2 feet
 thence North 21 Degrees 55 Minutes 56 Seconds East 111.7 feet
 thence North 18 Degrees 51 Minutes 50 Seconds East 100.7 feet
 thence North 24 Degrees 18 Minutes 31 Seconds East 92 feet
 thence North 21 Degrees 48 Minutes 55 Seconds East 99.2 feet
 thence North 01 Degrees 59 Minutes 53 Seconds West 113.2 feet
 thence North 03 Degrees 21 Minutes 51 Seconds East 111.8 feet
 thence North 11 Degrees 28 Minutes 19 Seconds East 110.6 feet
 thence North 06 Degrees 18 Minutes 59 Seconds East 99.1 feet
 thence North 08 Degrees 38 Minutes 06 Seconds West 79.6 feet
 thence North 14 Degrees 50 Minutes 56 Seconds West 86.4 feet
 thence North 30 Degrees 35 Minutes 39 Seconds West 113.9 feet
 thence North 19 Degrees 59 Minutes 30 Seconds West 121.9 feet
 thence North 38 Degrees 40 Minutes 07 Seconds West 133.8 feet
 thence North 40 Degrees 29 Minutes 05 Seconds West 98.7 feet
 thence North 32 Degrees 41 Minutes 07 Seconds West 23.3 feet
 thence North 32 Degrees 57 Minutes 26 Seconds West 9.7 feet
 thence North 29 Degrees 56 Minutes 04 Seconds West 47.2 feet
 thence North 25 Degrees 01 Minutes 34 Seconds West 121 feet
 thence North 32 Degrees 05 Minutes 50 Seconds West 40.5 feet
 thence North 22 Degrees 51 Minutes 38 Seconds East 612.1 feet
 thence North 26 Degrees 53 Minutes 10 Seconds West 496.9 feet
 thence North 07 Degrees 46 Minutes 12 Seconds East 121 feet
 thence North 23 Degrees 10 Minutes 27 Seconds East 756.3 feet more or less to **the ending**

point at: 41 degrees 32 minutes 31.08 seconds North Latitude and -113 degrees 07 minutes 31.47 seconds West Longitude, which can be converted to mapping accuracy State Plane Utah North Zone NAD 83 feet coordinates of X = 1,195,484.3 feet and Y = 3,725,350.0 feet.