

**Amended Acknowledgment and
Amended Notice of Acknowledgment
of Acceptance of R.S. 2477
Right-of-Way Grant**

THE STATE OF UTAH

TO ALL WHOM THESE PRESENTS SHALL COME, Greeting:

Know ye, This is an Amended Acknowledgment and Amended Notice of Acknowledgment made under Utah Code Sections 72-5-309 through 310 inclusive, that the grant of the United States of America of “the right of way for the construction of highways over public lands, not reserved for public uses” under United States Revised Statutes 2477 (43 U.S.C. Section 932 (repealed October 21, 1976, with proviso recognizing the validity of rights-of-way already established)) was accepted for and on behalf of the State of Utah and its political subdivision Box Elder County as it pertains to the highway located in Box Elder County known as Board Ranch Road; County Road Number: 13; State Geographic Information Database (SGID) Road Identification Number: RD020038. Total road length is 16.44 miles more or less.

This Amended Acknowledgment and Amended Notice of Acknowledgment supersedes the information contained in the Acknowledgment recorded at Ent 238503, Bk 988, Beg Pg 597.

The reason for this Amended Acknowledgment and Amended Notice of Acknowledgment includes, but is not limited to, the fact that the road was constructed, mechanically, or by continuous use as a public highway for a period of at least ten years, over public lands not reserved for public uses, prior to the earlier of (a) the October 21, 1976 repeal of R.S. 2477 or (b) the date the servient estate was reserved for public uses.

This Amended Acknowledgment and Amended Notice of Acknowledgment applies only to the segments of the road that traverse land owned by the Bureau of Land Management, United States Department of the Interior, and does not apply to segments of the road that traverse land owned by any other person or entity. The State of Utah and its political subdivisions reserve the right to make further acknowledgments and notices of acknowledgment with regard to road segments that traverse land owned by other entities, including the United States of America, through one or more of its agencies.

A printed copy of a map showing the location of the road in said county is appended hereto as “Attachment 1,” a printed copy of representative photos of the road is appended hereto as “Attachment 2,” a printed copy of a description of the beginning and ending points of the entire road together with a list of Townships, Ranges and Sections that may be traversed by the road in said county is appended hereto as “Attachment 3,” and a printed copy of the Road Centerline Description Cover Page(s) is appended hereto as “Attachment 4.” The Appendices listed in “Attachment 4” that contain the actual road centerline descriptions are incorporated herein by reference.

A printed copy of this Amended Acknowledgment and Amended Notice of Acknowledgment, together with its Attachments and Appendices, may be viewed and/or obtained at the office of the Utah State Archives.

An electronic copy of this Amended Acknowledgment and Amended Notice of Acknowledgment, together with its Attachments and Appendices, may be viewed and/or downloaded as read-only PDF (Portable Document Format) files via the Internet at <http://recorded2477roads.utah.gov>.

The owner of the servient estate in the land underlying the road-segments subject to this Amended Acknowledgment and Amended Notice is believed to be the United States of America through one or more of its agencies. Any of such agencies or any other person with a servient ownership claim or a competing dominant estate right-of-way ownership claim, may file a petition in the State District Court for Salt Lake County for a decision regarding the correctness of this Amended Acknowledgment. A claimant shall file a petition within sixty (60) days after receipt of this Notice.

In Witness Whereof, I, John Harja, the official designee of the Governor of the State of Utah, in conformity to the laws of the State (Utah Code Sections 72-5-308 through 310 inclusive), have caused this Amended Acknowledgment and Amended Notice of Acknowledgment to be made.

Signed by my hand in Salt Lake City, Utah, the 15th day of November, 2007.

By the Governor's Designee



John Harja

CERTIFICATION

State of Utah)
 : ss
County of Salt Lake)

I hereby certify that the signer of the foregoing document, John Harja, is personally known by me, has made a voluntary signature and taken an oath stating that he is the official designee of the Governor of the State of Utah and is authorized to sign this document on the Governor's behalf pursuant to Utah Code Section 72-5-309. He further vouched that, based upon information and belief, the facts alleged therein are true.

Dated this 15th day of November, 2007.



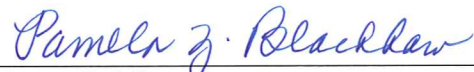

Notary Public

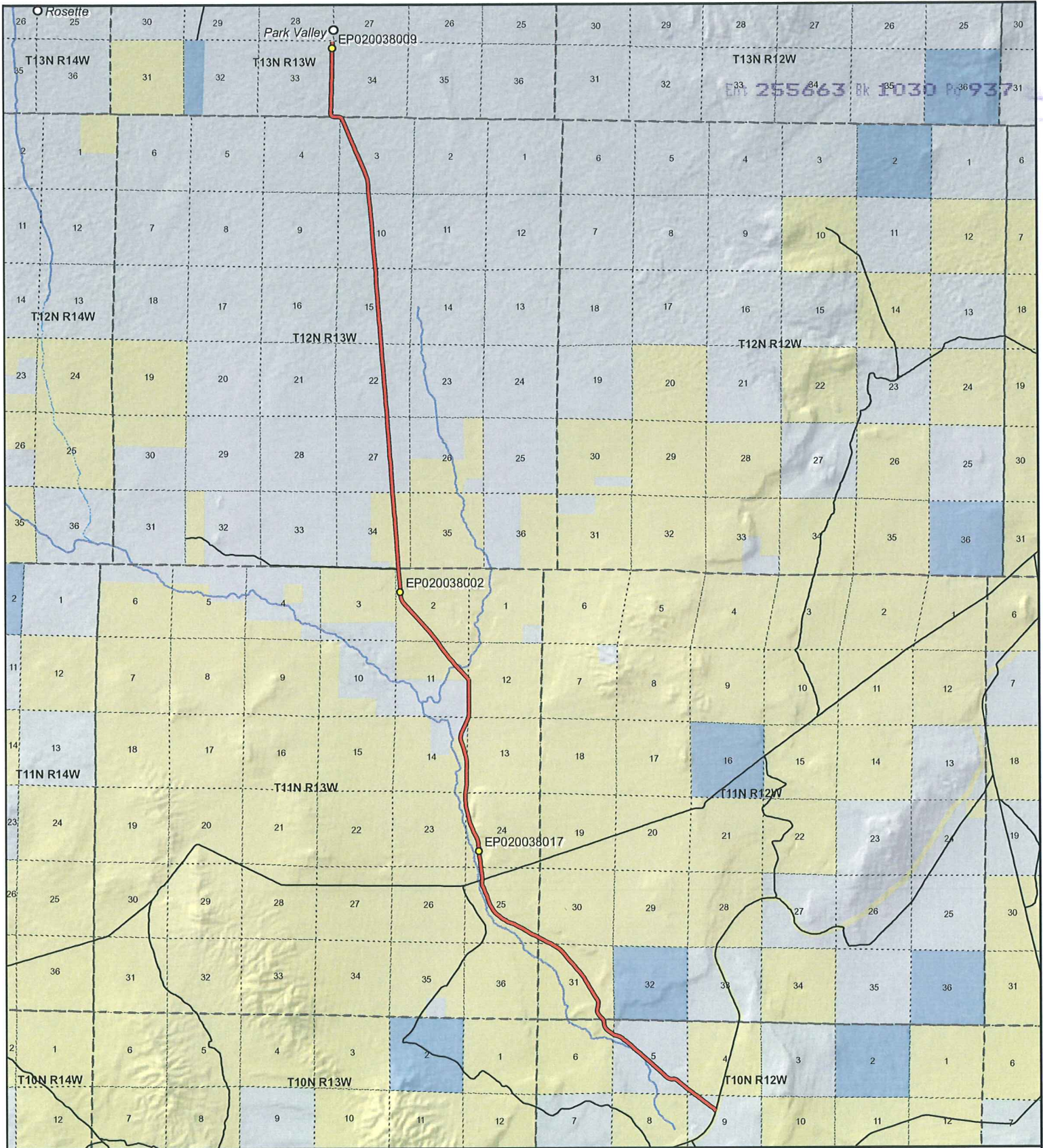

**Board Ranch Road - Box Elder County
SGID RD_ID RD020038**

Land Ownership Categories

- BLM
- Private
- SITLA, State Trust Land
- USFS, National Forest
- State Parks and Recreation
- Tribal, Indian Reservation
- NPS, National Park
- ◆ Wilderness
- ◆ UDWR Wildlife Reserve
- ◆ DOD, Military
- ◆ State Sovereign Land
- ◆ National Recreation Area
- ◆ USFWS, Natl. Wildlife Refuge

Transportation Network

- Board Ranch Road
- Title V: Issued Or Under Consideration By BLM Or County
- Other Roads
- Photo Event Point
- Section = 1 Mile



1:110,161

1 inch equals 1.7 miles



Map prepared by the State of Utah
Automated Geographic Reference Center
Room 5130 State Office Building
Salt Lake City, Utah 84114
Nov 10, 2006





EP020038002



EP020038009



EP020038017

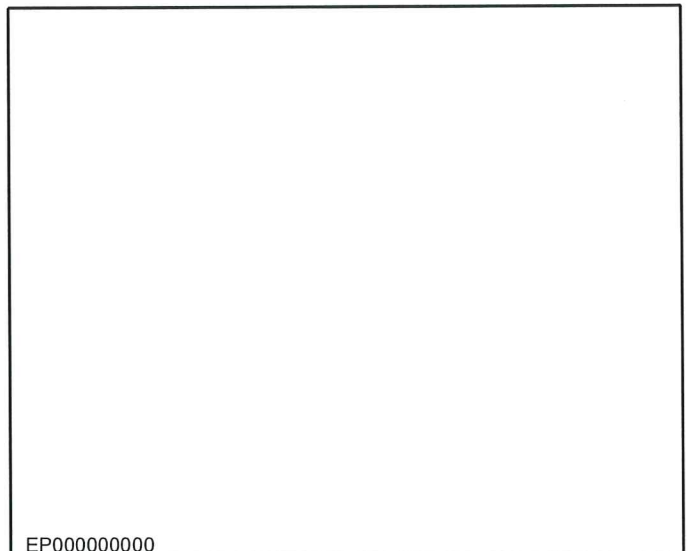

EP000000000

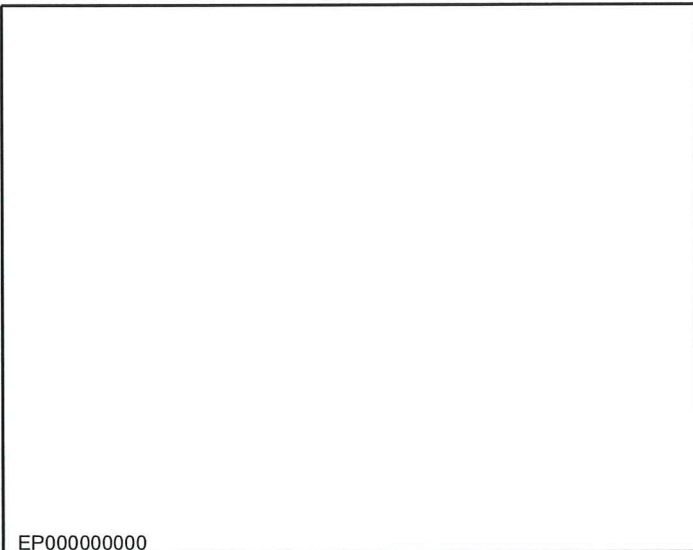

EP000000000

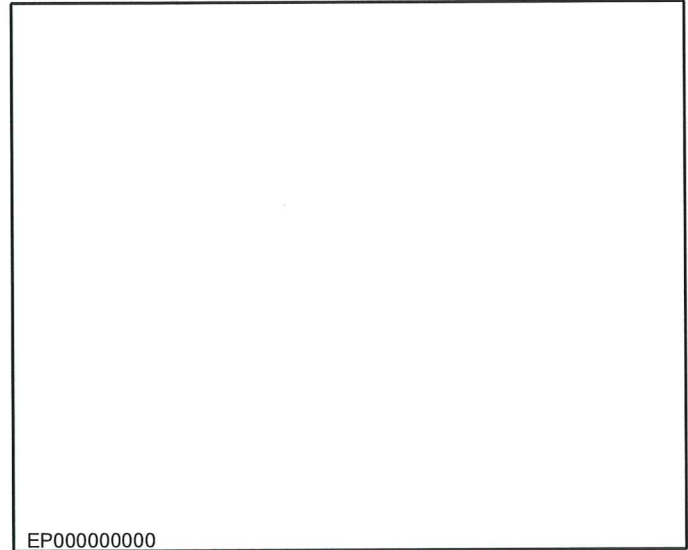

EP000000000

**Board Ranch Road - Box Elder County
SGID RD_ID RD020038**

Map prepared by the State of Utah
Automated Geographic Reference Center
Room 5130 State Office Building
Salt Lake City, Utah 84114
November 9, 2006



Attachment 3

Beginning & Ending Points and Township, Range, and Section References For:

Popular Name: Board Ranch Road

County: Box Elder

County Road Number: 13

State Geographic Information Database (SGID) Road Identification Number: RD020038.

Total Road Length: 16.44 miles more or less.

Beginning at a point on the road centerline located at 41 degrees 36 minutes 41.08 seconds North Latitude and -113 degrees 13 minutes 26.36 seconds West Longitude, which can be converted to mapping accuracy State Plane Utah North Zone NAD 83 feet coordinates of X = 1,169,004.8 feet and Y = 3,751,169.5 feet based on the US Survey Foot conversion.

Ending at a point on the road centerline located at 41 degrees 49 minutes 00.87 seconds North Latitude and -113 degrees 19 minutes 47.35 seconds West Longitude, which can be converted to mapping accuracy State Plane Utah North Zone NAD 83 feet coordinates of X = 1,141,646.6 feet and Y = 3,826,626.3 feet based on the US Survey Foot conversion.

This road may traverse:

Township 10 North Range 12 West, Section(s) 4,5,6,9, Salt Lake Base & Meridian

Township 11 North Range 12 West, Section(s) 30,31, Salt Lake Base & Meridian

Township 11 North Range 13 West, Section(s) 2,11,12,13,14,23,24,25, Salt Lake Base & Meridian

Township 12 North Range 13 West, Section(s) 3,4,10,15,22,27,34, Salt Lake Base & Meridian

Township 13 North Range 13 West, Section(s) 33,34, Salt Lake Base & Meridian

See Attachment 1 above for a cartographic depiction of the course of this road.

Attachment 4
Road Centerline Description Cover Page(s)

Popular Name: Board Ranch Road

County: Box Elder

County Road Number: 13

State Geographic Information Database (SGID) Road Identification Number: RD020038.

Total Road Length: 16.44 miles more or less.

Centerline Descriptions Of Road-Segments That Cross Over Federally Owned Land, Derived From Global Positioning System Data And Cross-checked against USGS Digital Orthophoto Quadrangles Compiled By The Utah Automated Geographic Reference Center And Entered Into The State Geographic Information Database (SGID).

Road-Segments Listed by SGID Road Identification Number (RD ID)	Road-Segment Numbers	Believed Ownership Of Servient Estate	Approximate Segment Length	See Attached Appendix
RD020038	001	BLM	0.04 Miles	A
RD020038	002	PVT	0.3 Miles	(not shown)
RD020038	003	BLM	0.13 Miles	B
RD020038	004	PVT	1.26 Miles	(not shown)
RD020038	005	BLM	4.84 Miles	C
RD020038	006	PVT	0.26 Miles	(not shown)
RD020038	007	BLM	3.38 Miles	D
RD020038	008	PVT	6.23 Miles	(not shown)
		Total Road Length	16.44	

* Indicates that a Title V permit will be requested, is in process, or has been issued.

† Indicates that road-segments crossing Forest Service land are under consideration by the state and county as of the date of this Amended Acknowledgment and Amended Notice of Acknowledgment.

Appendix A to Attachment 4

Popular Name: Board Ranch Road

County: Box Elder

County Road Number: 13

State Geographic Information Database (SGID) Road Identification Number: RD020038.

Road-Segment Number: 001

Road-Segment Length: 0.04 miles more or less.

Believed owner of the land underlying this road-segment is: Bureau of Land Management.

The following description is based upon the geographic coordinate system using the NAD83 Datum. The source is GPS mapping grade data as indicated in the metadata and/or the transportation data model of the State of Utah Geographic Information Database (SGID).

The road-segment itself is the monument that is identified by its physical presence on the land. The location of said physical presence is closely approximated by mapping grade Global Positioning System (GPS) data. Said data are checked against the corresponding gray-scale 1-meter Digital Orthophoto Quadrangles published by the United States Geological Survey (USGS) to verify a reasonable degree of accuracy. In circumstances where accurate satellite signal acquisition is not possible, such as deep, narrow canyons or under a canopy of dense foliage, or where very sharp curves in the road make accuracy questionable, such portions of the road were digitized from the corresponding gray-scale 1-meter Digital Orthophoto Quadrangles published by the United States Geological Survey (USGS).

This road-segment may traverse:

Township 10 North Range 12 West, Section(s) 9, Salt Lake Base & Meridian

The following description closely approximates the location of the centerline of the physical monument (Board Ranch Road)-- Segment 001 based on mapping grade Global Positioning System (GPS) data as defined above:

Beginning at a point on the road center line located at 41 degrees 36 minutes 41.08 seconds North Latitude and -113 degrees 13 minutes 26.36 seconds West Longitude, which can be converted to mapping accuracy State Plane Utah North Zone NAD 83 feet coordinates of X = 1,169,004.8 feet and Y = 3,751,169.5 feet; thence the following courses along the said road center line:

thence North 27 Degrees 22 Minutes 34 Seconds West 71.5 feet

thence North 48 Degrees 36 Minutes 29 Seconds West 126.2 feet

thence North 54 Degrees 55 Minutes 11 Seconds West 27.5 feet more or less to **the ending**

point at: 41 degrees 36 minutes 42.66 seconds North Latitude and -113 degrees 13 minutes 28.37 seconds West Longitude, which can be converted to mapping accuracy State Plane Utah North Zone NAD 83 feet coordinates of X = 1,168,854.8 feet and Y = 3,751,332.1 feet.

Appendix B to Attachment 4

Popular Name: Board Ranch Road

County: Box Elder

County Road Number: 13

State Geographic Information Database (SGID) Road Identification Number: RD020038.

Road-Segment Number: 003

Road-Segment Length: 0.13 miles more or less.

Believed owner of the land underlying this road-segment is: Bureau of Land Management.

The following description is based upon the geographic coordinate system using the NAD83 Datum. The source is GPS mapping grade data as indicated in the metadata and/or the transportation data model of the State of Utah Geographic Information Database (SGID).

The road-segment itself is the monument that is identified by its physical presence on the land. The location of said physical presence is closely approximated by mapping grade Global Positioning System (GPS) data. Said data are checked against the corresponding gray-scale 1-meter Digital Orthophoto Quadrangles published by the United States Geological Survey (USGS) to verify a reasonable degree of accuracy. In circumstances where accurate satellite signal acquisition is not possible, such as deep, narrow canyons or under a canopy of dense foliage, or where very sharp curves in the road make accuracy questionable, such portions of the road were digitized from the corresponding gray-scale 1-meter Digital Orthophoto Quadrangles published by the United States Geological Survey (USGS).

This road-segment may traverse:

Township 10 North Range 12 West, Section(s) 4,5, Salt Lake Base & Meridian

The following description closely approximates the location of the centerline of the physical monument (Board Ranch Road)-- Segment 003 based on mapping grade Global Positioning System (GPS) data as defined above:

Beginning at a point on the road center line located at 41 degrees 36 minutes 051.8 seconds North Latitude and -113 degrees 13 minutes 45.64 seconds West Longitude, which can be converted to mapping accuracy State Plane Utah North Zone NAD 83 feet coordinates of X = 1,167,561.5 feet and Y = 3,752,282.9 feet; thence the following courses along the said road center line:

thence North 53 Degrees 15 Minutes 45 Seconds West 65.4 feet

thence North 53 Degrees 06 Minutes 53 Seconds West 200.7 feet

thence North 56 Degrees 18 Minutes 19 Seconds West 196.4 feet

thence North 54 Degrees 31 Minutes 42 Seconds West 199 feet

thence North 51 Degrees 44 Minutes 21 Seconds West 37.6 feet

thence North 51 Degrees 44 Minutes 56 Seconds West 1.5 feet more or less to **the ending point**

at: 41 degrees 36 minutes 55.72 seconds North Latitude and -113 degrees 13 minutes 53.24 seconds West Longitude, which can be converted to mapping accuracy State Plane Utah North Zone NAD 83 feet coordinates of X = 1,166,992.4 feet and Y = 3,752,691.1 feet.

Appendix C to Attachment 4

Popular Name: Board Ranch Road

County: Box Elder

County Road Number: 13

State Geographic Information Database (SGID) Road Identification Number: RD020038.

Road-Segment Number: 005

Road-Segment Length: 4.84 miles more or less.

Believed owner of the land underlying this road-segment is: Bureau of Land Management.

The following description is based upon the geographic coordinate system using the NAD83 Datum. The source is GPS mapping grade data as indicated in the metadata and/or the transportation data model of the State of Utah Geographic Information Database (SGID).

The road-segment itself is the monument that is identified by its physical presence on the land. The location of said physical presence is closely approximated by mapping grade Global Positioning System (GPS) data. Said data are checked against the corresponding gray-scale 1-meter Digital Orthophoto Quadrangles published by the United States Geological Survey (USGS) to verify a reasonable degree of accuracy. In circumstances where accurate satellite signal acquisition is not possible, such as deep, narrow canyons or under a canopy of dense foliage, or where very sharp curves in the road make accuracy questionable, such portions of the road were digitized from the corresponding gray-scale 1-meter Digital Orthophoto Quadrangles published by the United States Geological Survey (USGS).

This road-segment may traverse:

Township 10 North Range 12 West, Section(s) 6, Salt Lake Base & Meridian

Township 11 North Range 12 West, Section(s) 30,31, Salt Lake Base & Meridian

Township 11 North Range 13 West, Section(s) 13,14,23,24,25, Salt Lake Base & Meridian

The following description closely approximates the location of the centerline of the physical monument (Board Ranch Road)-- Segment 005 based on mapping grade Global Positioning System (GPS) data as defined above:

Beginning at a point on the road center line located at 41 degrees 37 minutes 32.92 seconds North Latitude and -113 degrees 15 minutes 04.11 seconds West Longitude, which can be converted to mapping accuracy State Plane Utah North Zone NAD 83 feet coordinates of X = 1,161,686.4 feet and Y = 3,756,563.4 feet; thence the following courses along the said road center line:

thence North 59 Degrees 39 Minutes 17 Seconds West 61.7 feet
thence North 55 Degrees 05 Minutes 56 Seconds West 147.8 feet
thence North 51 Degrees 46 Minutes 57 Seconds West 144.7 feet
thence North 50 Degrees 11 Minutes 06 Seconds West 137.4 feet
thence North 48 Degrees 38 Minutes 35 Seconds West 120.8 feet
thence North 39 Degrees 44 Minutes 30 Seconds West 118.9 feet
thence North 18 Degrees 51 Minutes 55 Seconds West 133.2 feet
thence North 10 Degrees 15 Minutes 05 Seconds West 144.9 feet
thence North 08 Degrees 52 Minutes 19 Seconds West 132.7 feet
thence North 10 Degrees 18 Minutes 34 Seconds West 109.9 feet

thence North 24 Degrees 00 Minutes 59 Seconds West 56.2 feet
thence North 24 Degrees 01 Minutes 02 Seconds West 36.9 feet
thence North 45 Degrees 28 Minutes 50 Seconds West 95.3 feet
thence North 53 Degrees 45 Minutes 50 Seconds West 115.6 feet
thence North 40 Degrees 08 Minutes 48 Seconds West 140.9 feet
thence North 38 Degrees 40 Minutes 00 Seconds West 131.7 feet
thence North 32 Degrees 11 Minutes 34 Seconds West 90.8 feet
thence North 16 Degrees 41 Minutes 22 Seconds West 102.6 feet
thence North 02 Degrees 47 Minutes 35 Seconds East 138 feet
thence North 11 Degrees 30 Minutes 24 Seconds East 143.8 feet
thence North 11 Degrees 19 Minutes 33 Seconds East 144.4 feet
thence North 09 Degrees 03 Minutes 24 Seconds East 144.6 feet
thence North 06 Degrees 54 Minutes 36 Seconds West 163.5 feet
thence North 30 Degrees 50 Minutes 05 Seconds West 205.6 feet
thence North 34 Degrees 12 Minutes 21 Seconds West 239 feet
thence North 31 Degrees 52 Minutes 34 Seconds West 254 feet
thence North 30 Degrees 25 Minutes 24 Seconds West 255.9 feet
thence North 30 Degrees 43 Minutes 53 Seconds West 252.9 feet
thence North 30 Degrees 51 Minutes 58 Seconds West 257.1 feet
thence North 30 Degrees 40 Minutes 54 Seconds West 258.5 feet
thence North 31 Degrees 25 Minutes 44 Seconds West 260.5 feet
thence North 35 Degrees 04 Minutes 06 Seconds West 261.5 feet
thence North 39 Degrees 37 Minutes 14 Seconds West 260.6 feet
thence North 40 Degrees 44 Minutes 50 Seconds West 260.7 feet
thence North 41 Degrees 19 Minutes 45 Seconds West 258.6 feet
thence North 40 Degrees 01 Minutes 28 Seconds West 255.3 feet
thence North 40 Degrees 31 Minutes 47 Seconds West 251.7 feet
thence North 39 Degrees 10 Minutes 32 Seconds West 252.7 feet
thence North 37 Degrees 57 Minutes 51 Seconds West 254.7 feet
thence North 39 Degrees 06 Minutes 53 Seconds West 258.8 feet
thence North 46 Degrees 33 Minutes 53 Seconds West 260.8 feet
thence North 54 Degrees 35 Minutes 41 Seconds West 261.1 feet
thence North 60 Degrees 45 Minutes 56 Seconds West 262.5 feet
thence North 61 Degrees 52 Minutes 49 Seconds West 261.6 feet
thence North 61 Degrees 48 Minutes 42 Seconds West 261 feet
thence North 62 Degrees 04 Minutes 14 Seconds West 256.3 feet
thence North 63 Degrees 24 Minutes 20 Seconds West 249.1 feet
thence North 63 Degrees 17 Minutes 22 Seconds West 216.1 feet
thence North 63 Degrees 17 Minutes 23 Seconds West 25.5 feet
thence North 63 Degrees 27 Minutes 10 Seconds West 233.6 feet
thence North 64 Degrees 20 Minutes 58 Seconds West 220.1 feet
thence North 63 Degrees 02 Minutes 50 Seconds West 207.5 feet
thence North 55 Degrees 56 Minutes 00 Seconds West 203.2 feet
thence North 56 Degrees 53 Minutes 13 Seconds West 199.4 feet
thence North 62 Degrees 47 Minutes 34 Seconds West 188 feet
thence North 64 Degrees 09 Minutes 13 Seconds West 178.4 feet
thence North 62 Degrees 30 Minutes 25 Seconds West 172.1 feet
thence North 61 Degrees 03 Minutes 54 Seconds West 164.4 feet
thence North 61 Degrees 38 Minutes 00 Seconds West 153 feet

thence North 64 Degrees 52 Minutes 23 Seconds West 153.3 feet
thence North 72 Degrees 01 Minutes 02 Seconds West 161.7 feet
thence North 69 Degrees 15 Minutes 52 Seconds West 168.8 feet
thence North 61 Degrees 20 Minutes 21 Seconds West 175.9 feet
thence North 61 Degrees 23 Minutes 20 Seconds West 179.6 feet
thence North 54 Degrees 27 Minutes 35 Seconds West 190.3 feet
thence North 50 Degrees 05 Minutes 38 Seconds West 190.4 feet
thence North 50 Degrees 04 Minutes 54 Seconds West 185.3 feet
thence North 49 Degrees 15 Minutes 17 Seconds West 197.2 feet
thence North 45 Degrees 20 Minutes 31 Seconds West 204.1 feet
thence North 28 Degrees 24 Minutes 52 Seconds West 223.1 feet
thence North 28 Degrees 55 Minutes 11 Seconds West 229.7 feet
thence North 24 Degrees 09 Minutes 08 Seconds West 225.9 feet
thence North 20 Degrees 26 Minutes 14 Seconds West 214.8 feet
thence North 20 Degrees 45 Minutes 21 Seconds West 201.3 feet
thence North 20 Degrees 30 Minutes 32 Seconds West 192.2 feet
thence North 21 Degrees 45 Minutes 58 Seconds West 185 feet
thence North 23 Degrees 37 Minutes 28 Seconds West 176.8 feet
thence North 24 Degrees 02 Minutes 51 Seconds West 155.9 feet
thence North 23 Degrees 01 Minutes 28 Seconds West 138.7 feet
thence North 15 Degrees 42 Minutes 02 Seconds West 127.6 feet
thence North 02 Degrees 47 Minutes 38 Seconds East 119.9 feet
thence North 07 Degrees 33 Minutes 17 Seconds East 102.7 feet
thence North 02 Degrees 25 Minutes 17 Seconds East 47.6 feet
thence North 01 Degrees 27 Minutes 59 Seconds East 31.2 feet
thence North 03 Degrees 34 Minutes 15 Seconds West 128.1 feet
thence North 09 Degrees 07 Minutes 39 Seconds West 182.6 feet
thence North 09 Degrees 05 Minutes 18 Seconds West 194.2 feet
thence North 07 Degrees 26 Minutes 39 Seconds West 201.7 feet
thence North 06 Degrees 58 Minutes 52 Seconds West 143.6 feet
thence North 06 Degrees 58 Minutes 52 Seconds West 57.8 feet
thence North 05 Degrees 00 Minutes 54 Seconds West 189.3 feet
thence North 01 Degrees 42 Minutes 31 Seconds West 178.8 feet
thence North 07 Degrees 41 Minutes 28 Seconds West 177 feet
thence North 14 Degrees 03 Minutes 23 Seconds West 184 feet
thence North 02 Degrees 03 Minutes 28 Seconds West 197.3 feet
thence North 00 Degrees 20 Minutes 32 Seconds West 198.1 feet
thence North 12 Degrees 25 Minutes 48 Seconds West 189.6 feet
thence North 07 Degrees 28 Minutes 02 Seconds West 185.1 feet
thence North 00 Degrees 26 Minutes 52 Seconds East 190.3 feet
thence North 15 Degrees 07 Minutes 26 Seconds West 201.9 feet
thence North 24 Degrees 11 Minutes 19 Seconds West 213.4 feet
thence North 28 Degrees 01 Minutes 24 Seconds West 226 feet
thence North 25 Degrees 47 Minutes 25 Seconds West 210.7 feet
thence North 20 Degrees 33 Minutes 26 Seconds West 187 feet
thence North 21 Degrees 40 Minutes 02 Seconds West 183.1 feet
thence North 24 Degrees 00 Minutes 16 Seconds West 197 feet
thence North 18 Degrees 12 Minutes 40 Seconds West 230.9 feet
thence North 16 Degrees 30 Minutes 14 Seconds West 251 feet

thence North 15 Degrees 10 Minutes 16 Seconds West 235.9 feet
 thence North 15 Degrees 29 Minutes 01 Seconds West 202.2 feet
 thence North 14 Degrees 32 Minutes 01 Seconds West 147.2 feet
 thence North 12 Degrees 53 Minutes 56 Seconds West 73.9 feet
 thence North 11 Degrees 39 Minutes 09 Seconds West 35.1 feet
 thence North 11 Degrees 20 Minutes 14 Seconds West 58.5 feet
 thence North 08 Degrees 02 Minutes 51 Seconds West 40.7 feet
 thence North 08 Degrees 02 Minutes 51 Seconds West 71.9 feet
 thence North 06 Degrees 40 Minutes 58 Seconds West 178.2 feet
 thence North 02 Degrees 34 Minutes 59 Seconds West 209.8 feet
 thence North 01 Degrees 41 Minutes 54 Seconds West 221.8 feet
 thence North 01 Degrees 45 Minutes 16 Seconds East 233.1 feet
 thence North 01 Degrees 21 Minutes 48 Seconds East 85.4 feet
 thence North 01 Degrees 21 Minutes 47 Seconds East 146 feet
 thence North 07 Degrees 49 Minutes 26 Seconds East 217.1 feet
 thence North 08 Degrees 17 Minutes 04 Seconds East 192.5 feet
 thence North 03 Degrees 59 Minutes 56 Seconds East 177.7 feet
 thence North 00 Degrees 31 Minutes 51 Seconds East 150.6 feet
 thence North 03 Degrees 35 Minutes 21 Seconds West 73.2 feet
 thence North 03 Degrees 35 Minutes 21 Seconds West 83.2 feet
 thence North 04 Degrees 05 Minutes 09 Seconds West 175.9 feet
 thence North 01 Degrees 10 Minutes 40 Seconds East 185.4 feet
 thence North 02 Degrees 34 Minutes 04 Seconds East 193.8 feet
 thence North 03 Degrees 33 Minutes 58 Seconds East 197.3 feet
 thence North 02 Degrees 38 Minutes 37 Seconds East 188.9 feet
 thence North 03 Degrees 30 Minutes 03 Seconds West 190.6 feet
 thence North 06 Degrees 06 Minutes 07 Seconds West 192.9 feet
 thence North 07 Degrees 57 Minutes 22 Seconds West 200.6 feet
 thence North 12 Degrees 13 Minutes 36 Seconds West 199.1 feet
 thence North 16 Degrees 37 Minutes 21 Seconds West 193.1 feet
 thence North 19 Degrees 27 Minutes 01 Seconds West 194.4 feet
 thence North 18 Degrees 54 Minutes 40 Seconds West 178.2 feet
 thence North 18 Degrees 53 Minutes 38 Seconds West 153.6 feet
 thence North 17 Degrees 40 Minutes 54 Seconds West 146.4 feet
 thence North 18 Degrees 34 Minutes 56 Seconds West 152 feet
 thence North 12 Degrees 26 Minutes 45 Seconds West 162.7 feet
 thence North 07 Degrees 17 Minutes 12 Seconds East 106.4 feet more or less to **the ending**

point at: 41 degrees 40 minutes 58.17 seconds North Latitude and -113 degrees 17 minutes 32.66 seconds West Longitude, which can be converted to mapping accuracy State Plane Utah North Zone NAD 83 feet coordinates of X = 1,150,835.5 feet and Y = 3,777,564.8 feet.

Appendix D to Attachment 4

Popular Name: Board Ranch Road

County: Box Elder

County Road Number: 13

State Geographic Information Database (SGID) Road Identification Number: RD020038.

Road-Segment Number: 007

Road-Segment Length: 3.38 miles more or less.

Believed owner of the land underlying this road-segment is: Bureau of Land Management.

The following description is based upon the geographic coordinate system using the NAD83 Datum. The source is GPS mapping grade data as indicated in the metadata and/or the transportation data model of the State of Utah Geographic Information Database (SGID).

The road-segment itself is the monument that is identified by its physical presence on the land. The location of said physical presence is closely approximated by mapping grade Global Positioning System (GPS) data. Said data are checked against the corresponding gray-scale 1-meter Digital Orthophoto Quadrangles published by the United States Geological Survey (USGS) to verify a reasonable degree of accuracy. In circumstances where accurate satellite signal acquisition is not possible, such as deep, narrow canyons or under a canopy of dense foliage, or where very sharp curves in the road make accuracy questionable, such portions of the road were digitized from the corresponding gray-scale 1-meter Digital Orthophoto Quadrangles published by the United States Geological Survey (USGS).

This road-segment may traverse:

Township 11 North Range 13 West, Section(s) 2,11,12,13, Salt Lake Base & Meridian

Township 12 North Range 13 West, Section(s) 34, Salt Lake Base & Meridian

The following description closely approximates the location of the centerline of the physical monument (Board Ranch Road)-- Segment 007 based on mapping grade Global Positioning System (GPS) data as defined above:

Beginning at a point on the road center line located at 41 degrees 41 minutes 10.63 seconds North Latitude and -113 degrees 17 minutes 26.29 seconds West Longitude, which can be converted to mapping accuracy State Plane Utah North Zone NAD 83 feet coordinates of X = 1,151,345.2 feet and Y = 3,778,815.7 feet; thence the following courses along the said road center line:

thence North 19 Degrees 52 Minutes 17 Seconds East	40.3 feet
thence North 19 Degrees 52 Minutes 15 Seconds East	78.2 feet
thence North 19 Degrees 52 Minutes 16 Seconds East	59.7 feet
thence North 03 Degrees 53 Minutes 35 Seconds East	310.9 feet
thence North 00 Degrees 55 Minutes 05 Seconds East	357.7 feet
thence North 00 Degrees 13 Minutes 09 Seconds East	367.4 feet
thence North 00 Degrees 07 Minutes 31 Seconds East	360.9 feet
thence North 00 Degrees 21 Minutes 45 Seconds East	346.1 feet
thence North 00 Degrees 02 Minutes 36 Seconds West	313.3 feet
thence North 00 Degrees 06 Minutes 11 Seconds East	252.6 feet
thence North 00 Degrees 34 Minutes 55 Seconds West	157.5 feet

thence North 05 Degrees 33 Minutes 21 Seconds West 93.9 feet
thence North 26 Degrees 37 Minutes 16 Seconds West 58.5 feet
thence North 26 Degrees 41 Minutes 23 Seconds West 38.4 feet
thence North 41 Degrees 00 Minutes 10 Seconds West 7.1 feet
thence North 41 Degrees 00 Minutes 00 Seconds West 176.7 feet
thence North 43 Degrees 50 Minutes 38 Seconds West 221.6 feet
thence North 45 Degrees 40 Minutes 28 Seconds West 200.7 feet
thence North 42 Degrees 39 Minutes 50 Seconds West 188.6 feet
thence North 43 Degrees 00 Minutes 06 Seconds West 187.4 feet
thence North 44 Degrees 00 Minutes 05 Seconds West 188.2 feet
thence North 42 Degrees 43 Minutes 42 Seconds West 193.2 feet
thence North 39 Degrees 37 Minutes 01 Seconds West 167.4 feet
thence North 37 Degrees 01 Minutes 11 Seconds West 155.4 feet
thence North 38 Degrees 20 Minutes 10 Seconds West 154 feet
thence North 45 Degrees 03 Minutes 45 Seconds West 189.3 feet
thence North 40 Degrees 08 Minutes 26 Seconds West 283.9 feet
thence North 36 Degrees 01 Minutes 36 Seconds West 345.3 feet
thence North 36 Degrees 25 Minutes 21 Seconds West 347.1 feet
thence North 36 Degrees 39 Minutes 31 Seconds West 345.7 feet
thence North 36 Degrees 42 Minutes 07 Seconds West 111 feet
thence North 36 Degrees 42 Minutes 07 Seconds West 227.1 feet
thence North 38 Degrees 23 Minutes 33 Seconds West 331.6 feet
thence North 39 Degrees 26 Minutes 05 Seconds West 340.3 feet
thence North 41 Degrees 57 Minutes 01 Seconds West 348.8 feet
thence North 42 Degrees 28 Minutes 25 Seconds West 342.8 feet
thence North 42 Degrees 36 Minutes 08 Seconds West 334.7 feet
thence North 42 Degrees 37 Minutes 44 Seconds West 328.1 feet
thence North 42 Degrees 38 Minutes 14 Seconds West 319.3 feet
thence North 43 Degrees 12 Minutes 12 Seconds West 304.3 feet
thence North 43 Degrees 05 Minutes 04 Seconds West 306 feet
thence North 42 Degrees 45 Minutes 31 Seconds West 277.7 feet
thence North 41 Degrees 55 Minutes 32 Seconds West 241.2 feet
thence North 30 Degrees 49 Minutes 32 Seconds West 234.1 feet
thence North 11 Degrees 34 Minutes 56 Seconds West 257.5 feet
thence North 04 Degrees 54 Minutes 24 Seconds West 334 feet
thence North 04 Degrees 48 Minutes 24 Seconds West 404.7 feet
thence North 04 Degrees 26 Minutes 45 Seconds West 412.8 feet
thence North 04 Degrees 36 Minutes 58 Seconds West 409.6 feet
thence North 04 Degrees 18 Minutes 52 Seconds West 360.1 feet
thence North 05 Degrees 14 Minutes 35 Seconds West 11.5 feet
thence North 03 Degrees 55 Minutes 13 Seconds West 26.3 feet
thence North 04 Degrees 27 Minutes 07 Seconds West 10.5 feet
thence North 04 Degrees 27 Minutes 02 Seconds West 374.3 feet
thence North 04 Degrees 36 Minutes 38 Seconds West 370.4 feet
thence North 04 Degrees 20 Minutes 39 Seconds West 376.2 feet
thence North 04 Degrees 24 Minutes 34 Seconds West 398 feet
thence North 04 Degrees 19 Minutes 54 Seconds West 396.3 feet
thence North 04 Degrees 34 Minutes 06 Seconds West 396.4 feet
thence North 04 Degrees 48 Minutes 04 Seconds West 396.8 feet

thence North 04 Degrees 19 Minutes 07 Seconds West 397.6 feet

thence North 04 Degrees 25 Minutes 12 Seconds West 406.2 feet

thence North 04 Degrees 36 Minutes 59 Seconds West 409.6 feet

thence North 04 Degrees 26 Minutes 12 Seconds West 404.5 feet

thence North 04 Degrees 25 Minutes 10 Seconds West 383.2 feet

thence North 04 Degrees 37 Minutes 13 Seconds West 352 feet

thence North 04 Degrees 34 Minutes 51 Seconds West 310.9 feet

thence North 04 Degrees 31 Minutes 58 Seconds West 6.9 feet more or less to **the ending point**

at: 41 degrees 43 minutes 47.59 seconds North Latitude and -113 degrees 18 minutes 41.81 seconds West Longitude, which can be converted to mapping accuracy State Plane Utah North Zone NAD 83 feet coordinates of X = 1,145,947.3 feet and Y = 3,794,818.0 feet.