

**Amended Acknowledgment and
Amended Notice of Acknowledgment
of Acceptance of R.S. 2477
Right-of-Way Grant**

THE STATE OF UTAH

TO ALL WHOM THESE PRESENTS SHALL COME, Greeting:

Know ye, This is an Amended Acknowledgment and Amended Notice of Acknowledgment made under Utah Code Sections 72-5-309 through 310 inclusive, that the grant of the United States of America of “the right of way for the construction of highways over public lands, not reserved for public uses” under United States Revised Statutes 2477 (43 U.S.C. Section 932 (repealed October 21, 1976, with proviso recognizing the validity of rights-of-way already established)) was accepted for and on behalf of the State of Utah and its political subdivision Box Elder County as it pertains to the highway located in Box Elder County known as Little Pigeon Road; County Road Number: 65; State Geographic Information Database (SGID) Road Identification Number: RD020124. Total road length is 14.7 miles more or less.

This Amended Acknowledgment and Amended Notice of Acknowledgment supersedes the information contained in the Acknowledgment recorded at Ent 238527, Bk 988, Beg Pg 741.

The reason for this Amended Acknowledgment and Amended Notice of Acknowledgment includes, but is not limited to, the fact that the road was constructed, mechanically, or by continuous use as a public highway for a period of at least ten years, over public lands not reserved for public uses, prior to the earlier of (a) the October 21, 1976 repeal of R.S. 2477 or (b) the date the servient estate was reserved for public uses.

This Amended Acknowledgment and Amended Notice of Acknowledgment applies only to the segments of the road that traverse land owned by the Bureau of Land Management, United States Department of the Interior, and does not apply to segments of the road that traverse land owned by any other person or entity. The State of Utah and its political subdivisions reserve the right to make further acknowledgments and notices of acknowledgment with regard to road segments that traverse land owned by other entities, including the United States of America, through one or more of its agencies.

A printed copy of a map showing the location of the road in said county is appended hereto as “Attachment 1,” a printed copy of representative photos of the road is appended hereto as “Attachment 2,” a printed copy of a description of the beginning and ending points of the entire road together with a list of Townships, Ranges and Sections that may be traversed by the road in said county is appended hereto as “Attachment 3,” and a printed copy of the Road Centerline Description Cover Page(s) is appended hereto as “Attachment 4.” The Appendices listed in “Attachment 4” that contain the actual road centerline descriptions are incorporated herein by reference.

A printed copy of this Amended Acknowledgment and Amended Notice of Acknowledgment, together with its Attachments and Appendices, may be viewed and/or obtained at the office of the Utah State Archives.

An electronic copy of this Amended Acknowledgment and Amended Notice of Acknowledgment, together with its Attachments and Appendices, may be viewed and/or downloaded as read-only PDF (Portable Document Format) files via the Internet at <http://recorded2477roads.utah.gov>.

The owner of the servient estate in the land underlying the road-segments subject to this Amended Acknowledgment and Amended Notice is believed to be the United States of America through one or more of its agencies. Any of such agencies or any other person with a servient ownership claim or a competing dominant estate right-of-way ownership claim, may file a petition in the State District Court for Salt Lake County for a decision regarding the correctness of this Amended Acknowledgment. A claimant shall file a petition within sixty (60) days after receipt of this Notice.

In Witness Whereof, I, John Harja, the official designee of the Governor of the State of Utah, in conformity to the laws of the State (Utah Code Sections 72-5-308 through 310 inclusive), have caused this Amended Acknowledgment and Amend Notice of Acknowledgment to be made.

Signed by my hand in Salt Lake City, Utah, the 15th day of November, 2007.

By the Governor's Designee

John Harja

CERTIFICATION

State of Utah)
 : ss
County of Salt Lake)

I hereby certify that the signer of the foregoing document, John Harja, is personally known by me, has made a voluntary signature and taken an oath stating that he is the official designee of the Governor of the State of Utah and is authorized to sign this document on the Governor's behalf pursuant to Utah Code Section 72-5-309. He further vouched that, based upon information and belief, the facts alleged therein are true.

Dated this 15th day of November, 2007.



Notary Public

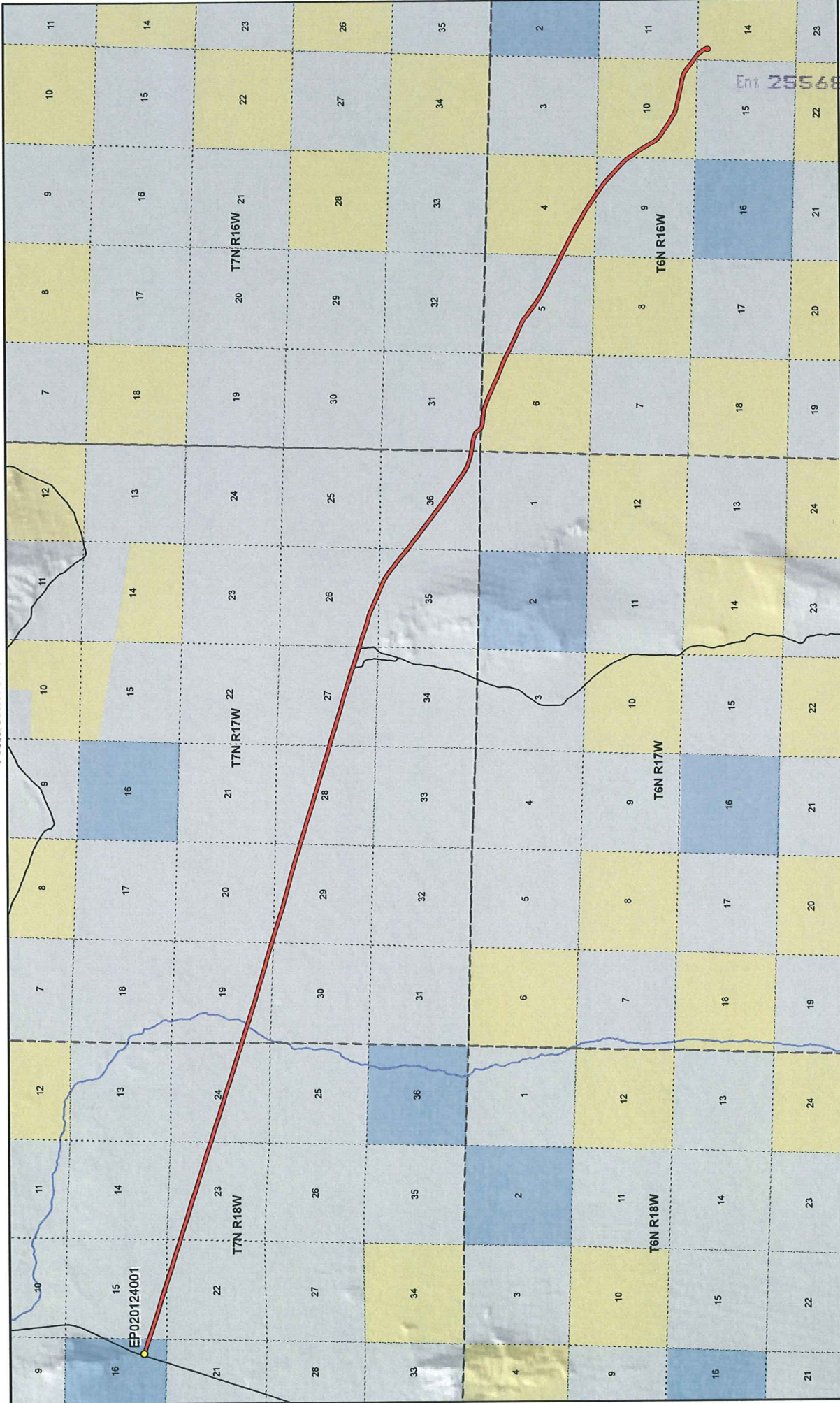

Map prepared by the State of Utah
 Automated Geographic Reference Center
 Room 5130 State Office Building
 Salt Lake City, Utah 84144
 Nov 10, 2006

Little Pigeon Road - Box Elder County SGID RD_ID RD020124

Transportation Network

- Little Pigeon Road
- Other Roads
- Title V: Issued Or Under Consideration By BLM
- County
- Photo Event Point
- Section = 1 Mile

Land Ownership Categories

- BLM
- Private
- SITLA, State Trust Land
- USFS, National Forest
- State Parks and Recreation
- Tribal, Indian Reservation
- NPS, National Park
- Wilderness
- UDWR Wildlife Reserve
- DOD, Military
- State Sovereign Land
- National Recreation Area
- USFWS, Natl. Wildlife Refuge

1:85,428
 1 inch equals 1.3 miles

Attachment 2

Ent 255488 Bk 1030 Pg 1089



EP020124001

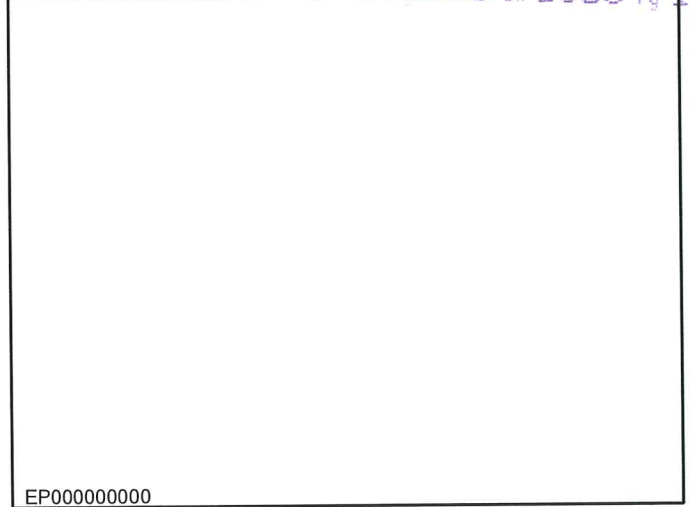

EP000000000

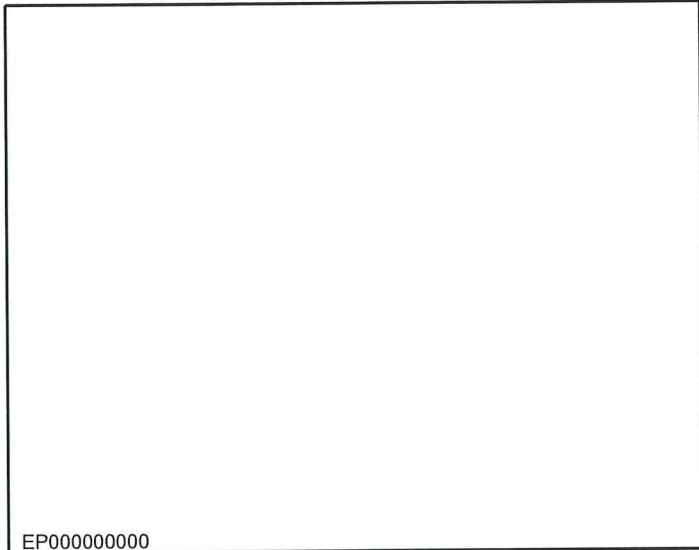

EP000000000

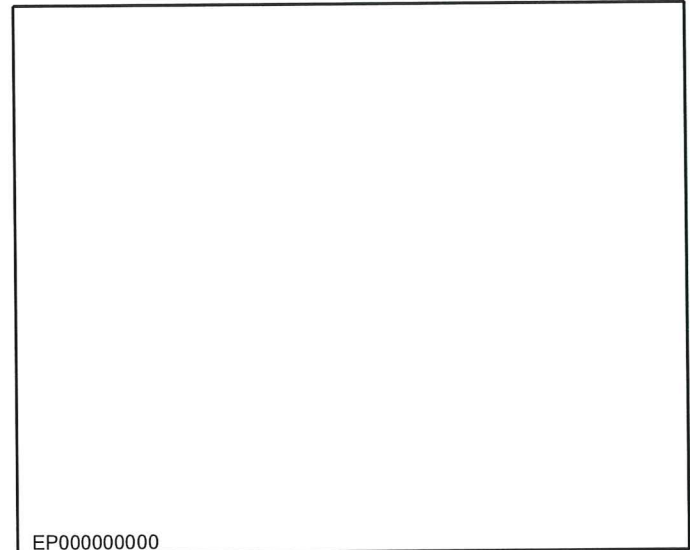

EP000000000

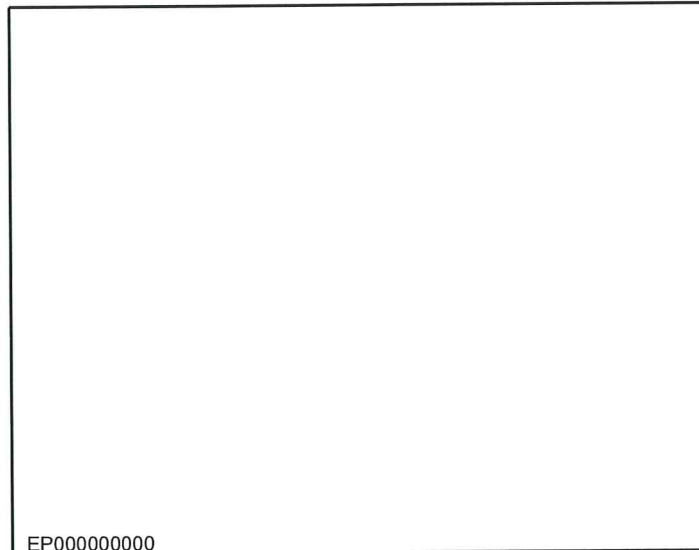

EP000000000

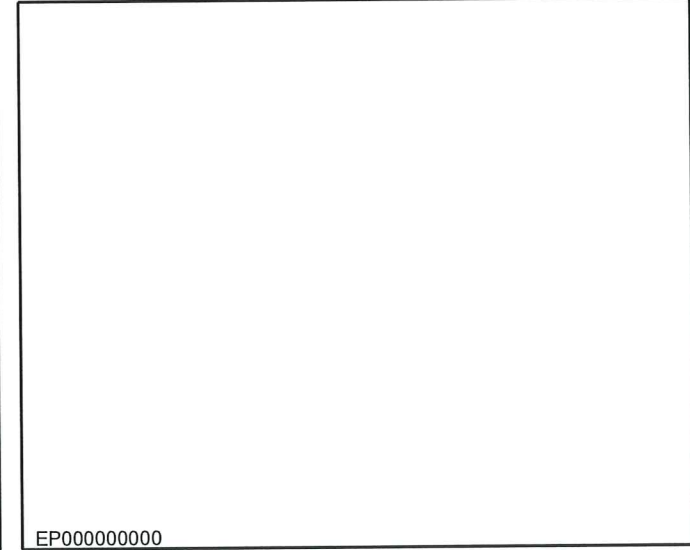

EP000000000

Little Pigeon Road - Box Elder County
SGID RD_ID RD020124

Map prepared by the State of Utah
Automated Geographic Reference Center
Room 5130 State Office Building
Salt Lake City, Utah 84114
November 9, 2006



Attachment 3

Beginning & Ending Points and Township, Range, and Section References For:

Popular Name: Little Pigeon Road

County: Box Elder

County Road Number: 65

State Geographic Information Database (SGID) Road Identification Number: RD020124.

Total Road Length: 14.7 miles more or less.

Beginning at a point on the road centerline located at 41 degrees 19 minutes 21.33 seconds North Latitude and -113 degrees 54 minutes 030.1 seconds West Longitude, which can be converted to mapping accuracy State Plane Utah North Zone NAD 83 feet coordinates of X = 978,992.6 feet and Y = 3,650,422.7 feet based on the US Survey Foot conversion.

Ending at a point on the road centerline located at 41 degrees 14 minutes 39.76 seconds North Latitude and -113 degrees 39 minutes 08.18 seconds West Longitude, which can be converted to mapping accuracy State Plane Utah North Zone NAD 83 feet coordinates of X = 1,048,603.5 feet and Y = 3,620,089.1 feet based on the US Survey Foot conversion.

This road may traverse:

Township 6 North Range 16 West, Section(s) 4,5,6,9,10,11,14, Salt Lake Base & Meridian

Township 7 North Range 16 West, Section(s) 31, Salt Lake Base & Meridian

Township 7 North Range 17 West, Section(s) 19,20,26,27,28,29,35,36, Salt Lake Base & Meridian

Township 7 North Range 18 West, Section(s) 15,16,22,23,24, Salt Lake Base & Meridian

See Attachment 1 above for a cartographic depiction of the course of this road.

**Attachment 4
Road Centerline Description Cover Page(s)**

Popular Name: Little Pigeon Road

County: Box Elder

County Road Number: 65

State Geographic Information Database (SGID) Road Identification Number: RD020124.

Total Road Length: 14.7 miles more or less.

Centerline Descriptions Of Road-Segments That Cross Over Federally Owned Land, Derived From Global Positioning System Data And Cross-checked against USGS Digital Orthophoto Quadrangles Compiled By The Utah Automated Geographic Reference Center And Entered Into The State Geographic Information Database (SGID).

Road-Segments Listed by SGID Road Identification Number (RD_ID)	Road-Segment Numbers	Believed Ownership Of Servient Estate	Approximate Segment Length	See Attached Appendix
RD020124	001	ST	0.18 Miles	(not shown)
RD020124	002	PVT	9.88 Miles	(not shown)
RD020124	003	BLM	0.81 Miles	A
RD020124	004	PVT	1.14 Miles	(not shown)
RD020124	005	BLM	0.69 Miles	B
RD020124	006	PVT	0.52 Miles	(not shown)
RD020124	007	BLM	1.24 Miles	C
RD020124	008	PVT	0.06 Miles	(not shown)
RD020124	009	BLM	0.18 Miles	D
		Total Road Length	14.7	_____

* Indicates that a Title V permit will be requested, is in process, or has been issued.

† Indicates that road-segments crossing Forest Service land are under consideration by the state and county as of the date of this Amended Acknowledgment and Amended Notice of Acknowledgment.

Appendix A to Attachment 4

Popular Name: Little Pigeon Road

County: Box Elder

County Road Number: 65

State Geographic Information Database (SGID) Road Identification Number: RD020124.

Road-Segment Number: 003

Road-Segment Length: 0.81 miles more or less.

Believed owner of the land underlying this road-segment is: Bureau of Land Management.

The following description is based upon the geographic coordinate system using the NAD83 Datum. The source is GPS mapping grade data as indicated in the metadata and/or the transportation data model of the State of Utah Geographic Information Database (SGID).

The road-segment itself is the monument that is identified by its physical presence on the land. The location of said physical presence is closely approximated by mapping grade Global Positioning System (GPS) data. Said data are checked against the corresponding gray-scale 1-meter Digital Orthophoto Quadrangles published by the United States Geological Survey (USGS) to verify a reasonable degree of accuracy. In circumstances where accurate satellite signal acquisition is not possible, such as deep, narrow canyons or under a canopy of dense foliage, or where very sharp curves in the road make accuracy questionable, such portions of the road were digitized from the corresponding gray-scale 1-meter Digital Orthophoto Quadrangles published by the United States Geological Survey (USGS).

This road-segment may traverse:

Township 6 North Range 16 West, Section(s) 6, Salt Lake Base & Meridian

The following description closely approximates the location of the centerline of the physical monument (Little Pigeon Road)-- Segment 003 based on mapping grade Global Positioning System (GPS) data as defined above:

Beginning at a point on the road center line located at 41 degrees 16 minutes 34.59 seconds North Latitude and -113 degrees 43 minutes 36.51 seconds West Longitude, which can be converted to mapping accuracy State Plane Utah North Zone NAD 83 feet coordinates of X = 1,028,409.8 feet and Y = 3,632,223.0 feet; thence the following courses along the said road center line:

thence South 52 Degrees 19 Minutes 57 Seconds East	13.3 feet
thence South 52 Degrees 15 Minutes 18 Seconds East	72.9 feet
thence South 81 Degrees 27 Minutes 02 Seconds East	191.2 feet
thence South 83 Degrees 09 Minutes 25 Seconds East	236.4 feet
thence South 82 Degrees 58 Minutes 44 Seconds East	256.3 feet
thence South 82 Degrees 02 Minutes 31 Seconds East	250.2 feet
thence South 73 Degrees 36 Minutes 34 Seconds East	239.4 feet
thence South 67 Degrees 56 Minutes 49 Seconds East	245.5 feet
thence South 66 Degrees 13 Minutes 16 Seconds East	232.9 feet
thence South 65 Degrees 57 Minutes 45 Seconds East	206.7 feet
thence South 66 Degrees 03 Minutes 38 Seconds East	179.5 feet
thence South 64 Degrees 52 Minutes 04 Seconds East	160.2 feet

thence South 65 Degrees 41 Minutes 04 Seconds East 153.4 feet
thence South 64 Degrees 33 Minutes 30 Seconds East 169.7 feet
thence South 64 Degrees 22 Minutes 01 Seconds East 209.8 feet
thence South 65 Degrees 57 Minutes 13 Seconds East 234.4 feet
thence South 68 Degrees 16 Minutes 22 Seconds East 244.5 feet
thence South 69 Degrees 45 Minutes 58 Seconds East 242.8 feet
thence South 66 Degrees 10 Minutes 24 Seconds East 244.4 feet
thence South 64 Degrees 50 Minutes 08 Seconds East 251.5 feet
thence South 63 Degrees 47 Minutes 47 Seconds East 222.2 feet more or less to **the ending**

point at: 41 degrees 16 minutes 21.22 seconds North Latitude and -113 degrees 42 minutes 44.13 seconds West Longitude, which can be converted to mapping accuracy State Plane Utah North Zone NAD 83 feet coordinates of X = 1,032,373.9 feet and Y = 3,630,768.4 feet.

Appendix B to Attachment 4

Popular Name: Little Pigeon Road

County: Box Elder

County Road Number: 65

State Geographic Information Database (SGID) Road Identification Number: RD020124.

Road-Segment Number: 005

Road-Segment Length: 0.69 miles more or less.

Believed owner of the land underlying this road-segment is: Bureau of Land Management.

The following description is based upon the geographic coordinate system using the NAD83 Datum. The source is GPS mapping grade data as indicated in the metadata and/or the transportation data model of the State of Utah Geographic Information Database (SGID).

The road-segment itself is the monument that is identified by its physical presence on the land. The location of said physical presence is closely approximated by mapping grade Global Positioning System (GPS) data. Said data are checked against the corresponding gray-scale 1-meter Digital Orthophoto Quadrangles published by the United States Geological Survey (USGS) to verify a reasonable degree of accuracy. In circumstances where accurate satellite signal acquisition is not possible, such as deep, narrow canyons or under a canopy of dense foliage, or where very sharp curves in the road make accuracy questionable, such portions of the road were digitized from the corresponding gray-scale 1-meter Digital Orthophoto Quadrangles published by the United States Geological Survey (USGS).

This road-segment may traverse:

Township 6 North Range 16 West, Section(s) 4, Salt Lake Base & Meridian

The following description closely approximates the location of the centerline of the physical monument (Little Pigeon Road)-- Segment 005 based on mapping grade Global Positioning System (GPS) data as defined above:

Beginning at a point on the road center line located at 41 degrees 15 minutes 53.45 seconds North Latitude and -113 degrees 41 minutes 34.54 seconds West Longitude, which can be converted to mapping accuracy State Plane Utah North Zone NAD 83 feet coordinates of X = 1,037,614.7 feet and Y = 3,627,824.4 feet; thence the following courses along the said road center line:

thence South 62 Degrees 53 Minutes 33 Seconds East	88.5 feet
thence South 62 Degrees 31 Minutes 52 Seconds East	320 feet
thence South 61 Degrees 49 Minutes 08 Seconds East	319.5 feet
thence South 61 Degrees 58 Minutes 24 Seconds East	314.2 feet
thence South 62 Degrees 23 Minutes 22 Seconds East	311.5 feet
thence South 60 Degrees 52 Minutes 06 Seconds East	313.4 feet
thence South 59 Degrees 57 Minutes 18 Seconds East	317.8 feet
thence South 60 Degrees 56 Minutes 05 Seconds East	320.7 feet
thence South 59 Degrees 44 Minutes 49 Seconds East	322.3 feet
thence South 57 Degrees 23 Minutes 58 Seconds East	322.8 feet
thence South 56 Degrees 28 Minutes 47 Seconds East	323.9 feet
thence South 55 Degrees 01 Minutes 45 Seconds East	323.5 feet

thence South 54 Degrees 52 Minutes 21 Seconds East 52.2 feet more or less to **the ending point at:** 41 degrees 15 minutes 36.17 seconds North Latitude and -113 degrees 40 minutes 52.63 seconds West Longitude, which can be converted to mapping accuracy State Plane Utah North Zone NAD 83 feet coordinates of X = 1,040,769.9 feet and Y = 3,625,995.4 feet.

Appendix C to Attachment 4

Popular Name: Little Pigeon Road

County: Box Elder

County Road Number: 65

State Geographic Information Database (SGID) Road Identification Number: RD020124.

Road-Segment Number: 007

Road-Segment Length: 1.24 miles more or less.

Believed owner of the land underlying this road-segment is: Bureau of Land Management.

The following description is based upon the geographic coordinate system using the NAD83 Datum. The source is GPS mapping grade data as indicated in the metadata and/or the transportation data model of the State of Utah Geographic Information Database (SGID).

The road-segment itself is the monument that is identified by its physical presence on the land. The location of said physical presence is closely approximated by mapping grade Global Positioning System (GPS) data. Said data are checked against the corresponding gray-scale 1-meter Digital Orthophoto Quadrangles published by the United States Geological Survey (USGS) to verify a reasonable degree of accuracy. In circumstances where accurate satellite signal acquisition is not possible, such as deep, narrow canyons or under a canopy of dense foliage, or where very sharp curves in the road make accuracy questionable, such portions of the road were digitized from the corresponding gray-scale 1-meter Digital Orthophoto Quadrangles published by the United States Geological Survey (USGS).

This road-segment may traverse:

Township 6 North Range 16 West, Section(s) 10,11, Salt Lake Base & Meridian

The following description closely approximates the location of the centerline of the physical monument (Little Pigeon Road)-- Segment 007 based on mapping grade Global Positioning System (GPS) data as defined above:

Beginning at a point on the road center line located at 41 degrees 15 minutes 18.44 seconds North Latitude and -113 degrees 40 minutes 25.35 seconds West Longitude, which can be converted to mapping accuracy State Plane Utah North Zone NAD 83 feet coordinates of X = 1,042,808.2 feet and Y = 3,624,149.6 feet; thence the following courses along the said road center line:

thence South 34 Degrees 37 Minutes 39 Seconds East	6.9 feet
thence South 34 Degrees 27 Minutes 35 Seconds East	226.6 feet
thence South 35 Degrees 04 Minutes 13 Seconds East	293 feet
thence South 34 Degrees 10 Minutes 51 Seconds East	292.7 feet
thence South 33 Degrees 41 Minutes 43 Seconds East	288.7 feet
thence South 29 Degrees 31 Minutes 15 Seconds East	281.8 feet
thence South 29 Degrees 37 Minutes 46 Seconds East	261.4 feet
thence South 42 Degrees 12 Minutes 36 Seconds East	259.9 feet
thence South 51 Degrees 18 Minutes 33 Seconds East	276.1 feet
thence South 57 Degrees 25 Minutes 53 Seconds East	289.9 feet
thence South 55 Degrees 59 Minutes 41 Seconds East	290.8 feet
thence South 58 Degrees 15 Minutes 08 Seconds East	274.8 feet

thence South 59 Degrees 18 Minutes 18 Seconds East 209.4 feet
thence South 61 Degrees 46 Minutes 24 Seconds East 223.7 feet
thence South 68 Degrees 01 Minutes 20 Seconds East 254.9 feet
thence South 78 Degrees 30 Minutes 54 Seconds East 817 feet
thence South 77 Degrees 10 Minutes 34 Seconds East 273.8 feet
thence South 77 Degrees 26 Minutes 11 Seconds East 279.3 feet
thence South 80 Degrees 03 Minutes 17 Seconds East 285 feet
thence South 71 Degrees 12 Minutes 29 Seconds East 285.4 feet
thence South 56 Degrees 57 Minutes 35 Seconds East 277.3 feet
thence South 53 Degrees 41 Minutes 26 Seconds East 277.6 feet
thence South 53 Degrees 14 Minutes 10 Seconds East 310.3 feet
thence South 53 Degrees 11 Minutes 20 Seconds East 16.6 feet more or less to **the ending**

point at: 41 degrees 14 minutes 45.55 seconds North Latitude and -113 degrees 39 minutes 15.84 seconds West Longitude, which can be converted to mapping accuracy State Plane Utah North Zone NAD 83 feet coordinates of X = 1,048,033.1 feet and Y = 3,620,689.6 feet.

Appendix D to Attachment 4

Popular Name: Little Pigeon Road

County: Box Elder

County Road Number: 65

State Geographic Information Database (SGID) Road Identification Number: RD020124.

Road-Segment Number: 009

Road-Segment Length: 0.18 miles more or less.

Believed owner of the land underlying this road-segment is: Bureau of Land Management.

The following description is based upon the geographic coordinate system using the NAD83 Datum. The source is GPS mapping grade data as indicated in the metadata and/or the transportation data model of the State of Utah Geographic Information Database (SGID).

The road-segment itself is the monument that is identified by its physical presence on the land. The location of said physical presence is closely approximated by mapping grade Global Positioning System (GPS) data. Said data are checked against the corresponding gray-scale 1-meter Digital Orthophoto Quadrangles published by the United States Geological Survey (USGS) to verify a reasonable degree of accuracy. In circumstances where accurate satellite signal acquisition is not possible, such as deep, narrow canyons or under a canopy of dense foliage, or where very sharp curves in the road make accuracy questionable, such portions of the road were digitized from the corresponding gray-scale 1-meter Digital Orthophoto Quadrangles published by the United States Geological Survey (USGS).

This road-segment may traverse:

Township 6 North Range 16 West, Section(s) 14, Salt Lake Base & Meridian

The following description closely approximates the location of the centerline of the physical monument (Little Pigeon Road)-- Segment 009 based on mapping grade Global Positioning System (GPS) data as defined above:

Beginning at a point on the road center line located at 41 degrees 14 minutes 43.79 seconds North Latitude and -113 degrees 39 minutes 012.7 seconds West Longitude, which can be converted to mapping accuracy State Plane Utah North Zone NAD 83 feet coordinates of X = 1,048,267.8 feet and Y = 3,620,505.0 feet; thence the following courses along the said road center line:

thence South 49 Degrees 43 Minutes 44 Seconds East 1.2 feet
thence South 49 Degrees 56 Minutes 55 Seconds East 29.7 feet
thence South 43 Degrees 33 Minutes 53 Seconds East 135.5 feet
thence South 40 Degrees 45 Minutes 07 Seconds East 124.9 feet
thence South 40 Degrees 31 Minutes 20 Seconds East 124.5 feet
thence South 26 Degrees 06 Minutes 41 Seconds East 96.5 feet
thence South 09 Degrees 11 Minutes 02 Seconds West 59.5 feet
thence South 28 Degrees 45 Minutes 17 Seconds West 60.1 feet
thence South 08 Degrees 26 Minutes 26 Seconds West 58.1 feet
thence South 45 Degrees 01 Minutes 48 Seconds East 44.3 feet
thence North 87 Degrees 38 Minutes 20 Seconds East 46.3 feet
thence North 35 Degrees 50 Minutes 24 Seconds East 48.4 feet

thence North 04 Degrees 52 Minutes 26 Seconds West 49.7 feet

thence North 19 Degrees 45 Minutes 03 Seconds West 54.3 feet

thence North 31 Degrees 51 Minutes 17 Seconds West 43.1 feet more or less to **the ending**

point at: 41 degrees 14 minutes 39.76 seconds North Latitude and -113 degrees 39 minutes 08.18 seconds West Longitude, which can be converted to mapping accuracy State Plane Utah North Zone NAD 83 feet coordinates of X = 1,048,603.5 feet and Y = 3,620,089.1 feet.