

**Amended Acknowledgment and
Amended Notice of Acknowledgment
of Acceptance of R.S. 2477
Right-of-Way Grant**

Ent 255691 Bk 1030 Pg 1105
Date 19-Nov-2007 10:00AM Fee \$0.00
LuAnn Adams - Filed By Ia
Box Elder Co., UT
For GOVERNOR FOR THE STATE OF UTAH

THE STATE OF UTAH

TO ALL WHOM THESE PRESENTS SHALL COME, Greeting:

Know ye, This is an Amended Acknowledgment and Amended Notice of Acknowledgment made under Utah Code Sections 72-5-309 through 310 inclusive, that the grant of the United States of America of “the right of way for the construction of highways over public lands, not reserved for public uses” under United States Revised Statutes 2477 (43 U.S.C. Section 932 (repealed October 21, 1976, with proviso recognizing the validity of rights-of-way already established)) was accepted for and on behalf of the State of Utah and its political subdivision Box Elder County as it pertains to the highway located in Box Elder County known as Mud Basin Road; County Road Number: 73; State Geographic Information Database (SGID) Road Identification Number: RD020134. Total road length is 7.27 miles more or less.

This Amended Acknowledgment and Amended Notice of Acknowledgment supersedes the information contained in the Acknowledgment recorded at Ent 238530, Bk 988, Beg Pg 761.

The reason for this Amended Acknowledgment and Amended Notice of Acknowledgment includes, but is not limited to, the fact that the road was constructed, mechanically, or by continuous use as a public highway for a period of at least ten years, over public lands not reserved for public uses, prior to the earlier of (a) the October 21, 1976 repeal of R.S. 2477 or (b) the date the servient estate was reserved for public uses.

This Amended Acknowledgment and Amended Notice of Acknowledgment applies only to the segments of the road that traverse land owned by the Bureau of Land Management, United States Department of the Interior, and does not apply to segments of the road that traverse land owned by any other person or entity. The State of Utah and its political subdivisions reserve the right to make further acknowledgments and notices of acknowledgment with regard to road segments that traverse land owned by other entities, including the United States of America, through one or more of its agencies.

A printed copy of a map showing the location of the road in said county is appended hereto as “Attachment 1,” a printed copy of representative photos of the road is appended hereto as “Attachment 2,” a printed copy of a description of the beginning and ending points of the entire road together with a list of Townships, Ranges and Sections that may be traversed by the road in said county is appended hereto as “Attachment 3,” and a printed copy of the Road Centerline Description Cover Page(s) is appended hereto as “Attachment 4.” The Appendices listed in “Attachment 4” that contain the actual road centerline descriptions are incorporated herein by reference.

A printed copy of this Amended Acknowledgment and Amended Notice of Acknowledgment, together with its Attachments and Appendices, may be viewed and/or obtained at the office of the Utah State Archives.

An electronic copy of this Amended Acknowledgment and Amended Notice of Acknowledgment, together with its Attachments and Appendices, may be viewed and/or downloaded as read-only PDF (Portable Document Format) files via the Internet at <http://recorded2477roads.utah.gov>.

The owner of the servient estate in the land underlying the road-segments subject to this Amended Acknowledgment and Amended Notice is believed to be the United States of America through one or more of its agencies. Any of such agencies or any other person with a servient ownership claim or a competing dominant estate right-of-way ownership claim, may file a petition in the State District Court for Salt Lake County for a decision regarding the correctness of this Amended Acknowledgment. A claimant shall file a petition within sixty (60) days after receipt of this Notice.

In Witness Whereof, I, John Harja, the official designee of the Governor of the State of Utah, in conformity to the laws of the State (Utah Code Sections 72-5-308 through 310 inclusive), have caused this Amended Acknowledgment and Amend Notice of Acknowledgment to be made.

Signed by my hand in Salt Lake City, Utah, the 15th day of November, 2007.

By the Governor's Designee



John Harja

CERTIFICATION

State of Utah)
 : ss
County of Salt Lake)

I hereby certify that the signer of the foregoing document, John Harja, is personally known by me, has made a voluntary signature and taken an oath stating that he is the official designee of the Governor of the State of Utah and is authorized to sign this document on the Governor's behalf pursuant to Utah Code Section 72-5-309. He further vouched that, based upon information and belief, the facts alleged therein are true.

Dated this 15th day of November, 2007.



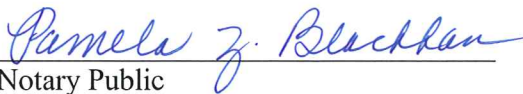

Notary Public

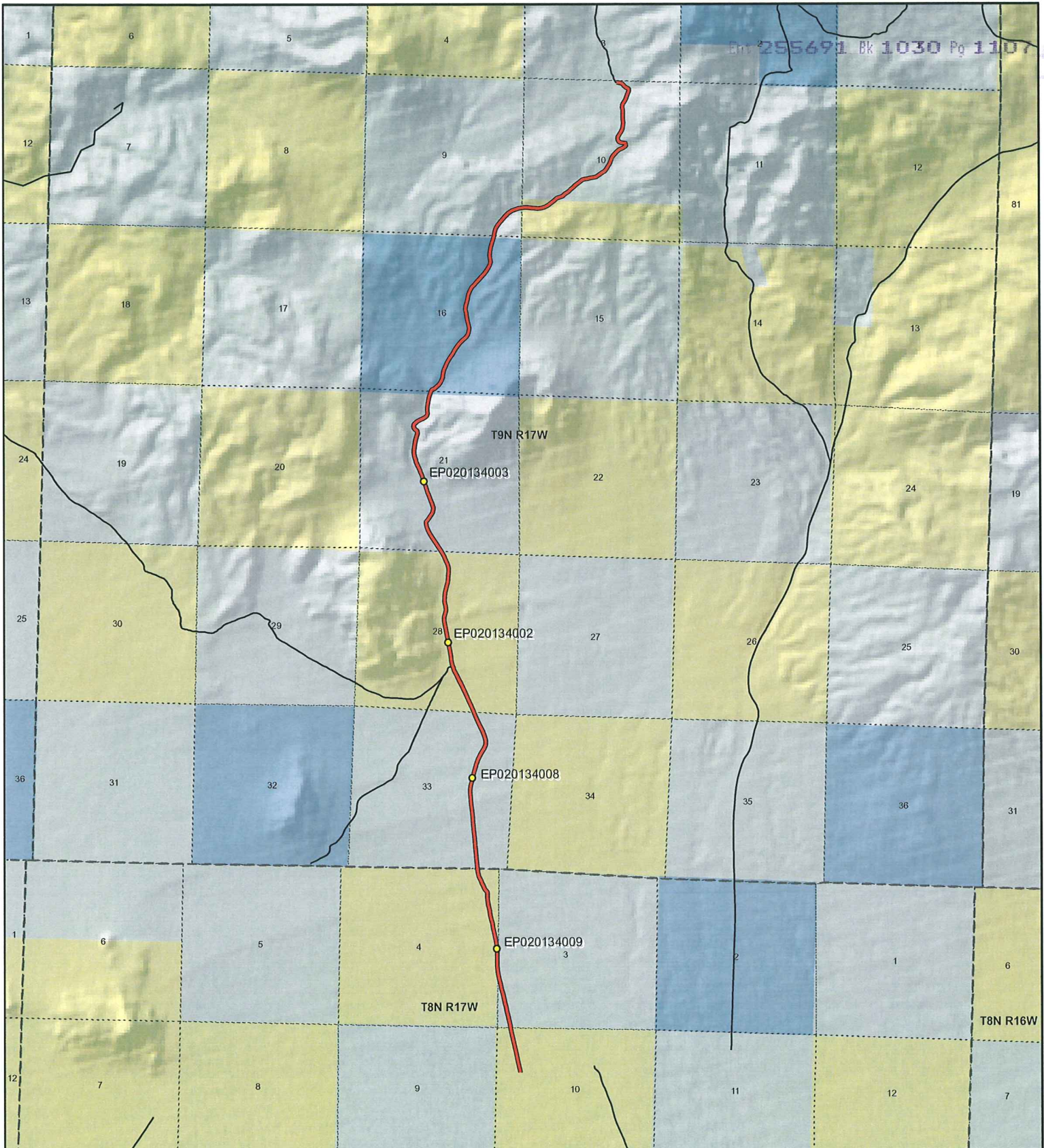

Doc 255691 Bk 1030 Pg 1107

1:52,157
1 inch equals 0.8 miles

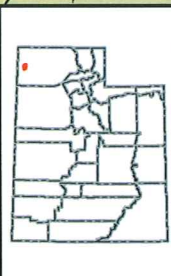

Mud Basin Road - Box Elder County
SGID RD_ID RD020134

Land Ownership Categories		Transportation Network
BLM	Wilderness	Mud Basin Road
Private	UDWR Wildlife Reserve	Title V: Issued Or Under Consideration By BLM Or County
SITLA, State Trust Land	DOD, Military	Other Roads
USFS, National Forest	State Sovereign Land	Photo Event Point
State Parks and Recreation	National Recreation Area	Section = 1 Mile
Tribal, Indian Reservation	USFWS, Natl. Wildlife Refuge	
NPS, National Park		

Map prepared by the State of Utah
Automated Geographic Reference Center
Room 5130 State Office Building
Salt Lake City, Utah 84114
Nov 10, 2006



EP020134002



EP020134003



EP020134008



EP020134009

EP000000000

EP000000000

**Mud Basin Road - Box Elder County
SGID RD_ID RD020134**

Map prepared by the State of Utah
Automated Geographic Reference Center
Room 5130 State Office Building
Salt Lake City, Utah 84114
November 9, 2006



Attachment 3

Beginning & Ending Points and Township, Range, and Section References For:

Popular Name: Mud Basin Road

County: Box Elder

County Road Number: 73

State Geographic Information Database (SGID) Road Identification Number: RD020134.

Total Road Length: 7.27 miles more or less.

Beginning at a point on the road centerline located at 41 degrees 25 minutes 56.55 seconds North Latitude and -113 degrees 47 minutes 12.95 seconds West Longitude, which can be converted to mapping accuracy State Plane Utah North Zone NAD 83 feet coordinates of X = 1,013,386.5 feet and Y = 3,689,509.0 feet based on the US Survey Foot conversion.

Ending at a point on the road centerline located at 41 degrees 31 minutes 23.77 seconds North Latitude and -113 degrees 46 minutes 42.96 seconds West Longitude, which can be converted to mapping accuracy State Plane Utah North Zone NAD 83 feet coordinates of X = 1,016,538.9 feet and Y = 3,722,556.3 feet based on the US Survey Foot conversion.

This road may traverse:

Township 8 North Range 17 West, Section(s) 3,4,10, Salt Lake Base & Meridian

Township 9 North Range 17 West, Section(s) 9,10,16,21,28,33, Salt Lake Base & Meridian

See Attachment 1 above for a cartographic depiction of the course of this road.

Attachment 4
Road Centerline Description Cover Page(s)

Popular Name: Mud Basin Road

County: Box Elder

County Road Number: 73

State Geographic Information Database (SGID) Road Identification Number: RD020134.

Total Road Length: 7.27 miles more or less.

Centerline Descriptions Of Road-Segments That Cross Over Federally Owned Land, Derived From Global Positioning System Data And Cross-checked against USGS Digital Orthophoto Quadrangles Compiled By The Utah Automated Geographic Reference Center And Entered Into The State Geographic Information Database (SGID).

Road-Segments Listed by SGID Road Identification Number (RD_ID)	Road-Segment Numbers	Believed Ownership Of Servient Estate	Approximate Segment Length	See Attached Appendix
RD020134	001	BLM	0.3 Miles	A
RD020134	002	PVT	0.42 Miles	(not shown)
RD020134	003	BLM	0.61 Miles	B
RD020134	004	PVT	1.02 Miles	(not shown)
RD020134	005	BLM	1.06 Miles	C
RD020134	006	PVT	1.13 Miles	(not shown)
RD020134	007	ST	1.13 Miles	(not shown)
RD020134	008	PVT	0.27 Miles	(not shown)
RD020134	009	BLM	0.24 Miles	D
RD020134	010	PVT	1.09 Miles	(not shown)
		Total Road Length	7.27	_____

* Indicates that a Title V permit will be requested, is in process, or has been issued.

† Indicates that road-segments crossing Forest Service land are under consideration by the state and county as of the date of this Amended Acknowledgment and Amended Notice of Acknowledgment.

Appendix A to Attachment 4

Popular Name: Mud Basin Road

County: Box Elder

County Road Number: 73

State Geographic Information Database (SGID) Road Identification Number: RD020134.

Road-Segment Number: 001

Road-Segment Length: 0.3 miles more or less.

Believed owner of the land underlying this road-segment is: Bureau of Land Management.

The following description is based upon the geographic coordinate system using the NAD83 Datum. The source is GPS mapping grade data as indicated in the metadata and/or the transportation data model of the State of Utah Geographic Information Database (SGID).

The road-segment itself is the monument that is identified by its physical presence on the land. The location of said physical presence is closely approximated by mapping grade Global Positioning System (GPS) data. Said data are checked against the corresponding gray-scale 1-meter Digital Orthophoto Quadrangles published by the United States Geological Survey (USGS) to verify a reasonable degree of accuracy. In circumstances where accurate satellite signal acquisition is not possible, such as deep, narrow canyons or under a canopy of dense foliage, or where very sharp curves in the road make accuracy questionable, such portions of the road were digitized from the corresponding gray-scale 1-meter Digital Orthophoto Quadrangles published by the United States Geological Survey (USGS).

This road-segment may traverse:

Township 8 North Range 17 West, Section(s) 3,10, Salt Lake Base & Meridian

The following description closely approximates the location of the centerline of the physical monument (Mud Basin Road)-- Segment 001 based on mapping grade Global Positioning System (GPS) data as defined above:

Beginning at a point on the road center line located at 41 degrees 25 minutes 56.55 seconds North Latitude and -113 degrees 47 minutes 12.95 seconds West Longitude, which can be converted to mapping accuracy State Plane Utah North Zone NAD 83 feet coordinates of X = 1,013,386.5 feet and Y = 3,689,509.0 feet; thence the following courses along the said road center line:

thence North 22 Degrees 08 Minutes 18 Seconds West 5.3 feet

thence North 11 Degrees 52 Minutes 18 Seconds West 82 feet

thence North 12 Degrees 02 Minutes 24 Seconds West 140.7 feet

thence North 12 Degrees 24 Minutes 58 Seconds West 167.7 feet

thence North 12 Degrees 38 Minutes 10 Seconds West 186.3 feet

thence North 12 Degrees 55 Minutes 12 Seconds West 188.2 feet

thence North 12 Degrees 55 Minutes 33 Seconds West 544.8 feet

thence North 12 Degrees 30 Minutes 53 Seconds West 174.1 feet

thence North 12 Degrees 11 Minutes 30 Seconds West 33.3 feet

thence North 12 Degrees 11 Minutes 29 Seconds West 56.9 feet more or less to **the ending**

point at: 41 degrees 26 minutes 11.68 seconds North Latitude and -113 degrees 47 minutes 18.02 seconds West Longitude, which can be converted to mapping accuracy State Plane Utah North Zone NAD 83 feet

coordinates of X = 1,013,040.8 feet and Y = 3,691,049.9 feet.

Appendix B to Attachment 4

Popular Name: Mud Basin Road

County: Box Elder

County Road Number: 73

State Geographic Information Database (SGID) Road Identification Number: RD020134.

Road-Segment Number: 003

Road-Segment Length: 0.61 miles more or less.

Believed owner of the land underlying this road-segment is: Bureau of Land Management.

The following description is based upon the geographic coordinate system using the NAD83 Datum. The source is GPS mapping grade data as indicated in the metadata and/or the transportation data model of the State of Utah Geographic Information Database (SGID).

The road-segment itself is the monument that is identified by its physical presence on the land. The location of said physical presence is closely approximated by mapping grade Global Positioning System (GPS) data. Said data are checked against the corresponding gray-scale 1-meter Digital Orthophoto Quadrangles published by the United States Geological Survey (USGS) to verify a reasonable degree of accuracy. In circumstances where accurate satellite signal acquisition is not possible, such as deep, narrow canyons or under a canopy of dense foliage, or where very sharp curves in the road make accuracy questionable, such portions of the road were digitized from the corresponding gray-scale 1-meter Digital Orthophoto Quadrangles published by the United States Geological Survey (USGS).

This road-segment may traverse:

Township 8 North Range 17 West, Section(s) 4, Salt Lake Base & Meridian

The following description closely approximates the location of the centerline of the physical monument (Mud Basin Road)-- Segment 003 based on mapping grade Global Positioning System (GPS) data as defined above:

Beginning at a point on the road center line located at 41 degrees 26 minutes 32.76 seconds North Latitude and -113 degrees 47 minutes 24.66 seconds West Longitude, which can be converted to mapping accuracy State Plane Utah North Zone NAD 83 feet coordinates of X = 1,012,591.9 feet and Y = 3,693,196.3 feet; thence the following courses along the said road center line:

thence North 02 Degrees 13 Minutes 54 Seconds West 63.5 feet
thence North 00 Degrees 45 Minutes 42 Seconds West 221.4 feet
thence North 01 Degrees 20 Minutes 02 Seconds West 188.6 feet
thence North 07 Degrees 44 Minutes 59 Seconds West 170.3 feet
thence North 13 Degrees 09 Minutes 58 Seconds West 169.9 feet
thence North 12 Degrees 29 Minutes 33 Seconds West 174.5 feet
thence North 11 Degrees 44 Minutes 31 Seconds West 155.9 feet
thence North 12 Degrees 17 Minutes 02 Seconds West 150.5 feet
thence North 13 Degrees 35 Minutes 32 Seconds West 151.6 feet
thence North 13 Degrees 29 Minutes 31 Seconds West 149.9 feet
thence North 09 Degrees 06 Minutes 30 Seconds West 116.2 feet
thence North 10 Degrees 39 Minutes 27 Seconds West 111.7 feet

thence North 12 Degrees 29 Minutes 33 Seconds West 109 feet
thence North 10 Degrees 40 Minutes 19 Seconds West 113.4 feet
thence North 06 Degrees 20 Minutes 48 Seconds West 100.3 feet
thence North 02 Degrees 10 Minutes 51 Seconds East 112 feet
thence North 02 Degrees 50 Minutes 10 Seconds West 90.3 feet
thence North 38 Degrees 36 Minutes 26 Seconds West 75.2 feet
thence North 36 Degrees 11 Minutes 20 Seconds West 62.7 feet
thence North 33 Degrees 08 Minutes 14 Seconds West 52.7 feet
thence North 22 Degrees 42 Minutes 05 Seconds West 62.1 feet
thence North 22 Degrees 19 Minutes 18 Seconds West 95.5 feet
thence North 25 Degrees 52 Minutes 02 Seconds West 121.8 feet
thence North 24 Degrees 45 Minutes 15 Seconds West 113.5 feet
thence North 16 Degrees 41 Minutes 50 Seconds West 106 feet
thence North 07 Degrees 12 Minutes 28 Seconds West 137.1 feet
thence North 06 Degrees 40 Minutes 39 Seconds West 33.8 feet more or less to **the ending**

point at: 41 degrees 27 minutes 03.18 seconds North Latitude and -113 degrees 47 minutes 34.44 seconds West Longitude, which can be converted to mapping accuracy State Plane Utah North Zone NAD 83 feet coordinates of X = 1,011,928.2 feet and Y = 3,696,293.8 feet.

Appendix C to Attachment 4

Popular Name: Mud Basin Road

County: Box Elder

County Road Number: 73

State Geographic Information Database (SGID) Road Identification Number: RD020134.

Road-Segment Number: 005

Road-Segment Length: 1.06 miles more or less.

Believed owner of the land underlying this road-segment is: Bureau of Land Management.

The following description is based upon the geographic coordinate system using the NAD83 Datum. The source is GPS mapping grade data as indicated in the metadata and/or the transportation data model of the State of Utah Geographic Information Database (SGID).

The road-segment itself is the monument that is identified by its physical presence on the land. The location of said physical presence is closely approximated by mapping grade Global Positioning System (GPS) data. Said data are checked against the corresponding gray-scale 1-meter Digital Orthophoto Quadrangles published by the United States Geological Survey (USGS) to verify a reasonable degree of accuracy. In circumstances where accurate satellite signal acquisition is not possible, such as deep, narrow canyons or under a canopy of dense foliage, or where very sharp curves in the road make accuracy questionable, such portions of the road were digitized from the corresponding gray-scale 1-meter Digital Orthophoto Quadrangles published by the United States Geological Survey (USGS).

This road-segment may traverse:

Township 9 North Range 17 West, Section(s) 28, Salt Lake Base & Meridian

The following description closely approximates the location of the centerline of the physical monument (Mud Basin Road)-- Segment 005 based on mapping grade Global Positioning System (GPS) data as defined above:

Beginning at a point on the road center line located at 41 degrees 27 minutes 054.6 seconds North Latitude and -113 degrees 47 minutes 38.04 seconds West Longitude, which can be converted to mapping accuracy State Plane Utah North Zone NAD 83 feet coordinates of X = 1,011,791.6 feet and Y = 3,701,502.7 feet; thence the following courses along the said road center line:

thence North 24 Degrees 36 Minutes 43 Seconds West 19.2 feet
thence North 24 Degrees 36 Minutes 46 Seconds West 30.8 feet
thence North 24 Degrees 55 Minutes 08 Seconds West 182.1 feet
thence North 24 Degrees 45 Minutes 58 Seconds West 192.7 feet
thence North 24 Degrees 42 Minutes 48 Seconds West 203.4 feet
thence North 25 Degrees 15 Minutes 39 Seconds West 204.7 feet
thence North 26 Degrees 02 Minutes 19 Seconds West 194.4 feet
thence North 25 Degrees 08 Minutes 07 Seconds West 180.6 feet
thence North 25 Degrees 34 Minutes 44 Seconds West 177.7 feet
thence North 26 Degrees 14 Minutes 42 Seconds West 178.7 feet
thence North 21 Degrees 34 Minutes 03 Seconds West 91.5 feet
thence North 21 Degrees 37 Minutes 05 Seconds West 66.9 feet

thence North 11 Degrees 31 Minutes 56 Seconds West 158.8 feet
thence North 09 Degrees 10 Minutes 09 Seconds West 185.9 feet
thence North 08 Degrees 47 Minutes 41 Seconds West 187.3 feet
thence North 13 Degrees 05 Minutes 46 Seconds West 178.2 feet
thence North 11 Degrees 56 Minutes 55 Seconds West 184.2 feet
thence North 10 Degrees 29 Minutes 39 Seconds West 191.6 feet
thence North 11 Degrees 55 Minutes 06 Seconds West 191.2 feet
thence North 10 Degrees 27 Minutes 16 Seconds West 151.3 feet
thence North 09 Degrees 46 Minutes 29 Seconds West 118 feet
thence North 00 Degrees 09 Minutes 44 Seconds West 106.6 feet
thence North 18 Degrees 18 Minutes 04 Seconds East 116 feet
thence North 09 Degrees 23 Minutes 35 Seconds East 126.1 feet
thence North 05 Degrees 58 Minutes 02 Seconds West 137.1 feet
thence North 13 Degrees 56 Minutes 06 Seconds West 145.1 feet
thence North 02 Degrees 38 Minutes 52 Seconds East 188.8 feet
thence North 08 Degrees 38 Minutes 01 Seconds East 126.2 feet
thence North 12 Degrees 34 Minutes 16 Seconds East 149.7 feet
thence North 13 Degrees 25 Minutes 39 Seconds East 135.1 feet
thence North 12 Degrees 36 Minutes 50 Seconds East 134.6 feet
thence North 06 Degrees 33 Minutes 23 Seconds East 142.1 feet
thence North 03 Degrees 47 Minutes 04 Seconds East 141.4 feet
thence North 02 Degrees 19 Minutes 24 Seconds West 132.6 feet
thence North 17 Degrees 58 Minutes 57 Seconds West 127.7 feet
thence North 25 Degrees 39 Minutes 51 Seconds West 128.8 feet
thence North 23 Degrees 07 Minutes 16 Seconds West 142.3 feet
thence North 26 Degrees 36 Minutes 19 Seconds West 140.8 feet
thence North 35 Degrees 27 Minutes 04 Seconds West 20.6 feet more or less to **the ending**

point at: 41 degrees 28 minutes 47.12 seconds North Latitude and -113 degrees 47 minutes 54.27 seconds West Longitude, which can be converted to mapping accuracy State Plane Utah North Zone NAD 83 feet coordinates of X = 1,010,697.0 feet and Y = 3,706,849.1 feet.

Appendix D to Attachment 4

Popular Name: Mud Basin Road

County: Box Elder

County Road Number: 73

State Geographic Information Database (SGID) Road Identification Number: RD020134.

Road-Segment Number: 009

Road-Segment Length: 0.24 miles more or less.

Believed owner of the land underlying this road-segment is: Bureau of Land Management.

The following description is based upon the geographic coordinate system using the NAD83 Datum. The source is GPS mapping grade data as indicated in the metadata and/or the transportation data model of the State of Utah Geographic Information Database (SGID).

The road-segment itself is the monument that is identified by its physical presence on the land. The location of said physical presence is closely approximated by mapping grade Global Positioning System (GPS) data. Said data are checked against the corresponding gray-scale 1-meter Digital Orthophoto Quadrangles published by the United States Geological Survey (USGS) to verify a reasonable degree of accuracy. In circumstances where accurate satellite signal acquisition is not possible, such as deep, narrow canyons or under a canopy of dense foliage, or where very sharp curves in the road make accuracy questionable, such portions of the road were digitized from the corresponding gray-scale 1-meter Digital Orthophoto Quadrangles published by the United States Geological Survey (USGS).

This road-segment may traverse:

Township 9 North Range 17 West, Section(s) 9,10, Salt Lake Base & Meridian

The following description closely approximates the location of the centerline of the physical monument (Mud Basin Road)-- Segment 009 based on mapping grade Global Positioning System (GPS) data as defined above:

Beginning at a point on the road center line located at 41 degrees 30 minutes 041.5 seconds North Latitude and -113 degrees 47 minutes 23.96 seconds West Longitude, which can be converted to mapping accuracy State Plane Utah North Zone NAD 83 feet coordinates of X = 1,013,308.4 feet and Y = 3,718,361.8 feet; thence the following courses along the said road center line:

thence North 80 Degrees 36 Minutes 19 Seconds East	20.7 feet
thence North 77 Degrees 53 Minutes 30 Seconds East	24.1 feet
thence North 86 Degrees 48 Minutes 42 Seconds East	9.9 feet
thence North 86 Degrees 48 Minutes 42 Seconds East	56.1 feet
thence North 86 Degrees 18 Minutes 47 Seconds East	56.2 feet
thence North 89 Degrees 39 Minutes 35 Seconds East	12.5 feet
thence North 86 Degrees 36 Minutes 54 Seconds East	61.7 feet
thence South 79 Degrees 18 Minutes 59 Seconds East	102.9 feet
thence South 85 Degrees 09 Minutes 32 Seconds East	127.1 feet
thence South 88 Degrees 43 Minutes 02 Seconds East	115.8 feet
thence North 85 Degrees 46 Minutes 24 Seconds East	121 feet
thence North 73 Degrees 41 Minutes 38 Seconds East	125.2 feet

thence North 61 Degrees 16 Minutes 01 Seconds East 110.4 feet

thence North 56 Degrees 34 Minutes 30 Seconds East 129.2 feet

thence North 49 Degrees 40 Minutes 58 Seconds East 140.4 feet

thence North 49 Degrees 12 Minutes 05 Seconds East 40.6 feet more or less to **the ending**

point at: 41 degrees 30 minutes 044.5 seconds North Latitude and -113 degrees 47 minutes 08.72 seconds West Longitude, which can be converted to mapping accuracy State Plane Utah North Zone NAD 83 feet coordinates of X = 1,014,475.2 feet and Y = 3,718,634.5 feet.

**Amended Acknowledgment and
Amended Notice of Acknowledgment
of Acceptance of R.S. 2477
Right-of-Way Grant**

THE STATE OF UTAH

TO ALL WHOM THESE PRESENTS SHALL COME, Greeting:

Know ye, This is an Amended Acknowledgment and Amended Notice of Acknowledgment made under Utah Code Sections 72-5-309 through 310 inclusive, that the grant of the United States of America of “the right of way for the construction of highways over public lands, not reserved for public uses” under United States Revised Statutes 2477 (43 U.S.C. Section 932 (repealed October 21, 1976, with proviso recognizing the validity of rights-of-way already established)) was accepted for and on behalf of the State of Utah and its political subdivision Box Elder County as it pertains to the highway located in Box Elder County known as Red Dome Road; County Road Number: 83; State Geographic Information Database (SGID) Road Identification Number: RD020148. Total road length is 11.99 miles more or less.

This Amended Acknowledgment and Amended Notice of Acknowledgment supersedes the information contained in the Acknowledgment recorded at Ent 238532, Bk 988, Beg Pg 773.

The reason for this Amended Acknowledgment and Amended Notice of Acknowledgment includes, but is not limited to, the fact that the road was constructed, mechanically, or by continuous use as a public highway for a period of at least ten years, over public lands not reserved for public uses, prior to the earlier of (a) the October 21, 1976 repeal of R.S. 2477 or (b) the date the servient estate was reserved for public uses.

This Amended Acknowledgment and Amended Notice of Acknowledgment applies only to the segments of the road that traverse land owned by the Bureau of Land Management, United States Department of the Interior, and does not apply to segments of the road that traverse land owned by any other person or entity. The State of Utah and its political subdivisions reserve the right to make further acknowledgments and notices of acknowledgment with regard to road segments that traverse land owned by other entities, including the United States of America, through one or more of its agencies.

A printed copy of a map showing the location of the road in said county is appended hereto as “Attachment 1,” a printed copy of representative photos of the road is appended hereto as “Attachment 2,” a printed copy of a description of the beginning and ending points of the entire road together with a list of Townships, Ranges and Sections that may be traversed by the road in said county is appended hereto as “Attachment 3,” and a printed copy of the Road Centerline Description Cover Page(s) is appended hereto as “Attachment 4.” The Appendices listed in “Attachment 4” that contain the actual road centerline descriptions are incorporated herein by reference.

A printed copy of this Amended Acknowledgment and Amended Notice of Acknowledgment, together with its Attachments and Appendices, may be viewed and/or obtained at the office of the Utah State Archives.

An electronic copy of this Amended Acknowledgment and Amended Notice of Acknowledgment, together with its Attachments and Appendices, may be viewed and/or downloaded as read-only PDF (Portable Document Format) files via the Internet at <http://recorded2477roads.utah.gov>.

The owner of the servient estate in the land underlying the road-segments subject to this Amended Acknowledgment and Amended Notice is believed to be the United States of America through one or more of its agencies. Any of such agencies or any other person with a servient ownership claim or a competing dominant estate right-of-way ownership claim, may file a petition in the State District Court for Salt Lake County for a decision regarding the correctness of this Amended Acknowledgment. A claimant shall file a petition within sixty (60) days after receipt of this Notice.

In Witness Whereof, I, John Harja, the official designee of the Governor of the State of Utah, in conformity to the laws of the State (Utah Code Sections 72-5-308 through 310 inclusive), have caused this Amended Acknowledgment and Amend Notice of Acknowledgment to be made.

Signed by my hand in Salt Lake City, Utah, the 15th day of NOVEMBER, 2007.

By the Governor's Designee



John Harja

CERTIFICATION

State of Utah)
 : ss
County of Salt Lake)

I hereby certify that the signer of the foregoing document, John Harja, is personally known by me, has made a voluntary signature and taken an oath stating that he is the official designee of the Governor of the State of Utah and is authorized to sign this document on the Governor's behalf pursuant to Utah Code Section 72-5-309. He further vouched that, based upon information and belief, the facts alleged therein are true.

Dated this 15th day of November, 2007.





Notary Public

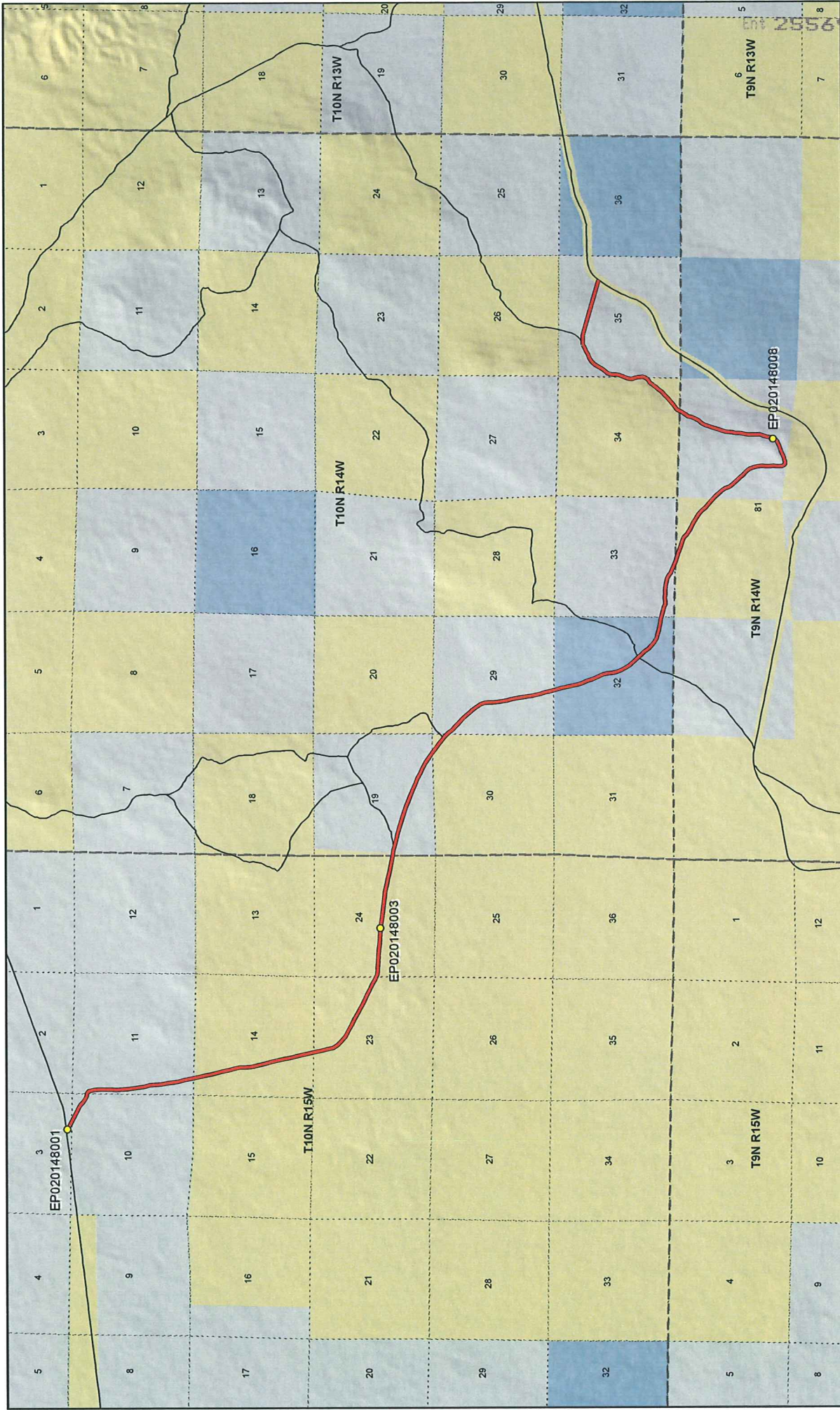

Red Dome Road - Box Elder County
SGID RD_ID RD020148

Land Ownership Categories

- BLM
- Private
- SITLA, State Trust Land
- USFS, National Forest
- State Parks and Recreation
- Tribal, Indian Reservation
- NPS, National Park
- Wilderness
- UDWR Wildlife Reserve
- DOD, Military
- State Sovereign Land
- National Recreation Area
- USFWS, Natl. Wildlife Refuge

Transportation Network

- Red Dome Road
- Other Roads
- Title V, Issued Or Under Consideration By BLM Or County
- Photo Event Point
- Section = 1 Mile

1:70,691
1 inch equals 1.1 miles

Map prepared by the State of Utah
Automated Geographic Reference Center
Room 5130 State Office Building
Salt Lake City, Utah 84114
Nov 09, 2006

Attachment 2



EP020148001



EP020148003



EP020148008

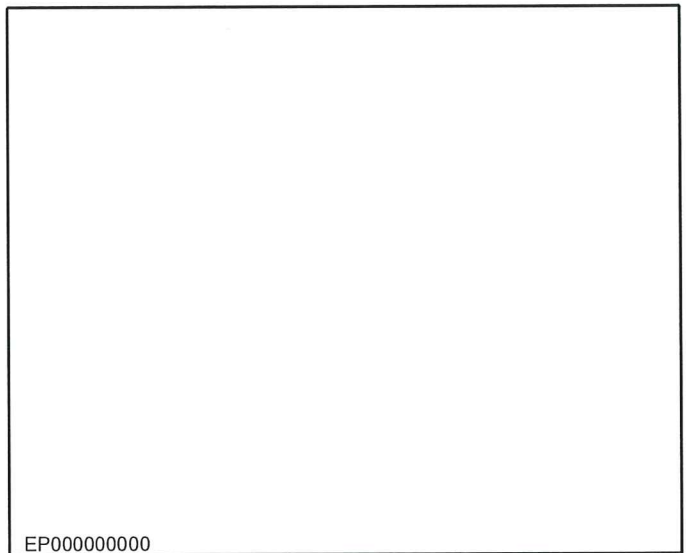

EP000000000

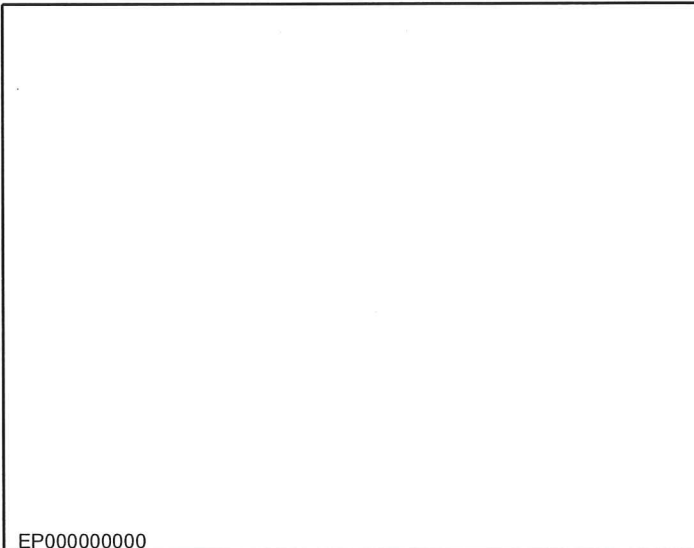

EP000000000

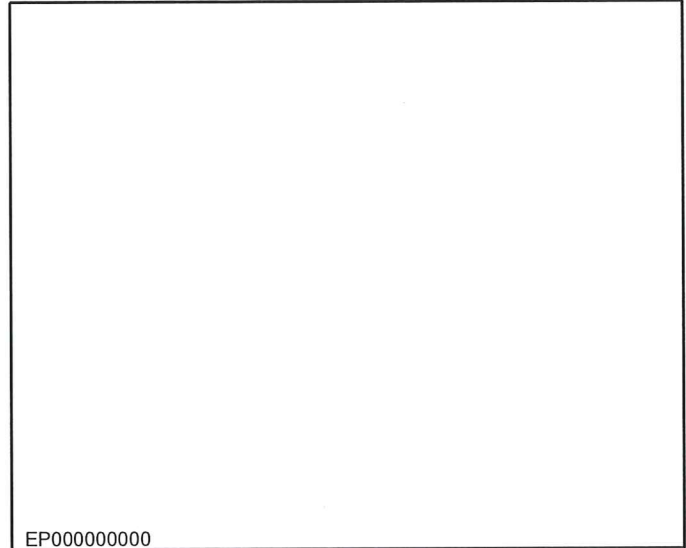

EP000000000

Red Dome Road - Box Elder County
SGID RD_ID RD020148

Map prepared by the State of Utah
Automated Geographic Reference Center
Room 5130 State Office Building
Salt Lake City, Utah 84114
November 9, 2006



Attachment 3

Beginning & Ending Points and Township, Range, and Section References For:

Popular Name: Red Dome Road

County: Box Elder

County Road Number: 83

State Geographic Information Database (SGID) Road Identification Number: RD020148.

Total Road Length: 11.99 miles more or less.

Beginning at a point on the road centerline located at 41 degrees 36 minutes 43.87 seconds North Latitude and -113 degrees 32 minutes 50.57 seconds West Longitude, which can be converted to mapping accuracy State Plane Utah North Zone NAD 83 feet coordinates of X = 1,080,597.1 feet and Y = 3,753,370.7 feet based on the US Survey Foot conversion.

Ending at a point on the road centerline located at 41 degrees 33 minutes 00.53 seconds North Latitude and -113 degrees 24 minutes 29.83 seconds West Longitude, which can be converted to mapping accuracy State Plane Utah North Zone NAD 83 feet coordinates of X = 1,118,127.4 feet and Y = 3,729,904.3 feet based on the US Survey Foot conversion.

This road may traverse:

Township 10 North Range 14 West, Section(s) 19,29,30,32,33,34,35, Salt Lake Base & Meridian

Township 10 North Range 15 West, Section(s) 3,10,11,14,23,24, Salt Lake Base & Meridian

Township 9 North Range 14 West, Section(s) 3,4,10, Salt Lake Base & Meridian

See Attachment 1 above for a cartographic depiction of the course of this road.

**Attachment 4
Road Centerline Description Cover Page(s)**

Popular Name: Red Dome Road

County: Box Elder

County Road Number: 83

State Geographic Information Database (SGID) Road Identification Number: RD020148.

Total Road Length: 11.99 miles more or less.

Centerline Descriptions Of Road-Segments That Cross Over Federally Owned Land, Derived From Global Positioning System Data And Cross-checked against USGS Digital Orthophoto Quadrangles Compiled By The Utah Automated Geographic Reference Center And Entered Into The State Geographic Information Database (SGID).

Road-Segments Listed by SGID Road Identification Number (RD ID)	Road-Segment Numbers	Believed Ownership Of Servient Estate	Approximate Segment Length	See Attached Appendix
RD020148	001	PVT	1.27 Miles	(not shown)
RD020148	002	BLM	2.95 Miles	A
RD020148	003	PVT	0.91 Miles	(not shown)
RD020148	004	BLM	0.2 Miles	B
RD020148	005	PVT	1.01 Miles	(not shown)
RD020148	006	ST	1.18 Miles	(not shown)
RD020148	007	PVT	0.48 Miles	(not shown)
RD020148	008	BLM	0.63 Miles	C
RD020148	009	PVT	1.78 Miles	(not shown)
RD020148	010	BLM	0.4 Miles	D
RD020148	011	PVT	0.07 Miles	(not shown)
RD020148	012	BLM	0.1 Miles	E
RD020148	013	PVT	0.99 Miles	(not shown)
RD020148	014	BLM	0.04 Miles	F
		Total Road Length	11.99	_____

* Indicates that a Title V permit will be requested, is in process, or has been issued.

† Indicates that road-segments crossing Forest Service land are under consideration by the state and county as of the date of this Amended Acknowledgment and Amended Notice of Acknowledgment.

Appendix A to Attachment 4

Popular Name: Red Dome Road

County: Box Elder

County Road Number: 83

State Geographic Information Database (SGID) Road Identification Number: RD020148.

Road-Segment Number: 002

Road-Segment Length: 2.95 miles more or less.

Believed owner of the land underlying this road-segment is: Bureau of Land Management.

The following description is based upon the geographic coordinate system using the NAD83 Datum. The source is GPS mapping grade data as indicated in the metadata and/or the transportation data model of the State of Utah Geographic Information Database (SGID).

The road-segment itself is the monument that is identified by its physical presence on the land. The location of said physical presence is closely approximated by mapping grade Global Positioning System (GPS) data. Said data are checked against the corresponding gray-scale 1-meter Digital Orthophoto Quadrangles published by the United States Geological Survey (USGS) to verify a reasonable degree of accuracy. In circumstances where accurate satellite signal acquisition is not possible, such as deep, narrow canyons or under a canopy of dense foliage, or where very sharp curves in the road make accuracy questionable, such portions of the road were digitized from the corresponding gray-scale 1-meter Digital Orthophoto Quadrangles published by the United States Geological Survey (USGS).

This road-segment may traverse:

Township 10 North Range 14 West, Section(s) 19, Salt Lake Base & Meridian

Township 10 North Range 15 West, Section(s) 14,23,24, Salt Lake Base & Meridian

The following description closely approximates the location of the centerline of the physical monument (Red Dome Road)-- Segment 002 based on mapping grade Global Positioning System (GPS) data as defined above:

Beginning at a point on the road center line located at 41 degrees 35 minutes 49.47 seconds North Latitude and -113 degrees 32 minutes 17.65 seconds West Longitude, which can be converted to mapping accuracy State Plane Utah North Zone NAD 83 feet coordinates of X = 1,082,967.7 feet and Y = 3,747,806.9 feet; thence the following courses along the said road center line:

thence South 12 Degrees 29 Minutes 43 Seconds East	53.9 feet
thence South 12 Degrees 41 Minutes 49 Seconds East	246.8 feet
thence South 11 Degrees 56 Minutes 42 Seconds East	251.2 feet
thence South 12 Degrees 13 Minutes 09 Seconds East	259.8 feet
thence South 11 Degrees 55 Minutes 49 Seconds East	264.5 feet
thence South 15 Degrees 12 Minutes 16 Seconds East	264.7 feet
thence South 14 Degrees 19 Minutes 32 Seconds East	262 feet
thence South 13 Degrees 32 Minutes 08 Seconds East	254.4 feet
thence South 13 Degrees 33 Minutes 34 Seconds East	239.6 feet
thence South 01 Degrees 07 Minutes 39 Seconds East	239.2 feet
thence South 04 Degrees 06 Minutes 30 Seconds East	264.6 feet

thence South 13 Degrees 46 Minutes 31 Seconds East 295.1 feet
 thence South 12 Degrees 53 Minutes 23 Seconds East 312.5 feet
 thence South 13 Degrees 10 Minutes 29 Seconds East 314.6 feet
 thence South 12 Degrees 50 Minutes 14 Seconds East 310.8 feet
 thence South 13 Degrees 10 Minutes 23 Seconds East 302.8 feet
 thence South 12 Degrees 51 Minutes 22 Seconds East 293.7 feet
 thence South 12 Degrees 56 Minutes 32 Seconds East 282.7 feet
 thence South 12 Degrees 46 Minutes 06 Seconds East 280.5 feet
 thence South 13 Degrees 03 Minutes 17 Seconds East 275.7 feet
 thence South 12 Degrees 47 Minutes 19 Seconds East 172.1 feet
 thence South 12 Degrees 47 Minutes 19 Seconds East 103.4 feet
 thence South 13 Degrees 11 Minutes 49 Seconds East 274.2 feet
 thence South 12 Degrees 12 Minutes 41 Seconds East 263.1 feet
 thence South 13 Degrees 21 Minutes 51 Seconds East 247.5 feet
 thence South 34 Degrees 00 Minutes 37 Seconds East 250.3 feet
 thence South 45 Degrees 39 Minutes 07 Seconds East 256.5 feet
 thence South 48 Degrees 12 Minutes 49 Seconds East 259.2 feet
 thence South 60 Degrees 59 Minutes 26 Seconds East 277.7 feet
 thence South 62 Degrees 41 Minutes 04 Seconds East 300.3 feet
 thence South 62 Degrees 27 Minutes 12 Seconds East 305.1 feet
 thence South 62 Degrees 44 Minutes 33 Seconds East 300.9 feet
 thence South 62 Degrees 41 Minutes 13 Seconds East 293.3 feet
 thence South 62 Degrees 33 Minutes 07 Seconds East 288.5 feet
 thence South 63 Degrees 02 Minutes 29 Seconds East 286.1 feet
 thence South 63 Degrees 12 Minutes 23 Seconds East 280.5 feet
 thence South 62 Degrees 09 Minutes 44 Seconds East 260.5 feet
 thence South 61 Degrees 39 Minutes 45 Seconds East 242.7 feet
 thence South 68 Degrees 05 Minutes 07 Seconds East 116.1 feet
 thence South 68 Degrees 05 Minutes 07 Seconds East 122 feet
 thence South 84 Degrees 55 Minutes 03 Seconds East 260.3 feet
 thence South 88 Degrees 34 Minutes 46 Seconds East 266.8 feet
 thence South 86 Degrees 25 Minutes 04 Seconds East 263.7 feet
 thence South 84 Degrees 14 Minutes 35 Seconds East 265.6 feet
 thence South 85 Degrees 54 Minutes 37 Seconds East 271.8 feet
 thence South 86 Degrees 14 Minutes 44 Seconds East 275.6 feet
 thence South 85 Degrees 48 Minutes 48 Seconds East 290.9 feet
 thence South 82 Degrees 47 Minutes 24 Seconds East 312 feet
 thence South 83 Degrees 30 Minutes 35 Seconds East 317.2 feet
 thence South 83 Degrees 31 Minutes 48 Seconds East 304.3 feet
 thence South 83 Degrees 14 Minutes 51 Seconds East 294.9 feet
 thence South 83 Degrees 32 Minutes 22 Seconds East 288.1 feet
 thence South 82 Degrees 20 Minutes 32 Seconds East 282.9 feet
 thence South 79 Degrees 25 Minutes 00 Seconds East 277 feet
 thence South 78 Degrees 26 Minutes 42 Seconds East 270.5 feet
 thence South 75 Degrees 41 Minutes 14 Seconds East 265.8 feet
 thence South 77 Degrees 10 Minutes 00 Seconds East 259.1 feet
 thence South 79 Degrees 32 Minutes 11 Seconds East 262.5 feet
 thence South 81 Degrees 44 Minutes 50 Seconds East 233.4 feet
 thence South 81 Degrees 44 Minutes 53 Seconds East 19 feet

thence South 81 Degrees 25 Minutes 22 Seconds East 99.4 feet more or less to **the ending point at:** 41 degrees 34 minutes 24.73 seconds North Latitude and -113 degrees 30 minutes 04.44 seconds West Longitude, which can be converted to mapping accuracy State Plane Utah North Zone NAD 83 feet coordinates of X = 1,092,889.0 feet and Y = 3,738,996.7 feet.

Appendix B to Attachment 4

Popular Name: Red Dome Road

County: Box Elder

County Road Number: 83

State Geographic Information Database (SGID) Road Identification Number: RD020148.

Road-Segment Number: 004

Road-Segment Length: 0.2 miles more or less.

Believed owner of the land underlying this road-segment is: Bureau of Land Management.

The following description is based upon the geographic coordinate system using the NAD83 Datum. The source is GPS mapping grade data as indicated in the metadata and/or the transportation data model of the State of Utah Geographic Information Database (SGID).

The road-segment itself is the monument that is identified by its physical presence on the land. The location of said physical presence is closely approximated by mapping grade Global Positioning System (GPS) data. Said data are checked against the corresponding gray-scale 1-meter Digital Orthophoto Quadrangles published by the United States Geological Survey (USGS) to verify a reasonable degree of accuracy. In circumstances where accurate satellite signal acquisition is not possible, such as deep, narrow canyons or under a canopy of dense foliage, or where very sharp curves in the road make accuracy questionable, such portions of the road were digitized from the corresponding gray-scale 1-meter Digital Orthophoto Quadrangles published by the United States Geological Survey (USGS).

This road-segment may traverse:

Township 10 North Range 14 West, Section(s) 30, Salt Lake Base & Meridian

The following description closely approximates the location of the centerline of the physical monument (Red Dome Road)-- Segment 004 based on mapping grade Global Positioning System (GPS) data as defined above:

Beginning at a point on the road center line located at 41 degrees 34 minutes 08.56 seconds North Latitude and -113 degrees 29 minutes 05.48 seconds West Longitude, which can be converted to mapping accuracy State Plane Utah North Zone NAD 83 feet coordinates of X = 1,097,331.1 feet and Y = 3,737,257.8 feet; thence the following courses along the said road center line:

thence South 53 Degrees 41 Minutes 55 Seconds East 209.7 feet

thence South 52 Degrees 37 Minutes 57 Seconds East 246.7 feet

thence South 51 Degrees 57 Minutes 08 Seconds East 237.7 feet

thence South 50 Degrees 53 Minutes 00 Seconds East 110.5 feet

thence South 50 Degrees 24 Minutes 03 Seconds East 107.8 feet

thence South 41 Degrees 56 Minutes 31 Seconds East 120.4 feet more or less to **the ending**

point at: 41 degrees 34 minutes 02.33 seconds North Latitude and -113 degrees 28 minutes 54.75 seconds West Longitude, which can be converted to mapping accuracy State Plane Utah North Zone NAD 83 feet coordinates of X = 1,098,132.6 feet and Y = 3,736,609.4 feet.

Appendix C to Attachment 4

Popular Name: Red Dome Road

County: Box Elder

County Road Number: 83

State Geographic Information Database (SGID) Road Identification Number: RD020148.

Road-Segment Number: 008

Road-Segment Length: 0.63 miles more or less.

Believed owner of the land underlying this road-segment is: Bureau of Land Management.

The following description is based upon the geographic coordinate system using the NAD83 Datum. The source is GPS mapping grade data as indicated in the metadata and/or the transportation data model of the State of Utah Geographic Information Database (SGID).

The road-segment itself is the monument that is identified by its physical presence on the land. The location of said physical presence is closely approximated by mapping grade Global Positioning System (GPS) data. Said data are checked against the corresponding gray-scale 1-meter Digital Orthophoto Quadrangles published by the United States Geological Survey (USGS) to verify a reasonable degree of accuracy. In circumstances where accurate satellite signal acquisition is not possible, such as deep, narrow canyons or under a canopy of dense foliage, or where very sharp curves in the road make accuracy questionable, such portions of the road were digitized from the corresponding gray-scale 1-meter Digital Orthophoto Quadrangles published by the United States Geological Survey (USGS).

This road-segment may traverse:

Township 9 North Range 14 West, Section(s) 3,4,10, Salt Lake Base & Meridian

The following description closely approximates the location of the centerline of the physical monument (Red Dome Road)-- Segment 008 based on mapping grade Global Positioning System (GPS) data as defined above:

Beginning at a point on the road center line located at 41 degrees 32 minutes 24.34 seconds North Latitude and -113 degrees 27 minutes 11.94 seconds West Longitude, which can be converted to mapping accuracy State Plane Utah North Zone NAD 83 feet coordinates of X = 1,105,722.4 feet and Y = 3,726,516.7 feet; thence the following courses along the said road center line:

thence South 68 Degrees 13 Minutes 55 Seconds East	10.7 feet
thence South 68 Degrees 13 Minutes 59 Seconds East	60.1 feet
thence South 76 Degrees 08 Minutes 45 Seconds East	173.9 feet
thence South 72 Degrees 25 Minutes 44 Seconds East	181.3 feet
thence South 68 Degrees 01 Minutes 51 Seconds East	185.8 feet
thence South 70 Degrees 51 Minutes 17 Seconds East	186.9 feet
thence South 73 Degrees 26 Minutes 44 Seconds East	185.1 feet
thence South 67 Degrees 36 Minutes 55 Seconds East	166.4 feet
thence South 46 Degrees 23 Minutes 09 Seconds East	203.2 feet
thence South 57 Degrees 01 Minutes 43 Seconds East	206.1 feet
thence South 63 Degrees 57 Minutes 10 Seconds East	188.2 feet
thence South 64 Degrees 11 Minutes 33 Seconds East	201 feet

thence South 60 Degrees 16 Minutes 15 Seconds East 216.1 feet
thence South 54 Degrees 23 Minutes 24 Seconds East 212.3 feet
thence South 47 Degrees 51 Minutes 04 Seconds East 206.4 feet
thence South 43 Degrees 12 Minutes 49 Seconds East 212.6 feet
thence South 50 Degrees 28 Minutes 44 Seconds East 220.1 feet
thence South 48 Degrees 19 Minutes 14 Seconds East 223 feet
thence South 47 Degrees 41 Minutes 33 Seconds East 69.6 feet more or less to **the ending**

point at: 41 degrees 32 minutes 08.65 seconds North Latitude and -113 degrees 26 minutes 34.58 seconds West Longitude, which can be converted to mapping accuracy State Plane Utah North Zone NAD 83 feet coordinates of X = 1,108,526.8 feet and Y = 3,724,865.2 feet.

Appendix D to Attachment 4

Popular Name: Red Dome Road

County: Box Elder

County Road Number: 83

State Geographic Information Database (SGID) Road Identification Number: RD020148.

Road-Segment Number: 010

Road-Segment Length: 0.4 miles more or less.

Believed owner of the land underlying this road-segment is: Bureau of Land Management.

The following description is based upon the geographic coordinate system using the NAD83 Datum. The source is GPS mapping grade data as indicated in the metadata and/or the transportation data model of the State of Utah Geographic Information Database (SGID).

The road-segment itself is the monument that is identified by its physical presence on the land. The location of said physical presence is closely approximated by mapping grade Global Positioning System (GPS) data. Said data are checked against the corresponding gray-scale 1-meter Digital Orthophoto Quadrangles published by the United States Geological Survey (USGS) to verify a reasonable degree of accuracy. In circumstances where accurate satellite signal acquisition is not possible, such as deep, narrow canyons or under a canopy of dense foliage, or where very sharp curves in the road make accuracy questionable, such portions of the road were digitized from the corresponding gray-scale 1-meter Digital Orthophoto Quadrangles published by the United States Geological Survey (USGS).

This road-segment may traverse:

Township 10 North Range 14 West, Section(s) 34, Salt Lake Base & Meridian

The following description closely approximates the location of the centerline of the physical monument (Red Dome Road)-- Segment 010 based on mapping grade Global Positioning System (GPS) data as defined above:

Beginning at a point on the road center line located at 41 degrees 32 minutes 24.04 seconds North Latitude and -113 degrees 25 minutes 44.46 seconds West Longitude, which can be converted to mapping accuracy State Plane Utah North Zone NAD 83 feet coordinates of X = 1,112,372.2 feet and Y = 3,726,337.2 feet; thence the following courses along the said road center line:

thence North 27 Degrees 09 Minutes 28 Seconds East	15.1 feet
thence North 30 Degrees 05 Minutes 41 Seconds East	121.7 feet
thence North 55 Degrees 41 Minutes 50 Seconds East	152.7 feet
thence North 52 Degrees 16 Minutes 18 Seconds East	159.4 feet
thence North 48 Degrees 35 Minutes 26 Seconds East	152.3 feet
thence North 45 Degrees 42 Minutes 53 Seconds East	151.3 feet
thence North 49 Degrees 22 Minutes 50 Seconds East	152.2 feet
thence North 48 Degrees 00 Minutes 59 Seconds East	150.6 feet
thence North 43 Degrees 31 Minutes 47 Seconds East	141.1 feet
thence North 40 Degrees 38 Minutes 34 Seconds East	139.1 feet
thence North 42 Degrees 55 Minutes 08 Seconds East	137.4 feet
thence North 34 Degrees 20 Minutes 46 Seconds East	125.7 feet

thence North 34 Degrees 12 Minutes 23 Seconds East 103.5 feet

thence North 37 Degrees 11 Minutes 05 Seconds East 103.4 feet

thence North 52 Degrees 37 Minutes 04 Seconds East 108.9 feet

thence North 49 Degrees 12 Minutes 20 Seconds East 111.2 feet

thence North 28 Degrees 09 Minutes 21 Seconds East 104.5 feet more or less to **the ending**

point at: 41 degrees 32 minutes 39.37 seconds North Latitude and -113 degrees 25 minutes 25.67 seconds West Longitude, which can be converted to mapping accuracy State Plane Utah North Zone NAD 83 feet coordinates of X = 1,113,835.2 feet and Y = 3,727,856.8 feet.

Appendix E to Attachment 4

Popular Name: Red Dome Road

County: Box Elder

County Road Number: 83

State Geographic Information Database (SGID) Road Identification Number: RD020148.

Road-Segment Number: 012

Road-Segment Length: 0.1 miles more or less.

Believed owner of the land underlying this road-segment is: Bureau of Land Management.

The following description is based upon the geographic coordinate system using the NAD83 Datum. The source is GPS mapping grade data as indicated in the metadata and/or the transportation data model of the State of Utah Geographic Information Database (SGID).

The road-segment itself is the monument that is identified by its physical presence on the land. The location of said physical presence is closely approximated by mapping grade Global Positioning System (GPS) data. Said data are checked against the corresponding gray-scale 1-meter Digital Orthophoto Quadrangles published by the United States Geological Survey (USGS) to verify a reasonable degree of accuracy. In circumstances where accurate satellite signal acquisition is not possible, such as deep, narrow canyons or under a canopy of dense foliage, or where very sharp curves in the road make accuracy questionable, such portions of the road were digitized from the corresponding gray-scale 1-meter Digital Orthophoto Quadrangles published by the United States Geological Survey (USGS).

This road-segment may traverse:

Township 10 North Range 14 West, Section(s) 34, Salt Lake Base & Meridian

The following description closely approximates the location of the centerline of the physical monument (Red Dome Road)-- Segment 012 based on mapping grade Global Positioning System (GPS) data as defined above:

Beginning at a point on the road center line located at 41 degrees 32 minutes 42.69 seconds North Latitude and -113 degrees 25 minutes 25.71 seconds West Longitude, which can be converted to mapping accuracy State Plane Utah North Zone NAD 83 feet coordinates of X = 1,113,840.0 feet and Y = 3,728,193.4 feet; thence the following courses along the said road center line:

thence North 14 Degrees 30 Minutes 37 Seconds West 102.9 feet

thence North 14 Degrees 26 Minutes 08 Seconds West 152.2 feet

thence North 09 Degrees 08 Minutes 26 Seconds East 171.3 feet

thence North 21 Degrees 16 Minutes 17 Seconds East 120.2 feet more or less to **the ending**

point at: 41 degrees 32 minutes 47.91 seconds North Latitude and -113 degrees 25 minutes 25.77 seconds West Longitude, which can be converted to mapping accuracy State Plane Utah North Zone NAD 83 feet coordinates of X = 1,113,847.1 feet and Y = 3,728,721.5 feet.

Appendix F to Attachment 4

Popular Name: Red Dome Road

County: Box Elder

County Road Number: 83

State Geographic Information Database (SGID) Road Identification Number: RD020148.

Road-Segment Number: 014

Road-Segment Length: 0.04 miles more or less.

Believed owner of the land underlying this road-segment is: Bureau of Land Management.

The following description is based upon the geographic coordinate system using the NAD83 Datum. The source is GPS mapping grade data as indicated in the metadata and/or the transportation data model of the State of Utah Geographic Information Database (SGID).

The road-segment itself is the monument that is identified by its physical presence on the land. The location of said physical presence is closely approximated by mapping grade Global Positioning System (GPS) data. Said data are checked against the corresponding gray-scale 1-meter Digital Orthophoto Quadrangles published by the United States Geological Survey (USGS) to verify a reasonable degree of accuracy. In circumstances where accurate satellite signal acquisition is not possible, such as deep, narrow canyons or under a canopy of dense foliage, or where very sharp curves in the road make accuracy questionable, such portions of the road were digitized from the corresponding gray-scale 1-meter Digital Orthophoto Quadrangles published by the United States Geological Survey (USGS).

This road-segment may traverse:

Township 10 North Range 14 West, Section(s) 35, Salt Lake Base & Meridian

The following description closely approximates the location of the centerline of the physical monument (Red Dome Road)-- Segment 014 based on mapping grade Global Positioning System (GPS) data as defined above:

Beginning at a point on the road center line located at 41 degrees 33 minutes 01.05 seconds North Latitude and -113 degrees 24 minutes 32.52 seconds West Longitude, which can be converted to mapping accuracy State Plane Utah North Zone NAD 83 feet coordinates of X = 1,117,924.1 feet and Y = 3,729,962.4 feet; thence the following courses along the said road center line:

thence South 74 Degrees 04 Minutes 21 Seconds East 211.4 feet more or less to **the ending point at:** 41 degrees 33 minutes 00.53 seconds North Latitude and -113 degrees 24 minutes 29.83 seconds West Longitude, which can be converted to mapping accuracy State Plane Utah North Zone NAD 83 feet coordinates of X = 1,118,127.4 feet and Y = 3,729,904.3 feet.