

**Acknowledgment and  
Notice of Acknowledgment  
of Acceptance of R.S. 2477  
Right-of-Way Grant**

**THE STATE OF UTAH**

**TO ALL WHOM THESE PRESENTS SHALL COME, Greeting:**

**Know ye,** This is an Acknowledgment and Notice of Acknowledgment made under Utah Code § 72-5-309 through 310 inclusive that the grant of the United States of America of “the right of way for the construction of highways over public lands, not reserved for public uses” under United States Revised Statutes 2477 (43 U.S.C. § 932 (repealed October 21, 1976, with proviso recognizing the validity of rights-of-way already established)) was accepted for and on behalf of the State of Utah and its political subdivision Box Elder County as it pertains to the highway located in Box Elder County known as Old Railroad Grade; County Road Number: 12.1; State Geographic Information Database (SGID) Road Identification Number: RD020027. Total road length is 14.18 miles more or less.

The reasons for this acknowledgment are as follows (indicated by an “X” in one or more blocks and any supplemental comment):

- The road was laid out or erected for public use over public lands not reserved for public uses prior to the earlier of (a) the October 21, 1976 repeal of R.S. 2477 or (b) the date the servient estate was reserved for public uses;
- By reason of its continuous use as a public highway over public lands not reserved for public uses for a period of at least ten years prior to the earlier of (a) the October 21, 1976 repeal of R.S. 2477 or (b) the date the servient estate was reserved for public uses;
- Other (explain).

A printed copy of a map showing the location of the road in said county is appended hereto as “Attachment 1.” A printed copy of photos of the road is appended hereto as “Attachment 2.” A printed copy of a description of the beginning and ending points of the entire road together with a list of Townships, Ranges and Sections that may be traversed by the road in said county is appended hereto as “Attachment 3.” A printed copy of the Road Centerline Description Cover Page(s) is appended hereto as “Attachment 4.” The Appendices referenced in “Attachment 4” that contain the actual road centerline descriptions are incorporated herein by reference.

A printed copy of this Acknowledgment and Notice of Acknowledgment, together with its Attachments and Appendices, may be viewed and/or obtained at the office of the Utah State Archives.

An electronic copy of this Acknowledgment and Notice of Acknowledgment, together with its Attachments and Appendices referenced in the Attachments, may be viewed and/or downloaded as read-only PDF (Portable



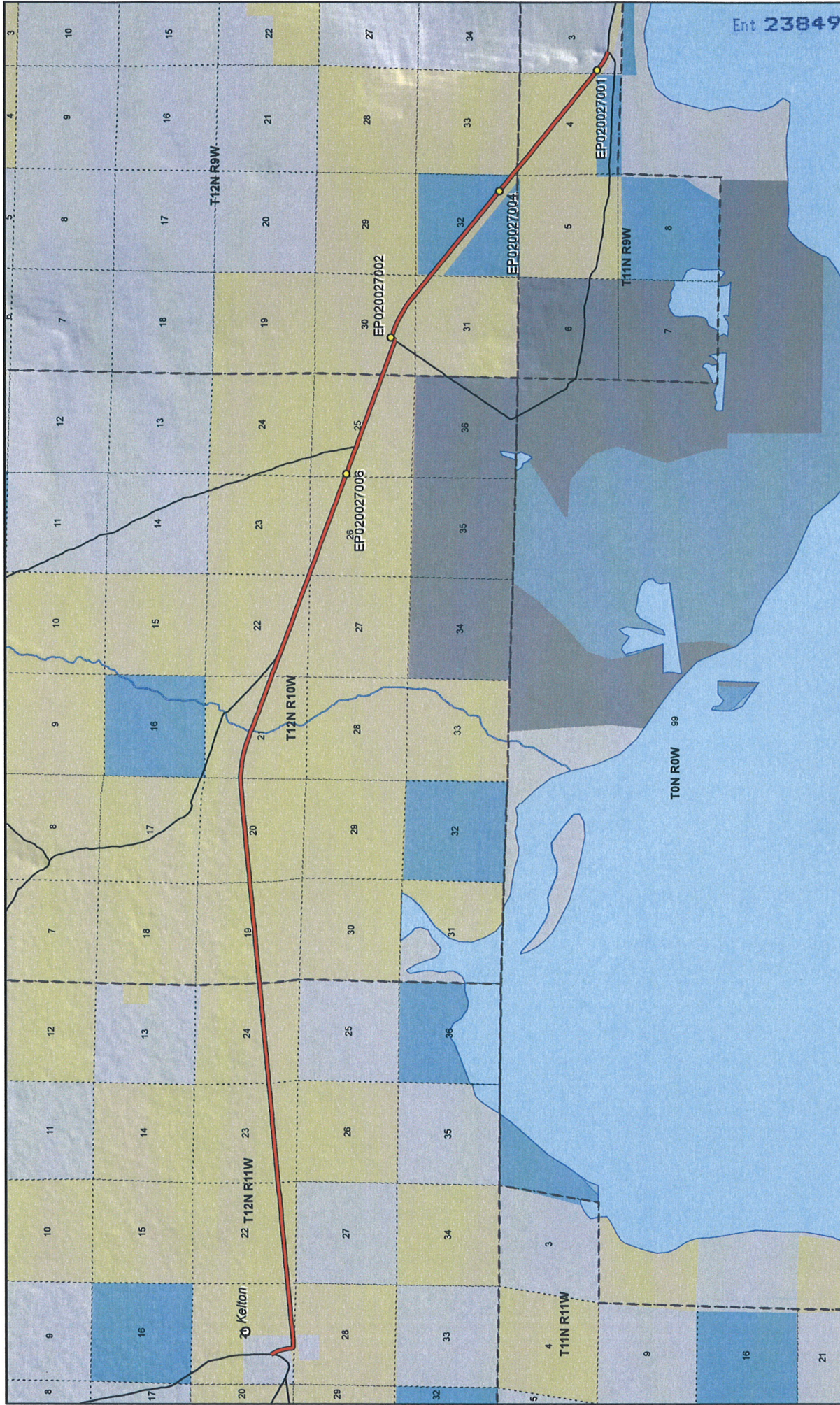

Ent 238494 Bk 988 Pg 545

Map prepared by the State of Utah  
Automated Geographic Reference Center  
Room 5130 State Office Building  
Salt Lake City, Utah 84114  
Nov 09, 2006



**Old Railroad Grade - Box Elder County**  
**SGID RD\_ID RD020027**

- |                            |   |
|----------------------------|---|
| Wilderness                 | Old Railroad Grade                                      |
| UDWR Wildlife Reserve      | Other Roads   |
| DOD, Military              | Title V, Issued Or Under Consideration By BLM Or County |
| State Sovereign Land       | Photo Event Point                                       |
| National Recreation Area   | Section = 1 Mile  |
| Tribal, Indian Reservation |   |
| NPS, National Park         |   |

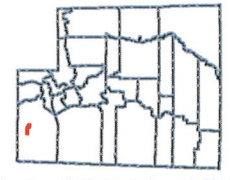

1:84,215  
1 inch equals 1.3 miles



EP020027001



EP020027002



EP020027004



EP020027006

EP000000000

EP000000000

*Old Railroad Grade - Box Elder County  
SGID RD\_ID RD020027*

Map prepared by the State of Utah  
Automated Geographic Reference Center  
Room 5130 State Office Building  
Salt Lake City, Utah 84114  
November 9, 2006



### Attachment 3

#### Beginning & Ending Points and Township, Range, and Section References For:

**Popular Name: Old Railroad Grade**

**County: Box Elder**

**County Road Number: 12.1**

**State Geographic Information Database (SGID) Road Identification Number: RD020027.**

**Total Road Length: 14.18 miles more or less.**

**Beginning at a point** on the road centerline located at 41 degrees 44 minutes 56.76 seconds North Latitude and -113 degrees 06 minutes 27.75 seconds West Longitude, which can be converted to mapping accuracy State Plane Utah North Zone NAD 83 feet coordinates of X = 1,201,725.2 feet and Y = 3,800,723.6 feet based on the US Survey Foot conversion.

**Ending at a point** on the road centerline located at 41 degrees 42 minutes 16.15 seconds North Latitude and -112 degrees 51 minutes 19.95 seconds West Longitude, which can be converted to mapping accuracy State Plane Utah North Zone NAD 83 feet coordinates of X = 1,270,273.3 feet and Y = 3,783,295.2 feet based on the US Survey Foot conversion.

This road may traverse:

Township 11 North Range 9 West, Section(s) 3,4, Salt Lake Base & Meridian

Township 12 North Range 10 West, Section(s) 19,20,21,22,23,25,26, Salt Lake Base & Meridian

Township 12 North Range 11 West, Section(s) 21,22,23,24, Salt Lake Base & Meridian

Township 12 North Range 9 West, Section(s) 30,31,32,33, Salt Lake Base & Meridian

See Attachment 1 above for a cartographic depiction of the course of this road.

**Attachment 4**  
**Road Centerline Description Cover Page(s)**

**Popular Name: Old Railroad Grade**

**County: Box Elder**

**County Road Number: 12.1**

**State Geographic Information Database (SGID) Road Identification Number: RD020027.**

**Total Road Length: 14.18 miles more or less.**

**Centerline Descriptions Of Road-Segments That Cross Over Federally Owned Land, Derived From Global Positioning System Data And Cross-checked against USGS Digital Orthophoto Quadrangles Compiled By The Utah Automated Geographic Reference Center And Entered Into The State Geographic Information Database (SGID).**

<b>Road-Segments Listed by SGID Road Identification Number (RD_ID)</b>	<b>Road-Segment Numbers</b>	<b>Believed Ownership Of Servient Estate</b>	<b>Approximate Segment Length</b>	<b>See Attached Appendix</b>
<b>RD020027</b>	<b>001</b>	<b>PVT</b>	<b>0.2 Miles</b>	<b>(not shown)</b>
<b>RD020027</b>	<b>002</b>	<b>BLM</b>	<b>11.15 Miles</b>	<b>A</b>
<b>RD020027</b>	<b>003</b>	<b>ST</b>	<b>0.9 Miles</b>	<b>(not shown)</b>
<b>RD020027</b>	<b>004</b>	<b>BLM</b>	<b>1.93 Miles</b>	<b>B</b>
		<b>Total Road Length</b>	<b>14.18</b>	<b>—————</b>

\* Indicates that a Title V permit will be requested, is in process, or has been issued.

† Indicates that road-segments crossing Forest Service land are under consideration by the state and county as of the date of this Acknowledgment and Notice of Acknowledgment.