

**Acknowledgment and  
Notice of Acknowledgment  
of Acceptance of R.S. 2477  
Right-of-Way Grant**

Ent 023884 Bk 68 Pg 267  
Date: 11-JUN-2008 9:45AM  
Fee: None  
Filed By: KP  
KERT PALLESEN, Recorder  
DAGGETT COUNTY  
For: GOVERNOR STATE OF UTAH

**THE STATE OF UTAH**

**TO ALL WHOM THESE PRESENTS SHALL COME, Greeting:**

**Know ye,** This is an Acknowledgment and Notice of Acknowledgment made under Utah Code Sections 72-5-309 through 310 inclusive, that the grant of the United States of America of “the right of way for the construction of highways over public lands, not reserved for public uses” under United States Revised Statutes 2477 (43 U.S.C. Section 932 (repealed October 21, 1976, with proviso recognizing the validity of rights-of-way already established)) was accepted for and on behalf of the State of Utah and its political subdivision Daggett County as it pertains to the highway located in Daggett County known as Red Creek Road; County Road Number: B25; State Geographic Information Database (SGID) Road Identification Number: RD050011. Total road length is 5.09 miles more or less.

The reason for this Acknowledgment and Notice of Acknowledgment includes, but is not limited to, the fact that the road was constructed, mechanically, or by continuous use as a public highway for a period of at least ten years, over public lands not reserved for public uses, prior to the earlier of (a) the October 21, 1976 repeal of R.S. 2477 or (b) the date the servient estate was reserved for public uses.

This Acknowledgment and Notice of Acknowledgment applies only to the segments of the road that traverse land owned by the Bureau of Land Management, United States Department of the Interior, and does not apply to segments of the road that traverse land owned by any other person or entity. The State of Utah and its political subdivisions reserve the right to make further acknowledgments and notices of acknowledgment with regard to road segments that traverse land owned by other entities, including the United States of America, through one or more of its agencies.

A printed copy of a map showing the location of the road in said county is appended hereto as “Attachment 1,” a printed copy of representative photos of the road is appended hereto as “Attachment 2,” a printed copy of a description of the beginning and ending points of the entire road together with a list of Townships, Ranges and Sections that may be traversed by the road in said county is appended hereto as “Attachment 3,” and a printed copy of the Road Centerline Description Cover Page(s) is appended hereto as “Attachment 4.” The Appendices listed in “Attachment 4” that contain the actual road centerline descriptions are incorporated herein by reference. Affidavits provided by individuals familiar with the road are appended hereto as “Attachment 5.”

A printed copy of this Acknowledgment and Notice of Acknowledgment, together with its Attachments and Appendices, may be viewed and/or obtained at the office of the Utah State Archives.

An electronic copy of this Acknowledgment and Notice of Acknowledgment, together with its Attachments and Appendices, may be viewed and/or downloaded as read-only PDF (Portable Document Format) files via the

Internet at <http://recorded2477roads.utah.gov>.

The owner of the servient estate in the land underlying the road-segments subject to this Acknowledgment and Notice is believed to be the United States of America through one or more of its agencies. Any of such agencies or any other person with a servient ownership claim or a competing dominant estate right-of-way ownership claim, may file a petition in the State District Court for Salt Lake County for a decision regarding the correctness of this Acknowledgment. A claimant shall file a petition within sixty (60) days after receipt of this Notice.

**In Witness Whereof**, I, John Harja, the official designee of the Governor of the State of Utah, in conformity to the laws of the State (Utah Code Sections 72-5-308 through 310 inclusive), have caused this Acknowledgment and Notice of Acknowledgment to be made.

Signed by my hand in Salt Lake City, Utah, the 5<sup>th</sup> day of June, 2008.

By the Governor's Designee

  
\_\_\_\_\_  
John Harja

**CERTIFICATION**

State of Utah                    )  
  : ss  
County of Salt Lake         )

I hereby certify that the signer of the foregoing document, John Harja, is personally known by me, has made a voluntary signature and taken an oath stating that he is the official designee of the Governor of the State of Utah and is authorized to sign this document on the Governor's behalf pursuant to Utah Code Section 72-5-309. He further vouched that, based upon information and belief, the facts alleged therein are true.

Dated this 5<sup>th</sup> day of June, 2008.



  
\_\_\_\_\_  
Notary Public





1:31,728  
1 inch equals 0.5 miles



### Red Creek Road - Daggett County

#### SGID RD\_ID RD050011

Map prepared by the State of Utah  
Automated Geographic Reference Center  
Room 5130 State Office Building  
Salt Lake City, Utah 84114  
Jun 05, 2008



<p><b>Land Ownership Categories</b></p> <ul style="list-style-type: none"> <li>BLM</li> <li>Private</li> <li>SITLA, State Trust Land</li> <li>USFS, National Forest</li> <li>State Parks and Recreation</li> <li>Tribal, Indian Reservation</li> <li>NPS, National Park</li> </ul>	<p><b>Transportation Network</b></p> <ul style="list-style-type: none"> <li>Red Creek Road</li> <li>Other Roads</li> <li>Title V, Issued Or Under Consideration By BLM Or County</li> <li>Photo Event Point</li> <li>Section = 1 Mile</li> </ul>
--	--

Attachment 2



EP050011001



EP050011013



EP050011014

EP000000000

EP000000000

EP000000000

**Red Creek Road - Daggett County**  
**SGID RD\_ID RD050011**

Map prepared by the State of Utah  
Automated Geographic Reference Center  
Room 5130 State Office Building  
Salt Lake City, Utah 84114  
June 05, 2008



## Attachment 3

### Beginning & Ending Points and Township, Range, and Section References For:

**Popular Name: Red Creek Road**

**County: Daggett**

**County Road Number: B25**

**State Geographic Information Database (SGID) Road Identification Number: RD050011.**

**Total Road Length: 5.09 miles more or less.**

**Beginning at a point** on the road centerline located at 40 degrees 55 minutes 32.77 seconds North Latitude and -109 degrees 13 minutes 37.34 seconds West Longitude, which can be converted to mapping accuracy State Plane Utah North Zone NAD 83 feet coordinates of X = 2,268,444.7 feet and Y = 3,504,891.6 feet based on the US Survey Foot conversion.

**Ending at a point** on the road centerline located at 40 degrees 54 minutes 14.35 seconds North Latitude and -109 degrees 08 minutes 46.15 seconds West Longitude, which can be converted to mapping accuracy State Plane Utah North Zone NAD 83 feet coordinates of X = 2,291,003.4 feet and Y = 3,497,552.9 feet based on the US Survey Foot conversion.

This road may traverse:

Township 2 North Range 24 East, Section(s) 8,9,13,15,16,22,23,24, Salt Lake Base & Meridian  
See Attachment 1 above for a cartographic depiction of the course of this road.

**Attachment 4  
Road Centerline Description Cover Page(s)**

**Popular Name: Red Creek Road**

**County: Daggett**

**County Road Number: B25**

**State Geographic Information Database (SGID) Road Identification Number: RD050011.**

**Total Road Length: 5.09 miles more or less.**

**Centerline Descriptions Of Road-Segments That Cross Over Federally Owned Land, Derived From Global Positioning System Data And Cross-checked against USGS Digital Orthophoto Quadrangles Compiled By The Utah Automated Geographic Reference Center And Entered Into The State Geographic Information Database (SGID).**

<b>Road-Segments Listed by SGID Road Identification Number (RD_ID)</b>	<b>Road-Segment Numbers</b>	<b>Believed Ownership Of Servient Estate</b>	<b>Approximate Segment Length</b>	<b>See Attached Appendix</b>
<b>RD050011</b>	<b>001</b>	<b>BLM</b>	<b>0.14 Miles</b>	<b>A</b>
<b>RD050011</b>	<b>002</b>	<b>ST</b>	<b>0.28 Miles</b>	<b>(not shown)</b>
<b>RD050011</b>	<b>003</b>	<b>BLM</b>	<b>0.79 Miles</b>	<b>B</b>
<b>RD050011</b>	<b>004</b>	<b>ST</b>	<b>0.48 Miles</b>	<b>(not shown)</b>
<b>RD050011</b>	<b>005</b>	<b>BLM</b>	<b>3.2 Miles</b>	<b>C</b>
<b>RD050011</b>	<b>006</b>	<b>ST</b>	<b>0.21 Miles</b>	<b>(not shown)</b>
		<b>Total Road Length</b>	<b>5.09</b>	<b>—————</b>

\* Indicates that a Title V permit will be requested, is in process, or has been issued.

† Indicates that road-segments crossing Forest Service land are under consideration by the state and county as of the date of this Acknowledgment and Notice of Acknowledgment.

## Attachment 5

**AFFIDAVIT OF ALEXANDER S. RADOSEVICH**

**RED CREEK ROAD**

**DAGGETT COUNTY, UTAH**

**ROAD NUMBER B25**

State of Utah                    )  
  : ss.  
County of Daggett            )

ALEXANDER S. RADOSEVICH, being first duly sworn, deposes and states as follows:

1. I am an adult competent to testify about the matters set forth below based upon my personal knowledge. I currently reside in Daggett County, Utah. I was born in Rock Springs, Wyoming in 1935, have lived in the Three Corners area of Northeastern Utah, Southern Wyoming and Northwestern Colorado all of my life, and currently at the Willow Creek Ranch in Brown’s Park, Daggett County, Utah.

2. I have traveled and am familiar with a road in Daggett County known as Red Creek Road. I am also familiar with the land the road traverses. When I first used and observed the road in 1941, it followed the same route as in 2007, when I last observed it. Attached is a Daggett County map showing Red Creek Road. To the best of my knowledge and based upon my use of and familiarity with this road and the land it traverses, the location and route of the road are correctly illustrated on the attached map.

3. I am informed that the County also identifies this road according to the road number listed above.

4. I have observed that the road has been open to the public for all to use, to come and go as they pleased, since at least as early as 1941 and continuing through 1976 to 2007. Throughout this time period, I observed travel on the road by means of horseback, cars,



recreational vehicles, motorcycles and trucks of all sizes. Throughout this time period, the road has been used weekly, weather permitting, for more than ten continuous years prior to 1976, and was so used in 2007.

5. Throughout the time period from 1941 to 2007, I have used the road myself to travel in and through the area, hunting, livestock operations, and recreation.

6. Throughout the time period described the previous paragraph, I have observed other vehicles from the general public using the road at various times for the uses described in the previous paragraph, plus government access, pipeline access, utility access and fishing.

7. It is also the reputation in the community that this road has been open to the public for all to use, to come and go as they pleased, since at least as early as the early 1900s and continuing through 1976 to the present, for the uses described in the previous paragraphs.

8. Prior to 1976, I observed construction and maintenance activities on the road including grading.

DATED this 8 day of April, 2008.

  
Alexander S. Radosevich

SUBSCRIBED AND SWORN to before me this 8<sup>th</sup> day of April, 2008.

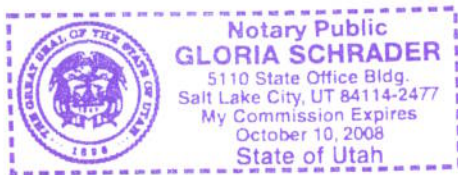

  
NOTARY PUBLIC

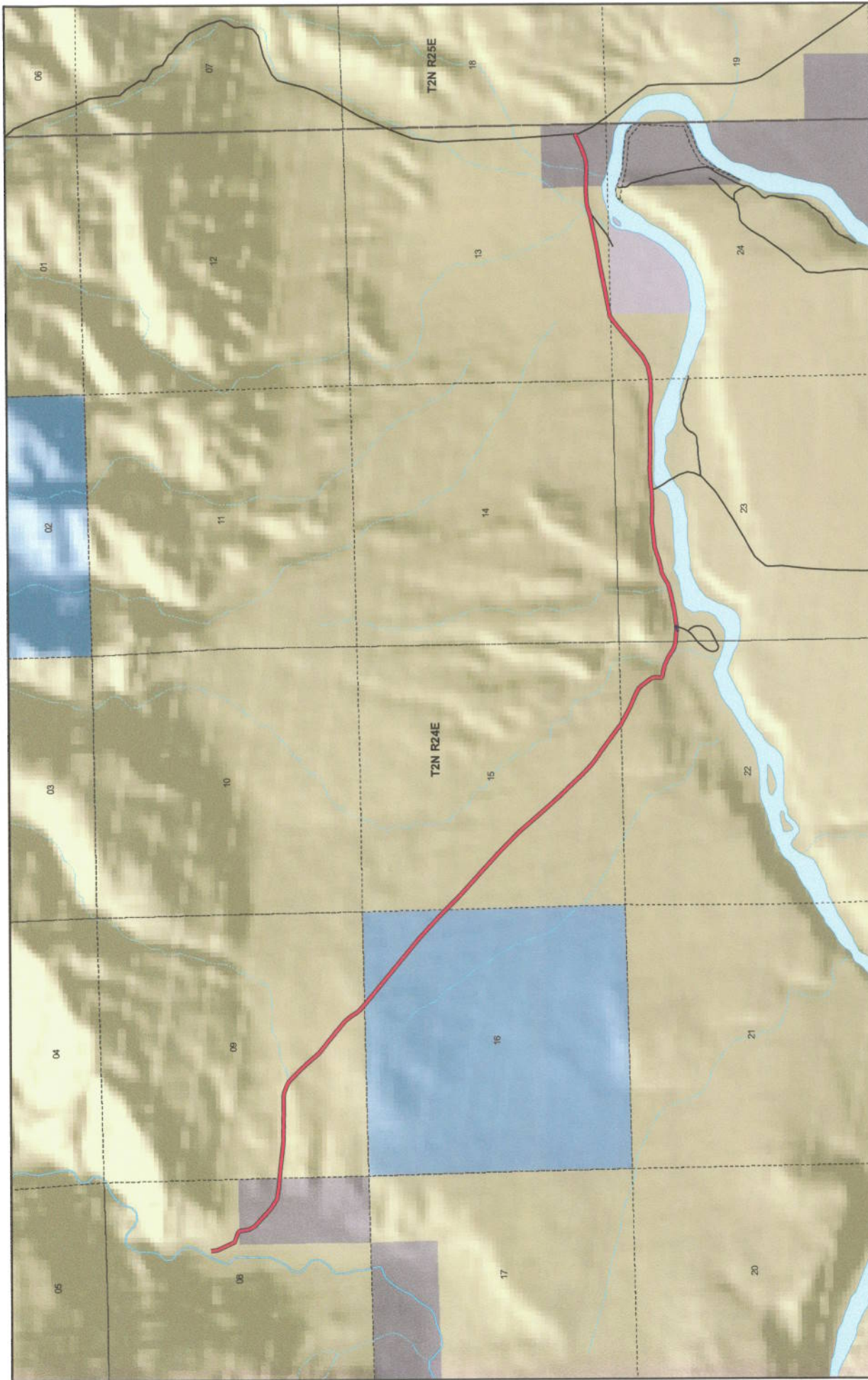

**Daggett County**  
**RED CREEK ROAD**  
**County Unique - B25**

**Land Ownership Categories**

- BLM
- USFS, National Forest
- SITLA, State Trust Land
- National Recreation Area

**Transportation Network**

- RED CREEK ROAD
- State / U.S. Highway
- Local Roads

**Misc**

- City / Town
- Municipalities
- Section = 1 Mile

**Misc**

- Wildlife Reserve
- Private

1:31,728  
1 inch equals 0.5 miles

Map prepared by the State of Utah  
Administrative Geographic Information Center  
AGRC  
Room 5130 State Office Building  
Salt Lake City, Utah 84114  
Apr 02, 2006

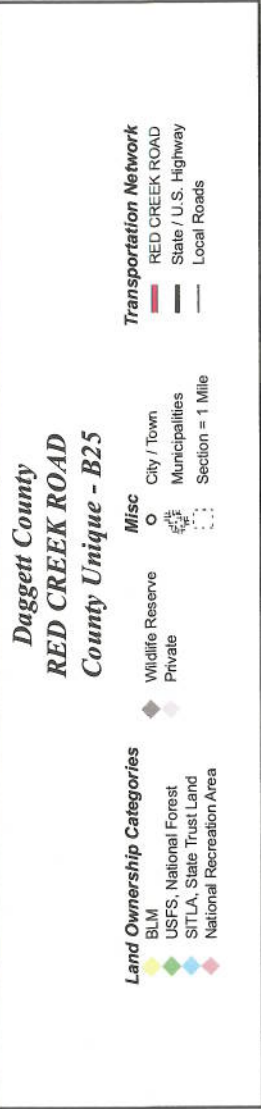

**AFFIDAVIT OF GENE BRIGGS**

**RED CREEK ROAD**

**DAGGETT COUNTY, UTAH**

**ROAD NUMBER B25**

State of Utah                    )  
  : ss.  
County of Daggett            )

GENE BRIGGS, being first duly sworn, deposes and states as follows:

1. I am an adult competent to testify about the matters set forth below based upon my personal knowledge. I currently reside in Daggett County, Utah. I have lived in Daggett County for 55 years. I was employed by the Daggett County Road Department from approximately 1963 to 1965. I was employed as the Daggett County Clerk, Auditor, Recorder and Treasurer from 1967 to 1994.

2. I have traveled and am familiar with a road in Daggett County known as Red Creek Road. I am also familiar with the land the road traverses. When I first used and observed the road in 1963, it followed the same route as in 2007, when I last observed it. Attached is a Daggett County map showing Red Creek Road. To the best of my knowledge and based upon my use of and familiarity with this road and the land it traverses, the location and route of the road are correctly illustrated on the attached map.

3. I am informed that the County also identifies this road according to the road number listed above.

4. I have observed that the road has been open to the public for all to use, to come and go as they pleased, since at least as early as 1963 and continuing through 1976 to 2007. Throughout this time period, I observed travel on the road by means of cars, recreational

vehicles, jeeps, motorcycles, ATVs, horses, pickup trucks, commercial trucks, road maintenance vehicles and snowmobiles. Throughout this time period, the road has been used daily, for more than ten continuous years prior to 1976, and was so used in 2007.

5. Throughout the time period from 1963 to 2007, I have used the road myself for road maintenance, camping, fishing, government access, travel in and through the area and recreation.

6. Throughout the time period described the previous paragraph, I have observed other vehicles from the general public using the road at various times for the uses described in the previous paragraph, plus, residential access, museum access, mail delivery, livestock operations, hunting and farming.

7. It is also the reputation in the community that this road has been open to the public for all to use, to come and go as they pleased, since at least as early as the early 1900s and continuing through 1976 to the present, for the uses described in the previous paragraphs.

8. Prior to 1976, I personally maintained this road.

DATED this 8<sup>th</sup> day of April, 2008.

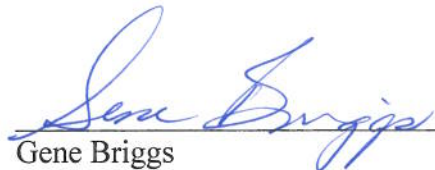
  
Gene Briggs

SUBSCRIBED AND SWORN to before me this 8<sup>th</sup> day of April, 2008.

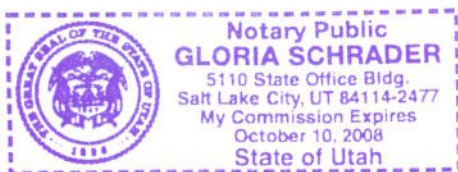

  
NOTARY PUBLIC

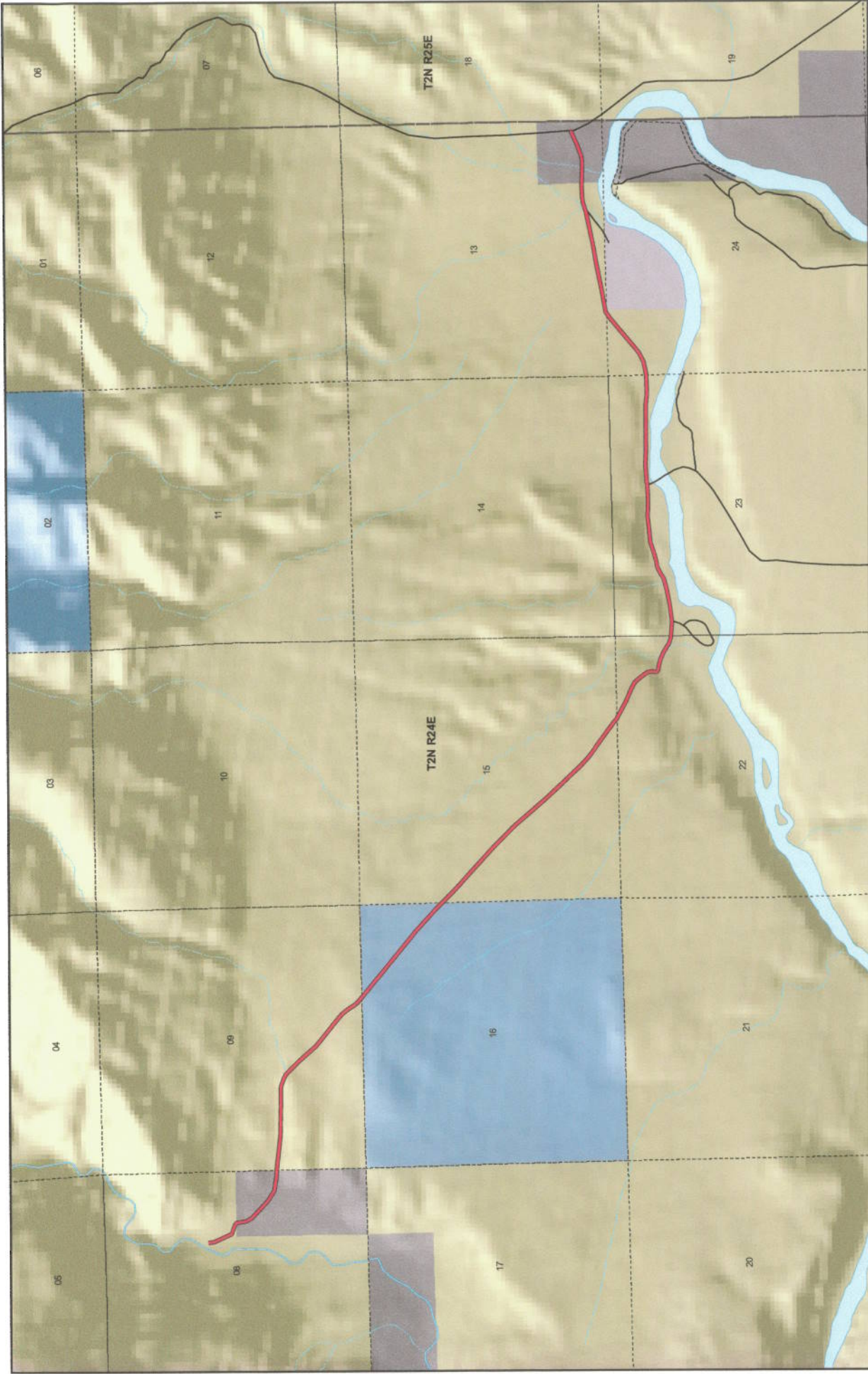

1:31,728  
1 inch equals 0.5 miles



Map prepared by the State of Utah  
Automated Geographic Information Center  
AGRC  
Room 4130 State Office Building  
Salt Lake City, Utah 84114  
Apr 02, 2008



**Daggett County**  
**RED CREEK ROAD**  
**County Unique - B25**

**Transportation Network**  
 RED CREEK ROAD  
 State / U.S. Highway  
 Local Roads

**Misc**  
 City / Town  
 Municipalities  
 Section = 1 Mile

**Land Ownership Categories**  
 BLM  
 USFS, National Forest  
 SITLA, State Trust Land  
 National Recreation Area

**Wildlife Reserve**  
 Private

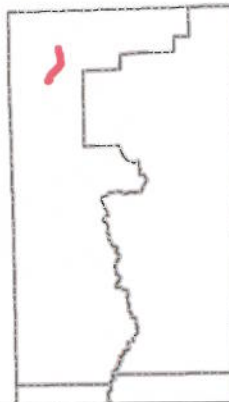

## Appendix A to Attachment 4

**Popular Name: Red Creek Road**

**County: Daggett**

**County Road Number: B25**

**State Geographic Information Database (SGID) Road Identification Number: RD050011.**

**Road-Segment Number: 001**

**Road-Segment Length: 0.14 miles more or less.**

**Believed owner of the land underlying this road-segment is: Bureau of Land Management.**

*The following description is based upon the geographic coordinate system using the NAD83 Datum. The source is GPS mapping grade data as indicated in the metadata and/or the transportation data model of the State of Utah Geographic Information Database (SGID).*

The road-segment itself is the monument that is identified by its physical presence on the land. The location of said physical presence is closely approximated by mapping grade Global Positioning System (GPS) data. Said data are checked against the corresponding gray-scale 1-meter Digital Orthophoto Quadrangles published by the United States Geological Survey (USGS) to verify a reasonable degree of accuracy. In circumstances where accurate satellite signal acquisition is not possible, such as deep, narrow canyons or under a canopy of dense foliage, or where very sharp curves in the road make accuracy questionable, such portions of the road were digitized from the corresponding gray-scale 1-meter Digital Orthophoto Quadrangles published by the United States Geological Survey (USGS).

This road-segment may traverse:

Township 2 North Range 24 East, Section(s) 8, Salt Lake Base & Meridian

The following description closely approximates the location of the centerline of the physical monument (Red Creek Road)-- Segment 001 based on mapping grade Global Positioning System (GPS) data as defined above:

**Beginning at a point** on the road center line located at 40 degrees 55 minutes 32.77 seconds North Latitude and -109 degrees 13 minutes 37.34 seconds West Longitude, which can be converted to mapping accuracy State Plane Utah North Zone NAD 83 feet coordinates of X = 2,268,444.7 feet and Y = 3,504,891.6 feet; thence the following courses along the said road center line:

thence South 05 Degrees 34 Minutes 28 Seconds East 118.6 feet

thence South 25 Degrees 17 Minutes 46 Seconds East 392.7 feet

thence South 66 Degrees 55 Minutes 52 Seconds East 202.4 feet

thence South 44 Degrees 01 Minutes 59 Seconds East 15.3 feet more or less to **the ending**

**point at:** 40 degrees 55 minutes 27.11 seconds North Latitude and -109 degrees 13 minutes 32.64 seconds West Longitude, which can be converted to mapping accuracy State Plane Utah North Zone NAD 83 feet coordinates of X = 2,268,820.8 feet and Y = 3,504,328.2 feet.

## Appendix B to Attachment 4

**Popular Name: Red Creek Road**

**County: Daggett**

**County Road Number: B25**

**State Geographic Information Database (SGID) Road Identification Number: RD050011.**

**Road-Segment Number: 003**

**Road-Segment Length: 0.79 miles more or less.**

**Believed owner of the land underlying this road-segment is: Bureau of Land Management.**

*The following description is based upon the geographic coordinate system using the NAD83 Datum. The source is GPS mapping grade data as indicated in the metadata and/or the transportation data model of the State of Utah Geographic Information Database (SGID).*

The road-segment itself is the monument that is identified by its physical presence on the land. The location of said physical presence is closely approximated by mapping grade Global Positioning System (GPS) data. Said data are checked against the corresponding gray-scale 1-meter Digital Orthophoto Quadrangles published by the United States Geological Survey (USGS) to verify a reasonable degree of accuracy. In circumstances where accurate satellite signal acquisition is not possible, such as deep, narrow canyons or under a canopy of dense foliage, or where very sharp curves in the road make accuracy questionable, such portions of the road were digitized from the corresponding gray-scale 1-meter Digital Orthophoto Quadrangles published by the United States Geological Survey (USGS).

This road-segment may traverse:

Township 2 North Range 24 East, Section(s) 9, Salt Lake Base & Meridian

The following description closely approximates the location of the centerline of the physical monument (Red Creek Road)-- Segment 003 based on mapping grade Global Positioning System (GPS) data as defined above:

**Beginning at a point** on the road center line located at 40 degrees 55 minutes 18.67 seconds North Latitude and -109 degrees 13 minutes 18.73 seconds West Longitude, which can be converted to mapping accuracy State Plane Utah North Zone NAD 83 feet coordinates of X = 2,269,909.9 feet and Y = 3,503,502.4 feet; thence the following courses along the said road center line:

thence South 85 Degrees 51 Minutes 58 Seconds East	83.8 feet
thence South 83 Degrees 54 Minutes 16 Seconds East	629.7 feet
thence South 88 Degrees 35 Minutes 55 Seconds East	649 feet
thence North 89 Degrees 03 Minutes 25 Seconds East	310.4 feet
thence South 80 Degrees 26 Minutes 35 Seconds East	57.3 feet
thence South 70 Degrees 18 Minutes 22 Seconds East	134.1 feet
thence South 61 Degrees 01 Minutes 07 Seconds East	103.9 feet
thence South 46 Degrees 30 Minutes 54 Seconds East	372.5 feet
thence South 42 Degrees 13 Minutes 44 Seconds East	453.6 feet
thence South 51 Degrees 01 Minutes 55 Seconds East	500.4 feet
thence South 55 Degrees 57 Minutes 24 Seconds East	37.8 feet
thence South 48 Degrees 26 Minutes 58 Seconds East	294.9 feet

thence South 44 Degrees 17 Minutes 24 Seconds East 88.9 feet  
thence South 36 Degrees 19 Minutes 43 Seconds East 115.6 feet  
thence South 31 Degrees 18 Minutes 03 Seconds East 101.4 feet  
thence South 38 Degrees 59 Minutes 49 Seconds East 88.2 feet  
thence South 50 Degrees 39 Minutes 55 Seconds East 127.9 feet more or less to **the ending**  
**point at:** 40 degrees 55 minutes 00.92 seconds North Latitude and -109 degrees 12 minutes 33.79 seconds  
West Longitude, which can be converted to mapping accuracy State Plane Utah North Zone NAD 83 feet  
coordinates of X = 2,273,406.1 feet and Y = 3,501,797.1 feet.



## Appendix C to Attachment 4

**Popular Name: Red Creek Road**

**County: Daggett**

**County Road Number: B25**

**State Geographic Information Database (SGID) Road Identification Number: RD050011.**

**Road-Segment Number: 005**

**Road-Segment Length: 3.2 miles more or less.**

**Believed owner of the land underlying this road-segment is: Bureau of Land Management.**

*The following description is based upon the geographic coordinate system using the NAD83 Datum. The source is GPS mapping grade data as indicated in the metadata and/or the transportation data model of the State of Utah Geographic Information Database (SGID).*

The road-segment itself is the monument that is identified by its physical presence on the land. The location of said physical presence is closely approximated by mapping grade Global Positioning System (GPS) data. Said data are checked against the corresponding gray-scale 1-meter Digital Orthophoto Quadrangles published by the United States Geological Survey (USGS) to verify a reasonable degree of accuracy. In circumstances where accurate satellite signal acquisition is not possible, such as deep, narrow canyons or under a canopy of dense foliage, or where very sharp curves in the road make accuracy questionable, such portions of the road were digitized from the corresponding gray-scale 1-meter Digital Orthophoto Quadrangles published by the United States Geological Survey (USGS).

This road-segment may traverse:

Township 2 North Range 24 East, Section(s) 13,15,22,23,24, Salt Lake Base & Meridian

The following description closely approximates the location of the centerline of the physical monument (Red Creek Road)-- Segment 005 based on mapping grade Global Positioning System (GPS) data as defined above:

**Beginning at a point** on the road center line located at 40 degrees 54 minutes 044.3 seconds North Latitude and -109 degrees 12 minutes 09.29 seconds West Longitude, which can be converted to mapping accuracy State Plane Utah North Zone NAD 83 feet coordinates of X = 2,275,330.7 feet and Y = 3,500,165.7 feet; thence the following courses along the said road center line:

thence South 45 Degrees 20 Minutes 14 Seconds East	396.6 feet
thence South 47 Degrees 42 Minutes 56 Seconds East	581.5 feet
thence South 47 Degrees 42 Minutes 20 Seconds East	561.5 feet
thence South 45 Degrees 39 Minutes 39 Seconds East	616.5 feet
thence South 40 Degrees 35 Minutes 52 Seconds East	550.4 feet
thence South 41 Degrees 19 Minutes 44 Seconds East	491.2 feet
thence South 44 Degrees 26 Minutes 41 Seconds East	431.8 feet
thence South 43 Degrees 55 Minutes 59 Seconds East	265 feet
thence South 47 Degrees 23 Minutes 05 Seconds East	279.3 feet
thence South 52 Degrees 14 Minutes 06 Seconds East	231.8 feet
thence South 62 Degrees 58 Minutes 10 Seconds East	31.4 feet
thence South 55 Degrees 23 Minutes 28 Seconds East	203.3 feet

thence South 53 Degrees 49 Minutes 08 Seconds East 278.4 feet  
 thence South 52 Degrees 54 Minutes 55 Seconds East 156.6 feet  
 thence South 53 Degrees 50 Minutes 58 Seconds East 69 feet  
 thence South 55 Degrees 57 Minutes 35 Seconds East 34.9 feet  
 thence South 55 Degrees 57 Minutes 19 Seconds East 40.7 feet  
 thence South 63 Degrees 10 Minutes 33 Seconds East 352.2 feet  
 thence South 66 Degrees 34 Minutes 12 Seconds East 264.6 feet  
 thence South 63 Degrees 18 Minutes 24 Seconds East 126.3 feet  
 thence South 48 Degrees 08 Minutes 02 Seconds East 90.4 feet  
 thence South 38 Degrees 55 Minutes 14 Seconds East 191 feet  
 thence South 31 Degrees 42 Minutes 38 Seconds East 78.8 feet  
 thence South 05 Degrees 35 Minutes 52 Seconds East 103.8 feet  
 thence South 11 Degrees 25 Minutes 49 Seconds West 40.2 feet  
 thence South 16 Degrees 11 Minutes 07 Seconds East 52.9 feet  
 thence South 62 Degrees 14 Minutes 11 Seconds East 38.3 feet  
 thence South 83 Degrees 37 Minutes 40 Seconds East 28.1 feet  
 thence South 75 Degrees 06 Minutes 56 Seconds East 199.9 feet  
 thence South 65 Degrees 17 Minutes 52 Seconds East 49.6 feet  
 thence South 64 Degrees 38 Minutes 06 Seconds East 87.8 feet  
 thence South 60 Degrees 59 Minutes 38 Seconds East 221 feet  
 thence South 70 Degrees 23 Minutes 30 Seconds East 129.8 feet  
 thence South 87 Degrees 10 Minutes 15 Seconds East 24.4 feet  
 thence South 87 Degrees 10 Minutes 47 Seconds East 273.4 feet  
 thence North 83 Degrees 45 Minutes 21 Seconds East 19.1 feet  
 thence North 83 Degrees 31 Minutes 46 Seconds East 350.1 feet  
 thence North 77 Degrees 20 Minutes 43 Seconds East 307.6 feet  
 thence North 74 Degrees 17 Minutes 45 Seconds East 222.9 feet  
 thence North 62 Degrees 29 Minutes 49 Seconds East 140.1 feet  
 thence North 60 Degrees 02 Minutes 36 Seconds East 129.5 feet  
 thence North 78 Degrees 54 Minutes 15 Seconds East 33.4 feet  
 thence North 78 Degrees 40 Minutes 53 Seconds East 44.8 feet  
 thence North 76 Degrees 07 Minutes 34 Seconds East 182.2 feet  
 thence North 72 Degrees 08 Minutes 11 Seconds East 261.5 feet  
 thence North 84 Degrees 03 Minutes 27 Seconds East 352.8 feet  
 thence North 82 Degrees 13 Minutes 23 Seconds East 215.4 feet  
 thence South 82 Degrees 19 Minutes 14 Seconds East 94.1 feet  
 thence South 83 Degrees 12 Minutes 46 Seconds East 13.2 feet  
 thence North 88 Degrees 17 Minutes 59 Seconds East 276 feet  
 thence North 86 Degrees 47 Minutes 59 Seconds East 230 feet  
 thence North 86 Degrees 35 Minutes 04 Seconds East 61.1 feet  
 thence North 85 Degrees 17 Minutes 03 Seconds East 343.9 feet  
 thence South 87 Degrees 43 Minutes 10 Seconds East 323.2 feet  
 thence North 89 Degrees 11 Minutes 03 Seconds East 393.4 feet  
 thence South 89 Degrees 50 Minutes 48 Seconds East 382.9 feet  
 thence North 89 Degrees 39 Minutes 43 Seconds East 132.6 feet  
 thence South 84 Degrees 17 Minutes 41 Seconds East 202.6 feet  
 thence North 87 Degrees 17 Minutes 37 Seconds East 384.3 feet  
 thence North 87 Degrees 17 Minutes 40 Seconds East 12.7 feet  
 thence North 78 Degrees 44 Minutes 15 Seconds East 181.8 feet

thence North 76 Degrees 26 Minutes 34 Seconds East 50.2 feet  
 thence North 71 Degrees 13 Minutes 37 Seconds East 15.6 feet  
 thence North 64 Degrees 31 Minutes 08 Seconds East 189.2 feet  
 thence North 57 Degrees 48 Minutes 08 Seconds East 68.4 feet  
 thence North 50 Degrees 21 Minutes 38 Seconds East 549.1 feet  
 thence North 48 Degrees 59 Minutes 13 Seconds East 332.3 feet  
 thence North 58 Degrees 27 Minutes 39 Seconds East 118.2 feet  
 thence North 58 Degrees 31 Minutes 00 Seconds East 5.3 feet  
 thence North 68 Degrees 01 Minutes 03 Seconds East 22.2 feet  
 thence North 78 Degrees 14 Minutes 27 Seconds East 463.9 feet  
 thence North 79 Degrees 28 Minutes 59 Seconds East 547.7 feet  
 thence North 78 Degrees 56 Minutes 15 Seconds East 352.6 feet  
 thence North 81 Degrees 00 Minutes 58 Seconds East 185.5 feet  
 thence North 77 Degrees 53 Minutes 11 Seconds East 530.6 feet  
 thence North 71 Degrees 39 Minutes 05 Seconds East 70 feet  
 thence North 71 Degrees 37 Minutes 15 Seconds East 120.8 feet  
 thence North 80 Degrees 54 Minutes 04 Seconds East 96.9 feet  
 thence North 87 Degrees 45 Minutes 44 Seconds East 198 feet  
 thence South 89 Degrees 32 Minutes 09 Seconds East 96.1 feet more or less to **the ending**

**point at:** 40 degrees 54 minutes 12.55 seconds North Latitude and -109 degrees 09 minutes 00.07 seconds West Longitude, which can be converted to mapping accuracy State Plane Utah North Zone NAD 83 feet coordinates of X = 2,289,939.8 feet and Y = 3,497,341.8 feet.