

Ent 401378 Bk A525 Pg 691
Date: 27-DEC-2007 10:01AM
Fee: None
Filed By: CBM
CAROLYNE MADSEN, Recorder
DUCHESNE COUNTY CORPORATION
For: STATE OF UTAH

**Amended Acknowledgment and
Amended Notice of Acknowledgment
of Acceptance of R.S. 2477
Right-of-Way Grant**

THE STATE OF UTAH

TO ALL WHOM THESE PRESENTS SHALL COME, Greeting:

Know ye, This is an Amended Acknowledgment and Amended Notice of Acknowledgment made under Utah Code Sections 72-5-309 through 310 inclusive, that the grant of the United States of America of “the right of way for the construction of highways over public lands, not reserved for public uses” under United States Revised Statutes 2477 (43 U.S.C. Section 932 (repealed October 21, 1976, with proviso recognizing the validity of rights-of-way already established)) was accepted for and on behalf of the State of Utah and its political subdivision Duchesne County as it pertains to the highway located in Duchesne County known as South Wells Draw Cutoff Road; County Road Number: 34b; State Geographic Information Database (SGID) Road Identification Number: RD070013. Total road length is 0.83 miles more or less.

This Amended Acknowledgment and Amended Notice of Acknowledgment supersedes the information contained in the Acknowledgment recorded at Ent 393658, Bk A500, Beg Pg 336.

The reason for this Amended Acknowledgment and Amended Notice of Acknowledgment includes, but is not limited to, the fact that the road was constructed, mechanically, or by continuous use as a public highway for a period of at least ten years, over public lands not reserved for public uses, prior to the earlier of (a) the October 21, 1976 repeal of R.S. 2477 or (b) the date the servient estate was reserved for public uses.

This Amended Acknowledgment and Amended Notice of Acknowledgment applies only to the segments of the road that traverse land owned by the Bureau of Land Management, United States Department of the Interior, and does not apply to segments of the road that traverse land owned by any other person or entity. The State of Utah and its political subdivisions reserve the right to make further acknowledgments and notices of acknowledgment with regard to road segments that traverse land owned by other entities, including the United States of America, through one or more of its agencies.

A printed copy of a map showing the location of the road in said county is appended hereto as “Attachment 1,” a printed copy of representative photos of the road is appended hereto as “Attachment 2,” a printed copy of a description of the beginning and ending points of the entire road together with a list of Townships, Ranges and Sections that may be traversed by the road in said county is appended hereto as “Attachment 3,” and a printed copy of the Road Centerline Description Cover Page(s) is appended hereto as “Attachment 4.” The Appendices listed in “Attachment 4” that contain the actual road centerline descriptions are incorporated herein by reference.

A printed copy of this Amended Acknowledgment and Amended Notice of Acknowledgment, together with its Attachments and Appendices, may be viewed and/or obtained at the office of the Utah State Archives.

An electronic copy of this Amended Acknowledgment and Amended Notice of Acknowledgment, together with its Attachments and Appendices, may be viewed and/or downloaded as read-only PDF (Portable Document Format) files via the Internet at <http://recorded2477roads.utah.gov>.

The owner of the servient estate in the land underlying the road-segments subject to this Amended Acknowledgment and Amended Notice is believed to be the United States of America through one or more of its agencies. Any of such agencies or any other person with a servient ownership claim or a competing dominant estate right-of-way ownership claim, may file a petition in the State District Court for Salt Lake County for a decision regarding the correctness of this Amended Acknowledgment. A claimant shall file a petition within sixty (60) days after receipt of this Notice.

In Witness Whereof, I, John Harja, the official designee of the Governor of the State of Utah, in conformity to the laws of the State (Utah Code Sections 72-5-308 through 310 inclusive), have caused this Amended Acknowledgment and Amended Notice of Acknowledgment to be made.

Signed by my hand in Salt Lake City, Utah, the 7th day of December, 2007.

By the Governor's Designee



John Harja

CERTIFICATION

State of Utah)
 : ss
County of Salt Lake)

I hereby certify that the signer of the foregoing document, John Harja, is personally known by me, has made a voluntary signature and taken an oath stating that he is the official designee of the Governor of the State of Utah and is authorized to sign this document on the Governor's behalf pursuant to Utah Code Section 72-5-309. He further vouched that, based upon information and belief, the facts alleged therein are true.

Dated this 7th day of December, 2007.

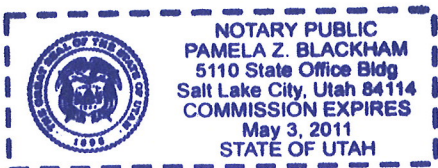



Notary Public

Ent 401370 Bk A0525 Pg 0693

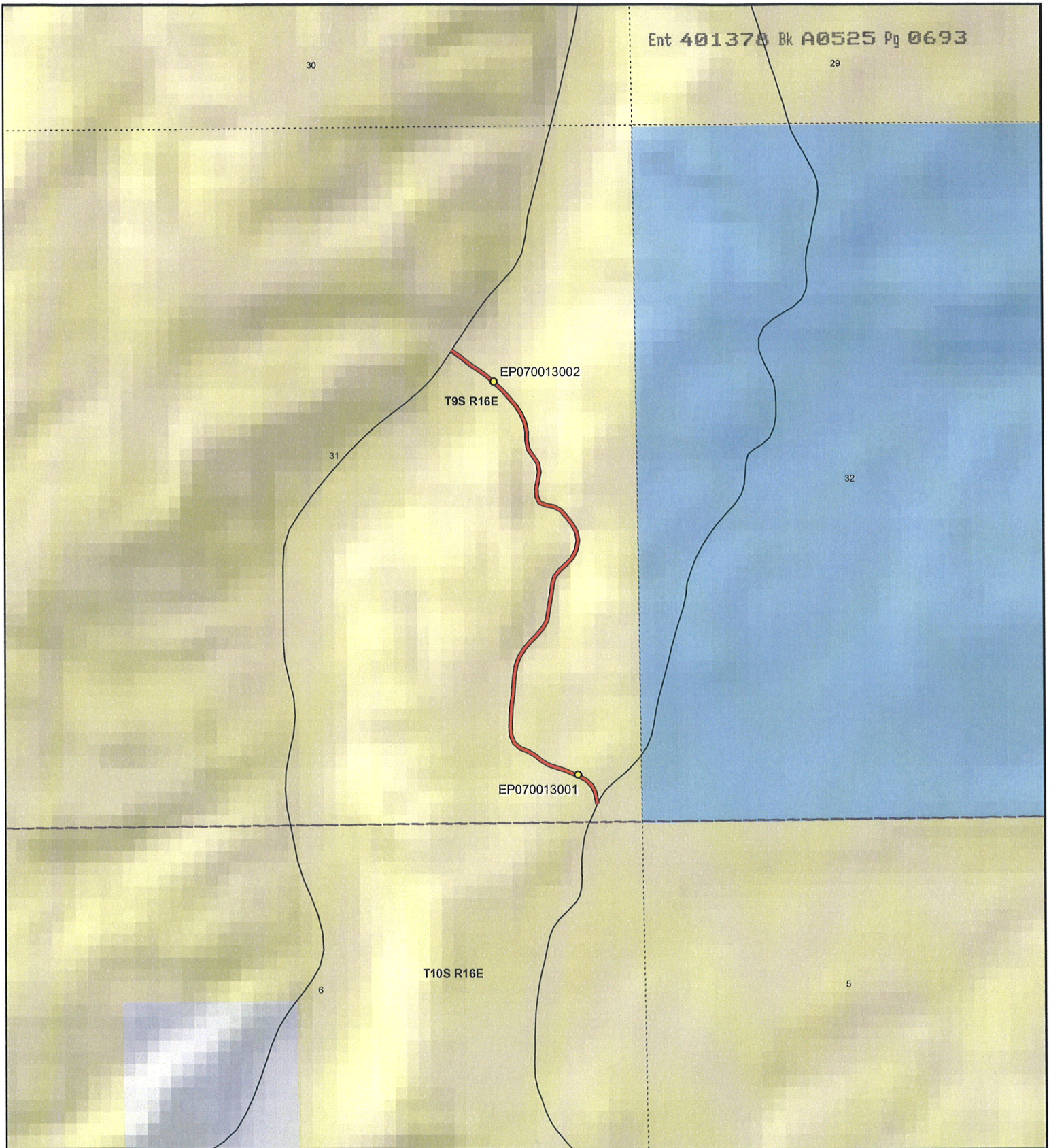

1:11,827
1 inch equals 0.2 miles

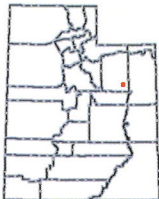

South Wells Draw Cutoff Road - Duchesne County
SGID RD_ID RD070013

Land Ownership Categories

- | | |
|----------------------------|------------------------------|
| BLM | Wilderness |
| Private | UDWR Wildlife Reserve |
| SITLA, State Trust Land | DOD, Military |
| USFS, National Forest | State Sovereign Land |
| State Parks and Recreation | National Recreation Area |
| Tribal, Indian Reservation | USFWS, Natl. Wildlife Refuge |
| NPS, National Park | |

Transportation Network

- | |
|---|
| South Wells Draw Cutoff Road |
| Title V: Issued Or Under Consideration By BLM Or County |
| Other Roads |
| Photo Event Point |
| Section = 1 Mile |

Map prepared by the State of Utah
Automated Geographic Reference Center
Room 5130 State Office Building
Salt Lake City, Utah 84114
Nov 27, 2006





EP070013001



EP070013002

EP000000000

EP000000000

EP000000000

EP000000000

South Wells Draw Cutoff Road - Duchesne County
SGID RD_ID RD070013



Map prepared by the State of Utah
Automated Geographic Reference Center
Room 5130 State Office Building
Salt Lake City, Utah 84114
November 27, 2006



Attachment 3

Beginning & Ending Points and Township, Range, and Section References For:

Popular Name: South Wells Draw Cutoff Road

County: Duchesne

County Road Number: 34b

State Geographic Information Database (SGID) Road Identification Number: RD070013.

Total Road Length: 0.83 miles more or less.

Beginning at a point on the road centerline located at 39 degrees 58 minutes 50.23 seconds North Latitude and -110 degrees 09 minutes 13.32 seconds West Longitude, which can be converted to mapping accuracy State Plane Utah Central Zone NAD 83 feet coordinates of X = 2,017,655.9 feet and Y = 7,164,503.5 feet based on the US Survey Foot conversion.

Ending at a point on the road centerline located at 39 degrees 59 minutes 024.3 seconds North Latitude and -110 degrees 09 minutes 026.9 seconds West Longitude, which can be converted to mapping accuracy State Plane Utah Central Zone NAD 83 feet coordinates of X = 2,016,547.0 feet and Y = 7,167,934.9 feet based on the US Survey Foot conversion.

This road may traverse:

Township 9 South Range 16 East, Section(s) 31, Salt Lake Base & Meridian
See Attachment 1 above for a cartographic depiction of the course of this road.

Attachment 4
Road Centerline Description Cover Page(s)

Popular Name: South Wells Draw Cutoff Road

County: Duchesne

County Road Number: 34b

State Geographic Information Database (SGID) Road Identification Number: RD070013.

Total Road Length: 0.83 miles more or less.

Centerline Descriptions Of Road-Segments That Cross Over Federally Owned Land, Derived From Global Positioning System Data And Cross-checked against USGS Digital Orthophoto Quadrangles Compiled By The Utah Automated Geographic Reference Center And Entered Into The State Geographic Information Database (SGID).

Road-Segments Listed by SGID Road Identification Number (RD_ID)	Road-Segment Numbers	Believed Ownership Of Servient Estate	Approximate Segment Length	See Attached Appendix
RD070013	001	BLM	0.83 Miles	A
		Total Road Length	0.83	_____

* Indicates that a Title V permit will be requested, is in process, or has been issued.

† Indicates that road-segments crossing Forest Service land are under consideration by the state and county as of the date of this Amended Acknowledgment and Amended Notice of Acknowledgment.

Appendix A to Attachment 4

Popular Name: South Wells Draw Cutoff Road

County: Duchesne

County Road Number: 34b

State Geographic Information Database (SGID) Road Identification Number: RD070013.

Road-Segment Number: 001

Road-Segment Length: 0.83 miles more or less.

Believed owner of the land underlying this road-segment is: Bureau of Land Management.

The following description is based upon the geographic coordinate system using the NAD83 Datum. The source is GPS mapping grade data as indicated in the metadata and/or the transportation data model of the State of Utah Geographic Information Database (SGID).

The road-segment itself is the monument that is identified by its physical presence on the land. The location of said physical presence is closely approximated by mapping grade Global Positioning System (GPS) data. Said data are checked against the corresponding gray-scale 1-meter Digital Orthophoto Quadrangles published by the United States Geological Survey (USGS) to verify a reasonable degree of accuracy. In circumstances where accurate satellite signal acquisition is not possible, such as deep, narrow canyons or under a canopy of dense foliage, or where very sharp curves in the road make accuracy questionable, such portions of the road were digitized from the corresponding gray-scale 1-meter Digital Orthophoto Quadrangles published by the United States Geological Survey (USGS).

This road-segment may traverse:

Township 9 South Range 16 East, Section(s) 31, Salt Lake Base & Meridian

The following description closely approximates the location of the centerline of the physical monument (South Wells Draw Cutoff Road)-- Segment 001 based on mapping grade Global Positioning System (GPS) data as defined above:

Beginning at a point on the road center line located at 39 degrees 58 minutes 50.23 seconds North Latitude and -110 degrees 09 minutes 13.32 seconds West Longitude, which can be converted to mapping accuracy State Plane Utah Central Zone NAD 83 feet coordinates of X = 2,017,655.9 feet and Y = 7,164,503.5 feet; thence the following courses along the said road center line:

thence North 12 Degrees 11 Minutes 50 Seconds West 97.2 feet
thence North 28 Degrees 02 Minutes 33 Seconds West 50.8 feet
thence North 46 Degrees 45 Minutes 02 Seconds West 55.7 feet
thence North 61 Degrees 12 Minutes 08 Seconds West 59.3 feet
thence North 66 Degrees 31 Minutes 17 Seconds West 57.7 feet
thence North 68 Degrees 34 Minutes 21 Seconds West 62.9 feet
thence North 71 Degrees 19 Minutes 51 Seconds West 64.6 feet
thence North 72 Degrees 55 Minutes 43 Seconds West 62.6 feet
thence North 59 Degrees 24 Minutes 24 Seconds West 62 feet
thence North 51 Degrees 12 Minutes 39 Seconds West 65.6 feet
thence North 60 Degrees 54 Minutes 41 Seconds West 62.2 feet

thence North 66 Degrees 40 Minutes 17 Seconds West 60.5 feet
thence North 50 Degrees 42 Minutes 58 Seconds West 59.2 feet
thence North 22 Degrees 56 Minutes 18 Seconds West 64 feet
thence North 01 Degrees 56 Minutes 23 Seconds West 69.6 feet
thence North 01 Degrees 09 Minutes 00 Seconds East 76.8 feet
thence North 03 Degrees 57 Minutes 10 Seconds East 79.3 feet
thence North 07 Degrees 36 Minutes 07 Seconds East 76.2 feet
thence North 05 Degrees 06 Minutes 34 Seconds East 72.9 feet
thence North 04 Degrees 07 Minutes 04 Seconds East 76.4 feet
thence North 08 Degrees 14 Minutes 13 Seconds East 75 feet
thence North 18 Degrees 36 Minutes 21 Seconds East 72.9 feet
thence North 31 Degrees 39 Minutes 34 Seconds East 73.1 feet
thence North 39 Degrees 59 Minutes 43 Seconds East 71 feet
thence North 43 Degrees 54 Minutes 25 Seconds East 68.7 feet
thence North 41 Degrees 16 Minutes 13 Seconds East 70.2 feet
thence North 27 Degrees 14 Minutes 03 Seconds East 68.1 feet
thence North 10 Degrees 56 Minutes 20 Seconds East 70.6 feet
thence North 08 Degrees 25 Minutes 39 Seconds East 73.4 feet
thence North 08 Degrees 02 Minutes 22 Seconds East 70 feet
thence North 08 Degrees 10 Minutes 59 Seconds East 64.4 feet
thence North 15 Degrees 40 Minutes 09 Seconds East 60.8 feet
thence North 36 Degrees 54 Minutes 58 Seconds East 61.8 feet
thence North 48 Degrees 07 Minutes 08 Seconds East 65.8 feet
thence North 43 Degrees 05 Minutes 25 Seconds East 66.9 feet
thence North 27 Degrees 21 Minutes 45 Seconds East 67.8 feet
thence North 09 Degrees 57 Minutes 41 Seconds East 68 feet
thence North 09 Degrees 07 Minutes 45 Seconds West 66.4 feet
thence North 27 Degrees 45 Minutes 12 Seconds West 67.7 feet
thence North 37 Degrees 50 Minutes 15 Seconds West 69.5 feet
thence North 41 Degrees 33 Minutes 25 Seconds West 67.2 feet
thence North 59 Degrees 14 Minutes 48 Seconds West 59.8 feet
thence North 80 Degrees 38 Minutes 42 Seconds West 58.6 feet
thence North 69 Degrees 02 Minutes 58 Seconds West 52.5 feet
thence North 26 Degrees 53 Minutes 00 Seconds West 52.8 feet
thence North 04 Degrees 04 Minutes 12 Seconds West 60.2 feet
thence North 10 Degrees 27 Minutes 05 Seconds East 61.5 feet
thence North 10 Degrees 33 Minutes 23 Seconds East 67.8 feet
thence North 08 Degrees 41 Minutes 03 Seconds West 67.7 feet
thence North 35 Degrees 07 Minutes 21 Seconds West 65.5 feet
thence North 34 Degrees 34 Minutes 59 Seconds West 63.5 feet
thence North 09 Degrees 44 Minutes 02 Seconds West 66.2 feet
thence North 01 Degrees 41 Minutes 20 Seconds West 68.6 feet
thence North 10 Degrees 18 Minutes 39 Seconds West 70 feet
thence North 23 Degrees 54 Minutes 07 Seconds West 70.5 feet
thence North 33 Degrees 43 Minutes 18 Seconds West 72.7 feet
thence North 39 Degrees 32 Minutes 25 Seconds West 78.4 feet
thence North 42 Degrees 43 Minutes 50 Seconds West 82.2 feet
thence North 46 Degrees 19 Minutes 03 Seconds West 79.8 feet
thence North 49 Degrees 52 Minutes 42 Seconds West 75.9 feet

thence North 54 Degrees 19 Minutes 45 Seconds West 72.6 feet
thence North 55 Degrees 41 Minutes 39 Seconds West 67 feet
thence North 54 Degrees 29 Minutes 40 Seconds West 61.1 feet
thence North 51 Degrees 29 Minutes 19 Seconds West 51.8 feet
thence North 53 Degrees 15 Minutes 43 Seconds West 40.3 feet
thence North 55 Degrees 22 Minutes 45 Seconds West 29.2 feet
thence North 55 Degrees 48 Minutes 35 Seconds West 6.4 feet more or less to **the ending point**

at: 39 degrees 59 minutes 024.3 seconds North Latitude and -110 degrees 09 minutes 026.9 seconds West Longitude, which can be converted to mapping accuracy State Plane Utah Central Zone NAD 83 feet coordinates of X = 2,016,547.0 feet and Y = 7,167,934.9 feet.