

Ent 486398 Bk 730 Pg 338 - 350
Date: 27-MAY-2008 12:03PM
Fee: None
Filed By: PL
MERLENE MOSHER DALTON, Recorder
GRAND COUNTY CORPORATION
For: STATE OF UTAH

**Acknowledgment and
Notice of Acknowledgment
of Acceptance of R.S. 2477
Right-of-Way Grant**

THE STATE OF UTAH

TO ALL WHOM THESE PRESENTS SHALL COME, Greeting:

Know ye, This is an Acknowledgment and Notice of Acknowledgment made under Utah Code Sections 72-5-309 through 310 inclusive, that the grant of the United States of America of “the right of way for the construction of highways over public lands, not reserved for public uses” under United States Revised Statutes 2477 (43 U.S.C. Section 932 (repealed October 21, 1976, with proviso recognizing the validity of rights-of-way already established)) was accepted for and on behalf of the State of Utah and its political subdivision Grand County as it pertains to the highway located in Grand County known as BRYSON GAS FIELD ROAD; County Road Number: 00199; State Geographic Information Database (SGID) Road Identification Number: RD100090. Total road length is 0.75 miles more or less.

The reason for this Acknowledgment and Notice of Acknowledgment includes, but is not limited to, the fact that the road was constructed, mechanically, or by continuous use as a public highway for a period of at least ten years, over public lands not reserved for public uses, prior to the earlier of (a) the October 21, 1976 repeal of R.S. 2477 or (b) the date the servient estate was reserved for public uses.

This Acknowledgment and Notice of Acknowledgment applies only to the segments of the road that traverse land owned by the Bureau of Land Management, United States Department of the Interior, and does not apply to segments of the road that traverse land owned by any other person or entity. The State of Utah and its political subdivisions reserve the right to make further acknowledgments and notices of acknowledgment with regard to road segments that traverse land owned by other entities, including the United States of America, through one or more of its agencies.

A printed copy of a map showing the location of the road in said county is appended hereto as “Attachment 1,” a printed copy of representative photos of the road is appended hereto as “Attachment 2,” a printed copy of a description of the beginning and ending points of the entire road together with a list of Townships, Ranges and Sections that may be traversed by the road in said county is appended hereto as “Attachment 3,” and a printed copy of the Road Centerline Description Cover Page(s) is appended hereto as “Attachment 4.” The Appendices listed in “Attachment 4” that contain the actual road centerline descriptions are incorporated herein by reference. Affidavits provided by individuals familiar with the road are appended hereto as “Attachment 5.”

A printed copy of this Acknowledgment and Notice of Acknowledgment, together with its Attachments and Appendices, may be viewed and/or obtained at the office of the Utah State Archives.

An electronic copy of this Acknowledgment and Notice of Acknowledgment, together with its Attachments and Appendices, may be viewed and/or downloaded as read-only PDF (Portable Document Format) files via the

Internet at <http://recorded2477roads.utah.gov>.

The owner of the servient estate in the land underlying the road-segments subject to this Acknowledgment and Notice is believed to be the United States of America through one or more of its agencies. Any of such agencies or any other person with a servient ownership claim or a competing dominant estate right-of-way ownership claim, may file a petition in the State District Court for Salt Lake County for a decision regarding the correctness of this Acknowledgment. A claimant shall file a petition within sixty (60) days after receipt of this Notice.

In Witness Whereof, I, John Harja, the official designee of the Governor of the State of Utah, in conformity to the laws of the State (Utah Code Sections 72-5-308 through 310 inclusive), have caused this Acknowledgment and Notice of Acknowledgment to be made.

Signed by my hand in Salt Lake City, Utah, the 22nd day of may, 2008.

By the Governor's Designee



John Harja

CERTIFICATION

State of Utah)
 : ss
County of Salt Lake)

I hereby certify that the signer of the foregoing document, John Harja, is personally known by me, has made a voluntary signature and taken an oath stating that he is the official designee of the Governor of the State of Utah and is authorized to sign this document on the Governor's behalf pursuant to Utah Code Section 72-5-309. He further vouched that, based upon information and belief, the facts alleged therein are true.



Dated this 22nd day of May, 2008.



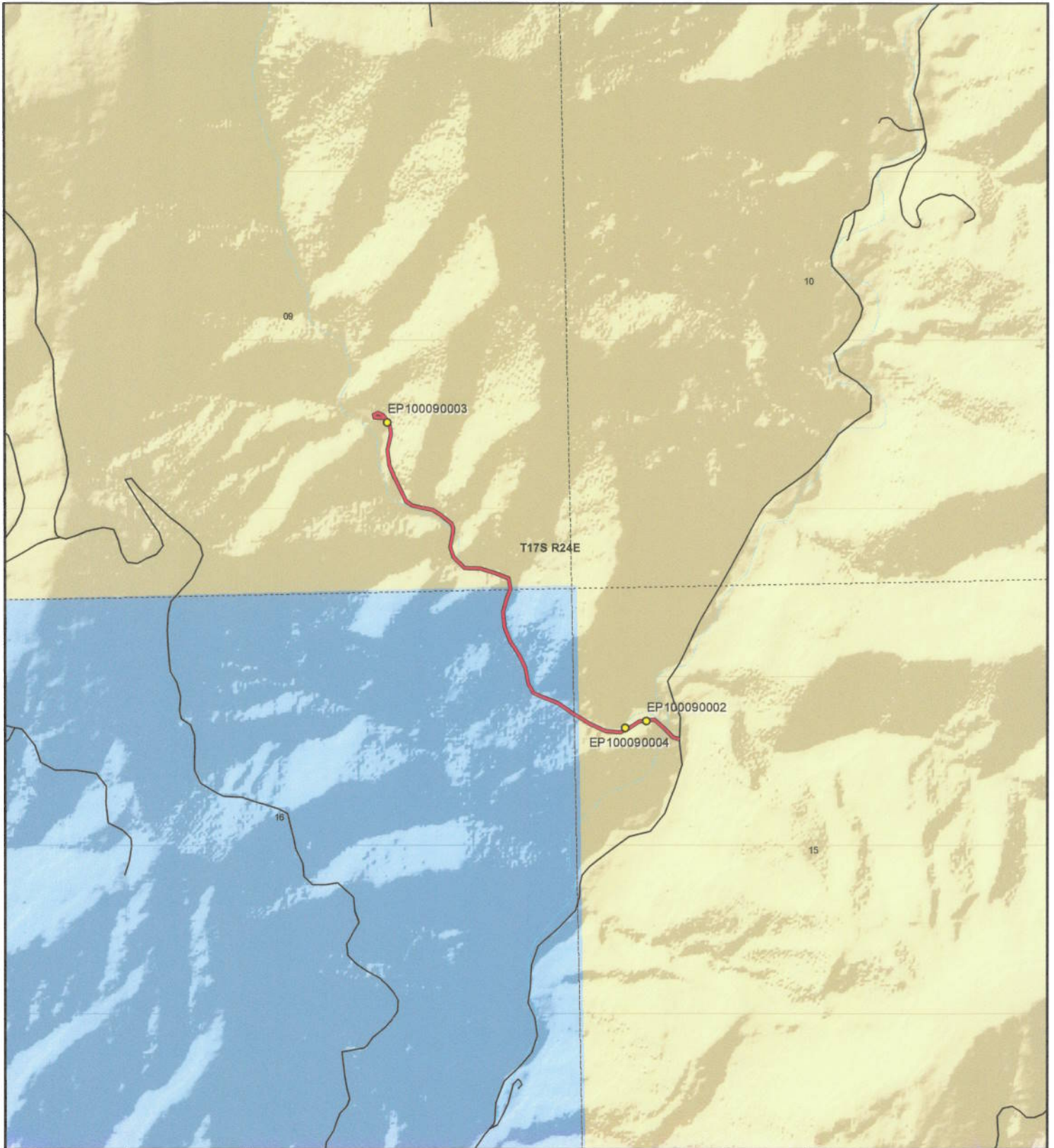

Notary Public



 <p>1:11,147 1 inch equals 0.2 miles</p>		<p style="text-align: center;">Bryson Gas Field Road - Grand County SGID RD_ID RD100090</p> <table border="0"> <tr> <td colspan="2">Land Ownership Categories</td> <td colspan="2">Transportation Network</td> </tr> <tr> <td> BLM</td> <td> Wilderness</td> <td> Bryson Gas Field Road</td> <td> Title V: Issued Or Under Consideration By BLM Or County</td> </tr> <tr> <td> Private</td> <td> UDWR Wildlife Reserve</td> <td> Other Roads</td> <td> Photo Event Point</td> </tr> <tr> <td> SITLA, State Trust Land</td> <td> DOD, Military</td> <td> Section = 1 Mile</td> <td></td> </tr> <tr> <td> USFS, National Forest</td> <td> State Sovereign Land</td> <td></td> <td></td> </tr> <tr> <td> State Parks and Recreation</td> <td> National Recreation Area</td> <td></td> <td></td> </tr> <tr> <td> Tribal, Indian Reservation</td> <td> USFWS, Natl. Wildlife Refuge</td> <td></td> <td></td> </tr> <tr> <td> NPS, National Park</td> <td></td> <td></td> <td></td> </tr> </table>	Land Ownership Categories		Transportation Network		BLM	Wilderness	Bryson Gas Field Road	Title V: Issued Or Under Consideration By BLM Or County	Private	UDWR Wildlife Reserve	Other Roads	Photo Event Point	SITLA, State Trust Land	DOD, Military	Section = 1 Mile		USFS, National Forest	State Sovereign Land			State Parks and Recreation	National Recreation Area			Tribal, Indian Reservation	USFWS, Natl. Wildlife Refuge			NPS, National Park				<p>Map prepared by the State of Utah Automated Geographic Reference Center Room 5130 State Office Building Salt Lake City, Utah 84114 Apr 10, 2008</p>  
Land Ownership Categories		Transportation Network																																	
BLM	Wilderness	Bryson Gas Field Road	Title V: Issued Or Under Consideration By BLM Or County																																
Private	UDWR Wildlife Reserve	Other Roads	Photo Event Point																																
SITLA, State Trust Land	DOD, Military	Section = 1 Mile																																	
USFS, National Forest	State Sovereign Land																																		
State Parks and Recreation	National Recreation Area																																		
Tribal, Indian Reservation	USFWS, Natl. Wildlife Refuge																																		
NPS, National Park																																			

Attachment 2



EP100090002

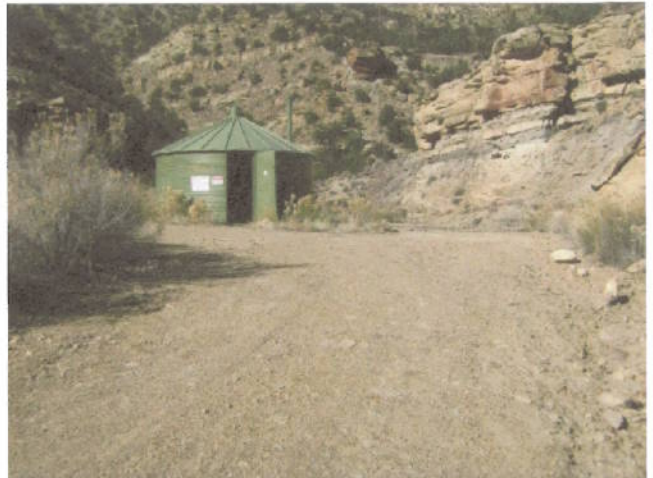

EP100090003

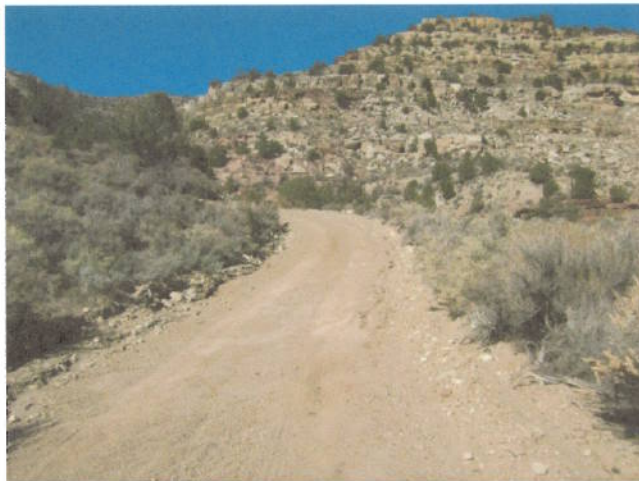

EP100090004

EP000000000

EP000000000

EP000000000

Ent 486398 Bk 0730 Pg 0341

Bryson Gas Field Road - Grand County
SGID RD_ID RD100090

Map prepared by the State of Utah
Automated Geographic Reference Center
Room 5130 State Office Building
Salt Lake City, Utah 84114
April 14, 2008



Attachment 3

Beginning & Ending Points and Township, Range, and Section References For:

Popular Name: BRYSON GAS FIELD ROAD

County: Grand

County Road Number: 00199

State Geographic Information Database (SGID) Road Identification Number: RD100090.

Total Road Length: 0.75 miles more or less.

Beginning at a point on the road centerline located at 39 degrees 19 minutes 56.98 seconds North Latitude and -109 degrees 15 minutes 15.13 seconds West Longitude, which can be converted to mapping accuracy State Plane Utah Central Zone NAD 83 feet coordinates of X = 2,275,583.1 feet and Y = 6,933,571.0 feet based on the US Survey Foot conversion.

Ending at a point on the road centerline located at 39 degrees 20 minutes 20.03 seconds North Latitude and -109 degrees 15 minutes 41.32 seconds West Longitude, which can be converted to mapping accuracy State Plane Utah Central Zone NAD 83 feet coordinates of X = 2,273,467.5 feet and Y = 6,935,850.6 feet based on the US Survey Foot conversion.

This road may traverse:

Township 17 South Range 24 East, Section(s) 9,15,16, Salt Lake Base & Meridian
See Attachment 1 above for a cartographic depiction of the course of this road.

Attachment 4
Road Centerline Description Cover Page(s)

Popular Name: BRYSON GAS FIELD ROAD

County: Grand

County Road Number: 00199

State Geographic Information Database (SGID) Road Identification Number: RD100090.

Total Road Length: 0.75 miles more or less.

Centerline Descriptions Of Road-Segments That Cross Over Federally Owned Land, Derived From Global Positioning System Data And Cross-checked against USGS Digital Orthophoto Quadrangles Compiled By The Utah Automated Geographic Reference Center And Entered Into The State Geographic Information Database (SGID).

Road-Segments Listed by SGID Road Identification Number (RD ID)	Road-Segment Numbers	Believed Ownership Of Servient Estate	Approximate Segment Length	See Attached Appendix
RD100090	001	BLM	0.16 Miles	A
RD100090	002	ST	0.22 Miles	(not shown)
RD100090	003	BLM	0.33 Miles	B
RD100090	004	BLM	0.04 Miles	C
		Total Road Length	0.75	_____

* Indicates that a Title V permit will be requested, is in process, or has been issued.

† Indicates that road-segments crossing Forest Service land are under consideration by the state and county as of the date of this Acknowledgment and Notice of Acknowledgment.

Attachment 5

AFFIDAVIT OF WILLIAM H. BUNIGER III

BRYSON GAS FIELD ROAD

GRAND COUNTY, UTAH

ROAD NUMBER 00199

State of Colorado)
 : ss.
County of Mesa)

WILLIAM H. BUNIGER III, being first duly sworn, deposes and states as follows:

1. I am an adult competent to testify about the matters set forth below based upon my personal knowledge. I currently reside in Loma, Mesa County, Colorado. I have lived in Mesa County for 62 years. I have worked and hunted in the Book Cliff area of Eastern Grand County, Utah for at least 50 years.

2. I have traveled and am familiar with a road in Grand County known as Bryson Gas Field Road. I am also familiar with the land the road traverses. When I first used and observed the road in the early 1960s it followed the same route as in 2003 when I last observed it. Attached is a Grand County map showing Bryson Gas Field Road. To the best of my knowledge and based upon my use of and familiarity with this road and the land it traverses, the location and route of the road are correctly illustrated on the attached map.

3. I am informed that Gand County also identifies this road according to the road number listed above.

4. I have observed that the road has been open to the public for all to use, to come and go as they pleased, since at least as early as the early 1960s and continuing through 2003. Throughout this time period I observed travel on the road by means of jeeps, pickup trucks and ATVs. During this time period, the road was used weekly, weather permitting, for more than ten continuous years prior to 1976 and was used weekly, weather permitting, in 2003.

5. Throughout the time period from the early 1960s to 2003, I used the road myself for oil field work and recreation.

6. Throughout the time period described in the previous paragraph, I have observed other vehicles from the general public using the road at various times for the uses described in the previous paragraph plus, livestock operations, rock hounding, wood gathering, oil and gas exploration and development and sightseeing.

7. It is also the reputation in the community that this road has been open to the public for all to use, to come and go as they pleased, since at least as early as the 1950s and continuing through 1976 to the present, for the uses described in the previous paragraphs.

8. Prior to 1976, I observed the graded surface of the road and evidence of maintenance and construction such as windrows along the side of the road.

DATED this 7 day of September, 2007.

William H. Buniger III
WILLIAM H. BUNIGER III

SUBSCRIBED AND SWORN to before me this 7th day of September, 2007.

Nettie Reed
NOTARY PUBLIC

My commission expires: 1/27/2011



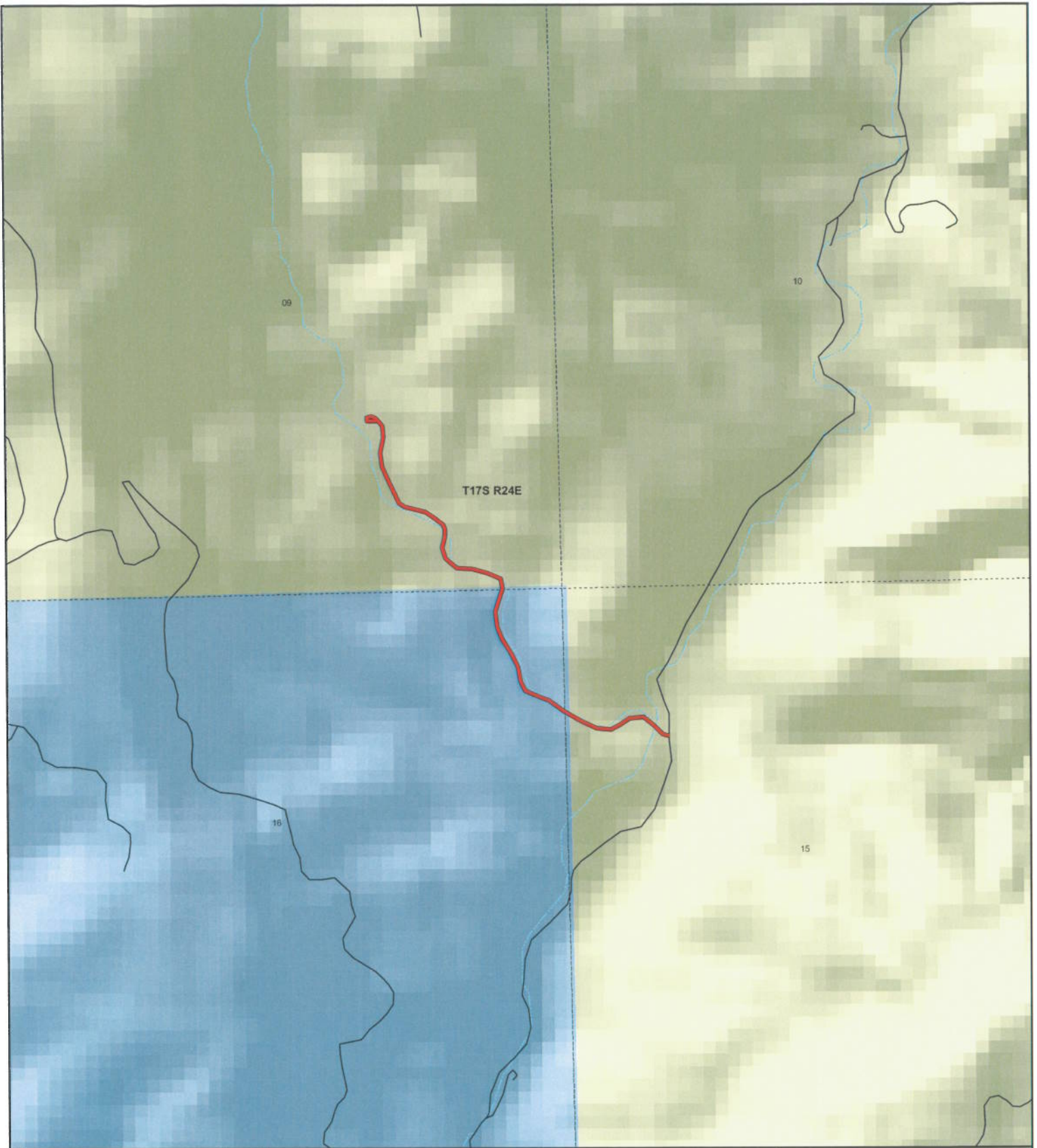

**Bryson Gas Field
County Unique - 00199**

Land Ownership Categories

- ◆ BLM
- ◆ US Forest Service
- ◆ Private
- ◆ State Lands
- ◆ National Parks (NPS)
- ◆ Wilderness
- ◆ National Recreation Area
- ◆ State Parks
- ◆ State Sovereign Land
- ◆ Tribal Lands
- ◆ Military
- ◆ Wildlife Reserve

Transportation Network

- Bryson Gas Field
- State / U.S. Highway
- Local Roads

Misc

- City / Town
- Municipalities
- Section = 1 Mile

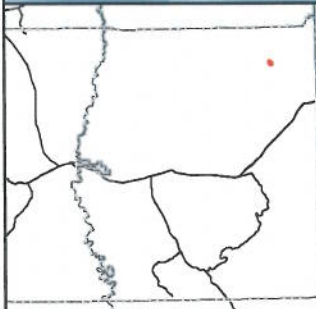

1:11,147
1 inch equals 0.2 miles



Map prepared by the State of Utah
AGRC
Room 5130 State Office Building
Salt Lake City, Utah 84114
Jul 25, 2007



AFFIDAVIT OF CHARLES E. ROBERTS

BRYSON GAS FIELD ROAD

COUNTY ROAD NUMBER 00199

GRAND COUNTY, UTAH

State of Colorado)
 : ss.
County of Mesa)

CHARLES E. ROBERTS, being first duly sworn, deposes and states as follows:

1. I am an adult competent to testify about the matters set forth below based upon my personal knowledge. Currently reside in Mack, Mesa County, Colorado. I have lived in Mesa County since 1948. I have worked and hunted in the Book Cliff area of Eastern Grand County, Utah since 1948.

2. I have traveled and am familiar with a road in Grand County known as Bryson Gas Field Road. I am also familiar with the land the road traverses. When I first used and observed the road in the early 1960s, it followed the same route as in 2003 when I last observed it. Attached is a Grand County map showing Bryson Gas Field Road. To the best of my knowledge and based upon my use of and familiarity with this road and the land it traverses, the location and route of the road are correctly illustrated on the attached map. The County also identifies this road according to the road number listed above.

3. I have observed that the road has been open to the public for all to use, to come and go as they pleased, since at least as early as the early 1960s and continuing through 1976 to 2003. Throughout this time period I have observed travel on the road by various means, including ATVs, trucks and jeeps. Throughout this time period, the road

has been used weekly, weather permitting, for more than ten continuous years prior to 1976, and was so used in 2003.

4. Throughout the time period from the early 1960s to 2003, I have used the road myself for hunting, oil field work, sightseeing and recreation.

5. Throughout the time period described in the previous paragraph, I observed vehicles using the road at various times for the uses described in the previous paragraph, plus livestock operations, rock hounding, wood gathering and oil and gas exploration.

6. It is also the reputation in the community that this road has been open to the public for all to use, to come and go as they pleased, since at least as early as the 1950s and continuing through 1976 to the present, for the uses described in the previous paragraphs.

7. Prior to 1976, I observed the graded surface of the road.

Dated this 7 day of September, 2007.



CHARLES E. ROBERTS

SUBSCRIBED AND SWORN to before me this 7th day of September, 2007.

NOTARY PUBLIC

My Commission Expires: 1/27/2011

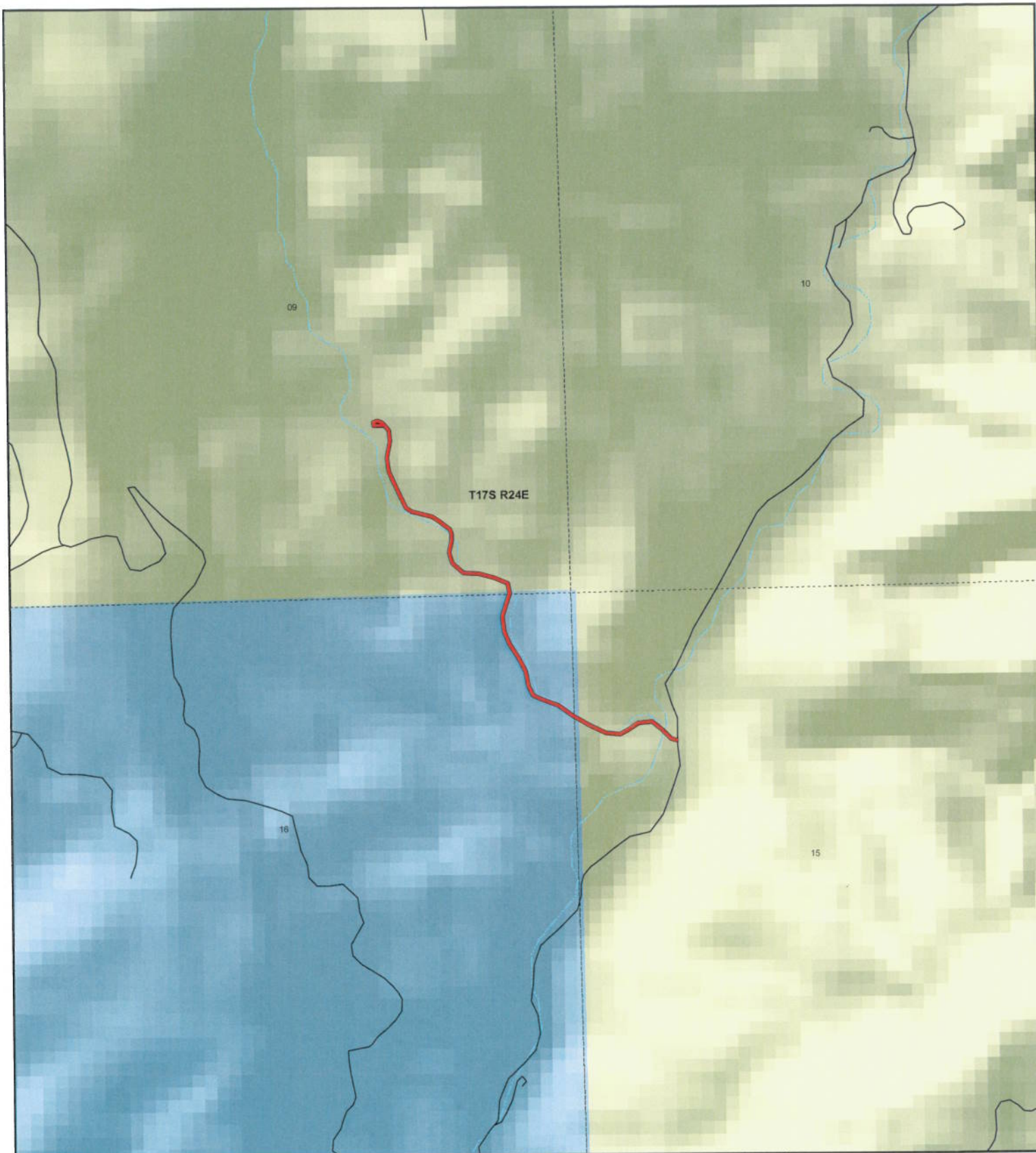



**Bryson Gas Field
County Unique - 00199**

Land Ownership Categories

- ◆ BLM
- ◆ US Forest Service
- ◆ Private
- ◆ State Lands
- ◆ National Parks (NPS)
- ◆ Wilderness
- ◆ National Recreation Area
- ◆ State Parks
- ◆ State Sovereign Land
- ◆ Tribal Lands
- ◆ Military
- ◆ Wildlife Reserve

Transportation Network

- Bryson Gas Field
- State / U.S. Highway
- Local Roads

Misc

- City / Town
- Municipalities
- Section = 1 Mile

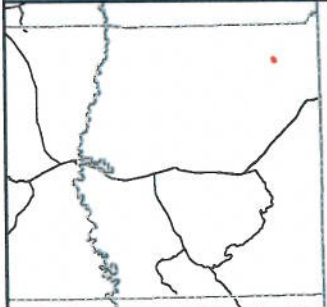

1:11,147
1 inch equals 0.2 miles



Map prepared by the State of Utah
AGRC
Room 5130 State Office Building
Salt Lake City, Utah 84114
Jul 25, 2007



Appendix A to Attachment 4

Popular Name: BRYSON GAS FIELD ROAD

County: Grand

County Road Number: 00199

State Geographic Information Database (SGID) Road Identification Number: RD100090.

Road-Segment Number: 001

Road-Segment Length: 0.16 miles more or less.

Believed owner of the land underlying this road-segment is: Bureau of Land Management.

The following description is based upon the geographic coordinate system using the NAD83 Datum. The source is GPS mapping grade data as indicated in the metadata and/or the transportation data model of the State of Utah Geographic Information Database (SGID).

The road-segment itself is the monument that is identified by its physical presence on the land. The location of said physical presence is closely approximated by mapping grade Global Positioning System (GPS) data. Said data are checked against the corresponding gray-scale 1-meter Digital Orthophoto Quadrangles published by the United States Geological Survey (USGS) to verify a reasonable degree of accuracy. In circumstances where accurate satellite signal acquisition is not possible, such as deep, narrow canyons or under a canopy of dense foliage, or where very sharp curves in the road make accuracy questionable, such portions of the road were digitized from the corresponding gray-scale 1-meter Digital Orthophoto Quadrangles published by the United States Geological Survey (USGS).

This road-segment may traverse:

Township 17 South Range 24 East, Section(s) 15, Salt Lake Base & Meridian

The following description closely approximates the location of the centerline of the physical monument (BRYSON GAS FIELD ROAD)-- Segment 001 based on mapping grade Global Positioning System (GPS) data as defined above:

Beginning at a point on the road center line located at 39 degrees 19 minutes 56.98 seconds North Latitude and -109 degrees 15 minutes 15.13 seconds West Longitude, which can be converted to mapping accuracy State Plane Utah Central Zone NAD 83 feet coordinates of X = 2,275,583.1 feet and Y = 6,933,571.0 feet; thence the following courses along the said road center line:

thence North 76 Degrees 28 Minutes 00 Seconds West 47.9 feet

thence North 45 Degrees 53 Minutes 05 Seconds West 91.4 feet

thence North 48 Degrees 56 Minutes 02 Seconds West 96.8 feet

thence South 83 Degrees 15 Minutes 11 Seconds West 102.8 feet

thence South 56 Degrees 58 Minutes 17 Seconds West 85 feet

thence South 61 Degrees 35 Minutes 55 Seconds West 73.2 feet

thence North 85 Degrees 43 Minutes 16 Seconds West 102 feet

thence North 65 Degrees 12 Minutes 38 Seconds West 127.5 feet

thence North 59 Degrees 36 Minutes 20 Seconds West 95 feet more or less to **the ending point**

at: 39 degrees 19 minutes 58.68 seconds North Latitude and -109 degrees 15 minutes 24.27 seconds West Longitude, which can be converted to mapping accuracy State Plane Utah Central Zone NAD 83 feet

coordinates of X = 2,274,860.7 feet and Y = 6,933,725.3 feet.

Appendix B to Attachment 4

Popular Name: BRYSON GAS FIELD ROAD

County: Grand

County Road Number: 00199

State Geographic Information Database (SGID) Road Identification Number: RD100090.

Road-Segment Number: 003

Road-Segment Length: 0.33 miles more or less.

Believed owner of the land underlying this road-segment is: Bureau of Land Management.

The following description is based upon the geographic coordinate system using the NAD83 Datum. The source is GPS mapping grade data as indicated in the metadata and/or the transportation data model of the State of Utah Geographic Information Database (SGID).

The road-segment itself is the monument that is identified by its physical presence on the land. The location of said physical presence is closely approximated by mapping grade Global Positioning System (GPS) data. Said data are checked against the corresponding gray-scale 1-meter Digital Orthophoto Quadrangles published by the United States Geological Survey (USGS) to verify a reasonable degree of accuracy. In circumstances where accurate satellite signal acquisition is not possible, such as deep, narrow canyons or under a canopy of dense foliage, or where very sharp curves in the road make accuracy questionable, such portions of the road were digitized from the corresponding gray-scale 1-meter Digital Orthophoto Quadrangles published by the United States Geological Survey (USGS).

This road-segment may traverse:

Township 17 South Range 24 East, Section(s) 9, Salt Lake Base & Meridian

The following description closely approximates the location of the centerline of the physical monument (BRYSON GAS FIELD ROAD)-- Segment 003 based on mapping grade Global Positioning System (GPS) data as defined above:

Beginning at a point on the road center line located at 39 degrees 20 minutes 07.94 seconds North Latitude and -109 degrees 15 minutes 30.23 seconds West Longitude, which can be converted to mapping accuracy State Plane Utah Central Zone NAD 83 feet coordinates of X = 2,274,369.2 feet and Y = 6,934,650.0 feet; thence the following courses along the said road center line:

thence North 12 Degrees 40 Minutes 42 Seconds West 60.5 feet
thence North 67 Degrees 19 Minutes 01 Seconds West 100.7 feet
thence North 74 Degrees 34 Minutes 47 Seconds West 114.8 feet
thence North 87 Degrees 00 Minutes 50 Seconds West 113.4 feet
thence North 48 Degrees 02 Minutes 46 Seconds West 107.3 feet
thence North 18 Degrees 49 Minutes 08 Seconds West 79.6 feet
thence North 12 Degrees 47 Minutes 18 Seconds East 87.6 feet
thence North 00 Degrees 03 Minutes 51 Seconds West 49.2 feet
thence North 19 Degrees 06 Minutes 35 Seconds West 36.4 feet
thence North 53 Degrees 51 Minutes 45 Seconds West 46.9 feet
thence North 52 Degrees 56 Minutes 16 Seconds West 45.9 feet

thence North 56 Degrees 38 Minutes 30 Seconds West 68 feet
thence North 77 Degrees 49 Minutes 56 Seconds West 83.4 feet
thence North 74 Degrees 52 Minutes 01 Seconds West 67.7 feet
thence North 56 Degrees 45 Minutes 56 Seconds West 50.4 feet
thence North 26 Degrees 01 Minutes 55 Seconds West 85.6 feet
thence North 25 Degrees 59 Minutes 20 Seconds West 103.7 feet
thence North 24 Degrees 08 Minutes 00 Seconds West 98.6 feet
thence North 06 Degrees 46 Minutes 23 Seconds West 102.4 feet
thence North 10 Degrees 40 Minutes 18 Seconds East 120.3 feet
thence North 07 Degrees 00 Minutes 34 Seconds West 79.3 feet
thence North 40 Degrees 12 Minutes 32 Seconds West 47 feet more or less to **the ending point**

at: 39 degrees 20 minutes 20.03 seconds North Latitude and -109 degrees 15 minutes 41.32 seconds West Longitude, which can be converted to mapping accuracy State Plane Utah Central Zone NAD 83 feet coordinates of X = 2,273,467.5 feet and Y = 6,935,850.6 feet.

Appendix C to Attachment 4

Popular Name: BRYSON GAS FIELD ROAD

County: Grand

County Road Number: 00199

State Geographic Information Database (SGID) Road Identification Number: RD100090.

Road-Segment Number: 004

Road-Segment Length: 0.04 miles more or less.

Believed owner of the land underlying this road-segment is: Bureau of Land Management.

The following description is based upon the geographic coordinate system using the NAD83 Datum. The source is GPS mapping grade data as indicated in the metadata and/or the transportation data model of the State of Utah Geographic Information Database (SGID).

The road-segment itself is the monument that is identified by its physical presence on the land. The location of said physical presence is closely approximated by mapping grade Global Positioning System (GPS) data. Said data are checked against the corresponding gray-scale 1-meter Digital Orthophoto Quadrangles published by the United States Geological Survey (USGS) to verify a reasonable degree of accuracy. In circumstances where accurate satellite signal acquisition is not possible, such as deep, narrow canyons or under a canopy of dense foliage, or where very sharp curves in the road make accuracy questionable, such portions of the road were digitized from the corresponding gray-scale 1-meter Digital Orthophoto Quadrangles published by the United States Geological Survey (USGS).

This road-segment may traverse:

Township 17 South Range 24 East, Section(s) 9, Salt Lake Base & Meridian

The following description closely approximates the location of the centerline of the physical monument (BRYSON GAS FIELD ROAD)-- Segment 004 based on mapping grade Global Positioning System (GPS) data as defined above:

Beginning at a point on the road center line located at 39 degrees 20 minutes 20.03 seconds North Latitude and -109 degrees 15 minutes 41.32 seconds West Longitude, which can be converted to mapping accuracy State Plane Utah Central Zone NAD 83 feet coordinates of X = 2,273,467.5 feet and Y = 6,935,850.6 feet; thence the following courses along the said road center line:

thence North 37 Degrees 12 Minutes 05 Seconds West 8.2 feet

thence North 46 Degrees 52 Minutes 47 Seconds West 21.5 feet

thence North 64 Degrees 37 Minutes 40 Seconds West 30.3 feet

thence South 72 Degrees 27 Minutes 57 Seconds West 33.3 feet

thence South 09 Degrees 01 Minutes 20 Seconds East 23.2 feet

thence South 89 Degrees 05 Minutes 45 Seconds East 76.1 feet more or less to **the ending**

point at: 39 degrees 20 minutes 20.03 seconds North Latitude and -109 degrees 15 minutes 41.32 seconds West Longitude, which can be converted to mapping accuracy State Plane Utah Central Zone NAD 83 feet coordinates of X = 2,273,467.5 feet and Y = 6,935,850.6 feet.