

**Acknowledgment and
Notice of Acknowledgment
of Acceptance of R.S. 2477
Right-of-Way Grant**

Ent 486424 Bk 731 Pg 65 - 78
Date: 27-MAY-2008 1:37PM
Fee: None
Filed By: PL
MERLENE MOSHER DALTON, Recorder
GRAND COUNTY CORPORATION
For: STATE OF UTAH

THE STATE OF UTAH

TO ALL WHOM THESE PRESENTS SHALL COME, Greeting:

Know ye, This is an Acknowledgment and Notice of Acknowledgment made under Utah Code Sections 72-5-309 through 310 inclusive, that the grant of the United States of America of “the right of way for the construction of highways over public lands, not reserved for public uses” under United States Revised Statutes 2477 (43 U.S.C. Section 932 (repealed October 21, 1976, with proviso recognizing the validity of rights-of-way already established)) was accepted for and on behalf of the State of Utah and its political subdivision Grand County as it pertains to the highway located in Grand County known as MESA WELLS 1 ROAD; County Road Number: 00240; State Geographic Information Database (SGID) Road Identification Number: RD100118. Total road length is 3.58 miles more or less.

The reason for this Acknowledgment and Notice of Acknowledgment includes, but is not limited to, the fact that the road was constructed, mechanically, or by continuous use as a public highway for a period of at least ten years, over public lands not reserved for public uses, prior to the earlier of (a) the October 21, 1976 repeal of R.S. 2477 or (b) the date the servient estate was reserved for public uses.

This Acknowledgment and Notice of Acknowledgment applies only to the segments of the road that traverse land owned by the Bureau of Land Management, United States Department of the Interior, and does not apply to segments of the road that traverse land owned by any other person or entity. The State of Utah and its political subdivisions reserve the right to make further acknowledgments and notices of acknowledgment with regard to road segments that traverse land owned by other entities, including the United States of America, through one or more of its agencies.

A printed copy of a map showing the location of the road in said county is appended hereto as “Attachment 1,” a printed copy of representative photos of the road is appended hereto as “Attachment 2,” a printed copy of a description of the beginning and ending points of the entire road together with a list of Townships, Ranges and Sections that may be traversed by the road in said county is appended hereto as “Attachment 3,” and a printed copy of the Road Centerline Description Cover Page(s) is appended hereto as “Attachment 4.” The Appendices listed in “Attachment 4” that contain the actual road centerline descriptions are incorporated herein by reference. Affidavits provided by individuals familiar with the road are appended hereto as “Attachment 5.”

A printed copy of this Acknowledgment and Notice of Acknowledgment, together with its Attachments and Appendices, may be viewed and/or obtained at the office of the Utah State Archives.

An electronic copy of this Acknowledgment and Notice of Acknowledgment, together with its Attachments and Appendices, may be viewed and/or downloaded as read-only PDF (Portable Document Format) files via the

Internet at <http://recorded2477roads.utah.gov>.

The owner of the servient estate in the land underlying the road-segments subject to this Acknowledgment and Notice is believed to be the United States of America through one or more of its agencies. Any of such agencies or any other person with a servient ownership claim or a competing dominant estate right-of-way ownership claim, may file a petition in the State District Court for Salt Lake County for a decision regarding the correctness of this Acknowledgment. A claimant shall file a petition within sixty (60) days after receipt of this Notice.

In Witness Whereof, I, John Harja, the official designee of the Governor of the State of Utah, in conformity to the laws of the State (Utah Code Sections 72-5-308 through 310 inclusive), have caused this Acknowledgment and Notice of Acknowledgment to be made.

Signed by my hand in Salt Lake City, Utah, the 22nd day of MAY, 2008.

By the Governor's Designee



John Harja

CERTIFICATION

State of Utah)
 : ss
County of Salt Lake)

I hereby certify that the signer of the foregoing document, John Harja, is personally known by me, has made a voluntary signature and taken an oath stating that he is the official designee of the Governor of the State of Utah and is authorized to sign this document on the Governor's behalf pursuant to Utah Code Section 72-5-309. He further vouched that, based upon information and belief, the facts alleged therein are true.



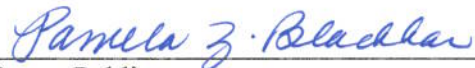

Dated this 22nd day of May, 2008.



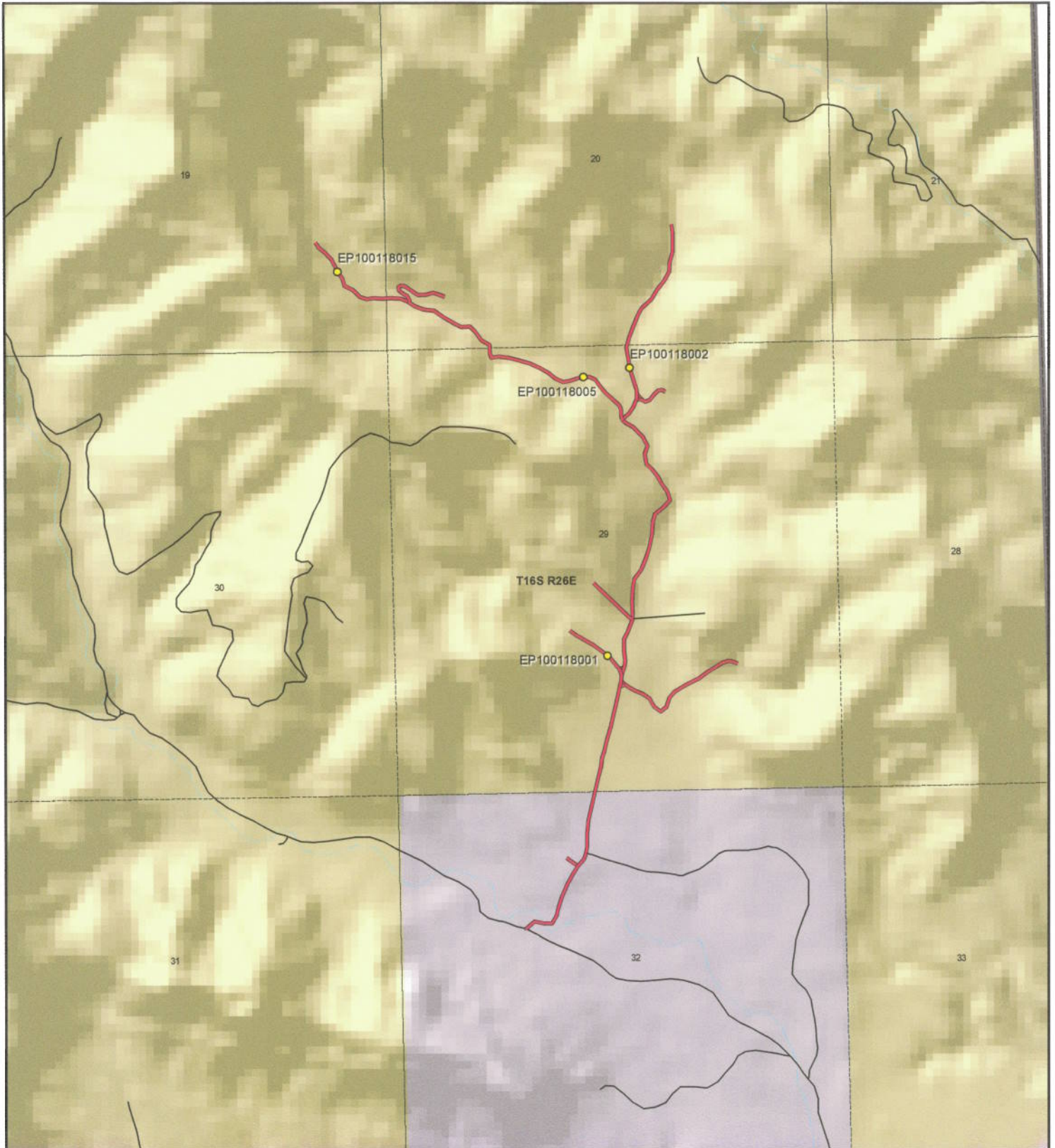

Notary Public



 <p>1:18,527 1 inch equals 0.3 miles</p>		<p style="text-align: center;">Mesa Wells 1 Road - Grand County SGID RD_ID RD100118</p> <table border="0"> <tr> <th colspan="2">Land Ownership Categories</th> <th>Transportation Network</th> </tr> <tr> <td> BLM</td> <td> Wilderness</td> <td> Mesa Wells 1 Road</td> </tr> <tr> <td> Private</td> <td> UDWR Wildlife Reserve</td> <td> Title V: Issued Or Under Consideration By BLM Or County</td> </tr> <tr> <td> SITLA, State Trust Land</td> <td> DOD, Military</td> <td> Other Roads</td> </tr> <tr> <td> USFS, National Forest</td> <td> State Sovereign Land</td> <td> Photo Event Point</td> </tr> <tr> <td> State Parks and Recreation</td> <td> National Recreation Area</td> <td> Section = 1 Mile</td> </tr> <tr> <td> Tribal, Indian Reservation</td> <td> USFWS, Natl. Wildlife Refuge</td> <td></td> </tr> <tr> <td> NPS, National Park</td> <td></td> <td></td> </tr> </table>	Land Ownership Categories		Transportation Network	BLM	Wilderness	Mesa Wells 1 Road	Private	UDWR Wildlife Reserve	Title V: Issued Or Under Consideration By BLM Or County	SITLA, State Trust Land	DOD, Military	Other Roads	USFS, National Forest	State Sovereign Land	Photo Event Point	State Parks and Recreation	National Recreation Area	Section = 1 Mile	Tribal, Indian Reservation	USFWS, Natl. Wildlife Refuge		NPS, National Park			<p>Map prepared by the State of Utah Automated Geographic Reference Center Room 5130 State Office Building Salt Lake City, Utah 84114 Apr 10, 2008</p>  
Land Ownership Categories		Transportation Network																									
BLM	Wilderness	Mesa Wells 1 Road																									
Private	UDWR Wildlife Reserve	Title V: Issued Or Under Consideration By BLM Or County																									
SITLA, State Trust Land	DOD, Military	Other Roads																									
USFS, National Forest	State Sovereign Land	Photo Event Point																									
State Parks and Recreation	National Recreation Area	Section = 1 Mile																									
Tribal, Indian Reservation	USFWS, Natl. Wildlife Refuge																										
NPS, National Park																											

Attachment 2



EP100118001



EP100118002



EP100118005



EP100118015

EP000000000

Ent 486424 Bk 0731 Pg 0068

EP000000000

Mesa Wells 1 Road - Grand County
SGID RD_ID RD100118



Map prepared by the State of Utah
Automated Geographic Reference Center
Room 5130 State Office Building
Salt Lake City, Utah 84114
April 14, 2008



Attachment 3

Beginning & Ending Points and Township, Range, and Section References For:

Popular Name: MESA WELLS 1 ROAD

County: Grand

County Road Number: 00240

State Geographic Information Database (SGID) Road Identification Number: RD100118.

Total Road Length: 3.58 miles more or less.

Beginning at a point on the road centerline located at 39 degrees 22 minutes 030.6 seconds North Latitude and -109 degrees 04 minutes 23.29 seconds West Longitude, which can be converted to mapping accuracy State Plane Utah Central Zone NAD 83 feet coordinates of X = 2,326,359.0 feet and Y = 6,950,445.6 feet based on the US Survey Foot conversion.

Ending at a point on the road centerline located at 39 degrees 23 minutes 05.43 seconds North Latitude and -109 degrees 04 minutes 15.78 seconds West Longitude, which can be converted to mapping accuracy State Plane Utah Central Zone NAD 83 feet coordinates of X = 2,326,852.8 feet and Y = 6,953,983.6 feet based on the US Survey Foot conversion.

This road may traverse:

Township 16 South Range 26 East, Section(s) 19,20,29,32, Salt Lake Base & Meridian
See Attachment 1 above for a cartographic depiction of the course of this road.

**Attachment 4
Road Centerline Description Cover Page(s)**

Popular Name: MESA WELLS 1 ROAD

County: Grand

County Road Number: 00240

State Geographic Information Database (SGID) Road Identification Number: RD100118.

Total Road Length: 3.58 miles more or less.

Centerline Descriptions Of Road-Segments That Cross Over Federally Owned Land, Derived From Global Positioning System Data And Cross-checked against USGS Digital Orthophoto Quadrangles Compiled By The Utah Automated Geographic Reference Center And Entered Into The State Geographic Information Database (SGID).

Road-Segments Listed by SGID Road Identification Number (RD_ID)	Road-Segment Numbers	Believed Ownership Of Servient Estate	Approximate Segment Length	See Attached Appendix
RD100118	001	PVT	0.21 Miles	(not shown)
RD100118	002	PVT	0.03 Miles	(not shown)
RD100118	003	PVT	0.18 Miles	(not shown)
RD100118	004	BLM	0.24 Miles	A
RD100118	005	BLM	0.01 Miles	B
RD100118	006	BLM	0.32 Miles	C
RD100118	007	BLM	0.01 Miles	D
RD100118	008	BLM	0.01 Miles	E
RD100118	009	BLM	0.01 Miles	F
RD100118	010	BLM	0.02 Miles	G
RD100118	011	BLM	0.02 Miles	H
RD100118	012	BLM	0.02 Miles	I
RD100118	013	BLM	0.11 Miles	J
RD100118	014	BLM	0.52 Miles	K
RD100118	015	BLM	0.05 Miles	L
RD100118	016	BLM	0.01 Miles	M
RD100118	017	BLM	0.02 Miles	N
RD100118	018	BLM	0.02 Miles	O
RD100118	019	BLM	0.41 Miles	P
RD100118	020	BLM	0.06 Miles	Q
RD100118	021	BLM	0.6 Miles	R
RD100118	022	BLM	0.16 Miles	S
RD100118	023	BLM	0.28 Miles	T
RD100118	024	BLM	0.12 Miles	U

RD100118	025	BLM	0.14 Miles	V
		Total Road Length	3.58	_____

* Indicates that a Title V permit will be requested, is in process, or has been issued.

† Indicates that road-segments crossing Forest Service land are under consideration by the state and county as of the date of this Acknowledgment and Notice of Acknowledgment.

Attachment 5

Ent 486424 Bk 0731 Pg 0072

AFFIDAVIT OF CHARLES E. ROBERTS

MESA WELLS 1 ROAD

GRAND COUNTY, UTAH

ROAD NUMBER 00240

State of Colorado)
 : ss.
County of Mesa)

CHARLES E. ROBERTS, being first duly sworn, deposes and states as follows:

1. I am an adult competent to testify about the matters set forth below based upon my personal knowledge. I currently reside in Mack, Mesa County, Colorado. I have lived in Mesa County since 1948. I have worked and hunted in the Book Cliff area of Eastern Gand County, Utah since 1948.

2. I have traveled and am familiar with a road in Grand County known as Mesa Wells 1 Road. I am also familiar with the land the road traverses. When I first used and observed the road in the late 1950s it followed the same route as in 2007 when I last observed it. Attached is a Grand County map showing Mesa Wells 1 Road. To the best of my knowledge and based upon my use of and familiarity with this road and the land it traverses, the location and route of the road are correctly illustrated on the attached map.

3. I am informed that Gand County also identifies this road according to the road number listed above.

4. I have observed that the road has been open to the public for all to use, to come and go as they pleased, since at least as early as the late 1950s and continuing through the 2007. Throughout this time period I observed travel on the road by means of cars, mountain bikes, jeeps, pickup trucks and ATVs. During this time period, the road was used daily for more than ten continuous years prior to 1976 and was used daily in 2007.

5. Throughout the time period from the late 1950s to 2007, I used the road myself for hunting, oil field work sightseeing and recreation.

6. Throughout the time period described in the previous paragraph, I have observed other vehicles from the general public using the road at various times for the uses described in the previous paragraph plus, livestock operations, rock hounding, wood gathering, oil and gas exploration and development and sightseeing.

7. It is also the reputation in the community that this road has been open to the public for all to use, to come and go as they pleased, since at least as early as the early 1900s and continuing through 1976 to the present, for the uses described in the previous paragraphs.

8. Prior to 1976, I observed the graded surface of the road and evidence of maintenance and construction such as windrows along the side of the road.

DATED this 7 day of September, 2007.



CHARLES E. ROBERTS

SUBSCRIBED AND SWORN to before me this 7th day of September, 2007.

NETTIE J. REED
NOTARY PUBLIC

My commission expires: 1/27/2011

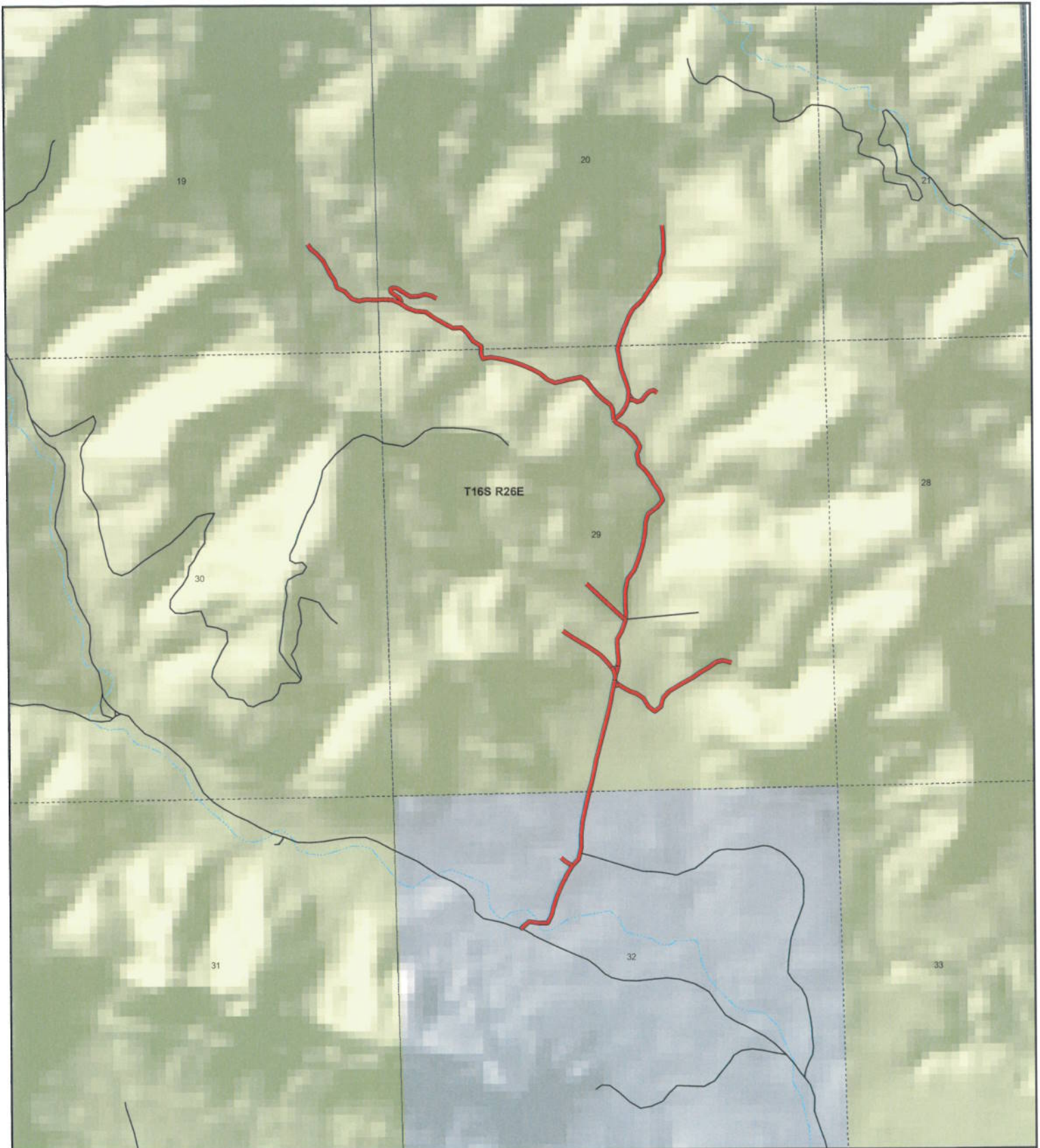



**Mesa Wells 1
County Unique - 00240**

Land Ownership Categories

- ◆ BLM
- ◆ US Forest Service
- ◆ Private
- ◆ State Lands
- ◆ National Parks (NPS)
- ◆ Wilderness
- ◆ National Recreation Area
- ◆ State Parks
- ◆ State Sovereign Land
- ◆ Tribal Lands
- ◆ Military
- ◆ Wildlife Reserve

Transportation Network

- Mesa Wells 1
- State / U.S. Highway
- Local Roads

Misc

- City / Town
- Municipalities
- Section = 1 Mile



1:18,229

1 inch equals 0.3 miles

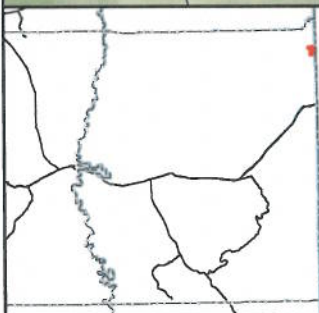

Map prepared by the State of Utah
AGRC
Room 5130 State Office Building
Salt Lake City, Utah 84114
Jul 26, 2007



AFFIDAVIT OF WILLIAM H. BUNIGER III

MESA WELLS 1ROAD

GRAND COUNTY, UTAH

ROAD NUMBER 00240

State of Colorado)
 : ss.
County of Mesa)

WILLIAM H. BUNIGER III, being first duly sworn, deposes and states as follows:

1. I am an adult competent to testify about the matters set forth below based upon my personal knowledge. I currently reside in Loma, Mesa County, Colorado. I have lived in Mesa County for 62 years. I have worked and hunted in the Book Cliff area of Eastern Gand County, Utah for at least 50 years.

2. I have traveled and am familiar with a road in Grand County known as Mesa Wells 1 Road. I am also familiar with the land the road traverses. When I first used and observed the road in the early 1960s it followed the same route as in 2007 when I last observed it. Attached is a Grand County map showing Mesa Wells 1 Road. To the best of my knowledge and based upon my use of and familiarity with this road and the land it traverses, the location and route of the road are correctly illustrated on the attached map.

3. I am informed that Gand County also identifies this road according to the road number listed above.

4. I have observed that the road has been open to the public for all to use, to come and go as they pleased, since at least as early as the early 1960s and continuing through 2007. Throughout this time period I observed travel on the road by means of cars, mountain bikes, jeeps, pickup trucks and ATVs. During this time period, the road was used daily for more than ten continuous years prior to 1976 and was used daily in 2007.

5. Throughout the time period from the early 1960s to 2007, I used the road myself for oil field work and recreation.

6. Throughout the time period described in the previous paragraph, I have observed other vehicles from the general public using the road at various times for the uses described in the previous paragraph plus, livestock operations, rock hounding, wood gathering, oil and gas exploration and development and sightseeing.

7. It is also the reputation in the community that this road has been open to the public for all to use, to come and go as they pleased, since at least as early as the early 1900s and continuing through 1976 to the present, for the uses described in the previous paragraphs.

8. Prior to 1976, I observed the graded surface of the road and evidence of maintenance and construction such as windrows along the side of the road.

DATED this 7 day of September, 2007.



WILLIAM H. BUNIGER III

SUBSCRIBED AND SWORN to before me this 7th day of September, 2007.

NETTIE J. REED
NOTARY PUBLIC

My commission expires: 11/27/2011

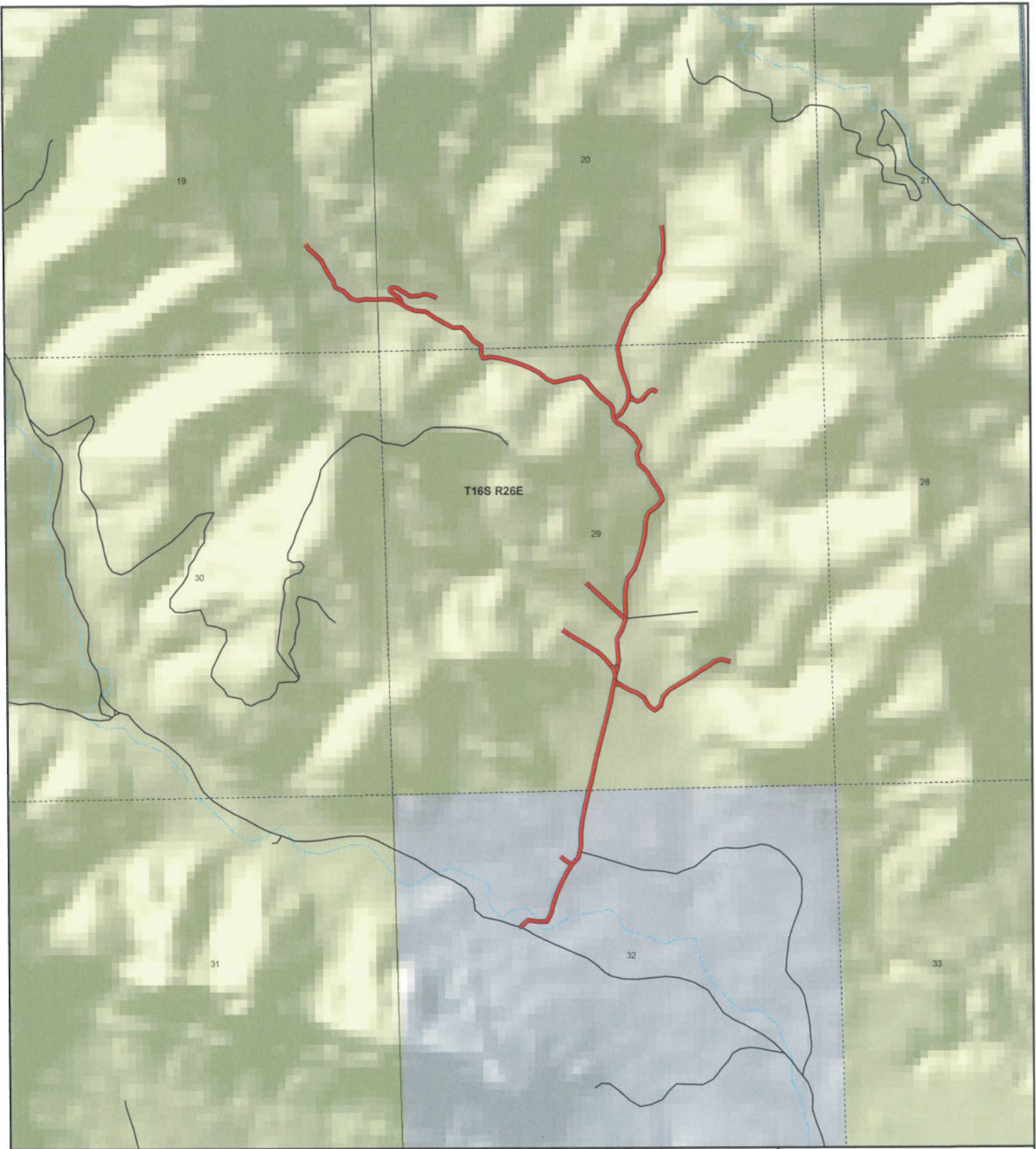



**Mesa Wells 1
County Unique - 00240**

Land Ownership Categories

- ◆ BLM
- ◆ US Forest Service
- ◆ Private
- ◆ State Lands
- ◆ National Parks (NPS)
- ◆ Wilderness
- ◆ National Recreation Area
- ◆ State Parks
- ◆ State Sovereign Land
- ◆ Tribal Lands
- ◆ Military
- ◆ Wildlife Reserve

Transportation Network

- Mesa Wells 1
- State / U.S. Highway
- Local Roads

Misc

- City / Town
- ⊙ Municipalities
- ⊞ Section = 1 Mile



1:18,229
1 inch equals 0.3 miles

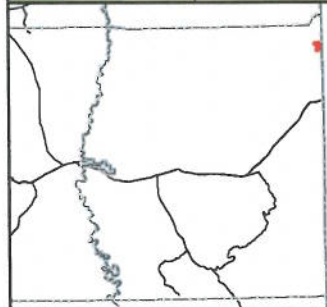

Map prepared by the State of Utah
AGRC
Room 5130 State Office Building
Salt Lake City, Utah 84114
Jul 25, 2007



Pg 0078

Appendix A to Attachment 4

Popular Name: MESA WELLS 1 ROAD

County: Grand

County Road Number: 00240

State Geographic Information Database (SGID) Road Identification Number: RD100118.

Road-Segment Number: 004

Road-Segment Length: 0.24 miles more or less.

Believed owner of the land underlying this road-segment is: Bureau of Land Management.

The following description is based upon the geographic coordinate system using the NAD83 Datum. The source is GPS mapping grade data as indicated in the metadata and/or the transportation data model of the State of Utah Geographic Information Database (SGID).

The road-segment itself is the monument that is identified by its physical presence on the land. The location of said physical presence is closely approximated by mapping grade Global Positioning System (GPS) data. Said data are checked against the corresponding gray-scale 1-meter Digital Orthophoto Quadrangles published by the United States Geological Survey (USGS) to verify a reasonable degree of accuracy. In circumstances where accurate satellite signal acquisition is not possible, such as deep, narrow canyons or under a canopy of dense foliage, or where very sharp curves in the road make accuracy questionable, such portions of the road were digitized from the corresponding gray-scale 1-meter Digital Orthophoto Quadrangles published by the United States Geological Survey (USGS).

This road-segment may traverse:

Township 16 South Range 26 East, Section(s) 29, Salt Lake Base & Meridian

The following description closely approximates the location of the centerline of the physical monument (MESA WELLS 1 ROAD)-- Segment 004 based on mapping grade Global Positioning System (GPS) data as defined above:

Beginning at a point on the road center line located at 39 degrees 22 minutes 046.5 seconds North Latitude and -109 degrees 04 minutes 12.49 seconds West Longitude, which can be converted to mapping accuracy State Plane Utah Central Zone NAD 83 feet coordinates of X = 2,327,163.4 feet and Y = 6,952,076.1 feet; thence the following courses along the said road center line:

thence North 13 Degrees 45 Minutes 30 Seconds East 118.2 feet

thence North 12 Degrees 47 Minutes 13 Seconds East 160 feet

thence North 09 Degrees 37 Minutes 50 Seconds East 114.9 feet

thence North 14 Degrees 29 Minutes 33 Seconds East 101.8 feet

thence North 14 Degrees 26 Minutes 27 Seconds East 137.4 feet

thence North 14 Degrees 00 Minutes 13 Seconds East 152.4 feet

thence North 14 Degrees 04 Minutes 37 Seconds East 154.1 feet

thence North 13 Degrees 04 Minutes 28 Seconds East 143.3 feet

thence North 11 Degrees 43 Minutes 48 Seconds East 127.5 feet

thence North 09 Degrees 20 Minutes 29 Seconds East 73.2 feet more or less to **the ending**

point at: 39 degrees 22 minutes 58.77 seconds North Latitude and -109 degrees 04 minutes 8.4 seconds West

Longitude, which can be converted to mapping accuracy State Plane Utah Central Zone NAD 83 feet
coordinates of X = 2,327,450.5 feet and Y = 6,953,325.9 feet.

Appendix B to Attachment 4

Popular Name: MESA WELLS 1 ROAD

County: Grand

County Road Number: 00240

State Geographic Information Database (SGID) Road Identification Number: RD100118.

Road-Segment Number: 005

Road-Segment Length: 0.01 miles more or less.

Believed owner of the land underlying this road-segment is: Bureau of Land Management.

The following description is based upon the geographic coordinate system using the NAD83 Datum. The source is GPS mapping grade data as indicated in the metadata and/or the transportation data model of the State of Utah Geographic Information Database (SGID).

The road-segment itself is the monument that is identified by its physical presence on the land. The location of said physical presence is closely approximated by mapping grade Global Positioning System (GPS) data. Said data are checked against the corresponding gray-scale 1-meter Digital Orthophoto Quadrangles published by the United States Geological Survey (USGS) to verify a reasonable degree of accuracy. In circumstances where accurate satellite signal acquisition is not possible, such as deep, narrow canyons or under a canopy of dense foliage, or where very sharp curves in the road make accuracy questionable, such portions of the road were digitized from the corresponding gray-scale 1-meter Digital Orthophoto Quadrangles published by the United States Geological Survey (USGS).

This road-segment may traverse:

Township 16 South Range 26 East, Section(s) 29, Salt Lake Base & Meridian

The following description closely approximates the location of the centerline of the physical monument (MESA WELLS 1 ROAD)-- Segment 005 based on mapping grade Global Positioning System (GPS) data as defined above:

Beginning at a point on the road center line located at 39 degrees 22 minutes 58.77 seconds North Latitude and -109 degrees 04 minutes 8.4 seconds West Longitude, which can be converted to mapping accuracy State Plane Utah Central Zone NAD 83 feet coordinates of X = 2,327,450.5 feet and Y = 6,953,325.9 feet; thence the following courses along the said road center line:

thence North 79 Degrees 40 Minutes 59 Seconds East 66.2 feet more or less to **the ending point at:** 39 degrees 22 minutes 58.87 seconds North Latitude and -109 degrees 04 minutes 07.56 seconds West Longitude, which can be converted to mapping accuracy State Plane Utah Central Zone NAD 83 feet coordinates of X = 2,327,515.6 feet and Y = 6,953,337.8 feet.

Appendix C to Attachment 4

Popular Name: MESA WELLS 1 ROAD

County: Grand

County Road Number: 00240

State Geographic Information Database (SGID) Road Identification Number: RD100118.

Road-Segment Number: 006

Road-Segment Length: 0.32 miles more or less.

Believed owner of the land underlying this road-segment is: Bureau of Land Management.

The following description is based upon the geographic coordinate system using the NAD83 Datum. The source is GPS mapping grade data as indicated in the metadata and/or the transportation data model of the State of Utah Geographic Information Database (SGID).

The road-segment itself is the monument that is identified by its physical presence on the land. The location of said physical presence is closely approximated by mapping grade Global Positioning System (GPS) data. Said data are checked against the corresponding gray-scale 1-meter Digital Orthophoto Quadrangles published by the United States Geological Survey (USGS) to verify a reasonable degree of accuracy. In circumstances where accurate satellite signal acquisition is not possible, such as deep, narrow canyons or under a canopy of dense foliage, or where very sharp curves in the road make accuracy questionable, such portions of the road were digitized from the corresponding gray-scale 1-meter Digital Orthophoto Quadrangles published by the United States Geological Survey (USGS).

This road-segment may traverse:

Township 16 South Range 26 East, Section(s) 29, Salt Lake Base & Meridian

The following description closely approximates the location of the centerline of the physical monument (MESA WELLS 1 ROAD)-- Segment 006 based on mapping grade Global Positioning System (GPS) data as defined above:

Beginning at a point on the road center line located at 39 degrees 22 minutes 58.87 seconds North Latitude and -109 degrees 04 minutes 07.56 seconds West Longitude, which can be converted to mapping accuracy State Plane Utah Central Zone NAD 83 feet coordinates of X = 2,327,515.6 feet and Y = 6,953,337.8 feet; thence the following courses along the said road center line:

thence South 58 Degrees 31 Minutes 06 Seconds East	62.2 feet
thence South 61 Degrees 25 Minutes 00 Seconds East	91.6 feet
thence South 70 Degrees 00 Minutes 31 Seconds East	70.8 feet
thence South 57 Degrees 14 Minutes 21 Seconds East	108.2 feet
thence South 30 Degrees 37 Minutes 40 Seconds East	115.9 feet
thence South 53 Degrees 10 Minutes 22 Seconds East	92.3 feet
thence North 51 Degrees 10 Minutes 43 Seconds East	89.6 feet
thence North 15 Degrees 31 Minutes 10 Seconds East	112.5 feet
thence North 40 Degrees 45 Minutes 55 Seconds East	95.8 feet
thence North 53 Degrees 10 Minutes 47 Seconds East	13.8 feet
thence North 60 Degrees 22 Minutes 39 Seconds East	50.3 feet

thence North 59 Degrees 45 Minutes 16 Seconds East 138.2 feet

thence North 61 Degrees 04 Minutes 23 Seconds East 137.1 feet

thence North 53 Degrees 45 Minutes 32 Seconds East 114.7 feet

thence North 59 Degrees 27 Minutes 41 Seconds East 114.1 feet

thence North 54 Degrees 14 Minutes 09 Seconds East 93.4 feet

thence North 71 Degrees 55 Minutes 31 Seconds East 80.7 feet

thence South 76 Degrees 42 Minutes 17 Seconds East 55.7 feet

thence South 70 Degrees 33 Minutes 30 Seconds East 58.2 feet more or less to **the ending**

point at: 39 degrees 23 minutes 01.13 seconds North Latitude and -109 degrees 03 minutes 050.5 seconds West Longitude, which can be converted to mapping accuracy State Plane Utah Central Zone NAD 83 feet coordinates of X = 2,328,848.6 feet and Y = 6,953,603.0 feet.

Appendix D to Attachment 4

Popular Name: MESA WELLS 1 ROAD

County: Grand

County Road Number: 00240

State Geographic Information Database (SGID) Road Identification Number: RD100118.

Road-Segment Number: 007

Road-Segment Length: 0.01 miles more or less.

Believed owner of the land underlying this road-segment is: Bureau of Land Management.

The following description is based upon the geographic coordinate system using the NAD83 Datum. The source is GPS mapping grade data as indicated in the metadata and/or the transportation data model of the State of Utah Geographic Information Database (SGID).

The road-segment itself is the monument that is identified by its physical presence on the land. The location of said physical presence is closely approximated by mapping grade Global Positioning System (GPS) data. Said data are checked against the corresponding gray-scale 1-meter Digital Orthophoto Quadrangles published by the United States Geological Survey (USGS) to verify a reasonable degree of accuracy. In circumstances where accurate satellite signal acquisition is not possible, such as deep, narrow canyons or under a canopy of dense foliage, or where very sharp curves in the road make accuracy questionable, such portions of the road were digitized from the corresponding gray-scale 1-meter Digital Orthophoto Quadrangles published by the United States Geological Survey (USGS).

This road-segment may traverse:

Township 16 South Range 26 East, Section(s) 29, Salt Lake Base & Meridian

The following description closely approximates the location of the centerline of the physical monument (MESA WELLS 1 ROAD)-- Segment 007 based on mapping grade Global Positioning System (GPS) data as defined above:

Beginning at a point on the road center line located at 39 degrees 22 minutes 58.87 seconds North Latitude and -109 degrees 04 minutes 07.56 seconds West Longitude, which can be converted to mapping accuracy State Plane Utah Central Zone NAD 83 feet coordinates of X = 2,327,515.6 feet and Y = 6,953,337.8 feet; thence the following courses along the said road center line:

thence North 52 Degrees 23 Minutes 14 Seconds West 21.3 feet

thence North 42 Degrees 02 Minutes 32 Seconds West 50.5 feet more or less to **the ending point at:** 39 degrees 22 minutes 59.38 seconds North Latitude and -109 degrees 04 minutes 08.19 seconds West Longitude, which can be converted to mapping accuracy State Plane Utah Central Zone NAD 83 feet coordinates of X = 2,327,464.9 feet and Y = 6,953,388.3 feet.

Appendix E to Attachment 4

Popular Name: MESA WELLS 1 ROAD

County: Grand

County Road Number: 00240

State Geographic Information Database (SGID) Road Identification Number: RD100118.

Road-Segment Number: 008

Road-Segment Length: 0.01 miles more or less.

Believed owner of the land underlying this road-segment is: Bureau of Land Management.

The following description is based upon the geographic coordinate system using the NAD83 Datum. The source is GPS mapping grade data as indicated in the metadata and/or the transportation data model of the State of Utah Geographic Information Database (SGID).

The road-segment itself is the monument that is identified by its physical presence on the land. The location of said physical presence is closely approximated by mapping grade Global Positioning System (GPS) data. Said data are checked against the corresponding gray-scale 1-meter Digital Orthophoto Quadrangles published by the United States Geological Survey (USGS) to verify a reasonable degree of accuracy. In circumstances where accurate satellite signal acquisition is not possible, such as deep, narrow canyons or under a canopy of dense foliage, or where very sharp curves in the road make accuracy questionable, such portions of the road were digitized from the corresponding gray-scale 1-meter Digital Orthophoto Quadrangles published by the United States Geological Survey (USGS).

This road-segment may traverse:

Township 16 South Range 26 East, Section(s) 29, Salt Lake Base & Meridian

The following description closely approximates the location of the centerline of the physical monument (MESA WELLS 1 ROAD)-- Segment 008 based on mapping grade Global Positioning System (GPS) data as defined above:

Beginning at a point on the road center line located at 39 degrees 22 minutes 59.38 seconds North Latitude and -109 degrees 04 minutes 08.19 seconds West Longitude, which can be converted to mapping accuracy State Plane Utah Central Zone NAD 83 feet coordinates of X = 2,327,464.9 feet and Y = 6,953,388.3 feet; thence the following courses along the said road center line:

thence South 05 Degrees 42 Minutes 10 Seconds West 11.5 feet

thence South 14 Degrees 35 Minutes 17 Seconds West 52.6 feet more or less to **the ending point at:** 39 degrees 22 minutes 58.77 seconds North Latitude and -109 degrees 04 minutes 8.4 seconds West Longitude, which can be converted to mapping accuracy State Plane Utah Central Zone NAD 83 feet coordinates of X = 2,327,450.5 feet and Y = 6,953,325.9 feet.

Appendix F to Attachment 4

Popular Name: MESA WELLS 1 ROAD

County: Grand

County Road Number: 00240

State Geographic Information Database (SGID) Road Identification Number: RD100118.

Road-Segment Number: 009

Road-Segment Length: 0.01 miles more or less.

Believed owner of the land underlying this road-segment is: Bureau of Land Management.

The following description is based upon the geographic coordinate system using the NAD83 Datum. The source is GPS mapping grade data as indicated in the metadata and/or the transportation data model of the State of Utah Geographic Information Database (SGID).

The road-segment itself is the monument that is identified by its physical presence on the land. The location of said physical presence is closely approximated by mapping grade Global Positioning System (GPS) data. Said data are checked against the corresponding gray-scale 1-meter Digital Orthophoto Quadrangles published by the United States Geological Survey (USGS) to verify a reasonable degree of accuracy. In circumstances where accurate satellite signal acquisition is not possible, such as deep, narrow canyons or under a canopy of dense foliage, or where very sharp curves in the road make accuracy questionable, such portions of the road were digitized from the corresponding gray-scale 1-meter Digital Orthophoto Quadrangles published by the United States Geological Survey (USGS).

This road-segment may traverse:

Township 16 South Range 26 East, Section(s) 29, Salt Lake Base & Meridian

The following description closely approximates the location of the centerline of the physical monument (MESA WELLS 1 ROAD)-- Segment 009 based on mapping grade Global Positioning System (GPS) data as defined above:

Beginning at a point on the road center line located at 39 degrees 22 minutes 59.38 seconds North Latitude and -109 degrees 04 minutes 08.19 seconds West Longitude, which can be converted to mapping accuracy State Plane Utah Central Zone NAD 83 feet coordinates of X = 2,327,464.9 feet and Y = 6,953,388.3 feet; thence the following courses along the said road center line:

thence North 06 Degrees 58 Minutes 26 Seconds East 64.5 feet more or less to **the ending point at:** 39 degrees 23 minutes 00.01 seconds North Latitude and -109 degrees 04 minutes 08.07 seconds West Longitude, which can be converted to mapping accuracy State Plane Utah Central Zone NAD 83 feet coordinates of X = 2,327,472.7 feet and Y = 6,953,452.4 feet.

Appendix G to Attachment 4

Popular Name: MESA WELLS 1 ROAD

County: Grand

County Road Number: 00240

State Geographic Information Database (SGID) Road Identification Number: RD100118.

Road-Segment Number: 010

Road-Segment Length: 0.02 miles more or less.

Believed owner of the land underlying this road-segment is: Bureau of Land Management.

The following description is based upon the geographic coordinate system using the NAD83 Datum. The source is GPS mapping grade data as indicated in the metadata and/or the transportation data model of the State of Utah Geographic Information Database (SGID).

The road-segment itself is the monument that is identified by its physical presence on the land. The location of said physical presence is closely approximated by mapping grade Global Positioning System (GPS) data. Said data are checked against the corresponding gray-scale 1-meter Digital Orthophoto Quadrangles published by the United States Geological Survey (USGS) to verify a reasonable degree of accuracy. In circumstances where accurate satellite signal acquisition is not possible, such as deep, narrow canyons or under a canopy of dense foliage, or where very sharp curves in the road make accuracy questionable, such portions of the road were digitized from the corresponding gray-scale 1-meter Digital Orthophoto Quadrangles published by the United States Geological Survey (USGS).

This road-segment may traverse:

Township 16 South Range 26 East, Section(s) 29, Salt Lake Base & Meridian

The following description closely approximates the location of the centerline of the physical monument (MESA WELLS 1 ROAD)-- Segment 010 based on mapping grade Global Positioning System (GPS) data as defined above:

Beginning at a point on the road center line located at 39 degrees 23 minutes 00.01 seconds North Latitude and -109 degrees 04 minutes 08.07 seconds West Longitude, which can be converted to mapping accuracy State Plane Utah Central Zone NAD 83 feet coordinates of X = 2,327,472.7 feet and Y = 6,953,452.4 feet; thence the following courses along the said road center line:

thence North 20 Degrees 52 Minutes 52 Seconds West 68.3 feet

thence North 36 Degrees 55 Minutes 12 Seconds West 34.7 feet more or less to **the ending point at:** 39 degrees 23 minutes 00.93 seconds North Latitude and -109 degrees 04 minutes 08.62 seconds West Longitude, which can be converted to mapping accuracy State Plane Utah Central Zone NAD 83 feet coordinates of X = 2,327,427.5 feet and Y = 6,953,544.0 feet.

Appendix H to Attachment 4

Popular Name: MESA WELLS 1 ROAD

County: Grand

County Road Number: 00240

State Geographic Information Database (SGID) Road Identification Number: RD100118.

Road-Segment Number: 011

Road-Segment Length: 0.02 miles more or less.

Believed owner of the land underlying this road-segment is: Bureau of Land Management.

The following description is based upon the geographic coordinate system using the NAD83 Datum. The source is GPS mapping grade data as indicated in the metadata and/or the transportation data model of the State of Utah Geographic Information Database (SGID).

The road-segment itself is the monument that is identified by its physical presence on the land. The location of said physical presence is closely approximated by mapping grade Global Positioning System (GPS) data. Said data are checked against the corresponding gray-scale 1-meter Digital Orthophoto Quadrangles published by the United States Geological Survey (USGS) to verify a reasonable degree of accuracy. In circumstances where accurate satellite signal acquisition is not possible, such as deep, narrow canyons or under a canopy of dense foliage, or where very sharp curves in the road make accuracy questionable, such portions of the road were digitized from the corresponding gray-scale 1-meter Digital Orthophoto Quadrangles published by the United States Geological Survey (USGS).

This road-segment may traverse:

Township 16 South Range 26 East, Section(s) 29, Salt Lake Base & Meridian

The following description closely approximates the location of the centerline of the physical monument (MESA WELLS 1 ROAD)-- Segment 011 based on mapping grade Global Positioning System (GPS) data as defined above:

Beginning at a point on the road center line located at 39 degrees 23 minutes 00.93 seconds North Latitude and -109 degrees 04 minutes 08.62 seconds West Longitude, which can be converted to mapping accuracy State Plane Utah Central Zone NAD 83 feet coordinates of X = 2,327,427.5 feet and Y = 6,953,544.0 feet; thence the following courses along the said road center line:

thence South 65 Degrees 33 Minutes 23 Seconds East 11.7 feet

thence South 80 Degrees 40 Minutes 08 Seconds East 29.3 feet

thence North 57 Degrees 26 Minutes 19 Seconds East 40 feet more or less to **the ending point**

at: 39 degrees 23 minutes 01.03 seconds North Latitude and -109 degrees 04 minutes 07.68 seconds West Longitude, which can be converted to mapping accuracy State Plane Utah Central Zone NAD 83 feet coordinates of X = 2,327,500.8 feet and Y = 6,953,555.9 feet.

Appendix I to Attachment 4

Popular Name: MESA WELLS 1 ROAD

County: Grand

County Road Number: 00240

State Geographic Information Database (SGID) Road Identification Number: RD100118.

Road-Segment Number: 012

Road-Segment Length: 0.02 miles more or less.

Believed owner of the land underlying this road-segment is: Bureau of Land Management.

The following description is based upon the geographic coordinate system using the NAD83 Datum. The source is GPS mapping grade data as indicated in the metadata and/or the transportation data model of the State of Utah Geographic Information Database (SGID).

The road-segment itself is the monument that is identified by its physical presence on the land. The location of said physical presence is closely approximated by mapping grade Global Positioning System (GPS) data. Said data are checked against the corresponding gray-scale 1-meter Digital Orthophoto Quadrangles published by the United States Geological Survey (USGS) to verify a reasonable degree of accuracy. In circumstances where accurate satellite signal acquisition is not possible, such as deep, narrow canyons or under a canopy of dense foliage, or where very sharp curves in the road make accuracy questionable, such portions of the road were digitized from the corresponding gray-scale 1-meter Digital Orthophoto Quadrangles published by the United States Geological Survey (USGS).

This road-segment may traverse:

Township 16 South Range 26 East, Section(s) 29, Salt Lake Base & Meridian

The following description closely approximates the location of the centerline of the physical monument (MESA WELLS 1 ROAD)-- Segment 012 based on mapping grade Global Positioning System (GPS) data as defined above:

Beginning at a point on the road center line located at 39 degrees 23 minutes 01.03 seconds North Latitude and -109 degrees 04 minutes 07.68 seconds West Longitude, which can be converted to mapping accuracy State Plane Utah Central Zone NAD 83 feet coordinates of X = 2,327,500.8 feet and Y = 6,953,555.9 feet; thence the following courses along the said road center line:

thence South 10 Degrees 17 Minutes 16 Seconds West 13.4 feet

thence South 15 Degrees 53 Minutes 18 Seconds West 94 feet more or less to **the ending point** at: 39 degrees 23 minutes 00.01 seconds North Latitude and -109 degrees 04 minutes 08.07 seconds West Longitude, which can be converted to mapping accuracy State Plane Utah Central Zone NAD 83 feet coordinates of X = 2,327,472.7 feet and Y = 6,953,452.4 feet.

Appendix J to Attachment 4

Popular Name: MESA WELLS 1 ROAD

County: Grand

County Road Number: 00240

State Geographic Information Database (SGID) Road Identification Number: RD100118.

Road-Segment Number: 013

Road-Segment Length: 0.11 miles more or less.

Believed owner of the land underlying this road-segment is: Bureau of Land Management.

The following description is based upon the geographic coordinate system using the NAD83 Datum. The source is GPS mapping grade data as indicated in the metadata and/or the transportation data model of the State of Utah Geographic Information Database (SGID).

The road-segment itself is the monument that is identified by its physical presence on the land. The location of said physical presence is closely approximated by mapping grade Global Positioning System (GPS) data. Said data are checked against the corresponding gray-scale 1-meter Digital Orthophoto Quadrangles published by the United States Geological Survey (USGS) to verify a reasonable degree of accuracy. In circumstances where accurate satellite signal acquisition is not possible, such as deep, narrow canyons or under a canopy of dense foliage, or where very sharp curves in the road make accuracy questionable, such portions of the road were digitized from the corresponding gray-scale 1-meter Digital Orthophoto Quadrangles published by the United States Geological Survey (USGS).

This road-segment may traverse:

Township 16 South Range 26 East, Section(s) 29, Salt Lake Base & Meridian

The following description closely approximates the location of the centerline of the physical monument (MESA WELLS 1 ROAD)-- Segment 013 based on mapping grade Global Positioning System (GPS) data as defined above:

Beginning at a point on the road center line located at 39 degrees 23 minutes 01.03 seconds North Latitude and -109 degrees 04 minutes 07.68 seconds West Longitude, which can be converted to mapping accuracy State Plane Utah Central Zone NAD 83 feet coordinates of X = 2,327,500.8 feet and Y = 6,953,555.9 feet; thence the following courses along the said road center line:

thence North 10 Degrees 21 Minutes 42 Seconds East 71.8 feet

thence North 06 Degrees 53 Minutes 03 Seconds West 122.2 feet

thence North 01 Degrees 53 Minutes 47 Seconds West 134.6 feet

thence North 28 Degrees 21 Minutes 27 Seconds East 108.5 feet

thence North 20 Degrees 03 Minutes 36 Seconds East 131.3 feet

thence North 04 Degrees 14 Minutes 32 Seconds East 18.1 feet more or less to **the ending**

point at: 39 degrees 23 minutes 06.57 seconds North Latitude and -109 degrees 04 minutes 06.32 seconds West Longitude, which can be converted to mapping accuracy State Plane Utah Central Zone NAD 83 feet coordinates of X = 2,327,592.5 feet and Y = 6,954,119.1 feet.

Appendix K to Attachment 4

Popular Name: MESA WELLS 1 ROAD

County: Grand

County Road Number: 00240

State Geographic Information Database (SGID) Road Identification Number: RD100118.

Road-Segment Number: 014

Road-Segment Length: 0.52 miles more or less.

Believed owner of the land underlying this road-segment is: Bureau of Land Management.

The following description is based upon the geographic coordinate system using the NAD83 Datum. The source is GPS mapping grade data as indicated in the metadata and/or the transportation data model of the State of Utah Geographic Information Database (SGID).

The road-segment itself is the monument that is identified by its physical presence on the land. The location of said physical presence is closely approximated by mapping grade Global Positioning System (GPS) data. Said data are checked against the corresponding gray-scale 1-meter Digital Orthophoto Quadrangles published by the United States Geological Survey (USGS) to verify a reasonable degree of accuracy. In circumstances where accurate satellite signal acquisition is not possible, such as deep, narrow canyons or under a canopy of dense foliage, or where very sharp curves in the road make accuracy questionable, such portions of the road were digitized from the corresponding gray-scale 1-meter Digital Orthophoto Quadrangles published by the United States Geological Survey (USGS).

This road-segment may traverse:

Township 16 South Range 26 East, Section(s) 29, Salt Lake Base & Meridian

The following description closely approximates the location of the centerline of the physical monument (MESA WELLS 1 ROAD)-- Segment 014 based on mapping grade Global Positioning System (GPS) data as defined above:

Beginning at a point on the road center line located at 39 degrees 23 minutes 06.57 seconds North Latitude and -109 degrees 04 minutes 06.32 seconds West Longitude, which can be converted to mapping accuracy State Plane Utah Central Zone NAD 83 feet coordinates of X = 2,327,592.5 feet and Y = 6,954,119.1 feet; thence the following courses along the said road center line:

thence North 03 Degrees 55 Minutes 18 Seconds East 52.6 feet
thence North 01 Degrees 20 Minutes 03 Seconds West 13.1 feet
thence North 02 Degrees 06 Minutes 37 Seconds West 124.7 feet
thence North 00 Degrees 09 Minutes 40 Seconds East 141.1 feet
thence North 09 Degrees 31 Minutes 38 Seconds East 144.9 feet
thence North 36 Degrees 32 Minutes 36 Seconds East 141.5 feet
thence North 20 Degrees 50 Minutes 58 Seconds East 140.7 feet
thence North 16 Degrees 02 Minutes 15 Seconds East 141.9 feet
thence North 13 Degrees 07 Minutes 46 Seconds East 158.6 feet
thence North 02 Degrees 32 Minutes 14 Seconds East 142.9 feet
thence North 16 Degrees 16 Minutes 31 Seconds East 97.6 feet

thence North 51 Degrees 22 Minutes 51 Seconds East 140.3 feet
thence North 40 Degrees 10 Minutes 30 Seconds East 105.7 feet
thence North 22 Degrees 01 Minutes 03 Seconds West 105.9 feet
thence North 35 Degrees 05 Minutes 32 Seconds West 119.8 feet
thence North 28 Degrees 38 Minutes 09 Seconds West 102.5 feet
thence North 37 Degrees 48 Minutes 47 Seconds West 91 feet
thence North 47 Degrees 14 Minutes 29 Seconds West 96 feet
thence North 10 Degrees 07 Minutes 33 Seconds West 126.5 feet
thence North 21 Degrees 16 Minutes 06 Seconds East 95.3 feet
thence North 27 Degrees 34 Minutes 00 Seconds West 125.5 feet
thence North 45 Degrees 53 Minutes 26 Seconds West 164 feet
thence North 61 Degrees 57 Minutes 46 Seconds West 110.5 feet
thence North 40 Degrees 10 Minutes 23 Seconds West 53.4 feet more or less to **the ending**

point at: 39 degrees 23 minutes 30.02 seconds North Latitude and -109 degrees 04 minutes 07.22 seconds West Longitude, which can be converted to mapping accuracy State Plane Utah Central Zone NAD 83 feet coordinates of X = 2,327,457.2 feet and Y = 6,956,488.7 feet.

Appendix L to Attachment 4

Popular Name: MESA WELLS 1 ROAD

County: Grand

County Road Number: 00240

State Geographic Information Database (SGID) Road Identification Number: RD100118.

Road-Segment Number: 015

Road-Segment Length: 0.05 miles more or less.

Believed owner of the land underlying this road-segment is: Bureau of Land Management.

The following description is based upon the geographic coordinate system using the NAD83 Datum. The source is GPS mapping grade data as indicated in the metadata and/or the transportation data model of the State of Utah Geographic Information Database (SGID).

The road-segment itself is the monument that is identified by its physical presence on the land. The location of said physical presence is closely approximated by mapping grade Global Positioning System (GPS) data. Said data are checked against the corresponding gray-scale 1-meter Digital Orthophoto Quadrangles published by the United States Geological Survey (USGS) to verify a reasonable degree of accuracy. In circumstances where accurate satellite signal acquisition is not possible, such as deep, narrow canyons or under a canopy of dense foliage, or where very sharp curves in the road make accuracy questionable, such portions of the road were digitized from the corresponding gray-scale 1-meter Digital Orthophoto Quadrangles published by the United States Geological Survey (USGS).

This road-segment may traverse:

Township 16 South Range 26 East, Section(s) 29, Salt Lake Base & Meridian

The following description closely approximates the location of the centerline of the physical monument (MESA WELLS 1 ROAD)-- Segment 015 based on mapping grade Global Positioning System (GPS) data as defined above:

Beginning at a point on the road center line located at 39 degrees 23 minutes 30.02 seconds North Latitude and -109 degrees 04 minutes 07.22 seconds West Longitude, which can be converted to mapping accuracy State Plane Utah Central Zone NAD 83 feet coordinates of X = 2,327,457.2 feet and Y = 6,956,488.7 feet; thence the following courses along the said road center line:

thence North 50 Degrees 25 Minutes 11 Seconds East 25.9 feet

thence North 49 Degrees 55 Minutes 05 Seconds East 87.2 feet

thence North 32 Degrees 25 Minutes 33 Seconds East 91.7 feet

thence North 22 Degrees 12 Minutes 06 Seconds East 83.5 feet more or less to **the ending**

point at: 39 degrees 23 minutes 32.22 seconds North Latitude and -109 degrees 04 minutes 05.01 seconds West Longitude, which can be converted to mapping accuracy State Plane Utah Central Zone NAD 83 feet coordinates of X = 2,327,624.6 feet and Y = 6,956,716.0 feet.

Appendix M to Attachment 4

Popular Name: MESA WELLS 1 ROAD

County: Grand

County Road Number: 00240

State Geographic Information Database (SGID) Road Identification Number: RD100118.

Road-Segment Number: 016

Road-Segment Length: 0.01 miles more or less.

Believed owner of the land underlying this road-segment is: Bureau of Land Management.

The following description is based upon the geographic coordinate system using the NAD83 Datum. The source is GPS mapping grade data as indicated in the metadata and/or the transportation data model of the State of Utah Geographic Information Database (SGID).

The road-segment itself is the monument that is identified by its physical presence on the land. The location of said physical presence is closely approximated by mapping grade Global Positioning System (GPS) data. Said data are checked against the corresponding gray-scale 1-meter Digital Orthophoto Quadrangles published by the United States Geological Survey (USGS) to verify a reasonable degree of accuracy. In circumstances where accurate satellite signal acquisition is not possible, such as deep, narrow canyons or under a canopy of dense foliage, or where very sharp curves in the road make accuracy questionable, such portions of the road were digitized from the corresponding gray-scale 1-meter Digital Orthophoto Quadrangles published by the United States Geological Survey (USGS).

This road-segment may traverse:

Township 16 South Range 26 East, Section(s) 29, Salt Lake Base & Meridian

The following description closely approximates the location of the centerline of the physical monument (MESA WELLS 1 ROAD)-- Segment 016 based on mapping grade Global Positioning System (GPS) data as defined above:

Beginning at a point on the road center line located at 39 degrees 23 minutes 32.22 seconds North Latitude and -109 degrees 04 minutes 05.01 seconds West Longitude, which can be converted to mapping accuracy State Plane Utah Central Zone NAD 83 feet coordinates of X = 2,327,624.6 feet and Y = 6,956,716.0 feet; thence the following courses along the said road center line:

thence North 76 Degrees 22 Minutes 03 Seconds East 42.8 feet

thence South 78 Degrees 07 Minutes 51 Seconds East 31 feet more or less to **the ending point** at: 39 degrees 23 minutes 32.23 seconds North Latitude and -109 degrees 04 minutes 04.09 seconds West Longitude, which can be converted to mapping accuracy State Plane Utah Central Zone NAD 83 feet coordinates of X = 2,327,696.6 feet and Y = 6,956,719.7 feet.

Appendix N to Attachment 4

Popular Name: MESA WELLS 1 ROAD

County: Grand

County Road Number: 00240

State Geographic Information Database (SGID) Road Identification Number: RD100118.

Road-Segment Number: 017

Road-Segment Length: 0.02 miles more or less.

Believed owner of the land underlying this road-segment is: Bureau of Land Management.

The following description is based upon the geographic coordinate system using the NAD83 Datum. The source is GPS mapping grade data as indicated in the metadata and/or the transportation data model of the State of Utah Geographic Information Database (SGID).

The road-segment itself is the monument that is identified by its physical presence on the land. The location of said physical presence is closely approximated by mapping grade Global Positioning System (GPS) data. Said data are checked against the corresponding gray-scale 1-meter Digital Orthophoto Quadrangles published by the United States Geological Survey (USGS) to verify a reasonable degree of accuracy. In circumstances where accurate satellite signal acquisition is not possible, such as deep, narrow canyons or under a canopy of dense foliage, or where very sharp curves in the road make accuracy questionable, such portions of the road were digitized from the corresponding gray-scale 1-meter Digital Orthophoto Quadrangles published by the United States Geological Survey (USGS).

This road-segment may traverse:

Township 16 South Range 26 East, Section(s) 29, Salt Lake Base & Meridian

The following description closely approximates the location of the centerline of the physical monument (MESA WELLS 1 ROAD)-- Segment 017 based on mapping grade Global Positioning System (GPS) data as defined above:

Beginning at a point on the road center line located at 39 degrees 23 minutes 32.23 seconds North Latitude and -109 degrees 04 minutes 04.09 seconds West Longitude, which can be converted to mapping accuracy State Plane Utah Central Zone NAD 83 feet coordinates of X = 2,327,696.6 feet and Y = 6,956,719.7 feet; thence the following courses along the said road center line:

thence North 53 Degrees 27 Minutes 41 Seconds West 16.4 feet

thence North 41 Degrees 45 Minutes 35 Seconds West 35 feet

thence North 35 Degrees 01 Minutes 35 Seconds West 51.9 feet more or less to **the ending point at:** 39 degrees 23 minutes 33.03 seconds North Latitude and -109 degrees 04 minutes 04.91 seconds West Longitude, which can be converted to mapping accuracy State Plane Utah Central Zone NAD 83 feet coordinates of X = 2,327,630.3 feet and Y = 6,956,798.1 feet.

Appendix O to Attachment 4

Popular Name: MESA WELLS 1 ROAD

County: Grand

County Road Number: 00240

State Geographic Information Database (SGID) Road Identification Number: RD100118.

Road-Segment Number: 018

Road-Segment Length: 0.02 miles more or less.

Believed owner of the land underlying this road-segment is: Bureau of Land Management.

The following description is based upon the geographic coordinate system using the NAD83 Datum. The source is GPS mapping grade data as indicated in the metadata and/or the transportation data model of the State of Utah Geographic Information Database (SGID).

The road-segment itself is the monument that is identified by its physical presence on the land. The location of said physical presence is closely approximated by mapping grade Global Positioning System (GPS) data. Said data are checked against the corresponding gray-scale 1-meter Digital Orthophoto Quadrangles published by the United States Geological Survey (USGS) to verify a reasonable degree of accuracy. In circumstances where accurate satellite signal acquisition is not possible, such as deep, narrow canyons or under a canopy of dense foliage, or where very sharp curves in the road make accuracy questionable, such portions of the road were digitized from the corresponding gray-scale 1-meter Digital Orthophoto Quadrangles published by the United States Geological Survey (USGS).

This road-segment may traverse:

Township 16 South Range 26 East, Section(s) 29, Salt Lake Base & Meridian

The following description closely approximates the location of the centerline of the physical monument (MESA WELLS 1 ROAD)-- Segment 018 based on mapping grade Global Positioning System (GPS) data as defined above:

Beginning at a point on the road center line located at 39 degrees 23 minutes 33.03 seconds North Latitude and -109 degrees 04 minutes 04.91 seconds West Longitude, which can be converted to mapping accuracy State Plane Utah Central Zone NAD 83 feet coordinates of X = 2,327,630.3 feet and Y = 6,956,798.1 feet; thence the following courses along the said road center line:

thence South 01 Degrees 54 Minutes 29 Seconds West 73.9 feet

thence South 21 Degrees 28 Minutes 11 Seconds West 8.8 feet more or less to **the ending point** at: 39 degrees 23 minutes 32.22 seconds North Latitude and -109 degrees 04 minutes 05.01 seconds West Longitude, which can be converted to mapping accuracy State Plane Utah Central Zone NAD 83 feet coordinates of X = 2,327,624.6 feet and Y = 6,956,716.0 feet.

Appendix P to Attachment 4

Popular Name: MESA WELLS 1 ROAD

County: Grand

County Road Number: 00240

State Geographic Information Database (SGID) Road Identification Number: RD100118.

Road-Segment Number: 019

Road-Segment Length: 0.41 miles more or less.

Believed owner of the land underlying this road-segment is: Bureau of Land Management.

The following description is based upon the geographic coordinate system using the NAD83 Datum. The source is GPS mapping grade data as indicated in the metadata and/or the transportation data model of the State of Utah Geographic Information Database (SGID).

The road-segment itself is the monument that is identified by its physical presence on the land. The location of said physical presence is closely approximated by mapping grade Global Positioning System (GPS) data. Said data are checked against the corresponding gray-scale 1-meter Digital Orthophoto Quadrangles published by the United States Geological Survey (USGS) to verify a reasonable degree of accuracy. In circumstances where accurate satellite signal acquisition is not possible, such as deep, narrow canyons or under a canopy of dense foliage, or where very sharp curves in the road make accuracy questionable, such portions of the road were digitized from the corresponding gray-scale 1-meter Digital Orthophoto Quadrangles published by the United States Geological Survey (USGS).

This road-segment may traverse:

Township 16 South Range 26 East, Section(s) 20,29, Salt Lake Base & Meridian

The following description closely approximates the location of the centerline of the physical monument (MESA WELLS 1 ROAD)-- Segment 019 based on mapping grade Global Positioning System (GPS) data as defined above:

Beginning at a point on the road center line located at 39 degrees 23 minutes 33.03 seconds North Latitude and -109 degrees 04 minutes 04.91 seconds West Longitude, which can be converted to mapping accuracy State Plane Utah Central Zone NAD 83 feet coordinates of X = 2,327,630.3 feet and Y = 6,956,798.1 feet; thence the following courses along the said road center line:

thence North 02 Degrees 09 Minutes 28 Seconds East 37.8 feet
thence North 18 Degrees 19 Minutes 26 Seconds West 115.6 feet
thence North 20 Degrees 28 Minutes 04 Seconds West 131 feet
thence North 09 Degrees 06 Minutes 31 Seconds West 41.5 feet
thence North 10 Degrees 38 Minutes 58 Seconds West 113.4 feet
thence North 11 Degrees 03 Minutes 28 Seconds West 116.9 feet
thence North 16 Degrees 30 Minutes 42 Seconds East 32.5 feet
thence North 16 Degrees 30 Minutes 14 Seconds East 97.8 feet
thence North 20 Degrees 03 Minutes 48 Seconds East 136.5 feet
thence North 22 Degrees 34 Minutes 26 Seconds East 140.7 feet
thence North 29 Degrees 23 Minutes 32 Seconds East 100.1 feet

thence North 47 Degrees 55 Minutes 30 Seconds East 73.9 feet
thence North 44 Degrees 50 Minutes 08 Seconds East 95.4 feet
thence North 30 Degrees 37 Minutes 08 Seconds East 122.4 feet
thence North 35 Degrees 37 Minutes 56 Seconds East 123.6 feet
thence North 31 Degrees 59 Minutes 41 Seconds East 124.2 feet
thence North 00 Degrees 29 Minutes 13 Seconds East 114.8 feet
thence North 16 Degrees 06 Minutes 04 Seconds East 128.3 feet
thence North 00 Degrees 06 Minutes 25 Seconds East 132.9 feet
thence North 02 Degrees 36 Minutes 16 Seconds West 108.4 feet
thence North 07 Degrees 35 Minutes 40 Seconds West 84.3 feet more or less to **the ending**

point at: 39 degrees 23 minutes 52.67 seconds North Latitude and -109 degrees 03 minutes 59.13 seconds West Longitude, which can be converted to mapping accuracy State Plane Utah Central Zone NAD 83 feet coordinates of X = 2,328,029.7 feet and Y = 6,958,796.8 feet.

Appendix Q to Attachment 4

Popular Name: MESA WELLS 1 ROAD

County: Grand

County Road Number: 00240

State Geographic Information Database (SGID) Road Identification Number: RD100118.

Road-Segment Number: 020

Road-Segment Length: 0.06 miles more or less.

Believed owner of the land underlying this road-segment is: Bureau of Land Management.

The following description is based upon the geographic coordinate system using the NAD83 Datum. The source is GPS mapping grade data as indicated in the metadata and/or the transportation data model of the State of Utah Geographic Information Database (SGID).

The road-segment itself is the monument that is identified by its physical presence on the land. The location of said physical presence is closely approximated by mapping grade Global Positioning System (GPS) data. Said data are checked against the corresponding gray-scale 1-meter Digital Orthophoto Quadrangles published by the United States Geological Survey (USGS) to verify a reasonable degree of accuracy. In circumstances where accurate satellite signal acquisition is not possible, such as deep, narrow canyons or under a canopy of dense foliage, or where very sharp curves in the road make accuracy questionable, such portions of the road were digitized from the corresponding gray-scale 1-meter Digital Orthophoto Quadrangles published by the United States Geological Survey (USGS).

This road-segment may traverse:

Township 16 South Range 26 East, Section(s) 29, Salt Lake Base & Meridian

The following description closely approximates the location of the centerline of the physical monument (MESA WELLS 1 ROAD)-- Segment 020 based on mapping grade Global Positioning System (GPS) data as defined above:

Beginning at a point on the road center line located at 39 degrees 23 minutes 32.23 seconds North Latitude and -109 degrees 04 minutes 04.09 seconds West Longitude, which can be converted to mapping accuracy State Plane Utah Central Zone NAD 83 feet coordinates of X = 2,327,696.6 feet and Y = 6,956,719.7 feet; thence the following courses along the said road center line:

thence South 56 Degrees 29 Minutes 23 Seconds East 41.2 feet

thence North 68 Degrees 21 Minutes 11 Seconds East 63.2 feet

thence North 38 Degrees 14 Minutes 01 Seconds East 77.6 feet

thence North 44 Degrees 40 Minutes 06 Seconds East 65 feet

thence North 78 Degrees 13 Minutes 02 Seconds East 49.6 feet

thence South 57 Degrees 29 Minutes 30 Seconds East 45.4 feet more or less to **the ending**

point at: 39 degrees 23 minutes 33.08 seconds North Latitude and -109 degrees 04 minutes 00.57 seconds West Longitude, which can be converted to mapping accuracy State Plane Utah Central Zone NAD 83 feet coordinates of X = 2,327,970.2 feet and Y = 6,956,813.2 feet.

Appendix R to Attachment 4

Popular Name: MESA WELLS 1 ROAD

County: Grand

County Road Number: 00240

State Geographic Information Database (SGID) Road Identification Number: RD100118.

Road-Segment Number: 021

Road-Segment Length: 0.6 miles more or less.

Believed owner of the land underlying this road-segment is: Bureau of Land Management.

The following description is based upon the geographic coordinate system using the NAD83 Datum. The source is GPS mapping grade data as indicated in the metadata and/or the transportation data model of the State of Utah Geographic Information Database (SGID).

The road-segment itself is the monument that is identified by its physical presence on the land. The location of said physical presence is closely approximated by mapping grade Global Positioning System (GPS) data. Said data are checked against the corresponding gray-scale 1-meter Digital Orthophoto Quadrangles published by the United States Geological Survey (USGS) to verify a reasonable degree of accuracy. In circumstances where accurate satellite signal acquisition is not possible, such as deep, narrow canyons or under a canopy of dense foliage, or where very sharp curves in the road make accuracy questionable, such portions of the road were digitized from the corresponding gray-scale 1-meter Digital Orthophoto Quadrangles published by the United States Geological Survey (USGS).

This road-segment may traverse:

Township 16 South Range 26 East, Section(s) 20,29, Salt Lake Base & Meridian

The following description closely approximates the location of the centerline of the physical monument (MESA WELLS 1 ROAD)-- Segment 021 based on mapping grade Global Positioning System (GPS) data as defined above:

Beginning at a point on the road center line located at 39 degrees 23 minutes 30.02 seconds North Latitude and -109 degrees 04 minutes 07.22 seconds West Longitude, which can be converted to mapping accuracy State Plane Utah Central Zone NAD 83 feet coordinates of X = 2,327,457.2 feet and Y = 6,956,488.7 feet; thence the following courses along the said road center line:

thence North 11 Degrees 46 Minutes 06 Seconds West 43.5 feet
thence North 02 Degrees 09 Minutes 34 Seconds West 77.1 feet
thence North 29 Degrees 45 Minutes 54 Seconds West 62.2 feet
thence North 50 Degrees 47 Minutes 53 Seconds West 92.8 feet
thence North 48 Degrees 08 Minutes 18 Seconds West 109.9 feet
thence North 40 Degrees 44 Minutes 15 Seconds West 103.4 feet
thence North 35 Degrees 10 Minutes 20 Seconds West 101.9 feet
thence North 63 Degrees 22 Minutes 32 Seconds West 79.6 feet
thence South 81 Degrees 02 Minutes 17 Seconds West 76.5 feet
thence South 76 Degrees 35 Minutes 46 Seconds West 65.3 feet
thence South 74 Degrees 19 Minutes 06 Seconds West 86.8 feet

thence South 78 Degrees 21 Minutes 30 Seconds West 83.6 feet
thence North 64 Degrees 40 Minutes 16 Seconds West 98.5 feet
thence North 49 Degrees 55 Minutes 03 Seconds West 108.8 feet
thence North 63 Degrees 32 Minutes 33 Seconds West 116.5 feet
thence North 66 Degrees 44 Minutes 29 Seconds West 114.8 feet
thence North 71 Degrees 12 Minutes 38 Seconds West 135.2 feet
thence North 77 Degrees 43 Minutes 52 Seconds West 142.9 feet
thence North 80 Degrees 55 Minutes 10 Seconds West 110.3 feet
thence South 81 Degrees 19 Minutes 04 Seconds West 90.4 feet
thence North 21 Degrees 53 Minutes 07 Seconds West 56.4 feet
thence North 02 Degrees 02 Minutes 03 Seconds West 57.4 feet
thence North 02 Degrees 04 Minutes 23 Seconds West 37.8 feet
thence North 59 Degrees 00 Minutes 09 Seconds West 110.4 feet
thence North 34 Degrees 47 Minutes 37 Seconds West 113.4 feet
thence North 47 Degrees 16 Minutes 29 Seconds West 98.5 feet
thence South 86 Degrees 55 Minutes 54 Seconds West 103.1 feet
thence North 61 Degrees 36 Minutes 19 Seconds West 119.5 feet
thence North 60 Degrees 27 Minutes 32 Seconds West 131.7 feet
thence North 56 Degrees 47 Minutes 30 Seconds West 124.7 feet
thence North 84 Degrees 55 Minutes 07 Seconds West 121.7 feet
thence North 67 Degrees 37 Minutes 11 Seconds West 110.5 feet
thence North 57 Degrees 23 Minutes 56 Seconds West 78.5 feet more or less to **the ending**

point at: 39 degrees 23 minutes 44.19 seconds North Latitude and -109 degrees 04 minutes 38.82 seconds West Longitude, which can be converted to mapping accuracy State Plane Utah Central Zone NAD 83 feet coordinates of X = 2,324,938.4 feet and Y = 6,957,855.4 feet.

Appendix S to Attachment 4

Popular Name: MESA WELLS 1 ROAD

County: Grand

County Road Number: 00240

State Geographic Information Database (SGID) Road Identification Number: RD100118.

Road-Segment Number: 022

Road-Segment Length: 0.16 miles more or less.

Believed owner of the land underlying this road-segment is: Bureau of Land Management.

The following description is based upon the geographic coordinate system using the NAD83 Datum. The source is GPS mapping grade data as indicated in the metadata and/or the transportation data model of the State of Utah Geographic Information Database (SGID).

The road-segment itself is the monument that is identified by its physical presence on the land. The location of said physical presence is closely approximated by mapping grade Global Positioning System (GPS) data. Said data are checked against the corresponding gray-scale 1-meter Digital Orthophoto Quadrangles published by the United States Geological Survey (USGS) to verify a reasonable degree of accuracy. In circumstances where accurate satellite signal acquisition is not possible, such as deep, narrow canyons or under a canopy of dense foliage, or where very sharp curves in the road make accuracy questionable, such portions of the road were digitized from the corresponding gray-scale 1-meter Digital Orthophoto Quadrangles published by the United States Geological Survey (USGS).

This road-segment may traverse:

Township 16 South Range 26 East, Section(s) 20, Salt Lake Base & Meridian

The following description closely approximates the location of the centerline of the physical monument (MESA WELLS 1 ROAD)-- Segment 022 based on mapping grade Global Positioning System (GPS) data as defined above:

Beginning at a point on the road center line located at 39 degrees 23 minutes 44.19 seconds North Latitude and -109 degrees 04 minutes 38.82 seconds West Longitude, which can be converted to mapping accuracy State Plane Utah Central Zone NAD 83 feet coordinates of X = 2,324,938.4 feet and Y = 6,957,855.4 feet; thence the following courses along the said road center line:

thence North 03 Degrees 11 Minutes 37 Seconds West 32.8 feet
thence North 33 Degrees 41 Minutes 41 Seconds West 51.1 feet
thence North 54 Degrees 52 Minutes 15 Seconds West 84.8 feet
thence North 46 Degrees 39 Minutes 37 Seconds West 38 feet
thence North 05 Degrees 18 Minutes 12 Seconds West 32.9 feet
thence North 63 Degrees 06 Minutes 12 Seconds East 25.7 feet
thence North 89 Degrees 40 Minutes 07 Seconds East 36.5 feet
thence South 67 Degrees 38 Minutes 51 Seconds East 34 feet
thence South 55 Degrees 48 Minutes 25 Seconds East 55 feet
thence South 53 Degrees 02 Minutes 41 Seconds East 16.2 feet
thence South 59 Degrees 01 Minutes 34 Seconds East 101 feet

thence North 85 Degrees 59 Minutes 58 Seconds East 102.5 feet
thence North 73 Degrees 33 Minutes 18 Seconds East 76.8 feet
thence South 75 Degrees 04 Minutes 34 Seconds East 74.8 feet
thence South 66 Degrees 30 Minutes 25 Seconds East 69 feet more or less to **the ending point**
at: 39 degrees 23 minutes 44.79 seconds North Latitude and -109 degrees 04 minutes 33.48 seconds West
Longitude, which can be converted to mapping accuracy State Plane Utah Central Zone NAD 83 feet
coordinates of X = 2,325,355.7 feet and Y = 6,957,926.7 feet.

Appendix T to Attachment 4

Popular Name: MESA WELLS 1 ROAD

County: Grand

County Road Number: 00240

State Geographic Information Database (SGID) Road Identification Number: RD100118.

Road-Segment Number: 023

Road-Segment Length: 0.28 miles more or less.

Believed owner of the land underlying this road-segment is: Bureau of Land Management.

The following description is based upon the geographic coordinate system using the NAD83 Datum. The source is GPS mapping grade data as indicated in the metadata and/or the transportation data model of the State of Utah Geographic Information Database (SGID).

The road-segment itself is the monument that is identified by its physical presence on the land. The location of said physical presence is closely approximated by mapping grade Global Positioning System (GPS) data. Said data are checked against the corresponding gray-scale 1-meter Digital Orthophoto Quadrangles published by the United States Geological Survey (USGS) to verify a reasonable degree of accuracy. In circumstances where accurate satellite signal acquisition is not possible, such as deep, narrow canyons or under a canopy of dense foliage, or where very sharp curves in the road make accuracy questionable, such portions of the road were digitized from the corresponding gray-scale 1-meter Digital Orthophoto Quadrangles published by the United States Geological Survey (USGS).

This road-segment may traverse:

Township 16 South Range 26 East, Section(s) 19,20, Salt Lake Base & Meridian

The following description closely approximates the location of the centerline of the physical monument (MESA WELLS 1 ROAD)-- Segment 023 based on mapping grade Global Positioning System (GPS) data as defined above:

Beginning at a point on the road center line located at 39 degrees 23 minutes 44.19 seconds North Latitude and -109 degrees 04 minutes 38.82 seconds West Longitude, which can be converted to mapping accuracy State Plane Utah Central Zone NAD 83 feet coordinates of X = 2,324,938.4 feet and Y = 6,957,855.4 feet; thence the following courses along the said road center line:

thence North 56 Degrees 38 Minutes 28 Seconds West 20.7 feet
thence North 66 Degrees 09 Minutes 27 Seconds West 92.1 feet
thence North 88 Degrees 45 Minutes 04 Seconds West 119 feet
thence South 87 Degrees 48 Minutes 12 Seconds West 55.4 feet
thence South 87 Degrees 46 Minutes 29 Seconds West 44.7 feet
thence North 88 Degrees 20 Minutes 21 Seconds West 94.4 feet
thence South 82 Degrees 27 Minutes 52 Seconds West 91.6 feet
thence North 74 Degrees 23 Minutes 09 Seconds West 89.6 feet
thence North 42 Degrees 48 Minutes 49 Seconds West 115.7 feet
thence North 64 Degrees 45 Minutes 55 Seconds West 110.2 feet
thence North 16 Degrees 46 Minutes 20 Seconds West 90.6 feet

thence North 37 Degrees 45 Minutes 55 Seconds West 82.6 feet
thence North 23 Degrees 35 Minutes 56 Seconds West 28.6 feet
thence North 26 Degrees 32 Minutes 19 Seconds West 32.9 feet
thence North 28 Degrees 55 Minutes 18 Seconds West 119.6 feet
thence North 42 Degrees 50 Minutes 30 Seconds West 120.2 feet
thence North 50 Degrees 56 Minutes 46 Seconds West 80.1 feet
thence North 33 Degrees 08 Minutes 52 Seconds West 72.2 feet more or less to **the ending**

point at: 39 degrees 23 minutes 51.46 seconds North Latitude and -109 degrees 04 minutes 52.77 seconds West Longitude, which can be converted to mapping accuracy State Plane Utah Central Zone NAD 83 feet coordinates of X = 2,323,824.0 feet and Y = 6,958,560.9 feet.

Appendix U to Attachment 4

Popular Name: MESA WELLS 1 ROAD

County: Grand

County Road Number: 00240

State Geographic Information Database (SGID) Road Identification Number: RD100118.

Road-Segment Number: 024

Road-Segment Length: 0.12 miles more or less.

Believed owner of the land underlying this road-segment is: Bureau of Land Management.

The following description is based upon the geographic coordinate system using the NAD83 Datum. The source is GPS mapping grade data as indicated in the metadata and/or the transportation data model of the State of Utah Geographic Information Database (SGID).

The road-segment itself is the monument that is identified by its physical presence on the land. The location of said physical presence is closely approximated by mapping grade Global Positioning System (GPS) data. Said data are checked against the corresponding gray-scale 1-meter Digital Orthophoto Quadrangles published by the United States Geological Survey (USGS) to verify a reasonable degree of accuracy. In circumstances where accurate satellite signal acquisition is not possible, such as deep, narrow canyons or under a canopy of dense foliage, or where very sharp curves in the road make accuracy questionable, such portions of the road were digitized from the corresponding gray-scale 1-meter Digital Orthophoto Quadrangles published by the United States Geological Survey (USGS).

This road-segment may traverse:

Township 16 South Range 26 East, Section(s) 29, Salt Lake Base & Meridian

The following description closely approximates the location of the centerline of the physical monument (MESA WELLS 1 ROAD)-- Segment 024 based on mapping grade Global Positioning System (GPS) data as defined above:

Beginning at a point on the road center line located at 39 degrees 23 minutes 06.57 seconds North Latitude and -109 degrees 04 minutes 06.32 seconds West Longitude, which can be converted to mapping accuracy State Plane Utah Central Zone NAD 83 feet coordinates of X = 2,327,592.5 feet and Y = 6,954,119.1 feet; thence the following courses along the said road center line:

thence North 62 Degrees 16 Minutes 18 Seconds West 34.9 feet

thence North 46 Degrees 43 Minutes 43 Seconds West 594.6 feet more or less to **the ending point at:** 39 degrees 23 minutes 10.88 seconds North Latitude and -109 degrees 04 minutes 12.07 seconds West Longitude, which can be converted to mapping accuracy State Plane Utah Central Zone NAD 83 feet coordinates of X = 2,327,128.7 feet and Y = 6,954,542.9 feet.

Appendix V to Attachment 4

Popular Name: MESA WELLS 1 ROAD

County: Grand

County Road Number: 00240

State Geographic Information Database (SGID) Road Identification Number: RD100118.

Road-Segment Number: 025

Road-Segment Length: 0.14 miles more or less.

Believed owner of the land underlying this road-segment is: Bureau of Land Management.

The following description is based upon the geographic coordinate system using the NAD83 Datum. The source is GPS mapping grade data as indicated in the metadata and/or the transportation data model of the State of Utah Geographic Information Database (SGID).

The road-segment itself is the monument that is identified by its physical presence on the land. The location of said physical presence is closely approximated by mapping grade Global Positioning System (GPS) data. Said data are checked against the corresponding gray-scale 1-meter Digital Orthophoto Quadrangles published by the United States Geological Survey (USGS) to verify a reasonable degree of accuracy. In circumstances where accurate satellite signal acquisition is not possible, such as deep, narrow canyons or under a canopy of dense foliage, or where very sharp curves in the road make accuracy questionable, such portions of the road were digitized from the corresponding gray-scale 1-meter Digital Orthophoto Quadrangles published by the United States Geological Survey (USGS).

This road-segment may traverse:

Township 16 South Range 26 East, Section(s) 29, Salt Lake Base & Meridian

The following description closely approximates the location of the centerline of the physical monument (MESA WELLS 1 ROAD)-- Segment 025 based on mapping grade Global Positioning System (GPS) data as defined above:

Beginning at a point on the road center line located at 39 degrees 23 minutes 00.93 seconds North Latitude and -109 degrees 04 minutes 08.62 seconds West Longitude, which can be converted to mapping accuracy State Plane Utah Central Zone NAD 83 feet coordinates of X = 2,327,427.5 feet and Y = 6,953,544.0 feet; thence the following courses along the said road center line:

thence North 35 Degrees 58 Minutes 09 Seconds West 52.5 feet
thence North 41 Degrees 35 Minutes 55 Seconds West 104.8 feet
thence North 48 Degrees 41 Minutes 53 Seconds West 29.6 feet
thence North 51 Degrees 20 Minutes 18 Seconds West 65.2 feet
thence North 56 Degrees 04 Minutes 14 Seconds West 137 feet
thence North 59 Degrees 27 Minutes 59 Seconds West 140.7 feet
thence North 58 Degrees 56 Minutes 58 Seconds West 107.1 feet
thence North 53 Degrees 25 Minutes 02 Seconds West 92.9 feet more or less to **the ending**

point at: 39 degrees 23 minutes 05.43 seconds North Latitude and -109 degrees 04 minutes 15.78 seconds West Longitude, which can be converted to mapping accuracy State Plane Utah Central Zone NAD 83 feet coordinates of X = 2,326,852.8 feet and Y = 6,953,983.6 feet.