

**Acknowledgment and
Notice of Acknowledgment
of Acceptance of R.S. 2477
Right-of-Way Grant**

Ent 486485 Bk 732 Pg 236-245
Date: 27-MAY-2008 3:59PM
Fee: None
Filed By: PL
MERLENE MOSHER DALTON, Recorder
GRAND COUNTY CORPORATION
For: STATE OF UTAH

THE STATE OF UTAH

TO ALL WHOM THESE PRESENTS SHALL COME, Greeting:

Know ye, This is an Acknowledgment and Notice of Acknowledgment made under Utah Code Sections 72-5-309 through 310 inclusive, that the grant of the United States of America of “the right of way for the construction of highways over public lands, not reserved for public uses” under United States Revised Statutes 2477 (43 U.S.C. Section 932 (repealed October 21, 1976, with proviso recognizing the validity of rights-of-way already established)) was accepted for and on behalf of the State of Utah and its political subdivision Grand County as it pertains to the highway located in Grand County known as CISCO SPRINGS 3 ROAD; County Road Number: 00384; State Geographic Information Database (SGID) Road Identification Number: RD100194. Total road length is 1.8 miles more or less.

The reason for this Acknowledgment and Notice of Acknowledgment includes, but is not limited to, the fact that the road was constructed, mechanically, or by continuous use as a public highway for a period of at least ten years, over public lands not reserved for public uses, prior to the earlier of (a) the October 21, 1976 repeal of R.S. 2477 or (b) the date the servient estate was reserved for public uses.

This Acknowledgment and Notice of Acknowledgment applies only to the segments of the road that traverse land owned by the Bureau of Land Management, United States Department of the Interior, and does not apply to segments of the road that traverse land owned by any other person or entity. The State of Utah and its political subdivisions reserve the right to make further acknowledgments and notices of acknowledgment with regard to road segments that traverse land owned by other entities, including the United States of America, through one or more of its agencies.

A printed copy of a map showing the location of the road in said county is appended hereto as “Attachment 1,” a printed copy of representative photos of the road is appended hereto as “Attachment 2,” a printed copy of a description of the beginning and ending points of the entire road together with a list of Townships, Ranges and Sections that may be traversed by the road in said county is appended hereto as “Attachment 3,” and a printed copy of the Road Centerline Description Cover Page(s) is appended hereto as “Attachment 4.” The Appendices listed in “Attachment 4” that contain the actual road centerline descriptions are incorporated herein by reference. Affidavits provided by individuals familiar with the road are appended hereto as “Attachment 5.”

A printed copy of this Acknowledgment and Notice of Acknowledgment, together with its Attachments and Appendices, may be viewed and/or obtained at the office of the Utah State Archives.

An electronic copy of this Acknowledgment and Notice of Acknowledgment, together with its Attachments and Appendices, may be viewed and/or downloaded as read-only PDF (Portable Document Format) files via the

Internet at <http://recorded2477roads.utah.gov>.

The owner of the servient estate in the land underlying the road-segments subject to this Acknowledgment and Notice is believed to be the United States of America through one or more of its agencies. Any of such agencies or any other person with a servient ownership claim or a competing dominant estate right-of-way ownership claim, may file a petition in the State District Court for Salt Lake County for a decision regarding the correctness of this Acknowledgment. A claimant shall file a petition within sixty (60) days after receipt of this Notice.

In Witness Whereof, I, John Harja, the official designee of the Governor of the State of Utah, in conformity to the laws of the State (Utah Code Sections 72-5-308 through 310 inclusive), have caused this Acknowledgment and Notice of Acknowledgment to be made.

Signed by my hand in Salt Lake City, Utah, the 22nd day of May, 2008.

By the Governor's Designee



John Harja

CERTIFICATION

State of Utah)
 : ss
County of Salt Lake)

I hereby certify that the signer of the foregoing document, John Harja, is personally known by me, has made a voluntary signature and taken an oath stating that he is the official designee of the Governor of the State of Utah and is authorized to sign this document on the Governor's behalf pursuant to Utah Code Section 72-5-309. He further vouched that, based upon information and belief, the facts alleged therein are true.

Dated this 22nd day of May, 2008.





Notary Public



Cisco Springs 3 Road - Grand County
SGID RD_ID RD100194

Land Ownership Categories

- BLM
- Private
- SITLA, State Trust Land
- USFS, National Forest
- State Parks and Recreation
- Tribal, Indian Reservation
- NPS, National Park

Wilderness

- UDWR, Wildlife Reserve
- DOD, Military
- State Sovereign Land
- National Recreation Area
- USFWS, Natl. Wildlife Refuge

Transportation Network

- Cisco Springs 3 Road
- Other Roads
- Title V, Issued Or Under Consideration By BLM Or County
- Photo Event Point
- Section = 1 Mile

1:17,503
1 inch equals 0.3 miles

Map prepared by the State of Utah
Automated Geographic Reference Center
Room 5130 State Office Building
Salt Lake City, Utah 84114
Apr 17, 2008

Attachment 2



EP100194002



EP100194007



EP100194008

EP000000000

EP000000000

EP000000000

Ent 486485 Bk 0732 Pg 0239

Cisco Springs 3 Road - Grand County
SGID RD_ID RD100194

Map prepared by the State of Utah
Automated Geographic Reference Center
Room 5130 State Office Building
Salt Lake City, Utah 84114
April 14, 2008



Attachment 3

Beginning & Ending Points and Township, Range, and Section References For:

Popular Name: CISCO SPRINGS 3 ROAD

County: Grand

County Road Number: 00384

State Geographic Information Database (SGID) Road Identification Number: RD100194.

Total Road Length: 1.8 miles more or less.

Beginning at a point on the road centerline located at 39 degrees 02 minutes 50.73 seconds North Latitude and -109 degrees 19 minutes 03.43 seconds West Longitude, which can be converted to mapping accuracy State Plane Utah Central Zone NAD 83 feet coordinates of X = 2,260,183.5 feet and Y = 6,829,329.3 feet based on the US Survey Foot conversion.

Ending at a point on the road centerline located at 39 degrees 02 minutes 11.23 seconds North Latitude and -109 degrees 17 minutes 32.98 seconds West Longitude, which can be converted to mapping accuracy State Plane Utah Central Zone NAD 83 feet coordinates of X = 2,267,416.4 feet and Y = 6,825,509.9 feet based on the US Survey Foot conversion.

This road may traverse:

Township 20 South Range 23 East, Section(s) 24,25, Salt Lake Base & Meridian
Township 20 South Range 24 East, Section(s) 29,30, Salt Lake Base & Meridian
See Attachment 1 above for a cartographic depiction of the course of this road.

**Attachment 4
Road Centerline Description Cover Page(s)**

Popular Name: CISCO SPRINGS 3 ROAD

County: Grand

County Road Number: 00384

State Geographic Information Database (SGID) Road Identification Number: RD100194.

Total Road Length: 1.8 miles more or less.

Centerline Descriptions Of Road-Segments That Cross Over Federally Owned Land, Derived From Global Positioning System Data And Cross-checked against USGS Digital Orthophoto Quadrangles Compiled By The Utah Automated Geographic Reference Center And Entered Into The State Geographic Information Database (SGID).

Road-Segments Listed by SGID Road Identification Number (RD_ID)	Road-Segment Numbers	Believed Ownership Of Servient Estate	Approximate Segment Length	See Attached Appendix
RD100194	001	BLM	0.3 Miles	A
RD100194	002	BLM	1.51 Miles	B
		Total Road Length	1.8	_____

* Indicates that a Title V permit will be requested, is in process, or has been issued.

† Indicates that road-segments crossing Forest Service land are under consideration by the state and county as of the date of this Acknowledgment and Notice of Acknowledgment.

Attachment 5

Ent 486485 Bk 0732 Pg 0242

AFFIDAVIT OF JAMES ROBERT WESTWOOD

CISCO SPRINGS 3 ROAD

GRAND COUNTY, UTAH

ROAD NUMBER 00384

State of Utah)
 : ss.
County of Grand)

JAMES ROBERT WESTWOOD, being first duly sworn, deposes and states as follows:

1. I am an adult competent to testify about the matters set forth below based upon my personal knowledge. I currently reside in Moab, Grand County, Utah. I have lived in Grand County for 64 years. I worked for the Grand County Road Department from 1961 to 1980.

2. I have traveled and am familiar with a road in Grand County known as Cisco Springs 3 Road. I am also familiar with the land the road traverses. When I first used and observed the road in the early 1960s it followed the same route as in 1980 when I last observed it. Attached is a Grand County map showing Cisco Springs 3 Road. To the best of my knowledge and based upon my use of and familiarity with this road and the land it traverses, the location and route of the road are correctly illustrated on the attached map.

3. I am informed that Grand County also identifies this road according to the road number listed above.

4. I have observed that the road has been open to the public for all to use, to come and go as they pleased, since at least as early as the early 1960s and continuing through 1980. Throughout this time period I observed travel on the road by means of road maintenance vehicles, jeeps and pickup trucks. During this time period, the road was used weekly, for more than ten continuous years prior to 1976 and was so used in 1980.

5. Throughout the time period from the early 1960s to 1980, I used the road myself for county road maintenance.

6. Throughout the time period described in the previous paragraph, I have observed other vehicles from the general public using the road at various times for the uses described in the previous paragraph plus oil and gas exploration, traveling in and through the area, livestock operations and sightseeing.

7. It is also the reputation in the community that this road has been open to the public for all to use, to come and go as they pleased, since at least as early as the early 1900s and continuing through 1976 to the present, for the uses described in the previous paragraphs.

8. Prior to 1976, I personally graded the road.

DATED this 8 day of September, 2007.

JAMES ROBERT WESTWOOD

SUBSCRIBED AND SWORN to before me this 8th day of September, 2007.

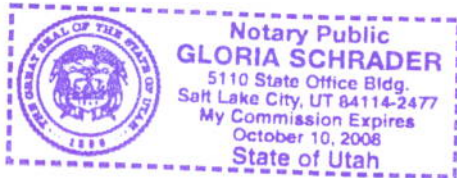

NOTARY PUBLIC

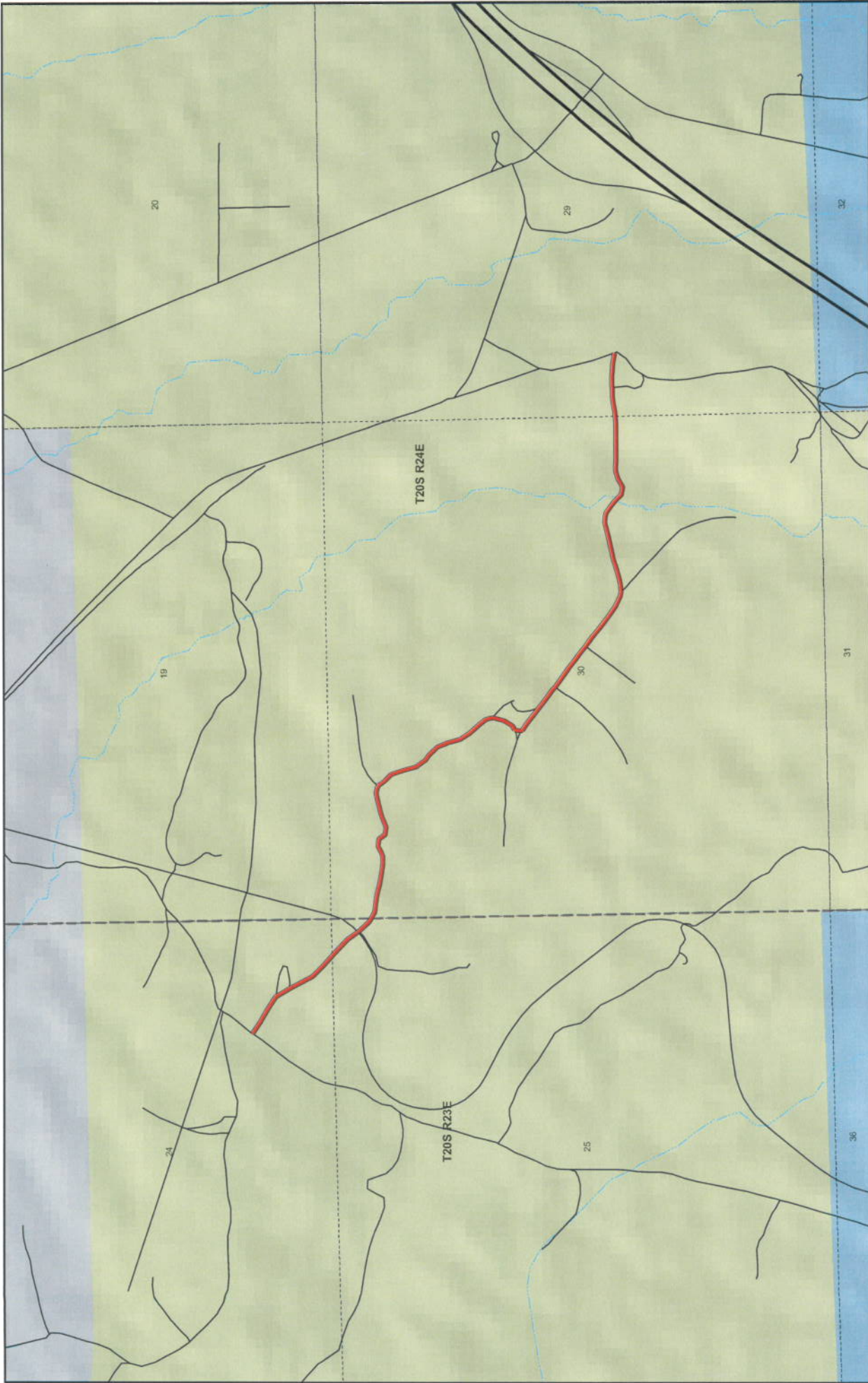



Prepared by the State of Utah
 Agriculture Geographic Reference Center
 AGRC
 Room 5130 State Office Building
 Salt Lake City, Utah 84114
 01/24/2007

Cisco Springs 3 County Unique - 00384

Land Ownership Categories

- BLM
- State Sovereign Land
- SITLA, State Trust Land
- USFS, National Forest
- National Park (NPS)
- Private

Misc

- Wildlife Reserve
- Military
- Wilderness
- State Park
- Tribal Lands

Transportation Network

- Cisco Springs 3
- State / U.S. Highway
- Local Roads

City / Town
 Municipalities
 Section = 1 Mile

484485 732 245

Appendix A to Attachment 4

Popular Name: CISCO SPRINGS 3 ROAD

County: Grand

County Road Number: 00384

State Geographic Information Database (SGID) Road Identification Number: RD100194.

Road-Segment Number: 001

Road-Segment Length: 0.3 miles more or less.

Believed owner of the land underlying this road-segment is: Bureau of Land Management.

The following description is based upon the geographic coordinate system using the NAD83 Datum. The source is GPS mapping grade data as indicated in the metadata and/or the transportation data model of the State of Utah Geographic Information Database (SGID).

The road-segment itself is the monument that is identified by its physical presence on the land. The location of said physical presence is closely approximated by mapping grade Global Positioning System (GPS) data. Said data are checked against the corresponding gray-scale 1-meter Digital Orthophoto Quadrangles published by the United States Geological Survey (USGS) to verify a reasonable degree of accuracy. In circumstances where accurate satellite signal acquisition is not possible, such as deep, narrow canyons or under a canopy of dense foliage, or where very sharp curves in the road make accuracy questionable, such portions of the road were digitized from the corresponding gray-scale 1-meter Digital Orthophoto Quadrangles published by the United States Geological Survey (USGS).

This road-segment may traverse:

Township 20 South Range 23 East, Section(s) 24,25, Salt Lake Base & Meridian

The following description closely approximates the location of the centerline of the physical monument (CISCO SPRINGS 3 ROAD)-- Segment 001 based on mapping grade Global Positioning System (GPS) data as defined above:

Beginning at a point on the road center line located at 39 degrees 02 minutes 50.73 seconds North Latitude and -109 degrees 19 minutes 03.43 seconds West Longitude, which can be converted to mapping accuracy State Plane Utah Central Zone NAD 83 feet coordinates of X = 2,260,183.5 feet and Y = 6,829,329.3 feet; thence the following courses along the said road center line:

thence South 56 Degrees 38 Minutes 52 Seconds East	147.9 feet
thence South 60 Degrees 31 Minutes 20 Seconds East	158.4 feet
thence South 57 Degrees 22 Minutes 00 Seconds East	153.7 feet
thence South 32 Degrees 20 Minutes 36 Seconds East	7.7 feet
thence South 32 Degrees 53 Minutes 56 Seconds East	109 feet
thence South 30 Degrees 01 Minutes 16 Seconds East	60.4 feet
thence South 28 Degrees 39 Minutes 50 Seconds East	268.4 feet
thence South 44 Degrees 46 Minutes 54 Seconds East	179.2 feet
thence South 47 Degrees 45 Minutes 17 Seconds East	123.8 feet
thence South 47 Degrees 45 Minutes 37 Seconds East	65.3 feet
thence South 47 Degrees 23 Minutes 12 Seconds East	166.1 feet

thence South 35 Degrees 43 Minutes 27 Seconds East 132.8 feet
thence South 37 Degrees 12 Minutes 28 Seconds East 8.2 feet more or less to **the ending point**
at: 39 degrees 02 minutes 039.5 seconds North Latitude and -109 degrees 18 minutes 50.04 seconds West
Longitude, which can be converted to mapping accuracy State Plane Utah Central Zone NAD 83 feet
coordinates of X = 2,261,267.8 feet and Y = 6,828,220.1 feet.

Appendix B to Attachment 4

Popular Name: CISCO SPRINGS 3 ROAD

County: Grand

County Road Number: 00384

State Geographic Information Database (SGID) Road Identification Number: RD100194.

Road-Segment Number: 002

Road-Segment Length: 1.51 miles more or less.

Believed owner of the land underlying this road-segment is: Bureau of Land Management.

The following description is based upon the geographic coordinate system using the NAD83 Datum. The source is GPS mapping grade data as indicated in the metadata and/or the transportation data model of the State of Utah Geographic Information Database (SGID).

The road-segment itself is the monument that is identified by its physical presence on the land. The location of said physical presence is closely approximated by mapping grade Global Positioning System (GPS) data. Said data are checked against the corresponding gray-scale 1-meter Digital Orthophoto Quadrangles published by the United States Geological Survey (USGS) to verify a reasonable degree of accuracy. In circumstances where accurate satellite signal acquisition is not possible, such as deep, narrow canyons or under a canopy of dense foliage, or where very sharp curves in the road make accuracy questionable, such portions of the road were digitized from the corresponding gray-scale 1-meter Digital Orthophoto Quadrangles published by the United States Geological Survey (USGS).

This road-segment may traverse:

Township 20 South Range 23 East, Section(s) 25, Salt Lake Base & Meridian

Township 20 South Range 24 East, Section(s) 29,30, Salt Lake Base & Meridian

The following description closely approximates the location of the centerline of the physical monument (CISCO SPRINGS 3 ROAD)-- Segment 002 based on mapping grade Global Positioning System (GPS) data as defined above:

Beginning at a point on the road center line located at 39 degrees 02 minutes 39.44 seconds North Latitude and -109 degrees 18 minutes 49.97 seconds West Longitude, which can be converted to mapping accuracy State Plane Utah Central Zone NAD 83 feet coordinates of X = 2,261,273.2 feet and Y = 6,828,213.5 feet; thence the following courses along the said road center line:

thence South 42 Degrees 17 Minutes 26 Seconds East	161 feet
thence South 61 Degrees 38 Minutes 43 Seconds East	32.8 feet
thence South 61 Degrees 38 Minutes 41 Seconds East	83.4 feet
thence South 84 Degrees 54 Minutes 36 Seconds East	86.7 feet
thence South 81 Degrees 47 Minutes 25 Seconds East	99.3 feet
thence South 74 Degrees 51 Minutes 17 Seconds East	98.3 feet
thence South 79 Degrees 24 Minutes 53 Seconds East	112.6 feet
thence South 82 Degrees 32 Minutes 41 Seconds East	108.9 feet
thence South 89 Degrees 14 Minutes 11 Seconds East	85.3 feet
thence North 67 Degrees 45 Minutes 54 Seconds East	44 feet

thence North 60 Degrees 59 Minutes 44 Seconds East 75.2 feet
 thence South 81 Degrees 49 Minutes 26 Seconds East 77.6 feet
 thence South 35 Degrees 43 Minutes 58 Seconds East 76.5 feet
 thence South 83 Degrees 32 Minutes 37 Seconds East 83.2 feet
 thence North 67 Degrees 58 Minutes 16 Seconds East 119.9 feet
 thence North 75 Degrees 53 Minutes 36 Seconds East 137.9 feet
 thence North 77 Degrees 19 Minutes 20 Seconds East 122.8 feet
 thence South 74 Degrees 10 Minutes 25 Seconds East 58.9 feet
 thence South 66 Degrees 02 Minutes 00 Seconds East 27.9 feet
 thence South 35 Degrees 10 Minutes 33 Seconds East 70 feet
 thence South 43 Degrees 22 Minutes 18 Seconds East 105.5 feet
 thence South 20 Degrees 58 Minutes 18 Seconds East 142 feet
 thence South 14 Degrees 27 Minutes 39 Seconds East 137 feet
 thence South 37 Degrees 35 Minutes 05 Seconds East 125.7 feet
 thence South 51 Degrees 55 Minutes 12 Seconds East 60.7 feet
 thence South 45 Degrees 27 Minutes 46 Seconds East 127.9 feet
 thence South 22 Degrees 11 Minutes 54 Seconds East 118.4 feet
 thence South 14 Degrees 11 Minutes 56 Seconds East 135.2 feet
 thence South 34 Degrees 08 Minutes 05 Seconds East 122.4 feet
 thence South 40 Degrees 53 Minutes 49 Seconds East 125.2 feet
 thence South 40 Degrees 36 Minutes 23 Seconds East 96.8 feet
 thence South 13 Degrees 25 Minutes 20 Seconds East 48.8 feet
 thence South 13 Degrees 47 Minutes 04 Seconds East 37.1 feet
 thence South 14 Degrees 34 Minutes 39 Seconds West 117.2 feet
 thence South 32 Degrees 06 Minutes 34 Seconds West 110.8 feet
 thence South 65 Degrees 56 Minutes 33 Seconds West 40.8 feet
 thence South 13 Degrees 17 Minutes 05 Seconds West 57.4 feet
 thence South 17 Degrees 27 Minutes 25 Seconds East 25.8 feet
 thence South 53 Degrees 56 Minutes 12 Seconds East 74.6 feet
 thence South 52 Degrees 21 Minutes 52 Seconds East 138.7 feet
 thence South 54 Degrees 07 Minutes 48 Seconds East 75 feet
 thence South 49 Degrees 56 Minutes 18 Seconds East 50.6 feet
 thence South 53 Degrees 53 Minutes 04 Seconds East 96.6 feet
 thence South 52 Degrees 49 Minutes 01 Seconds East 97 feet
 thence South 47 Degrees 14 Minutes 43 Seconds East 43.2 feet
 thence South 55 Degrees 23 Minutes 53 Seconds East 171.9 feet
 thence South 53 Degrees 09 Minutes 12 Seconds East 89.6 feet
 thence South 53 Degrees 22 Minutes 11 Seconds East 95.5 feet
 thence South 52 Degrees 19 Minutes 45 Seconds East 111.9 feet
 thence South 53 Degrees 02 Minutes 47 Seconds East 70.4 feet
 thence South 56 Degrees 38 Minutes 53 Seconds East 26.6 feet
 thence South 51 Degrees 08 Minutes 03 Seconds East 96 feet
 thence South 50 Degrees 40 Minutes 13 Seconds East 131.1 feet
 thence South 52 Degrees 35 Minutes 37 Seconds East 136.7 feet
 thence South 55 Degrees 00 Minutes 06 Seconds East 130.5 feet
 thence South 63 Degrees 54 Minutes 16 Seconds East 121.6 feet
 thence South 81 Degrees 59 Minutes 04 Seconds East 45.2 feet
 thence North 88 Degrees 09 Minutes 51 Seconds East 62.8 feet
 thence North 78 Degrees 02 Minutes 21 Seconds East 81.4 feet

thence North 72 Degrees 09 Minutes 01 Seconds East 92.7 feet
 thence North 73 Degrees 04 Minutes 08 Seconds East 114.9 feet
 thence North 76 Degrees 39 Minutes 32 Seconds East 124 feet
 thence North 77 Degrees 40 Minutes 19 Seconds East 142.2 feet
 thence North 76 Degrees 26 Minutes 20 Seconds East 143.5 feet
 thence South 88 Degrees 53 Minutes 33 Seconds East 65 feet
 thence South 75 Degrees 36 Minutes 19 Seconds East 45.2 feet
 thence South 54 Degrees 57 Minutes 00 Seconds East 87.8 feet
 thence South 49 Degrees 48 Minutes 02 Seconds East 70.7 feet
 thence South 49 Degrees 30 Minutes 49 Seconds East 20.1 feet
 thence South 54 Degrees 18 Minutes 39 Seconds East 11.2 feet
 thence South 41 Degrees 58 Minutes 19 Seconds East 19.8 feet
 thence South 44 Degrees 10 Minutes 09 Seconds East 43.2 feet
 thence South 79 Degrees 03 Minutes 17 Seconds East 83.8 feet
 thence North 59 Degrees 21 Minutes 39 Seconds East 104.1 feet
 thence North 73 Degrees 36 Minutes 21 Seconds East 89 feet
 thence North 86 Degrees 44 Minutes 37 Seconds East 32.2 feet
 thence South 86 Degrees 00 Minutes 37 Seconds East 65.2 feet
 thence North 89 Degrees 39 Minutes 41 Seconds East 77.5 feet
 thence South 89 Degrees 22 Minutes 47 Seconds East 98.1 feet
 thence North 89 Degrees 39 Minutes 41 Seconds East 98.8 feet
 thence South 89 Degrees 37 Minutes 40 Seconds East 132.3 feet
 thence North 84 Degrees 16 Minutes 53 Seconds East 67.9 feet
 thence North 84 Degrees 17 Minutes 22 Seconds East 54.7 feet
 thence North 80 Degrees 00 Minutes 05 Seconds East 78.2 feet
 thence North 81 Degrees 14 Minutes 04 Seconds East 89.6 feet
 thence North 89 Degrees 39 Minutes 41 Seconds East 85.1 feet
 thence North 71 Degrees 03 Minutes 11 Seconds East 20.6 feet
 thence North 89 Degrees 39 Minutes 41 Seconds East 50.2 feet
 thence South 88 Degrees 20 Minutes 14 Seconds East 47 feet
 thence South 86 Degrees 25 Minutes 41 Seconds East 48.1 feet
 thence South 84 Degrees 30 Minutes 43 Seconds East 80.8 feet
 thence South 80 Degrees 49 Minutes 36 Seconds East 119.1 feet more or less to **the ending**

point at: 39 degrees 02 minutes 11.23 seconds North Latitude and -109 degrees 17 minutes 32.98 seconds West Longitude, which can be converted to mapping accuracy State Plane Utah Central Zone NAD 83 feet coordinates of X = 2,267,416.4 feet and Y = 6,825,509.9 feet.