

**Acknowledgment and  
Notice of Acknowledgment  
of Acceptance of R.S. 2477  
Right-of-Way Grant**

Ent 106882 Bk 127 Pg 113  
Date: 16-JUN-2008 9:41AM  
Fee: None  
Filed By: RC  
SHANE A. MILLETT, Recorder  
PIUTE COUNTY CORPORATION  
For: GOVERNOR OF THE STATE OF UTAH

**THE STATE OF UTAH**

**TO ALL WHOM THESE PRESENTS SHALL COME, Greeting:**

**Know ye,** This is an Acknowledgment and Notice of Acknowledgment made under Utah Code Sections 72-5-309 through 310 inclusive, that the grant of the United States of America of “the right of way for the construction of highways over public lands, not reserved for public uses” under United States Revised Statutes 2477 (43 U.S.C. Section 932 (repealed October 21, 1976, with proviso recognizing the validity of rights-of-way already established)) was accepted for and on behalf of the State of Utah and its political subdivision Piute County as it pertains to the highway located in Piute County known as EAST PIUTE RESERVOIR "A" ROAD; County Road Number: PCRD3A; State Geographic Information Database (SGID) Road Identification Number: RD16003E. Total road length is 0.32 miles more or less.

The reason for this Acknowledgment and Notice of Acknowledgment includes, but is not limited to, the fact that the road was constructed, mechanically, or by continuous use as a public highway for a period of at least ten years, over public lands not reserved for public uses, prior to the earlier of (a) the October 21, 1976 repeal of R.S. 2477 or (b) the date the servient estate was reserved for public uses.

This Acknowledgment and Notice of Acknowledgment applies only to the segments of the road that traverse land owned by the Bureau of Land Management, United States Department of the Interior, and does not apply to segments of the road that traverse land owned by any other person or entity. The State of Utah and its political subdivisions reserve the right to make further acknowledgments and notices of acknowledgment with regard to road segments that traverse land owned by other entities, including the United States of America, through one or more of its agencies.

A printed copy of a map showing the location of the road in said county is appended hereto as “Attachment 1,” a printed copy of representative photos of the road is appended hereto as “Attachment 2,” a printed copy of a description of the beginning and ending points of the entire road together with a list of Townships, Ranges and Sections that may be traversed by the road in said county is appended hereto as “Attachment 3,” and a printed copy of the Road Centerline Description Cover Page(s) is appended hereto as “Attachment 4.” The Appendices listed in “Attachment 4” that contain the actual road centerline descriptions are incorporated herein by reference. Affidavits provided by individuals familiar with the road are appended hereto as “Attachment 5.”

A printed copy of this Acknowledgment and Notice of Acknowledgment, together with its Attachments and Appendices, may be viewed and/or obtained at the office of the Utah State Archives.

An electronic copy of this Acknowledgment and Notice of Acknowledgment, together with its Attachments and Appendices, may be viewed and/or downloaded as read-only PDF (Portable Document Format) files via the

Internet at <http://recorded2477roads.utah.gov>.

The owner of the servient estate in the land underlying the road-segments subject to this Acknowledgment and Notice is believed to be the United States of America through one or more of its agencies. Any of such agencies or any other person with a servient ownership claim or a competing dominant estate right-of-way ownership claim, may file a petition in the State District Court for Salt Lake County for a decision regarding the correctness of this Acknowledgment. A claimant shall file a petition within sixty (60) days after receipt of this Notice.

**In Witness Whereof**, I, John Harja, the official designee of the Governor of the State of Utah, in conformity to the laws of the State (Utah Code Sections 72-5-308 through 310 inclusive), have caused this Acknowledgment and Notice of Acknowledgment to be made.

Signed by my hand in Salt Lake City, Utah, the 12<sup>th</sup> day of June, 2008.

By the Governor's Designee

  
\_\_\_\_\_  
John Harja

**CERTIFICATION**

State of Utah                    )  
  : ss  
County of Salt Lake         )

I hereby certify that the signer of the foregoing document, John Harja, is personally known by me, has made a voluntary signature and taken an oath stating that he is the official designee of the Governor of the State of Utah and is authorized to sign this document on the Governor's behalf pursuant to Utah Code Section 72-5-309. He further vouched that, based upon information and belief, the facts alleged therein are true.

Dated this 12 day of June, 2008.

  
\_\_\_\_\_  
Notary Public

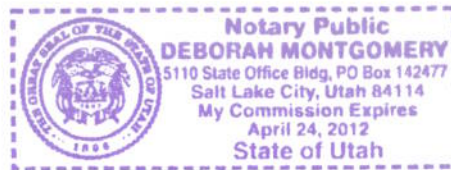

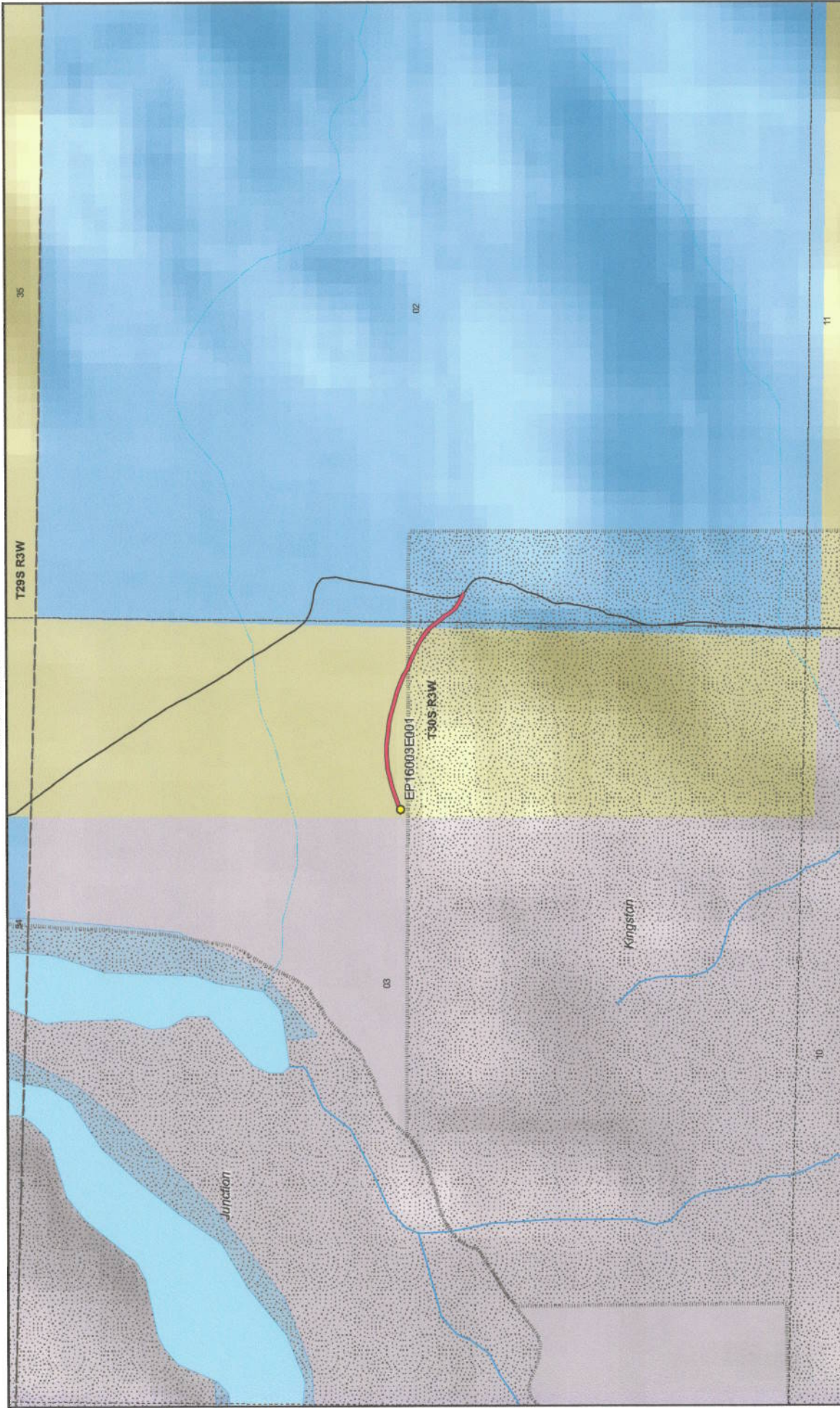



1:11,014  
1 inch equals 0.2 miles



### EAST PIUTE RESERVOIR "A" ROAD - Piute County

#### SGID RD\_ID RD16003E

**Land Ownership Categories**

- BLM
- Private
- SITLA, State Trust Land
- USFS, National Forest
- State Parks and Recreation
- Tribal, Indian Reservation
- NPS, National Park
- Wilderness
- JDWR Wildlife Reserve
- DOD, Military
- State Sovereign Land
- National Recreation Area
- USFWS, Natl. Wildlife Refuge

**Transportation Network**

- EAST PIUTE RESERVOIR "A" ROAD
- Other Roads
- Title V, Issued Or Under Consideration By BLM Or County
- Photo Event Point
- Section = 1 Mile

Map prepared by the State of Utah  
Automated Geographic Reference Center  
Room 9130 State Capitol Building  
Salt Lake City, Utah 84114  
Jun 11, 2008



Attachment 2



EP16003E001

EP000000000

EP000000000

EP000000000

EP000000000

EP000000000

**EAST PIUTE RESERVOIR "A" ROAD - Piute County**  
**SGID RD\_ID RD16003E**



Map prepared by the State of Utah  
Automated Geographic Reference Center  
Room 5130 State Office Building  
Salt Lake City, Utah 84114  
June 10, 2008



## Attachment 3

### Beginning & Ending Points and Township, Range, and Section References For:

**Popular Name: EAST PIUTE RESERVOIR "A" ROAD**

**County: Piute**

**County Road Number: PCRD3A**

**State Geographic Information Database (SGID) Road Identification Number: RD16003E.**

**Total Road Length: 0.32 miles more or less.**

**Beginning at a point** on the road centerline located at 38 degrees 13 minutes 50.25 seconds North Latitude and -112 degrees 10 minutes 57.28 seconds West Longitude, which can be converted to mapping accuracy State Plane Utah South Zone NAD 83 feet coordinates of X = 1,444,345.5 feet and Y = 10,412,694.0 feet based on the US Survey Foot conversion.

**Ending at a point** on the road centerline located at 38 degrees 13 minutes 046.2 seconds North Latitude and -112 degrees 10 minutes 38.26 seconds West Longitude, which can be converted to mapping accuracy State Plane Utah South Zone NAD 83 feet coordinates of X = 1,445,860.4 feet and Y = 10,412,274.0 feet based on the US Survey Foot conversion.

This road may traverse:

Township 30 South Range 3 West, Section(s) 2,3, Salt Lake Base & Meridian  
See Attachment 1 above for a cartographic depiction of the course of this road.

**Attachment 4  
Road Centerline Description Cover Page(s)**

**Popular Name: EAST PIUTE RESERVOIR "A" ROAD**

**County: Piute**

**County Road Number: PCRD3A**

**State Geographic Information Database (SGID) Road Identification Number: RD16003E.**

**Total Road Length: 0.32 miles more or less.**

**Centerline Descriptions Of Road-Segments That Cross Over Federally Owned Land, Derived From Global Positioning System Data And Cross-checked against USGS Digital Orthophoto Quadrangles Compiled By The Utah Automated Geographic Reference Center And Entered Into The State Geographic Information Database (SGID).**

<b>Road-Segments Listed by SGID Road Identification Number (RD_ID)</b>	<b>Road-Segment Numbers</b>	<b>Believed Ownership Of Servient Estate</b>	<b>Approximate Segment Length</b>	<b>See Attached Appendix</b>
<b>RD16003E</b>	<b>001</b>	<b>BLM</b>	<b>0.26 Miles</b>	<b>A</b>
<b>RD16003E</b>	<b>002</b>	<b>ST</b>	<b>0.06 Miles</b>	<b>(not shown)</b>
		<b>Total Road Length</b>	<b>0.32</b>	<b>_____</b>

\* Indicates that a Title V permit will be requested, is in process, or has been issued.

† Indicates that road-segments crossing Forest Service land are under consideration by the state and county as of the date of this Acknowledgment and Notice of Acknowledgment.

**Attachment 5**

**AFFIDAVIT OF JOAN ANDERSON**  
**EAST PIUTE RESERVOIR "A" ROAD**  
**PIUTE COUNTY, UTAH**  
**ROAD NUMBER PCRD 3A**

State of Utah                    )  
  : ss.  
County of Piute                 )

JOAN ANDERSON, being first duly sworn, deposes and states as follows:

1. I am an adult competent to testify about the matters set forth below based upon my personal knowledge. I currently reside in Piute County, Utah. I have lived in Piute County for 72 years.

2. I have traveled and am familiar with a road in Piute County known as East Piute Reservoir "A" Road. I am also familiar with the land the road traverses. When I first used and observed the road in the early 1950s, it followed the same route as in 2007 when I last observed it. Attached is a Piute County map showing East Piute Reservoir "A" Road. To the best of my knowledge and based upon my use of and familiarity with this road and the land it traverses, the location and route of the road are correctly illustrated on the attached map.

3. I am informed that the County also identifies this road according to the road number listed above.

4. I have observed that the road has been open to the public for all to use, to come and go as they pleased, since at least as early as the early 1950s and continuing through 1976 to 2007. Throughout this time period I have observed travel on the road by various means, including trucks, cars, jeeps, recreational vehicles and pickup trucks. Throughout this time period, the road has been used daily for more than ten continuous years prior to 1976, and was used daily in 2007.



5. Throughout the time period from the early 1950s to 2007, I have used the road myself for the following uses: rock hounding, hunting, photography, search and rescue and recreation.

6. Throughout the time period described in the previous paragraph, I observed other vehicles from the general public using the road at various times for the uses described in the previous paragraph, plus the following uses: livestock operations, gravel pit access and prospecting for minerals.

7. It is also the reputation in the community that this road has been open to the public for all to use, to come and go as they pleased, since at least as early as the early 1900s and continuing through 1976 to the present, for the uses described in the previous paragraphs.

8. Prior to 1976, I observed the graded surface of the road.

DATED this 20 day of May, 2008.

  
JOAN ANDERSON

SUBSCRIBED AND SWORN to before me this 20<sup>th</sup> day of May, 2008.

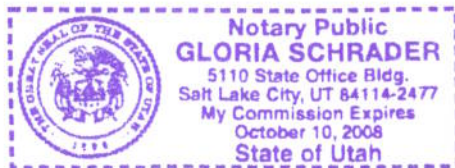

  
NOTARY PUBLIC

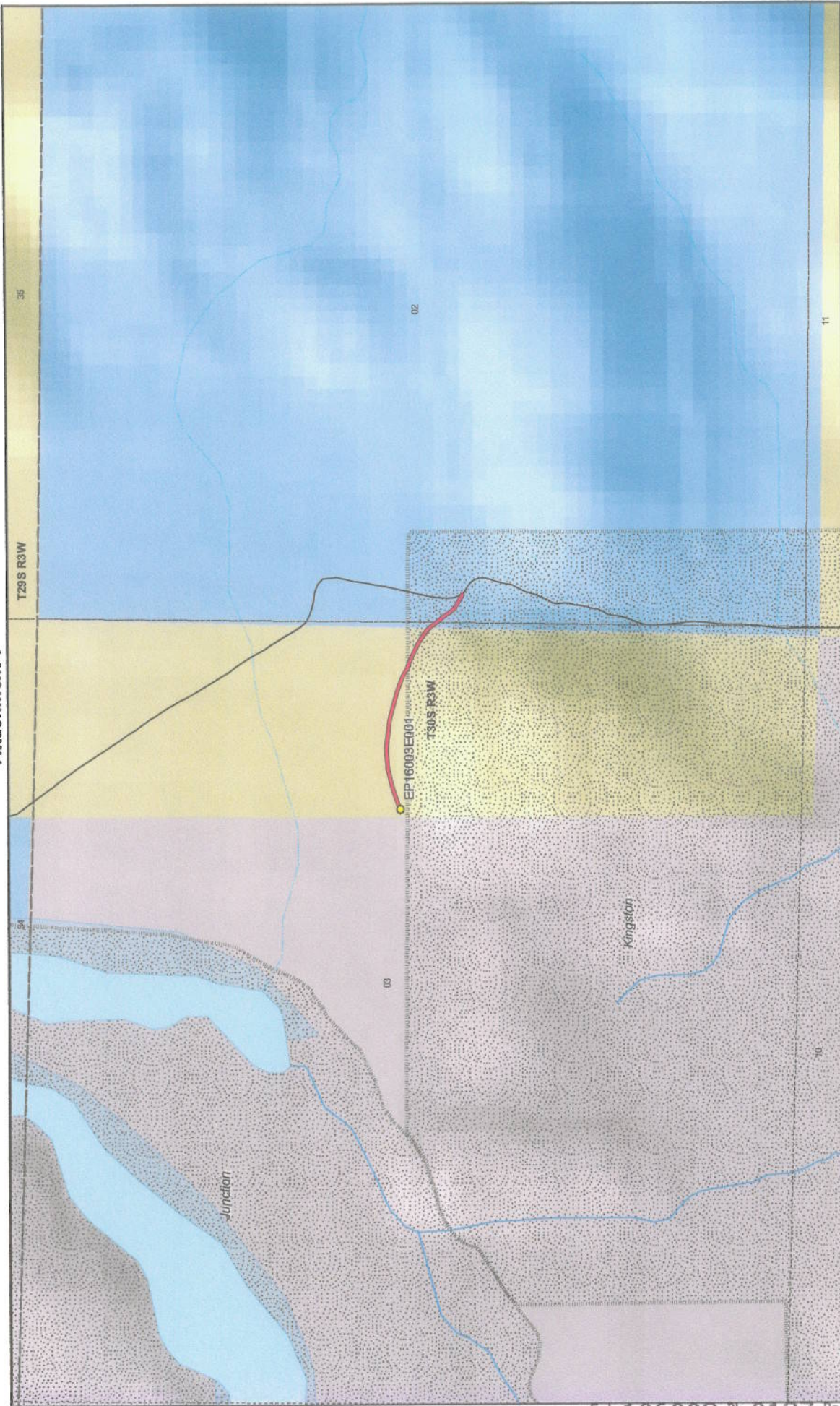



1:11,014  
1 inch equals 0.2 miles



### EAST PIUTE RESERVOIR "A" ROAD - Piute County SGID RD\_ID RD16003E

<b>Land Ownership Categories</b> <ul style="list-style-type: none"> <li>BLM</li> <li>Private</li> <li>SITLA, State Trust Land</li> <li>USFS, National Forest</li> <li>State Parks and Recreation</li> <li>Tribal, Indian Reservation</li> <li>NPS, National Park</li> <li>Wilderness</li> <li>UDWR Wildlife Reserve</li> <li>DOD, Military</li> <li>State Sovereign Land</li> <li>National Recreation Area</li> <li>USFWS, Natl. Wildlife Refuge</li> </ul>	<b>Transportation Network</b> <ul style="list-style-type: none"> <li>EAST PIUTE RESERVOIR "A" ROAD</li> <li>Other Roads</li> <li>Title V: Issued Or Under Consideration By BLM Or County</li> <li>Photo Event Point</li> <li>Section = 1 Mile</li> </ul>
--	---

Map prepared by the State of Utah  
Automated Geographic Reference Center  
Room 5130 State Office Building  
Salt Lake City, Utah 84114  
Jun 11, 2008



**AFFIDAVIT OF AFTON BLOOD**  
**EAST PIUTE RESERVOIR "A" ROAD**  
**PIUTE COUNTY, UTAH**  
**ROAD NUMBER PCRD3A**

State of Utah                    )  
  : ss.  
County of Piute                 )

AFTON BLOOD, being first duly sworn, deposes and states as follows:

1. I am an adult competent to testify about the matters set forth below based upon my personal knowledge. I currently reside in Piute County, Utah. I have lived in Piute County for 81 years.
2. I have traveled and am familiar with a road in Piute County known as East Piute Reservoir "A" Road. I am also familiar with the land the road traverses. When I first used and observed the road in the late 1940s, it followed the same route as in the early 1990s when I last observed it. Attached is a Piute County map showing East Piute Reservoir "A" Road. To the best of my knowledge and based upon my use of and familiarity with this road and the land it traverses, the location and route of the road are correctly illustrated on the attached map.
3. I am informed that the County also identifies this road according to the road number listed above.
4. I have observed that the road has been open to the public for all to use, to come and go as they pleased, since at least as early as the late 1940s and continuing through 1976 to the early 1990s. Throughout this time period I have observed travel on the road by various means, including trucks, recreational vehicles, and pickup trucks. Throughout this time period, the road has been used daily, weather permitting for more than ten continuous years prior to 1976, and was used daily, weather permitting in the early 1990s.
5. Throughout the time period from the late 1940s to the early 1990s, I have used the

road myself for the following uses: fishing, hunting, livestock operations, recreation and traveling in and through the area.

6. Throughout the time period described in the previous paragraph, I observed other vehicles from the general public using the road at various times for the uses described in the previous paragraph, plus the following uses: prospecting for minerals, government access and tourism.

7. It is also the reputation in the community that this road has been open to the public for all to use, to come and go as they pleased, since at least as the early 1900s and continuing through 1976 to the present, for the uses described in the previous paragraphs.

8. Prior to 1976, I observed the graded surface of the road.

DATED this 19 day of May, 2008.

  
AFTON BLOOD

SUBSCRIBED AND SWORN to before me this 19<sup>th</sup> day of May, 2008.

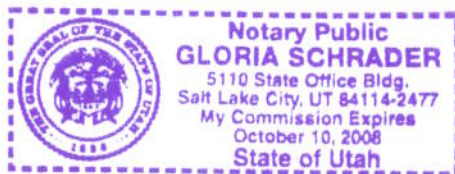

  
NOTARY PUBLIC

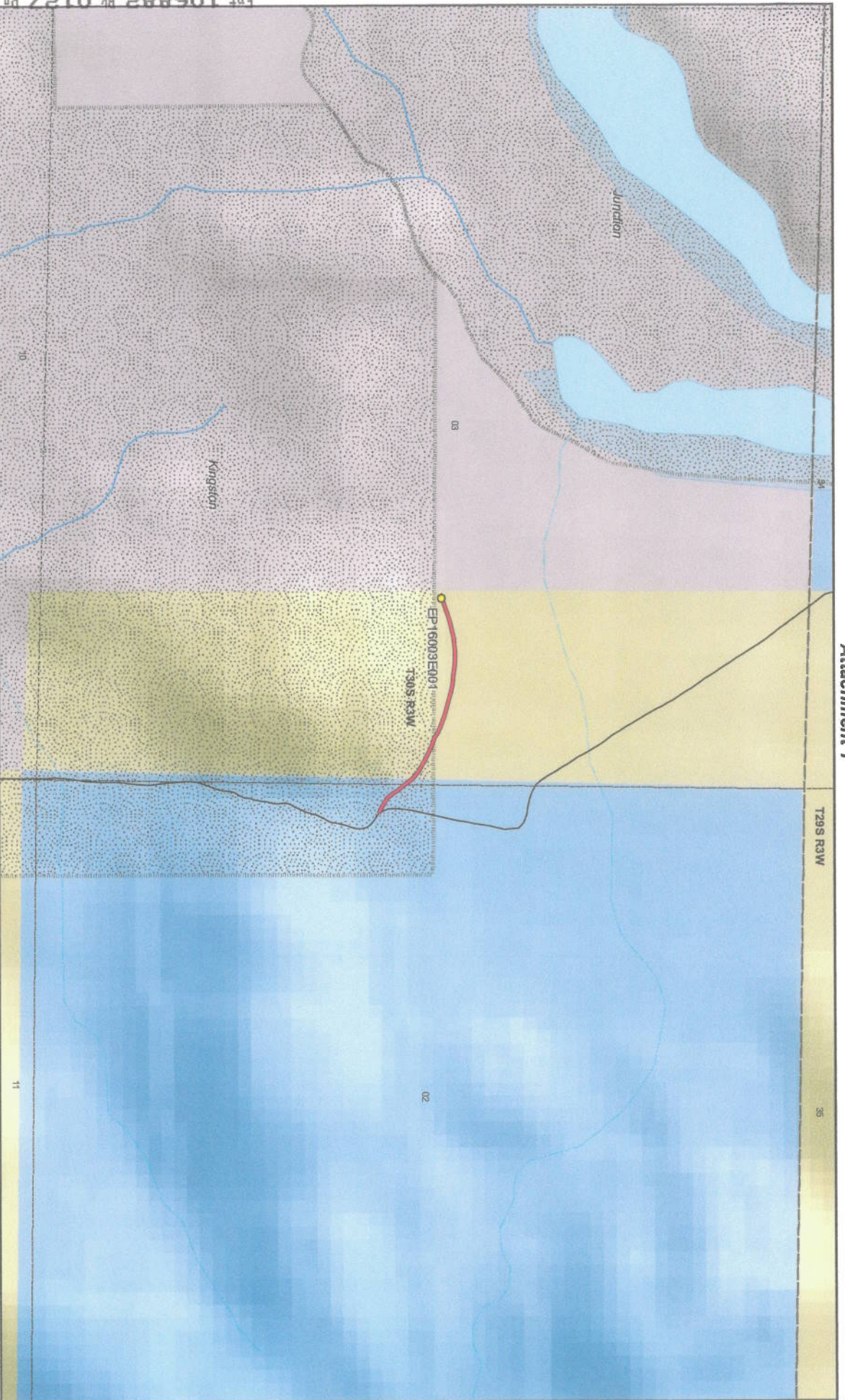

Ent 106882 BK 0127 Pg 0125



1:11,014  
1 inch equals 0.2 miles



- Land Ownership Categories**
- BLM
  - Private
  - SITTLA, State Trust Land
  - USFS, National Forest
  - State Parks and Recreation
  - Tribal, Indian Reservation
  - NPS, National Park

- Wilderness
- UDWR Wildlife Reserve
- DOD, Military
- State Sovereign Land
- National Recreation Area
- USFWS, Natl. Wildlife Refuge

- Transportation Network**
- EAST PUTE RESERVOIR "A" ROAD
  - Other Roads
  - Title V, Issued Or Under Consideration By BLM Or County
  - Photo Event Point
  - Section = 1 Mile

**EAST PUTE RESERVOIR "A" ROAD - Piute County**  
**SGID RD\_ID RD16003E**

Map prepared by the State of Utah  
Agriculture and Forestry Reference Center  
Room 5130 State Office Building  
Salt Lake City, Utah 84114  
Jun 11, 2008



## Appendix A to Attachment 4

**Popular Name: EAST PIUTE RESERVOIR "A" ROAD**

**County: Piute**

**County Road Number: PCRD3A**

**State Geographic Information Database (SGID) Road Identification Number: RD16003E.**

**Road-Segment Number: 001**

**Road-Segment Length: 0.26 miles more or less.**

**Believed owner of the land underlying this road-segment is: Bureau of Land Management.**

*The following description is based upon the geographic coordinate system using the NAD83 Datum. The source is GPS mapping grade data as indicated in the metadata and/or the transportation data model of the State of Utah Geographic Information Database (SGID).*

The road-segment itself is the monument that is identified by its physical presence on the land. The location of said physical presence is closely approximated by mapping grade Global Positioning System (GPS) data. Said data are checked against the corresponding gray-scale 1-meter Digital Orthophoto Quadrangles published by the United States Geological Survey (USGS) to verify a reasonable degree of accuracy. In circumstances where accurate satellite signal acquisition is not possible, such as deep, narrow canyons or under a canopy of dense foliage, or where very sharp curves in the road make accuracy questionable, such portions of the road were digitized from the corresponding gray-scale 1-meter Digital Orthophoto Quadrangles published by the United States Geological Survey (USGS).

This road-segment may traverse:

Township 30 South Range 3 West, Section(s) 3, Salt Lake Base & Meridian

The following description closely approximates the location of the centerline of the physical monument (EAST PIUTE RESERVOIR "A" ROAD)-- Segment 001 based on mapping grade Global Positioning System (GPS) data as defined above:

**Beginning at a point** on the road center line located at 38 degrees 13 minutes 50.25 seconds North Latitude and -112 degrees 10 minutes 57.28 seconds West Longitude, which can be converted to mapping accuracy State Plane Utah South Zone NAD 83 feet coordinates of X = 1,444,345.5 feet and Y = 10,412,694.0 feet; thence the following courses along the said road center line:

thence North 64 Degrees 56 Minutes 48 Seconds East	36.9 feet
thence North 65 Degrees 49 Minutes 34 Seconds East	37.3 feet
thence North 72 Degrees 30 Minutes 37 Seconds East	37.8 feet
thence North 73 Degrees 10 Minutes 06 Seconds East	49.6 feet
thence North 71 Degrees 28 Minutes 09 Seconds East	54.6 feet
thence North 74 Degrees 34 Minutes 48 Seconds East	55.4 feet
thence North 78 Degrees 31 Minutes 17 Seconds East	50.8 feet
thence North 81 Degrees 39 Minutes 50 Seconds East	49.4 feet
thence North 86 Degrees 49 Minutes 26 Seconds East	52.6 feet
thence South 88 Degrees 50 Minutes 07 Seconds East	50.9 feet
thence South 85 Degrees 49 Minutes 44 Seconds East	50.4 feet

thence South 84 Degrees 30 Minutes 04 Seconds East 55.1 feet  
thence South 82 Degrees 28 Minutes 19 Seconds East 55.3 feet  
thence South 81 Degrees 32 Minutes 34 Seconds East 58.1 feet  
thence South 74 Degrees 37 Minutes 25 Seconds East 60.7 feet  
thence South 73 Degrees 16 Minutes 50 Seconds East 59.4 feet  
thence South 72 Degrees 58 Minutes 42 Seconds East 59.5 feet  
thence South 72 Degrees 05 Minutes 05 Seconds East 57.7 feet  
thence South 64 Degrees 22 Minutes 47 Seconds East 53.3 feet  
thence South 60 Degrees 58 Minutes 32 Seconds East 51.6 feet  
thence South 69 Degrees 35 Minutes 17 Seconds East 51.9 feet  
thence South 66 Degrees 54 Minutes 32 Seconds East 47.9 feet  
thence South 61 Degrees 38 Minutes 25 Seconds East 47.9 feet  
thence South 62 Degrees 37 Minutes 19 Seconds East 52.3 feet  
thence South 61 Degrees 43 Minutes 51 Seconds East 54.2 feet  
thence South 49 Degrees 52 Minutes 02 Seconds East 52.6 feet  
thence South 41 Degrees 13 Minutes 40 Seconds East 13 feet more or less to **the ending point**

at: 38 degrees 13 minutes 048.5 seconds North Latitude and -112 degrees 10 minutes 041.3 seconds West Longitude, which can be converted to mapping accuracy State Plane Utah South Zone NAD 83 feet coordinates of X = 1,445,619.2 feet and Y = 10,412,507.7 feet.