

Ent 106909 Bk 127 Pg 464
Date: 16-JUN-2008 11:29AM
Fee: None
Filed By: RC
SHANE A. MILLETT, Recorder
PIUTE COUNTY CORPORATION
For: GOVERNOR OF THE STATE OF UTAH

**Acknowledgment and
Notice of Acknowledgment
of Acceptance of R.S. 2477
Right-of-Way Grant**

THE STATE OF UTAH

TO ALL WHOM THESE PRESENTS SHALL COME, Greeting:

Know ye, This is an Acknowledgment and Notice of Acknowledgment made under Utah Code Sections 72-5-309 through 310 inclusive, that the grant of the United States of America of “the right of way for the construction of highways over public lands, not reserved for public uses” under United States Revised Statutes 2477 (43 U.S.C. Section 932 (repealed October 21, 1976, with proviso recognizing the validity of rights-of-way already established)) was accepted for and on behalf of the State of Utah and its political subdivision Piute County as it pertains to the highway located in Piute County known as HORSE PASTURE ROAD; County Road Number: PCRD51; State Geographic Information Database (SGID) Road Identification Number: RD160051. Total road length is 0.23 miles more or less.

The reason for this Acknowledgment and Notice of Acknowledgment includes, but is not limited to, the fact that the road was constructed, mechanically, or by continuous use as a public highway for a period of at least ten years, over public lands not reserved for public uses, prior to the earlier of (a) the October 21, 1976 repeal of R.S. 2477 or (b) the date the servient estate was reserved for public uses.

This Acknowledgment and Notice of Acknowledgment applies only to the segments of the road that traverse land owned by the Bureau of Land Management, United States Department of the Interior, and does not apply to segments of the road that traverse land owned by any other person or entity. The State of Utah and its political subdivisions reserve the right to make further acknowledgments and notices of acknowledgment with regard to road segments that traverse land owned by other entities, including the United States of America, through one or more of its agencies.

A printed copy of a map showing the location of the road in said county is appended hereto as “Attachment 1,” a printed copy of representative photos of the road is appended hereto as “Attachment 2,” a printed copy of a description of the beginning and ending points of the entire road together with a list of Townships, Ranges and Sections that may be traversed by the road in said county is appended hereto as “Attachment 3,” and a printed copy of the Road Centerline Description Cover Page(s) is appended hereto as “Attachment 4.” The Appendices listed in “Attachment 4” that contain the actual road centerline descriptions are incorporated herein by reference. Affidavits provided by individuals familiar with the road are appended hereto as “Attachment 5.”

A printed copy of this Acknowledgment and Notice of Acknowledgment, together with its Attachments and Appendices, may be viewed and/or obtained at the office of the Utah State Archives.

An electronic copy of this Acknowledgment and Notice of Acknowledgment, together with its Attachments and Appendices, may be viewed and/or downloaded as read-only PDF (Portable Document Format) files via the

Internet at <http://recorded2477roads.utah.gov>.

The owner of the servient estate in the land underlying the road-segments subject to this Acknowledgment and Notice is believed to be the United States of America through one or more of its agencies. Any of such agencies or any other person with a servient ownership claim or a competing dominant estate right-of-way ownership claim, may file a petition in the State District Court for Salt Lake County for a decision regarding the correctness of this Acknowledgment. A claimant shall file a petition within sixty (60) days after receipt of this Notice.

In Witness Whereof, I, John Harja, the official designee of the Governor of the State of Utah, in conformity to the laws of the State (Utah Code Sections 72-5-308 through 310 inclusive), have caused this Acknowledgment and Notice of Acknowledgment to be made.

Signed by my hand in Salt Lake City, Utah, the 12th day of June, 2008.

By the Governor's Designee



John Harja

CERTIFICATION

State of Utah)
 : ss
County of Salt Lake)

I hereby certify that the signer of the foregoing document, John Harja, is personally known by me, has made a voluntary signature and taken an oath stating that he is the official designee of the Governor of the State of Utah and is authorized to sign this document on the Governor's behalf pursuant to Utah Code Section 72-5-309. He further vouched that, based upon information and belief, the facts alleged therein are true.

Dated this 12 day of June, 2008.



Notary Public

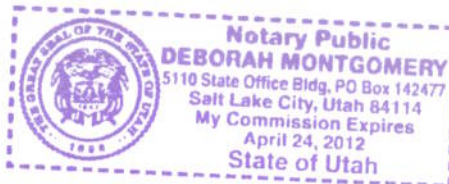

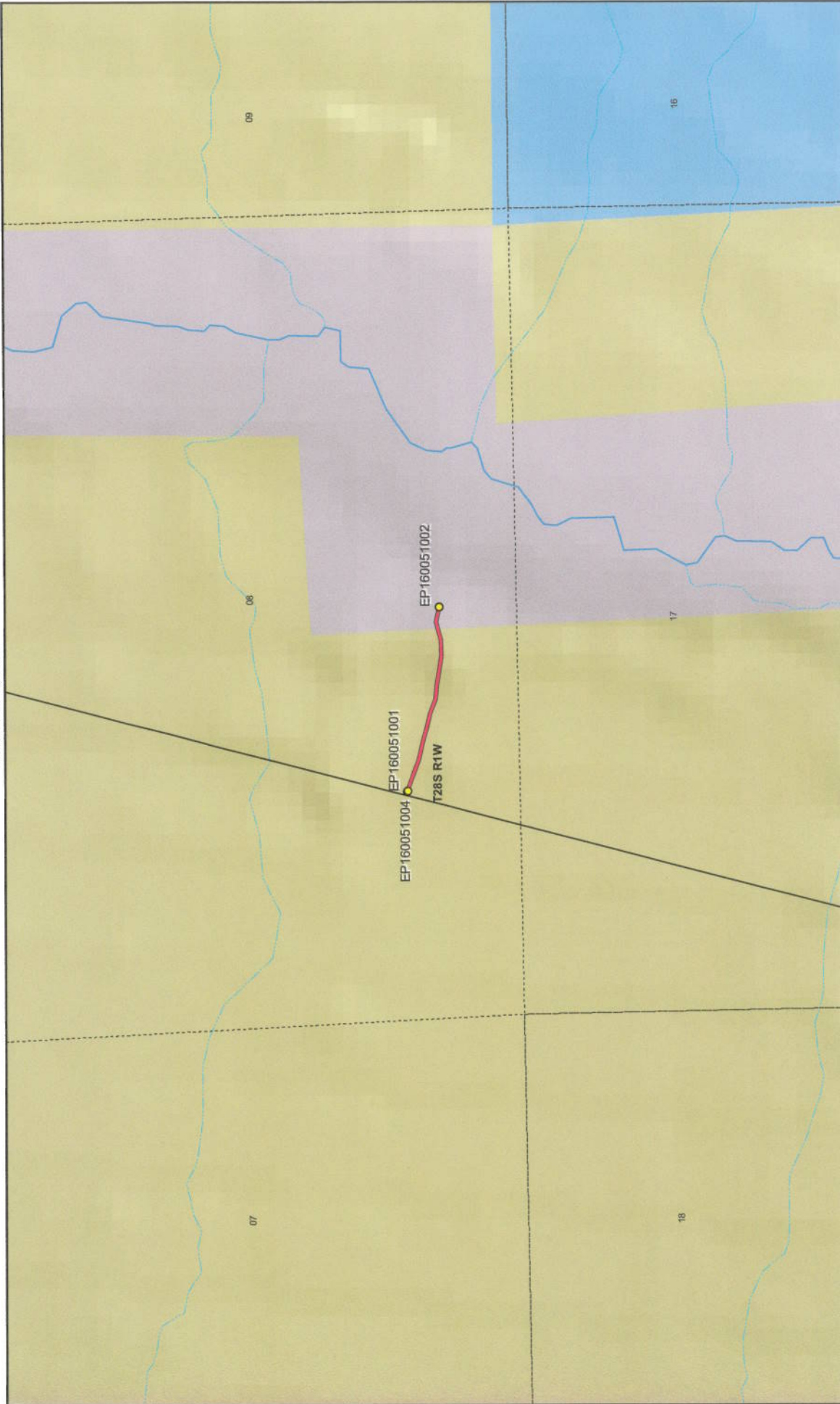

Map prepared by the State of Utah
 Automated Geographic Reference Center
 Room 5100, Capitol Building
 Salt Lake City, Utah 84114
 Jun 10, 2008

HORSE PASTURE ROAD - Piute County SGID RD_ID RD160051

| Land Ownership Categories | Transportation Network |
|--|---|
| <ul style="list-style-type: none"> BLM Private SITLA, State Trust Land USFS, National Forest State Parks and Recreation Tribal, Indian Reservation NPS, National Park | <ul style="list-style-type: none"> Wilderness UDWR, Wildlife Reserve DOD, Military State Sovereign Land National Recreation Area USFWS, Natl. Wildlife Refuge |
| <ul style="list-style-type: none"> Other Roads Title V: Issued Or Under Consideration By BLM Or County Photo Event Point | <ul style="list-style-type: none"> HORSE PASTURE ROAD Section = 1 Mile |

Attachment 2



EP160051002



EP160051004



EP160051001

EP000000000

EP000000000

EP000000000

HORSE PASTURE ROAD - Piute County
SGID RD_ID RD160051



Map prepared by the State of Utah
Automated Geographic Reference Center
Room 5130 State Office Building
Salt Lake City, Utah 84114
June 10, 2008



Attachment 3

Beginning & Ending Points and Township, Range, and Section References For:

Popular Name: HORSE PASTURE ROAD

County: Piute

County Road Number: PCRD51

State Geographic Information Database (SGID) Road Identification Number: RD160051.

Total Road Length: 0.23 miles more or less.

Beginning at a point on the road centerline located at 38 degrees 23 minutes 03.04 seconds North Latitude and -111 degrees 56 minutes 5 seconds West Longitude, which can be converted to mapping accuracy State Plane Utah South Zone NAD 83 feet coordinates of X = 1,515,801.8 feet and Y = 10,468,188.4 feet based on the US Survey Foot conversion.

Ending at a point on the road centerline located at 38 degrees 23 minutes 01.01 seconds North Latitude and -111 degrees 55 minutes 49.91 seconds West Longitude, which can be converted to mapping accuracy State Plane Utah South Zone NAD 83 feet coordinates of X = 1,517,002.2 feet and Y = 10,467,978.0 feet based on the US Survey Foot conversion.

This road may traverse:

Township 28 South Range 1 West, Section(s) 8, Salt Lake Base & Meridian
See Attachment 1 above for a cartographic depiction of the course of this road.

**Attachment 4
Road Centerline Description Cover Page(s)**

Popular Name: HORSE PASTURE ROAD

County: Piute

County Road Number: PCRD51

State Geographic Information Database (SGID) Road Identification Number: RD160051.

Total Road Length: 0.23 miles more or less.

Centerline Descriptions Of Road-Segments That Cross Over Federally Owned Land, Derived From Global Positioning System Data And Cross-checked against USGS Digital Orthophoto Quadrangles Compiled By The Utah Automated Geographic Reference Center And Entered Into The State Geographic Information Database (SGID).

| Road-Segments Listed by SGID Road Identification Number (RD ID) | Road-Segment Numbers | Believed Ownership Of Servient Estate | Approximate Segment Length | See Attached Appendix |
|--|---------------------------------|--|---|----------------------------------|
| RD160051 | 001 | BLM | 0.21 Miles | A |
| RD160051 | 002 | PVT | 0.02 Miles | (not shown) |
| | | Total Road Length | 0.23 | _____ |

* Indicates that a Title V permit will be requested, is in process, or has been issued.

† Indicates that road-segments crossing Forest Service land are under consideration by the state and county as of the date of this Acknowledgment and Notice of Acknowledgment.

Attachment 5

AFFIDAVIT OF MAVEN T. BAGLEY

HORSE PASTURE ROAD

PIUTE COUNTY, UTAH

ROAD NUMBER PCRD51

State of Utah)
 : ss.
County of Piute)

MAVEN T. BAGLEY, being first duly sworn, deposes and states as follows:

1. I am an adult competent to testify about the matters set forth below based upon my personal knowledge. I currently reside in Piute County, Utah. I have lived in Piute County for most of the past 77 years.

2. I have traveled and am familiar with a road in Piute County known as Horse Pasture Road. I am also familiar with the land the road traverses. When I first used and observed the road in the early 1940s, it followed the same route as in 2007 when I last observed it. Attached is a Piute County map showing Horse Pasture Road. To the best of my knowledge and based upon my use of and familiarity with this road and the land it traverses, the location and route of the road are correctly illustrated on the attached map.

3. I am informed that the County also identifies this road according to the road number listed above.

4. I have observed that the road has been open to the public for all to use, to come and go as they pleased, since at least as early as the early 1940s and continuing through 1976 to 2007. Throughout this time period I have observed travel on the road by various means, including trucks, recreational vehicles, and pickup trucks. Throughout this time period, the road has been used daily for more than ten continuous years prior to 1976, and was used daily in 2007.

5. Throughout the time period from the early 1940s to 2007, I have used the road myself for the following uses: residential access and travel in and through the area.

6. Throughout the time period described in the previous paragraph, I observed other vehicles from the general public using the road at various times for the uses described in the previous paragraph, plus the following uses: livestock operations and farming.

7. It is also the reputation in the community that this road has been open to the public for all to use, to come and go as they pleased, since at least as the early 1900s and continuing through 1976 to the present, for the uses described in the previous paragraphs.

8. Prior to 1976, I observed the graded surface of the road.

DATED this 19 day of May, 2008.

Maven T. Bagley
MAVEN T. BAGLEY

SUBSCRIBED AND SWORN to before me this 19th day of May, 2008.

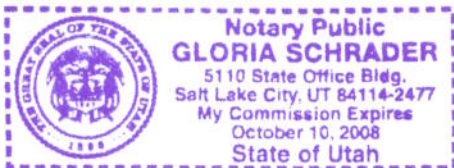

Gloria Schrader
NOTARY PUBLIC

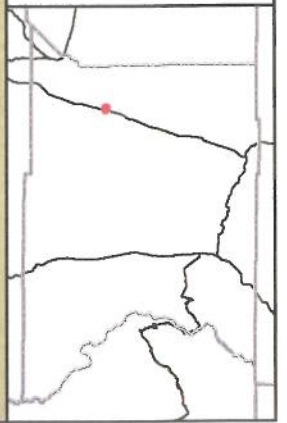

Piute County
HORSE PASTURE ROAD
County Unique - PCRD51

- Land Ownership Categories**
- BLM
 - Private
 - SITLA, State Trust Land
 - USFS, National Forest
 - Wildlife Reserve
- Misc**
- City / Town
 - Municipalities
 - Section = 1 Mile
- Transportation Network**
- HORSE PASTURE ROAD
 - State / U.S. Highway
 - Local Roads



1:9,975
 1 inch equals 0.2 miles



Map prepared by the State of Utah
 Automated Geographic Reference Center
 Room 5130 State Office Building
 Salt Lake City, Utah 84114
 May 07, 2008

AFFIDAVIT OF RICHARD TORGERSON

HORSE PASTURE ROAD

PIUTE COUNTY, UTAH

ROAD NUMBER PCRD51

State of Utah)
 : ss.
County of Piute)

RICHARD TORGERSON, being first duly sworn, deposes and states as follows:

1. I am an adult competent to testify about the matters set forth below based upon my personal knowledge. I currently reside in Piute County, Utah. I have lived in Piute County for most of the past 70 years.

2. I have traveled and am familiar with a road in Piute County known as Horse Pasture Road. I am also familiar with the land the road traverses. When I first used and observed the road in the early 1960s, it followed the same route as in 2008 when I last observed it. Attached is a Piute County map showing Horse Pasture Road. To the best of my knowledge and based upon my use of and familiarity with this road and the land it traverses, the location and route of the road are correctly illustrated on the attached map.

3. I am informed that the County also identifies this road according to the road number listed above.

4. I have observed that the road has been open to the public for all to use, to come and go as they pleased, since at least as early as the early 1960s and continuing through 1976 to 2008. Throughout this time period I have observed travel on the road by various means, including trucks, recreational vehicles, and pickup trucks. Throughout this time period, the road has been used daily, weather permitting for more than ten continuous years prior to 1976, and was used daily, weather permitting in 2008.

5. Throughout the time period from the early 1960s to 2008, I have used the road

myself for feeding horses and hunting.

6. Throughout the time period described in the previous paragraph, I observed other vehicles from the general public using the road at various times for the uses described in the previous paragraph, plus the following uses: livestock operations, fishing and travel in and through the area.

7. It is also the reputation in the community that this road has been open to the public for all to use, to come and go as they pleased, since at least as the early 1900s and continuing through 1976 to the present, for the uses described in the previous paragraphs.

8. Prior to 1976, I observed the graded surface of the road.

DATED this 19th day of May, 2008.

RICHARD TORGERSON

SUBSCRIBED AND SWORN to before me this 19th day of May, 2008.

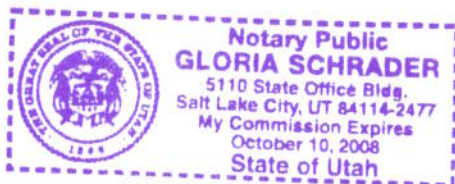

NOTARY PUBLIC

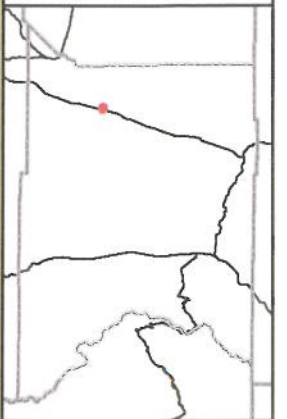

Piute County
HORSE PASTURE ROAD
County Unique - PCRD51

- Land Ownership Categories**
- BLM
 - Private
 - SITLA, State Trust Land
 - USFS, National Forest
 - Wildlife Reserve

- Misc**
- City / Town
 - Municipalities
 - Section = 1 Mile

- Transportation Network**
- HORSE PASTURE ROAD
 - State / U.S. Highway
 - Local Roads



1:9,975
 1 inch equals 0.2 miles



Map prepared by the State of Utah
 AGRC
 Automated Geographic Reference Center
 Room 5130, Office Building
 Salt Lake City, Utah 84114
 May 07, 2009

Appendix A to Attachment 4

Popular Name: HORSE PASTURE ROAD

County: Piute

County Road Number: PCRD51

State Geographic Information Database (SGID) Road Identification Number: RD160051.

Road-Segment Number: 001

Road-Segment Length: 0.21 miles more or less.

Believed owner of the land underlying this road-segment is: Bureau of Land Management.

The following description is based upon the geographic coordinate system using the NAD83 Datum. The source is GPS mapping grade data as indicated in the metadata and/or the transportation data model of the State of Utah Geographic Information Database (SGID).

The road-segment itself is the monument that is identified by its physical presence on the land. The location of said physical presence is closely approximated by mapping grade Global Positioning System (GPS) data. Said data are checked against the corresponding gray-scale 1-meter Digital Orthophoto Quadrangles published by the United States Geological Survey (USGS) to verify a reasonable degree of accuracy. In circumstances where accurate satellite signal acquisition is not possible, such as deep, narrow canyons or under a canopy of dense foliage, or where very sharp curves in the road make accuracy questionable, such portions of the road were digitized from the corresponding gray-scale 1-meter Digital Orthophoto Quadrangles published by the United States Geological Survey (USGS).

This road-segment may traverse:

Township 28 South Range 1 West, Section(s) 8, Salt Lake Base & Meridian

The following description closely approximates the location of the centerline of the physical monument (HORSE PASTURE ROAD)-- Segment 001 based on mapping grade Global Positioning System (GPS) data as defined above:

Beginning at a point on the road center line located at 38 degrees 23 minutes 03.04 seconds North Latitude and -111 degrees 56 minutes 5 seconds West Longitude, which can be converted to mapping accuracy State Plane Utah South Zone NAD 83 feet coordinates of X = 1,515,801.8 feet and Y = 10,468,188.4 feet; thence the following courses along the said road center line:

| | |
|--|------------|
| thence South 69 Degrees 34 Minutes 04 Seconds East | 23.2 feet |
| thence South 68 Degrees 47 Minutes 06 Seconds East | 76.9 feet |
| thence South 69 Degrees 27 Minutes 34 Seconds East | 140.1 feet |
| thence South 76 Degrees 38 Minutes 47 Seconds East | 136.1 feet |
| thence South 76 Degrees 00 Minutes 49 Seconds East | 86.4 feet |
| thence South 75 Degrees 49 Minutes 12 Seconds East | 99.7 feet |
| thence South 68 Degrees 33 Minutes 00 Seconds East | 92.9 feet |
| thence South 84 Degrees 39 Minutes 56 Seconds East | 90 feet |
| thence South 82 Degrees 04 Minutes 14 Seconds East | 93.8 feet |
| thence South 81 Degrees 08 Minutes 45 Seconds East | 105 feet |
| thence North 87 Degrees 46 Minutes 36 Seconds East | 108.4 feet |

thence North 74 Degrees 12 Minutes 26 Seconds East 66.4 feet more or less to **the ending point at:** 38 degrees 23 minutes 1 seconds North Latitude and -111 degrees 55 minutes 51.39 seconds West Longitude, which can be converted to mapping accuracy State Plane Utah South Zone NAD 83 feet coordinates of X = 1,516,884.4 feet and Y = 10,467,977.4 feet.