

**Acknowledgment and
Notice of Acknowledgment
of Acceptance of R.S. 2477
Right-of-Way Grant**

Recorded JUN 10 2008 Filing No. 74760
At 3:46 ~~AM~~/PM in Book P10 Page 1243
Fee No fee Debra L. Ames Rich County Recorder
Requested by Governor State of Utah

THE STATE OF UTAH

TO ALL WHOM THESE PRESENTS SHALL COME, Greeting:

Know ye, This is an Acknowledgment and Notice of Acknowledgment made under Utah Code Sections 72-5-309 through 310 inclusive, that the grant of the United States of America of “the right of way for the construction of highways over public lands, not reserved for public uses” under United States Revised Statutes 2477 (43 U.S.C. Section 932 (repealed October 21, 1976, with proviso recognizing the validity of rights-of-way already established)) was accepted for and on behalf of the State of Utah and its political subdivision Rich County as it pertains to the highway located in Rich County known as RIVER LANE ROAD; County Road Number: BR44; State Geographic Information Database (SGID) Road Identification Number: RD170276. Total road length is 3.44 miles more or less.

The reason for this Acknowledgment and Notice of Acknowledgment includes, but is not limited to, the fact that the road was constructed, mechanically, or by continuous use as a public highway for a period of at least ten years, over public lands not reserved for public uses, prior to the earlier of (a) the October 21, 1976 repeal of R.S. 2477 or (b) the date the servient estate was reserved for public uses.

This Acknowledgment and Notice of Acknowledgment applies only to the segments of the road that traverse land owned by the Bureau of Land Management, United States Department of the Interior, and does not apply to segments of the road that traverse land owned by any other person or entity. The State of Utah and its political subdivisions reserve the right to make further acknowledgments and notices of acknowledgment with regard to road segments that traverse land owned by other entities, including the United States of America, through one or more of its agencies.

A printed copy of a map showing the location of the road in said county is appended hereto as “Attachment 1,” a printed copy of representative photos of the road is appended hereto as “Attachment 2,” a printed copy of a description of the beginning and ending points of the entire road together with a list of Townships, Ranges and Sections that may be traversed by the road in said county is appended hereto as “Attachment 3,” and a printed copy of the Road Centerline Description Cover Page(s) is appended hereto as “Attachment 4.” The Appendices listed in “Attachment 4” that contain the actual road centerline descriptions are incorporated herein by reference. Affidavits provided by individuals familiar with the road are appended hereto as “Attachment 5.”

A printed copy of this Acknowledgment and Notice of Acknowledgment, together with its Attachments and Appendices, may be viewed and/or obtained at the office of the Utah State Archives.

An electronic copy of this Acknowledgment and Notice of Acknowledgment, together with its Attachments and Appendices, may be viewed and/or downloaded as read-only PDF (Portable Document Format) files via the

Internet at <http://recorded2477roads.utah.gov>.

The owner of the servient estate in the land underlying the road-segments subject to this Acknowledgment and Notice is believed to be the United States of America through one or more of its agencies. Any of such agencies or any other person with a servient ownership claim or a competing dominant estate right-of-way ownership claim, may file a petition in the State District Court for Salt Lake County for a decision regarding the correctness of this Acknowledgment. A claimant shall file a petition within sixty (60) days after receipt of this Notice.

In Witness Whereof, I, John Harja, the official designee of the Governor of the State of Utah, in conformity to the laws of the State (Utah Code Sections 72-5-308 through 310 inclusive), have caused this Acknowledgment and Notice of Acknowledgment to be made.

Signed by my hand in Salt Lake City, Utah, the 5th day of June, 2008.

By the Governor's Designee

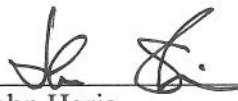

John Harja

CERTIFICATION

State of Utah)
 : ss
County of Salt Lake)

I hereby certify that the signer of the foregoing document, John Harja, is personally known by me, has made a voluntary signature and taken an oath stating that he is the official designee of the Governor of the State of Utah and is authorized to sign this document on the Governor's behalf pursuant to Utah Code Section 72-5-309. He further vouched that, based upon information and belief, the facts alleged therein are true.

Dated this 5th day of June, 2008.

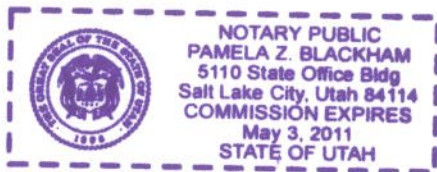



Notary Public

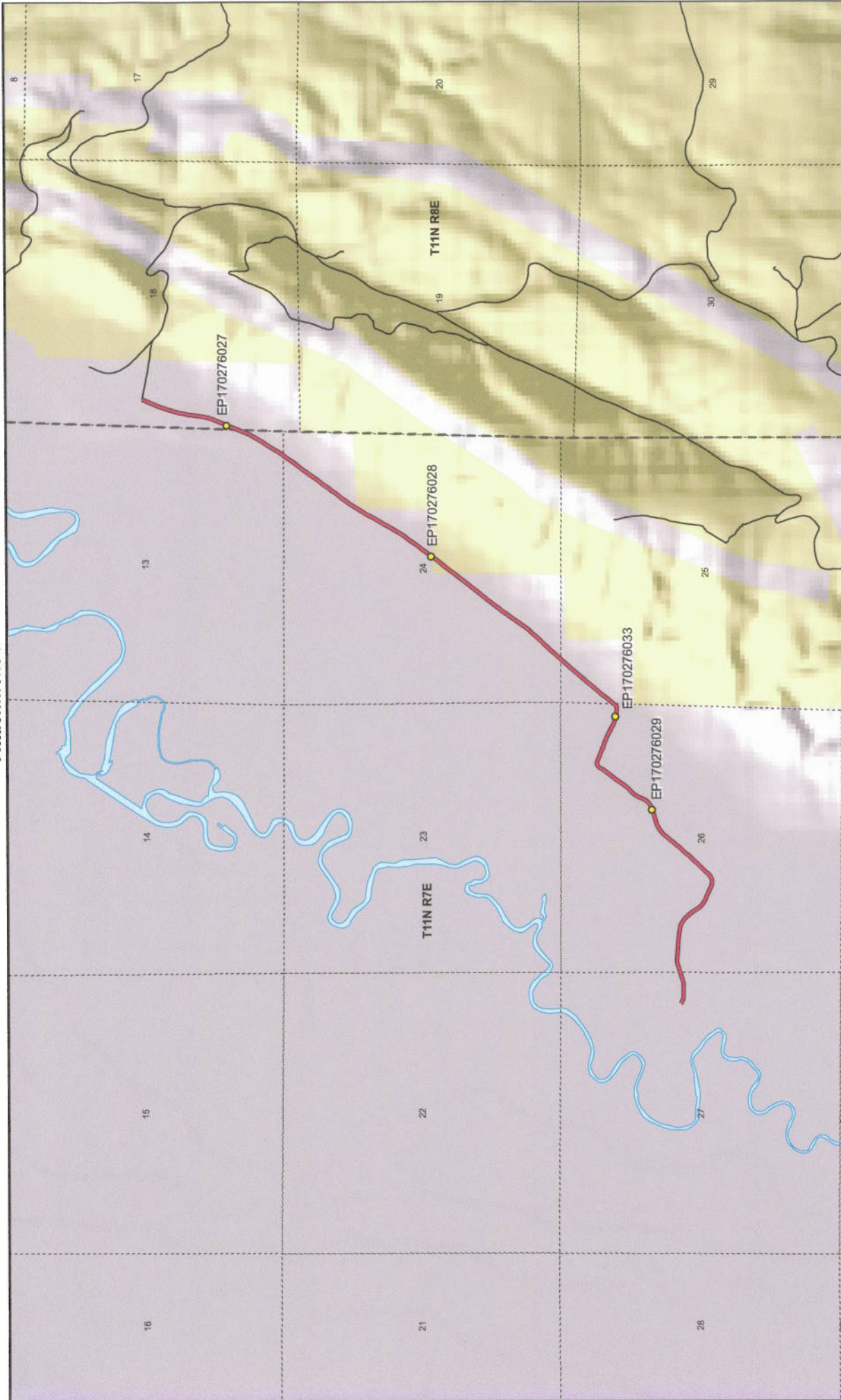

RIVER LANE ROAD - Rich County
SGID RD_ID RD170276

Map prepared by the State of Utah
Automated Geographic Reference Center
Room 5130 State Office Building
Salt Lake City, Utah 84114
Nov 27, 2006



Land Ownership Categories

- BLM
- Private
- SITLA, State Trust Land
- USFS, National Forest
- State Parks and Recreation
- Tribal, Indian Reservation
- NPS, National Park

Transportation Network

- RIVER LANE ROAD
- Other Roads
- Title V, Issued Or Under Consideration By BLM
- Photo Event Point
- Section = 1 Mile





Page 1 of 1

Attachment 1



EP170276027



EP170276028



EP170276029



EP170276033

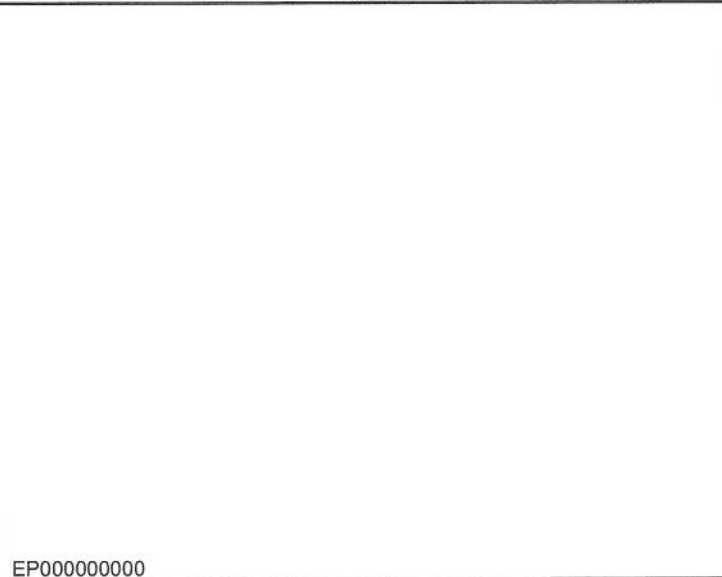

EP000000000

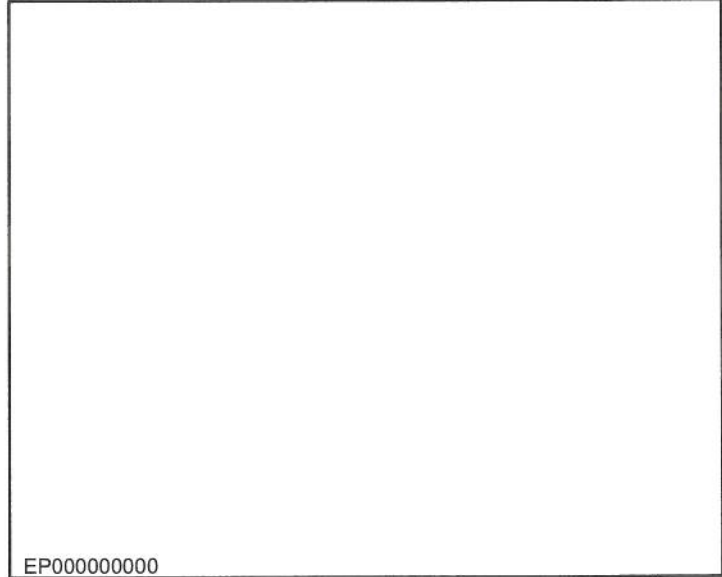

EP000000000

River Lane - Rich County
SGID RD_ID RD170276

Map prepared by the State of Utah
Automated Geographic Reference Center
Room 5130 State Office Building
Salt Lake City, Utah 84114
November 10, 2006



Attachment 3

Beginning & Ending Points and Township, Range, and Section References For:

Popular Name: RIVER LANE ROAD

County: Rich

County Road Number: BR44

State Geographic Information Database (SGID) Road Identification Number: RD170276.

Total Road Length: 3.44 miles more or less.

Beginning at a point on the road centerline located at 41 degrees 40 minutes 00.68 seconds North Latitude and -111 degrees 07 minutes 53.68 seconds West Longitude, which can be converted to mapping accuracy State Plane Utah North Zone NAD 83 feet coordinates of X = 1,741,079.7 feet and Y = 3,766,909.6 feet based on the US Survey Foot conversion.

Ending at a point on the road centerline located at 41 degrees 41 minutes 43.69 seconds North Latitude and -111 degrees 05 minutes 19.39 seconds West Longitude, which can be converted to mapping accuracy State Plane Utah North Zone NAD 83 feet coordinates of X = 1,752,740.2 feet and Y = 3,777,387.7 feet based on the US Survey Foot conversion.

This road may traverse:

Township 11 North Range 7 East, Section(s) 13,24,25,26,27, Salt Lake Base & Meridian

Township 11 North Range 8 East, Section(s) 18, Salt Lake Base & Meridian

See Attachment 1 above for a cartographic depiction of the course of this road.

Attachment 4
Road Centerline Description Cover Page(s)

Popular Name: RIVER LANE ROAD

County: Rich

County Road Number: BR44

State Geographic Information Database (SGID) Road Identification Number: RD170276.

Total Road Length: 3.44 miles more or less.

Centerline Descriptions Of Road-Segments That Cross Over Federally Owned Land, Derived From Global Positioning System Data And Cross-checked against USGS Digital Orthophoto Quadrangles Compiled By The Utah Automated Geographic Reference Center And Entered Into The State Geographic Information Database (SGID).

Road-Segments Listed by SGID Road Identification Number (RD ID)	Road-Segment Numbers	Believed Ownership Of Servient Estate	Approximate Segment Length	See Attached Appendix
RD170276	001	PVT	2.11 Miles	(not shown)
RD170276	002	BLM	0.1 Miles	A
RD170276	003	PVT	0.33 Miles	(not shown)
RD170276	004	BLM	0 Miles	B
RD170276	005	PVT	0.89 Miles	(not shown)
		Total Road Length	3.44	—————

* Indicates that a Title V permit will be requested, is in process, or has been issued.

† Indicates that road-segments crossing Forest Service land are under consideration by the state and county as of the date of this Acknowledgment and Notice of Acknowledgment.

Attachment 5

AFFIDAVIT OF N. SETH WESTON

**RIVER LANE ROAD
RICH COUNTY, UTAH
ROAD NUMBER BR44**

State of Utah)
 : ss.
County of Rich)

N. SETH WESTON, being first duly sworn, deposes and states as follows:

1. I am an adult competent to testify about the matters set forth below based upon my personal knowledge. I currently reside in Rich County, Utah. I have lived in Rich County all of my life for the past 66 years.

2. I have traveled and am familiar with a road in Rich County known as River Lane Road. I am also familiar with the land the road traverses. When I first used and observed the road in the late 1950s, it followed the same route as in 2008 when I last observed it. Attached is a Rich County map showing River Lane Road. To the best of my knowledge and based upon my use of and familiarity with this road and the land it traverses, the location and route of the road are correctly illustrated on the attached map.

3. I am informed that the County also identifies this road according to the road number listed above.

4. I have observed that the road has been open to the public for all to use, to come and go as they pleased, since at least as early as the late 1950s and continuing through 1976 to 2008. Throughout this time period I have observed travel on the road by means of cars, trucks, pickup trucks, cattle and hay trucks and ATVs. Throughout this time period, the road has been used daily weather permitting for more than ten continuous years prior to 1976, and is presently used daily, weather permitting.

5. Throughout the time period from the late 1950s to 2008, I have used the road myself for farming, livestock operations, traveling in and through the area and hunting

6. Throughout the time period described in the previous paragraph, I have observed other vehicles from the general public using the road at various times for the uses described in the previous paragraph, plus access to private property and residences, mining, oil and gas exploration, recreation.

7. It is also the reputation in the community that this road has been open to the public for all to use, to come and go as they pleased, since at least as early as the early 1900s and continuing through 1976 to the present, for the uses described in the previous paragraphs.

8. Prior to 1976, I observed graders and maintenance equipment performing maintenance and construction activities on the road.

DATED this 10 day of March, 2008.

N. Seth Weston
N. SETH WESTON

SUBSCRIBED AND SWORN to before me this 10th day of March, 2008.

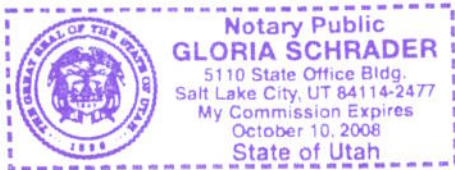

Gloria Schrader
NOTARY PUBLIC

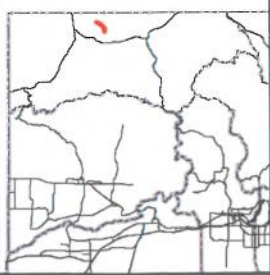
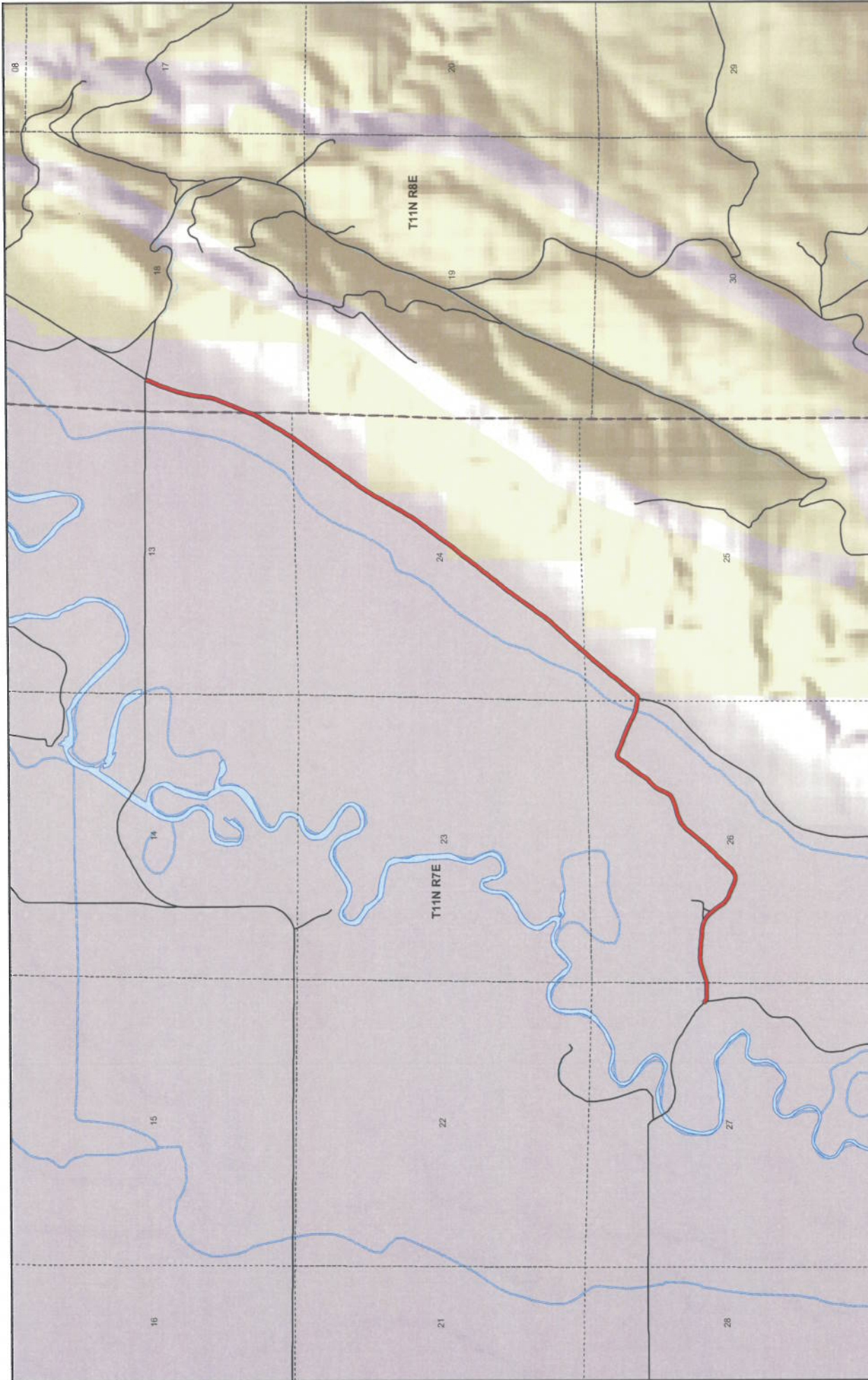

Rich County
RIVER LANE ROAD
County Unique - BR44

- | | | |
|----------------------------------|------------------|-------------------------------|
| Land Ownership Categories | Misc | Transportation Network |
| BLM | Wildlife Reserve | RIVER LANE ROAD |
| Private | State Park | State / U.S. Highway |
| SITLA, State Trust Land | City / Town | Local Roads |
| USFS, National Forest | Municipalities | |
| | Section = 1 Mile | |



1:25,523
 1 inch equals 0.5 miles



Map prepared by the State of Utah
 Automated Geographic Reference Center
 AGRC
 Room 5136 State Office Building
 Salt Lake City, Utah 84111
 Mar 03, 2008

AFFIDAVIT OF DAVID DEE JONES

**RIVER LANE ROAD
RICH COUNTY, UTAH
ROAD NUMBER BR44**

State of Utah)
 : ss.
County of Rich)

DAVID DEE JONES, being first duly sworn, deposes and states as follows:

1. I am an adult competent to testify about the matters set forth below based upon my personal knowledge. I currently reside in Rich County, Utah. I have lived in Rich County for 65 years. I was employed with the Rich County Road Department from 1988 until 2007.

2. I have traveled and am familiar with a road in Rich County known as River Lane Road. I am also familiar with the land the road traverses. When I first used and observed the road in the late 1950s, it followed the same route as in 2008 when I last observed it. Attached is a Rich County map showing River Lane Road. To the best of my knowledge and based upon my use of and familiarity with this road and the land it traverses, the location and route of the road are correctly illustrated on the attached map.

3. I am informed that the County also identifies this road according to the road number listed above.

4. I have observed that the road has been open to the public for all to use, to come and go as they pleased, since at least as early as the late 1950s and continuing through 1976 to 2008. Throughout this time period, the road has been used daily for more than ten continuous years prior to 1976, and is presently used daily.

5. Throughout the time period from the late 1950s to 2008, I have used the road myself for hunting, recreation, livestock operations and travel in and through the area..

6. Throughout the time period described in the previous paragraph, I have observed other vehicles from the general public using the road at various times for the uses described in the previous paragraph, plus farming, trapping, travel to and from schools and residential access.

7. It is also the reputation in the community that this road has been open to the public for all to use, to come and go as they pleased, since at least as early as the mid 1930s and continuing through 1976 to the present, for the uses described in the previous paragraphs.

8. Prior to 1976, I observed the graded surface of the road.

DATED this 10 day of March, 2008.

DAVID DEE JONES

SUBSCRIBED AND SWORN to before me this 10th day of March, 2008.

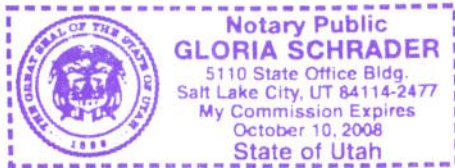

NOTARY PUBLIC

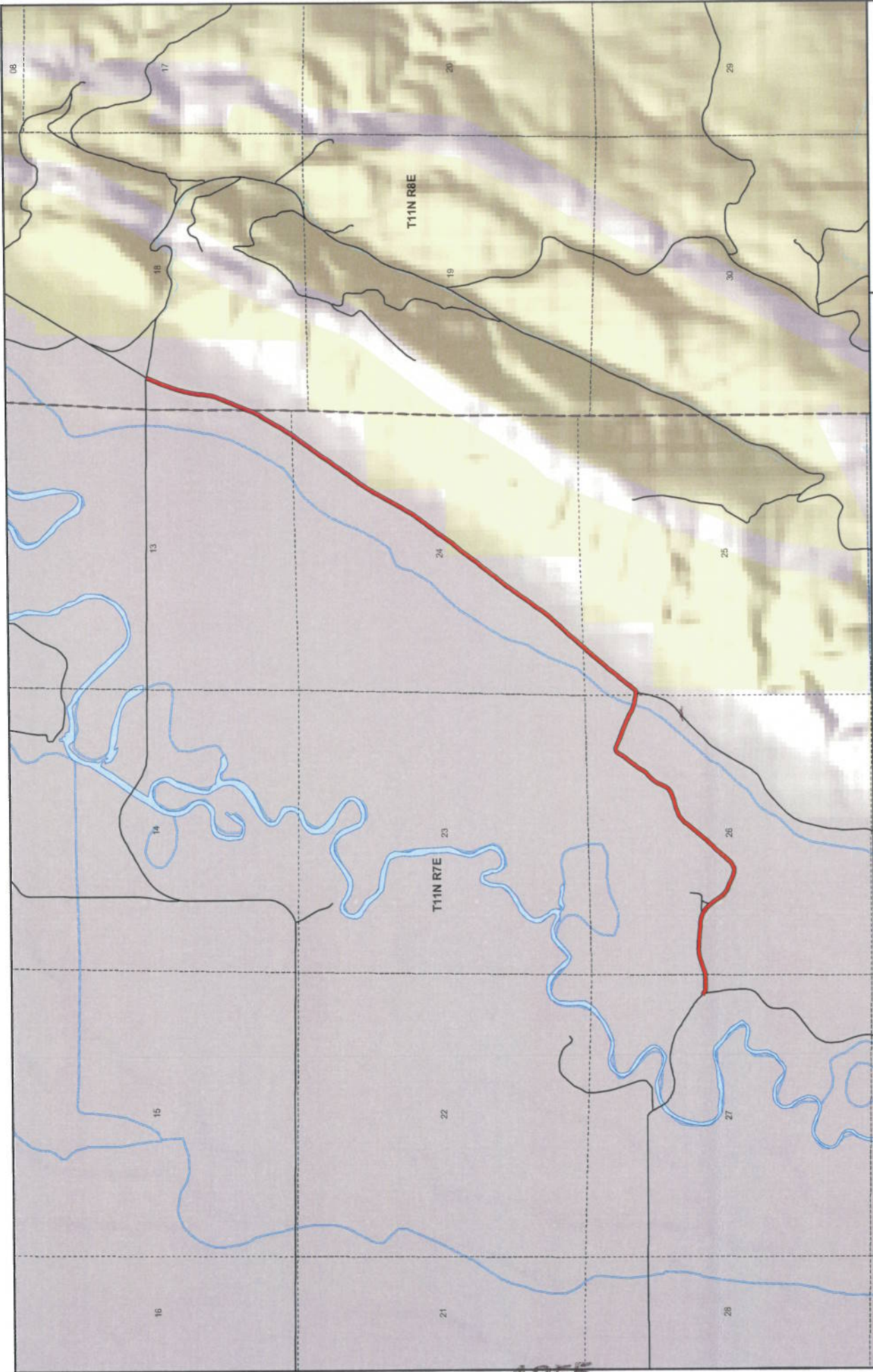



1:29,523
1 Inch equals 0.5 miles

Map prepared by the State of Utah
Automated Geographic Reference Center
Room 538 State Office Building
Salt Lake City, Utah 84114
Mar 05, 2008

Rich County RIVER LANE ROAD County Unique - BR44

<p>Land Ownership Categories</p> <ul style="list-style-type: none"> BLM Private SITLA, State Trust Land USFS, National Forest 	<p>Misc</p> <ul style="list-style-type: none"> Wildlife Reserve State Park City / Town Municipalities Section = 1 Mile 	<p>Transportation Network</p> <ul style="list-style-type: none"> RIVER LANE ROAD State / U.S. Highway Local Roads
--	--	---

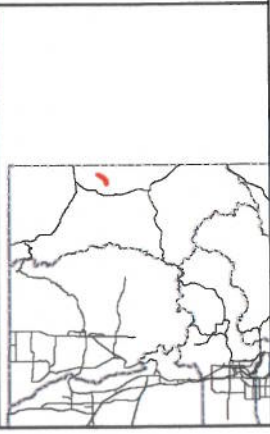

Appendix A to Attachment 4

Popular Name: RIVER LANE ROAD

County: Rich

County Road Number: BR44

State Geographic Information Database (SGID) Road Identification Number: RD170276.

Road-Segment Number: 002

Road-Segment Length: 0.1 miles more or less.

Believed owner of the land underlying this road-segment is: Bureau of Land Management.

The following description is based upon the geographic coordinate system using the NAD83 Datum. The source is GPS mapping grade data as indicated in the metadata and/or the transportation data model of the State of Utah Geographic Information Database (SGID).

The road-segment itself is the monument that is identified by its physical presence on the land. The location of said physical presence is closely approximated by mapping grade Global Positioning System (GPS) data. Said data are checked against the corresponding gray-scale 1-meter Digital Orthophoto Quadrangles published by the United States Geological Survey (USGS) to verify a reasonable degree of accuracy. In circumstances where accurate satellite signal acquisition is not possible, such as deep, narrow canyons or under a canopy of dense foliage, or where very sharp curves in the road make accuracy questionable, such portions of the road were digitized from the corresponding gray-scale 1-meter Digital Orthophoto Quadrangles published by the United States Geological Survey (USGS).

This road-segment may traverse:

Township 11 North Range 7 East, Section(s) 24, Salt Lake Base & Meridian

The following description closely approximates the location of the centerline of the physical monument (RIVER LANE ROAD)-- Segment 002 based on mapping grade Global Positioning System (GPS) data as defined above:

Beginning at a point on the road center line located at 41 degrees 40 minutes 44.14 seconds North Latitude and -111 degrees 06 minutes 03.99 seconds West Longitude, which can be converted to mapping accuracy State Plane Utah North Zone NAD 83 feet coordinates of X = 1,749,384.8 feet and Y = 3,771,344.7 feet; thence the following courses along the said road center line:

thence North 37 Degrees 10 Minutes 33 Seconds East 49.6 feet

thence North 37 Degrees 07 Minutes 49 Seconds East 95.5 feet

thence North 37 Degrees 59 Minutes 58 Seconds East 97.9 feet

thence North 37 Degrees 40 Minutes 40 Seconds East 99.1 feet

thence North 37 Degrees 12 Minutes 09 Seconds East 96.4 feet

thence North 36 Degrees 46 Minutes 53 Seconds East 77.8 feet

thence North 36 Degrees 12 Minutes 30 Seconds East 5.7 feet more or less to **the ending point**

at: 41 degrees 40 minutes 48.22 seconds North Latitude and -111 degrees 05 minutes 59.79 seconds West Longitude, which can be converted to mapping accuracy State Plane Utah North Zone NAD 83 feet coordinates of X = 1,749,701.6 feet and Y = 3,771,759.7 feet.

Appendix B to Attachment 4

Popular Name: RIVER LANE ROAD

County: Rich

County Road Number: BR44

State Geographic Information Database (SGID) Road Identification Number: RD170276.

Road-Segment Number: 004

Road-Segment Length: 0 miles more or less.

Believed owner of the land underlying this road-segment is: Bureau of Land Management.

The following description is based upon the geographic coordinate system using the NAD83 Datum. The source is GPS mapping grade data as indicated in the metadata and/or the transportation data model of the State of Utah Geographic Information Database (SGID).

The road-segment itself is the monument that is identified by its physical presence on the land. The location of said physical presence is closely approximated by mapping grade Global Positioning System (GPS) data. Said data are checked against the corresponding gray-scale 1-meter Digital Orthophoto Quadrangles published by the United States Geological Survey (USGS) to verify a reasonable degree of accuracy. In circumstances where accurate satellite signal acquisition is not possible, such as deep, narrow canyons or under a canopy of dense foliage, or where very sharp curves in the road make accuracy questionable, such portions of the road were digitized from the corresponding gray-scale 1-meter Digital Orthophoto Quadrangles published by the United States Geological Survey (USGS).

This road-segment may traverse:

Township 11 North Range 7 East, Section(s) 24, Salt Lake Base & Meridian

The following description closely approximates the location of the centerline of the physical monument (RIVER LANE ROAD)-- Segment 004 based on mapping grade Global Positioning System (GPS) data as defined above:

Beginning at a point on the road center line located at 41 degrees 41 minutes 02.56 seconds North Latitude and -111 degrees 05 minutes 47.38 seconds West Longitude, which can be converted to mapping accuracy State Plane Utah North Zone NAD 83 feet coordinates of X = 1,750,636.2 feet and Y = 3,773,214.8 feet; thence the following courses along the said road center line:

thence North 32 Degrees 03 Minutes 19 Seconds East 15.2 feet more or less to **the ending point at:** 41 degrees 41 minutes 02.68 seconds North Latitude and -111 degrees 05 minutes 47.27 seconds West Longitude, which can be converted to mapping accuracy State Plane Utah North Zone NAD 83 feet coordinates of X = 1,750,644.2 feet and Y = 3,773,227.7 feet.