

**Acknowledgment and  
Notice of Acknowledgment  
of Acceptance of R.S. 2477  
Right-of-Way Grant**

ENT 21730:2008 PG 1 of 6  
RANDALL A. COVINGTON  
UTAH COUNTY RECORDER  
2008 Feb 26 9:03 am FEE 0.00 BY CS  
RECORDED FOR GOVERNOR STATE OF UTAH

**THE STATE OF UTAH**

**TO ALL WHOM THESE PRESENTS SHALL COME, Greeting:**

**Know ye,** This is an Acknowledgment and Notice of Acknowledgment made under Utah Code Sections 72-5-309 through 310 inclusive, that the grant of the United States of America of “the right of way for the construction of highways over public lands, not reserved for public uses” under United States Revised Statutes 2477 (43 U.S.C. Section 932 (repealed October 21, 1976, with proviso recognizing the validity of rights-of-way already established)) was accepted for and on behalf of the State of Utah and its political subdivision Utah County as it pertains to the highway located in Utah County known as CEDAR FORT DIAGONAL; County Road Number: B831; State Geographic Information Database (SGID) Road Identification Number: RD250002. Total road length is 0.26 miles more or less.

The reason for this Acknowledgment and Notice of Acknowledgment includes, but is not limited to, the fact that the road was constructed, mechanically, or by continuous use as a public highway for a period of at least ten years, over public lands not reserved for public uses, prior to the earlier of (a) the October 21, 1976 repeal of R.S. 2477 or (b) the date the servient estate was reserved for public uses.

This Acknowledgment and Notice of Acknowledgment applies only to the segments of the road that traverse land owned by the Bureau of Land Management, United States Department of the Interior, and does not apply to segments of the road that traverse land owned by any other person or entity. The State of Utah and its political subdivisions reserve the right to make further acknowledgments and notices of acknowledgment with regard to road segments that traverse land owned by other entities, including the United States of America, through one or more of its agencies.

A printed copy of a map showing the location of the road in said county is appended hereto as “Attachment 1,” a printed copy of representative photos of the road is appended hereto as “Attachment 2,” a printed copy of a description of the beginning and ending points of the entire road together with a list of Townships, Ranges and Sections that may be traversed by the road in said county is appended hereto as “Attachment 3,” and a printed copy of the Road Centerline Description Cover Page(s) is appended hereto as “Attachment 4.” The Appendices listed in “Attachment 4” that contain the actual road centerline descriptions are incorporated herein by reference.

A printed copy of this Acknowledgment and Notice of Acknowledgment, together with its Attachments and Appendices, may be viewed and/or obtained at the office of the Utah State Archives.

An electronic copy of this Acknowledgment and Notice of Acknowledgment, together with its Attachments and Appendices, may be viewed and/or downloaded as read-only PDF (Portable Document Format) files via the

Internet at <http://recorded2477roads.utah.gov>.

The owner of the servient estate in the land underlying the road-segments subject to this Acknowledgment and Notice is believed to be the United States of America through one or more of its agencies. Any of such agencies or any other person with a servient ownership claim or a competing dominant estate right-of-way ownership claim, may file a petition in the State District Court for Salt Lake County for a decision regarding the correctness of this Acknowledgment. A claimant shall file a petition within sixty (60) days after receipt of this Notice.

**In Witness Whereof**, I, John Harja, the official designee of the Governor of the State of Utah, in conformity to the laws of the State (Utah Code Sections 72-5-308 through 310 inclusive), have caused this Acknowledgment and Notice of Acknowledgment to be made.

Signed by my hand in Salt Lake City, Utah, the 21<sup>st</sup> day of FEBRUARY, 2008.

By the Governor's Designee

  
\_\_\_\_\_  
John Harja

### CERTIFICATION

State of Utah                    )  
                                          : ss  
County of Salt Lake            )

I hereby certify that the signer of the foregoing document, John Harja, is personally known by me, has made a voluntary signature and taken an oath stating that he is the official designee of the Governor of the State of Utah and is authorized to sign this document on the Governor's behalf pursuant to Utah Code Section 72-5-309. He further vouched that, based upon information and belief, the facts alleged therein are true.

Dated this 21<sup>st</sup> day of February, 2008.

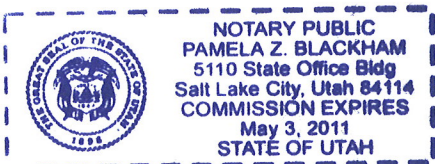

  
\_\_\_\_\_  
Notary Public

ENT 21730-2008 Pg. 3 of 6

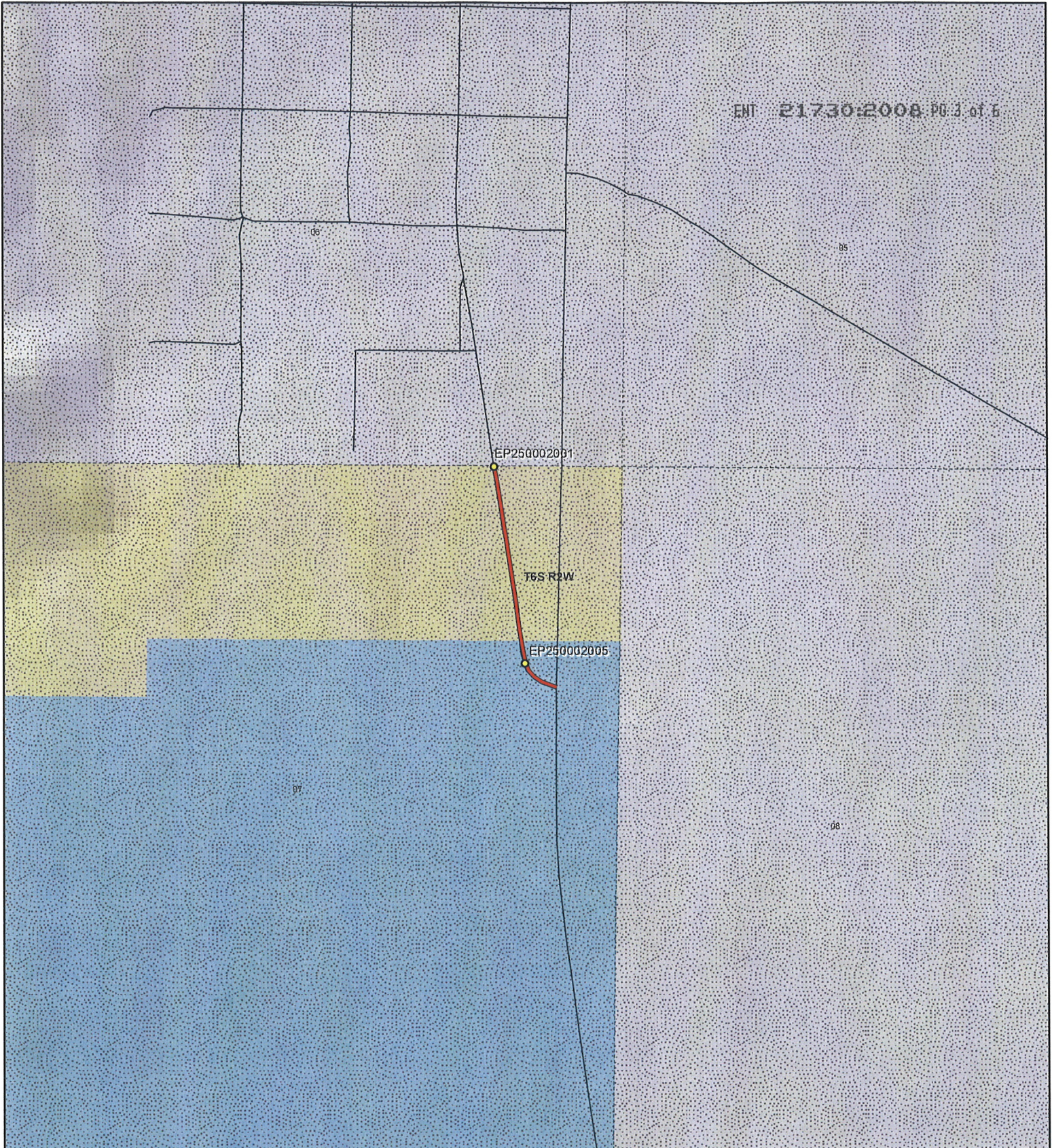

**CEDAR FORT DIAGONAL - Utah County**  
**SGID RD\_ID RD250002**

**Land Ownership Categories**

- |                            |                              |
|----------------------------|------------------------------|
| BLM                        | Wilderness                   |
| Private                    | UDWR Wildlife Reserve        |
| SITLA, State Trust Land    | DOD, Military                |
| USFS, National Forest      | State Sovereign Land         |
| State Parks and Recreation | National Recreation Area     |
| Tribal, Indian Reservation | USFWS, Natl. Wildlife Refuge |
| NPS, National Park         |                              |

**Transportation Network**

- |                                                         |
|---------------------------------------------------------|
| CEDAR FORT DIAGONAL                                     |
| Title V: Issued Or Under Consideration By BLM Or County |
| Other Roads                                             |
| Photo Event Point                                       |
| Section = 1 Mile                                        |



1:8,865  
1 inch equals 0.1 miles



Map prepared by the State of Utah  
 Automated Geographic Reference Center  
 Room 5130 State Office Building  
 Salt Lake City, Utah 84114  
 Feb 14, 2008





EP250002001

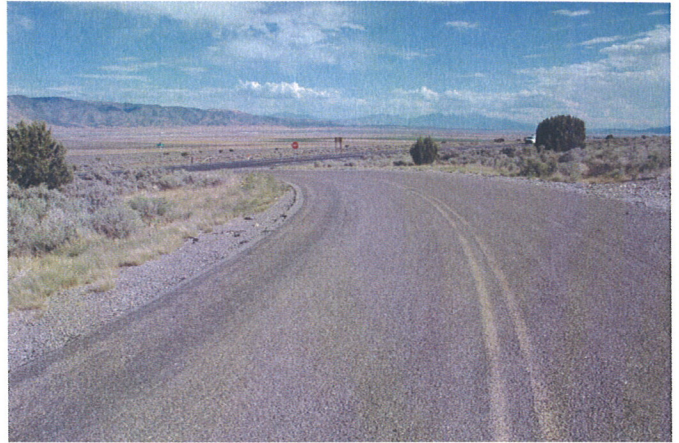

EP250002005

EP000000000

EP000000000

EP000000000

EP000000000

**CEDAR FORT DIAGONAL - Utah County**  
**SGID RD\_ID RD250002**

Map prepared by the State of Utah  
Automated Geographic Reference Center  
Room 5130 State Office Building  
Salt Lake City, Utah 84114  
February 14, 2008



## Attachment 3

ENT 21730:2008 PG 5 of 6

### Beginning & Ending Points and Township, Range, and Section References For:

**Popular Name: CEDAR FORT DIAGONAL**

**County: Utah**

**County Road Number: B831**

**State Geographic Information Database (SGID) Road Identification Number: RD250002.**

**Total Road Length: 0.26 miles more or less.**

**Beginning at a point** on the road centerline located at 40 degrees 19 minutes 00.03 seconds North Latitude and -112 degrees 06 minutes 08.86 seconds West Longitude, which can be converted to mapping accuracy State Plane Utah Central Zone NAD 83 feet coordinates of X = 1,472,423.8 feet and Y = 7,284,643.5 feet based on the US Survey Foot conversion.

**Ending at a point** on the road centerline located at 40 degrees 19 minutes 12.35 seconds North Latitude and -112 degrees 06 minutes 13.57 seconds West Longitude, which can be converted to mapping accuracy State Plane Utah Central Zone NAD 83 feet coordinates of X = 1,472,067.8 feet and Y = 7,285,892.7 feet based on the US Survey Foot conversion.

This road may traverse:

Township 6 South Range 2 West, Section(s) 7, Salt Lake Base & Meridian  
See Attachment 1 above for a cartographic depiction of the course of this road.

**Attachment 4  
Road Centerline Description Cover Page(s)**

**Popular Name: CEDAR FORT DIAGONAL**

**County: Utah**

**County Road Number: B831**

**State Geographic Information Database (SGID) Road Identification Number: RD250002.**

**Total Road Length: 0.26 miles more or less.**

**Centerline Descriptions Of Road-Segments That Cross Over Federally Owned Land, Derived From Global Positioning System Data And Cross-checked against USGS Digital Orthophoto Quadrangles Compiled By The Utah Automated Geographic Reference Center And Entered Into The State Geographic Information Database (SGID).**

<b>Road-Segments Listed by SGID Road Identification Number (RD ID)</b>	<b>Road-Segment Numbers</b>	<b>Believed Ownership Of Servient Estate</b>	<b>Approximate Segment Length</b>	<b>See Attached Appendix</b>
<b>RD250002</b>	<b>001</b>	<b>ST</b>	<b>0.07 Miles</b>	<b>(not shown)</b>
<b>RD250002</b>	<b>002</b>	<b>BLM</b>	<b>0.19 Miles</b>	<b>A</b>
		<b>Total Road Length</b>	<b>0.26</b>	<b>_____</b>

\* Indicates that a Title V permit will be requested, is in process, or has been issued.

† Indicates that road-segments crossing Forest Service land are under consideration by the state and county as of the date of this Acknowledgment and Notice of Acknowledgment.

## Appendix A to Attachment 4

**Popular Name: CEDAR FORT DIAGONAL**

**County: Utah**

**County Road Number: B831**

**State Geographic Information Database (SGID) Road Identification Number: RD250002.**

**Road-Segment Number: 002**

**Road-Segment Length: 0.19 miles more or less.**

**Believed owner of the land underlying this road-segment is: Bureau of Land Management.**

*The following description is based upon the geographic coordinate system using the NAD83 Datum. The source is GPS mapping grade data as indicated in the metadata and/or the transportation data model of the State of Utah Geographic Information Database (SGID).*

The road-segment itself is the monument that is identified by its physical presence on the land. The location of said physical presence is closely approximated by mapping grade Global Positioning System (GPS) data. Said data are checked against the corresponding gray-scale 1-meter Digital Orthophoto Quadrangles published by the United States Geological Survey (USGS) to verify a reasonable degree of accuracy. In circumstances where accurate satellite signal acquisition is not possible, such as deep, narrow canyons or under a canopy of dense foliage, or where very sharp curves in the road make accuracy questionable, such portions of the road were digitized from the corresponding gray-scale 1-meter Digital Orthophoto Quadrangles published by the United States Geological Survey (USGS).

This road-segment may traverse:

Township 6 South Range 2 West, Section(s) 7, Salt Lake Base & Meridian

The following description closely approximates the location of the centerline of the physical monument (CEDAR FORT DIAGONAL)-- Segment 002 based on mapping grade Global Positioning System (GPS) data as defined above:

**Beginning at a point** on the road center line located at 40 degrees 19 minutes 02.59 seconds North Latitude and -112 degrees 06 minutes 11.48 seconds West Longitude, which can be converted to mapping accuracy State Plane Utah Central Zone NAD 83 feet coordinates of X = 1,472,222.8 feet and Y = 7,284,903.9 feet; thence the following courses along the said road center line:

thence North 09 Degrees 26 Minutes 29 Seconds West 62.2 feet  
thence North 08 Degrees 01 Minutes 44 Seconds West 93.1 feet  
thence North 08 Degrees 15 Minutes 24 Seconds West 92.8 feet  
thence North 08 Degrees 22 Minutes 05 Seconds West 89.2 feet  
thence North 09 Degrees 28 Minutes 08 Seconds West 86.8 feet  
thence North 08 Degrees 58 Minutes 12 Seconds West 83 feet  
thence North 08 Degrees 14 Minutes 53 Seconds West 76.2 feet  
thence North 09 Degrees 06 Minutes 45 Seconds West 73.1 feet  
thence North 09 Degrees 06 Minutes 45 Seconds West 73.1 feet  
thence North 09 Degrees 28 Minutes 20 Seconds West 68.1 feet  
thence North 09 Degrees 28 Minutes 52 Seconds West 70.1 feet

thence North 08 Degrees 48 Minutes 42 Seconds West 60.1 feet  
thence North 09 Degrees 24 Minutes 08 Seconds West 47.9 feet  
thence North 09 Degrees 54 Minutes 37 Seconds West 25.6 feet more or less to **the ending**  
**point at:** 40 degrees 19 minutes 12.35 seconds North Latitude and -112 degrees 06 minutes 13.57 seconds  
West Longitude, which can be converted to mapping accuracy State Plane Utah Central Zone NAD 83 feet  
coordinates of X = 1,472,067.8 feet and Y = 7,285,892.7 feet.