

**Acknowledgment and  
Notice of Acknowledgment  
of Acceptance of R.S. 2477  
Right-of-Way Grant**

ENT 21731;2008 PG 1 of 6  
RANDALL A. COVINGTON  
UTAH COUNTY RECORDER  
2008 Feb 26 9:04 am FEE 0.00 BY CS  
RECORDED FOR GOVERNOR STATE OF UTAH

**THE STATE OF UTAH**

**TO ALL WHOM THESE PRESENTS SHALL COME, Greeting:**

**Know ye,** This is an Acknowledgment and Notice of Acknowledgment made under Utah Code Sections 72-5-309 through 310 inclusive, that the grant of the United States of America of “the right of way for the construction of highways over public lands, not reserved for public uses” under United States Revised Statutes 2477 (43 U.S.C. Section 932 (repealed October 21, 1976, with proviso recognizing the validity of rights-of-way already established)) was accepted for and on behalf of the State of Utah and its political subdivision Utah County as it pertains to the highway located in Utah County known as CHIMNEY ROCK PASS ROAD; County Road Number: B835; State Geographic Information Database (SGID) Road Identification Number: RD250003. Total road length is 6.3 miles more or less.

The reason for this Acknowledgment and Notice of Acknowledgment includes, but is not limited to, the fact that the road was constructed, mechanically, or by continuous use as a public highway for a period of at least ten years, over public lands not reserved for public uses, prior to the earlier of (a) the October 21, 1976 repeal of R.S. 2477 or (b) the date the servient estate was reserved for public uses.

This Acknowledgment and Notice of Acknowledgment applies only to the segments of the road that traverse land owned by the Bureau of Land Management, United States Department of the Interior, and does not apply to segments of the road that traverse land owned by any other person or entity. The State of Utah and its political subdivisions reserve the right to make further acknowledgments and notices of acknowledgment with regard to road segments that traverse land owned by other entities, including the United States of America, through one or more of its agencies.

A printed copy of a map showing the location of the road in said county is appended hereto as “Attachment 1,” a printed copy of representative photos of the road is appended hereto as “Attachment 2,” a printed copy of a description of the beginning and ending points of the entire road together with a list of Townships, Ranges and Sections that may be traversed by the road in said county is appended hereto as “Attachment 3,” and a printed copy of the Road Centerline Description Cover Page(s) is appended hereto as “Attachment 4.” The Appendices listed in “Attachment 4” that contain the actual road centerline descriptions are incorporated herein by reference.

A printed copy of this Acknowledgment and Notice of Acknowledgment, together with its Attachments and Appendices, may be viewed and/or obtained at the office of the Utah State Archives.

An electronic copy of this Acknowledgment and Notice of Acknowledgment, together with its Attachments and Appendices, may be viewed and/or downloaded as read-only PDF (Portable Document Format) files via the

Internet at <http://recorded2477roads.utah.gov>.

The owner of the servient estate in the land underlying the road-segments subject to this Acknowledgment and Notice is believed to be the United States of America through one or more of its agencies. Any of such agencies or any other person with a servient ownership claim or a competing dominant estate right-of-way ownership claim, may file a petition in the State District Court for Salt Lake County for a decision regarding the correctness of this Acknowledgment. A claimant shall file a petition within sixty (60) days after receipt of this Notice.

**In Witness Whereof**, I, John Harja, the official designee of the Governor of the State of Utah, in conformity to the laws of the State (Utah Code Sections 72-5-308 through 310 inclusive), have caused this Acknowledgment and Notice of Acknowledgment to be made.

Signed by my hand in Salt Lake City, Utah, the 21<sup>st</sup> day of FEBRUARY, 2008.

By the Governor's Designee

  
\_\_\_\_\_  
John Harja

**CERTIFICATION**

State of Utah                    )  
  : ss  
County of Salt Lake         )

I hereby certify that the signer of the foregoing document, John Harja, is personally known by me, has made a voluntary signature and taken an oath stating that he is the official designee of the Governor of the State of Utah and is authorized to sign this document on the Governor's behalf pursuant to Utah Code Section 72-5-309. He further vouched that, based upon information and belief, the facts alleged therein are true.

Dated this 21<sup>st</sup> day of February, 2008.



  
\_\_\_\_\_  
Notary Public



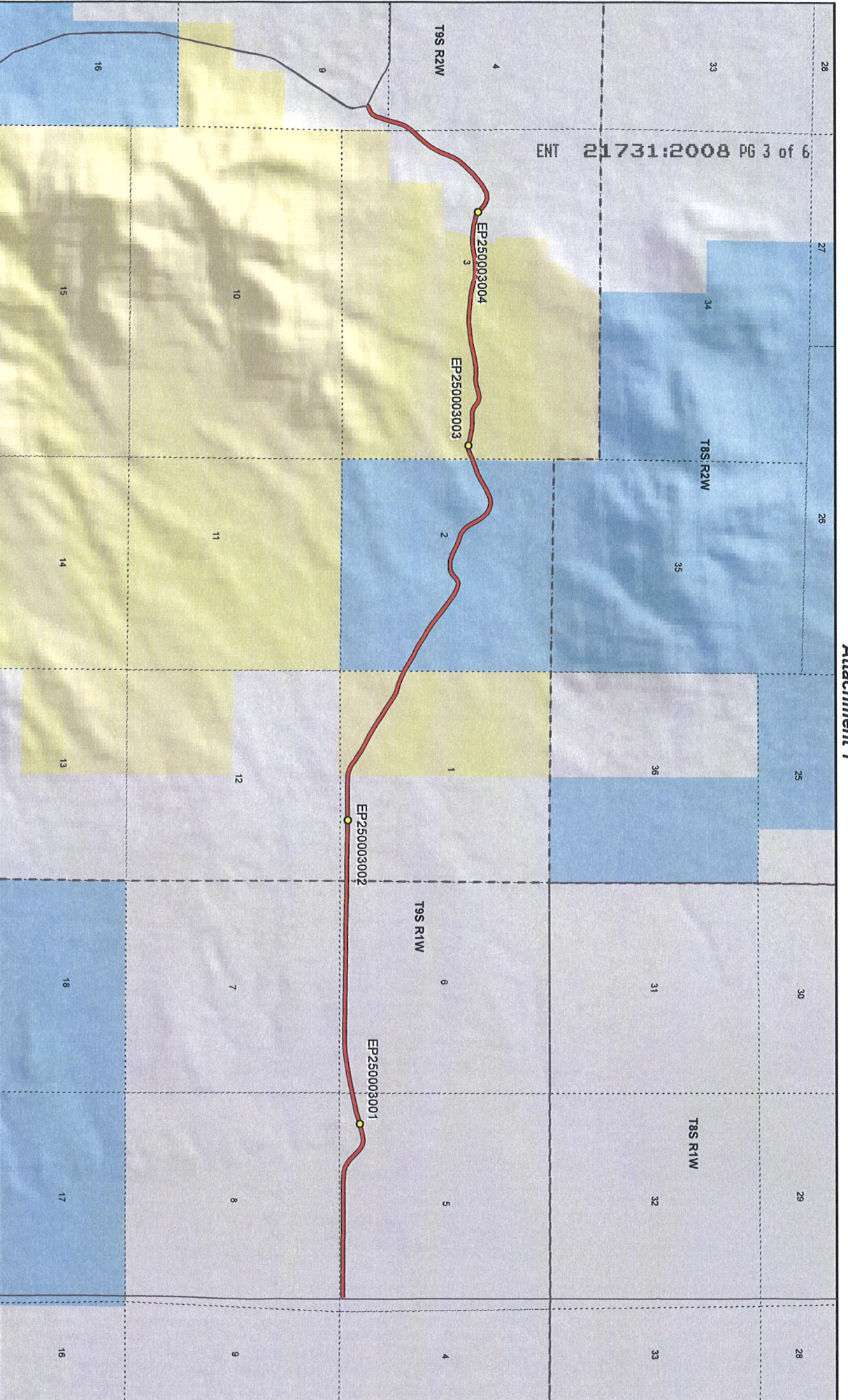

ENT 21731:2008 PG 3 of 6

**CHIMNEY ROCK PASS ROAD - Utah County**  
**SGID RD\_ID RD250003**

**Land Ownership Categories**

- BLM
- Private
- SITLA, State Trust Land
- USFS, National Forest
- State Parks and Recreation
- Tribal, Indian Reservation
- NPS, National Park
- Wilderness
- UDWR Wildlife Reserve
- DOD, Military
- State Sovereign Land
- National Recreation Area
- USFWS, Natl. Wildlife Refuge

**Transportation Network**

- CHIMNEY ROCK PASS ROAD
- Other Roads
- Title V, Issued Or Under Consideration By BLM Or County
- Photo Event Point

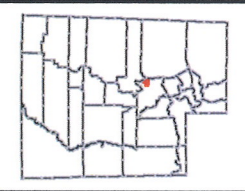

Map prepared by the State of Utah  
 Automated Geographic Reference Center  
 Room 5130 State Office Building  
 Salt Lake City, Utah 84114  
 Nov 03, 2006







EP250003001



EP250003002



EP250003003

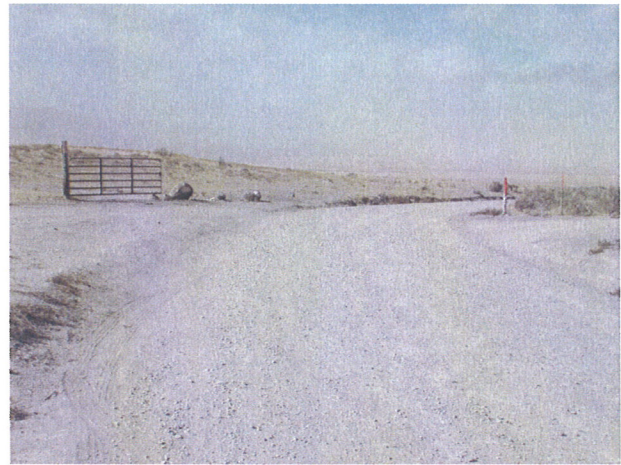

EP250003004

EP000000000

EP000000000

*Chimney Rock Pass Road - Utah County*  
**SGID RD\_ID RD250003**

Map prepared by the State of Utah  
Automated Geographic Reference Center  
Room 5130 State Office Building  
Salt Lake City, Utah 84114  
October 30, 2006



**Beginning & Ending Points and Township, Range, and Section References For:**

**Popular Name: CHIMNEY ROCK PASS ROAD**

**County: Utah**

**County Road Number: B835**

**State Geographic Information Database (SGID) Road Identification Number: RD250003.**

**Total Road Length: 6.3 miles more or less.**

**Beginning at a point** on the road centerline located at 40 degrees 03 minutes 20.16 seconds North Latitude and -112 degrees 03 minutes 54.34 seconds West Longitude, which can be converted to mapping accuracy State Plane Utah Central Zone NAD 83 feet coordinates of X = 1,482,242.7 feet and Y = 7,189,476.1 feet based on the US Survey Foot conversion.

**Ending at a point** on the road centerline located at 40 degrees 03 minutes 16.75 seconds North Latitude and -111 degrees 57 minutes 30.17 seconds West Longitude, which can be converted to mapping accuracy State Plane Utah Central Zone NAD 83 feet coordinates of X = 1,512,110.7 feet and Y = 7,188,959.4 feet based on the US Survey Foot conversion.

This road may traverse:

Township 9 South Range 1 West, Section(s) 5,6, Salt Lake Base & Meridian

Township 9 South Range 2 West, Section(s) 1,2,3,4,9, Salt Lake Base & Meridian

See Attachment 1 above for a cartographic depiction of the course of this road.

**Attachment 4**  
**Road Centerline Description Cover Page(s)**

ENT 21731:2008 PG 6 of 6

**Popular Name: CHIMNEY ROCK PASS ROAD**

**County: Utah**

**County Road Number: B835**

**State Geographic Information Database (SGID) Road Identification Number: RD250003.**

**Total Road Length: 6.3 miles more or less.**

**Centerline Descriptions Of Road-Segments That Cross Over Federally Owned Land, Derived From Global Positioning System Data And Cross-checked against USGS Digital Orthophoto Quadrangles Compiled By The Utah Automated Geographic Reference Center And Entered Into The State Geographic Information Database (SGID).**

<b>Road-Segments Listed by SGID Road Identification Number (RD_ID)</b>	<b>Road-Segment Numbers</b>	<b>Believed Ownership Of Servient Estate</b>	<b>Approximate Segment Length</b>	<b>See Attached Appendix</b>
<b>RD250003</b>	<b>001</b>	<b>PVT</b>	<b>0.95 Miles</b>	<b>(not shown)</b>
<b>RD250003</b>	<b>002</b>	<b>BLM</b>	<b>1.08 Miles</b>	<b>A</b>
<b>RD250003</b>	<b>003</b>	<b>ST</b>	<b>1.18 Miles</b>	<b>(not shown)</b>
<b>RD250003</b>	<b>004</b>	<b>BLM</b>	<b>0.57 Miles</b>	<b>B</b>
<b>RD250003</b>	<b>005</b>	<b>PVT</b>	<b>2.52 Miles</b>	<b>(not shown)</b>
		<b>Total Road Length</b>	<b>6.3</b>	<b>_____</b>

\* Indicates that a Title V permit will be requested, is in process, or has been issued.

† Indicates that road-segments crossing Forest Service land are under consideration by the state and county as of the date of this Acknowledgment and Notice of Acknowledgment.

## Appendix A to Attachment 4

**Popular Name: CHIMNEY ROCK PASS ROAD**

**County: Utah**

**County Road Number: B835**

**State Geographic Information Database (SGID) Road Identification Number: RD250003.**

**Road-Segment Number: 002**

**Road-Segment Length: 1.08 miles more or less.**

**Believed owner of the land underlying this road-segment is: Bureau of Land Management.**

*The following description is based upon the geographic coordinate system using the NAD83 Datum. The source is GPS mapping grade data as indicated in the metadata and/or the transportation data model of the State of Utah Geographic Information Database (SGID).*

The road-segment itself is the monument that is identified by its physical presence on the land. The location of said physical presence is closely approximated by mapping grade Global Positioning System (GPS) data. Said data are checked against the corresponding gray-scale 1-meter Digital Orthophoto Quadrangles published by the United States Geological Survey (USGS) to verify a reasonable degree of accuracy. In circumstances where accurate satellite signal acquisition is not possible, such as deep, narrow canyons or under a canopy of dense foliage, or where very sharp curves in the road make accuracy questionable, such portions of the road were digitized from the corresponding gray-scale 1-meter Digital Orthophoto Quadrangles published by the United States Geological Survey (USGS).

This road-segment may traverse:

Township 9 South Range 2 West, Section(s) 3, Salt Lake Base & Meridian

The following description closely approximates the location of the centerline of the physical monument (CHIMNEY ROCK PASS ROAD)-- Segment 002 based on mapping grade Global Positioning System (GPS) data as defined above:

**Beginning at a point** on the road center line located at 40 degrees 03 minutes 46.26 seconds North Latitude and -112 degrees 03 minutes 012.5 seconds West Longitude, which can be converted to mapping accuracy State Plane Utah Central Zone NAD 83 feet coordinates of X = 1,485,512.1 feet and Y = 7,192,095.8 feet; thence the following courses along the said road center line:

thence South 84 Degrees 03 Minutes 08 Seconds East	30 feet
thence North 88 Degrees 32 Minutes 55 Seconds East	166.7 feet
thence North 80 Degrees 24 Minutes 13 Seconds East	162.9 feet
thence North 79 Degrees 22 Minutes 56 Seconds East	156.1 feet
thence North 82 Degrees 40 Minutes 52 Seconds East	161.7 feet
thence North 88 Degrees 02 Minutes 57 Seconds East	173.3 feet
thence South 84 Degrees 49 Minutes 14 Seconds East	171.1 feet
thence South 74 Degrees 17 Minutes 05 Seconds East	166.3 feet
thence South 78 Degrees 36 Minutes 01 Seconds East	169.6 feet
thence South 80 Degrees 48 Minutes 22 Seconds East	168.7 feet
thence South 84 Degrees 18 Minutes 06 Seconds East	156.4 feet

thence South 86 Degrees 26 Minutes 26 Seconds East 145.4 feet  
thence South 84 Degrees 49 Minutes 52 Seconds East 154.3 feet  
thence South 87 Degrees 01 Minutes 40 Seconds East 171.3 feet  
thence North 84 Degrees 07 Minutes 13 Seconds East 169.5 feet  
thence North 81 Degrees 44 Minutes 17 Seconds East 166.3 feet  
thence North 83 Degrees 05 Minutes 56 Seconds East 157.6 feet  
thence North 77 Degrees 52 Minutes 58 Seconds East 152.5 feet  
thence North 77 Degrees 43 Minutes 25 Seconds East 166.4 feet  
thence North 78 Degrees 24 Minutes 37 Seconds East 168 feet  
thence North 80 Degrees 57 Minutes 24 Seconds East 162.3 feet  
thence North 89 Degrees 04 Minutes 55 Seconds East 158.2 feet  
thence South 88 Degrees 32 Minutes 14 Seconds East 157.9 feet  
thence North 82 Degrees 46 Minutes 48 Seconds East 153 feet  
thence North 70 Degrees 24 Minutes 40 Seconds East 143.2 feet  
thence North 79 Degrees 38 Minutes 43 Seconds East 141.3 feet  
thence South 73 Degrees 56 Minutes 02 Seconds East 139.6 feet  
thence South 55 Degrees 10 Minutes 09 Seconds East 142.5 feet  
thence South 65 Degrees 18 Minutes 23 Seconds East 135.8 feet  
thence South 88 Degrees 17 Minutes 50 Seconds East 139.2 feet  
thence North 88 Degrees 26 Minutes 01 Seconds East 151.3 feet  
thence South 85 Degrees 59 Minutes 28 Seconds East 152 feet  
thence South 80 Degrees 03 Minutes 51 Seconds East 147.4 feet  
thence South 77 Degrees 35 Minutes 06 Seconds East 126.5 feet  
thence South 74 Degrees 38 Minutes 38 Seconds East 97.1 feet  
thence South 74 Degrees 47 Minutes 57 Seconds East 24.5 feet  
thence South 77 Degrees 55 Minutes 41 Seconds East 30.6 feet  
thence South 77 Degrees 47 Minutes 40 Seconds East 15.1 feet  
thence North 83 Degrees 02 Minutes 38 Seconds East 71 feet  
thence North 68 Degrees 01 Minutes 13 Seconds East 120 feet  
thence North 67 Degrees 08 Minutes 17 Seconds East 142.1 feet  
thence North 68 Degrees 12 Minutes 31 Seconds East 31.4 feet more or less to **the ending**

**point at:** 40 degrees 03 minutes 46.91 seconds North Latitude and -112 degrees 02 minutes 0.6 seconds West Longitude, which can be converted to mapping accuracy State Plane Utah Central Zone NAD 83 feet coordinates of X = 1,491,102.1 feet and Y = 7,192,127.7 feet.



## Appendix B to Attachment 4

**Popular Name: CHIMNEY ROCK PASS ROAD**

**County: Utah**

**County Road Number: B835**

**State Geographic Information Database (SGID) Road Identification Number: RD250003.**

**Road-Segment Number: 004**

**Road-Segment Length: 0.57 miles more or less.**

**Believed owner of the land underlying this road-segment is: Bureau of Land Management.**

*The following description is based upon the geographic coordinate system using the NAD83 Datum. The source is GPS mapping grade data as indicated in the metadata and/or the transportation data model of the State of Utah Geographic Information Database (SGID).*

The road-segment itself is the monument that is identified by its physical presence on the land. The location of said physical presence is closely approximated by mapping grade Global Positioning System (GPS) data. Said data are checked against the corresponding gray-scale 1-meter Digital Orthophoto Quadrangles published by the United States Geological Survey (USGS) to verify a reasonable degree of accuracy. In circumstances where accurate satellite signal acquisition is not possible, such as deep, narrow canyons or under a canopy of dense foliage, or where very sharp curves in the road make accuracy questionable, such portions of the road were digitized from the corresponding gray-scale 1-meter Digital Orthophoto Quadrangles published by the United States Geological Survey (USGS).

This road-segment may traverse:

Township 9 South Range 2 West, Section(s) 1, Salt Lake Base & Meridian

The following description closely approximates the location of the centerline of the physical monument (CHIMNEY ROCK PASS ROAD)-- Segment 004 based on mapping grade Global Positioning System (GPS) data as defined above:

**Beginning at a point** on the road center line located at 40 degrees 03 minutes 30.65 seconds North Latitude and -112 degrees 00 minutes 52.44 seconds West Longitude, which can be converted to mapping accuracy State Plane Utah Central Zone NAD 83 feet coordinates of X = 1,496,391.3 feet and Y = 7,190,452.2 feet; thence the following courses along the said road center line:

thence South 63 Degrees 45 Minutes 29 Seconds East	5.1 feet
thence South 62 Degrees 39 Minutes 15 Seconds East	68.5 feet
thence South 65 Degrees 13 Minutes 28 Seconds East	166.3 feet
thence South 72 Degrees 43 Minutes 41 Seconds East	162.8 feet
thence South 73 Degrees 43 Minutes 42 Seconds East	155.1 feet
thence South 60 Degrees 38 Minutes 13 Seconds East	159 feet
thence South 56 Degrees 04 Minutes 41 Seconds East	169.1 feet
thence South 58 Degrees 02 Minutes 17 Seconds East	178.2 feet
thence South 60 Degrees 19 Minutes 28 Seconds East	183.8 feet
thence South 58 Degrees 25 Minutes 17 Seconds East	192.5 feet
thence South 56 Degrees 37 Minutes 59 Seconds East	183.4 feet

thence South 59 Degrees 31 Minutes 06 Seconds East 182.6 feet  
thence South 62 Degrees 46 Minutes 13 Seconds East 170.3 feet  
thence South 63 Degrees 03 Minutes 53 Seconds East 157.6 feet  
thence South 61 Degrees 58 Minutes 39 Seconds East 141.7 feet  
thence South 56 Degrees 10 Minutes 42 Seconds East 149.1 feet  
thence South 56 Degrees 40 Minutes 06 Seconds East 147.4 feet  
thence South 57 Degrees 27 Minutes 10 Seconds East 133.6 feet  
thence South 58 Degrees 14 Minutes 06 Seconds East 120.5 feet  
thence South 73 Degrees 10 Minutes 32 Seconds East 92.4 feet  
thence South 73 Degrees 15 Minutes 58 Seconds East 30.2 feet  
thence South 85 Degrees 53 Minutes 54 Seconds East 55.3 feet more or less to **the ending**

**point at:** 40 degrees 03 minutes 16.95 seconds North Latitude and -112 degrees 00 minutes 18.43 seconds West Longitude, which can be converted to mapping accuracy State Plane Utah Central Zone NAD 83 feet coordinates of X = 1,499,028.1 feet and Y = 7,189,050.4 feet.