

**Acknowledgment and
Notice of Acknowledgment
of Acceptance of R.S. 2477
Right-of-Way Grant**

ENT 21733;2008 PG 1 of 6
RANDALL A. COVINGTON
UTAH COUNTY RECORDER
2008 Feb 26 9:06 am FEE 0.00 BY CS
RECORDED FOR GOVERNOR STATE OF UTAH

THE STATE OF UTAH

TO ALL WHOM THESE PRESENTS SHALL COME, Greeting:

Know ye, This is an Acknowledgment and Notice of Acknowledgment made under Utah Code Sections 72-5-309 through 310 inclusive, that the grant of the United States of America of “the right of way for the construction of highways over public lands, not reserved for public uses” under United States Revised Statutes 2477 (43 U.S.C. Section 932 (repealed October 21, 1976, with proviso recognizing the validity of rights-of-way already established)) was accepted for and on behalf of the State of Utah and its political subdivision Utah County as it pertains to the highway located in Utah County known as ELBERTA SLANT ROAD; County Road Number: B850; State Geographic Information Database (SGID) Road Identification Number: RD250007. Total road length is 7.5 miles more or less.

The reason for this Acknowledgment and Notice of Acknowledgment includes, but is not limited to, the fact that the road was constructed, mechanically, or by continuous use as a public highway for a period of at least ten years, over public lands not reserved for public uses, prior to the earlier of (a) the October 21, 1976 repeal of R.S. 2477 or (b) the date the servient estate was reserved for public uses.

This Acknowledgment and Notice of Acknowledgment applies only to the segments of the road that traverse land owned by the Bureau of Land Management, United States Department of the Interior, and does not apply to segments of the road that traverse land owned by any other person or entity. The State of Utah and its political subdivisions reserve the right to make further acknowledgments and notices of acknowledgment with regard to road segments that traverse land owned by other entities, including the United States of America, through one or more of its agencies.

A printed copy of a map showing the location of the road in said county is appended hereto as “Attachment 1,” a printed copy of representative photos of the road is appended hereto as “Attachment 2,” a printed copy of a description of the beginning and ending points of the entire road together with a list of Townships, Ranges and Sections that may be traversed by the road in said county is appended hereto as “Attachment 3,” and a printed copy of the Road Centerline Description Cover Page(s) is appended hereto as “Attachment 4.” The Appendices listed in “Attachment 4” that contain the actual road centerline descriptions are incorporated herein by reference.

A printed copy of this Acknowledgment and Notice of Acknowledgment, together with its Attachments and Appendices, may be viewed and/or obtained at the office of the Utah State Archives.

An electronic copy of this Acknowledgment and Notice of Acknowledgment, together with its Attachments and Appendices, may be viewed and/or downloaded as read-only PDF (Portable Document Format) files via the

Internet at <http://recorded2477roads.utah.gov>.

The owner of the servient estate in the land underlying the road-segments subject to this Acknowledgment and Notice is believed to be the United States of America through one or more of its agencies. Any of such agencies or any other person with a servient ownership claim or a competing dominant estate right-of-way ownership claim, may file a petition in the State District Court for Salt Lake County for a decision regarding the correctness of this Acknowledgment. A claimant shall file a petition within sixty (60) days after receipt of this Notice.

In Witness Whereof, I, John Harja, the official designee of the Governor of the State of Utah, in conformity to the laws of the State (Utah Code Sections 72-5-308 through 310 inclusive), have caused this Acknowledgment and Notice of Acknowledgment to be made.

Signed by my hand in Salt Lake City, Utah, the 21st day of FEBRUARY, 2008.

By the Governor's Designee



John Harja

CERTIFICATION

State of Utah)
 : ss
County of Salt Lake)

I hereby certify that the signer of the foregoing document, John Harja, is personally known by me, has made a voluntary signature and taken an oath stating that he is the official designee of the Governor of the State of Utah and is authorized to sign this document on the Governor's behalf pursuant to Utah Code Section 72-5-309. He further vouched that, based upon information and belief, the facts alleged therein are true.

Dated this 21st day of February, 2008.



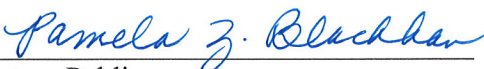

Notary Public

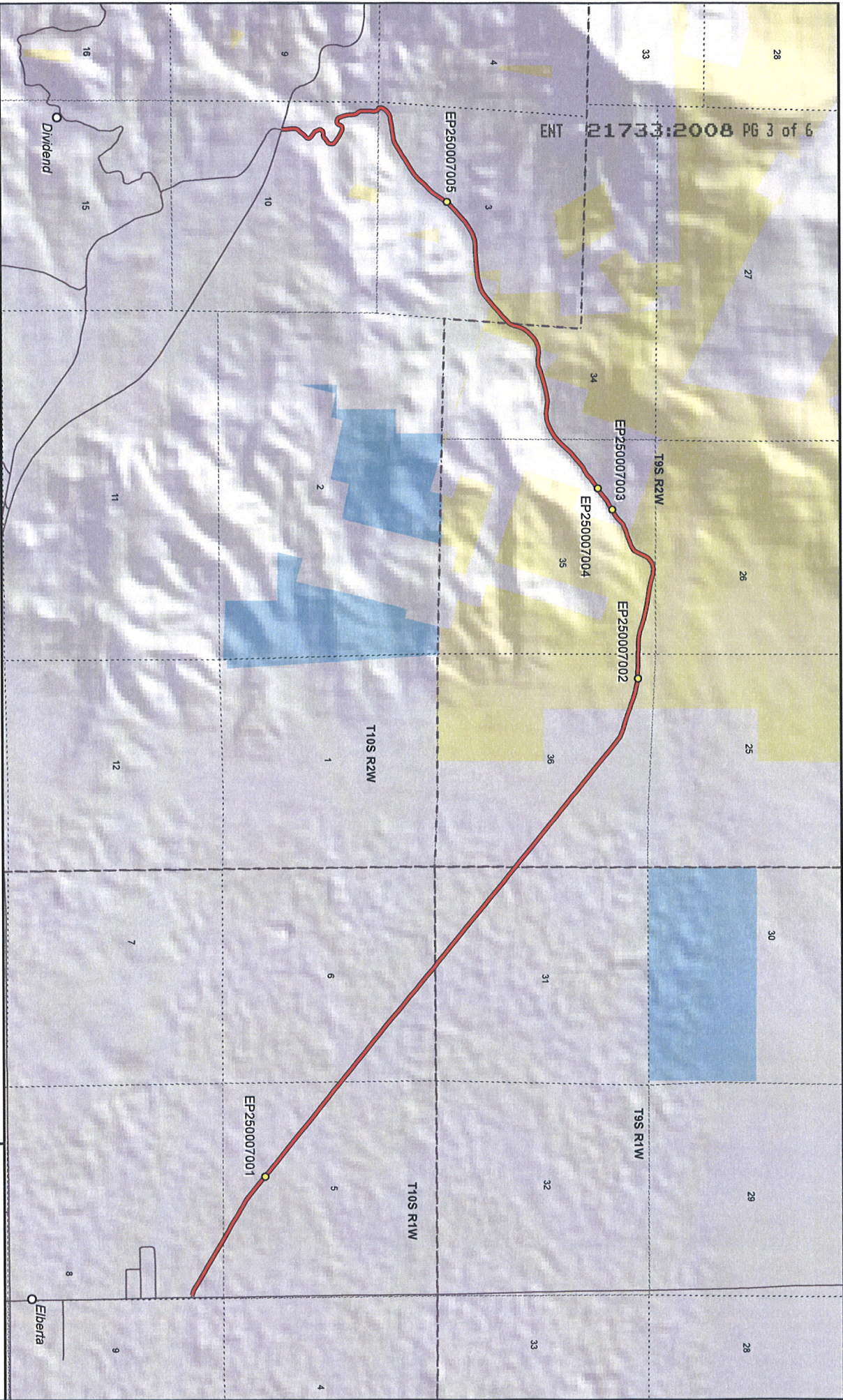

ENT 21733:2008 PG 3 of 6

ELBERTA SLANT ROAD - Utah County
SGID RD_ID RD250007

- Land Ownership Categories**
- BLM
 - Private
 - SITLA, State Trust Land
 - USFS, National Forest
 - State Parks and Recreation
 - Tribal, Indian Reservation
 - NPS, National Park
 - Wilderness
 - UDWR Wildlife Reserve
 - DOD, Military
 - State Sovereign Land
 - National Recreation Area
 - USFWS, Natl. Wildlife Refuge
- Transportation Network**
- ELBERTA SLANT ROAD
 - Other Roads
 - Title V, Issued Or Under Consideration By BLM Or County
 - Photo Event Point
 - Section = 1 Mile

Map prepared by the State of Utah
 Automated Geographic Reference Center
 Room 5130 State Office Building
 Salt Lake City, Utah 84114
 Nov 03, 2006



1:39,821
 1 inch equals 0.6 miles

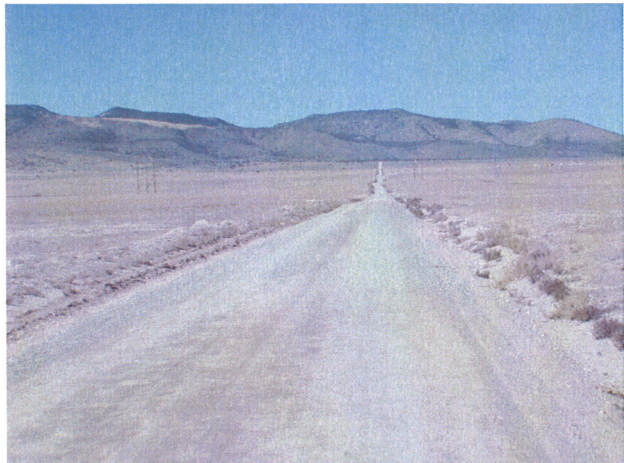

EP250007001



EP250007002



EP250007003



EP250007004



EP250007005

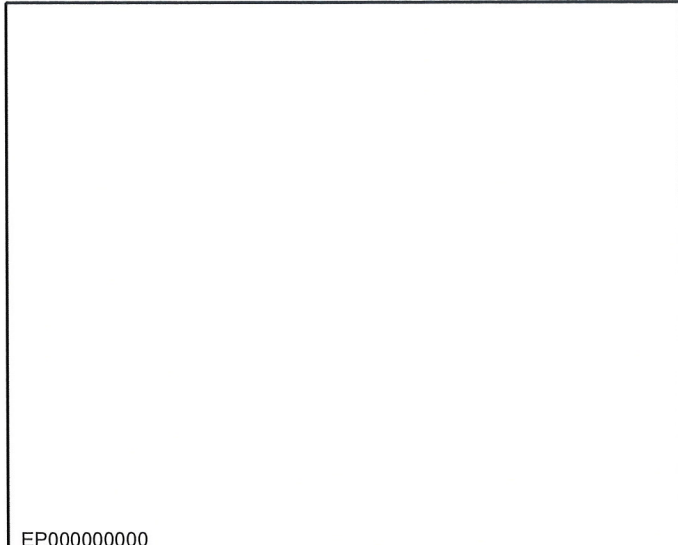

EP000000000

Elberta Slant Road - Utah County
SGID RD_ID RD250007

Map prepared by the State of Utah
Automated Geographic Reference Center
Room 5130 State Office Building
Salt Lake City, Utah 84114
October 30, 2006



Attachment 3**Beginning & Ending Points and Township, Range, and Section References For:****Popular Name: ELBERTA SLANT ROAD****County: Utah****County Road Number: B850****State Geographic Information Database (SGID) Road Identification Number: RD250007.****Total Road Length: 7.5 miles more or less.**

Beginning at a point on the road centerline located at 39 degrees 58 minutes 12.09 seconds North Latitude and -112 degrees 03 minutes 37.84 seconds West Longitude, which can be converted to mapping accuracy State Plane Utah Central Zone NAD 83 feet coordinates of X = 1,483,330.0 feet and Y = 7,158,297.0 feet based on the US Survey Foot conversion.

Ending at a point on the road centerline located at 39 degrees 57 minutes 51.88 seconds North Latitude and -111 degrees 57 minutes 24.26 seconds West Longitude, which can be converted to mapping accuracy State Plane Utah Central Zone NAD 83 feet coordinates of X = 1,512,401.8 feet and Y = 7,156,087.2 feet based on the US Survey Foot conversion.

This road may traverse:

Township 10 South Range 1 West, Section(s) 5,6,8, Salt Lake Base & Meridian

Township 10 South Range 2 West, Section(s) 3,10, Salt Lake Base & Meridian

Township 9 South Range 1 West, Section(s) 31, Salt Lake Base & Meridian

Township 9 South Range 2 West, Section(s) 26,34,35,36, Salt Lake Base & Meridian

See Attachment 1 above for a cartographic depiction of the course of this road.

Attachment 4
Road Centerline Description Cover Page(s)

Popular Name: ELBERTA SLANT ROAD

County: Utah

County Road Number: B850

State Geographic Information Database (SGID) Road Identification Number: RD250007.

Total Road Length: 7.5 miles more or less.

Centerline Descriptions Of Road-Segments That Cross Over Federally Owned Land, Derived From Global Positioning System Data And Cross-checked against USGS Digital Orthophoto Quadrangles Compiled By The Utah Automated Geographic Reference Center And Entered Into The State Geographic Information Database (SGID).

Road-Segments Listed by SGID Road Identification Number (RD_ID)	Road-Segment Numbers	Believed Ownership Of Servient Estate	Approximate Segment Length	See Attached Appendix
RD250007	001	PVT	1.63 Miles	(not shown)
RD250007	002	BLM	0.02 Miles	A
RD250007	003	PVT	0.15 Miles	(not shown)
RD250007	004	BLM	0.32 Miles	B
RD250007	005	PVT	0.97 Miles	(not shown)
RD250007	006	BLM	0.66 Miles	C
RD250007	007	PVT	3.75 Miles	(not shown)
		Total Road Length	7.5	_____

* Indicates that a Title V permit will be requested, is in process, or has been issued.

† Indicates that road-segments crossing Forest Service land are under consideration by the state and county as of the date of this Acknowledgment and Notice of Acknowledgment.

Appendix A to Attachment 4

Popular Name: ELBERTA SLANT ROAD

County: Utah

County Road Number: B850

State Geographic Information Database (SGID) Road Identification Number: RD250007.

Road-Segment Number: 002

Road-Segment Length: 0.02 miles more or less.

Believed owner of the land underlying this road-segment is: Bureau of Land Management.

The following description is based upon the geographic coordinate system using the NAD83 Datum. The source is GPS mapping grade data as indicated in the metadata and/or the transportation data model of the State of Utah Geographic Information Database (SGID).

The road-segment itself is the monument that is identified by its physical presence on the land. The location of said physical presence is closely approximated by mapping grade Global Positioning System (GPS) data. Said data are checked against the corresponding gray-scale 1-meter Digital Orthophoto Quadrangles published by the United States Geological Survey (USGS) to verify a reasonable degree of accuracy. In circumstances where accurate satellite signal acquisition is not possible, such as deep, narrow canyons or under a canopy of dense foliage, or where very sharp curves in the road make accuracy questionable, such portions of the road were digitized from the corresponding gray-scale 1-meter Digital Orthophoto Quadrangles published by the United States Geological Survey (USGS).

This road-segment may traverse:

Township 10 South Range 2 West, Section(s) 3, Salt Lake Base & Meridian

The following description closely approximates the location of the centerline of the physical monument (ELBERTA SLANT ROAD)-- Segment 002 based on mapping grade Global Positioning System (GPS) data as defined above:

Beginning at a point on the road center line located at 39 degrees 59 minutes 00.59 seconds North Latitude and -112 degrees 02 minutes 52.78 seconds West Longitude, which can be converted to mapping accuracy State Plane Utah Central Zone NAD 83 feet coordinates of X = 1,486,868.3 feet and Y = 7,163,182.8 feet; thence the following courses along the said road center line:

thence North 82 Degrees 43 Minutes 13 Seconds East 111.1 feet more or less to **the ending point at:** 39 degrees 59 minutes 00.73 seconds North Latitude and -112 degrees 02 minutes 51.36 seconds West Longitude, which can be converted to mapping accuracy State Plane Utah Central Zone NAD 83 feet coordinates of X = 1,486,978.4 feet and Y = 7,163,196.9 feet.

Appendix B to Attachment 4

Popular Name: ELBERTA SLANT ROAD

County: Utah

County Road Number: B850

State Geographic Information Database (SGID) Road Identification Number: RD250007.

Road-Segment Number: 004

Road-Segment Length: 0.32 miles more or less.

Believed owner of the land underlying this road-segment is: Bureau of Land Management.

The following description is based upon the geographic coordinate system using the NAD83 Datum. The source is GPS mapping grade data as indicated in the metadata and/or the transportation data model of the State of Utah Geographic Information Database (SGID).

The road-segment itself is the monument that is identified by its physical presence on the land. The location of said physical presence is closely approximated by mapping grade Global Positioning System (GPS) data. Said data are checked against the corresponding gray-scale 1-meter Digital Orthophoto Quadrangles published by the United States Geological Survey (USGS) to verify a reasonable degree of accuracy. In circumstances where accurate satellite signal acquisition is not possible, such as deep, narrow canyons or under a canopy of dense foliage, or where very sharp curves in the road make accuracy questionable, such portions of the road were digitized from the corresponding gray-scale 1-meter Digital Orthophoto Quadrangles published by the United States Geological Survey (USGS).

This road-segment may traverse:

Township 10 South Range 2 West, Section(s) 3, Salt Lake Base & Meridian

Township 9 South Range 2 West, Section(s) 34, Salt Lake Base & Meridian

The following description closely approximates the location of the centerline of the physical monument (ELBERTA SLANT ROAD)-- Segment 004 based on mapping grade Global Positioning System (GPS) data as defined above:

Beginning at a point on the road center line located at 39 degrees 59 minutes 04.28 seconds North Latitude and -112 degrees 02 minutes 42.62 seconds West Longitude, which can be converted to mapping accuracy State Plane Utah Central Zone NAD 83 feet coordinates of X = 1,487,660.6 feet and Y = 7,163,551.8 feet; thence the following courses along the said road center line:

thence North 50 Degrees 04 Minutes 44 Seconds East	81.3 feet
thence North 46 Degrees 43 Minutes 00 Seconds East	156.5 feet
thence North 48 Degrees 32 Minutes 55 Seconds East	154.7 feet
thence North 46 Degrees 11 Minutes 54 Seconds East	131.1 feet
thence North 44 Degrees 40 Minutes 39 Seconds East	3.7 feet
thence North 45 Degrees 40 Minutes 43 Seconds East	119.5 feet
thence North 44 Degrees 40 Minutes 39 Seconds East	9.3 feet
thence North 22 Degrees 12 Minutes 05 Seconds East	120.8 feet
thence North 14 Degrees 02 Minutes 12 Seconds East	127 feet
thence North 25 Degrees 01 Minutes 25 Seconds East	138 feet

thence North 35 Degrees 11 Minutes 54 Seconds East 131 feet
thence North 45 Degrees 16 Minutes 05 Seconds East 112.5 feet
thence North 48 Degrees 17 Minutes 56 Seconds East 91.8 feet
thence North 54 Degrees 46 Minutes 30 Seconds East 120.4 feet
thence North 69 Degrees 58 Minutes 44 Seconds East 141.2 feet
thence North 88 Degrees 25 Minutes 55 Seconds East 30.2 feet more or less to **the ending**

point at: 39 degrees 59 minutes 15.93 seconds North Latitude and -112 degrees 02 minutes 28.56 seconds West Longitude, which can be converted to mapping accuracy State Plane Utah Central Zone NAD 83 feet coordinates of X = 1,488,762.2 feet and Y = 7,164,723.3 feet.

Appendix C to Attachment 4

Popular Name: ELBERTA SLANT ROAD

County: Utah

County Road Number: B850

State Geographic Information Database (SGID) Road Identification Number: RD250007.

Road-Segment Number: 006

Road-Segment Length: 0.66 miles more or less.

Believed owner of the land underlying this road-segment is: Bureau of Land Management.

The following description is based upon the geographic coordinate system using the NAD83 Datum. The source is GPS mapping grade data as indicated in the metadata and/or the transportation data model of the State of Utah Geographic Information Database (SGID).

The road-segment itself is the monument that is identified by its physical presence on the land. The location of said physical presence is closely approximated by mapping grade Global Positioning System (GPS) data. Said data are checked against the corresponding gray-scale 1-meter Digital Orthophoto Quadrangles published by the United States Geological Survey (USGS) to verify a reasonable degree of accuracy. In circumstances where accurate satellite signal acquisition is not possible, such as deep, narrow canyons or under a canopy of dense foliage, or where very sharp curves in the road make accuracy questionable, such portions of the road were digitized from the corresponding gray-scale 1-meter Digital Orthophoto Quadrangles published by the United States Geological Survey (USGS).

This road-segment may traverse:

Township 9 South Range 2 West, Section(s) 26,35, Salt Lake Base & Meridian

The following description closely approximates the location of the centerline of the physical monument (ELBERTA SLANT ROAD)-- Segment 006 based on mapping grade Global Positioning System (GPS) data as defined above:

Beginning at a point on the road center line located at 39 degrees 59 minutes 37.49 seconds North Latitude and -112 degrees 01 minutes 31.58 seconds West Longitude, which can be converted to mapping accuracy State Plane Utah Central Zone NAD 83 feet coordinates of X = 1,493,209.8 feet and Y = 7,166,878.4 feet; thence the following courses along the said road center line:

thence North 66 Degrees 21 Minutes 17 Seconds East	59.7 feet
thence North 69 Degrees 18 Minutes 03 Seconds East	85.8 feet
thence North 69 Degrees 01 Minutes 36 Seconds East	69.8 feet
thence North 69 Degrees 48 Minutes 08 Seconds East	148.6 feet
thence North 68 Degrees 26 Minutes 51 Seconds East	140.5 feet
thence North 57 Degrees 31 Minutes 05 Seconds East	129.5 feet
thence North 30 Degrees 38 Minutes 28 Seconds East	135.9 feet
thence North 20 Degrees 42 Minutes 18 Seconds East	135.4 feet
thence North 33 Degrees 06 Minutes 08 Seconds East	118 feet
thence North 51 Degrees 42 Minutes 07 Seconds East	98.7 feet
thence North 56 Degrees 56 Minutes 32 Seconds East	81.9 feet

thence North 76 Degrees 58 Minutes 13 Seconds East 102.9 feet
thence North 63 Degrees 06 Minutes 44 Seconds East 0.7 feet
thence North 77 Degrees 08 Minutes 55 Seconds East 15.1 feet
thence South 82 Degrees 11 Minutes 32 Seconds East 27.8 feet
thence South 71 Degrees 53 Minutes 15 Seconds East 1 feet
thence South 81 Degrees 56 Minutes 37 Seconds East 128.4 feet
thence South 76 Degrees 06 Minutes 33 Seconds East 180.4 feet
thence South 77 Degrees 33 Minutes 47 Seconds East 185.7 feet
thence South 81 Degrees 04 Minutes 43 Seconds East 183.9 feet
thence South 81 Degrees 29 Minutes 13 Seconds East 192.3 feet
thence South 80 Degrees 18 Minutes 10 Seconds East 188.6 feet
thence South 78 Degrees 11 Minutes 49 Seconds East 171.8 feet
thence South 73 Degrees 00 Minutes 08 Seconds East 165.3 feet
thence South 72 Degrees 49 Minutes 36 Seconds East 158.3 feet
thence South 76 Degrees 43 Minutes 53 Seconds East 153.6 feet
thence South 86 Degrees 39 Minutes 45 Seconds East 154.2 feet
thence South 88 Degrees 30 Minutes 49 Seconds East 156 feet
thence South 89 Degrees 05 Minutes 41 Seconds East 91.9 feet more or less to **the ending**

point at: 39 degrees 59 minutes 41.15 seconds North Latitude and -112 degrees 00 minutes 051.5 seconds West Longitude, which can be converted to mapping accuracy State Plane Utah Central Zone NAD 83 feet coordinates of X = 1,496,331.2 feet and Y = 7,167,231.0 feet.