

**Acknowledgment and  
Notice of Acknowledgment  
of Acceptance of R.S. 2477  
Right-of-Way Grant**

ENT 21741:2008 PG 1 of 6  
RANDALL A. COVINGTON  
UTAH COUNTY RECORDER  
2008 Feb 26 9:12 am FEE 0.00 BY CS  
RECORDED FOR GOVERNOR STATE OF UTAH

**THE STATE OF UTAH**

**TO ALL WHOM THESE PRESENTS SHALL COME, Greeting:**

**Know ye,** This is an Acknowledgment and Notice of Acknowledgment made under Utah Code Sections 72-5-309 through 310 inclusive, that the grant of the United States of America of “the right of way for the construction of highways over public lands, not reserved for public uses” under United States Revised Statutes 2477 (43 U.S.C. Section 932 (repealed October 21, 1976, with proviso recognizing the validity of rights-of-way already established)) was accepted for and on behalf of the State of Utah and its political subdivision Utah County as it pertains to the highway located in Utah County known as SOLDIER PASS ROAD; County Road Number: B952; State Geographic Information Database (SGID) Road Identification Number: RD250018. Total road length is 4.54 miles more or less.

The reason for this Acknowledgment and Notice of Acknowledgment includes, but is not limited to, the fact that the road was constructed, mechanically, or by continuous use as a public highway for a period of at least ten years, over public lands not reserved for public uses, prior to the earlier of (a) the October 21, 1976 repeal of R.S. 2477 or (b) the date the servient estate was reserved for public uses.

This Acknowledgment and Notice of Acknowledgment applies only to the segments of the road that traverse land owned by the Bureau of Land Management, United States Department of the Interior, and does not apply to segments of the road that traverse land owned by any other person or entity. The State of Utah and its political subdivisions reserve the right to make further acknowledgments and notices of acknowledgment with regard to road segments that traverse land owned by other entities, including the United States of America, through one or more of its agencies.

A printed copy of a map showing the location of the road in said county is appended hereto as “Attachment 1,” a printed copy of representative photos of the road is appended hereto as “Attachment 2,” a printed copy of a description of the beginning and ending points of the entire road together with a list of Townships, Ranges and Sections that may be traversed by the road in said county is appended hereto as “Attachment 3,” and a printed copy of the Road Centerline Description Cover Page(s) is appended hereto as “Attachment 4.” The Appendices listed in “Attachment 4” that contain the actual road centerline descriptions are incorporated herein by reference.

A printed copy of this Acknowledgment and Notice of Acknowledgment, together with its Attachments and Appendices, may be viewed and/or obtained at the office of the Utah State Archives.

An electronic copy of this Acknowledgment and Notice of Acknowledgment, together with its Attachments and Appendices, may be viewed and/or downloaded as read-only PDF (Portable Document Format) files via the

Internet at <http://recorded2477roads.utah.gov>.

The owner of the servient estate in the land underlying the road-segments subject to this Acknowledgment and Notice is believed to be the United States of America through one or more of its agencies. Any of such agencies or any other person with a servient ownership claim or a competing dominant estate right-of-way ownership claim, may file a petition in the State District Court for Salt Lake County for a decision regarding the correctness of this Acknowledgment. A claimant shall file a petition within sixty (60) days after receipt of this Notice.

**In Witness Whereof**, I, John Harja, the official designee of the Governor of the State of Utah, in conformity to the laws of the State (Utah Code Sections 72-5-308 through 310 inclusive), have caused this Acknowledgment and Notice of Acknowledgment to be made.

Signed by my hand in Salt Lake City, Utah, the 21<sup>st</sup> day of FEBRUARY, 2008.

By the Governor's Designee

  
\_\_\_\_\_  
John Harja

**CERTIFICATION**

State of Utah                    )  
  : ss  
County of Salt Lake         )

I hereby certify that the signer of the foregoing document, John Harja, is personally known by me, has made a voluntary signature and taken an oath stating that he is the official designee of the Governor of the State of Utah and is authorized to sign this document on the Governor's behalf pursuant to Utah Code Section 72-5-309. He further vouched that, based upon information and belief, the facts alleged therein are true.

Dated this 21<sup>st</sup> day of February, 2008.

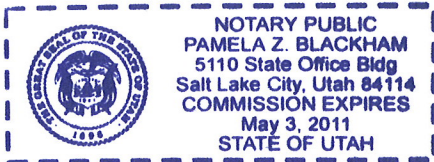

  
\_\_\_\_\_  
Notary Public

ENT 21741:2008 Pg 3 of 6

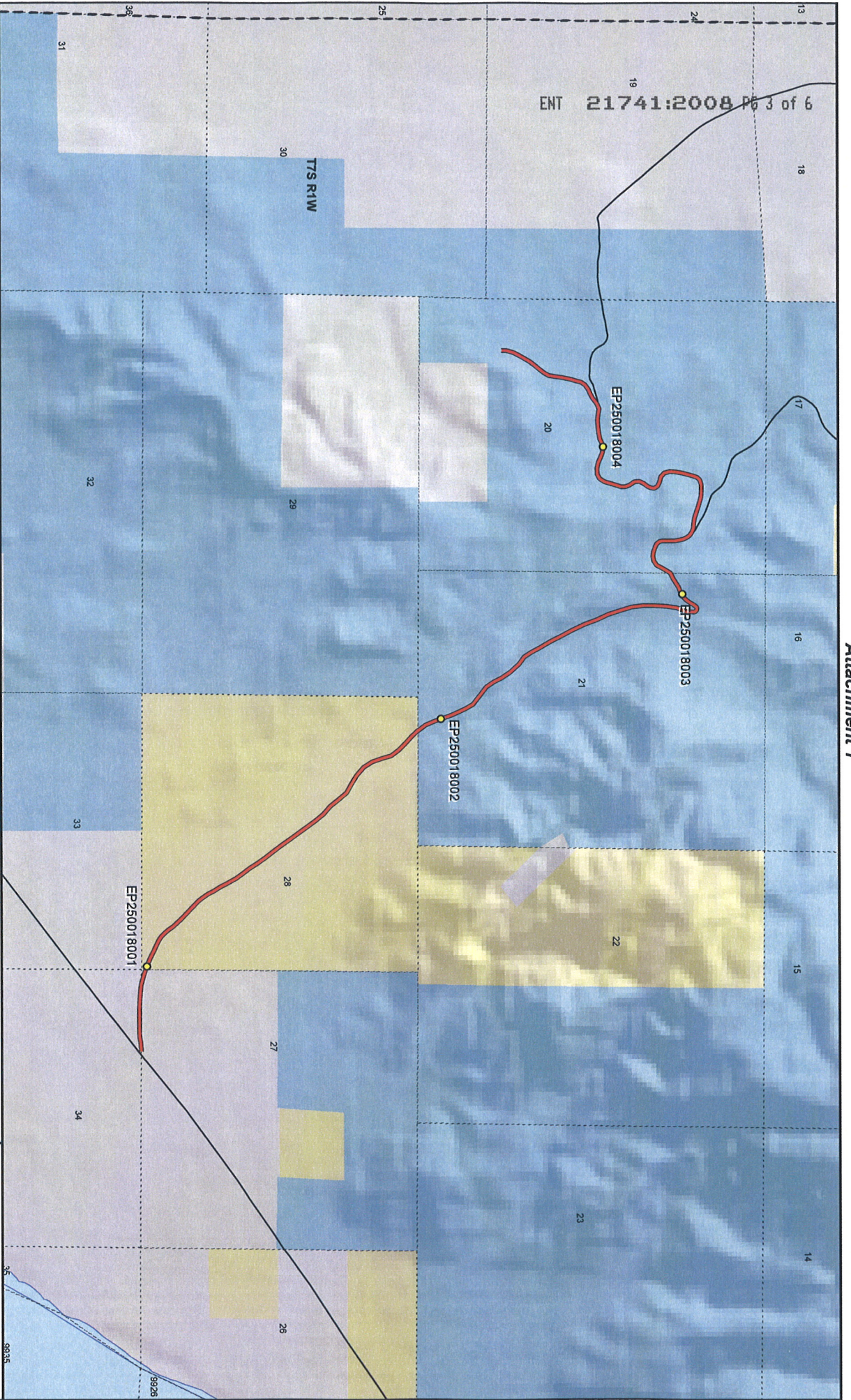

**SOLDIER PASS ROAD - Utah County**  
**SGID RD\_ID RD250018**

**Land Ownership Categories**

- BLM
- Private
- SITLA, State Trust Land
- USFS, National Forest
- State Parks and Recreation
- Tribal, Indian Reservation
- NPS, National Park
- Wilderness
- UDWR, Wildlife Reserve
- DOD, Military
- State Sovereign Land
- National Recreation Area
- USFWS, Natl. Wildlife Refuge

**Transportation Network**

- SOLDIER PASS ROAD
- Other Roads
- Title V, Issued Or Under Consideration By BLM Or County
- Photo Event Point
- Section = 1 Mile



1:30,481  
 1 inch equals 0.5 miles



Map prepared by the State of Utah  
 Automated Geographic Reference Center  
 Room 5130 State Office Building  
 Salt Lake City, Utah 84114  
 Nov 03, 2006





EP250018001



EP250018002



EP250018003



EP250018004

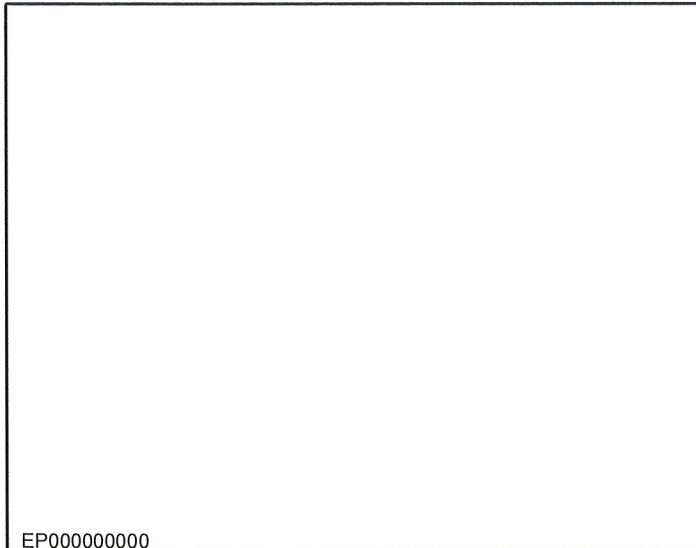

EP000000000

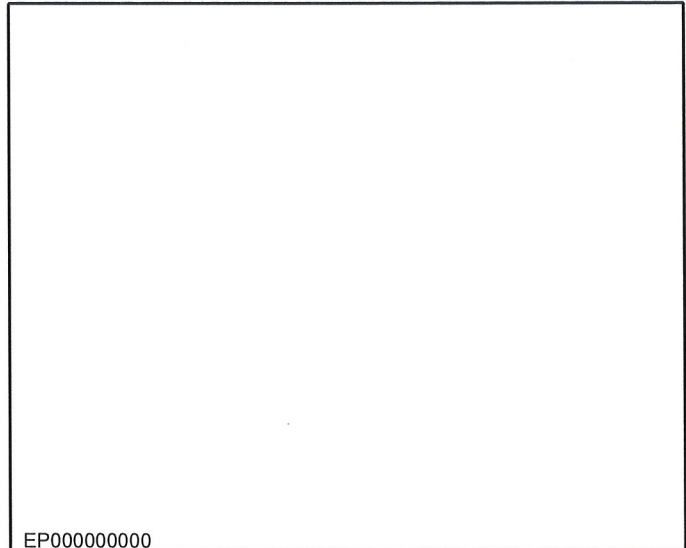

EP000000000

**Soldier Pass Road - Utah County**  
**SGID RD\_ID RD250018**

Map prepared by the State of Utah  
Automated Geographic Reference Center  
Room 5130 State Office Building  
Salt Lake City, Utah 84114  
October 30, 2006



### Attachment 3

#### Beginning & Ending Points and Township, Range, and Section References For:

**Popular Name: SOLDIER PASS ROAD**

**County: Utah**

**County Road Number: B952**

**State Geographic Information Database (SGID) Road Identification Number: RD250018.**

**Total Road Length: 4.54 miles more or less.**

**Beginning at a point** on the road centerline located at 40 degrees 11 minutes 21.97 seconds North Latitude and -111 degrees 58 minutes 58.62 seconds West Longitude, which can be converted to mapping accuracy State Plane Utah Central Zone NAD 83 feet coordinates of X = 1,505,498.6 feet and Y = 7,238,091.4 feet based on the US Survey Foot conversion.

**Ending at a point** on the road centerline located at 40 degrees 10 minutes 14.97 seconds North Latitude and -111 degrees 56 minutes 05.25 seconds West Longitude, which can be converted to mapping accuracy State Plane Utah Central Zone NAD 83 feet coordinates of X = 1,518,918.7 feet and Y = 7,231,243.2 feet based on the US Survey Foot conversion.

This road may traverse:

Township 7 South Range 1 West, Section(s) 20,21,27,28,34, Salt Lake Base & Meridian  
See Attachment 1 above for a cartographic depiction of the course of this road.

**Attachment 4  
Road Centerline Description Cover Page(s)**

**Popular Name: SOLDIER PASS ROAD**

**County: Utah**

**County Road Number: B952**

**State Geographic Information Database (SGID) Road Identification Number: RD250018.**

**Total Road Length: 4.54 miles more or less.**

**Centerline Descriptions Of Road-Segments That Cross Over Federally Owned Land, Derived From Global Positioning System Data And Cross-checked against USGS Digital Orthophoto Quadrangles Compiled By The Utah Automated Geographic Reference Center And Entered Into The State Geographic Information Database (SGID).**

<b>Road-Segments Listed by SGID Road Identification Number (RD ID)</b>	<b>Road-Segment Numbers</b>	<b>Believed Ownership Of Servient Estate</b>	<b>Approximate Segment Length</b>	<b>See Attached Appendix</b>
<b>RD250018</b>	<b>001</b>	<b>ST</b>	<b>2.9 Miles</b>	<b>(not shown)</b>
<b>RD250018</b>	<b>002</b>	<b>BLM</b>	<b>1.34 Miles</b>	<b>A</b>
<b>RD250018</b>	<b>003</b>	<b>PVT</b>	<b>0.3 Miles</b>	<b>(not shown)</b>
		<b>Total Road Length</b>	<b>4.54</b>	<b>_____</b>

\* Indicates that a Title V permit will be requested, is in process, or has been issued.

† Indicates that road-segments crossing Forest Service land are under consideration by the state and county as of the date of this Acknowledgment and Notice of Acknowledgment.

## Appendix A to Attachment 4

**Popular Name: SOLDIER PASS ROAD**

**County: Utah**

**County Road Number: B952**

**State Geographic Information Database (SGID) Road Identification Number: RD250018.**

**Road-Segment Number: 002**

**Road-Segment Length: 1.34 miles more or less.**

**Believed owner of the land underlying this road-segment is: Bureau of Land Management.**

*The following description is based upon the geographic coordinate system using the NAD83 Datum. The source is GPS mapping grade data as indicated in the metadata and/or the transportation data model of the State of Utah Geographic Information Database (SGID).*

The road-segment itself is the monument that is identified by its physical presence on the land. The location of said physical presence is closely approximated by mapping grade Global Positioning System (GPS) data. Said data are checked against the corresponding gray-scale 1-meter Digital Orthophoto Quadrangles published by the United States Geological Survey (USGS) to verify a reasonable degree of accuracy. In circumstances where accurate satellite signal acquisition is not possible, such as deep, narrow canyons or under a canopy of dense foliage, or where very sharp curves in the road make accuracy questionable, such portions of the road were digitized from the corresponding gray-scale 1-meter Digital Orthophoto Quadrangles published by the United States Geological Survey (USGS).

This road-segment may traverse:

Township 7 South Range 1 West, Section(s) 28, Salt Lake Base & Meridian

The following description closely approximates the location of the centerline of the physical monument (SOLDIER PASS ROAD)-- Segment 002 based on mapping grade Global Positioning System (GPS) data as defined above:

**Beginning at a point** on the road center line located at 40 degrees 11 minutes 06.75 seconds North Latitude and -111 degrees 57 minutes 24.99 seconds West Longitude, which can be converted to mapping accuracy State Plane Utah Central Zone NAD 83 feet coordinates of X = 1,512,756.4 feet and Y = 7,236,513.0 feet; thence the following courses along the said road center line:

thence South 43 Degrees 52 Minutes 31 Seconds East	174.3 feet
thence South 47 Degrees 29 Minutes 04 Seconds East	178.6 feet
thence South 46 Degrees 55 Minutes 35 Seconds East	174.3 feet
thence South 36 Degrees 38 Minutes 03 Seconds East	181.2 feet
thence South 16 Degrees 43 Minutes 33 Seconds East	181.3 feet
thence South 18 Degrees 57 Minutes 59 Seconds East	201.2 feet
thence South 33 Degrees 52 Minutes 55 Seconds East	196.5 feet
thence South 50 Degrees 45 Minutes 31 Seconds East	200.9 feet
thence South 57 Degrees 29 Minutes 46 Seconds East	193.7 feet
thence South 61 Degrees 07 Minutes 38 Seconds East	191.7 feet
thence South 39 Degrees 25 Minutes 06 Seconds East	203 feet

thence South 39 Degrees 51 Minutes 22 Seconds East 202.1 feet  
 thence South 49 Degrees 29 Minutes 59 Seconds East 200.8 feet  
 thence South 38 Degrees 17 Minutes 33 Seconds East 195.2 feet  
 thence South 36 Degrees 14 Minutes 23 Seconds East 196.9 feet  
 thence South 36 Degrees 51 Minutes 54 Seconds East 194 feet  
 thence South 36 Degrees 23 Minutes 42 Seconds East 192.8 feet  
 thence South 35 Degrees 12 Minutes 00 Seconds East 198 feet  
 thence South 37 Degrees 39 Minutes 00 Seconds East 198.1 feet  
 thence South 38 Degrees 54 Minutes 39 Seconds East 199.4 feet  
 thence South 35 Degrees 57 Minutes 09 Seconds East 193.8 feet  
 thence South 32 Degrees 05 Minutes 48 Seconds East 179.5 feet  
 thence South 36 Degrees 49 Minutes 01 Seconds East 169.4 feet  
 thence South 37 Degrees 04 Minutes 41 Seconds East 161.8 feet  
 thence South 29 Degrees 41 Minutes 42 Seconds East 161.9 feet  
 thence South 26 Degrees 56 Minutes 28 Seconds East 163.3 feet  
 thence South 29 Degrees 12 Minutes 53 Seconds East 155.5 feet  
 thence South 30 Degrees 42 Minutes 56 Seconds East 140.8 feet  
 thence South 34 Degrees 33 Minutes 56 Seconds East 123.1 feet  
 thence South 40 Degrees 14 Minutes 41 Seconds East 104.8 feet  
 thence South 45 Degrees 09 Minutes 01 Seconds East 152.7 feet  
 thence South 47 Degrees 27 Minutes 50 Seconds East 161.6 feet  
 thence South 46 Degrees 12 Minutes 54 Seconds East 179.2 feet  
 thence South 41 Degrees 32 Minutes 28 Seconds East 172.3 feet  
 thence South 37 Degrees 39 Minutes 27 Seconds East 121.8 feet  
 thence South 41 Degrees 35 Minutes 23 Seconds East 89.1 feet  
 thence South 47 Degrees 29 Minutes 18 Seconds East 92.2 feet  
 thence South 56 Degrees 31 Minutes 26 Seconds East 94.4 feet  
 thence South 62 Degrees 47 Minutes 39 Seconds East 95.8 feet  
 thence South 64 Degrees 33 Minutes 18 Seconds East 105.7 feet  
 thence South 64 Degrees 46 Minutes 46 Seconds East 98.9 feet  
 thence South 66 Degrees 13 Minutes 57 Seconds East 88.4 feet  
 thence South 68 Degrees 04 Minutes 31 Seconds East 78 feet  
 thence South 68 Degrees 20 Minutes 21 Seconds East 57 feet  
 thence South 70 Degrees 55 Minutes 36 Seconds East 24.7 feet  
 thence South 00 Degrees 19 Minutes 28 Seconds East 3.3 feet  
 thence South 70 Degrees 04 Minutes 40 Seconds East 42.7 feet  
 thence South 71 Degrees 23 Minutes 59 Seconds East 12.1 feet more or less to **the ending**

**point at:** 40 degrees 10 minutes 15.66 seconds North Latitude and -111 degrees 56 minutes 25.49 seconds West Longitude, which can be converted to mapping accuracy State Plane Utah Central Zone NAD 83 feet coordinates of X = 1,517,348.3 feet and Y = 7,231,320.6 feet.