

**Acknowledgment and
Notice of Acknowledgment
of Acceptance of R.S. 2477
Right-of-Way Grant**

DOC # 20080019348

Right of Way Page 1 of 21
Russell Shirts Washington County Recorder
05/12/2008 09:23:59 AM Fee \$ 0.00
By GOVERNOR OF STATE OF UTAH



THE STATE OF UTAH

TO ALL WHOM THESE PRESENTS SHALL COME, Greeting:

Know ye, This is an Acknowledgment and Notice of Acknowledgment made under Utah Code Sections 72-5-309 through 310 inclusive, that the grant of the United States of America of “the right of way for the construction of highways over public lands, not reserved for public uses” under United States Revised Statutes 2477 (43 U.S.C. Section 932 (repealed October 21, 1976, with proviso recognizing the validity of rights-of-way already established)) was accepted for and on behalf of the State of Utah and its political subdivision Washington County as it pertains to the highway located in Washington County known as HONEYMOON TRAIL; County Road Number: 0425; State Geographic Information Database (SGID) Road Identification Number: RD270425. Total road length is 6.01 miles more or less.

The reason for this Acknowledgment and Notice of Acknowledgment includes, but is not limited to, the fact that the road was constructed, mechanically, or by continuous use as a public highway for a period of at least ten years, over public lands not reserved for public uses, prior to the earlier of (a) the October 21, 1976 repeal of R.S. 2477 or (b) the date the servient estate was reserved for public uses.

This Acknowledgment and Notice of Acknowledgment applies only to the segments of the road that traverse land owned by the Bureau of Land Management, United States Department of the Interior, and does not apply to segments of the road that traverse land owned by any other person or entity. The State of Utah and its political subdivisions reserve the right to make further acknowledgments and notices of acknowledgment with regard to road segments that traverse land owned by other entities, including the United States of America, through one or more of its agencies.

A printed copy of a map showing the location of the road in said county is appended hereto as “Attachment 1,” a printed copy of representative photos of the road is appended hereto as “Attachment 2,” a printed copy of a description of the beginning and ending points of the entire road together with a list of Townships, Ranges and Sections that may be traversed by the road in said county is appended hereto as “Attachment 3,” and a printed copy of the Road Centerline Description Cover Page(s) is appended hereto as “Attachment 4.” The Appendices listed in “Attachment 4” that contain the actual road centerline descriptions are incorporated herein by reference. Affidavits provided by individuals familiar with the road are appended hereto as “Attachment 5.”

A printed copy of this Acknowledgment and Notice of Acknowledgment, together with its Attachments and Appendices, may be viewed and/or obtained at the office of the Utah State Archives.

An electronic copy of this Acknowledgment and Notice of Acknowledgment, together with its Attachments and Appendices, may be viewed and/or downloaded as read-only PDF (Portable Document Format) files via the

Internet at <http://recorded2477roads.utah.gov>.

The owner of the servient estate in the land underlying the road-segments subject to this Acknowledgment and Notice is believed to be the United States of America through one or more of its agencies. Any of such agencies or any other person with a servient ownership claim or a competing dominant estate right-of-way ownership claim, may file a petition in the State District Court for Salt Lake County for a decision regarding the correctness of this Acknowledgment. A claimant shall file a petition within sixty (60) days after receipt of this Notice.

In Witness Whereof, I, John Harja, the official designee of the Governor of the State of Utah, in conformity to the laws of the State (Utah Code Sections 72-5-308 through 310 inclusive), have caused this Acknowledgment and Notice of Acknowledgment to be made.

Signed by my hand in Salt Lake City, Utah, the 23rd day of April, 2008.

By the Governor's Designee



John Harja

CERTIFICATION

State of Utah)
 : ss
County of Salt Lake)

I hereby certify that the signer of the foregoing document, John Harja, is personally known by me, has made a voluntary signature and taken an oath stating that he is the official designee of the Governor of the State of Utah and is authorized to sign this document on the Governor's behalf pursuant to Utah Code Section 72-5-309. He further vouched that, based upon information and belief, the facts alleged therein are true.

Dated this 23rd day of April, 2008.





Notary Public

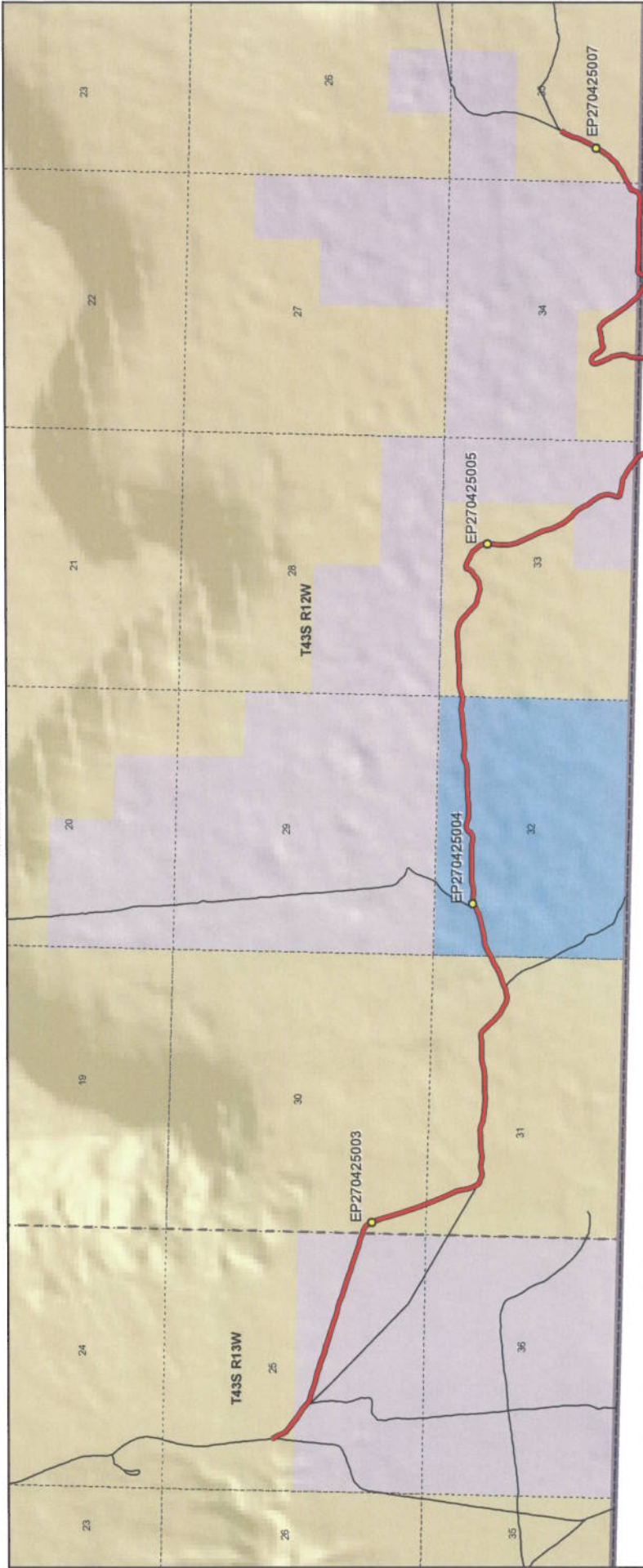

1:36,500
1 inch equals 0.6 miles

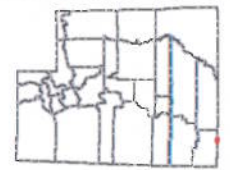

HONEYMOON TRAIL - Washington County
SGID RD_ID RD270425

- Land Ownership Categories**
- BLM
 - Private
 - SITLA, State Trust Land
 - USFS, National Forest
 - State Parks and Recreation
 - Tribal, Indian Reservation
 - NPS, National Park
 - Wilderness
 - UDWR Wildlife Reserve
 - DOD, Military
 - State Sovereign Land
 - National Recreation Area
 - USFWS, Natl. Wildlife Refuge

- Transportation Network**
- HONEYMOON TRAIL
 - Other Roads
 - Title V, Issued Or Under Consideration By BLM Or County
 - Photo Event Point
 - Section = 1 Mile

Map prepared by the State of Utah
Automated Geographic Reference Center
Room 5130 State Office Building
Salt Lake City, Utah 84114
Feb 12, 2008



Attachment 2



EP270425003



EP270425004



EP270425005



EP270425007

EP000000000

EP000000000

HONEYMOON TRAIL - Washington County
SGID RD_ID RD270425

Map prepared by the State of Utah
Automated Geographic Reference Center
Room 5130 State Office Building
Salt Lake City, Utah 84114
February 14, 2008



Attachment 3

Beginning & Ending Points and Township, Range, and Section References For:

Popular Name: HONEYMOON TRAIL

County: Washington

County Road Number: 0425

State Geographic Information Database (SGID) Road Identification Number: RD270425.

Total Road Length: 6.01 miles more or less.

Beginning at a point on the road centerline located at 37 degrees 01 minutes 09.15 seconds North Latitude and -113 degrees 16 minutes 012.6 seconds West Longitude, which can be converted to mapping accuracy State Plane Utah South Zone NAD 83 feet coordinates of X = 1,123,611.1 feet and Y = 9,975,759.6 feet based on the US Survey Foot conversion.

Ending at a point on the road centerline located at 37 degrees 00 minutes 00.05 seconds North Latitude and -113 degrees 11 minutes 22.93 seconds West Longitude, which can be converted to mapping accuracy State Plane Utah South Zone NAD 83 feet coordinates of X = 1,146,973.8 feet and Y = 9,968,337.4 feet based on the US Survey Foot conversion.

This road may traverse:

Township 43 South Range 12 West, Section(s) 30,31,32,33,34,35, Salt Lake Base & Meridian

Township 43 South Range 13 West, Section(s) 25, Salt Lake Base & Meridian

See Attachment 1 above for a cartographic depiction of the course of this road.

Attachment 4
Road Centerline Description Cover Page(s)

Popular Name: HONEYMOON TRAIL

County: Washington

County Road Number: 0425

State Geographic Information Database (SGID) Road Identification Number: RD270425.

Total Road Length: 6.01 miles more or less.

Centerline Descriptions Of Road-Segments That Cross Over Federally Owned Land, Derived From Global Positioning System Data And Cross-checked against USGS Digital Orthophoto Quadrangles Compiled By The Utah Automated Geographic Reference Center And Entered Into The State Geographic Information Database (SGID).

Road-Segments Listed by SGID Road Identification Number (RD ID)	Road-Segment Numbers	Believed Ownership Of Servient Estate	Approximate Segment Length	See Attached Appendix
RD270425	001	BLM	0.11 Miles	A
RD270425	002	PVT	0.78 Miles	(not shown)
RD270425	003	BLM	1.43 Miles	B
RD270425	004	ST	1.03 Miles	(not shown)
RD270425	005	BLM	1.04 Miles	C
RD270425	006	PVT	0.36 Miles	(not shown)
RD270425	007	PVT	0.38 Miles	(not shown)
RD270425	008	BLM	0.33 Miles	D
RD270425	009	BLM	0.45 Miles	E
RD270425	010	PVT	0.09 Miles	(not shown)
		Total Road Length	6.01	

* Indicates that a Title V permit will be requested, is in process, or has been issued.

† Indicates that road-segments crossing Forest Service land are under consideration by the state and county as of the date of this Acknowledgment and Notice of Acknowledgment.

Attachment 5

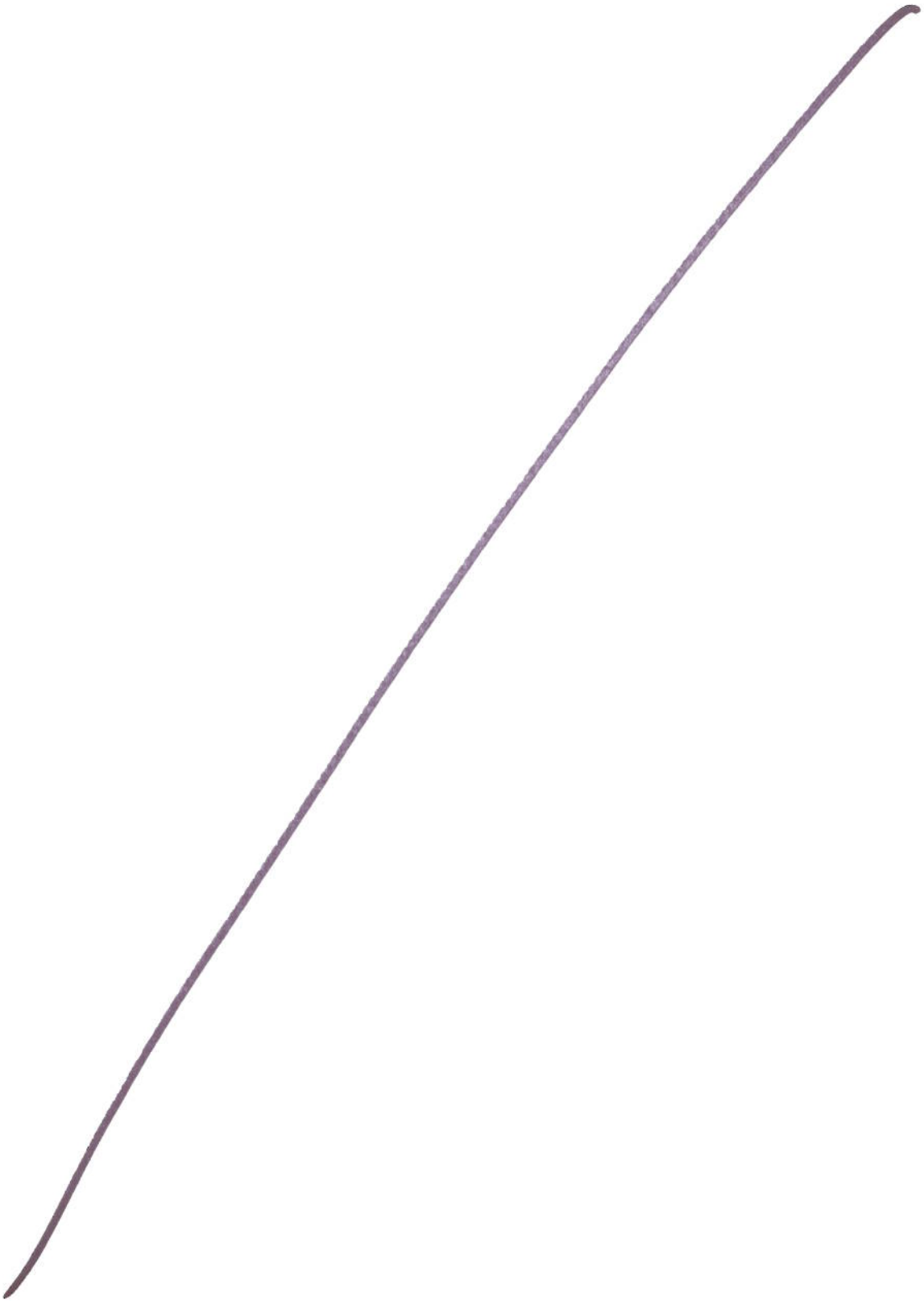

Appendix A to Attachment 4

Popular Name: HONEYMOON TRAIL

County: Washington

County Road Number: 0425

State Geographic Information Database (SGID) Road Identification Number: RD270425.

Road-Segment Number: 001

Road-Segment Length: 0.11 miles more or less.

Believed owner of the land underlying this road-segment is: Bureau of Land Management.

The following description is based upon the geographic coordinate system using the NAD83 Datum. The source is GPS mapping grade data as indicated in the metadata and/or the transportation data model of the State of Utah Geographic Information Database (SGID).

The road-segment itself is the monument that is identified by its physical presence on the land. The location of said physical presence is closely approximated by mapping grade Global Positioning System (GPS) data. Said data are checked against the corresponding gray-scale 1-meter Digital Orthophoto Quadrangles published by the United States Geological Survey (USGS) to verify a reasonable degree of accuracy. In circumstances where accurate satellite signal acquisition is not possible, such as deep, narrow canyons or under a canopy of dense foliage, or where very sharp curves in the road make accuracy questionable, such portions of the road were digitized from the corresponding gray-scale 1-meter Digital Orthophoto Quadrangles published by the United States Geological Survey (USGS).

This road-segment may traverse:

Township 43 South Range 13 West, Section(s) 25, Salt Lake Base & Meridian

The following description closely approximates the location of the centerline of the physical monument (HONEYMOON TRAIL)-- Segment 001 based on mapping grade Global Positioning System (GPS) data as defined above:

Beginning at a point on the road center line located at 37 degrees 01 minutes 09.15 seconds North Latitude and -113 degrees 16 minutes 012.6 seconds West Longitude, which can be converted to mapping accuracy State Plane Utah South Zone NAD 83 feet coordinates of X = 1,123,611.1 feet and Y = 9,975,759.6 feet; thence the following courses along the said road center line:

thence South 28 Degrees 37 Minutes 01 Seconds East 38 feet

thence South 28 Degrees 17 Minutes 47 Seconds East 75.4 feet

thence South 23 Degrees 11 Minutes 18 Seconds East 75.9 feet

thence South 27 Degrees 06 Minutes 49 Seconds East 63.2 feet

thence South 38 Degrees 42 Minutes 02 Seconds East 60.7 feet

thence South 46 Degrees 26 Minutes 18 Seconds East 80.5 feet

thence South 52 Degrees 35 Minutes 18 Seconds East 82.1 feet

thence South 56 Degrees 12 Minutes 59 Seconds East 83.2 feet

thence South 55 Degrees 31 Minutes 45 Seconds East 5.6 feet more or less to **the ending point**

at: 37 degrees 01 minutes 04.99 seconds North Latitude and -113 degrees 16 minutes 08.21 seconds West Longitude, which can be converted to mapping accuracy State Plane Utah South Zone NAD 83 feet

coordinates of X = 1,123,959.0 feet and Y = 9,975,331.6 feet.

Appendix B to Attachment 4

Popular Name: HONEYMOON TRAIL

County: Washington

County Road Number: 0425

State Geographic Information Database (SGID) Road Identification Number: RD270425.

Road-Segment Number: 003

Road-Segment Length: 1.43 miles more or less.

Believed owner of the land underlying this road-segment is: Bureau of Land Management.

The following description is based upon the geographic coordinate system using the NAD83 Datum. The source is GPS mapping grade data as indicated in the metadata and/or the transportation data model of the State of Utah Geographic Information Database (SGID).

The road-segment itself is the monument that is identified by its physical presence on the land. The location of said physical presence is closely approximated by mapping grade Global Positioning System (GPS) data. Said data are checked against the corresponding gray-scale 1-meter Digital Orthophoto Quadrangles published by the United States Geological Survey (USGS) to verify a reasonable degree of accuracy. In circumstances where accurate satellite signal acquisition is not possible, such as deep, narrow canyons or under a canopy of dense foliage, or where very sharp curves in the road make accuracy questionable, such portions of the road were digitized from the corresponding gray-scale 1-meter Digital Orthophoto Quadrangles published by the United States Geological Survey (USGS).

This road-segment may traverse:

Township 43 South Range 12 West, Section(s) 30,31,32, Salt Lake Base & Meridian

The following description closely approximates the location of the centerline of the physical monument (HONEYMOON TRAIL)-- Segment 003 based on mapping grade Global Positioning System (GPS) data as defined above:

Beginning at a point on the road center line located at 37 degrees 00 minutes 52.01 seconds North Latitude and -113 degrees 15 minutes 20.29 seconds West Longitude, which can be converted to mapping accuracy State Plane Utah South Zone NAD 83 feet coordinates of X = 1,127,820.1 feet and Y = 9,973,945.7 feet; thence the following courses along the said road center line:

thence South 69 Degrees 08 Minutes 37 Seconds East	23.5 feet
thence South 67 Degrees 05 Minutes 02 Seconds East	22.5 feet
thence South 66 Degrees 15 Minutes 09 Seconds East	56.4 feet
thence South 53 Degrees 57 Minutes 21 Seconds East	55.4 feet
thence South 40 Degrees 53 Minutes 02 Seconds East	60.5 feet
thence South 27 Degrees 32 Minutes 16 Seconds East	60.9 feet
thence South 21 Degrees 15 Minutes 37 Seconds East	67.8 feet
thence South 18 Degrees 46 Minutes 36 Seconds East	100.3 feet
thence South 18 Degrees 52 Minutes 30 Seconds East	113.2 feet
thence South 18 Degrees 28 Minutes 40 Seconds East	124 feet
thence South 18 Degrees 21 Minutes 18 Seconds East	131.1 feet

thence South 17 Degrees 01 Minutes 17 Seconds East 136.7 feet
 thence South 17 Degrees 15 Minutes 34 Seconds East 142.7 feet
 thence South 17 Degrees 46 Minutes 56 Seconds East 146.2 feet
 thence South 19 Degrees 37 Minutes 55 Seconds East 149.5 feet
 thence South 21 Degrees 17 Minutes 38 Seconds East 93.5 feet
 thence South 21 Degrees 17 Minutes 38 Seconds East 61.1 feet
 thence South 22 Degrees 32 Minutes 29 Seconds East 160.2 feet
 thence South 22 Degrees 11 Minutes 28 Seconds East 162.7 feet
 thence South 25 Degrees 17 Minutes 31 Seconds East 151.3 feet
 thence South 23 Degrees 58 Minutes 23 Seconds East 140.4 feet
 thence South 10 Degrees 31 Minutes 17 Seconds East 127.3 feet
 thence South 12 Degrees 35 Minutes 07 Seconds East 126.3 feet
 thence South 21 Degrees 23 Minutes 05 Seconds East 124.8 feet
 thence South 28 Degrees 45 Minutes 00 Seconds East 84 feet
 thence South 51 Degrees 37 Minutes 21 Seconds East 52.5 feet
 thence South 72 Degrees 38 Minutes 40 Seconds East 67.1 feet
 thence South 72 Degrees 41 Minutes 24 Seconds East 84.7 feet
 thence South 83 Degrees 07 Minutes 02 Seconds East 57.9 feet
 thence North 75 Degrees 26 Minutes 10 Seconds East 55.9 feet
 thence North 78 Degrees 37 Minutes 44 Seconds East 66.5 feet
 thence South 83 Degrees 48 Minutes 18 Seconds East 75.6 feet
 thence South 81 Degrees 20 Minutes 26 Seconds East 95 feet
 thence North 89 Degrees 43 Minutes 02 Seconds East 70.9 feet
 thence North 78 Degrees 34 Minutes 52 Seconds East 84.9 feet
 thence North 84 Degrees 52 Minutes 24 Seconds East 97.1 feet
 thence North 88 Degrees 24 Minutes 55 Seconds East 101.1 feet
 thence North 87 Degrees 11 Minutes 28 Seconds East 111.7 feet
 thence North 88 Degrees 24 Minutes 15 Seconds East 114.5 feet
 thence South 77 Degrees 38 Minutes 57 Seconds East 97.5 feet
 thence South 69 Degrees 48 Minutes 08 Seconds East 87.2 feet
 thence South 77 Degrees 55 Minutes 23 Seconds East 84.3 feet
 thence South 84 Degrees 12 Minutes 36 Seconds East 77.5 feet
 thence South 85 Degrees 28 Minutes 19 Seconds East 66.5 feet
 thence South 84 Degrees 59 Minutes 33 Seconds East 89 feet
 thence South 84 Degrees 10 Minutes 01 Seconds East 101.6 feet
 thence South 88 Degrees 16 Minutes 48 Seconds East 93.9 feet
 thence North 84 Degrees 54 Minutes 05 Seconds East 89.9 feet
 thence North 88 Degrees 45 Minutes 10 Seconds East 97.4 feet
 thence North 89 Degrees 43 Minutes 02 Seconds East 111.9 feet
 thence North 87 Degrees 45 Minutes 13 Seconds East 114.9 feet
 thence North 81 Degrees 35 Minutes 14 Seconds East 116 feet
 thence North 79 Degrees 35 Minutes 53 Seconds East 117.6 feet
 thence North 78 Degrees 22 Minutes 24 Seconds East 108.4 feet
 thence North 85 Degrees 12 Minutes 31 Seconds East 91.8 feet
 thence South 88 Degrees 45 Minutes 28 Seconds East 86.3 feet
 thence North 88 Degrees 44 Minutes 58 Seconds East 97.1 feet
 thence North 89 Degrees 19 Minutes 48 Seconds East 97.1 feet
 thence North 84 Degrees 16 Minutes 00 Seconds East 86.3 feet
 thence South 86 Degrees 35 Minutes 28 Seconds East 61.1 feet

thence South 59 Degrees 56 Minutes 49 Seconds East 51.3 feet
 thence South 49 Degrees 21 Minutes 10 Seconds East 62.1 feet
 thence South 47 Degrees 39 Minutes 16 Seconds East 78.5 feet
 thence South 41 Degrees 26 Minutes 47 Seconds East 79.7 feet
 thence South 40 Degrees 34 Minutes 29 Seconds East 98.9 feet
 thence South 46 Degrees 58 Minutes 27 Seconds East 110 feet
 thence South 53 Degrees 43 Minutes 39 Seconds East 107.4 feet
 thence South 62 Degrees 48 Minutes 51 Seconds East 111.7 feet
 thence South 62 Degrees 23 Minutes 41 Seconds East 101.7 feet
 thence South 65 Degrees 14 Minutes 49 Seconds East 60.5 feet
 thence South 82 Degrees 26 Minutes 49 Seconds East 72.2 feet
 thence North 79 Degrees 47 Minutes 44 Seconds East 100.9 feet
 thence North 76 Degrees 02 Minutes 45 Seconds East 75 feet
 thence North 76 Degrees 02 Minutes 45 Seconds East 25 feet
 thence North 65 Degrees 35 Minutes 46 Seconds East 96.3 feet
 thence North 69 Degrees 29 Minutes 02 Seconds East 109.1 feet
 thence North 67 Degrees 36 Minutes 10 Seconds East 111.5 feet
 thence North 64 Degrees 02 Minutes 25 Seconds East 113.6 feet
 thence North 63 Degrees 55 Minutes 59 Seconds East 118.4 feet
 thence North 65 Degrees 43 Minutes 13 Seconds East 111.3 feet
 thence North 62 Degrees 09 Minutes 29 Seconds East 42.7 feet
 thence North 62 Degrees 09 Minutes 16 Seconds East 5.7 feet more or less to **the ending point**

at: 37 degrees 00 minutes 27.14 seconds North Latitude and -113 degrees 14 minutes 10.01 seconds West Longitude, which can be converted to mapping accuracy State Plane Utah South Zone NAD 83 feet coordinates of X = 1,133,472.7 feet and Y = 9,971,324.3 feet.

Attachment 5

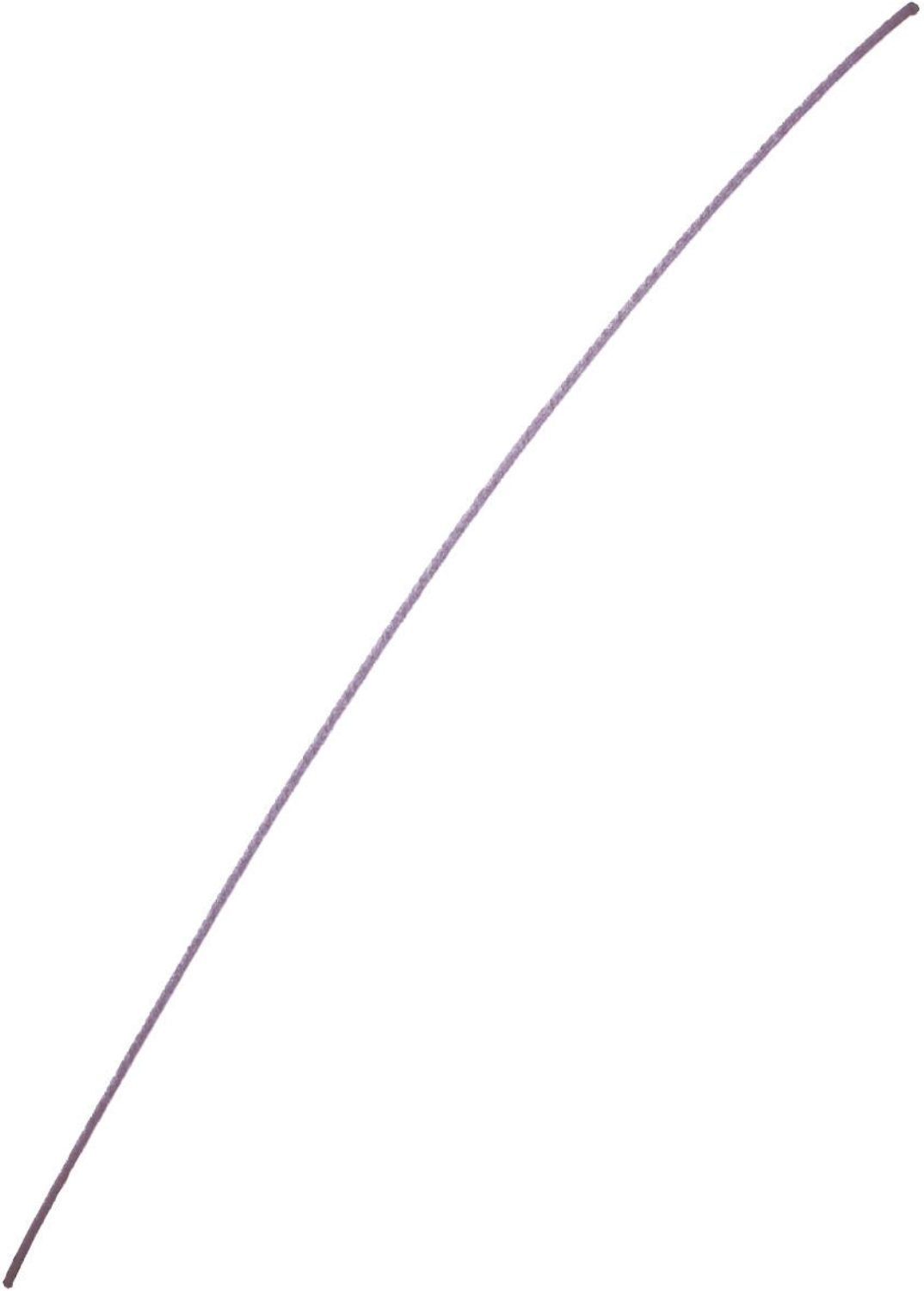

AFFIDAVIT OF RYMAL J. HINTON
HONEYMOON TRAIL ROAD
COUNTY ROAD NUMBER 0425
WASHINGTON COUNTY, UTAH

State of Utah)
 :ss
County of Washington)

RYMAL J. HINTON, being first duly sworn, deposes and states as follows:

1. I am an adult competent to testify about the matters set forth below based upon my personal knowledge. I am 56 years old. I currently reside in Hurricane, Washington County, Utah. I have lived in Washington County my entire life. I have been employed as a Deputy Sheriff for Washington County for about 28 years, and a member of the Search and Rescue Team for 37 years.

2. I have traveled and am familiar with a road in Washington County known as HONEYMOON TRAIL ROAD. I am also familiar with the land the road traverses. I traveled the road with my father as early as 1960, before I could drive, for recreation and on search and rescue operations. When I first used and observed the road in 1960, it followed the same route as in 2006 when I last observed it. Attached is a Washington County map showing HONEYMOON TRAIL ROAD. To the best of my knowledge and based upon my use of and familiarity with this road and the land it traverses, the location and route of the road are correctly illustrated on the attached map. The County also identifies this road according to the road number listed above.

3. I have observed that the road has been open to the public for all to use, to come and go as they pleased, since at least 1960, and continuing through 1976 to the present. Throughout this time period I have observed travel on the road by trucks, jeeps, stock trucks and other motor vehicles. Throughout this time period, the road has been used daily for more than ten continuous years prior to 1976, and it is presently used on a daily basis, weather permitting.

4. Throughout the time period from 1960 to the present, I have used the road myself for hunting, camping, hiking, sight seeing, wood gathering, government access for my job, and trapping.

5. Throughout the time period described in the previous paragraphs, I observed vehicles using the road at various times for the uses described in the previous paragraphs, plus livestock operations, commerce, mining and prospecting, recreation and tourism, and travel in and through the general areas.

6. It is also the reputation in the community that this road has been open to the public for all to use, to come and go as they pleased as early as 1900, when pioneers used the road, and continuing through 1976 to the present, for the uses described in the previous paragraphs.

7. Prior to 1976, I occasionally observed graders and road crews from Washington County on the road. I observed general repairs and maintenance of the road.

I observed cattle guards, berms, cuts and fills, grader marks, culverts, flood repair work, and gated areas, where necessary.

DATED this 12 of April, 2007.





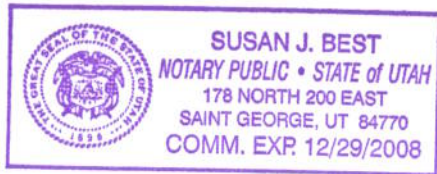

RYMAL J. HINTON

SUBSCRIBED AND SWORN to before me this 12 day of April, 2007.

NOTARY PUBLIC



WASHINGTON COUNTY HONEYMOON TRAIL ROAD #0425

-  RS2477 Road
-  Class B Roads
-  Transportation
-  INTERSTATE
-  SECONDARY ROUTE
-  Municipal Boundary

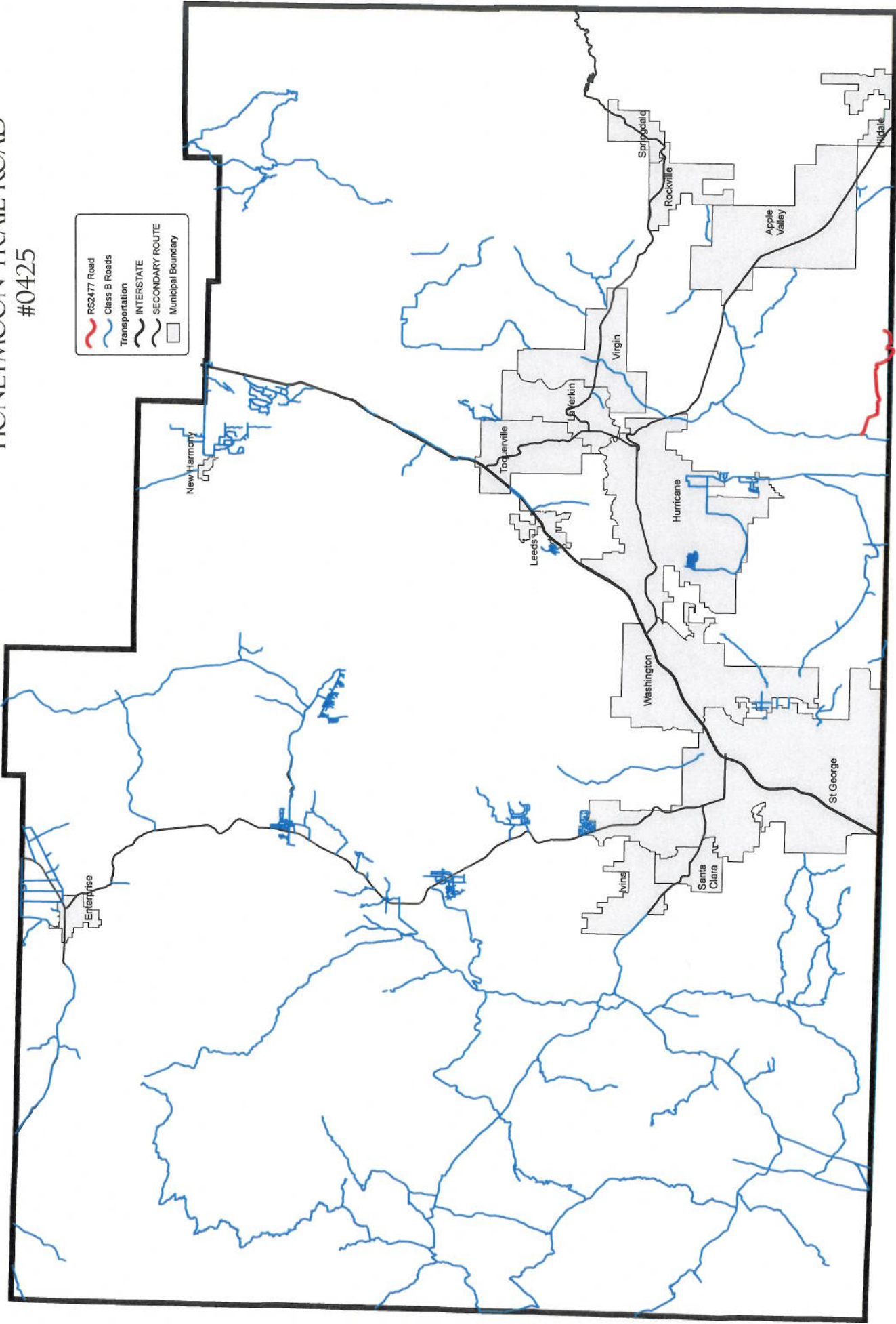

3. I have observed that the road has been open to the public for all to use, to come and go as they pleased, since 1964, and continuing through 1976 to 2006.

Throughout this time period I have observed travel on the road by private pickup trucks, jeeps, stock trucks, motorcycles, and other motor vehicles. Through out this time period, the road has been used daily for more than ten continuous years prior to 1976, and it is presently used daily.

4. Throughout the time period from 1964 to 2006, I have used the road myself, occasionally, weather permitting, for wood gathering, sight seeing and hunting.

5. Throughout the time period described in the previous paragraph, I observed vehicles using the road at various times for uses described in the previous paragraph, plus government access; trapping; livestock operations; mining; prospecting; tourism; and recreation, such as camping, picnicking, hiking, and traveling in and through the general areas.

6. It is also my understanding that it is the reputation in the community that this road has been open to the public for all to use, to come and go as they pleased since the early pioneer settlers arrived, and continuing through 1976 to 2006, for the uses described in the previous paragraphs.

7. Prior to 1976, I observed general repairs, maintenance and/or construction activities of the road by Washington County. I observed parked graders, cattle guards, berms, gravel, culverts, graded and raised surfaces, cuts and fills, grader marks, and flood and repair work on the road on an as-needed-basis. I occasionally observed Washington County graders on the road.

DATED this 2nd of March, 2007

GEORGE EDWARD WRIGHT





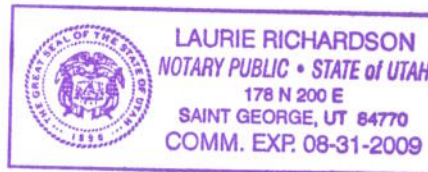

SUBSCRIBED AND SWORN to before me this 2nd day of March, 2007.



NOTARY PUBLIC

END OF DOCUMENT

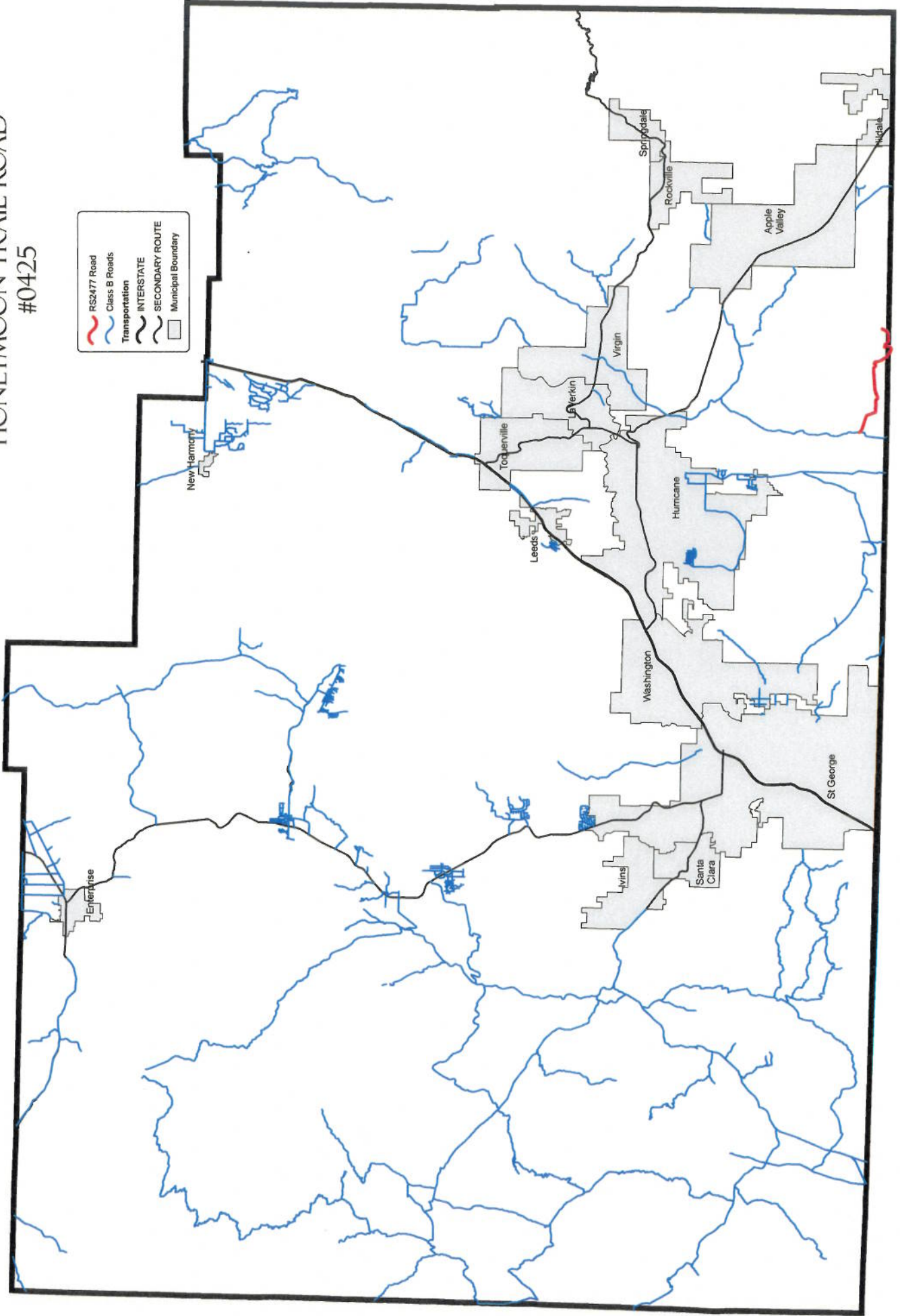

WASHINGTON COUNTY HONEYMOON TRAIL ROAD #0425

-  RS2477 Road
-  Class B Roads
-  Transportation
-  INTERSTATE
-  SECONDARY ROUTE
-  Municipal Boundary



Appendix C to Attachment 4

Popular Name: HONEYMOON TRAIL

County: Washington

County Road Number: 0425

State Geographic Information Database (SGID) Road Identification Number: RD270425.

Road-Segment Number: 005

Road-Segment Length: 1.04 miles more or less.

Believed owner of the land underlying this road-segment is: Bureau of Land Management.

The following description is based upon the geographic coordinate system using the NAD83 Datum. The source is GPS mapping grade data as indicated in the metadata and/or the transportation data model of the State of Utah Geographic Information Database (SGID).

The road-segment itself is the monument that is identified by its physical presence on the land. The location of said physical presence is closely approximated by mapping grade Global Positioning System (GPS) data. Said data are checked against the corresponding gray-scale 1-meter Digital Orthophoto Quadrangles published by the United States Geological Survey (USGS) to verify a reasonable degree of accuracy. In circumstances where accurate satellite signal acquisition is not possible, such as deep, narrow canyons or under a canopy of dense foliage, or where very sharp curves in the road make accuracy questionable, such portions of the road were digitized from the corresponding gray-scale 1-meter Digital Orthophoto Quadrangles published by the United States Geological Survey (USGS).

This road-segment may traverse:

Township 43 South Range 12 West, Section(s) 33, Salt Lake Base & Meridian

The following description closely approximates the location of the centerline of the physical monument (HONEYMOON TRAIL)-- Segment 005 based on mapping grade Global Positioning System (GPS) data as defined above:

Beginning at a point on the road center line located at 37 degrees 00 minutes 33.96 seconds North Latitude and -113 degrees 13 minutes 04.82 seconds West Longitude, which can be converted to mapping accuracy State Plane Utah South Zone NAD 83 feet coordinates of X = 1,138,772.1 feet and Y = 9,971,916.2 feet; thence the following courses along the said road center line:

thence North 80 Degrees 12 Minutes 51 Seconds East	14.3 feet
thence North 74 Degrees 20 Minutes 26 Seconds East	81.7 feet
thence North 74 Degrees 29 Minutes 56 Seconds East	88.7 feet
thence North 81 Degrees 35 Minutes 12 Seconds East	92.8 feet
thence North 88 Degrees 01 Minutes 11 Seconds East	88.6 feet
thence North 88 Degrees 38 Minutes 53 Seconds East	87.9 feet
thence North 87 Degrees 41 Minutes 09 Seconds East	92.6 feet
thence North 89 Degrees 21 Minutes 03 Seconds East	102.7 feet
thence North 87 Degrees 18 Minutes 28 Seconds East	101.5 feet
thence North 86 Degrees 07 Minutes 32 Seconds East	78.6 feet
thence North 87 Degrees 04 Minutes 54 Seconds East	78.5 feet

thence North 86 Degrees 26 Minutes 29 Seconds East 109.1 feet
 thence North 87 Degrees 05 Minutes 54 Seconds East 107.7 feet
 thence North 86 Degrees 36 Minutes 29 Seconds East 102.8 feet
 thence South 89 Degrees 53 Minutes 45 Seconds East 97.1 feet
 thence South 78 Degrees 58 Minutes 23 Seconds East 88.7 feet
 thence South 68 Degrees 14 Minutes 31 Seconds East 87.4 feet
 thence South 57 Degrees 57 Minutes 48 Seconds East 95.1 feet
 thence South 52 Degrees 26 Minutes 22 Seconds East 104.3 feet
 thence South 46 Degrees 38 Minutes 59 Seconds East 107 feet
 thence South 43 Degrees 57 Minutes 02 Seconds East 109.8 feet
 thence South 50 Degrees 15 Minutes 09 Seconds East 85.7 feet
 thence South 64 Degrees 10 Minutes 08 Seconds East 74.5 feet
 thence South 76 Degrees 48 Minutes 52 Seconds East 80.3 feet
 thence South 75 Degrees 07 Minutes 28 Seconds East 85.3 feet
 thence South 76 Degrees 29 Minutes 38 Seconds East 92.2 feet
 thence North 87 Degrees 36 Minutes 13 Seconds East 89 feet
 thence North 74 Degrees 45 Minutes 30 Seconds East 44.5 feet
 thence North 73 Degrees 13 Minutes 31 Seconds East 52 feet
 thence North 50 Degrees 46 Minutes 02 Seconds East 50.6 feet
 thence North 48 Degrees 35 Minutes 43 Seconds East 54.9 feet
 thence North 61 Degrees 07 Minutes 56 Seconds East 58.3 feet
 thence North 56 Degrees 44 Minutes 21 Seconds East 51.2 feet
 thence North 38 Degrees 34 Minutes 13 Seconds East 45.5 feet
 thence North 22 Degrees 05 Minutes 49 Seconds East 48.3 feet
 thence North 28 Degrees 21 Minutes 40 Seconds East 44.5 feet
 thence North 66 Degrees 57 Minutes 07 Seconds East 39.8 feet
 thence South 79 Degrees 11 Minutes 21 Seconds East 51.2 feet
 thence South 65 Degrees 22 Minutes 41 Seconds East 70.9 feet
 thence South 61 Degrees 41 Minutes 33 Seconds East 74.7 feet
 thence South 63 Degrees 22 Minutes 37 Seconds East 73.9 feet
 thence South 61 Degrees 25 Minutes 07 Seconds East 76.8 feet
 thence South 43 Degrees 00 Minutes 23 Seconds East 75.9 feet
 thence South 39 Degrees 57 Minutes 52 Seconds East 77.6 feet
 thence South 29 Degrees 09 Minutes 46 Seconds East 83.6 feet
 thence South 09 Degrees 23 Minutes 25 Seconds East 87.1 feet
 thence South 00 Degrees 04 Minutes 23 Seconds East 89.6 feet
 thence South 04 Degrees 08 Minutes 52 Seconds West 89.2 feet
 thence South 07 Degrees 24 Minutes 46 Seconds West 85.7 feet
 thence South 05 Degrees 29 Minutes 20 Seconds West 91.3 feet
 thence South 02 Degrees 04 Minutes 47 Seconds East 83.7 feet
 thence South 10 Degrees 14 Minutes 00 Seconds East 75.9 feet
 thence South 15 Degrees 52 Minutes 32 Seconds East 58.6 feet
 thence South 18 Degrees 29 Minutes 29 Seconds East 78.7 feet
 thence South 22 Degrees 32 Minutes 29 Seconds East 84 feet
 thence South 24 Degrees 30 Minutes 38 Seconds East 86.3 feet
 thence South 26 Degrees 45 Minutes 01 Seconds East 86.1 feet
 thence South 26 Degrees 23 Minutes 35 Seconds East 92.4 feet
 thence South 27 Degrees 16 Minutes 32 Seconds East 98.3 feet
 thence South 23 Degrees 28 Minutes 53 Seconds East 99.9 feet

thence South 16 Degrees 08 Minutes 47 Seconds East 94.8 feet
thence South 16 Degrees 34 Minutes 58 Seconds East 94.7 feet
thence South 23 Degrees 19 Minutes 35 Seconds East 95.5 feet
thence South 28 Degrees 11 Minutes 23 Seconds East 100.2 feet
thence South 30 Degrees 43 Minutes 40 Seconds East 93.2 feet
thence South 39 Degrees 09 Minutes 44 Seconds East 93.6 feet
thence South 38 Degrees 38 Minutes 15 Seconds East 96.2 feet
thence South 46 Degrees 32 Minutes 58 Seconds East 51.1 feet more or less to **the ending**

point at: 37 degrees 00 minutes 012.4 seconds North Latitude and -113 degrees 12 minutes 18.44 seconds West Longitude, which can be converted to mapping accuracy State Plane Utah South Zone NAD 83 feet coordinates of X = 1,142,494.3 feet and Y = 9,969,667.4 feet.

Appendix D to Attachment 4

Popular Name: HONEYMOON TRAIL

County: Washington

County Road Number: 0425

State Geographic Information Database (SGID) Road Identification Number: RD270425.

Road-Segment Number: 008

Road-Segment Length: 0.33 miles more or less.

Believed owner of the land underlying this road-segment is: Bureau of Land Management.

The following description is based upon the geographic coordinate system using the NAD83 Datum. The source is GPS mapping grade data as indicated in the metadata and/or the transportation data model of the State of Utah Geographic Information Database (SGID).

The road-segment itself is the monument that is identified by its physical presence on the land. The location of said physical presence is closely approximated by mapping grade Global Positioning System (GPS) data. Said data are checked against the corresponding gray-scale 1-meter Digital Orthophoto Quadrangles published by the United States Geological Survey (USGS) to verify a reasonable degree of accuracy. In circumstances where accurate satellite signal acquisition is not possible, such as deep, narrow canyons or under a canopy of dense foliage, or where very sharp curves in the road make accuracy questionable, such portions of the road were digitized from the corresponding gray-scale 1-meter Digital Orthophoto Quadrangles published by the United States Geological Survey (USGS).

This road-segment may traverse:

Township 43 South Range 12 West, Section(s) 35, Salt Lake Base & Meridian

The following description closely approximates the location of the centerline of the physical monument (HONEYMOON TRAIL)-- Segment 008 based on mapping grade Global Positioning System (GPS) data as defined above:

Beginning at a point on the road center line located at 37 degrees 00 minutes 02.85 seconds North Latitude and -113 degrees 10 minutes 54.33 seconds West Longitude, which can be converted to mapping accuracy State Plane Utah South Zone NAD 83 feet coordinates of X = 1,149,298.3 feet and Y = 9,968,578.3 feet; thence the following courses along the said road center line:

thence North 62 Degrees 14 Minutes 33 Seconds East	46.2 feet
thence North 62 Degrees 59 Minutes 14 Seconds East	51.1 feet
thence North 61 Degrees 34 Minutes 57 Seconds East	53.6 feet
thence North 58 Degrees 56 Minutes 47 Seconds East	50 feet
thence North 57 Degrees 04 Minutes 20 Seconds East	49.9 feet
thence North 57 Degrees 05 Minutes 09 Seconds East	54.1 feet
thence North 58 Degrees 41 Minutes 46 Seconds East	56.7 feet
thence North 55 Degrees 44 Minutes 47 Seconds East	55.8 feet
thence North 46 Degrees 49 Minutes 06 Seconds East	50.6 feet
thence North 42 Degrees 27 Minutes 58 Seconds East	53.2 feet
thence North 42 Degrees 56 Minutes 05 Seconds East	52.2 feet

thence North 45 Degrees 22 Minutes 13 Seconds East 61 feet
thence North 42 Degrees 07 Minutes 30 Seconds East 56.4 feet
thence North 33 Degrees 04 Minutes 30 Seconds East 47.1 feet
thence North 29 Degrees 30 Minutes 23 Seconds East 52.2 feet
thence North 33 Degrees 48 Minutes 42 Seconds East 51.5 feet
thence North 33 Degrees 19 Minutes 39 Seconds East 65.8 feet
thence North 30 Degrees 40 Minutes 50 Seconds East 67 feet
thence North 27 Degrees 23 Minutes 52 Seconds East 67.8 feet
thence North 28 Degrees 27 Minutes 23 Seconds East 69.6 feet
thence North 28 Degrees 54 Minutes 51 Seconds East 76.7 feet
thence North 29 Degrees 02 Minutes 55 Seconds East 79 feet
thence North 22 Degrees 21 Minutes 30 Seconds East 66.5 feet
thence North 15 Degrees 34 Minutes 21 Seconds East 57.6 feet
thence North 15 Degrees 47 Minutes 07 Seconds East 62.8 feet
thence North 19 Degrees 38 Minutes 57 Seconds East 63.5 feet
thence North 22 Degrees 34 Minutes 41 Seconds East 65.9 feet
thence North 27 Degrees 54 Minutes 20 Seconds East 57 feet
thence North 29 Degrees 45 Minutes 16 Seconds East 55.7 feet
thence North 36 Degrees 43 Minutes 38 Seconds East 53.4 feet more or less to **the ending**

point at: 37 degrees 00 minutes 16.35 seconds North Latitude and -113 degrees 10 minutes 41.95 seconds West Longitude, which can be converted to mapping accuracy State Plane Utah South Zone NAD 83 feet coordinates of X = 1,150,327.1 feet and Y = 9,969,925.8 feet.

Appendix E to Attachment 4

Popular Name: HONEYMOON TRAIL

County: Washington

County Road Number: 0425

State Geographic Information Database (SGID) Road Identification Number: RD270425.

Road-Segment Number: 009

Road-Segment Length: 0.45 miles more or less.

Believed owner of the land underlying this road-segment is: Bureau of Land Management.

The following description is based upon the geographic coordinate system using the NAD83 Datum. The source is GPS mapping grade data as indicated in the metadata and/or the transportation data model of the State of Utah Geographic Information Database (SGID).

The road-segment itself is the monument that is identified by its physical presence on the land. The location of said physical presence is closely approximated by mapping grade Global Positioning System (GPS) data. Said data are checked against the corresponding gray-scale 1-meter Digital Orthophoto Quadrangles published by the United States Geological Survey (USGS) to verify a reasonable degree of accuracy. In circumstances where accurate satellite signal acquisition is not possible, such as deep, narrow canyons or under a canopy of dense foliage, or where very sharp curves in the road make accuracy questionable, such portions of the road were digitized from the corresponding gray-scale 1-meter Digital Orthophoto Quadrangles published by the United States Geological Survey (USGS).

This road-segment may traverse:

Township 43 South Range 12 West, Section(s) 34, Salt Lake Base & Meridian

The following description closely approximates the location of the centerline of the physical monument (HONEYMOON TRAIL)-- Segment 009 based on mapping grade Global Positioning System (GPS) data as defined above:

Beginning at a point on the road center line located at 37 degrees 00 minutes 00.03 seconds North Latitude and -113 degrees 11 minutes 38.62 seconds West Longitude, which can be converted to mapping accuracy State Plane Utah South Zone NAD 83 feet coordinates of X = 1,145,701.3 feet and Y = 9,968,358.0 feet; thence the following courses along the said road center line:

thence North 04 Degrees 23 Minutes 05 Seconds East 21.2 feet
thence North 03 Degrees 52 Minutes 36 Seconds East 54.3 feet
thence North 10 Degrees 40 Minutes 56 Seconds East 53.5 feet
thence North 20 Degrees 16 Minutes 23 Seconds East 58.9 feet
thence North 18 Degrees 43 Minutes 57 Seconds East 61.4 feet
thence North 05 Degrees 43 Minutes 33 Seconds East 56.4 feet
thence North 08 Degrees 19 Minutes 20 Seconds West 58.6 feet
thence North 10 Degrees 31 Minutes 50 Seconds West 59 feet
thence North 04 Degrees 43 Minutes 37 Seconds West 63.5 feet
thence North 14 Degrees 14 Minutes 40 Seconds West 61.2 feet
thence North 35 Degrees 19 Minutes 42 Seconds West 57.7 feet

thence North 32 Degrees 03 Minutes 13 Seconds West 67.9 feet
 thence North 23 Degrees 34 Minutes 50 Seconds West 74.7 feet
 thence North 24 Degrees 07 Minutes 18 Seconds West 77.1 feet
 thence North 15 Degrees 55 Minutes 30 Seconds West 68.1 feet
 thence North 03 Degrees 28 Minutes 51 Seconds East 50 feet
 thence North 33 Degrees 04 Minutes 30 Seconds East 47.1 feet
 thence North 71 Degrees 01 Minutes 26 Seconds East 46.1 feet
 thence South 74 Degrees 02 Minutes 24 Seconds East 43.4 feet
 thence South 50 Degrees 20 Minutes 24 Seconds East 52.6 feet
 thence South 37 Degrees 12 Minutes 57 Seconds East 59.5 feet
 thence South 30 Degrees 54 Minutes 46 Seconds East 58 feet
 thence South 35 Degrees 14 Minutes 59 Seconds East 61.3 feet
 thence South 49 Degrees 26 Minutes 03 Seconds East 57.7 feet
 thence South 75 Degrees 22 Minutes 37 Seconds East 47.2 feet
 thence North 79 Degrees 21 Minutes 28 Seconds East 31 feet
 thence North 67 Degrees 45 Minutes 23 Seconds East 43.9 feet
 thence North 84 Degrees 53 Minutes 30 Seconds East 50.7 feet
 thence North 84 Degrees 15 Minutes 11 Seconds East 37.9 feet
 thence North 81 Degrees 45 Minutes 50 Seconds East 45.1 feet
 thence North 87 Degrees 19 Minutes 51 Seconds East 39.4 feet
 thence North 80 Degrees 58 Minutes 15 Seconds East 47.5 feet
 thence North 69 Degrees 06 Minutes 59 Seconds East 49.4 feet
 thence North 79 Degrees 18 Minutes 03 Seconds East 45.4 feet
 thence South 70 Degrees 09 Minutes 34 Seconds East 45.8 feet
 thence South 50 Degrees 22 Minutes 49 Seconds East 49.6 feet
 thence South 46 Degrees 06 Minutes 19 Seconds East 48.5 feet
 thence South 43 Degrees 13 Minutes 45 Seconds East 58.3 feet
 thence South 33 Degrees 03 Minutes 15 Seconds East 62.4 feet
 thence South 30 Degrees 19 Minutes 37 Seconds East 70.1 feet
 thence South 32 Degrees 17 Minutes 18 Seconds East 74.3 feet
 thence South 34 Degrees 56 Minutes 47 Seconds East 75 feet
 thence South 36 Degrees 02 Minutes 12 Seconds East 70.7 feet
 thence South 35 Degrees 56 Minutes 17 Seconds East 18.1 feet more or less to **the ending**

point at: 37 degrees 00 minutes 03.64 seconds North Latitude and -113 degrees 11 minutes 26.88 seconds West Longitude, which can be converted to mapping accuracy State Plane Utah South Zone NAD 83 feet coordinates of X = 1,146,659.7 feet and Y = 9,968,705.3 feet.